

iHome®

Model iHL31

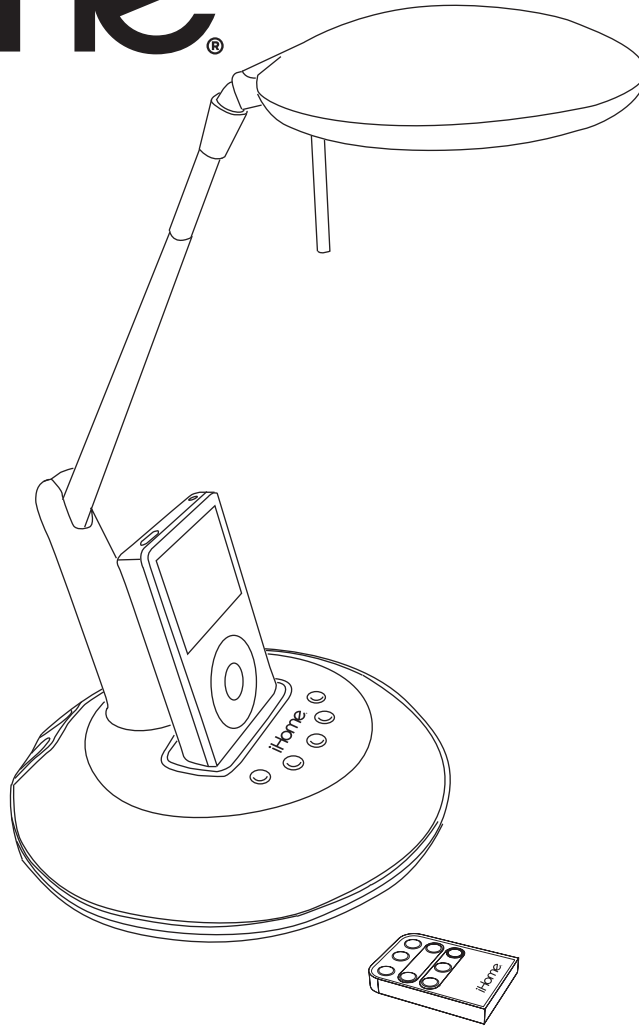

NOTE: THIS UNIT WILL NOT CONTROL OR CHARGE 3G iPod

Questions? Visit www.checkolite.com

Table of Contents

Using the iHL31.....	2
Quick Start.....	3
Using the Remote Control Unit.....	4
Maintenance.....	5
FCC Regulations.....	5
Consumer Guide to Product Safety.....	6
Troubleshooting.....	7
Warranty information.....	8

Using the iH31

Powering the Lamp

- Attach the AC adapter cable to jack on the back of the iHL31, and then power the lamp by plugging the power plug into a wall socket.
- The iHL31 uses a halogen bulb (G5.3) with a maximum wattage of 35W (included).
- The light can be turned on by either pressing  at the base of the lamp or the remote control.





Installing your iPod

- The iHL31 comes with removable dock inserts to ensure your iPod fits perfectly in the docking station.
- Place proper insert for your iPod (see insert table under Quick Start) in dock, then gently dock iPod. When docked, your iPod will charge until fully charged. **Unit will not overcharge iPod. Note: The iHL31 will not control or charge 3G iPod models.**
- Upon removal, gently pull upwards to minimize rocking back and forth.

Using the Line-in jack

- An audio patch cord comes with the iHL31. Use it to play non-docking iPods or other audio devices through the iHL31 line-in jack (one end in the device's line-out or headphones jack, the other in the iHL31 line-in jack). Make sure there is no iPod docked in the iHL31 when using the line-in jack. Any non-docking iPod models, including the iPod Shuffle as well as other audio devices using the patch cord, will not charge.

Listening to your iPod

- The base of the lamp features four buttons to control your music: volume control, speaker on/off, and bass boost. Use  to decrease sound,  to increase,  to turn the speaker power on and off, and  for added bass.
- The same controls may be accessed with the remote control. Please refer to the remote control diagram for usage.

quick start

1: power

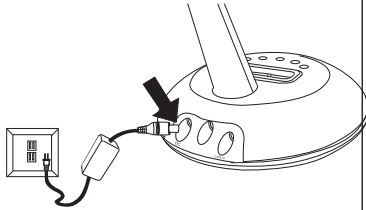

Attach AC adapter cable to jack on back of the iHL31 and plug the other end into a wall socket.

2: light

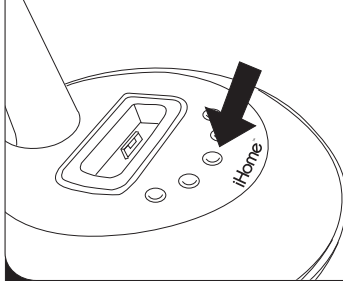

Press the Light button to turn the light on. Press again to turn the light off. Maximum wattage for the light is 35W.

3: insert

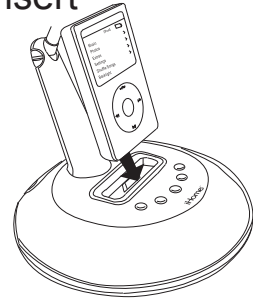

Insert an iPod into the dock (iPod must not be in a skin or case). The iPod will charge while docked.

4: non-docking

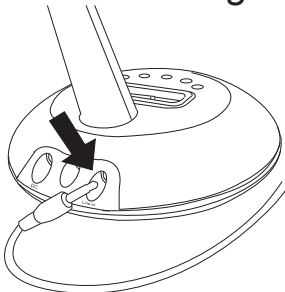

For all non-docking iPod models, including the iPod shuffle, as well as other audio devices, use the 3.5mm line-in patch cord. (All non-docking models will not charge.)

5: play

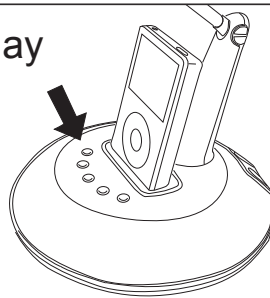

The base of the unit features quick reach buttons for playing your iPod, including bass boost, speaker/power, and volume control. You may also use the remote control for additional features.



Bass



Speaker/Power



Light on/off



Volume -



Volume +

Using the Remote Control Unit

The remote control controls basic functions on the iHL31 and certain iPod functions when the iPod is docked in the iHL31. For best results, use the remote control within twelve feet or six meters of the unit.

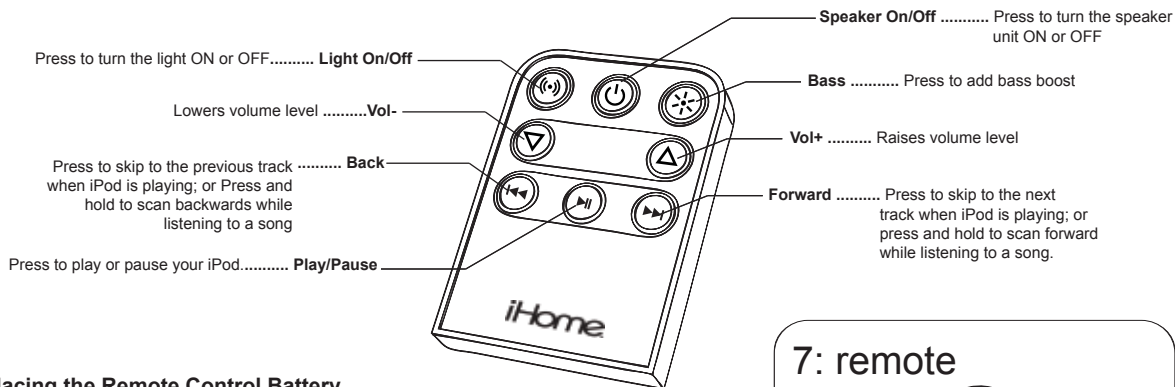

Replacing the Remote Control Battery

When the remote control stops operating or its range seems reduced, replace the battery with a new one.

1. The battery door is located on the bottom of the back end of the unit.
2. Grip with a fingernail or coin and pull the battery door latch.
3. Insert one "CR2025" 3-volt lithium battery. Make sure the polarity (the + and the - side of the battery is facing the back of the unit).
4. Slide the battery holder back into the remote control.

NOTE: PLEASE DISCARD BATTERIES PROPERLY

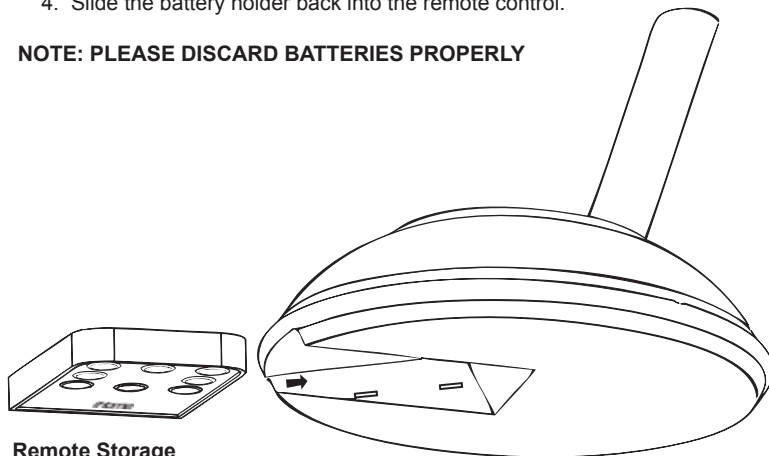

Remote Storage

Remote control slides inside compartment located underneath the base lamp

7: remote

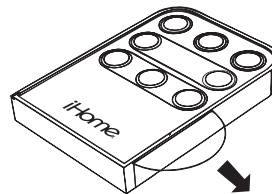

The remote controls all the lamp's functions. Battery comes preinserted. Remove plastic slip before operating.

maintenance

1: unscrew

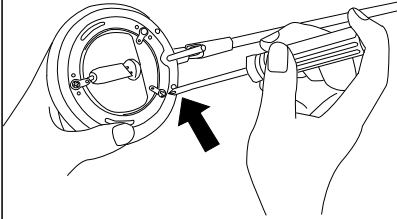

Using a phillip's head screwdriver, loosen all the screws of the bulb's clear casing. Turn the metal clips away from the circular disc to release the casing.

2: replace

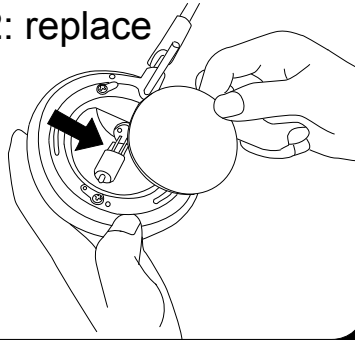

Remove the halogen bulb from the two-pronged slot and replace with a new bulb. Place the circular disc back in its original location and slide the metal clips to secure the disc in place. Tighten the screws to ensure a firm hold.

NOTE: When replacing the bulb do not touch with bare hands as touching the bulb will significantly reduce its life span.

FCC Regulations

Warning: Changes or modifications to this unit not expressly approved by the party responsible for compliance could void the user's authority to operate the equipment.

NOTE: This equipment has been tested and found to comply with the limits for a Class B digital device, pursuant to Part 15 of the FCC Rules. These limits are designed to provide reasonable protection against harmful interference in a residential installation. This equipment generates, uses and can radiate radio frequency energy and, if not installed and used in accordance with the instructions, may cause harmful interference to radio communications. However, there is no guarantee that interference will not occur in a particular installation. If this equipment does cause harmful interference to radio or television reception, which can be determined by turning the equipment off and on, the user is encouraged to try to correct the interference by one or more of the following measures:

Reorient or relocate the receiving antenna.

Increase the separation between the equipment and receiver.

Connect the equipment into an outlet on a circuit different from that to which the receiver is connected.

Consult the dealer or an experienced radio/ TV technician for help.

IMPORTANT SAFETY INSTRUCTIONS

When used in the directed manner, this unit has been designed and manufactured to ensure your personal safety. However, improper use can result in potential electrical shock or fire hazards. Please read all safety and operating instructions carefully before installation and use, and keep these instructions handy for future reference. Take special note of all warnings listed in these instructions and on the unit.

1. **Water and Moisture** - The unit should not be used near water. For example: near a bathtub, washbowl, kitchen sink, laundry tub, swimming pool or in a wet basement.
2. **Ventilation** - The unit should be situated so that its location or position does not interfere with its proper ventilation. For example, it should not be situated on a bed, sofa, rug, or similar surface that may block ventilation openings. Also, it should not be placed in a built-in installation, such as a bookcase or cabinet, which may impede the flow of air through the ventilation openings.
3. **Heat** - The unit should be situated away from heat sources such as radiators, heat registers, stoves or other appliances (including amplifiers) that produce heat.
4. **Power Sources** - The unit should be connected to a power supply only of the type described in the operating instructions or as marked on the appliance.
5. **Power- Cable Protection** - Power supply cables should be routed so that they are not likely to be walked on or pinched by items placed upon or against them. It is always best to have a clear area from where the cable exits the unit to where it is plugged into an AC socket.
6. **Cleaning** - The unit should be cleaned only as recommended. Clean using only a slightly damp cloth. Do not use cleaners with chemical agents.
7. **Objects and Liquid Entry** - Care should be taken so that objects do not fall and liquids are not spilled into any openings or vents located on the product.
8. **Attachments** - Do not use attachments not recommended by the product manufacturer.
9. **Lightning and Power Surge Protection** - Unplug the unit from the wall socket and disconnect the antenna or cable system during a lightning storm or when it is left unattended and unused for long periods of time. This will prevent damage to the product due to lightning and power-line surges.
10. **Overloading** - Do not overload wall sockets, extension cords, or integral convenience receptacles as this can result in a risk of fire or electric shock.
11. **Damage Requiring Service** - The unit should be serviced by qualified service personnel when:
 - A. the power supply cable or plug has been damaged.
 - B. objects have fallen into or liquid has been spilled into the enclosure.
 - C. the unit has been exposed to rain.
 - D. the unit has been dropped or enclosure damaged.
 - E. the unit exhibits a marked change in performance or does not operate normally.
12. **Polarized Plug** - Do not defeat the purpose of the polarized or grounding plug. A polarized plug has two blades with one wider than the other. A grounding plug has two blades and a third grounding prong. The wide blade or the third prong is provided for your safety. If the provided plug does not fit your outlet, consult an electrician for replacement of the obsolete outlet.
13. **Periods of Nonuse** - If the unit is to be left unused for an extended period of time, such as a month or longer, the power cable should be unplugged from the unit to prevent damage or corrosion.
14. **Servicing** - The user should not attempt to service the unit beyond those methods described in the user's operating instructions. Service methods not covered in the operating instructions should be referred to the qualified service personnel.
15. **Handling** - Avoid rough handling such as bumping or dropping unit. Avoid moisture and extreme temperatures. For best results, use between the temperatures of 40°F (4°C) and 100°F (38°C).

Troubleshooting

Symptom	Possible Problem	Solution
iHL31 does not turn on	AC adaptor isn't plugged into a working wall socket or not plugged into the power supply jack on back of unit.	Plug the AC adaptor into a working wall socket and plug the connector into the supply jack on the unit
iHL31 doesn't respond	iHL31 requires a reset	If unit is plugged in and doesn't respond, try resetting the unit by following these steps: a) remove iPod from dock b) unplug unit from power source c) wait 1 hour, then resume use
	iPod is not docked properly	Remove your iPod from the dock and check from obstruction on the connectors in the dock and on your iPod. Then reseal it in the dock.
iPod does not respond to the unit/iPod is playing but no sound comes out	iPod is not docked properly	Remove your iPod from the dock and check from obstruction on the connectors in the dock and on your iPod. Then reseal it in the dock.
	Your iPod software is too old	Upgrade software on your iPod. For details visit http://www.apple.com/ipod/download
	iPod is locked up/plays but no sound comes out	Check the volume setting. Make sure your iPod is working properly before docking into the unit. Please refer to your iPod manual for details. See above for software upgrade information. You may need to reset your iPod. To do so: 1. Toggle the Hold switch to hold position, then off. 2. Press and hold the Menu and center Select buttons at the same time until Apple logo appears. You may need to repeat this step.
	Using 1st and 2nd generation iPod, iPod shuffle or other devices	iHL31 cannot control those iPod or these devices.
iHL31/iPod performance is erratic	The iHL31 is reacting to external interference	Move unit away from potential sources of external interference such as computers, modems, wireless devices (routers) or fluorescent light.
No sound from iHL31	Volume is set too low on iHL31	Make sure volume is turned up.
iPod didn't charge up	iPod is not installed properly	Remove your iPod from the dock and check from obstruction on the connectors in the dock and on your iPod. Then reseal it in the dock.
	iPod is locked up/frozen	Please make sure your iPod is working properly before docking into the unit. Please refer to your iPod manual for details.
	iPod battery has a problem	
Sound is distorted	Volume level is set too high	Decrease the volume
	Sound source is distorted	If the iPod original sound source (MP3) is old or of poor quality, distortion and noise are easily noticed with high-power speakers. Try a different audio source such as a music CD. If you are using an external sound source like older generation of iPod or iPod shuffle, try reducing the output volume on the device itself. Also try turning bass boost OFF.
Can't hear headphones/ speakers attached to line out jack	Line out jack is not meant for headphones. Speakers need a power source.	The signal from the line out jack needs amplification. Use powered speakers/ monitors or other amplified audio device.
Remote control didn't work	Battery weak	Replace current battery with new battery
	Remote control is out of range of the iHL31 remote sensor	Move within 20 feet or 6 meters of the unit
Unit/adaptor gets warm after extended play at high volume	This is normal	Turn unit off for a while or lower volume

LIMITED 90-DAY WARRANTY

iHome Products, a division of Checkolite, warrants this product to be free from defects in workmanship and materials, under normal use and conditions for a period of 90 days from the date of original purchase. Should this product fail to function in a satisfactory manner, it is best to first contact customer service at 1-800-265-9960. Should this fail to resolve the matter and service still be required by reason of any defect or malfunction during the warranty period, Checkolite will repair, or at its discretion, replace this product without charge (except \$10.00 for handling, packing and return UPS/ postage, and insurance). This decision is subject to verification of the defect or malfunction upon delivery of this product to the Factory Service Center listed below. The product must include proof of purchase, including date of purchase. When returning this product, be sure to do the following:

1. Enclose a photocopy of the sales receipt.
2. Enclose a check or money order payable to the order of Checkolite for the sum of \$10.00
3. Send the unit pre paid and insured, to the Factory Service Center listed below.

**Checkolite International Inc.
142 Charles St.
Jersey City, NJ 07307**

Disclaimer of Warranty

NOTE: This warranty is valid only if the product is used for the purpose for which it was designed. It does not cover (i) products which have been damaged by negligence of willful actions, misuse or accident, or which have been modified or repairs by unauthorized persons; (ii) cracked or broken cabinets, or units damaged by excessive heat; (iii) damage to digital media players; (iv) the cost of shipping this product to the Factory Service Center and the return to the owner; (v) Bulbs on iHL10 and iHL30 are not covered under this warranty.

This warranty is valid only in the United States of America and does not extend to owners of the product other than to the original purchaser. In no event will COL contractors, resellers, their officers, directors, shareholders, members or agents be liable to you or any third party for any consequential or incidental damages, any lost profits, actual, exemplary or punitive damages. (Some states do not allow limitations on implied warranties or exclusion of consequential damages, so these restrictions may not apply to you.) This warranty gives you specific legal rights, and you may also have other rights which vary from state to state. Your acknowledgement and agreement to fully and completely abide by the above mentioned disclaimer of warranty is contractually binding to you upon your transfer of currency (money orders, cashier's check, or credit card) for purchase of your COL product.

**Questions? Visit www.Checkolite.com. For any other questions call:
1-800-265-9960 Toll Free**