



14+  
AGES

# USER MANUAL

NO.CX-10D

PLEASE CAREFULLY READ THE  
INSTRUCTION MANUAL BEFORE FLYING

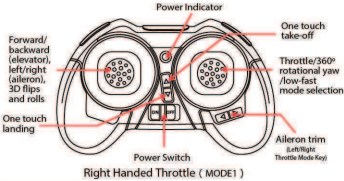

Right Handed Throttle (MODE1)

**FLYING ENVIRONMENT**  
Before undertaking indoor flights, ensure to have plenty of open space; make sure there are no obstacles, animals or other people nearby.

**WARNING** Please make sure the surroundings are suitable when operating CX-10D. Always keep your CX-10D in your line of sight. Adult supervision is recommended for users below 18 years old.

**ATTENTION**  
RC range - approx 25 meters. Please note flying your aircraft out of recommended range may cause crash or loss of the aircraft (it may fly away or fall down). Warning: do not fly in the strong wind, as the aircraft may fly out of RC range (it may fly away or fall down). The time of flight may be affected by the wind and battery voltage rate. If the flight time is less than 1 minute, please recharge the battery.

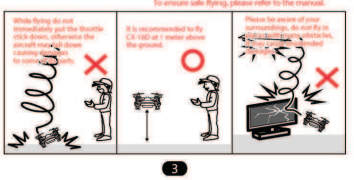

**3**

**Aileron directional stick:** Left/Right controls left and right flight direction.



**Height Hold:** In order to maintain and hold flight height, take off and after reaching required height put the throttle stick to the middle.



**Height Hold:** If the aircraft flies too high, gradually put the throttle stick down and after reaching wanted height put the throttle stick to the middle.

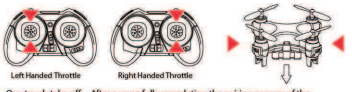

**One touch take-off:** After successfully completing the pairing process of the transmitter and the aircraft, press the one touch take-off button. The aircraft will take off, and hover at around 1.5 meters height.



**6**

**Back Flip**  
Press the directional stick and hold it, while the transmitter beeps push the directional (elevator/aileron) stick full down.



**TRIM ADJUSTMENT INTRODUCTION**

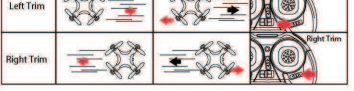

**Calibration of Accelerometer**  
If your aircraft begins to be unstable during flight or drifts quickly to one direction, please calibrate the accelerometer.

1. Turn on aircraft/transmitter and pair them. The aircraft should be placed on flat level surface.

2. Enter advanced mode (3 beeps) by pressing throttle stick and releasing it.

**Left handed throttle transmitter:** Push the throttle and directional (elevator/aileron) sticks to the lowest right corner and elevator/aileron (forward/backward/left/right) stick to lower right corner. The indicating lights on the aircraft will flash for 1-2 seconds, release the sticks. Wait until the aircraft's lights stop flashing indicating successful calibration.

**Right handed throttle transmitter:** Push the throttle and directional (elevator/aileron) sticks to the lowest right corner and elevator/aileron (forward/backward/left/right) stick to lower right corner. The indicating lights on the aircraft will flash for 1-2 seconds, release the sticks. Wait until the aircraft's lights stop flashing indicating successful calibration.

**9**

## SAFETY GUIDE FOR LITHIUM BATTERY



Pay attention while charging the lithium battery. Inappropriate charging of lithium battery may cause: fire, injury or loss of property. By operating this device you acknowledge and accept all risks and responsibilities of use. The manufacturer, retailer or sales agent are not responsible for any accidents. Please, read carefully the safety guidance and instructions for charging, before using this product.

**GUARANTEE OF THE LITHIUM BATTERY**  
The guarantee covers raw materials and manufacturing defects, but not the product itself. The manufacturer bears no responsibility for any loss, injury or damage and therefore won't compensate the amount higher than the value of the retail price.

1. Do not leave the charger/battery unattended while in use.
2. Only use the included USB charging line while charging the battery.
3. It is highly forbidden to decompose and disassemble the battery.
4. Do not keep or use the battery in high-temperature areas or near heat sources or flammable products.
5. It is highly forbidden to cover the battery or the charger. Ensure that the battery is charged in well ventilated and fire-resistant location.
6. If the battery begins to smell or "puff" during charge, please unplug the battery from the charger and move the battery to a safe outdoor place to avoid combustion or explosion (please, dispose the battery in appropriate way).
7. Storing or transporting batteries together with metal objects is strictly forbidden.
8. It is forbidden to throw batteries into the fire or cause them to be heated.
9. It is forbidden to contact metal objects to the plus and minus ends of the battery.
10. It is highly forbidden to reverse/change plus and minus polarities of the battery.
11. If by any accident battery's electrolyte (battery's fluid) gets into your eyes, do not rub your eyes instead rinse your eyes with clear water.
12. Store the battery in a cool and dry environment.

**1**

## TRANSMITTER BATTERY INSTALLATION

Transmitter battery installation



## CHARGING AIRCRAFT BATTERY

Connect the charging cable to the aircraft, and then plug the USB side to the computer or any other USB charger. While charging the USB indicator will be ON. The USB indicator is OFF when fully charged. The USB charging cable can be connected to Apple chargers and other smart phone chargers. It also can be charged using portable batteries and car phone chargers. Only standard 4.5-5.5V USB chargers are supported.

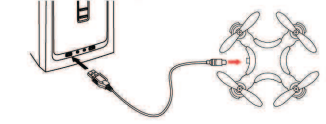

## GETTING STARTED

### PAIRING

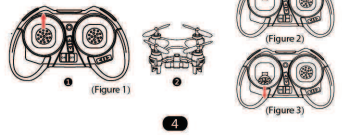

**4**

**One touch landing:** Press one touch landing button and the aircraft will descend.



**MODE SETTING**  
You can fly CX-10D in 3 unique modes: beginners-intermediates-advanced. To change flying modes gently press the throttle stick the transmitter will beep once indicating beginners mode; gently press the throttle stick one more time and the transmitter will beep twice indicating intermediate mode; gently press the throttle stick again and the transmitter will beep 3 times indicating advanced mode.

**FAST-ROTATION ABILITY (advanced mode is needed)**  
When CX-10D flies in height hold, push the throttle stick toward left to turn the CX-10D anticlockwise, or push the throttle stick toward right to turn it clockwise.

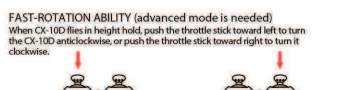

**360° Flips and Rolls**  
Flips and rolls can be performed in all 3 flying modes, press the directional stick and release it, the transmitter will beep once indicating the flip mode is entered; use directional (elevator/aileron) stick to perform rolls and flips by moving it fast to the direction in which flip/roll is wanted.

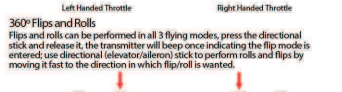

**7**

**360° Flips and Rolls**  
Flips and rolls can be performed in all 3 flying modes, press the directional stick and release it, the transmitter will beep once indicating the flip mode is entered; use directional (elevator/aileron) stick to perform rolls and flips by moving it fast to the direction in which flip/roll is wanted.



**7**

**NOTE:** If the aircraft still drifts away, place it on flat level surface and use few sheets of paper by placing them under the aircraft's legs on the side to which it drifts (adjust paper sheet quantity accordingly to the drift's deviation).

## TROUBLESHOOTING

If the aircraft still drifts, calibrate accelerometer again. If the drift continues, check propellers of the aircraft, if needed replace damaged propellers.

If the aircraft can't take off, recharge the battery. If it still can not take off, repeat calibration of accelerometer again according to the manual.

**9**

## ILLUSTRATION OF EACH PART

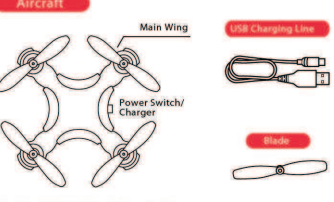

## TRANSMITTER INSTRUCTION MANUAL

**Left/Right Throttle Mode**  
Press and hold left/right trim, turn on the transmitter, and then release trim button. The transmitter will beep once indicating Right Throttle Mode is activated. Note: left handed throttle mode is a default setting.

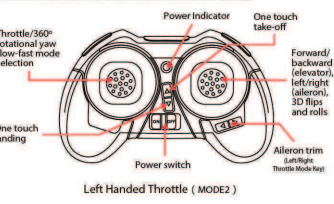

Left Handed Throttle (MODE2)

**1**

**2**

**3**

**Operation and Control**  
Attention: avoid sharp moves of the control sticks, and maintain smooth moves of the controls. During the flight, the aircraft's battery may lose some power. Therefore, adjust the throttle stick accordingly to maintain aircraft's height.

**Throttle stick:** Up/Down controls the aircraft's flying height.



**Rotational yaw stick:** Left/Right controls aircraft's rotational movement



**Elevator directional stick:** controls forward/backward flight direction



**5**

**6**

**7**

**8**

**9**

**10**

**11**

**12**

**13**

**14**

**15**

**16**

**17**

**18**

**19**

**20**

**21**

**22**

**23**

**24**

**25**

**26**

**27**

**28**

**29**

**30**

**31**