



AGES
14+

USER MANUAL

NO.CX-33W

(wifi version)



PLEASE CAREFULLY READ THE
INSTRUCTION MANUAL BEFORE FLYING.

Controlling Operation of Wifi Connection with Mobile

Illustration of Each Part

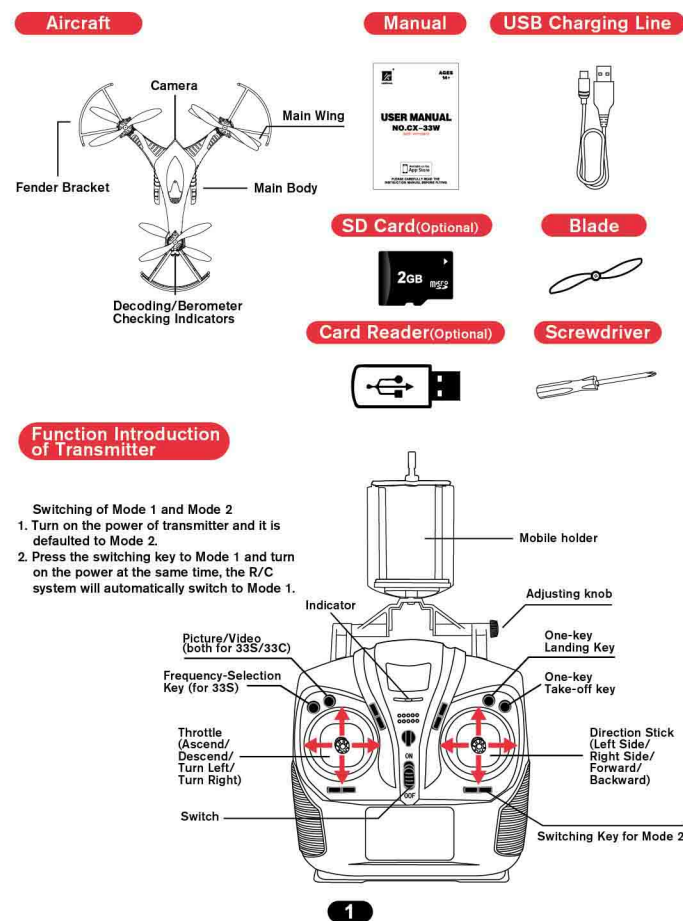

Function Introduction of Transmitter

- Switching of Mode 1 and Mode 2
1. Turn on the power of transmitter and it is defaulted to Mode 2.
 2. Press the switching key to Mode 1 and turn on the power at the same time, the R/C system will automatically switch to Mode 1.

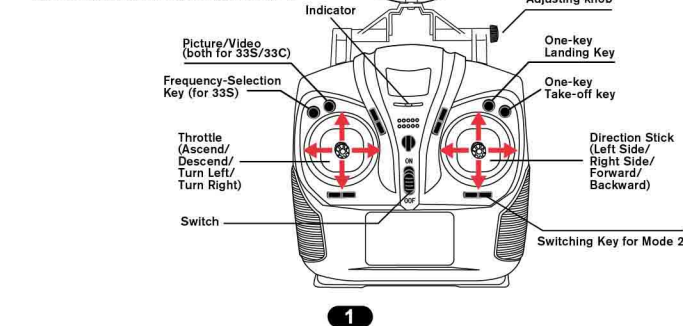

1

Controlling Operation of Wifi Connection with Mobile

Wifi connecting steps and using ways of IOS mobile software

- 1.Download and Install the Software
Please download and install the software CX-33wifi in APP store or directly scan the two-dimension code (as Figure 1) for downloading and installing.
- 2.Wifi Connection Instruction
(1)Connect the power of aircraft and the indicator will begin to flash rapidly.
(2)Enter the setting of "iPhone" or "iPad", and open wifi to find out CX-wifi720P and connect. When the mark "✓" appears which means successful connection, exit the setting after finishing.
(3)Open the software of CX-33wifi in Iphone or iPad and click the icon to enter the control interface. (Please keep away from other wifi signals as far as possible when flying.)

Wifi connecting steps and using ways of Andriod mobile software

- 1.Download and Install the Software
For overseas users: Search CX-33wifi in Google Play to download and install or directly scan two-dimension code (as Figure 2) to download and install.
For home users: Search CX-33wifi in Andriod market to download and install or directly scan two-dimension code (as Figure 3) to download and install.



2.Wifi Connection Instruction

- 1.Connect the power of aircraft and the indicator will begin to flash rapidly.
- 2.Enter the setting of Android phone and open Wifi to find out CX-wifi720P and connect it.
- 3.Open the software CX-33wifi and click the icon to use it.



Note: Please fly in the spacious indoor, and make sure there is no obstacles, animals or humans nearby. When flying, do not allow the aircraft beyond your sight. The children should be under the guidance of adults when flying.

2

3.Connect with Wifi

Wifi connecting steps of IOS mobile

- 1.Enter the setting of "iPhone" or "iPad", and open wifi to find out CX-wifi720P and connect. When the mark "✓" appears which means successful connection, exit the setting after finishing.
- 2.Open the software of CX-33wifi in Iphone or iPad and click the icon to enter the control interface. (Please keep away from other wifi signals as far as possible when flying.)
- 3.Please turn off the phone control interface when the aircraft is controlled by transmitter, which is to click "ON" such as the figure shown.



Note: When the aircraft is controlled by transmitter, it should make decoding between the transmitter and aircraft and then connect with Wifi.

Instruction of Control Interface

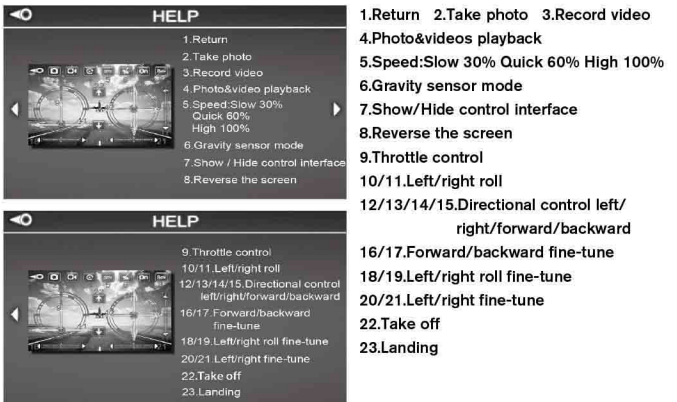

3

Function Setting



Help Click this button to enter function setting

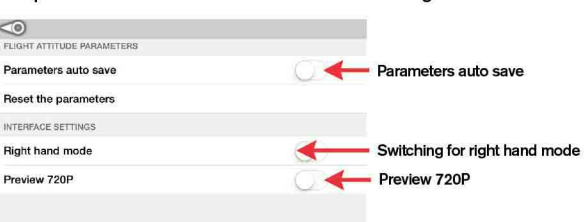

Operation Method

1.Manual flying control (take MODE 2 as example)

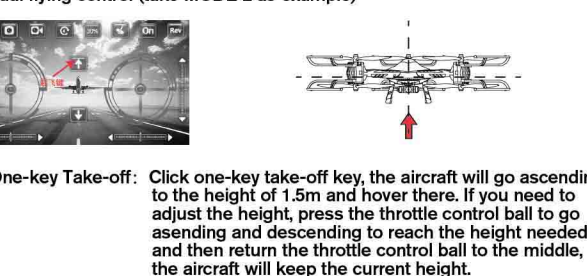

4



(2) Throttle control: When pressing the throttle control ball and pushing it up, the motor will rotate and the higher the push, the faster the rotation (that is to say, the higher the flight); when pushing down, the motor will decelerate and the lower the speed, the slower the motor rotation.



(3) Ailerons (left and right) control: When the aileron control ball moves to left side, the aircraft will fly to left; when the aileron control ball moves to right side, the aircraft will fly to right.



(4) Lifting (forward and backward) control: When the lifting control ball moves to upside, the aircraft will fly forward; when the lifting control ball moves to downside, the aircraft will fly backward.



(5) Rotation control: When the direction control ball moves to left, the nose of the aircraft will rotate to left; when the direction control ball moves to right, the nose of the aircraft will rotate to right.

5



2.Gravity sensing control (take mode 2 as example)
Touch the gravity sensing control key on the phone flying control interface. It would be the colorful icon when being ON status and it would be the grey icon when being OFF status. As the pictures shown below:

OFF status of gravity sensing



ON status of gravity sensing



6

When the status icon of gravity sensing control switch key is colorful, the lifting and ailerons control have already been switched to gravity sensing control (one-hand operating flight is available). Direction control at this time is as below:



(1) Throttle control: When pressing the throttle control ball and pushing it up, the motor will rotate and the higher the push, the faster the rotation (that is to say, the higher the flight); when pushing down, the motor will decelerate and the lower the speed, the slower the motor rotation.



(2) Ailerons(left and right)control:When the phone moves to left side, the aircraft will fly to left;when the phone moves to right side, the aircraft will fly to right.



(3) Lifting (forward and backward) control: when the phone moves to upside, the aircraft will fly forward; when the phone moves to downside, the aircraft will fly backward.



(4) Rotation control: When the direction control ball moves to left, the nose of the aircraft will rotate to left; when the direction control ball moves to right, the nose of the aircraft will rotate to right.

7

3.Video Operation Ways

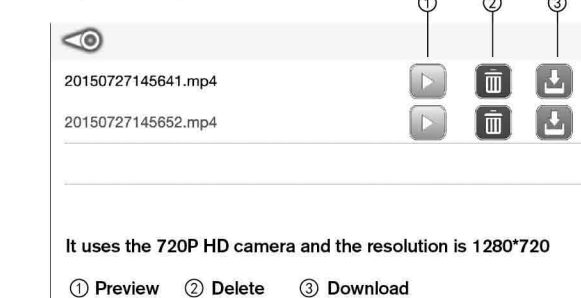

Note: When using this function, the phone wifi should connect with the aircraft. The videos will be kept in the aircraft SD card. Please click the download button when you need to store it in phone.

- Notes:
- 1.If it can't search for WIFI, please close the WIFI and reconnect it.
 - 2.If it needs to replace the battery, please totally exit the controlling software, and then select the responding hot-point name for making connection. After successful connection, reopen the software.
 - 3.The largest control radius of WIFI is 25m, and please don't fly beyond this scope.

Preparation before Take Off



8

2.Battery Installation of Aircraft

- (1) Rotate the battery cover sheet to the largest position as the arrow (anti-clockwise) direction and open the battery bin. (As Figure 1 Shown)
- (2) Insert the battery plug to the slot in correct direction (As Figure 2Shown), put the battery into the battery bin at the same time and close the battery bin gate at last.

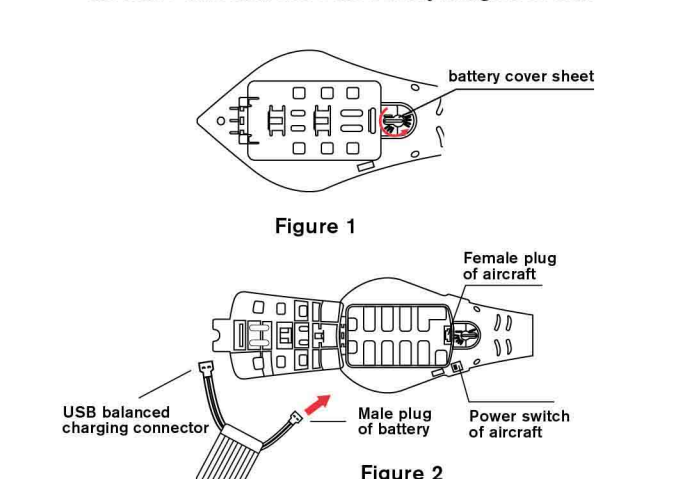

9



4.Make sure the actual distance between the tail of the aircraft and the operator is 1.0-2.0m.

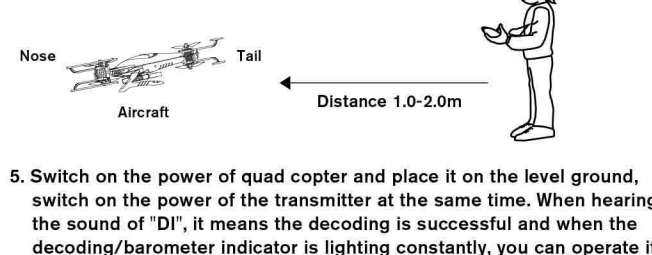

Aircraft Charging

Take out the battery from the quad copter and connect with the charger, and then insert the USB charging line into the USB port of the computer or any other USB chargers. The USB red light is the power indicators and the green light is the charging indicators. When the green light is flashing, that represents it is under charging. When the green light is constantly lighting, that represents it is fully charged. Besides Apple charger, this USB charging wire can be connected with any other chargers of Smart mobile or movable power or being charged on the USB interface on the car. The voltage of the USB interface is $\pm 5\pm 0.5V$. (The charging time is about 3.5 hours)

10

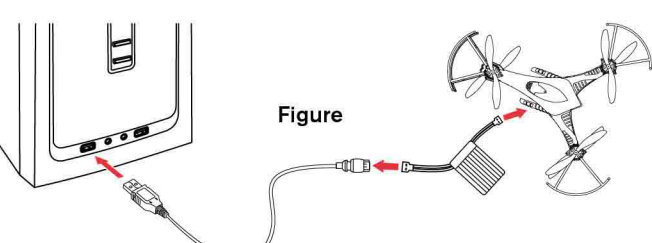

Basic Operation Methods of Aircraft

(take Mode 2 as example)

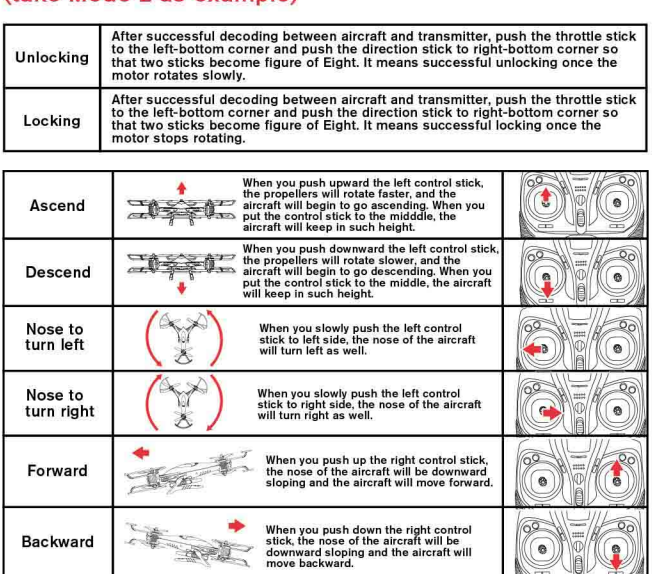

11

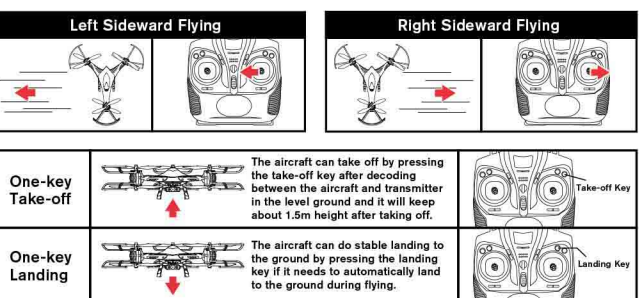

Disassembly and Assembly of WIFI module

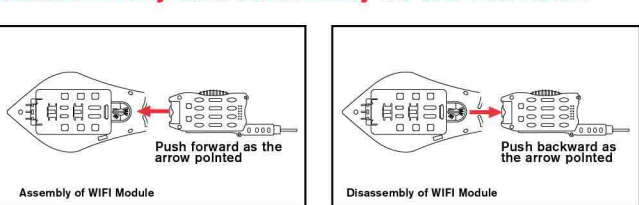

Calibration of Aircraft

When the quad copter is hit or flies unstable, you need to calibrate it and the calibration ways are as the followings:

- 1.After finishing decoding, please adjust the Hi/L Gear to the position of High while push the Left/Right control stick to the right-bottom corner at the same time. Wait till the red indicators of the aircraft are flashing, it means the calibration is successful.
- 2.When making calibration, please make sure the aircraft should be placed on the level ground.

12

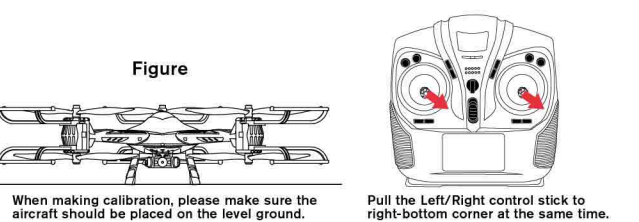

Installation of Propellers

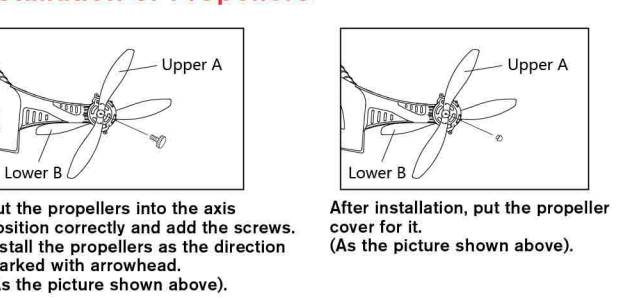

Installation of Fender Bracket

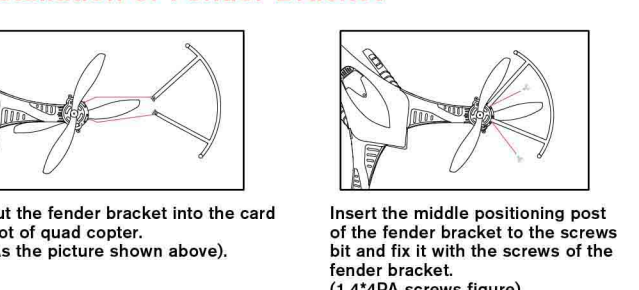

13

Lithium Battery Safety Instruction

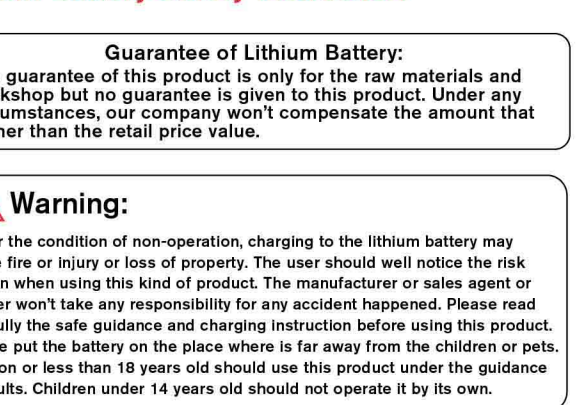

- 1.It is highly forbidden to charge it for a long time under unattended condition so as to avoid the accidents.
- 2.Please use the original USB charging line and battery charger by our company.
- 3.It is highly forbidden to decompose or disassemble the battery.
- 4.Batteries are forbidden to be used or kept under high temperature or heat source or near the flammable product.
- 5.When charging the battery, covering the charger or battery is highly forbidden. Please keep ventilation and make sure that it should be charged under the condition of fire safety.
- 6.If the battery sends out smelly odor or gets heated or deformed or there is any abnormal phenomenon happened during the process of charging, please remove the batteries from the charging device or charger and move to the safety outdoor place (If there are batteries which appear abnormal phenomenon, please don't litter around. Please dispose it by taking safe measure) so as not to cause combustion or explosion.
- 7.Batteries are forbidden to be stored or transported together with the metallic object.
- 8.Batteries are forbidden to be thrown into the fire or get heated.
- 9.Metal is forbidden to connect directly with the "+" "-" polarity of the battery.
- 10.It is highly forbidden to upside down the "+" "-" polarity of the battery.
- 11.If there any battery leakage happened or electrolyte liquid mistakenly goes into the eyes, please don't rub the eyes but rinse the eyes with clear water or go to the nearest hospital for curing.
- 12.When the battery is not used, please store it in the cool or dry environment.

14

Guidance for Solving Problems

- 1.Transmitter and aircraft can't make decoding
A: When turn on and make decoding, don't move any other sticks or trimming.
 - 2.The blades stop or slowly react
A: (1) low power of lithium battery; (2) needs to re-decoding.
 - 3.The aircraft is shaking or shocking or in big noise when flying
A: Check whether the motors, body shell and blades are correctly installed.
 - 4.The blades can rotate but can't take off
A: Check whether the blades A/B are correctly installed and please correctly install the blades as the figure show.
 - 5.One or more motors can't rotate
A: (1) The motor is broken and replace the new one; (2) The motor line drops and it needs to bond the wire again; (3) Any transistor on the sender inside the transmitter is burn and it needs to change to a new transmitter.
 - 6.The aircraft is still drifting after calibration again
A: Put the aircraft on the level ground and put several papers in its drifting direction (the thickness depends on the level of the drifting so that you can put the calibration accelerator on the level ground and solve the drifting problem.
- CE0890
- This device complies with Part 15 of the FCC Rules. Operation is subject to the following two conditions: (1) this device may not cause harmful interference, and (2) this device must accept any interference received, including interference that may cause undesired operation. changes or modifications not expressly approved by the party responsible for compliance could void the user's authority to operate the equipment.
- This equipment has been tested and found to comply with the limits for a Class B digital device, pursuant to Part 15 of the FCC Rules. These limits are designed to provide reasonable protection against harmful interference in a residential installation. This equipment generates, uses and can radiate radio frequency energy and, if not installed and used in accordance with the instructions, may cause harmful interference to radio communications. However, there is no guarantee that interference will not occur in a particular installation.
- If this equipment does cause harmful interference to radio or television reception, which can be determined by turning the equipment off and on, the user is encouraged to try to correct the interference by one or more of the following measures:
- Reorient or relocate the receiving antenna.
 - Increase the separation between the equipment and receiver.
 - Connect the equipment into an outlet on a circuit different from that to which the receiver is connected.
 - Consult the dealer or an experienced radio/TV technician for help.
- This equipment must be installed and operated in accordance with provided instructions and the antenna(s) used for this transmitter must be installed to provide a separation distance of at least 20 cm from all persons and must not be co-located or operating in conjunction with any other antenna or transmitter. End-users and installers must be provided with antenna installation instructions and transmitter operating conditions for satisfying RF exposure compliance.

15

16