

The Audex Motorola Jacket combines coveted **U** snowboarding apparel with leading Bluetooth® wireless technology from Motorola. This cutting edge technology provides music and wireless communications on or off the mountain. Answer calls from friends and control your favorite tunes using the integrated control panel on your sleeve. Free yourself to enjoy other activities while your Bluetooth-compatible mobile phone, Bluetooth streaming music device, or iPod® stay in your pockets and out of your way.

The Audex Motorola Jacket features integrated stereo speakers in the hood, a microphone and chest/battery module embedded within the inside pocket of the jacket, as well as a control panel on the sleeve that allows remote operation of your phone and music device. When you prefer a more secluded experience, enjoy instant privacy by listening to music or conducting calls with a wired headset plugged into the 3.5mm headset jack on the chest module. When it is time to wind down, the removable electronics make it easy to clean your jacket.

### Package Contents

- Control Module
- Chest Module (optional accessory required for iPod)
- Speakers (1 left, 1 right)
- Microphone
- Battery
- Wall Charger (with adapters)
- User's Guide (this booklet)
- Quick Start Guide
- Warranty Leaflet (Europe)

Motorola, Inc.  
Consumer Advocacy Office  
1307 East Algonquin Road  
Schaumburg, IL 60196  
www.hellomoto.com

1-800-331-6456 (United States)

1-888-390-6456 (TTY/TDD United States for hearing impaired)

1-800-461-4575 (Canada)

Certain mobile phone features are dependent on the capabilities and settings of your service provider's network. Additionally, certain features may not be activated by your service provider, and/or the provider's network settings may limit the feature's functionality. Always contact your service provider about feature availability and functionality. All features, functionality, and other product specifications, as well as the information contained in this user's guide are based upon the latest available information and are believed to be accurate at the time of printing. Motorola reserves the right to change or modify any information or specifications without notice or obligation.

The use of wireless devices and their accessories may be prohibited or restricted in certain areas. Always obey the laws and regulations on the use of these products.

MOTOROLA and the Stylized M Logo are registered in the US Patent & Trademark Office. The Bluetooth trademarks are owned by their proprietor and used by Motorola, Inc. under license. iPod is a registered trademark of Apple Computer, Inc., registered in the U.S. and other countries. All other product or service names are the property of their respective owners.

© Motorola, Inc., 2006.

**Caution:** Changes or modifications made in the phone or Bluetooth module, not expressly approved by Motorola, will void the user's authority to operate the equipment.

## Software Copyright Notice

The Motorola products described in this manual may include copyrighted Motorola and third-party software stored in semiconductor memories or other media. Laws in the United States and other countries preserve for Motorola and third-party software providers certain exclusive rights for copyrighted software, such as the exclusive rights to distribute or reproduce the copyrighted software. Accordingly, any copyrighted software contained in the Motorola products may not be modified, reverse-engineered, distributed, or reproduced in any manner to the extent allowed by law. Furthermore, the purchase of the Motorola products shall not be deemed to grant either directly or by implication, estoppel, or otherwise, any license under the copyrights, patents, or patent applications of Motorola or any third-party software provider, except for the normal, non-exclusive, royalty-free license to use that arises by operation of law in the sale of a product.

Manual Number: 6809502A75-0

DRAFT

# Contents

---

<b>Audex™ Motorola Jacket Series</b> .....	<b>1</b>
Package Contents .....	1
<b>Audex Components</b> .....	<b>5</b>
Installing Your Audex Components .....	5
Charging the Battery .....	6
Installing Your Battery .....	7
<b>Basic Audex Operation</b> .....	<b>7</b>
Keys and Indicator Light .....	7
Display .....	9
Menus .....	11
Audio Tones .....	12
Idle Screen .....	12
<b>Using Your Audex Motorola Jacket</b> .....	<b>13</b>
Turning Your Audex System On & Off .....	13
Pairing Your Bluetooth Device(s) with Your Jacket .....	14
Listening to Music .....	14
Making and Receiving Calls .....	17
Locking/Unlocking Control Module Keys .....	19
Using Privacy Mode .....	19
<b>Customizing Your Audex Motorola Jacket</b> .....	<b>19</b>
Setting Display Text Scrolling Speed .....	19
Setting Time .....	19
<b>Maintenance and Care</b> .....	<b>20</b>
Care .....	20
Washing Instructions .....	20
<b>European Union Directives Conformance Statement</b> .....	<b>21</b>
<b>Caring for the Environment by Recycling</b> .....	<b>21</b>
<b>Recycling Mobile Phones and Accessories</b> .....	<b>21</b>
<b>Safety and General Information</b> .....	<b>22</b>
<b>Support</b> .....	<b>24</b>
<b>Consumer Warranty Coverage</b> .....	<b>25</b>
<b>Audex Components by Motorola Limited Warranty –</b>	
<b>North America</b> .....	<b>26</b>
<b>Smart Practices While Driving</b> .....	<b>28</b>
<b>Industry Canada Notice to Users</b> .....	<b>29</b>
<b>FCC Notice to Users</b> .....	<b>29</b>
<b>Export Law Assurances</b> .....	<b>30</b>

# Audex Components

Before you get started, take a moment to familiarize yourself with the components of your new Audex Motorola Jacket. The following components are provided in the box included with your jacket:

- Control Module
- Chest Module
- Speakers (2)
- Microphone
- Battery

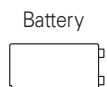
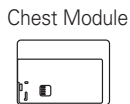
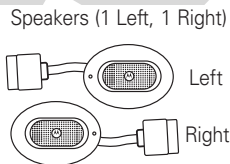
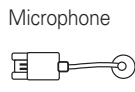

## Installing Your Audex Components

For instructions on installing the components on your jacket, see the *Audex Motorola Jacket Series Quick Start Guide* (included in your box of components).

Once installed and connected, the components are located on the jacket as shown below:

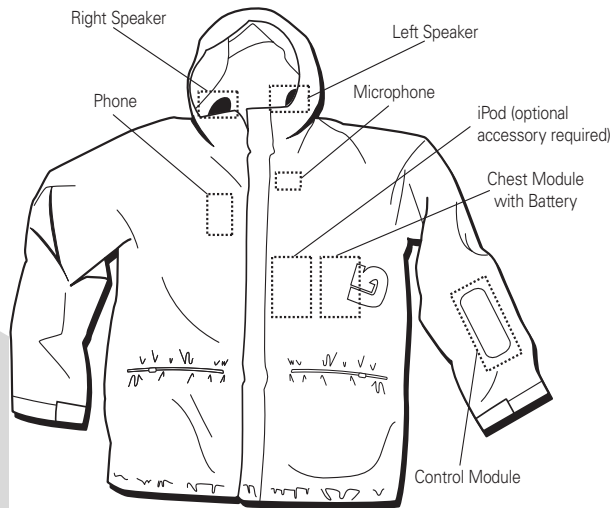

**Note:** Bluetooth-enabled music device may be stored in any jacket pocket.

The following items must be purchased separately:

- Bluetooth phone with Handsfree (HFP) and Headset profiles for voice communication.
- Bluetooth music device (phone or other device) with A2DP and AVRCP profiles to stream music.
- iPod with optional accessory to play music (requires iPod with Dock Connector).

## Bluetooth Profiles

The following table provides guidelines regarding Audex Motorola Jacket features that depend on the Bluetooth profiles supported and used by the phone or music device:

Profile	Description
HFP (Handsfree Profile)	Telephony / Call management: operations related to placing/ receiving phone calls
A2DP (Advanced Audio Distribution Profile)	Stereo music streaming
AVRCP (Audio Video Remote Control Profile)	Remote music control (for example, ability to remotely Play / Pause or Stop music)

There are three typical scenarios for using the Audex Motorola Jacket:

- Listen to music and make/receive calls from a compatible Bluetooth-enabled cell phone with both Advanced Audio Distribution Profile (A2DP) and Handsfree Profile (HFP).
- Make/receive phone calls from a compatible Bluetooth-enabled cell phone with Handsfree Profile (HFP), and listen to music from a Bluetooth-enabled music source with Advanced Audio Distribution Profile (A2DP).
- Make/receive phone calls from a compatible Bluetooth-enabled cell phone with Handsfree Profile (HFP), and listen to music from a wired iPod music source.

## Charging the Battery

Your Audex system utilizes a rechargeable battery that is installed in the Chest Module. The battery powers all electronic components that come with your jacket. Follow these steps to charge the battery:

- 1 If necessary, install the proper country power adapter on the wall charger connector as shown in the example.

The following power adapters are provided with your jacket:

- UK (SYN7455A)
- Europe (SYN7456A)

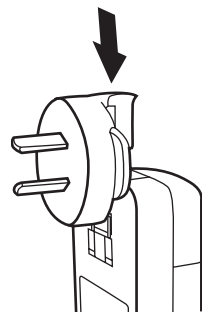

- 2 Plug the charger into the battery's charging port as shown.

Be sure to align the plug correctly. If the plug does not connect to the unit easily, try flipping it over and re-inserting.

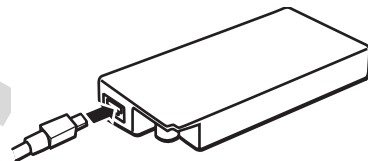

- 3 Plug the charger into an electrical wall outlet.

The red indicator light turns on when the battery is charging. When the battery is fully charged (about 2-3 hours), an additional green indicator light turns on.

## Installing Your Battery

Follow the steps shown to install the battery into the Chest Module.

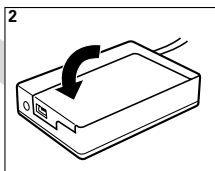
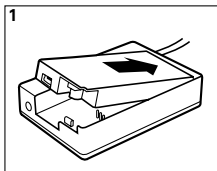

**Note:** Make sure the battery is properly seated onto the Chest Module by firmly pressing down after installing.

### Battery Tips

Battery performance depends on network configuration, signal strength, operating temperature, features selected, and voice, data, and other application usage patterns.

- Always use Motorola Original batteries and chargers. The warranty does not cover damage caused by non-Motorola batteries and/or chargers.
- New batteries or batteries stored for a long time may take more time to charge.
- When charging your battery, keep it near room temperature.
- When storing your battery, keep it partially charged in a cool, dark, dry place.
- Never expose batteries to temperatures below -10°C (14°F) or above 60°C (140°F).
- It is normal for batteries to gradually wear down and require longer charging times. If you notice a change in your battery life, it is probably time to purchase a new battery.

**Warning:** Never dispose of batteries in a fire because they may explode.

Before using your Audex system, read the battery safety information in “Safety and General Information” on page 22.

## Basic Audex Operation

The Audex system is operated using the Control Module. The Control Module furnishes a combination of buttons and a display screen to operate your Bluetooth-enabled phone and audio device with your jacket. Here’s a quick anatomy lesson of the Control Module.

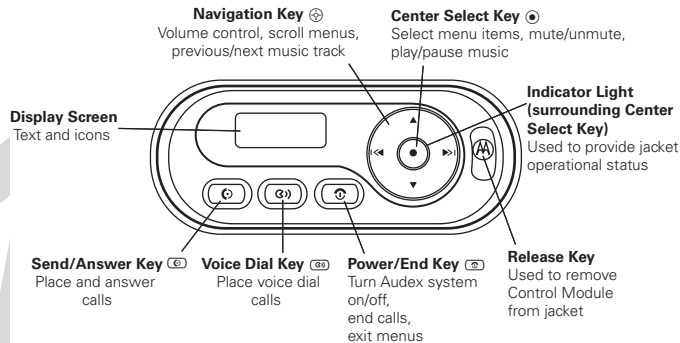



### Keys and Indicator Light

Several push button keys and a multi-position navigation key allow you to perform tasks with your phone and audio device using the Control Module on your jacket. An indicator light is also provided on the Control Module to furnish status information about call and music operation with your jacket.

## Push Button Keys

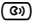
Push button keys are used to operate the Control Module. Each key provides multiple functions when used within the jacket

Key	Function
 Send / Answer	<ul style="list-style-type: none"> <li>answer an incoming call</li> <li>place call (your phone must support dialed and received calls lists)</li> <li>access dialed call list</li> <li>switch between two connected calls</li> <li>link two connected calls together</li> <li>display Audex software revision</li> </ul>
 Voice Dial	<ul style="list-style-type: none"> <li>place call (your phone must support voice dial features)</li> </ul>
 End / Power	<ul style="list-style-type: none"> <li>power on/off Audex system</li> <li>end a call (connected or on hold)</li> <li>ignore an incoming call</li> <li>stop music and display Idle screen</li> </ul>
 Center Select	<ul style="list-style-type: none"> <li>play / pause song</li> <li>select menu items</li> <li>lock / unlock Control Module keys</li> <li>mute / unmute call</li> </ul>

## Navigation Key

The navigation key is a multi-position controller that provides easy scrolling capabilities on the Control Module.

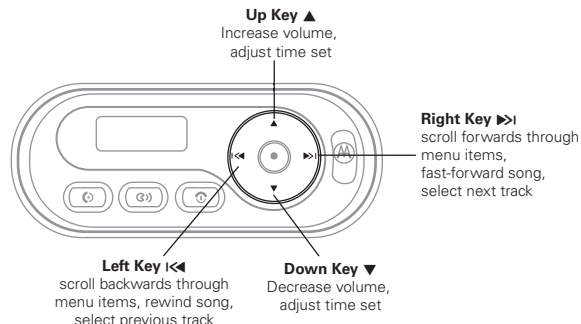

Each position on the navigation key provides multiple functions:

Key	Function
▲ Up	<ul style="list-style-type: none"> <li>increase volume</li> <li>adjust time value in time setting</li> </ul>
▼ Down	<ul style="list-style-type: none"> <li>decrease volume</li> <li>adjust time value in time setting</li> </ul>
◀◀ Left	<ul style="list-style-type: none"> <li>access bottom of main menu (from Idle screen)</li> <li>scroll backward through menu items</li> <li>start song over</li> <li>play previous song (press twice)</li> <li>rewind song (press and hold)</li> </ul>



Key	Function (Continued)
 Right	<ul style="list-style-type: none"> <li>access top of main menu (from Idle screen)</li> <li>scroll forward through menu items</li> <li>skip to next song</li> <li>fast-forward song (press and hold)</li> </ul>

## Indicator Light

The indicator light surrounding the center select key is a multi-color LED that provides jacket operation status information on the Control Module.

Indicator	Status
Three Blue Flashes	power on/off
Blue Pulse	standby
Quick Blue Flash	call incoming
Blue Flash	call connected (in call)
Solid Blue	pairing mode
Solid Blue with Quick Purple Flashes	pairing successful
Purple Flash	call muted
Quick Red Flashes	battery low
Three Green Flashes	music started/stopped
Green Pulse	music playing
Green Flash	music paused

## Display

A display panel on the Control Module provides text and indicators for status and activity when using your Audex Motorola Jacket.

There are three main areas on your display panel:





- Status
- Navigation
- Activity

### Status

The status area provides jacket operational and configuration status, and is highlighted in the figure below:



The following indicators display in the status area:

Indicator(s)	Indicates
	Battery charge level
	Bluetooth connection active
	Call ringer audible
	Call ringer silent
	Phone connected (Handsfree connection)

## Navigation

The navigation area provides music operational status, menu item navigation, and call on hold indication (on GSM phones). This area is highlighted in the figure below:



The following indicators display in the navigation area:

Indicator(s)	Indicates
1/3	Menu/iPod list index (icon shown is example)
	Music playing
	Music paused
	Starting song over / Play previous song
	Skipping to next song
	Rewinding song
	Fast-forwarding song
	Call on hold

## Activity

The activity area shows icons and text relating to current operations on your jacket, and is highlighted in the figure below:



The following indicators display in the current activity area:

Indicator(s)	Indicates
	Bluetooth discovery mode
	Call dialing
	Call connected
	Call ended
	Call failed
	Incoming call
	Missed call
	Say name (voice dial)
	Bluetooth device connected (to jacket)
	iPod connected (to jacket)
	Device not connected (to jacket)
	Volume level
	Back (in menus)
	Hold / lock mode
	Dialed calls list
	Received calls list
	Item selection
	Folder selection
	Song selection

## Menus

Your Audex Motorola Jacket provides a menu interface for performing certain operating and configuring tasks. Available menu selections are dependent upon which devices are currently connected to the jacket.

Menus are accessed from the Idle screen or music playback screen when music is paused. Use the following guidelines for operating the menus:

- Scroll through menus using the ◀◀ and ▶▶ keys.
- Menus are indicated by the Folder Selection (📁) icon.
- Make a menu selection using the ⏪ key.
- Within a menu, the currently selected item is indicated by the Item Selection (✓) icon.
- Use the **Back** selection in each menu to step backwards.

The following selections are provided in the main menu:

Menu	Selection(s)	Description	See:
Play Music/ Resume Music	N/A	plays last selected song on music source	“Playing Music (Bluetooth Streaming)” on page 15 or “Playing Music (iPod)” on page 15

**Note:** These selections are provided only when a music source is connected.

Playlists / Artists / Albums / Songs	items as stored on iPod	provides list of selectable items on the iPod	
---	-------------------------------	---	--

**Note:** These selections are provided only when iPod is selected as music source.

Menu	Selection(s)	Description	See:
Recent Calls	Received Calls	access calls received on the phone	“Making a Call Using a Recent Call Phone Number” on page 17
	Dialed Calls	access calls dialed on the phone	
	Back	returns to previous menu	
<b>Note:</b> Availability of Dialed Calls and Received Calls menu elections are phone dependent. If your phone does not support dialed or received call lists, those selections do not display in the menus.			
Setup	Select Music Source	selects music source to listen to on jacket	“Selecting Music Source” on page 15
	Find Me	places Audex system in Bluetooth discovery mode	“Pairing Your Bluetooth Device(s) with Your Jacket” on page 14
	Delete Music Source	deletes wireless music source from Audex system memory	“Deleting Bluetooth Music Source” on page 16
	Set Scroll Speed	sets text scrolling speed on display	“Setting Display Text Scrolling Speed” on page 19
	Set Time	selects method to set time on display	“Setting Time” on page 19
	Back	return to previous menu	
Back	N/A	exits main menu and returns you to Idle screen	

## Audio Tones

The Audex System generates audio tones in your jacket speakers that provide operational status information. Some typical tones include:

Tone	Status
ring tone	incoming call
two descending tones	battery low
five ascending tones	power on
two ascending tones	successful pairing
three descending tones	call ended/rejected/dropped
three ascending tones	call connected

## Idle Screen

The Idle screen functions as the central default screen on the Control Module display. When not operating your phone or music device, the Audex system displays the Idle screen.

The Idle screen shows the music source currently selected on your jacket. This can be one of several Bluetooth streaming music devices paired with your jacket, or an iPod connected to your jacket via optional accessory as shown.



While your jacket can be paired to multiple Bluetooth streaming music sources, only one source can be selected at a time. When no music source is selected on the jacket, the following displays.



To play music, you must first select a music source. See “Selecting Music Source” on page 15 for steps on selecting a music source.



If a song was playing and is currently paused, the Music Paused (⏸) icon also displays on the Idle screen. You can resume playing the song from the Idle screen by pressing the (⏵) key.

# Using Your Audex Motorola Jacket

This section provides instructions on performing operating tasks with your Audex Motorola Jacket.

## Turning Your Audex System On & Off

To turn on or off your Audex system, press and hold  key on the Control Module for at least 5 seconds until the Motorola logo displays.

**Note:** You can view the Audex Motorola Jacket software versions (control module displays first, followed by chest module) while turning on your Audex system by pressing and holding the  key (along with the  key).

When turned on, the Audex system establishes a connection with paired Bluetooth devices (phone and/or streaming music devices) and iPod via wired connection. Once the Audex system finishes connecting to your devices, the Idle screen with the currently selected music source displays. For details on listening to music or selecting a different music source, see “Listening to Music” on page 14.

## Connecting to Your Bluetooth Devices

When connecting to a Bluetooth device, **Connecting <Device Name>** displays first for a few seconds (music devices only—phone connection does not display this). Once connected, the Bluetooth Device Connected () icon and text display for a few seconds:



**Note:** If the phone is already on a call when connecting to the Audex Motorola Jacket, the Call Connected () icon displays for a few seconds.

If no Bluetooth device(s) are connected, the Audex system automatically enters Bluetooth discovery mode. See “Pairing Your Bluetooth Device(s) with Your Jacket” on page 14 for details on pairing your Bluetooth device(s) with your jacket.

## Connecting to Your iPod

Using the optional accessory, follow the steps shown to connect the iPod to the Chest Module.

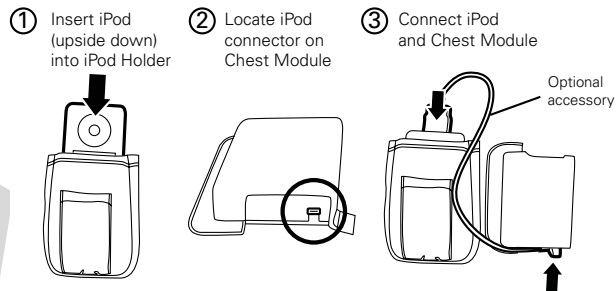

When connecting to the iPod, **Connecting iPod** displays first for a few seconds. Once connected, the iPod Connection () icon and text displays for a few seconds:



## No Connections

When no device connections are established, and the device discovery mode times out after 3 minutes, the Audex Motorola Jacket automatically turns off.

# Pairing Your Bluetooth Device(s) with Your Jacket

To operate with your Audex system, your Bluetooth devices must be paired with your jacket. To do this, follow these steps:

1 If your Audex Motorola Jacket is not in Bluetooth discovery mode, do the following:

- a In the main menu, scroll to **Setup** and press **OK** key.
- b Scroll to **Find Me** and press **OK** key.



The jacket is placed in Bluetooth discovery mode for 3 minutes. (indicator light is solid blue).

2 Using your Bluetooth phone or music device, perform a Bluetooth device discovery (refer to your phone or music device manual for detailed instructions on accessing Bluetooth and putting it in device discovery mode).

For most Motorola phones, you can find the Bluetooth option under the Main Menu or Connections menu:

After accessing Bluetooth:

- a Select **Look for Devices**.  
The phone lists Bluetooth devices it finds.
- b Select **Audex**.
- c Select **OK** or **Yes** to pair your jacket with your phone.

d Enter the passkey: **0000**

e Select **OK**.

**Note:** These steps are for most Motorola phones. For other phones, see your phone's user's guide for instructions on performing a Bluetooth device discovery.

When your Audex Motorola Jacket successfully pairs with your Bluetooth phone or music device, the indicator light flashes rapidly in blue with quick purple flashes for 5 seconds. The Bluetooth Active (📶) and Phone Connected (📱) icons display when paired with your phone, while the Bluetooth Active (📶) and Bluetooth Device Connected (🎧) icons display when paired with your music device.

## Listening to Music



Your Audex Motorola Jacket allows you to select from multiple Bluetooth streaming music sources or an iPod to listen to music.

**Note:** In some instances, if your Bluetooth phone is paired with the Audex system to make wireless phone calls, you may have to temporarily disconnect the phone's handsfree link to establish a wireless music connection with your Bluetooth music device. Once the wireless music link is established, the Audex system attempts to automatically reestablish the handsfree link (ensure your phone has Bluetooth is turned on). When reconnected, the Phone Connected (📱) icon displays to indicate successful handsfree link with your phone. If the icon does not display, pressing the Send key manually re-establishes the handsfree connection.

Similarly, in instances where the Audex system is supporting both handsfree and streaming music connections, and the streaming music link is disconnected (e.g. deleting a music source), then the handsfree connection may also disconnect. If this occurs, the Audex system automatically re-establishes the handsfree link with your phone. If this does not occur, press **OK** key to manually re-establish the handsfree link.

## Selecting Music Source

You must select which music source to listen to on your jacket.

- 1 In the main menu, scroll to **Setup** and press  key.
- 2 Scroll to **Select Music Source** and press  key.
- 3 Scroll to music source and press  key.



Once selected, **Connecting...** displays for a few seconds. When connected, the Idle screen displays showing the selected music source.

## Playing Music (Bluetooth Streaming)

To play music from your selected Bluetooth streaming music source:

In the main menu, scroll to **Play Music** and press  key.



You see the Streaming Music playback screen:



Music will begin playing from the beginning of your playlist. If a playlist is not created, then the music may stop at the end of each song.

**Note:** Song track/artist information does not display when streaming music.

## Playing Music (iPod)

To play music from your iPod:

In the main menu, scroll through menus to find a playlist/artist/album/song to play and press  key.

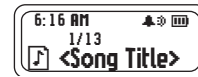



You see the iPod Music playback screen:













**Note:** The Audex Motorola Jacket has

been optimized for the English language. Certain non-English characters will not appear on the Control Module display. Full Audex system functionality, however, is not impacted. For example, "música" will appear as "m sica".

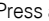
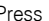
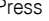
From the Streaming Music or iPod Music playback screen, you can do the following:

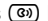

To do this...	Do this
Pause/resume music	Press  key. <ul style="list-style-type: none"><li>• When music is playing, the Music Playing () icon displays.</li><li>• When music is paused, the Music Paused () displays.</li></ul>
	<b>Note:</b> When pausing Bluetooth streaming music, the main menu displays. Before resuming Bluetooth streaming music playing, ensure <b>Resume Music</b> displays.

To do this...	Do this
Lock keypad	Press and hold  key. When keypad is locked, the Hold/Lock Mode (  ) displays.
Change music volume	Press the  and  keys.
Fast-forward song	Press and hold  key. <b>Note:</b> For iPod, holding the  key while paused fast forwards in increments of 1, 5, 10, and then 20 songs.
Skip to next song	Press  key. <b>Note:</b> For iPod, if playing last song on list, music is stopped and list is displayed.
Rewind song	Press and hold  key.
Start song over	Press  key. <b>Note:</b> For iPod, if playing first song on list, music is stopped and list is displayed. <b>Note:</b> If pressed during first 3 seconds of song, you are skipped to the beginning of previous song.
Play previous song	Press  key twice.
Go to Idle screen	Press  key. Music is paused.
Stop streaming music	Press  key twice.

To do this...	Do this
Make voice dial call	Press  key. Music is paused. When call is ended, music is resumed.
Go to recent calls list	Press  key. Music is paused. When call is ended, music is resumed.

## Deleting Bluetooth Music Source

You can remove a paired Bluetooth music source from your Audex system's memory.

- In the main menu, scroll to **Setup** and press  key.
- Scroll to **Delete Music Source** and press  key.



Once selected, **Source Delete** displays for a few seconds. When deleted, the Idle screen displays showing the selected music source.

**Note:** If the current selected music source is deleted, the Audex system will set the music source to the first connected Bluetooth streaming device.



## Making and Receiving Calls

Your Audex Motorola Jacket allows you to make and receive phone calls from your Bluetooth phone.

**Note:** Some features are phone/network dependent.

### Making a Voice Dial Call

**Note:** To make a voice dial call, your phone must support voice dial features.

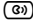
- 1 Press  key. If music is playing, it is paused.



- 2 Speak name of person to call. Name is repeated over jacket speakers and the Call Dialing () icon displays.

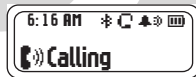



Once connected, the Call Connected () icon displays.

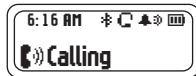

### Making a Handset Dial Call

- 1 Dial the phone number using the phone handset. You will hear dialing over the jacket speakers. (If music is playing, it is paused.)
- 2 Press Send key on the phone. Ringing is heard over jacket speakers and the Call Dialing () icon displays.



Once connected, the Call Connected () icon displays.



## Making a Call using Last Dialed Phone Number

To make a call using last dialed phone number, press and hold the  key until you hear



ringing over jacket speakers and see the Call Dialing () icon display.

Once connected, the Call Connected () icon displays.



## Making a Call Using a Recent Call Phone Number

- 1 In the main menu, scroll to **Recent Calls** and press  key.



**Shortcut:** Press  key from the Streaming Music or iPod Music playback screen to directly access the Dialed Calls menu (skipping step 2).

- 2 Scroll to **Dialed Calls** or **Received Calls** and press  key.



- 3 Scroll to phone number and press  key.



Once selected, **Calling** and the Call Dialing () icon display.



Once connected, the Call Connected (☎) icon displays for a few seconds. Then the caller ID dialed displays during the call.

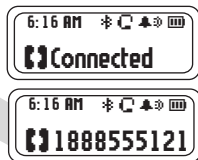

## Receiving a Call

When an incoming call is active, the Call Dialing (☎) icon and caller ID displays.

**Note:** To modify ringer volume, press ▲ or ▼ key.



## Answering a Call

To answer an incoming call, press the (☎) key. If music is playing, it is paused.

Once connected, the Call Connected (☎) icon displays for a few seconds. Then, the caller ID displays during the call.

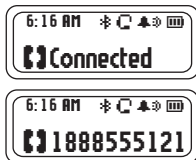

## Rejecting a Call

To ignore an incoming call, press the (☎) key.

## Missing a Call

For calls that are missed, the Missed Call (☎) icon displays. When any key (except (☎) key) is pressed, the Idle screen displays. If the (☎) key is pressed, the Received Calls list displays.

To resume music that was playing before missing the call, press the (☎) key again when in Idle mode.

From the Call Connected screen, you can do the following:

To do this...	Do this
Mute / unmute a call	Press (☎) key, <ul style="list-style-type: none"><li>When call is muted, <b>Muted</b> displays.</li><li>When call is unmuted, Call Connected screen redisplay.</li></ul>
Change the call volume	Press the ▲ and ▼ keys.
Answer a second incoming call	Press (☎) key. First call is placed on hold. On GSM phones, Call On Hold (☎) icon and text displays.
Reject a second incoming call	Press (☎) key.
Switch between two calls (active and on hold)	Press (☎) key. <b>Note:</b> On GSM phones, when the remote caller ends the active call, the other call remains on hold until you press the (☎) key to resume it. Until you resume the call, the Call On Hold (☎) icon (and text) displays in the Activity area of the display.

### To do this... (Continued)

### Do this

Link two (active and on hold) calls (3-way conference)

Press and hold  key.



**Conference** displays on GSM phones.



End a call

Press  key.

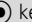
Call Ended () icon and text displays. If music was playing before call, it resumes playing.

## Locking/Unlocking Control Module Keys

To lock keys on the Control Module, press and hold  key for 5 seconds. The Hold/Lock Mode () icon displays and the Control Module keys are disabled (locked).

To unlock keys on the Control Module, press and hold  key for 5 seconds until the Hold/Lock Mode () icon no longer displays.

## Using Privacy Mode

Your Audex Motorola Jacket allows you to listen to audio in privacy using headphones. In privacy mode, all audio from your phone or music device is output to your headphones (while the speakers in the jacket hood are silent).

To use privacy mode, connect your headphones into the headphone jack on the Chest Module.

Headphone Jack  
(for Privacy Mode)

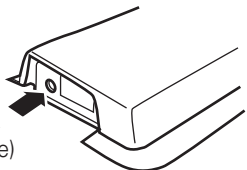

# Customizing Your Audex Motorola Jacket

This section provides instructions for customizing operations for your Audex Motorola Jacket.

## Setting Display Text Scrolling Speed

1 In the main menu, scroll to **Setup** and press  key.



2 Scroll to **Set Scroll Speed** and press  key.

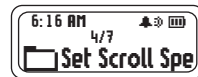

3 Scroll to desired setting and press  key.

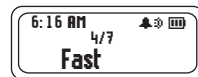

Once selected, you see Item Selected () icon and **Speed Change** display for a few seconds.

## Setting Time

1 In the main menu, scroll to **Setup** and press  key.

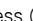

2 Scroll to **Set Time** and press  key.







3 Do one of the following:

- To derive time from your phone (default setting), scroll to **Automatic** and press  key. Once selected, you see Item Selected (✓) icon and **Time Changed** display for a few seconds.
- To set time manually, continue to step 4.

4 Scroll to **Manual** and press  key.

5 Set time as follows:

- Press  and  keys to move between hour and minute values.
- Press  and  keys to change value.

6 Press  key.

Once selected, you see Item Selected (✓) icon and **Time Changed** display for a few seconds.

## Maintenance and Care

---

Please use the following guidelines for proper maintenance and care of your Audex Motorola Jacket:

### Care

- Allow jacket to completely dry after riding or exposure to moisture. Do not expose the Audex components to moisture.
- This jacket is a high-tech piece of apparel. Do not expose the Audex components to excessive force or impact. Be careful not to drop the Audex Motorola Jacket.

### Washing Instructions

- **Excessive washing is not recommended.**
- Before washing the jacket, you must remove your phone, music devices, and all Audex Motorola Jacket components. See “Audex Components” on page 5 for a listing of all components. Electronic components warranty will no longer be valid if components are not removed prior to washing.
- Tuck in all cords, close pockets, and zip the jacket closed.
- Follow washing instructions on the inside of the jacket. These are as follows:
  - Machine Wash Warm (Below 30c) using powdered detergent. Rinse thoroughly.
  - DO NOT Bleach.
  - Tumble dry low heat, or hang dry in shade.
  - DO NOT iron.
  - DO NOT dry clean.
  - DO NOT use fabric softener.
  - Periodically replenish water repellent finish – spray on only.
- Allow your jacket to completely dry before reinstalling the Audex electronic components.

## European Union Directives Conformance Statement

---

Hereby, Motorola declares that this product is in compliance with:

-  •The essential requirements and other relevant provisions of Directive 1999/5/EC  
•All other relevant EU Directives



The above gives an example of a typical Product Approval Number.

You can view your product's Declaration of Conformity (DoC) to Directive 1999/5/EC (to R&TTE Directive) at [www.motorola.com/rtte](http://www.motorola.com/rtte). To find your DoC, enter the product Approval Number from your product's label in the "Search" bar on the Web site.

## Caring for the Environment by Recycling

---



This symbol on a Motorola product means the product should not be disposed of with household waste.

## Recycling Mobile Phones and Accessories

---

Do not dispose of mobile phones or electrical accessories, such as chargers or headsets, with your household waste. In some countries or regions, collection systems are set up to handle electrical and electronic waste items. Contact your regional authorities for more details. If collection systems aren't available, return unwanted mobile phones or electrical accessories to any Motorola Approved Service Centre in your region.

# Safety and General Information

**IMPORTANT INFORMATION ON SAFE AND EFFICIENT OPERATION. READ THIS INFORMATION BEFORE USING YOUR DEVICE.**

## Approved Accessories

Use of accessories not approved by Motorola, including but not limited to batteries, antennas, and convertible covers, may cause your phone to exceed RF energy exposure guidelines and may void your phone's warranty. For a list of approved Motorola accessories, visit our website at [www.motorola.com](http://www.motorola.com).

## Electromagnetic Interference/Compatibility

**Note:** Nearly every electronic device is susceptible to electromagnetic interference (EMI) if inadequately shielded, designed, or otherwise configured for electromagnetic compatibility.

## Facilities

Turn off your phone in any facility where posted notices instruct you to do so. These facilities may include hospitals or health care facilities that may be using equipment that is sensitive to external RF energy.

## Aircraft

When instructed to do so, turn off your device when on board an aircraft. Any use of a device must be in accordance with applicable regulations per airline crew instructions.

## Medical Devices

### Hearing Aids







Some devices may interfere with some hearing aids. In the event of such interference, you may want to consult with your hearing aid manufacturer to discuss alternatives.

### Other Medical Devices

If you use any other personal medical device, consult the manufacturer of your device to determine if it is adequately shielded from RF energy. Your physician may be able to assist you in obtaining this information.

## Batteries and Chargers

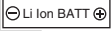
Your battery, charger, or mobile device may contain symbols, defined as follows:

Symbol	Definition
	Important safety information follows.
	Do not dispose of your battery or mobile device in a fire.
	Your battery or mobile device may require recycling in accordance with local laws. Contact your local regulatory authorities for more information.
	Do not throw your battery or mobile device in the trash.
	Your mobile device contains an internal lithium ion battery.
	Do not let your battery, charger, or mobile device get wet.
	Listening at full volume to music or voice through a headset may damage your hearing.

## Safety Information: General Use

### USE AT YOUR OWN RISK

Do not use your headphones and cellular phone while riding or moving. Only use them while waiting for the lift, on the lift, waiting to ride, or in the lodge. Listening to tunes or talking on a phone while riding may prevent you from hearing others around you, distract you from riding safely, and limit your ability to hear what your edges are doing on the snow. All of these can cause loss of control and an accident possibly resulting in injury or death to you or others.

## Avoid Distraction

Using headsets while operating a motor vehicle, motorcycle or bicycle is dangerous, and is illegal in some states. Check your local laws. Use caution while using your Audex Motorola Jacket Series when engaging in ANY activity that requires your full attention. Avoid placing or receiving calls while driving an automobile, motorcycle, equipment or any other motorized mode of transportation to reduce the risk of accident or injury.

## Avoid Hearing Damage

Using the headset at high volume may result in permanent hearing loss. If you experience ringing in your ear, reduce the volume or discontinue using Audex Motorola Jacket Series. With continued use at high volume, your ear may become accustomed to the sound level, which may result in permanent damage to your hearing. Keep Audex Motorola Jacket Series volume at a safe level.

## Avoid Moisture

It is important to properly dry jacket after every use by hanging in a warm, dry location. Do not expose the Audex components to moisture.

## Location of Use

Audex Motorola Jacket Series is NOT to be used in the vicinity of any explosive or hazardous substances, as it may become volatile and cause serious injury or death.

See "Electromagnetic Interference" above for restrictions on using Audex Motorola Jacket Series in medical facilities and aboard aircraft.

## Proper Care of your Audex Motorola Jacket

### Do Not Modify or Dismantle

Do not attempt to open Audex Motorola Jacket system components. Doing so may expose you to electric shock and serious injury. There are no user-serviceable parts inside. Any attempt to alter or repair the module will void the limited warranty. Users are not permitted to make changes or modify the device in any way. Changes and modifications void the user's authority to operate the device. See 47 CFR Sec. 15.21.

### Battery

Do not attempt to remove the internal rechargeable battery. Disposal of devices that contain internal rechargeable batteries must be in accordance with local environmental regulations.

For additional information on purchasing replacement batteries, please visit [www.hellomoto.com](http://www.hellomoto.com).

## Temperature

- Do not use your Audex Motorola Jacket in temperatures lower than -10°C / 14°F or higher than 60°C / 140°F. **Battery life may temporarily shorten in low-temperature conditions.**
- Do not recharge your Audex Motorola Jacket in temperatures lower than 0°C / 32°F or higher than 40°C / 104°F.
- Conditions inside a parked car can exceed this temperature range. Do not store your Audex Motorola Jacket in a parked car.
- Do not store your Audex Motorola Jacket in direct sunlight.
- Storing your Audex Motorola Jacket fully charged in high temperature conditions may permanently reduce the life of the battery.

## Shock

Do not expose your Audex Motorola Jacket to excessive force or impact. Be careful not to drop your Audex Motorola Jacket.

## Charger

Do not force the charging cable connector into the battery charging port. If the connector won't go into the port, try flipping the connector 180 degrees. Do not attempt to charge your Audex Motorola Jacket with any charger other than the one designed by Motorola specifically to be used with this product.

## Cleaning

To clean components in your Audex Motorola Jacket System, use a soft cotton cloth to gently brush all surfaces to remove any grit or particles that might scratch the surfaces. Please note the following:

- The Audex Motorola Jacket components are not waterproof.** and excessive moisture will damage the electronic circuitry. Do not rinse or immerse any modules.
- Before cleaning, make sure the Audex Motorola Jacket System is unplugged from the wall charger.
- Do not clean the modules with soaps, detergents, ammonia, alkaline cleaners, abrasive cleaning compounds or solvents. These substances may leak into the module and damage the electronic circuitry.

# Support

---

<b>Turkey</b>	212 317 45 95
<b>United Kingdom</b>	0870 9010 555

If your Audex Motorola Jacket does not function, please make sure that the battery is properly installed and charged, all electronics are properly secure with wiring connectors, and you have followed the instructions to install your system. For additional assistance, contact Motorola Product Support:

<b>North America</b>	<a href="http://www.hellomoto.com/Bluetoothsupport">www.hellomoto.com/Bluetoothsupport</a> or 1.877.MOTOBLU
<b>Australia</b>	1300 138823
<b>New Zealand</b>	0508 6686 7652
<b>Austria</b>	0800 297 246
<b>Belgium</b>	027 001 660
<b>Croatia</b>	0800 223 003
<b>Czech Republic</b>	844 111 145
<b>Denmark</b>	43 48 8005
<b>Eire</b>	1850 909 555
<b>Finland</b>	0800 117 036
<b>France</b>	0825 303 302
<b>Germany</b>	18 035 050
<b>Greece</b>	210 6800 009
<b>Hungary</b>	40 200 800
<b>Italy</b>	199 501 160
<b>Luxembourg</b>	03420 808 296
<b>Netherlands</b>	020 201 5034
<b>Norway</b>	22 551 004
<b>Poland</b>	801 620 620
<b>Portugal</b>	214 101 001
<b>Romania</b>	(021) 3057999
<b>Russia</b>	7 800 200 1313
<b>Slovak Republic</b>	850 111 011
<b>Slovenia</b>	0800 800 50
<b>Spain</b>	902 100 077
<b>Sweden</b>	08 445 1210
<b>Switzerland</b>	0800 553 109



# Consumer Warranty Coverage

---

Thank you for purchasing your Audex Motorola Jacket. The Audex Motorola Jacket is covered by two different warranties: one that covers the Audex components, and which is administered by Motorola, Inc., and one that covers the jacket and all sewn in components. For more information regarding the warranty of the jacket and sewn in components, refer to Audextech.com.

## Audex Motorola Jacket Series Product Coverage – Jacket and Sewn In Components Coverage

### Covered:

- Defective sewing.
- Defective zippers and attachment hardware.
- Velcro patches and/or snaps.
- Missing or broken drawstrings and cords.

### Not Covered:

- Rips and tears.
- Fading (this includes UV damage).
- Pilling.
- Shrinking.
- Damage (including color bleeding and loss of waterproof qualities) resulting from improper washing or the use of improper detergents).

## Audex Motorola Jacket Series Claims Procedure – Jacket and Sewn In Components Coverage

### STEP ONE

#### Evaluate the Validity of the Claim

- Was the product purchased in the last 12 months?
- Does the damage appear to be attributable to defective materials or workmanship?
- Does the damage appear to be due to impact, abuse, negligence, or reactions to heat, solvents, or harsh detergents?

For specific instructions regarding different products, please consult the Warranty Guidelines.

**If it appears to meet the "Covered" Guidelines in this manual, continue...**

### STEP TWO

#### CALL FOR A RETURN AUTHORIZATION (RA) NUMBER

- Dealers call 1-800-367-2951.
- Consumers call 1-800-881-3138.
- Tell us WHAT you are sending back - describe the product.
- Tell us WHY you are sending it back - describe the problem.
- Record the RA# and details in a log.

### STEP THREE

#### PACK AND SHIP THE PRODUCT IMMEDIATELY!

- Include the original proof of purchase (receipt).
- Include a brief description of the problem and the RA#
- Mark the defect with masking tape if possible.
- Print the RA# clearly on the outside of the box.
- Ship the claim to:

Audex  
Attn: Product Service RA# \_\_\_\_\_  
30 Community Drive Suite #3  
South Burlington, VT 05403

Customers are responsible for shipping charges. Refer to [www.audextech.com](http://www.audextech.com) for more information.

Overnight and 2-Day shipments will be returned in the same manner at our expense.

**\*\*\*W48 GOES INTO EFFECT WHEN WE RECEIVE THE PRODUCT.\*\*\***

(What is W48? This means the product will be on its way back to you in 2 business days.)

Within 48 hours of receipt of product, the claim will be handled in one of the following ways:

- If the returned product is within the valid warranty period of one year and judged to be defective, we will repair or replace the product. **The warranty remains valid on repaired and replaced items for the remainder of the warranty coverage period.**
- If the problem is determined to be not covered under warranty but can be repaired, we will call with a quote, and to get authorization to proceed with the repair.
- If the problem is not covered under warranty, nor repairable, the product will be returned as is.

# Audex Components by Motorola Limited Warranty – North America

## What Does this Warranty Cover?

Subject to the exclusions contained below, Motorola, Inc. warrants its telephones, pagers, messaging devices, and consumer and professional two-way radios (excluding commercial, government or industrial radios) that operate via Family Radio Service or General Mobile Radio Service, Motorola-branded or certified accessories sold for use with these Products (“Accessories”) and Motorola software contained on CD-ROMs or other tangible media and sold for use with these Products (“Software”) to be free from defects in materials and workmanship under normal consumer usage for the period(s) outlined below. This limited warranty is a consumer’s exclusive remedy, and applies as follows to new Motorola Products, Accessories and Software purchased by consumers in the United States or Canada, which are accompanied by this written warranty:

Products Covered	Length of Coverage	Exclusions
<b>A Products and Accessories</b> as defined above, unless otherwise provided for below.	<b>A One (1) year</b> from the date of purchase by the first consumer purchaser of the product unless otherwise provided for below.	<p><b>Normal Wear and Tear.</b> Periodic maintenance, repair and replacement of parts due to normal wear and tear are excluded from coverage.</p> <p><b>Batteries.</b> Only batteries whose fully charged capacity falls below 80% of their rated capacity and batteries that leak are covered by this limited warranty.</p> <p><b>Wiring and other electrical harnesses.</b> Wiring and other electrical harnesses integrated into clothing or wearable items and which connect Products or Accessories are excluded from coverage.</p>

Products Covered	Length of Coverage	Exclusions
<b>1 Decorative Accessories and Cases.</b> Decorative covers, bezels, PhoneWrap™ covers and cases.	<b>1 Limited lifetime warranty</b> for the lifetime of ownership by the first consumer purchaser of the product.	<p><b>Abuse &amp; Misuse.</b> Defects or damage that result from: (a) improper operation, storage, misuse or abuse, accident or neglect, such as physical damage (cracks, scratches, etc.) to the surface of the product resulting from misuse; (b) impact, collision or other contact with solid objects; (c) contact with liquid, water, rain, extreme humidity or heavy perspiration, sand, dirt or the like, extreme heat, or food; (d) contact with solvents, adhesives, or other chemicals; (e) use of the Products or Accessories for commercial purposes or subjecting the Product or Accessory to abnormal usage or conditions; or (f) other acts which are not the fault of Motorola, are excluded from coverage.</p> <p><b>Use of Non-Motorola Products and Accessories.</b> Defects or damage that result from the use of Non-Motorola branded or certified Products, Accessories, Software or other peripheral equipment are excluded from coverage.</p> <p><b>Unauthorized Service or Modification.</b> Defects or damages resulting from service, testing, adjustment, installation, maintenance, alteration, or modification in any way by someone other than Motorola, or its authorized service centers, are excluded from coverage.</p>

Products Covered	Length of Coverage	Exclusions
<b>2 Monaural Headsets.</b> Ear buds and boom headsets that transmit mono sound through a wired connection.	<b>2 Limited lifetime warranty</b> for the lifetime of ownership by the first consumer purchaser of the product.	<b>Altered Products.</b> Products or Accessories with (a) serial numbers or date tags that have been removed, altered or obliterated; (b) broken seals or that show evidence of tampering; (c) mismatched board serial numbers; or (d) nonconforming or non-Motorola housings, or parts, are excluded from coverage.
<b>3 Consumer and Professional Two-Way Radio Accessories.</b>	<b>3 Ninety (90) days</b> from the date of purchase by the first consumer purchaser of the product.	<b>Communication Services.</b> Defects, damages, or the failure of Products, Accessories or Software due to any communication service or signal you may subscribe to or use with the Products Accessories or Software is excluded from coverage.
<b>4 Products and Accessories that are Repaired or Replaced.</b>	<b>4 The balance of the original warranty or for ninety (90) days</b> from the date returned to the consumer, whichever is longer.	
<b>B Software.</b> Applies only to physical defects in the media that embodies the copy of the software (e.g. CD-ROM, or floppy disk)	<b>B Ninety (90) days</b> from the date of purchase.	<b>Software Embodied in Physical Media.</b> No warranty is made that the software will meet your requirements or will work in combination with any hardware or software applications provided by third parties, that the operation of the software products will be uninterrupted or error free, or that all defects in the software products will be corrected. <b>Software NOT Embodied in Physical Media.</b> Software that is not embodied in physical media (e.g. software that is downloaded from the internet), is provided "as is" and without warranty.

## Who Is Covered?

This warranty extends only to the first consumer purchaser, and is not transferable.

## What Will Motorola Do?

Motorola, at its option, will at no charge repair, replace or refund the purchase price of any Products, Accessories or Software that does not conform to this warranty. We may use functionally equivalent reconditioned/refurbished/pre-owned or new Products, Accessories or parts. No data, software or applications added to your Product, Accessory or Software, including but not limited to personal contacts, games and ringer tones, will be reinstalled. To avoid losing such data, software and applications please create a back up prior to requesting service.

## How to Obtain Warranty Service or Other Information

<b>USA</b>	<b>Phones:</b> 1-800-331-6456 <b>Pagers:</b> 1-800-548-9954 <b>Two-Way Radios and Messaging Devices:</b> 1-800-353-2729
<b>Canada</b>	<b>All Products:</b> 1-800-461-4575
<b>TTY</b>	1-888-390-6456
For <b>Accessories</b> and <b>Software</b> , please call the telephone number designated above for the product with which they are used.	

You will receive instructions on how to ship the Products, Accessories or Software, at your expense, to a Motorola Authorized Repair Center. To obtain service, you must include: (a) a copy of your receipt, bill of sale or other comparable proof of purchase; (b) a written description of the problem; (c) the name of your service provider, if applicable; (d) the name and location of the installation facility (if applicable) and, most importantly; (e) your address and telephone number.

## What Other Limitations Are There?

ANY IMPLIED WARRANTIES, INCLUDING WITHOUT LIMITATION THE IMPLIED WARRANTIES OF MERCHANTABILITY AND FITNESS FOR A PARTICULAR PURPOSE, SHALL BE LIMITED TO THE DURATION OF THIS LIMITED WARRANTY. OTHERWISE THE REPAIR, REPLACEMENT, OR REFUND AS PROVIDED UNDER THIS EXPRESS LIMITED WARRANTY IS THE EXCLUSIVE REMEDY OF THE

CONSUMER, AND IS PROVIDED IN LIEU OF ALL OTHER WARRANTIES, EXPRESS OR IMPLIED. IN NO EVENT SHALL MOTOROLA BE LIABLE, WHETHER IN CONTRACT OR TORT (INCLUDING NEGLIGENCE) FOR DAMAGES IN EXCESS OF THE PURCHASE PRICE OF THE PRODUCT, ACCESSORY OR SOFTWARE, OR FOR ANY INDIRECT, INCIDENTAL, SPECIAL OR CONSEQUENTIAL DAMAGES OF ANY KIND, OR LOSS OF REVENUE OR PROFITS, LOSS OF BUSINESS, LOSS OF INFORMATION OR DATA, SOFTWARE OR APPLICATIONS OR OTHER FINANCIAL LOSS ARISING OUT OF OR IN CONNECTION WITH THE ABILITY OR INABILITY TO USE THE PRODUCTS, ACCESSORIES OR SOFTWARE TO THE FULL EXTENT THESE DAMAGES MAY BE DISCLAIMED BY LAW.

**Some states and jurisdictions do not allow the limitation or exclusion of incidental or consequential damages, or limitation on the length of an implied warranty, so the above limitations or exclusions may not apply to you. This warranty gives you specific legal rights, and you may also have other rights that vary from state to state or from one jurisdiction to another.**

Laws in the United States and other countries preserve for Motorola certain exclusive rights for copyrighted Motorola software such as the exclusive rights to reproduce and distribute copies of the Motorola software. Motorola software may only be copied into, used in, and redistributed with, the Products associated with such Motorola software. No other use, including without limitation disassembly of such Motorola software or exercise of the exclusive rights reserved for Motorola, is permitted.

## Smart Practices While Driving

---

### Drive Safe, Call Smart <sup>SM</sup>

**Check the laws and regulations on the use of mobile devices and their accessories in the areas where you drive. Always obey them. The use of these devices may be prohibited or restricted in certain areas. Contact [www.motorola.com/callsmart](http://www.motorola.com/callsmart) for more information.**

Your mobile device lets you communicate by voice and data—almost anywhere, anytime, wherever wireless service is available and safe conditions allow. When driving a car, driving is your first responsibility. If you choose to use your mobile device while driving, remember the following tips:

- **Get to know your Motorola mobile device and its features such as speed dial and redial.** If available, these features help you to place your call without taking your attention off the road.
- **When available, use a handsfree device.** If possible, add an additional layer of convenience to your mobile device with one of the many Motorola Original™ handsfree accessories available today.
- **Position your mobile device within easy reach.** Be able to access your mobile device without removing your eyes from the road. If you receive an incoming call at an inconvenient time, if possible, let your voice mail answer it for you.
- **Let the person you are speaking with know you are driving; if necessary, suspend the call in heavy traffic or hazardous weather conditions.** Rain, sleet, snow, ice, and even heavy traffic can be hazardous.
- **Do not take notes or look up phone numbers while driving.** Jotting down a “to do” list or going through your address book takes attention away from your primary responsibility—driving safely.
- **Dial sensibly and assess the traffic; if possible, place calls when your car is not moving or before pulling into traffic.** If you must make a call while moving, dial only a few numbers, check the road and your mirrors, then continue.
- **Do not engage in stressful or emotional conversations that may be distracting.** Make people you are talking with aware you are driving and suspend conversations that can divert your attention away from the road.
- **Use your mobile device to call for help.** Dial 911 or other local emergency number in the case of fire, traffic accident, or medical emergencies.<sup>1</sup>

- **Use your mobile device to help others in emergencies.** If you see an auto accident, crime in progress, or other serious emergency where lives are in danger, call 911 or other local emergency number, as you would want others to do for you.<sup>1</sup>
- **Call roadside assistance or a special non-emergency wireless assistance number when necessary.** If you see a broken-down vehicle posing no serious hazard, a broken traffic signal, a minor traffic accident where no one appears injured, or a vehicle you know to be stolen, call roadside assistance or other special non-emergency wireless number.<sup>1</sup>

## Industry Canada Notice to Users

---

Operation is subject to the following two conditions: (1) This device may not cause interference and (2) This device must accept any interference, including interference that may cause undesired operation of the device Ref IC RSS 210 Sec. 5.11. The term "IC:" before the certification/registration number only signifies that registration was performed based on a Declaration of Conformity indicating that Industry Canada technical specifications were met. It does not imply that Industry Canada approved the equipment. See Ref IC Self-Marking 6(f) and RSP-100 Sec. 4.

## FCC Notice to Users

---

Users are not permitted to make changes or modify the device in any way. Changes or modifications not expressly approved by the party responsible for compliance could void the user's authority to operate the equipment. See 47 CFR Sec. 15.21.

This device complies with part 15 of the FCC Rules. Operation is subject to the following two conditions: (1) This device may not cause harmful interference, and (2) this device must accept any interference received, including interference that may cause undesired operation. See 47 CFR Sec. 15.19(3).

This equipment has been tested and found to comply with the limits for a Class B digital device, pursuant to part 15 of the FCC Rules. These limits are designed to provide reasonable protection against harmful interference in a residential installation. This equipment generates, uses and can radiate radio frequency energy and, if not installed and used in accordance with the instructions, may cause harmful interference to radio communications. However, there is no guarantee that interference will not occur in a particular installation. If this equipment does cause harmful interference to radio or television reception, which can be determined by turning the equipment off and on, the user is encouraged to try to correct the interference by one or more of the following measures:

- Reorient or relocate the receiving antenna.
- Increase the separation between the equipment and the receiver.
- Connect the equipment to an outlet on a circuit different from that to which the receiver is connected.
- Consult the dealer or an experienced radio/TV technician for help.

---

1. Wherever wireless phone service is available.

# Export Law Assurances

---

This product is controlled under the export regulations of the United States of America and Canada. The Governments of the United States of America and Canada may restrict the exportation or re-exportation of this product to certain destinations. For further information contact the U.S. Department of Commerce or the Canadian Department of Foreign Affairs and International Trade.

DRAFT