

# User Manual

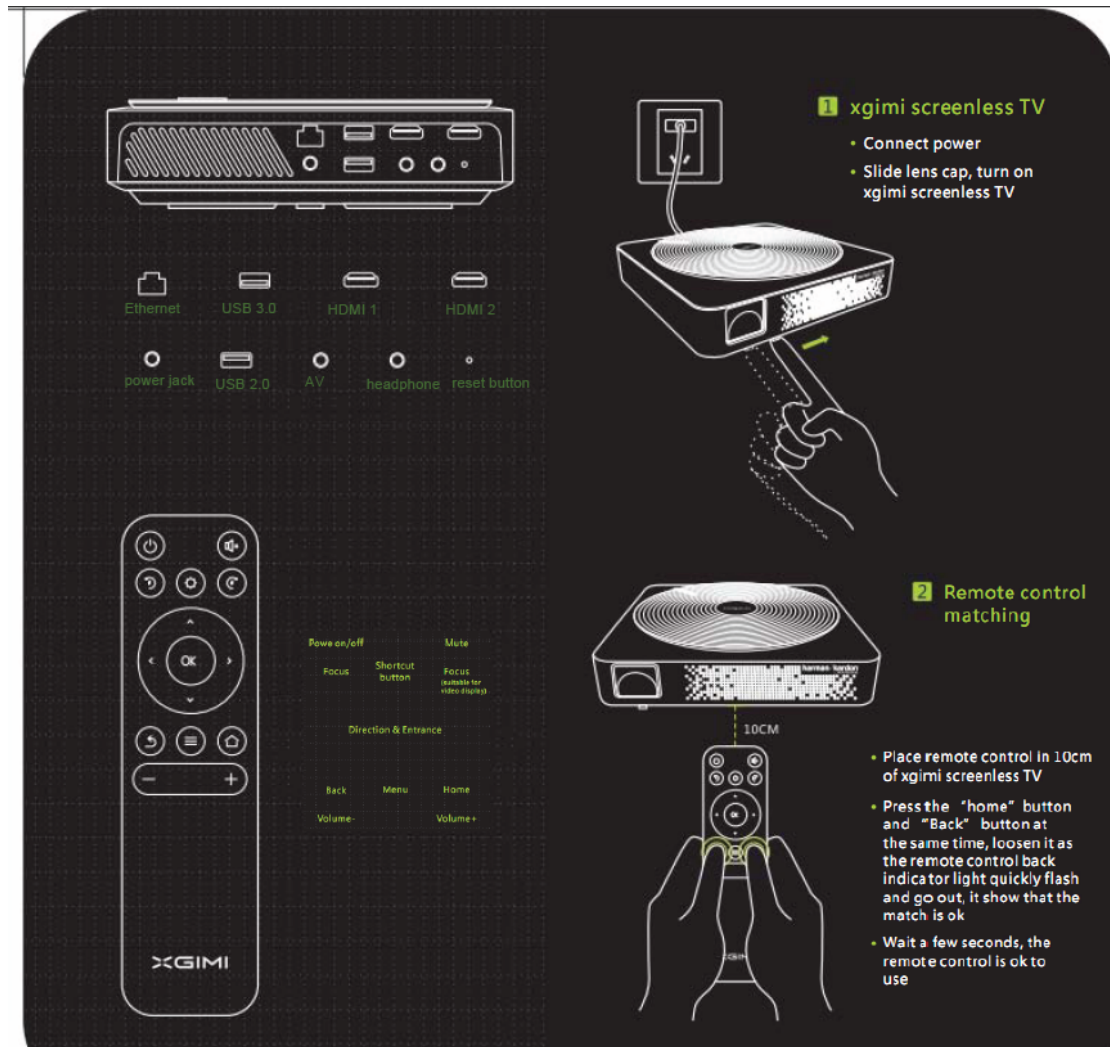

Ethernet	USB3.0	HDMI1	HDMI2	
Power	USB2.0	AV in	Audio out	RST

## Remote control

Power on/off		Mute
Focus	Shortcut button	Focus
	Direction & Entrance	
Back	Menu	Home
Volume-		Volume+

## 1, xgimi super screenless TV

Connect power

Slide lens cap, turn on xgimi super screenless TV

## 2, Remote control matching

Place remote control in 10cm of xgimi super screenless TV

Press the “home”button and “Back” button at the same time, loosen it as the remote control back indicator light quickly flash and go out, it show that the match is ok

Wait a few seconds, the remote control is ok to use

**3 Remote control focusing**

- By adjusting the left and right focus keys to make the picture clear

**4 Xgimi Assistant**

Mobile control xgimi screenless TV, scan the QR code,download xgimi assistant

- Mobile phone resources: easy to push the mobile phone resource to the screenless TV with one button, browse pictures and videos freely
- Frequency control: Xgimi screenless TV one-key synchronize to the mobile phone. Support resco bubbles games operate
- Mobile remote control: Mobile phone control the screenless TV easily

**Warranty List**

All the following items under the condition of non-artificial damage

- 7 days full-refund or change to the same type and model product, since the date of got the projector.
- 30 days freely change to the same type and model product,since the date of got the projector.
- 1 years repair,since the date of got the projector.

**Warranty Exemption Clause:**

belong to the following situation but not only the situations, is not included in the warranty

- Exceed the warranty
- Unauthorized repair, misuse, collision, neglect, abuse, changes into a liquid, accidents, and incorrect installation caused goods quality problem, or tear, altered labeling, machine serial number, anti-counterfeiting tags
- Force majeure such as fire ,flooding ,lightning damage
- Due to failures human operate
- Use other non-xgimi accessories,or fault operate,lead to product failure or accident
- Operate and maintenance do not obey the user's manual

Chengdu Xgimi Technology Co.Ltd  
China hotline: 400-0028-960 Website: www.xgimi.com  
Add:A705,Tianfu Software Park, Hi-tech Zone, Chengdu

**Declaration**

This is A-class products, in the living environment, the product may cause radio interference, in this case, may require users take concrete and effective measures to avoid the interference

## 3, Remote control focus adjustment

Adjust the left and right “FOCUS” button to make picture more clear

## 4, Xgimi Assistant

Mobile control xgimi super screenless TV, scan the QR code,download xgimi assistant

Mobile phone resources:easy to push the mobile phone resource to the screenless TV with one button, browse pictures and videos freely

Frequency control: Xgimi super screenless TV one-key synchronize to the mobile phone. Support resco bubbles games operate

Mobile remote control: Mobile phone control the super TV easily

**Warranty List:**

All the following items under the condition of non-artificial damage

7 days full-refund or change to the same type and model product , since the date of got the projector.

30 days freely change to the same type and model product,since the date of got the projector.

1 years repair,since the date of got the projector.

**Warranty Exemption Clause:**

Exceed the warranty

Unauthorized repair, misuse, collision, neglect, abuse, changes into a liquid, accidents, and incorrect installation caused goods quality problem, or tear, altered labeling, machine serial number, anti-counterfeiting tags

Force majeure such as fire ,flooding ,lightning damage

Due to failures human operate

Use other non-xgimi accessories,or fault operate,lead to product failure or accident

Operate and maintenance do not obey the user's manual

**Contact us**

Chengdu Xgimi Technology Co.Ltd

Add:A705,Tianfu Software Park, Hi-tech Zone,Chengdu

China hotline: 400-0028-960

Website: [www.xgimi.com](http://www.xgimi.com)

**Declaration**

This is A-class products, in the living environment, the product may cause radio interference, in this case, may require users take concrete and effective measures to avoid the interference

This device complies with Part 15 of the FCC Rules. Operation is subject to the following two conditions:

(1) This device may not cause harmful interference, and (2) this device must accept any interference received, including interference that may cause undesired operation.

Caution: Changes or modifications not expressly approved by the party responsible for compliance could void the user's authority to operate the equipment.

NOTE: This equipment has been tested and found to comply with the limits for a Class B digital device, pursuant to part 15 of the FCC Rules. These limits are designed to provide reasonable protection against harmful interference in a residential installation. This equipment generates uses and can radiate radio frequency energy and, if not installed and used in accordance with the instructions, may cause harmful interference to radio communications. However, there is no guarantee that interference will not occur in a particular installation. If this equipment does cause harmful interference to radio or television reception, which can be determined by turning the equipment off and on, the user is encouraged to try to correct the interference by one or more of the following measures:

- Reorient or relocate the receiving antenna.
- Increase the separation between the equipment and receiver.
- Connect the equipment into an outlet on a circuit different from that to which the receiver is connected.
- Consult the dealer or an experienced radio/TV technician for help.