



User Manual

Federal Communications Commission (FCC) Requirements, Part 15

This equipment has been tested and found to comply with the limits for a class B digital device, pursuant to part 15 of the FCC Rules. These limits are designed to provide reasonable protection against harmful interference in a residential installation.

This equipment generates, uses and can radiate radio frequency energy and, if not installed and used in accordance with the instructions, may cause harmful interference to radio communications. However, there is no guarantee that interference will not occur in a particular installation. If this equipment does cause harmful interference to radio or television reception, which can be determined by turning the equipment off and on, the user is encouraged to try to correct the interference by one or more of the following measures:

- Reorient or relocate the receiving antenna.**
- Increase the separation between the equipment and receiver.**
- Connect the equipment into an outlet on a circuit different from that to which the receiver is connected.**
- Consult the dealer or an experienced radio/TV technician for help.**

<p>CAUTION: Any changes of modifications not expressly approved by the grantee of this device could void the users authority to operate the equipment.</p>

Quick Installation Guide for RF Wireless Optical Mouse

THIS UNIT COMPLIES WITH PART 15 FCC RULES.

OPERATION IS SUBJECT TO FOLLOWING TWO CONDITIONS:

(1) THIS DEVICE MAY NOT CAUSE HARMFUL INTERFERENCE.

(2) THIS DEVICE MUST ACCEPT ANY INTERFERENCE RECEIVED, INCLUDING INTERFERENCE THAT MAY CAUSE UNDESIRABLE OPERATION.

1. Contents of the Package

Please check the contents of the package. It should contain the following:

- RF Wireless Optical Mouse
- Receiver
- AC to DC adaptor
- DC to DC cable
- USB to DC cable
- Two AA Ni-MH rechargeable batteries (or Alkaline batteries)
- Mouse Driver (Disk or CD-ROM)
- Quick Installation Guide for RF Wireless Optical Mouse

Please contact your dealer if anything is missing or damaged.

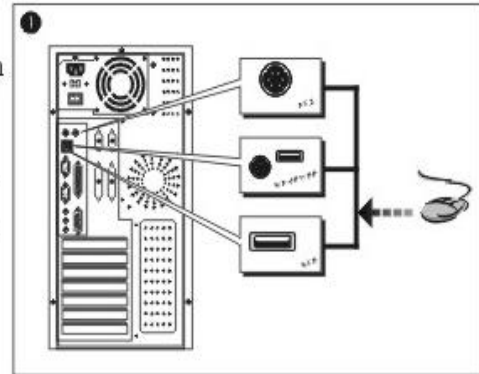

2. Hardware Installation (See illustration 1)

2-1. Installing a Mouse with Mouse Port (PS/2) Connector

If you have a mouse receiver with a round mouse port connector, you must turn off the computer before connecting or disconnecting your mouse.

2-2. Installing a USB Mouse

When you use a mouse with USB connector, you don't have to shut off the computer. Just plug the USB connector into the USB port.

2-3. Installing a Combo (USB→PS/2) Mouse

The Combo Mouse comes with a USB connector, together with a USB→PS/2 port adapter.

Before plug your mouse into the computer, make sure what kind of mouse port you have. If you have a USB port, plug in the original USB connector; if you have a PS/2 port, please first connect the adaptor to the cable, then plug into the PS/2 port.

2-4. Select a Suitable Channel (See illustration 2)

First, check how many channels of the mouse on the package or the channel switch. Open the mouse battery cover, then set channel switch to "1" or "2". There will be some interference when your nearby classmates or colleagues are using the same channel. Change to the other channel immediately when it happened. If your mouse is only one-channel type, just skip this section.

2-5. Linkage (See illustration 3)

Press ID Link Button (on the top of the Receiver), the LED light Green should blink slowly at this time. Press ID Link Button of Mouse, the LED light blinking should become quickly. If the Link is complete, the LED will stay in Light, but blinks when the mouse is moving.

3. Software Installation (See illustration 3 & 4)

Insert the disk or CD-ROM to download the driver. Please find and double click the **setup**.



Mouse software supports DOS, Windows 3.1, Windows 95, Windows 98, Windows NT 3.51, Windows NT 4.0, Windows 2000 and Windows ME.

Before installing any software under Windows NT 4.0, we strongly recommend you to create an Emergency Repair Disk using the Repair Disk utility provided by the system (RDISK.EXE).

Please note that USB mice are only supported under Windows 98, Windows 2000 and Windows ME.

4. Operation

After using the disk or CD-ROM to download the driver, there will an icon in the start bar. While double click the icon, a Mouse Control

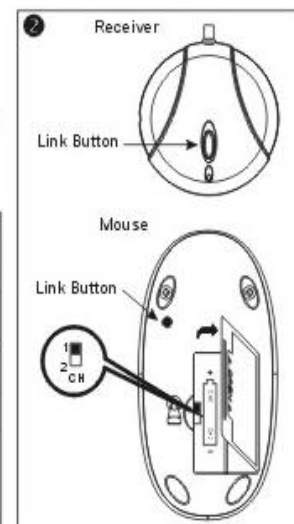
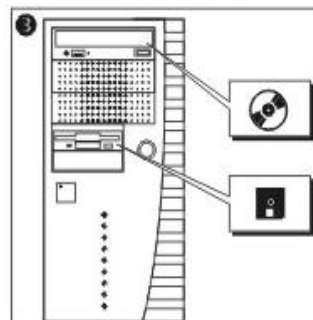

Panel window shows up. You can choose any function you like for programmable buttons.

- A. Mouse Control Panel  will show up in the start bar. Please double the icon.
- A. Wheel: (See illustration 5)
 - a. Wheel Mode: Choose system default (Intel - Mouse) mode or enhance scroll mode
 - b. Wheel Speed: Choose the speed of scrolling
- B. (Programmable)Buttons: (See illustration 6) Choose which function you like to be.

5. Charging

First check if your mouse is rechargeable type or not. Rechargeable type will use Ni-MH rechargeable batteries or Alkaline batteries. Non-rechargeable type will use only Alkaline batteries. Recommend to charge the mouse over 8 hours for first time using.

The following are 3 charge modes:

1. Power from receiver (See illustration 7-1) Connect receiver and mouse with DC plug cable
 2. Power from USB charger(See illustration 7-2) Connect USB port of PC and mouse with an USB charger
 3. Power from adaptor (See illustration 7-3)
- AC to DC adaptor plugs in the mouse

System Default	Up	Find File	Close	Wheel
F1- F10	Down	System Help	Application	Launch Default
Esc	Left	Middle Button	Double Click	Browser Launch
Backspace	Right	Minimize All	Maximize	Default E-mail
Enter	Undo	Windows	Window	I.E. Backward
Space	Redo	Run...	Minimize	Universal Scroll
Delete	Cut	Start Menu	Window	Auto Scroll
Page Up/Down	Copy	System Property	Drag Lock	Universal Zoom
Tab	Paste	Undo Minimize	Shift Lock	Connect to Internet
Home	Explorer	All Windows	Control Lock	
End	Find Computer	Control Panel	Horizontal	

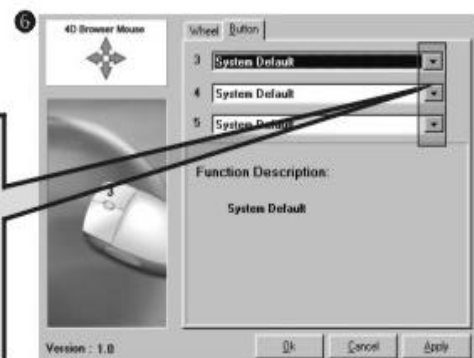
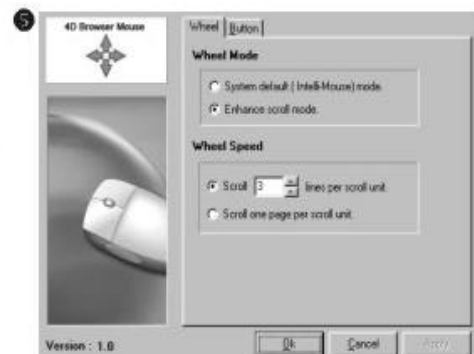

Notice:

1. The indicator on the rubber wheel should be light while moving the mouse. Please charge the mouse immediately.
2. While the mouse is in sleeping mode, please press any button or move the scroll wheel to wake up.
3. While charging the mouse, you can keep to work.
4. After charging 18 - 20 hours, you can use the mouse for 45 days.

