

6. Introduction of the Office Application Software: You can simply apply the Office application functions through the one-touch hot key on the top of the Office mouse. (Figure2)

Figure2

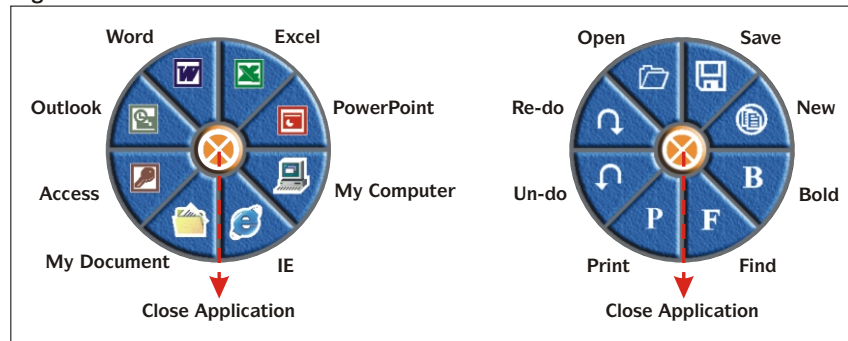

Uninstall Driver

Mouse Software can be removed from Windows by clicking the Add/Remove Programs icon in the Control Panel or clicking the "Uninstall" icon in the folder that "Setup.exe" created in "Programs" of "Start". Select Mouse Software installed and click the "Remove" button.

Notice

- The optical technology can precisely detect the mouse motion on most surfaces. Please avoid using the optical mouse on any reflective, transparent, metallic or complex-pattern surface.
- The LED indicator on the mouse will light while the mouse is low battery. Please change the batteries immediately.
- While not click the Office hot key, the Office pop-up window appears and there is no any reaction from the right button. Please eliminate the situation by repeatedly clicking the Office hot key.



Office Wireless Optical Mouse

Super Mini

User's Quick Guide

Office Wireless Optical Mouse Super Mini User's Quick Guide

Notice:

Federal Communications Commission (FCC) requirements, Part 15
This equipment has been tested and found to comply with the limits for a class B digital device, pursuant to part 15 of the FCC Rules. These limits are designed to provide reasonable protection against harmful interference in a residential installation.

This equipment generates, uses and can radiate radio frequency energy and, if not installed and used in accordance with the instructions, may cause harmful interference to radio communications. However, there is no guarantee that interference will not occur in a particular installation. If this equipment does cause harmful interference to radio or television reception, which can be determined by turning the equipment off and on, the user is encouraged to try to correct the interference by one or more of the following measures:

- Reorient or relocate the receiving antenna.
- Increase the separation between the equipment and receiver.
- Connect the equipment into an outlet on a circuit different from that to which the receiver is connected.
- Consult the dealer or an experienced radio/TV technician for help.

CAUTION: Any changes of modifications not expressly approved by the grantee of this device could void the user's authority to operate the equipment.

This device complies with Part 15 of the FCC Rules. Operation is subject to the following two conditions: (1) this device may not cause harmful interference, and (2) this device must accept any interference received, including interference that may cause undesired operation.

Congratulations on your purchase of this Office Wireless Optical Mouse. Please carefully read the User's Quick Guide to learn about the installation and the powerful functions of your new Office Wireless Optical Mouse.

Contents of the Package

- Super Mini Office Wireless Optical Mouse
- Mini Receiver (USB or UP Combo)
- Two AAA Batteries
- Office Mouse Driver CD-ROM
- User's Quick Guide

Install Hardware

Put the batteries into the battery case

1. Place your thumbs on the top of the mouse.
2. Press slightly and push out the top case. (Figure 1)
3. Insert the batteries and then close the top case.

Connect the Receiver to Your Computer

1. **USB Connector:** Plug the connector of the mini receiver into the USB port of the computer. (Figure 2)
2. **USB to PS/2 Connector:** Connect the USB to PS/2 connector to the mini receiver and then plug the connector to the PS/2 port of the computer. (Figure 3)

Link the Mouse with the Receiver

1. Turn on the computer. The LED indicator on the receiver

Figure 1



Figure 2

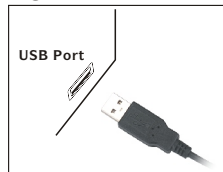

Figure 3



- will light. (Figure 4)
2. Press the ID Link Button at the bottom of the mini receiver and the LED indicator will blink. The receiver is ready to automatically link with the mouse. (Figure 4)
3. Press the ID Link Button on the back of the mouse. The indicator will stay in light while successfully finish the linkage. (Figure 5)
4. The LED indicator will blink while you move the mouse.
5. If you need to re-link the mouse or after changing the mouse batteries, please repeat the above linkage step 2~3.
6. If the mouse is interfered by other wireless-mouse users nearby, please change the Link ID by re-linkage immediately.
7. There are 256 Link IDs.
8. The LED indicator on the mouse will light while the mouse is low battery. Please change the batteries immediately. (Figure 6)
9. Press any button to wake up the mouse while the mouse is in the sleeping mode.

Figure 4



Figure 5



Figure 6



Install Driver

Notice:

- The driver supports Windows 98, Windows NT, Windows 2000, Windows ME and Windows XP.
- When you change the interface port, please reinstall the driver.

1. Insert the driver CD-ROM to your computer. The PC system may automatically install the driver through selecting the PC auto-install function.
2. If the PC system does not set the auto-install function, please double click the file "Setup.exe" and follow the setup instructions to complete the driver installation.
3. Restart the computer.
4. A Mouse Setting icon will appear on the task bar of Windows after you successfully finish the installation.
5. Double click the Mouse Setting icon and then follow the instructions of the selection items to set the mouse properties. (figure 7~8)

Figure 7

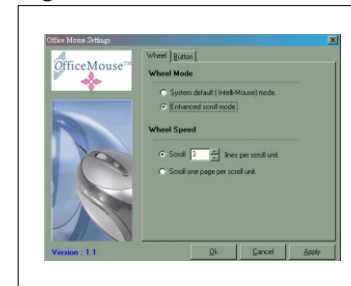

Figure 8

