

CHRIS KING®
PRECISION COMPONENTS

ISO XD Driveshell Addendum

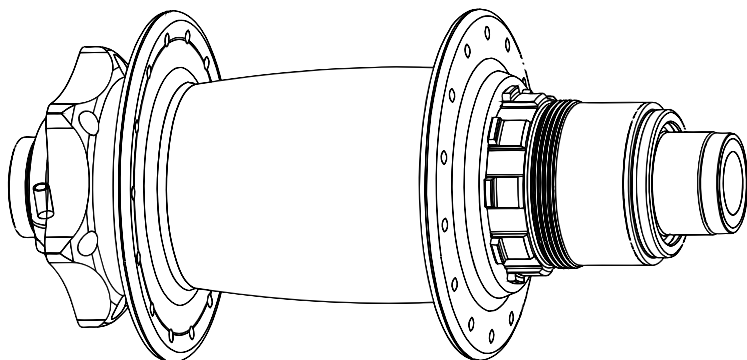

5 year warranty
register online
chrisking.com/warranty

Congratulations

You have just purchased an XD Driveshell for your Chris King ISO hubs. With proper care and maintenance you will enjoy many years of the legendary performance you have come to expect from all Chris King Precision Components. This addendum is a supplement to the Chris King ISO manual to give you the specific information needed for the setup and use of your new XD Driveshell.

Preparation

Chris King XD Driveshell are compatible with Chris King ISO Rear Hubs and Chris King ISO DH Rear Hubs. With the correct parts converting your existing hub is easy. Note, when converting your hub make sure that that Axle ID matches the XD Driveshell ID. See Figure 1 for identification locations.

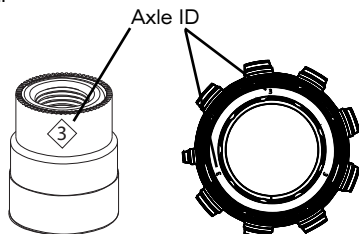

Figure 1

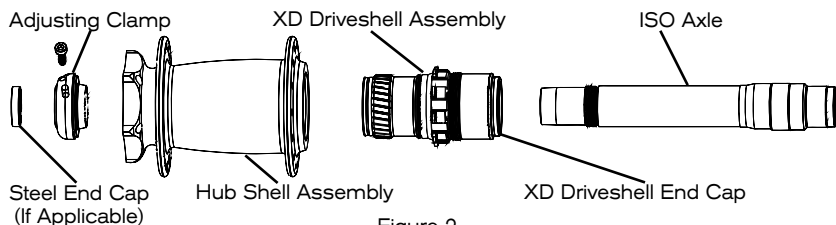

Figure 2

Disassembly of one piece axle on rear ISO XD Driveshell equipped hub (see Figure 2)

1. Remove cassette using a chain whip and HG™ cassette lock ring removal tool.
*If the XD Driveshell End Cap is removed along with the cassette use a small punch or small flat head screw driver to gently tap the Driveshell End Cap out of the cassette.
2. With Adjusting Clamp facing towards you, hold opposite end of axle stationary, loosen pinchbolt with a 2.5mm hex wrench and rotate clamp in a counter clockwise direction to unscrew it from the thru-axle. If Adjusting Clamp is difficult to remove, insert a 2.5mm hex key into the "helper hole" on the Adjusting Clamp adjacent to 2.5mm hex bolt. Use the hex key as a lever to unscrew Adjusting Clamp. Note: 142/157mm also axles feature a steel axle end cap that will pop off of axle end as Adjusting Clamp is pulled from axle.
3. Remove axle from hub by pushing the axle from the non-drive side.
4. Holding hub or wheel in your left hand, pull the driveshell while also rotating it

in a counter-clockwise direction away from the hub.

5. Hub shell bearings, RingDrive internals and driveshell bearing assemblies can now be accessed.

For RingDrive inspection and maintenance information, see “The RingDrive”, pg. 12 of the ISO Manual.

For bearing service, information see “Service of the bearings”, pg. 14 of the ISO Manual.

Further disassembly requires specialized tools. These come individually or in the Chris King Hub Service Tool Kit, which are available at any authorized Chris King dealer, or directly from Chris King Precision Components. Visit our website at http://chrisking.com/tools/tls_hubs for further information.

Reassembly of a one-piece axle on a rear ISO XD Driveshell equipped hub (see Figure 2)

1. Lightly grease threads on adjusting clamp. Apply two drops of lightweight, low viscosity oil, with PTFE (e.g. TriFlow™) to the axle O-ring and sleeve. If using QR adaptors or FunBolts, apply anti-seize to threads before threading them into the axle.
2. Apply two drops of lightweight, low viscosity oil, with PTFE (e.g. TriFlow™) to driveshell O-ring. Holding hub or wheel in your left hand, insert the driveshell into the hub shell; turn in a counter-clockwise motion so the driveshell will pull itself into the hub shell. Finish installation by pressing the driveshell into position. A distinctive click sound will indicate that the driveshell is firmly seated in the hub.
3. Insert a finger or a dental pick from the non-drive side to push on the spring retainer to ensure that the spring retainer is correctly seated on the driveshell.
4. Insert main axle, small end first into the driveshell. Continue until axle is through the hub and the large end is firmly seated in the driveshell.
5. Thread adjusting clamp onto the protruding threads of axle.
6. Snug the adjusting clamp up to the bearing. Once the hub is properly adjusted torque pinchbolt to 1.13Nm(10inch-pounds). Note: 142mm and 157mm axles feature a steel axle end cap that must be hand-pressed back onto the end of the axle.
7. Proceed to “Adjustment of one piece axle on rear ISO hub”, pg. 9 of ISO Manual.

To improve performance, the axles have been precisely matched with the needle bearings in the driveshell. Be sure to combine only like numbered parts, (e.g., #3 axle with #3 needle bearing race, See Figure 1).

Tech Note: Weights

- XD Driveshell Assembly Complete - 90 grams
- XD Driveshell Assembly Ceramic Complete - 88 grams
- XD Driveshell - 54 grams
- XD Driveshell End Cap - 8 grams

Limited Warranty

Chris King Precision Components warrants its products to be free from defects in materials or workmanship for the following periods from the original date of purchase:

Headsets: Ten (10) years

Hubs: Five (5) years

Bottom Brackets: Five (5) years

Wheels: The hubs only are warranted for a period of five (5) years. All other wheel components that are not manufactured by Chris King Precision Components such as, but without limitation, rims, spokes, and nipples, are not warranted by Chris King Precision Components.

Accessories: One (1) year

Soft Goods: Ninety (90) days

Any Chris King product that is found by Chris King Precision Components to be defective in materials or workmanship will be repaired or replaced at the discretion of Chris King Precision Components. This warranty does not cover damage or failure resulting from misuse, abuse, alteration, neglect, normal and reasonable wear and tear, crash or impact, failure to perform routine maintenance as instructed, improper installation, or use other than that for which the product was intended.

In order to make a warranty claim, the Chris King product alone (i.e., not including any other equipment such as cassettes, skewers, steering tubes, etc.), together with a copy of the original receipt showing the date of purchase of the product, must be returned to Chris King Precision Components at the address set forth on its website (www.chrisking.com) postage prepaid. If a defect is found, our entire liability and your sole remedy shall be, at our option, free repair or replacement of the Chris King product. Chris King Precision Components shall not be held liable for any indirect, special, punitive, or consequential damages. The warranty does not cover any Chris King Precision Components product where the serial number has been altered or removed.

To the fullest extent permitted by applicable law, this written express limited warranty is in lieu of all other warranties, implied or expressed, and does not cover any representation or warranty made by dealers beyond the provisions of this warranty. If any implied warranties exist by applicable law, such implied warranties shall be limited to the duration of the express limited warranty for the product. Some U.S. states and foreign countries provide rights in addition to those above or do not allow the exclusion or limitation of certain warranties or limitation of liability for certain types of damages. Therefore, the above limitations may not apply to you or there may be laws of a state or foreign country which supersede the above. Any clause of this limited warranty or any disclaimer or limitation of liability contained herein that is declared invalid shall be deemed severable and not affect the validity or enforceability of the remaining clauses.

You are strongly encouraged to register your Chris King product on the website within thirty (30) days of the original date of purchase. Registration will assist us in processing your warranty claim and in expediting our response.

All trademarks, registered trademarks, and logos are of their respective holders.

©King Cycle Group, 2014. All rights reserved.

Printed with soy ink. Contains 100% post consumer recycled paper fiber.



CHRIS KING PRECISION COMPONENTS

2801 NW Nela Street

Portland, OR 97210

phone: 800.523.6008

fax: 503.972.4051

www.chrisking.com

email: info@chrisking.com