

Wi-Fi Smart Adaptor Operating Instruction

Table of contents

I. Product Overview-----	2
II. Product Features-----	2
III. Mobile Client Software Installation-----	2,3
IV. Phone Wi-Fi Network Connection Settings-----	3
V. Adding Device-----	4,5,6,7
VI. Control Operation-----	7,8
VII. Modify Device Information-----	8,9,10
VIII. Timer Setting-----	10,11,12
IX. Countdown Setting-----	12,13,14
X. Restore Factory Settings-----	14
XI. Delete Device-----	14,15
XII. Technical Parameters-----	15
XIII. Failure Analysis-----	15
XIV.Cautions-----	15,16
XV. MPE Reminding-----	16,17
XVI.Region Selection-----	17
XVII.After-sales Service -----	17

I. Product Overview

Wi-Fi smart plug switch is a kind of power socket, via Wi-Fi wireless network to connect Internet, so as to control electric appliance. From anywhere with an Internet connection, via smart phone client-side, user can control the power on/off and the status display of the socket; meanwhile, client-side supports control of multiple sockets. Wi-Fi smart socket uses smart Config network technology, by simple network configuration, and also supports 10 groups of timer tasks and a group of countdown task. With these characteristics, users can locally or remotely control any appliances they want according to their own habits, such as electric water heater, drinking fountain, aquarium playing oxygen equipment, lights, to have wireless and intelligent life. As the appliances are not needed, they can be turned off conveniently by mobile phone, so as to save energy and make sure appliances are in the off state, to ensure safe use of electrical appliances.

II. Product Features

- ★ Support Wi-Fi Wireless Network
- ★ Support current status feedback, reporting current status back to client-side
- ★ Support smart Config network technology, with simple network operation
- ★ Supports 10 groups of timer tasks and a group of countdown task
- ★ Client-side can control 128 Wi-Fi sockets at most
- ★ Support multiple client-side controlling one Wi-Fi socket
- ★ Support local and remote wireless control

III. Mobile Client Software Installation

YD APP supports Android2.0 or later and IOS 6.0 or later versions of phone and table PC.

Method One: Use your phone which is equipped with two-dimensional code scanning capability software, scanning the two-dimensional IOS or Android code printed on the box, then the client installer can be downloaded.

Method Two: iPhone user enters APP Store and search "YD-SW1" to get the free client installer



Customers using Android phone enters Google Play or other APP stores and Search "YD-SW1" to get the free client program.



After successful installation, an icon will appear on the phone screen as follows (Figure 1):

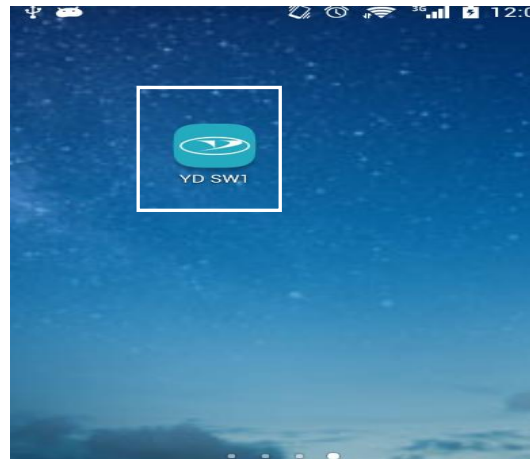

Figure 1

IV. Phone Wi-Fi Network Connection Settings

- Click the “Settings” button on the phone interface (Figure 2), select the “Wi-Fi” to click into wireless network setting, and set the “Wi-Fi” control switch as open (Figure 3), i.e. click household wireless router model "VM664034-2G" and enter the password to connect (Figure 4). Note: Do not connect the phone to the 5GHz WIFI router.
- Below for reference:



Figure 2

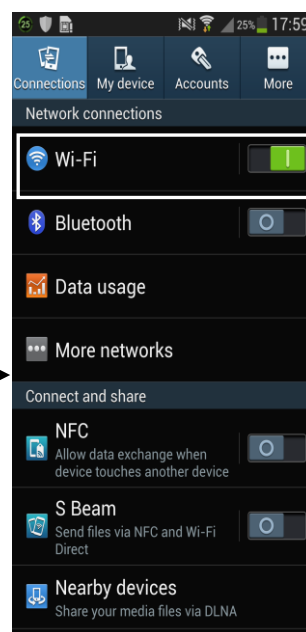

Figure 3

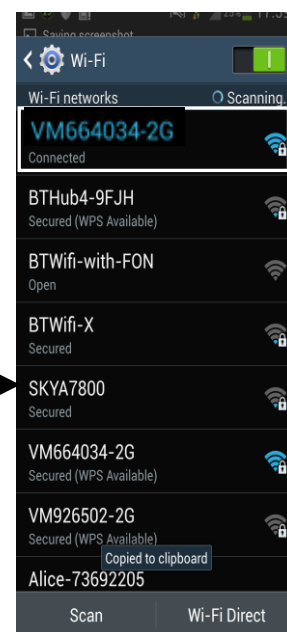

Figure 4

V. Adding Device

- The first time you need to configure the product, plug in the product, place the equipment on home Wi-Fi environment, make the phone connect to Wi-Fi (About how to connect the phone to Wi-Fi, it has been described in details above).
- After the product is powered on, the blue indicator in its front is on slow flashing mode. Long press the on-off button for more than 4s until the blue LED lights become quick flashing, which means on network configuration status. Loosen the button. At that moment the socket is under fast flashing status. (If there are no quick flash of the blue indicator, turn off the power, re-operate it according to the above method)

Note: Ordinarily ON/OFF button is used as manual switch. Press the power switch once, the power is on, so as the red indicators; press the button twice, the power is off, the red indicator dies out.

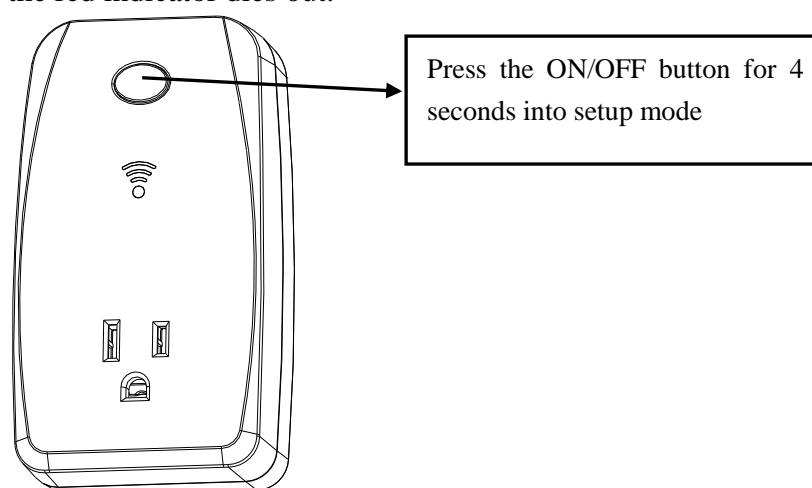

Figure 5

- Next, Start the “YD-SW1” software on phone interface. The Figure 6, Figure 7 and Figure 8 will appear when the first time starting the software (but it won’t appear later).



Figure 6

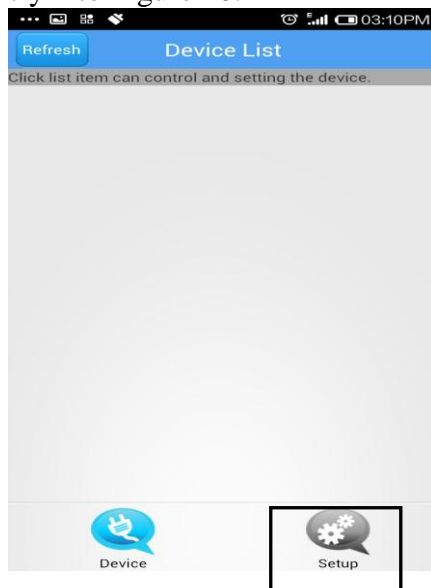

Figure 7

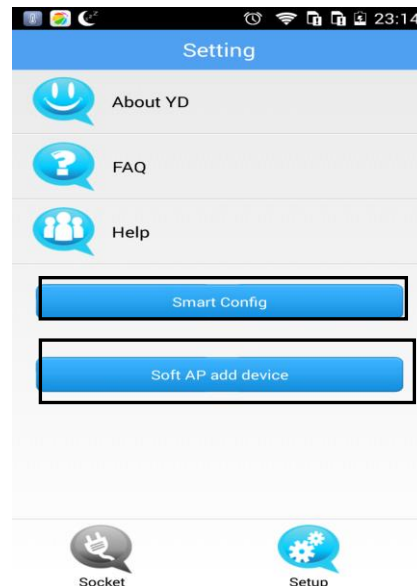

Figure 8

Click the “Action right now” button (Figure 8) to enter into the main interface (Figure 9). There is no devices list to be controlled for the first time using the software, so we need to add and configure controlled devices. Click “setup” button on Figure 9 to entry into Figure 10.



(Figure 9)



(Figure 10)

There are two methods:

Method 1:

Click the “Smart Config” button on Figure 10 for entering into Config page (Figure 11).

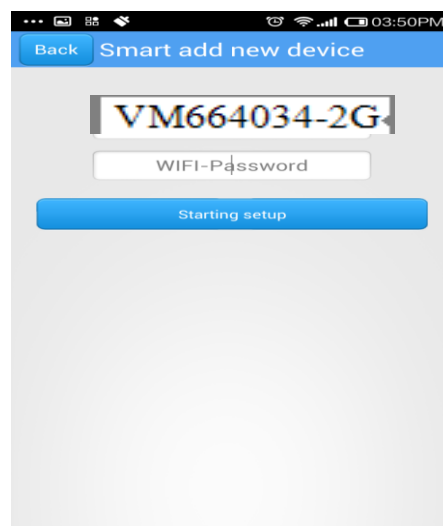

(Figure 11)

At this point the name of your wireless network has been automatically acquired, please enter the password for the wireless router you connected (i.e. I try to connect to the router network of my company, network SSID: VM664034-2G, password: 87654321). Click the "Starting setup" button on Figure 12 to conduct configuration. Note: Please set up your device in normal Wi-Fi signal environment (see Figure 13):

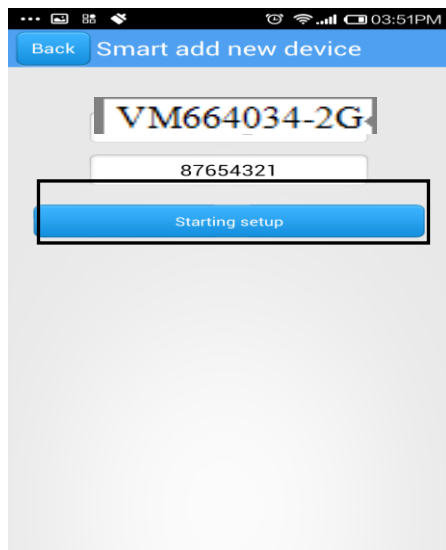

Figure 12

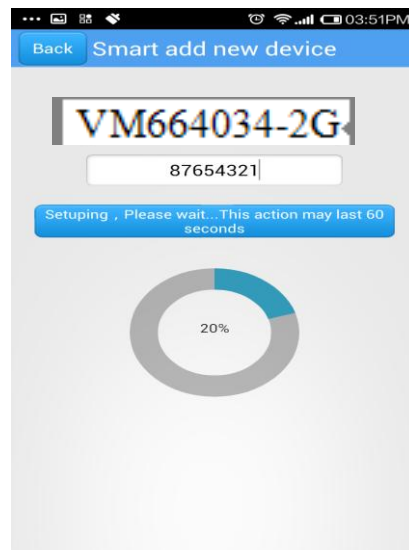

Figure 13

While configuring, the blue LED in front of the product will flash from fast to slow until the LED keeps lighting and "success" is prompted from the phone software to indicate the device is successfully added (Figure 14), which means the successful connection of socket to Wi- Fi router.

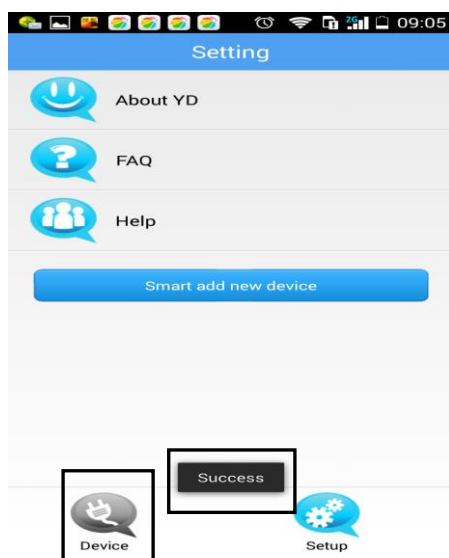

Figure 14

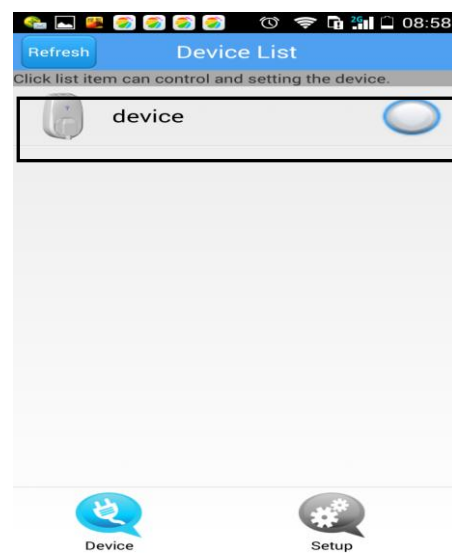

Figure 15

Click the “Device” button in Figure 14 to enter into Figure 15, by this time, the socket will be automatically added to the device list in the [Device] interface.

(Note that if the added device does not appear in the interface. Please click "Refresh" button to refresh.)

➤ **Method 2**

- Press and hold the Wi-Fi socket button, and release the button when seeing the blue lamp from quick flashing to slow flashing.
- Go to the “settings” of cellphone and “open the WLAN settings” and manually connect to GoWin.setup.

- Enter YD-SW1 software(the equipment cannot be controlled at this time when the equipment icon appears in the interface) equipment setting as Figure 10 and Click “Add device by soft AP mode” .
- Enter Figure A. If the wireless router used in your home is WM664034-2G, click the router and input the password to connect. After successful configuration, click OK button in Figure C for confirmation. This socket will be automatically added to the equipment list (please note that after successful configuration; please wait to control the equipment after the socket blue lamp is off.). Please press the refresh button if there is no “Refresh” button.

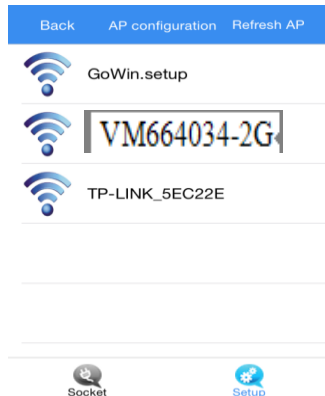

Figure (A)



Figure (B)

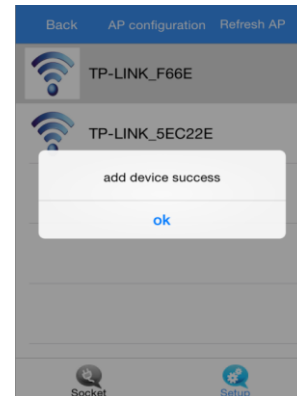

Figure (C)

Note: when the product is power on again within the same Wifi network, it needs no re-configuration because it will connect automatically. However, if you wants a reconfiguration, it is OK.

VI. Control Operation

Click the device you want to control on device list (see Figure 16), enter into the main control interface (see Figure 17), click on the power button, then the socket can be on or off controlled; meanwhile, the turning on or off sound can be heard. Power button "gray" indicates the power is off, while "blue" indicates that the power socket is switched on. At the same time the socket is on two-way communication. When the socket is manually turned on or off, the client will receive the current status feedback from the socket. That is to say, one can simply start the client in the phone anywhere at any time to check if one's appliance is currently in the on or off status.

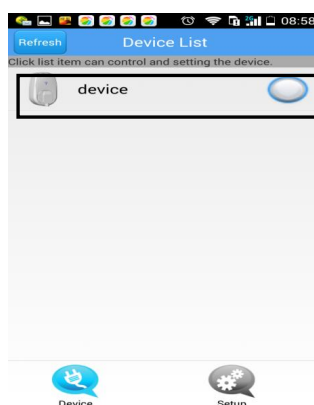

Figure 16



Figure 17

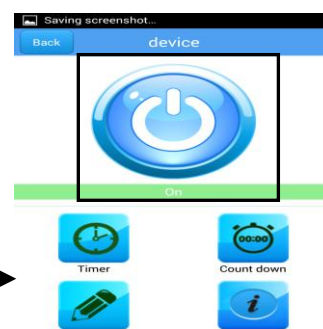

Figure 18

Remote Control: When you are not in the current socket Wi-Fi LAN, you can remote control them via GPRS, mobile 3G or other Wi-Fi networks (Just make sure your phone is connected to the Internet). The system automatically confirms whether you are local or remote. If remote, it will detect the remote control password at the first time clicking power button; after the password is confirmed, you can enter the control status. Note: When switching remote and LAN, one network may appear off, yet another on the network still connecting; the client will prompt the device is not online, this process may take dozens of seconds or one minute; at this moment you also can manually refresh and then you can enter the device online (if the network connection is OK).

Note: Due to Wi-Fi network is limited or protected in some places, Phone or table PC can connect Wi-Fi network to the Internet, but can not use it to remote control. In this situation, you can turn off Wi-Fi and control the device via mobile 3G/4G.

VII. Modify Device Information

- Enter into main control interface (see Figure 19), click “Edit” into device information modification page, and then click “device” to modify the device name (see Figure 20). For example, the socket is connected to heater, the device name can be changed to "Heater" and click "Done" button to confirm (see Figure 21). In this way, it is more convenient for you to clearly see the equipment you need to control from the device list, and to define the content as you like.

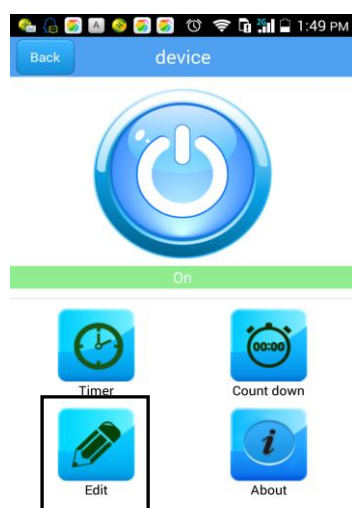

Figure 19



Figure 20



Figure 21

- You can also modify the device icon (see Figure 22). Click the icon place will pop up "take a photograph", "select shortcut icon" and "choose from album" dialog box, then select the electrical picture that the socket connected to, and

reflect the picture on the device list, which is more intuitive to reflect your socket control and the corresponding appliance, and more convenient for your operation.

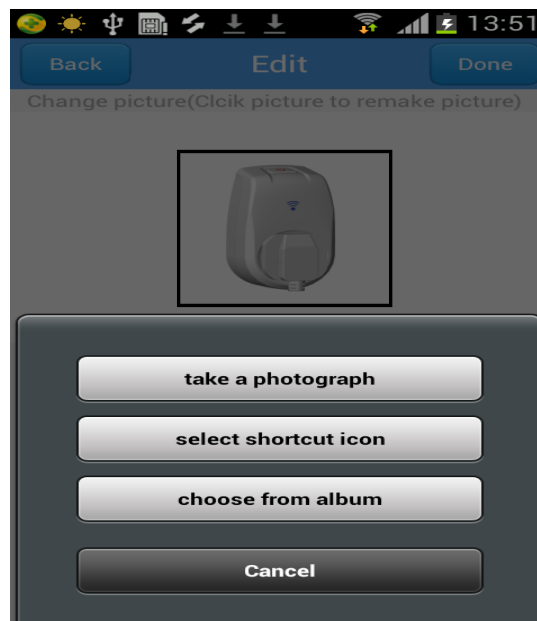

Figure 22

Also you can lock/unlock the device here. Click on the "Shape Lock" icon, then single click to lock and double click to unlock (see Figure 23, 24). Once locked, no one can search out the socket. Users who have added the socket can also control the device, only after unlocked, can those who never added the device search it within the local network; which ensures the concealment and security of your device. When you and those who you want them to control have added the device, you can enable this function (but delete the device from the list accidentally after you lock the setting, you can restore the factory settings, details see restored factory settings X below).
Note: suggest that do not use "lock function" when you use device normally

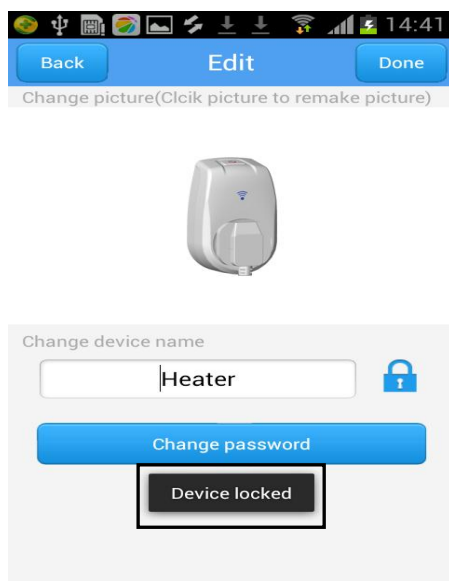

Figure 23

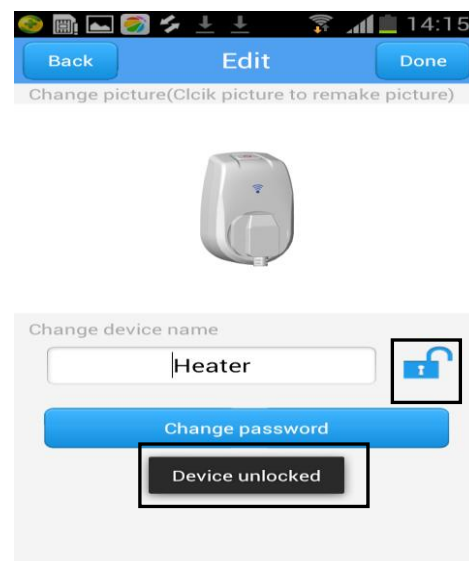

Figure 24

- Click "Change password" (see Figure 25), the remote password of the device can

be changed. Fill in the old and new password as requested (factory default remote password is 666666) (see Figure 26 & 27). After successful modification, other users whose remote password is different from the one you set cannot remotely control your appliances.

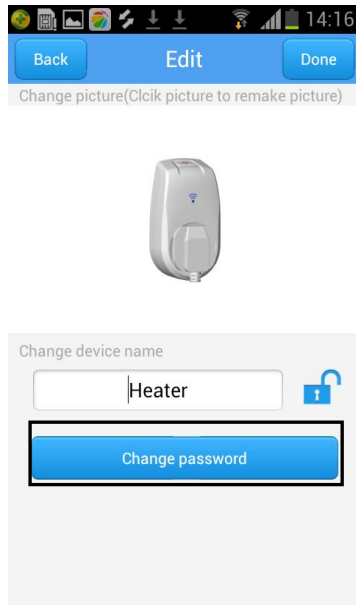

Figure 25

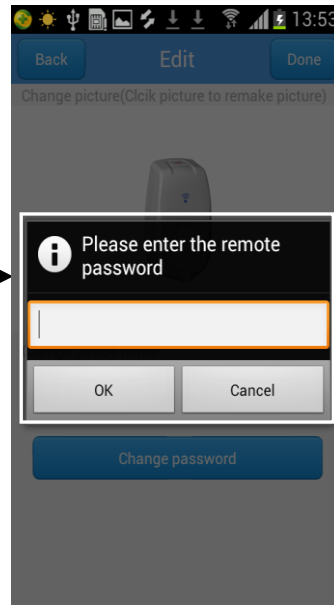

Figure 26

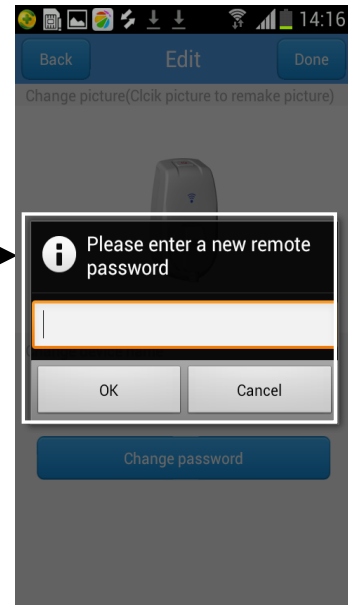

Figure 27

VIII. Timer Setting

- Enter into main control interface (see Figure 28), click “Timer” button into Figure 29, and then click “Add” to add timer task. Enter into Figure 30, click “Select Loop” button to select the timer circle, including Circle action every day, Circle action on week(specified one day or several days circle are allowed to choose), only action one time. For example, select “Only action one time” and click confirm button “Done” (see Figure 31), and then select timer working status (Timer ON/Timer OFF), and to select the time needed from the timer window, i.e. “Timer ON” is set as Figure 32 shown, select the time needed and click confirm button “OK”; “Timer OFF” is set as Figure 33 shown, select the time needed and click confirm button “OK”; See Figure 34 after setting Timer ON and Timer OFF, click “Done” button to save, corresponding timer information will be displayed on the timer list after successful settings (see Figure 35).

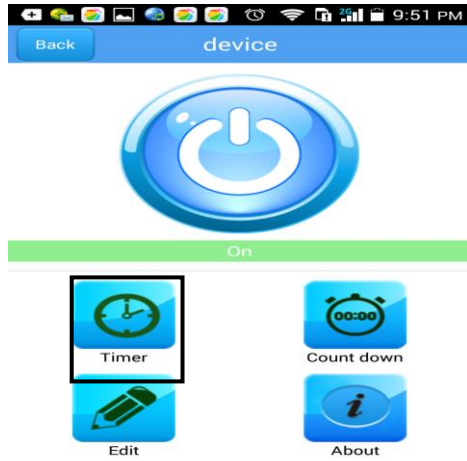

Figure 28

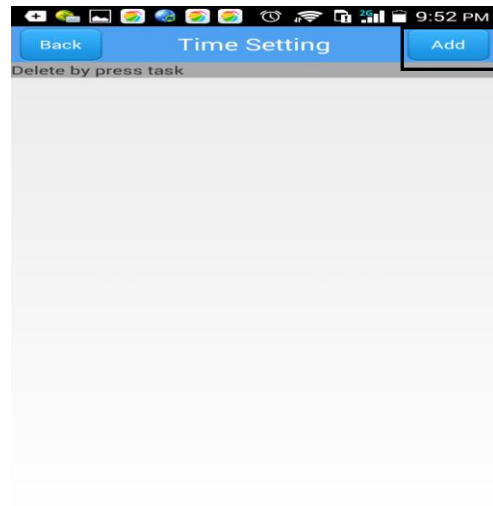

Figure 29

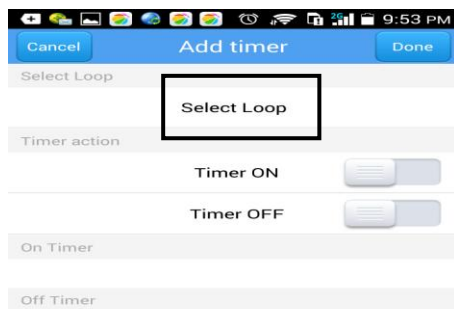

Figure 30

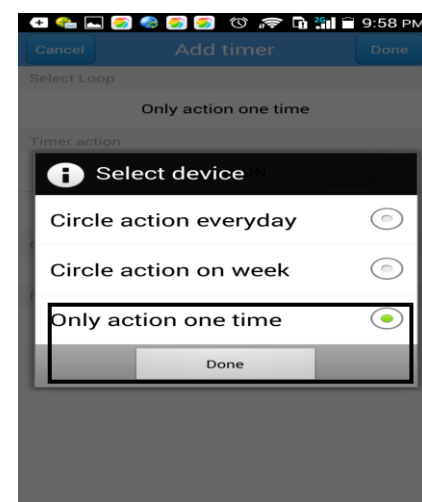

Figure 31

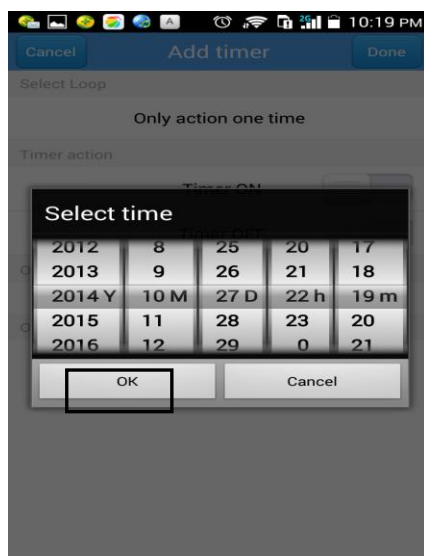

Figure 32

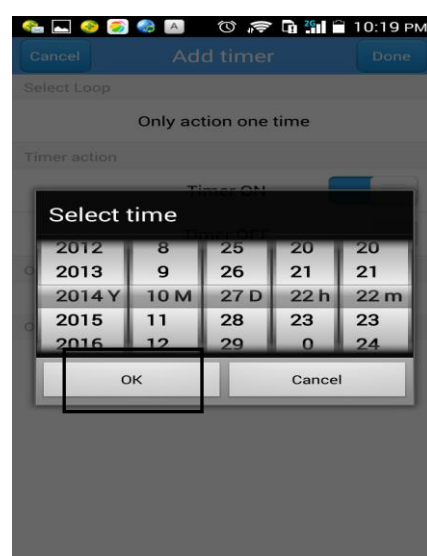

Figure 33

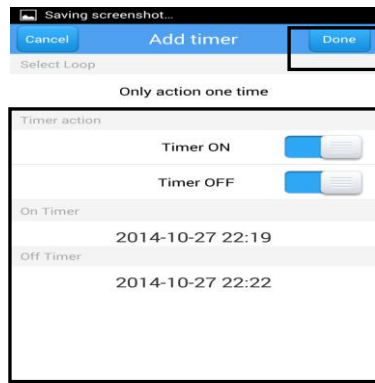

Figure 34

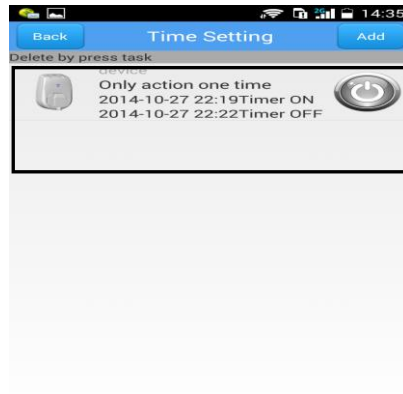

Figure 35

- Delete Timer Task (see Figure 36)



Figure 36

Select and long press the timer task, “Delete” pop up, and press “OK” to delete the timer task. If customer use iPhone operating system just slip to the left to delete countdown task.

- Note:**
1. Timer task must be set under local Wi-Fi (i.e. Wi-Fi that the socket connected to). Timer Task cannot be set remotely.
 2. After the task being set up in local, task will be executed no matter it is local, remote or mobile phone without any network.
 3. Timing error. Due to the deviation of the phone time and system cloud time, there will be tens of seconds or one minute time error, depending on the time difference of each user's phone.
 4. Each socket can set up 10 timed task groups.

IX. Countdown Setting

- Enter into main control interface (see Figure 37), click “Count down” button to enter Figure 38. Click “Add” button into countdown parameter setting interface (see Figure 39), and select countdown control status, on or off, then “Select Time” (Figure 40), including hour and second options, maximum countdown 23 hours 59 seconds and minimum 1 minute. For example, select “Count down timer ON”, then click “Setup timers” as 1 minute and click “OK” button (see Figure 41), and then click “Done” button into Figure 42. After successful setting, countdown information will be displayed on the countdown list and corresponding remaining countdown time information will be also displayed.



Figure 37

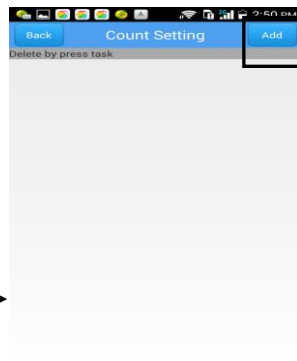

Figure 38

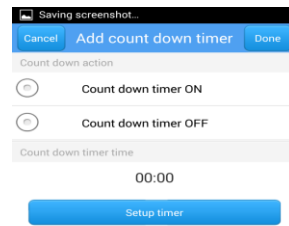

Figure 39



Figure 40

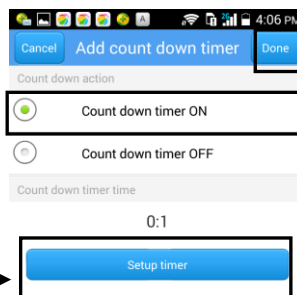

Figure 41

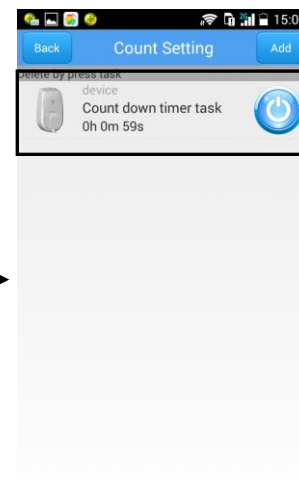

Figure 42

➤ Delete Countdown Task (see Figure 43)

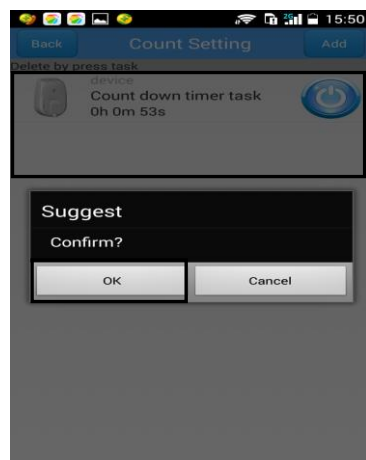

Figure 43

Select and long press the countdown, "Delete" pop up, and press button "OK" to delete the timer task. If you use Iphone operating system, just slip left to delete this devise.

- Note:**
1. Countdown task must be set under local Wi-Fi (i.e. Wi-Fi that the socket connected to). Countdown Task cannot be set remotely.
 2. After the task being set up in local, countdown will be executed no matter it is local or remote or mobile phone without any network.
 3. Timing error. Due to the deviation of the phone time and system cloud time, there will be tens of seconds or one minute timing error, depending on the time difference of each user's phone.
 4. Each socket can set up 1 countdown task groups. If another new countdown task needs to be set, one needs to delete the original countdown task.

X. Restore Factory Settings

- After the socket is powered on, long press button ON/OFF on the socket panel for around 8 seconds. At this moment the Blue LED in front of the socket will flash from the fast status to slow, which means have been successfully restored to the factory settings status. Loosen the button.(see Figure 44)

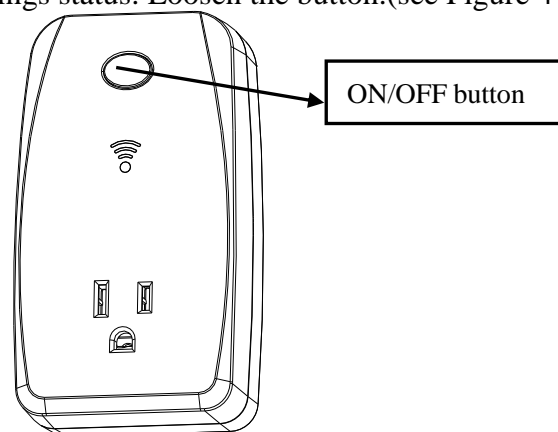

Figure 44

XI. Delete Device

Select the device needs to be deleted from the device list, long press the device, then click the “OK” button to delete the device on the popup window (see Figure 45).

If you use Iphone operating system,just slip left to delete this devise. (see Figure 46).

But since the socket with automatic search function, it will automatically search out the device from the list even after deleting the device, with original device information. Therefore, the device should be removed under the conditions that the device is offline or other client-side locks the socket; in this way, the device will not be searched out from the device list.

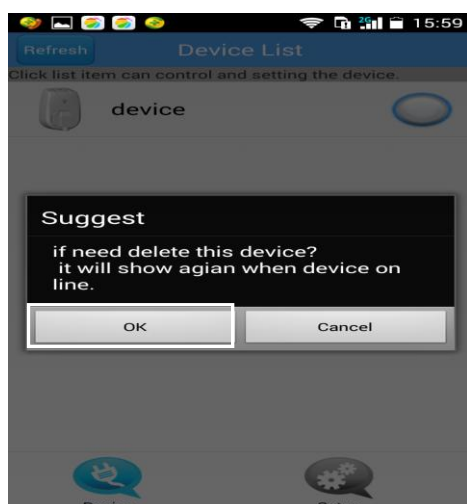

Figure 45

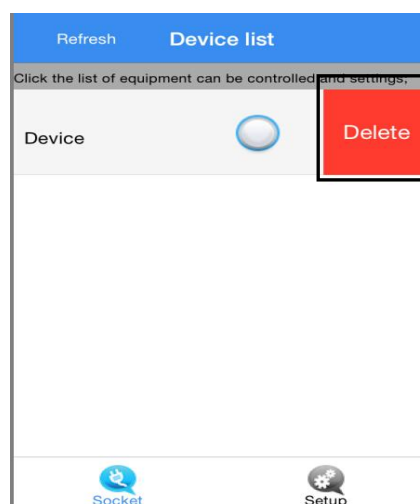

Figure 46

XII. Technical Parameters

Voltage:	125VAC, 60Hz
Max Load:	15 A, Resistive ,15A General purpose, 10A Tungsten,TV-5,1/2HP
WIFI Frequency :	2.4GHz
Communication Standard:	IEEE802.11b/g/n
Security Mechanism:	WEP/WPA-PSK/WPA2-PSK, TKIP
Communication range/distance:	using in the normal Wi-Fi signal environment
Product Type:	WFU-1
Software Version:	YD -SW1
Operating temperature	0 °C to +35 °C

XIII. Failure Analysis

1. Check if the power socket connection is normal
2. Check if the phone is connected to WIFI network
3. If the WIFI password input while configuring is correct
4. Refer to client-side [FAQ] for specific issues

XIV. Cautions

This device complies with Part 15 of the FCC Rules / Industry Canada licence-exempt RSS standard(s). Operation is subject to the following two conditions: (1) this device may not cause harmful interference, and (2) this device must accept any interference received, including interference that may cause undesired operation.

Le présent appareil est conforme aux CNR d'Industrie Canada applicables aux appareils radio exempts de licence. L'exploitation est autorisée aux deux conditions suivantes : (1) l'appareil ne doit pas produire de brouillage, et (2) l'utilisateur de l'appareil doit accepter tout brouillage radio électrique subi, même si le brouillage est

susceptible d'en compromettre le fonctionnement.

Changes or modifications not expressly approved by the party responsible for compliance could void the user's authority to operate the equipment.

This equipment has been tested and found to comply with the limits for a Class B digital device, pursuant to part 15 of the FCC Rules. These limits are designed to provide reasonable protection against harmful interference in a residential installation. This equipment generates uses and can radiate radio frequency energy and, if not installed and used in accordance with the instructions, may cause harmful interference to radio communications. However, there is no guarantee that interference will not occur in a particular installation. If this equipment does cause harmful interference to radio or television reception, which can be determined by turning the equipment off and on, the user is encouraged to try to correct the interference by one or more of the following measures:

- Reorient or relocate the receiving antenna.
- Increase the separation between the equipment and receiver.
- Connect the equipment into an outlet on a circuit different from that to which the receiver is connected.
- Consult the dealer or an experienced radio/TV technician for help.

Under Industry Canada regulations, this radio transmitter may only operate using an antenna of a type and maximum (or lesser) gain approved for the transmitter by Industry Canada. To reduce potential radio interference to other users, the antenna type and its gain should be so chosen that the equivalent isotropically radiated power (e.i.r.p.) is not more than that necessary for successful communication.

Conform ément à la réglementation d'Industrie Canada, le présent émetteur radio peut fonctionner avec une antenne d'un type et d'un gain maximal (ou inférieur) approuvé pour l'émetteur par Industrie Canada. Dans le but de réduire les risques de brouillage radio électrique à l'intention des autres utilisateurs, il faut choisir le type d'antenne et son gain de sorte que la puissance isotrope rayonnée équivalente (p.i.r.e.) ne dépasse pas l'intensité nécessaire à l'établissement d'une communication satisfaisante.

XV. MPE Reminding

To satisfy FCC / IC RF exposure requirements, a separation distance of 20 cm or more should be maintained between the antenna of this device and persons during device operation.

To ensure compliance, operations at closer than this distance is not recommended.

Les antennes installées doivent être situées de façon à ce que la population ne puisse

y être exposée à une distance de moins de 20 cm. Installer les antennes de façon à ce que le personnel ne puisse approcher à 20 cm ou moins de la position centrale de l'antenne.

La FCC des États-Unis stipule que cet appareil doit être en tout temps éloigné d'au moins 20 cm des personnes pendant son fonctionnement.

XVI. Region Selection

Limited by local law regulations, version for North America does not have region selection option.

XVII. After-sales Service

Please contact our company if there is any product failure that consumers cannot resolve. Contact



CIXI CITY YIDONG ELECTRONIC CO., LTD

Add: Guanhaiwei Industrial Zone, West Section, Cixi Ningbo, P. R. China

Tel: +86-574-63631599 63630759

Fax: +86-574-63630188

E-mail: cxyidong@cn-yidong.com

Web: www.cn-yidong.com

For safety, always switch off your appliances before connecting.

For indoor use only.

Whenever you change a wifi network, reconnection is required.

Do not plug in and out the device continually. Always wait for an interval of 10 seconds

For Pluggable equipment, the socket-outlet shall be installed near the equipment and shall be easily accessible.

To disconnect Voltage pull the plug.

Do not connect after each other

Only used in dry place