

Step 3 – Install and charge battery

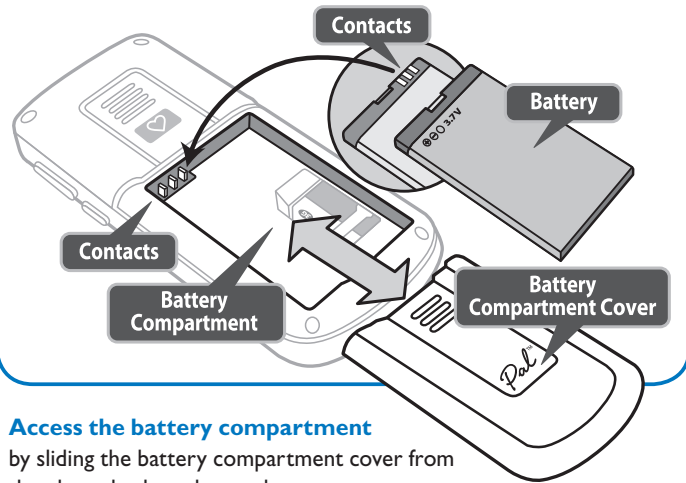

Access the battery compartment

by sliding the battery compartment cover from the phone back as shown above.

Install the battery by ensuring that the contacts on the battery and battery compartment are engaged. Replace the battery compartment cover as shown above. Make sure that it snaps securely into place.

Start the battery charging process by inserting the “plug-tip” of the AC Power cord into the charging port (11) of the phone. Plug the AC Power Adapter into a 110V electrical outlet. Charging time is approximately 2-3 hours.

The battery indication on the phone LCD will begin to “blink.” If the phone is powered off, the LCD will display “charging.”

When charging is complete the battery indicator will stop “blinking.”

Step 4 – Make/Receive Calls

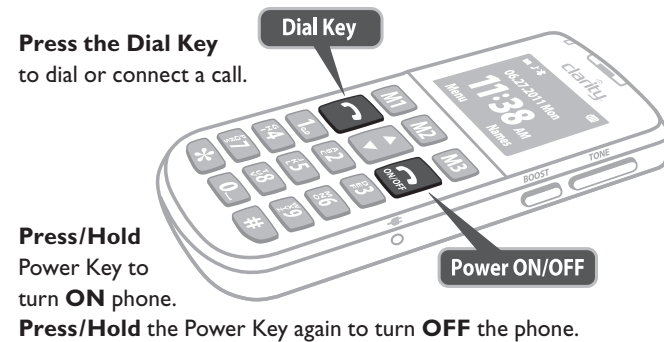

Press the Dial Key to dial or connect a call.

Press/Hold Power Key to turn **ON** phone.

Press/Hold the Power Key again to turn **OFF** the phone.

Make a call

Three methods for making a call.

- 1) **Phonebook** – Find the number you want to dial, and press **Dial Key**.
- 2) **Call Register** – Enter the list of missed calls, received calls or dialed calls, and then choose the number, and press Dial Key.
- 3) **Manual** – In idle mode, input the number by pressing the numeric keys, then press the Dial Key.

Receive a call

On incoming calls, the ring will be a sound, or the phone will vibrate.

Press the **Dial Key** to answer, or press **Reject** (M3 key) to refuse the call.

You can also receive the call by selecting “Option” (M1 key), or by pressing the “Dial” key.

Menu Navigation

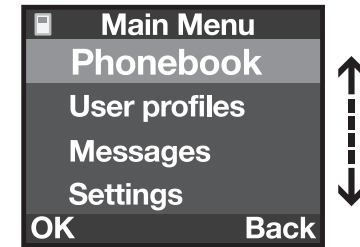

Select menu options (OK, Back, etc.) by pressing the **M1** or **M3** Memory Keys.



Scroll through the menu listings by pressing the **UP/DOWN** Arrow Key.



Clarity, a Division of Plantronics, Inc.
6131 Preservation Drive, Chattanooga, TN 37416

CONTACT Tel: 800-426-3738 Fax: 800-325-8871
E-mail: claritycs@plantronics.com
Website: ClarityProducts.com

©2011 Clarity, a Division of Plantronics, Inc. All Rights Reserved.
Clarity, Clarity Pal, and Smart for Seniors are trademarks or registered trademarks of Plantronics, Inc.

Printed in China

Quick Setup Guide

Smart for Seniors™

Clarity Pal™ Amplified Mobile Phone



clarity® ClarityProducts.com

Thanks for choosing the Clarity Pal™ mobile phone

*More than just a mobile phone, this is mobile peace of mind. The Clarity Pal™ mobile phone gives you the freedom to stay connected with the ones you love, and know that help is available wherever you go.**

- Designed especially for seniors on-the-go. Only 5 inches in length and one-half inch in thickness. Easily fits in your pocket or purse.
- Clarity Power™ technology amplifies sound up to 40 decibels and is Hearing Aid compatible.
- Full-keypad features large buttons for viewing and easy dialing.
- Prominently located Emergency Button for quick access.
- See User's Manual at ClarityProducts.com/Pal for more features.

*Requires cell phone service.

Contents

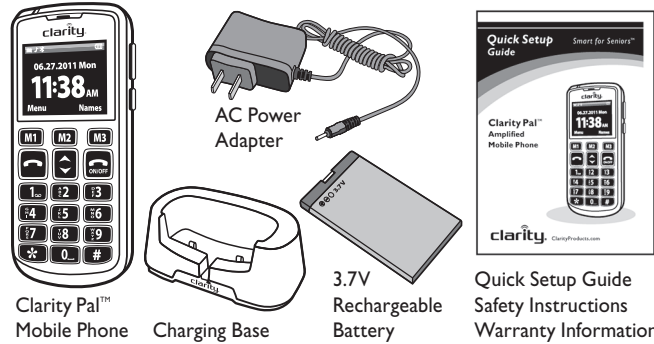

Step 1 – Review Basic Phone Features

- 1 Volume Adjust Button
- 2 Headset Port
- 3 **M1*** Memory Key – Long-press/Memory (Short-press key to access and select menu options.)
- 4 **M2** Memory Key
- 5 **M3*** Memory Key – Long-press/Memory (Short-press key to access and select menu options.)
- 6 Dial Key (Press to connect call)
- 7 ON/OFF Key (Long-press to Power ON/OFF)
- 8 Arrow Key (Menu Scroll)
- 9 TONE Button
- 10 BOOST Button (Amplify)
- 11 AC Power (Charging Port)
- 12 Emergency Button (Located on back of phone)
- 13 Phone Status Icons
- 14 AC Power Adapter

Important: Before using phone, please read Safety Instructions.

Additional information is available online at: ClarityProducts.com/Pal

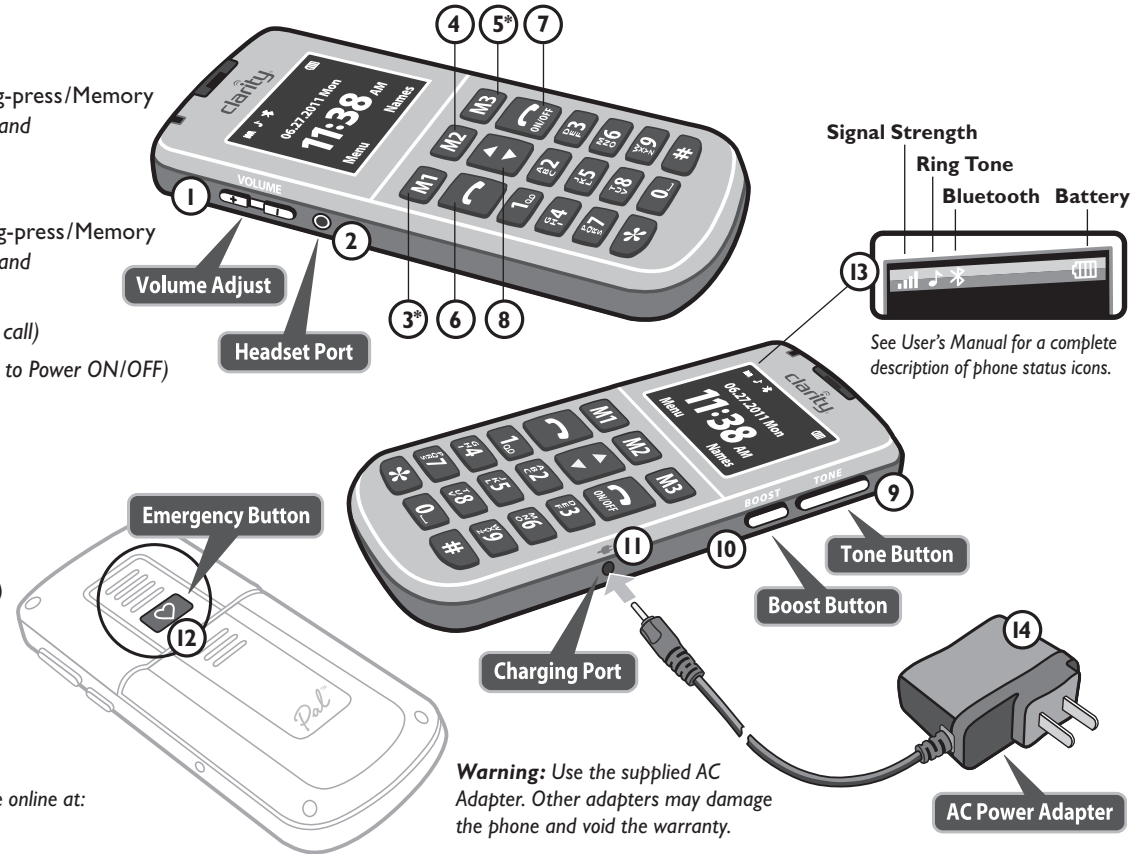

Step 2 – Install SIM card

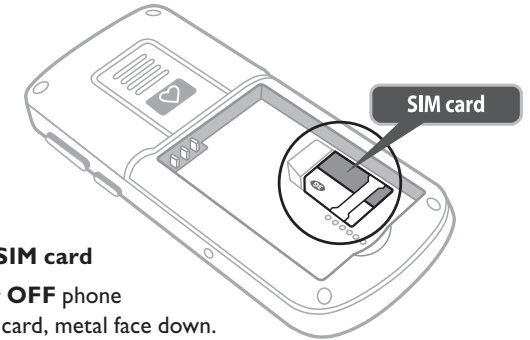

Install SIM card

- Power **OFF** phone
- Insert card, metal face down.

Warning: Do not remove SIM card while phone is charging, or connected to AC power.

Install SIM card and connect to a network

A network provider (of your choice) will provide you with a SIM card that is key for entering the GSM network and their particular network.

First install the SIM card, then battery. (See STEP 3 for battery installation instructions.) Once SIM card and battery are installed, power-on the phone. The phone will begin searching for a registered network, or other available networks. Once connected, the name of network supplier will show on the LCD.

If the LCD prompts **“Emergency Call Only”**, it means you are out of the network service area. However, you may still make emergency calls according to signal strength.

FCC REQUIREMENTS AND REGULATIONS

CAUTION: Changes or modifications to this equipment not expressly approved by the party responsible for compliance could void the user's authority to operate the equipment.

Privacy of communications may not be ensured when using this phone.

CAUTION: To maintain the compliance with the FCC's (RF) exposure guideline, place the base unit at least 20cm from nearby persons.

For body worn operation, this handset has been tested and meets the FCC (RF) exposure guidelines when used with the (Clarity) accessories supplied or designated for this product. Use of other accessories may not ensure compliance with FCC (RF) exposure guidelines.

Industry Canada Technical Specifications

This product meets the applicable Industry Canada technical specifications.

Before installing this equipment, users should ensure that it is permissible to be connected to the facilities of the local telecommunications company. The equipment must also be installed using an acceptable method of connection. In some cases, the company's inside wiring associated with a single line individual service may be extended by means of a certified connector assembly (telephone extension cord). The customer should be aware that compliance with the above conditions may not prevent degradation of service in some situations. Repairs to certified equipment should be made by an authorized Canadian maintenance facility designated by the supplier.

Any repairs or alterations made by the user to this equipment, or equipment malfunctions, may give the telecommunications company cause to request the user to disconnect the equipment.

FCC REQUIREMENTS AND REGULATIONS

Users should ensure for their own protection that the electrical ground connections of the power utility, telephone lines and internal metallic water pipe system, if present, are connected together. This precaution may be particularly important in rural areas.

CAUTION: Users should not attempt to make such connections themselves, but should contact the appropriate electrical inspection authority, or electrician, as appropriate.

The Ringer Equivalence Number is an indication of the maximum number of terminals allowed to be connected to a telephone interface. The termination on an interface may consist of any combination of devices subject only to the requirement that the sum of the Ringer Equivalence Numbers of all the devices does not exceed five.

(The term "IC:" before the certification/registration number only signifies that the Industry Canada technical specifications were met.)

This Class B digital apparatus complies with Canadian ICES-003.

The party responsible for regulatory compliance:

Clarity, a Division of Plantronics, Inc.
6131 Preservation Drive
Chattanooga, TN 37416
Phone: 1-800-552-3368

clarity

Clarity, a Division of Plantronics, Inc.
6131 Preservation Drive, Chattanooga, TN 37416

CONTACT Tel: 800-426-3738 Fax: 800-325-8871
E-mail: claritycs@plantronics.com
Website: ClarityProducts.com

©2011 Clarity, a Division of Plantronics, Inc. All Rights Reserved.
Clarity, Clarity Pal, and Smart for Seniors are trademarks or registered trademarks of Plantronics, Inc.
Printed in China

Warranty
Service/FCC Regulations

Smart for Seniors™

Clarity Pal™
Amplified
Mobile Phone



clarity® ClarityProducts.com

WARRANTY AND SERVICE

The following warranty and service information applies only to products purchased and used in the U.S. and Canada. For warranty information in other countries, please contact your local retailer or distributor.

Limited Warranty

Clarity, a division of Plantronics, Inc. ("Clarity") warrants to the original consumer purchaser that, except for limitations and exclusions set forth below, this product shall be free from defects in materials and workmanship for a period of one (1) year from the date of original purchase ("Warranty Period"). The obligation of Clarity under this warranty shall be at Clarity's option, without charge, of any part or unit that proves to be defective in material or workmanship during the Warranty Period.

Exclusions from Warranty

This warranty applies only to defects in factory materials and factory workmanship. Any condition caused by accident, abuse, misuse or improper operation, violation of instructions furnished by Clarity, destruction or alteration, improper electrical voltages or currents, or repair or maintenance attempted by anyone other than Clarity or an authorized service center, is not a defect covered by this warranty.

Implied Warranties

Under state law, you may be entitled to the benefit of certain implied warranties. These implied warranties will continue in force only during the warranty period. Some states do allow limitations on how long an implied warranty lasts, so the above limitation may not apply to you.

WARRANTY AND SERVICE

Incidental or Consequential Damages

Neither Clarity nor your retail dealer or selling distributors has any responsibility for any incidental or consequential damages including without limitation, commercial loss or profit, or for any incidental expenses, loss of time, or inconvenience. Some states do not allow exclusion or limitation of incidental or consequential damage, so the above limitation or exclusion may not apply to you.

Other Legal Rights

This warranty gives you specific legal rights and you may also have other rights which vary from state to state.

How to Obtain Warranty Service

Before returning a product, please call or contact a Clarity Service Center.

All product returns must be prepaid. Use the appropriate Service Center address as follows:

In the United States
Clarity Service Center
6131 Preservation Drive
Chattanooga, TN 37416

Tel: (423) 622-7793 or
(800) 426-3738
Fax: (423) 622-7646 or
(800) 325-8871

In Canada
Plantronics Service Center
151 Hymus Blvd.
Pointe Claire
Quebec, Canada H9R 1E9

Tel: (800) 540-8363
(514) 956-8363
Fax: (514) 956-1825

WARRANTY AND SERVICE

Please use the original container, or pack the unit(s) in a sturdy carton with sufficient packing material to prevent damage.

Include the following information:

1. A proof-of-purchase indicating model number and date of purchase.
2. Bill-to address.
3. Ship-to address.
4. Number and description of units shipped.
5. Name and telephone number of person to call, should contact be necessary.
6. Reason for return and description of the problem.

Damage occurring during shipment is deemed the responsibility of the carrier, and claims should be made directly with the carrier.

FCC REQUIREMENTS AND REGULATIONS

Part 15 of FCC Rules Information

This device complies with Part 15 of the FCC Rules. Operation is subject to the following two conditions: (1) This device may not cause harmful interference, and (2) this device must accept any interference received, including interference that may cause undesired operation.

Your equipment has been tested and found to comply with the limits of a Class B digital device, pursuant to Part 15 of FCC rules. These limits are designed to provide reasonable protection against harmful interference in residential installation.

This equipment generates, uses and can radiate radio frequency energy and, if not installed and used in accordance with the instructions, may cause harmful interference to radio communications. However, there is no guarantee that interference will not occur in a particular installation.

If this equipment does cause harmful interference to radio or television reception, which can be determined by turning the equipment off and on — you are encouraged to try to correct the interference by one of the following measures:

1. Where it can be done safely, reorient the receiving television or radio antenna.
2. To the extent possible, relocate the television, radio or other receiver with respect to the telephone equipment. *(This increases the separation between the telephone equipment and the receiver.)*
3. Connect the telephone equipment into an outlet on a circuit different from that to which the television, radio, or other receiver is connected.
4. Consult the dealer or an experienced Radio/TV technician for help.

IMPORTANT SAFETY INSTRUCTIONS

Removable Battery

This phone contains a removable battery pack. Change the battery pack only as directed in the User Manual.

- Always store batteries where children cannot reach them.
- Remove a spent battery promptly. When replacing the battery, use only the battery provided by Clarity.
- Do not allow any battery or its holder to contact metal objects such as keys or coins.

MAINTENANCE AND CARE

This phone is not customer serviceable. Do not attempt to repair or modify the phone. Doing so may result in injury or void your warranty.

Product Cleaning

Use only a slightly damp lint-free cloth to clean the phone. Use of household cleaners, alcohol, or other chemicals may damage your mobile phone.

Handling the Phone

Do not drop, disassemble, open, crush, bend, deform, puncture,

shred, microwave, incinerate, paint, or insert foreign objects into the phone.

Discontinue use of your phone and contact Clarity at **1-800-426-3738** if the product overheats, has a damaged cord or plug, or if the product has been damaged.

Connecting Accessories

Do not force connectors into ports. In case of experiencing unreasonable resistance when attempting to insert a connector in a port, check for compatibility, obstruction in the port, or a disfigured connector.

Do not insert anything into the phone other than as directed in the user manual because this may cause damage to the internal components or cause injury to you.

USE ENVIRONMENT

Avoiding Water and Wet Locations

Do not use the phone in rain, or near washbasins or other wet locations. Take care not to spill any food or liquid on the phone. In case the phone gets wet, unplug

IMPORTANT SAFETY INSTRUCTIONS

all cables, turn off the phone before cleaning, and allow it to dry thoroughly before turning it on again. Do not attempt to dry the phone with an external heat source, such as a microwave oven or hair dryer.

Choking Hazard

Never allow children to play with the phone or accessories — small parts may be a choking hazard.

LISTENING LEVEL WARNINGS

Exposure to high volume sound levels may damage your hearing. Although there is no single volume setting that is appropriate for everyone, you should always use your mobile phone with the volume set at moderate levels and avoid prolonged exposure to high volume sound levels. The louder the volume, the less time is required before your hearing could be affected. You may experience different sound levels when using your headset or headphones with different devices. The device you use and its settings affect the level of sound you hear. If you experience hearing discomfort, you should stop listening to the device

through your headset or headphones. To protect your hearing, some hearing experts suggest that you:

1. Set the volume control in a low position before putting the headset or headphones on your ears.
2. Limit the amount of time you use headsets or headphones at high volume.
3. Avoid turning up the volume to block out noisy surroundings.
4. Turn the volume down if the sound from the headset or headphones prevents you from hearing people speaking near you.

Visit www.plantronics.com/healthandsafety for more information on headsets and hearing.

Exposure to Electromagnetic Energy in the Radio Frequency Band

When turned on, this device transmits and receives electromagnetic radiation in the radio frequency (RF) bandwidth through its antenna. By international scientific agreement, the unit of measurement of (RF) energy is the "specific absorption rate," or SAR. In the

IMPORTANT SAFETY INSTRUCTIONS

United States, the applicable SAR limit for this phone, set by the FCC is 1.60 mW/g (thousandths of watts per gram of mass), or 1.60 W/Kg (watts per kilogram of mass). The maximum SAR exposure measured for this phone was 0.738 W/Kg when the phone was turned on but not in use (body position), and 0.264 W/Kg when the phone

was in use (cheek position). In all cases, the phone was passed by an independent testing facility.

Disposal and Recycling

Check and follow local laws regarding disposal and recycling of your phone and battery.



Clarity, a Division of Plantronics, Inc.
6131 Preservation Drive, Chattanooga, TN 37416

CONTACT Tel: 800-426-3738 Fax: 800-325-8871
E-mail: claritycs@plantronics.com
Website: ClarityProducts.com

©2011 Clarity, a Division of Plantronics, Inc. All Rights Reserved.
Clarity, Clarity Pal, and Smart for Seniors are trademarks or registered trademarks of Plantronics, Inc.
Printed in China

Safety Instructions

Smart for Seniors™

Clarity Pal™ Amplified Mobile Phone



 ClarityProducts.com

IMPORTANT SAFETY INSTRUCTIONS

Please read the following safety instructions before using your Clarity Pal™ Dual Band Mobile Phone and accessories. Please keep these instructions for your reference. When using this product, these safety precautions and warnings should be followed to reduce the risk of fire, electric shock, injury to persons and damage to property. Additional warnings may be present on the product, packaging, or in the user instructions.

WARNINGS

Emergency Call Feature

When the emergency button is pressed the emergency numbers saved in the phone's address book will be called in the order you have selected until a party is reached. Up to five emergency numbers may be saved in the address book. The numbers and the order they will be called must be entered into the phone in order to ensure the desired numbers are dialed when the emergency button is pressed. After you have entered your five emergency numbers, you should test the phone's emergency call feature by pressing the emergency button to ensure that you have correctly entered the numbers into the phone.

Since the phone service must be purchased in advance through

monthly pre-paid credits, you must ensure that you have made your pre-payment in order for the phone service to remain activated. If you do not make your monthly pre-payment or if you do not make a full monthly payment, you will lose your phone service, and the phone and the emergency call feature will not be available.

You must also ensure that the phone's battery is fully-charged at all times and that the phone is in good working condition in order for the emergency call feature to work.

If the phone is outside of a coverage area, if network service is temporarily suspended by the network carrier, or if there is network or phone interference, the emergency call feature will not be available during those times.

IMPORTANT SAFETY INSTRUCTIONS

This phone is not equipped with a global positioning service or other means to determine the physical location of the phone. Consequently, if an emergency situation arises but you are unable to provide your location to an emergency contact person in your address book, neither they nor an emergency response service may be able to locate you.

The SIM card must be installed and activated before you will receive any phone service. If the SIM card is damaged or replaced, the emergency contact numbers you entered into the phone will be lost. In that case you must re-enter your five emergency contact numbers into the phone's address book in order to restore the emergency call feature.

After you have re-entered your five emergency numbers, you should test the phone's emergency call feature by pressing the emergency button to ensure that you have correctly entered the numbers into the phone.

RADIO FREQUENCY INTERFERENCE

Pacemakers

The Health Industry Manufacturers Association recommends that a minimum separation of (6) inches be maintained between a handheld wireless phone and a pacemaker to avoid potential interference with the pacemaker. Persons with pacemakers:

- Should always keep the phone more than (6) inches from their pacemaker when the phone is turned on.
- Should not carry the phone in a breast pocket.
- Should use the ear opposite the pacemaker to minimize the potential for interference.

If you have any reason to suspect that interference is taking place, turn the phone off immediately.

Hearing Aids

The phone may interfere with some hearing aids. If it does, consult the hearing aid manufacturer or your physician for alternatives or remedies.

IMPORTANT SAFETY INSTRUCTIONS

Other Medical Devices

If you use any other personal medical device, consult the device manufacturer or your physician to determine if it is adequately shielded from external (RF) energy.

COMPLIANCE WITH MOBILE PHONE USE RESTRICTIONS

Air Travel

Mobile phone use may be prohibited during air travel.

Posted Signs

Obey posted signs or notices prohibiting mobile phone use in certain locations, including but not limited to blasting areas, health care facilities and aircraft.

Health Care Facilities

Turn the phone off in health care facilities when any regulations posted in these areas instruct you to do so. Hospitals and health care facilities may use equipment that is sensitive to external (RF) energy.

Driving Safely

Check and follow local laws and regulations regarding use of a mobile phone while driving.

If you decide to use a mobile phone while driving a vehicle, give your full attention to driving safely and keep the following driving tips in mind:

- Be responsible behind the wheel. Don't Text and Drive!
- Get to know your wireless device and its features such as speed dial and redial.
- Position your wireless device within easy reach.
- Dial sensibly and assess the traffic. Place calls when you are not moving.
- Let the person you are speaking with know you are driving. If necessary suspend the call in heavy traffic or hazardous weather conditions.
- Do not take notes or look up phone numbers while driving.
- Use a hands-free device for convenience and comfort.
- Do not engage in stressful or emotional conversations that might divert your attention from the road.
- Dial 911 or other local emergency numbers to report

IMPORTANT SAFETY INSTRUCTIONS

serious emergencies — it's free from your wireless phone.

- Use your wireless phone to help others in emergencies.
- Call roadside assistance or a special non-emergency wireless number when necessary.

* *Driving Tips used with permission from CTIA-The Wireless Association®*

For Vehicles Equipped with an Air Bag

An air bag inflates with great force. Do not store the phone or any of its accessories in the area over the air bag or in the air bag deployment area.

CHARGER WARNINGS

- Use only those Clarity products and accessories designed for use with this product.
- Do not disassemble the product or AC adapter as this may expose you to dangerous voltages or other risks. Incorrect reassembly can cause electric shock or fire when the product is subsequently used.

BATTERY WARNINGS

To avoid the risk of explosion, fire or leakage of toxic chemicals, please observe the following warnings:

- Do not dispose of the product or battery in a fire or heat above 40°C (104°F).
- Do not open, deform or mutilate the battery. There may be corrosive materials which can cause damage to eyes or skin and may be toxic if swallowed.