

# airconsole | Airconsole LE - Quick Start User Guide

## Device Overview

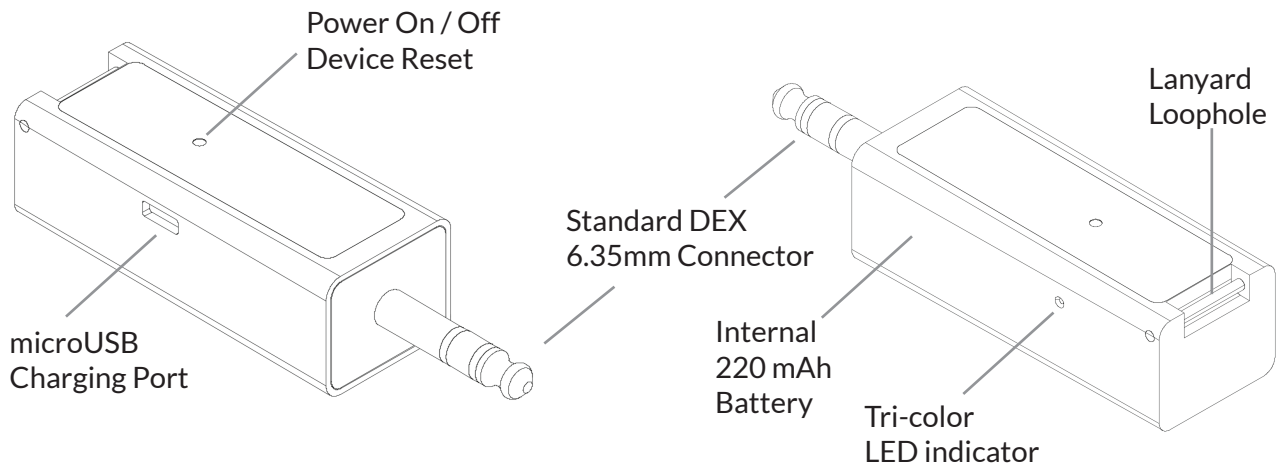

## Quick Setup



### Download Airconsole Quickstart App

Airconsole LE is configured wirelessly via the free Airconsole Quickstart App available for both iOS or Android devices. Download and install the App via the below links or search for "Airconsole Quickstart" on either Google Play or Apple App Store

Android:

<https://play.google.com/store/apps/details?id=com.getconsole.airconsolequickstart&hl=en>

Apple:

<https://itunes.apple.com/nz/app/airconsole-quickstart/id1029731960?mt=8>



### Check Your Airconsole LE is Powered On

Airconsole LE is generally always on. You can check by looking for LED indicator blinking every minute. If no LED blinks use paperclip to press down the Power On button for 2 seconds. The LED should show Orange and then blink every minute. If your Airconsole LE does not blink, connect external microUSB charging cable to power the battery (see next page for charging instructions).



### Follow the App Install Instructions

Discover Airconsole LE then tap View Status. Tap Edit Configuration and then Configure your Airconsole LE Serial Baud Rate. Optionally, enable security features. When finished tap Push and confirm to Push the configuration over Bluetooth to the Airconsole LE. It will automatically reboot.

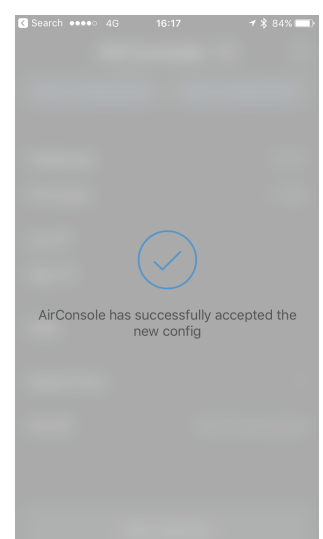
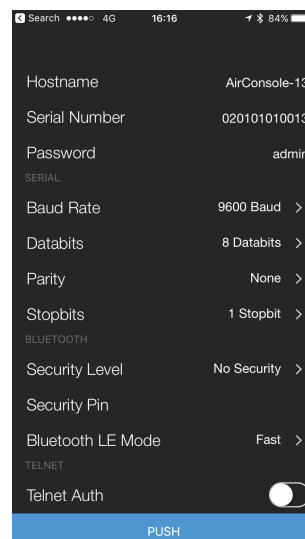
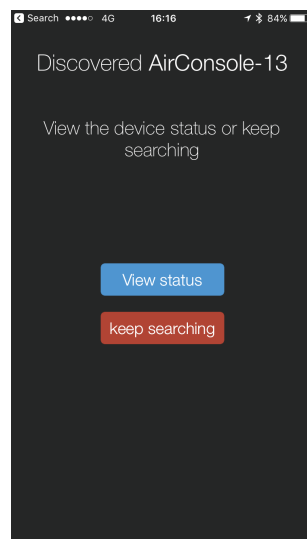
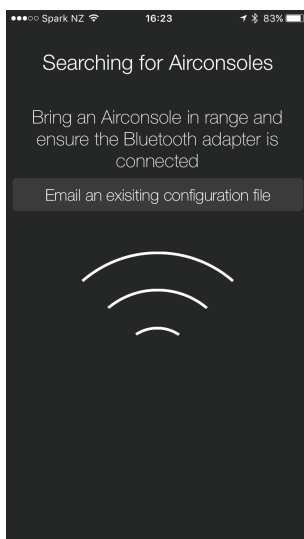

Charging Instructions

Connect provided microUSB charging cable to Airconsole LE microUSB charging port. The Charging cable runs from any USB power adaptor that provides 500mA or greater charging current. When the Charging cable is connected the LED will blink Blue colour to indicate charging is started. When the battery is full and USB charger is still connected, the LED will change to solid blue colour. Charge up your Airconsole LE every few months, depending on usage.

Further Support

Please visit [support.get-console.com](http://support.get-console.com) for full user manuals and developer SDKs for use with Airconsole LE.

FCC Statement: FCC Part 15 Subpart B Class B

This device complies with part 15 of the FCC Rules. Operation is subject to the following two conditions:

- 1. This device may not cause harmful interference.
- 2. This device must accept any interference received, including interference that may cause undesired operation.

This equipment has been tested and found to comply with the limits for a Class B digital device pursuant to part 15 of the FCC Rules. These limits are designed to provide reasonable protection against harmful interference in a residential installation. This equipment generates, uses, and can radiate radio frequency energy and, if not installed and used in accordance with the instructions, may cause harmful interference to radio communications. However, there is no guarantee that interference will not occur in a particular installation. If this equipment does cause harmful interference to radio or television reception, which can be determined by turning the equipment off and on, the user is encouraged to try to correct the interference by one or more of the following measures:

- Reorient or relocate the receiving antenna.
- Increase the separation between the equipment and receiver.
- Connect the equipment into an outlet on a circuit different from that to which the receiver is connected.
- Consult the dealer or an experienced radio or television technician for help.

If necessary, the user should consult the dealer or an experienced radio/ television technician for additional suggestions. Cloudstore is not responsible for any radio or television interference caused by unauthorized modifications of this equipment or the substitution or attachment of connecting cables and equipment other than those specified by Cloudstore. The correction is the responsibility of the user. Use only shielded data cables with this system. This unit has been tested with cables less than 3 meters. Cables greater than 3 meters may not meet class B performance.

**Caution:** Any changes or modifications made to this equipment not expressly approved by Cloudstore may void the FCC authorization to operate this equipment.

RF Exposure Warning

This equipment complies with FCC RF exposure limits set forth for an uncontrolled environment. This equipment must not be co-located or operating in conjunction with any other antenna or transmitter.

GCAC2-LE Specifications

Mechanical

Dimensions (LxWxH)

101 mm x 26 mm x 20 mm (3.98 in x 1.02 in x 0.8in)

Weight

35 g (1.2 oz)

Environmental

Operating Temperature

-10°C to 50°C (14°F to 122°F)

Storage Temperature

-25°C to 70°C (-13°F to 158°F)

Humidity

0 to 95% relative humidity, (non-condensing)

ESD

±15KV Air and ±8KV Contact

Environmental Sealing

Rated to IP62

Drop

Withstands multiple 3.3 m (10 ft) drops to concrete

Tumble

Exceeds 1000 cycles 1 m (3.3 ft) tumbles

Battery life\*

Expected battery life is based on 12 DEX transactions per day averaging transmission of 10kB each.

Selected Battery	45mAH Replaceable	220mAH Fixed Installed
Expected Life	21 Days 5 MB	180 Days 26 MB

Expected battery life also dependent on external operating temperature and frequency of use. Results may vary from above table.

Operating System Support

Support for Apple iOS 10+, Android 5.1+, MacOS 10.10+ and Windows 8.1+.

Full Software Development Kit (SDK) available from [support.get-console.com](http://support.get-console.com)

Warranty

12 Month Factory Warranty from date of purchase