

The Cobra line of quality products includes:

- CB Radios
- microTALK® Radios
- Radar/Laser Detectors
- Safety Alert® Traffic Warning Systems
- Mobile GPS Navigation Systems
- HighGear® Accessories
- CobraMarine® VHF Radios
- Marine Chartplotters
- Power Inverters
- Accessories

For more information or to order any of our products, please visit our website:  
[www.cobra.com](http://www.cobra.com)

Nothing Comes Close to a Cobra®

English

Cobra®

**14BAND**

Operating Instructions

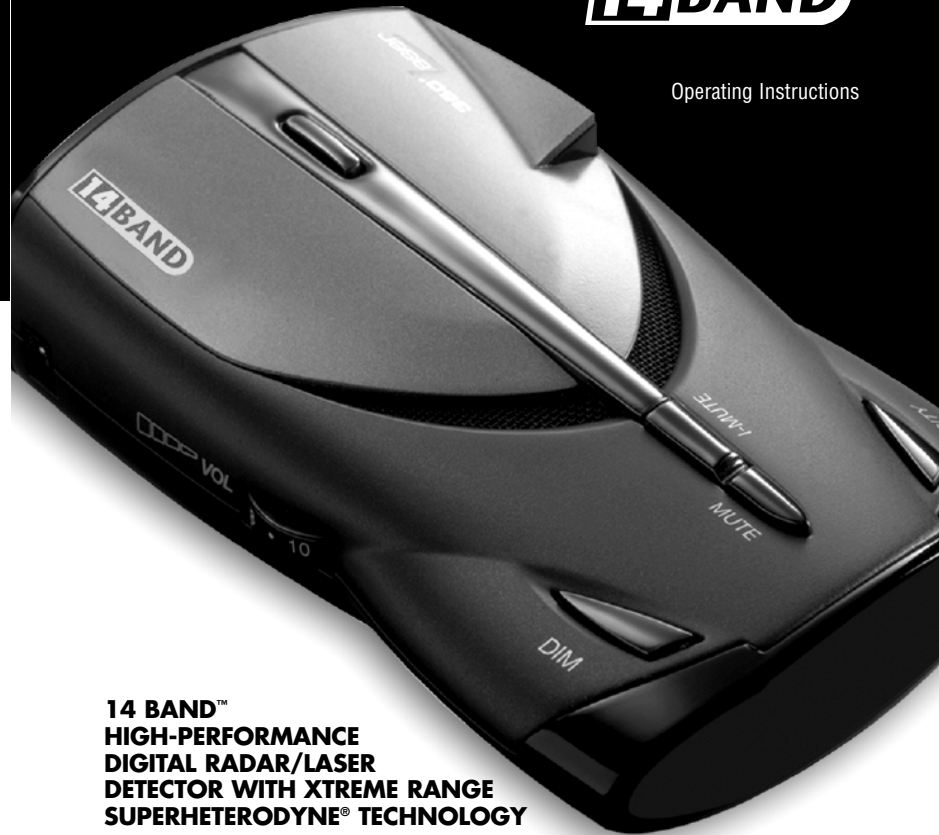

**14 BAND™  
HIGH-PERFORMANCE  
DIGITAL RADAR/LASER  
DETECTOR WITH XTREME RANGE  
SUPERHETERODYNE® TECHNOLOGY**

**XRS 9545**

Printed in China  
Part No. 490-490-P  
Version A

Nothing Comes Close to a Cobra®

English

Introduction

**Important Information and  
Customer Assistance**

### Important Information

#### Federal Laws Governing the Use of Radar Detectors

It is not against federal law to receive radar transmissions with your Cobra radar/laser detector. The Communications Act of 1924 guarantees your right to receive radio transmissions on any frequency. Local laws that contravene this Act, while illegal, may be enforced by your local law enforcement officials until and unless they are prohibited from doing so by federal court action.

#### Safety Alert

Use of this product is not intended to, and does not, ensure that motorists or passengers will not be involved in traffic accidents. It is only intended to alert the motorist that an emergency vehicle equipped with a Cobra Safety Alert transmitter is within range as defined by that product. Please call local fire and police departments to learn if coverage exists in your area.

#### Safe Driving

Motorists, as well as operators of emergency or service vehicles, are expected to exercise all due caution while using this product, and to obey all applicable traffic laws.

#### Security of Your Vehicle

Before leaving your vehicle, always remember to conceal your radar detector in order to reduce the possibility of break-in and theft.

Customer Assistance

### Customer Assistance

Should you encounter any problems with this product, or not understand its many features, please refer to this owner's manual. If you require further assistance after reading this manual, Cobra Electronics offers the following customer assistance services:

#### For Assistance in the U.S.A.

**Automated Help Desk** English only. 24 hours a day, 7 days a week 773-889-3087 (phone).

**Customer Assistance Operators** English and Spanish. 8:00 a.m. to 6:00 p.m. Central Time Mon. through Fri. (except holidays) 773-889-3087 (phone).

**Questions** English and Spanish. Faxes can be received at 773-622-2269 (fax).

**Technical Assistance** English only. [www.cobra.com](http://www.cobra.com) (on-line: Frequently Asked Questions). English and Spanish. [productinfo@cobra.com](mailto:productinfo@cobra.com) (e-mail).

#### For Assistance Outside the U.S.A.

**Contact Your Local Dealer**

©2009 Cobra Electronics Corporation  
6500 West Cortland Street  
Chicago, Illinois 60707 USA  
[www.cobra.com](http://www.cobra.com)

A1 English

## Controls, Indicators and Connections



\* Press and hold for four seconds to access these functions.



**WARNING**  
Modifications or parts substitutions not approved by Cobra Electronics Corporation may violate FCC Rules and void your authority to operate this equipment.

## Display

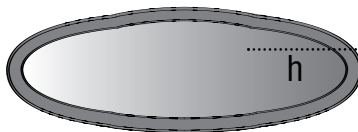

Alpha/Numeric Dot Matrix Text Display  
See pages 6 – 18 for more information about display features.

## Product Features

**Congratulations! You've made a smart choice by purchasing a high performance radar/laser detector from Cobra. Just look at some of the sophisticated features and capabilities your new unit includes:**

**Xtreme Range Superheterodyne Technology**  
With super-fast sweep circuitry, XRS provides extra detection range and the best possible advance warning to even the fastest radar guns

**Detection and Separate Alerts For:**  
Radar signals (X, K, Ka and Ku bands, with signal strength indicated), Laser signals, Safety Alert signals, Spectre I & IV+ signals, VG-2 signals

**LaserEye**  
For 360° detection of laser signals

**Instant-On Ready**  
Detects radar guns with "instant-on" (very fast) speed monitoring capabilities

**Pop Detection**  
Detects the latest super-fast instant-on single pulse radar guns

**Tone Alert or Voice Alert**  
With adjustable volume

**City or Highway**  
Modes to reduce false alerts

**DigiView Data Display**  
With easy-to-read alpha/numeric dot matrix text readout

**Alert Programming**  
Easy setting of radar bands to be monitored

**Safety Alert**  
Traffic warning system distinguishes important safety alerts from other K band signals

**Manual Mute or Auto Mute**  
A mute function of audio alerts

**IntelliMute**  
A mute function which automatically reduces false audio alerts by sensing engine RPMs

**IntelliMute Pro**  
Prevents detection by radar detector detectors (RDDs) when traveling at slower speeds

**Mounting**  
Mounts easily on windshield or dashboard

This booklet describes the simple steps for mounting and setting up your detector. It also provides helpful information about how radar and laser guns are used and how you can interpret the alerts you receive.

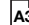
Nothing Comes Close to a Cobra® 

## Ordering From U.S.A.

Call 773-889-3087 for pricing or visit [www.cobra.com](http://www.cobra.com).

## For Credit Card Orders

Call 773-889-3087 [Press one from the main menu] 8:00 a.m. to 6:00 p.m. Central Time, Monday through Friday.

## Make Check or Money Order Payable To

Cobra Electronics, Attn: Accessories Dept.,  
6500 West Cortland Street, Chicago, IL 60707 U.S.A.

## To Order Online

Please visit our website: [www.cobra.com](http://www.cobra.com)

Item #	Description
420-030-N-001	Straight 12V Power Cord
420-026-N-001	Coiled 12V Power Cord
545-159-N-001	Windshield Mounting Bracket
CLP-2B	Dual Port Power Adapter

## Trademark Acknowledgement

Cobra®, DigiView®, EasySet®, Extra Sensory Detection®, IntelliMute®, IntelliMute® Pro, IntelliShield®, LaserEye®, Nothing Comes Close to a Cobra®, Safety Alert® Traffic Warning System, Strobe Alert®, VG-2 Alert®, Xtreme Range Superheterodyne® and the snake design are registered trademarks of Cobra Electronics Corporation, USA.

Cobra Electronics Corporation™, 14 Band™, 15 Band™, Extreme Bright DataGrafix™, IntelliLink™, Revolution™ Series, SmartPower™, Spectre Alert™, Super-Xtreme Range Superheterodyne™, S-XRS™, UltraBright™, and Voice Alert™ are trademarks of Cobra Electronics Corporation, USA.

Opticom™ is a trademark of 3M Corporation. Instaclear® for Ford is a registered trademark of Ford Motor Company, Inc. Electriclear® for GM is a registered trademark of General Motors Corporation. 20-20™ and Ultra-Lyte™ are trademarks of Laser Technology, Inc. ProLaser™ and ProLaser III™ are trademarks of Kustom Signals, Inc. Bee III™ and Pop™ are a trademarks of MPH Industries. Stalker™ LIDAR is a trademark of Applied Concepts, Inc. Spectre I™ and Spectre IV+™ are trademarks of Stealth Micro Systems Pty. Ltd. SpeedLaser™ is a trademark of Laser Atlanta, LLC. Interceptor VG-2™ is a trademark of TechniSonic Industries LTD. Tomar® is a registered trademark of TOMAR Electronics, Inc.

**Introduction**

Important Information .....	A1
Customer Assistance .....	A1
Controls, Indicators and Connections .....	A2
Display .....	A3
Product Features .....	A3

**Your Detector**

Installation .....	2
Getting Started .....	5
Auxiliary Audio Jack .....	5
Settings .....	6
Highway/City Mode .....	6
DigiView Data Display Brightness .....	7
Muting an Alert .....	8
Auto Mute Mode .....	8
IntelliMute .....	9
IntelliMute Pro .....	12
Voice/Tone Setting .....	13
VG-2 and Spectre I & IV+ Alert Settings .....	14
Radar Alert Settings .....	14
Pop Alert .....	15
Detection .....	16
Signals Detected .....	16
Audio Alerts .....	16
Visual Display .....	16
Instant-On Detection .....	19
Responding to Alerts .....	19
Understanding Radar and Laser .....	20
Maintenance .....	21
Specifications .....	22

**Warranty**

Limited 1-Year Warranty .....	22
-------------------------------	----

**Customer Assistance**

Product Service .....	23
Optional Accessories .....	24
Accessories Order Info .....	25
Trademark Acknowledgement .....	25

## Installation

### Where to Mount Your Unit

You will get optimum performance from your detector if you **Mount** it at a point approximately in the center of the vehicle, as low as possible on the front windshield without obstructing the unit's view of the road either to the front or rear. Make sure the unit is level with the road. You can also mount it directly on the dashboard.

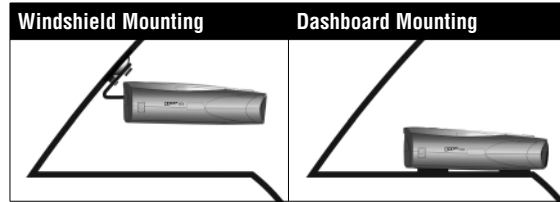

The unit's lens must not be blocked and the LaserEye should have a clear view out the back window to allow 360° detection.

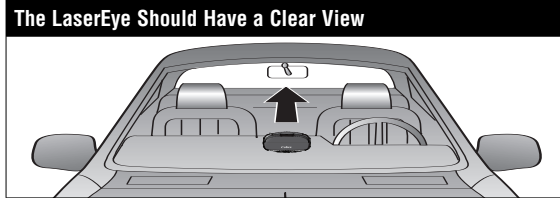

Radar and laser signals pass through glass but not through other materials and objects. Objects that can block or weaken incoming signals include:

- Windshield wiper blades
- Mirrored sun screens
- Dark tinting at the top of the windshield
- Heated windshields currently available on some vehicles (Instaclear for Ford, Electriclear for GM.) Consult your dealer to see if you have this option.

## Windshield Mounting

<p>1. Attach the rubber cups to the bracket.</p>	
<p>2. Make sure the rubber cups and your windshield are clean.</p>	
<p>3. Push the bracket firmly onto the windshield.</p>	
<p>4. Attach the detector to the bracket. Check the angle of the unit.</p>	
<p>5. To adjust the angle if necessary, gently push or pull on the bracket to bend it. <b>DO NOT</b> use the detector to bend the bracket.</p>	
<p>6. Plug the power cord into the detector.</p>	
<p>7. Plug the cigarette lighter adapter on the power cord into your vehicle's cigarette lighter.</p>	
<p>8. You can temporarily remove the detector whenever you wish by pressing the bracket release button and sliding it off the bracket.</p>	

## Dashboard Mounting

1. Place the detector on the dashboard to find a location where the unit has a clear, level view of the road. The angle can NOT be adjusted after mounting.

2. Remove the paper backing from one side of the hook-and-loop fastener.

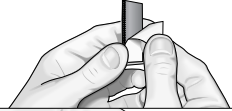

3. Attach the pad to the dashboard at your chosen location and remove the other paper backing.

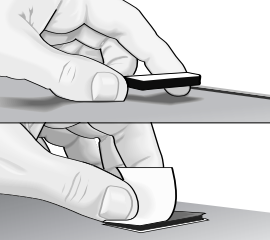

4. Attach the detector to the hook-and-loop fastener. You can remove and reattach the unit as often as you like.

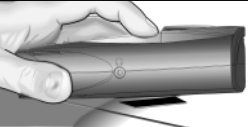

5. Plug the power cord into the detector.



6. Plug the cigarette lighter adapter on the power cord into your vehicle's cigarette lighter.

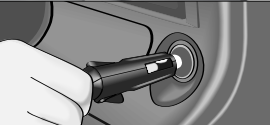

## Getting Started

Power On

Testing

System Ready

On-Off/  
Volume Control  
Rotate clockwise  
(away from you)



### To Turn On the Unit and Adjust the Audio Volume

Rotate the **On-Off/Volume** control clockwise (away from you).

Tone	Voice	Visual Display
Three beeps	<b>Testing</b> , then three beeps <b>System Ready</b>	The display will cycle through and show the user modes

Start-Up Complete

**h**

Start-up is complete when the display continuously shows the letters indicating the current user settings (C = **City** mode, h = **Highway** mode, i = **IntelliMute On**)



### NOTE

In some vehicles, power is supplied to the cigarette lighter even while the ignition is Off. If this is the case with your vehicle, you should turn Off or unplug your detector when parking for lengthy periods.

## Auxiliary Audio Jack

The Auxiliary Audio Jack can be used to connect external speakers in environments with high ambient noise levels. The internal speaker will be disconnected. (This uses a mini stereo audio connector.)



Auxiliary Audio Jack

## Settings

When changing the **Settings** on your detector, please keep in mind:

- Buttons can have multiple functions.
- Depending on your choice of Voice Alert or Tone Alert mode, you will hear either voice messages or tones confirming changes in settings.
- All settings will be stored in memory when the power is turned Off and recalled when the power is turned back On.

### Highway/City Mode

Setting your detector to **City** mode delays all X band audio alerts until the signal strength reaches Level 3. (A single beep will sound when the signal is first detected.) This will reduce false alerts while you are driving in, or near, urban areas where there are many sources for conflicting X band signals such as microwave towers and automatic door openers.

To change settings, follow the procedure listed below, which indicates what you will see and hear (either in Voice Alert or Tone Alert mode) as you complete each step. The factory setting is **Highway** mode.

Highway Mode



City Mode



**City Button**  
Press and release

#### To Change From Highway Mode to City Mode

Press and release the <b>City</b> button.	Tone	Voice	Visual Display
	One beep	<b>City</b>	<b>City</b> blinks, then <b>c</b> appears in the display

#### To Change From City Mode Back to Highway Mode

Press and release the <b>City</b> button again.	Tone	Voice	Visual Display
	Two beeps	<b>Highway</b>	<b>Highway</b> blinks, then <b>h</b> appears in the display

## DigiView Data Display Brightness

You can choose from four (4) settings for **Brightness** of the display. You can cycle through the settings by repeatedly pushing the **Dim** button. The factory setting is **Bright**.

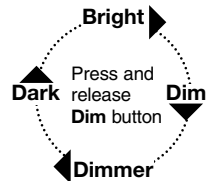

**Dim Button**  
Press and release

Dark Indicator



#### To Change the Brightness to Dim

Press and release the <b>Dim</b> button once.	Tone	Voice	Visual Display
	One beep	<b>Dim</b>	<b>Dim</b> blinks, then display dims

#### To Change the Brightness to Dimmer

Press and release the <b>Dim</b> button again.	Tone	Voice	Visual Display
	One beep	<b>Dimmer</b>	<b>Dimmer</b> blinks, then display dims further

#### To Change the Brightness to Dark

Press and release the <b>Dim</b> button a third time.	Tone	Voice	Visual Display
	One beep	<b>Dark</b>	<b>Dark</b> blinks, then display goes dark (no visual alerts will be seen)

#### To Change the Brightness to Bright

Press and release the <b>Dim</b> button a fourth time.	Tone	Voice	Visual Display
	Two beeps	<b>Bright</b>	<b>Bright</b> blinks, then display returns to full brightness



### Muting an Alert

Your detector allows you to quickly turn Off an audio **Alert** by momentarily pressing the **Mute** button. If you press the **Mute** button a second time during the Alert, the audio Alert will be turned back On.

### Auto Mute Mode

**Auto Mute** will automatically reduce the audio volume of all alerts after four seconds for as long as the signal is detected. The factory setting is Auto Mute On.



**Mute Button**  
Press and release

To Turn Auto Mute On			
	Tone	Voice	Visual Display
Press and release the <b>Mute</b> button again while no alert is occurring.	Two beeps	<b>Auto Mute On</b>	None, after <b>Auto Mute On</b> blinks

To Turn Auto Mute Off			
	Tone	Voice	Visual Display
Press and release the <b>Mute</b> button while no alert is occurring.	One beep	<b>Auto Mute Off</b>	None, after <b>Auto Mute Off</b> blinks

### IntelliMute

**IntelliMute** is a unique feature that allows you to avoid alerts you don't need to hear because you are stopped or moving slowly. By sensing the "revs" (RPMs) of your engine, IntelliMute knows when you are at low speed and automatically mutes alerts.

Before IntelliMute will work, you must set an activation point for your engine's revs (see page 10). Whenever the revs are below that point, IntelliMute will begin muting. The activation point will be stored in memory and recalled each time the power is turned On. The factory setting is IntelliMute Off.



#### NOTE

IntelliMute may not work with some vehicles because it cannot sense the engine's revs. In such cases, you can reduce unwanted audio alerts by using Auto Mute and City mode when appropriate.



**IntelliMute On**



**IntelliMute Button**  
Press and release

To Turn IntelliMute On			
	Tone	Voice	Visual Display
Press and release the <b>IntelliMute</b> button.	Two beeps	<b>IntelliMute On</b>	<b>IntelliMute On</b> blinks, then <b>i</b> appears in the display

To Turn IntelliMute Off			
	Tone	Voice	Visual Display
Press and release the <b>IntelliMute</b> button again.	One beep	<b>IntelliMute Off</b>	None, after <b>IntelliMute Off</b> blinks

**What to Remember While Using IntelliMute**

**IntelliMute** works with both **City** and **Auto Mute** modes.

Whenever engine revs are below the activation point, an arrow pointing down will appear in the display. Above the activation point, an arrow pointing up will appear.

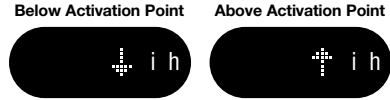

If, for any reason, the unit stops sensing your engine's revs, IntelliMute will indicate an error and automatically turn Off.

The rev point you set will be stored in the unit's memory when power is turned Off and recalled each time the power is turned On.

**NOTE**  
The rev point must be reset if you use your detector in a different vehicle.

**NOTE**  
When initially choosing your IntelliMute activation point, a setting of approximately 300 to 600 RPMs above idle is recommended. You can reset the activation point at any time to fit your individual preferences and driving style.

**Setting the IntelliMute Activation Point**

Your detector must be installed in your vehicle.

**CAUTION**  
Do not attempt to set the rev point while driving. Your vehicle should be parked and idling.

IntelliMute must be turned On before setting the activation point. Depending on whether the unit is in Tone Alert or Voice Alert mode, you will hear a series of beeps or voice messages as you follow the steps on the next page.

Hold IntelliMute Button Rev Level Set

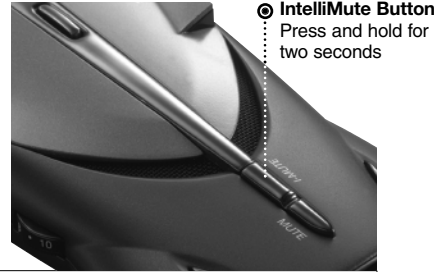

**To Set the IntelliMute Activation Point**

	Tone	Voice	Visual Display
Press and hold the <b>IntelliMute</b> button for two seconds.	Two beeps	<b>Set Engine Revs</b>	Press IntelliMute button again at desired RPMs
Rev your engine to the level you wish to set (recommend slightly above idle) and hold revs steady for two seconds.	None	None	None
At the desired rev level, press and release the <b>IntelliMute</b> button.	Three beeps	<b>IntelliMute Set</b>	IntelliMute Set!

IntelliMute Not Set

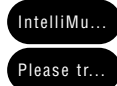

IntelliMute Off



**NOTE**  
If the unit is unable to sense usable pulses within three seconds or if you do not set a rev point within 20 seconds of beginning these steps, IntelliMute will indicate an error and automatically turn Off.

Tone	Voice	Visual Display
Four beeps	<b>IntelliMute Not Set, Please Try Again</b> followed by	IntelliMute not set Please try again
One beep	<b>IntelliMute Off</b>	IntelliMute Off



## IntelliMute Pro

**IntelliMute Pro** prevents detection by radar detector detectors (RDDs) such as VG-2, Spectre I and Spectre IV+ when traveling at slower speeds. It is intended for use by experienced users only.

When IntelliMute Pro is turned On, and engine RPMs are below the IntelliMute activation point, your detector's radar detection circuits are turned Off to prevent detection by RDDs.

Before IntelliMute Pro can be turned On, you must have turned On and Set the IntelliMute activation point. (See pages 9 through 11.)



### CAUTION

When IntelliMute Pro is On, **NO** radar signals will be detected and **NO** alerts will be given at RPMs **below** the IntelliMute activation point.

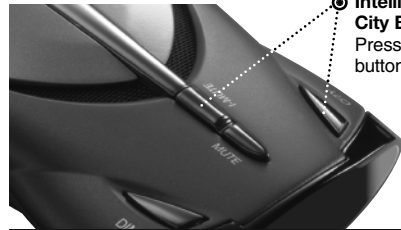

**IntelliMute Button City Button**  
Press and hold both buttons simultaneously



### NOTE

The arrow up or down will continue to show that engine RPMs are above or below the user-set value.

### To Turn IntelliMute Pro On

While no signal is being detected, press and hold both the <b>IntelliMute</b> and <b>City</b> buttons for four seconds.	Tone	Voice	Visual Display
	Two beeps	<b>IntelliMute Pro On</b>	i blinks continuously in the display after <b>IntelliMute Pro On</b> blinks

### To Turn IntelliMute Pro Off

Press and hold both the <b>IntelliMute</b> and <b>City</b> buttons for four seconds.	Tone	Voice	Visual Display
	One beep	<b>IntelliMute Pro Off</b>	None, after <b>IntelliMute Pro Off</b> blinks

## Voice/Tone Setting

You can set your detector to sound alerts with either a **Voice** or a **Tone**. You can change settings by using the **Mute** button.

In Voice Alert mode, you will first hear several tones, then a voice message announcing the type of signal detected, followed by more tones. In Tone Alert mode, you will hear the tones only. The factory setting is Voice Alert mode.

**Mute Button**  
Press and hold for two seconds

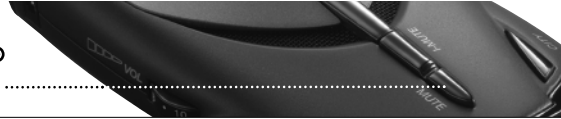

### To Change From Voice Alert to Tone Alert

While no signal is being detected, press and hold the <b>Mute</b> button for two seconds.	Tone	Voice	Visual Display
	One beep	<b>Tone Alert</b>	None, after <b>Tone</b> blinks in the display

### To Change From Tone Alert Back to Voice Alert

While no signal is being detected, press and hold the <b>Mute</b> button for two seconds again.	Tone	Voice	Visual Display
	None	<b>Voice Alert</b>	None, after <b>Voice</b> blinks in the display

## VG-2 and Spectre I & IV+ Alert Settings

Police use radar detector detectors (RDDs) to spot users of radar detectors. Your detector is able to identify signals from **VG-2**, **Spectre I** and **Spectre IV+** RDDs and can provide alerts when any of these or similar devices are in use near your vehicle.

Your detector **can** be spotted by Spectre IV+ RDDs, but is invisible to VG-2 and Spectre I RDDs. You can choose whether you want to be alerted to VG-2 and Spectre I & IV+ RDD signals. The factory setting for VG-2 and Spectre I & IV+ alerts is Off.



**Dim Button**  
Press and hold for four seconds

Spectre I & IV+ and VG-2 On	Spectre I & IV+ and VG-2 Off
<b>Spectre</b>	<b>Spectre</b>
<b>&amp; VG2</b>	<b>&amp; VG2</b>
<b>On</b>	<b>Off</b>

### To Turn VG-2 and Spectre I & IV+ Alerts On and Off

While no signal is being detected, press and hold the <b>Dim</b> button for four seconds.	Tone	Voice	Visual Display
On = Two Beeps	<b>Spectre VG-2 On</b>	<b>Spectre &amp; VG2 On</b>	<b>Spectre &amp; VG2 On</b> blinks in the display
Off = One Beep	<b>Spectre VG-2 Off</b>	<b>Spectre &amp; VG2 Off</b>	<b>Spectre &amp; VG2 Off</b> blinks in the display

## Radar Alert Settings

The detector allows you to choose whether it will show alerts on the **X**, **K**, and **Ku Bands**. The factory settings are: X Band and K Band On; Ku Band Off.

### To Turn X Band On and Off

While no signal is being detected, press and hold both the <b>Dim</b> and <b>Mute</b> buttons for four seconds.	Tone	Voice	Visual Display
X On = Two beeps	<b>X On</b>	<b>X On</b>	<b>X On</b> blinks in the display
X Off = One beep	<b>X Off</b>	<b>X Off</b>	<b>X Off</b> blinks in the display

## Radar Alert Settings (continued)

### To Turn K Band On and Off

While no signal is being detected, press and hold both the <b>Mute</b> and <b>City</b> buttons for four seconds.	Tone	Voice	Visual Display
K On = Two beeps	<b>K On</b>	<b>K On</b>	<b>K On</b> blinks in the display
K Off = One beep	<b>K Off</b>	<b>K Off</b>	<b>K Off</b> blinks in the display

### To Turn Ku Band\* On and Off

While no signal is being detected, press and hold the <b>City</b> button for four seconds.	Tone	Voice	Visual Display
Ku On = Two beeps	<b>Ku On</b>	<b>Ku On</b>	<b>Ku On</b> blinks in the display
Ku Off = One beep	<b>Ku Off</b>	<b>Ku Off</b>	<b>Ku Off</b> blinks in the display

## Pop Alert

The Pop Mode Radar Gun is a single-pulse Doppler radar that is a feature of a K and Ka (Bee III Ka radar gun) band Instant-On radar gun. It uses a single, short-time pulse to measure the target vehicle's speed.

The Pop mode receiver senses Pop singles beyond the effective range of Pop radar guns. As the Pop mode receiver is so sensitive, you should limit the use of Pop Detect mode to highway and rural driving.

**Pop Alert** will alert you to Pop radar signals. During the alert, the unit continues to detect other signals. The factory setting is Pop Detect Off.

### To Turn Pop Alert On and Off

While no signal is being detected, press and hold both the <b>Dim</b> and <b>City</b> buttons for four seconds.	Tone	Voice	Visual Display
Pop On = Two beeps	<b>Pop On</b>	<b>Pop On</b>	<b>Pop On</b> blinks in the display
Pop Off = One beep	<b>Pop Off</b>	<b>Pop Off</b>	<b>Pop Off</b> blinks in the display

## Detection

### Signals Detected

The tables on the following pages show you the types of **Signals** your detector will detect, as well as the voice and visual alerts it provides for each of them.

### Audio Alerts

In **Voice Alert** mode you will first hear several tones, then a voice message announcing the type of signal detected, followed by more tones. In **Tone Alert** mode, you will hear the tones only.

In both **Voice Alert** and **Tone Alert** modes, a distinctly different alert tone is used for each type of signal detected (including separate tones for each laser signal). For X, K, Ka and Ku band radar signals, the tones will repeat faster as you approach the signal source. The repeat rate of the tones gives you useful information about the signal detected. (See responding to alerts on page 19.)

### Visual Display

An indication of the type of signal detected will appear in the DigiView Data Display. During X, K, Ka and Ku alerts, you will also see from 1 to 5 vertical bars, indicating the strength of the signal detected.

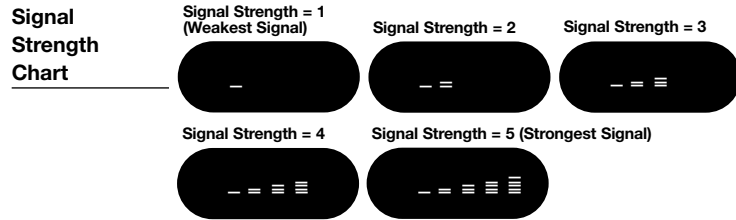

### Radar Signals, Voice and Visual Displays

Type of Signal	Voice	Visual Display
X Band Radar	<b>X Alert</b>	X and Signal Strength
K Band Radar	<b>K Alert</b>	K and Signal Strength
Ka Band Radar	<b>Ka Alert</b>	Ka and Signal Strength
Ku Band Radar	<b>Ku Alert</b>	Ku and Signal Strength
Pop Radar	<b>Pop Alert</b>	POP

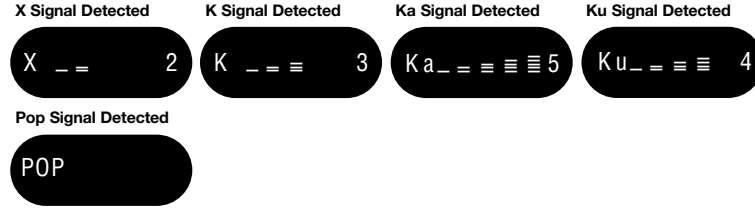

### Laser Signals, Voice and Visual Displays

Type of Signal	Voice	Visual Display
LTI 20-20*	<b>Laser Alert</b>	Laser 20/20
LTI Ultra-Lyte*	<b>Laser Alert</b>	Laser UltraLyte
Kustom Signals ProLaser*	<b>Laser Alert</b>	Laser Pro Laser
Kustom Signals ProLaser III*	<b>Laser Alert</b>	Laser Pro Laser 3
Stalker LIDAR*	<b>Laser Alert</b>	Stalker
Laser Atlanta - Speedlaser*	<b>Laser Alert</b>	SpeedLaser

\* Your detector provides 360° detection of these signals.

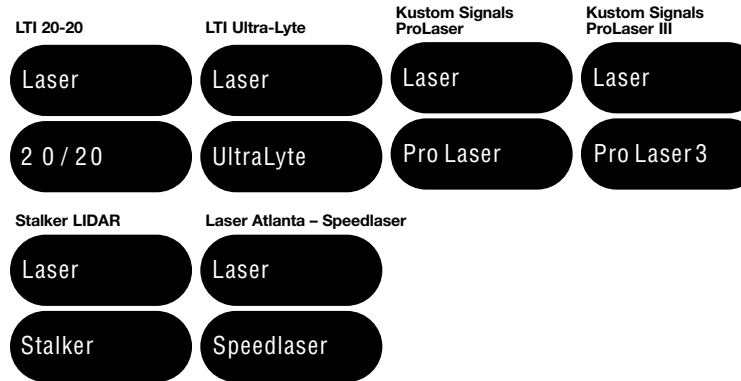

**NOTE**  
Beep rate changes with different laser alerts.



## Safety Alert Signals, Voice and Visual Displays

Type of Signal	Voice	Visual Display
Emergency Vehicles	<b>Emergency Vehicle Approaching</b>	Emergency Vehicle
Road Hazards	<b>Road Hazard Ahead</b>	Road Hazard
Trains	<b>Train Approaching</b>	Train

\* Your detector provides 360° detection of this signal.

Emergency Alert Signal Detected

Emergency...

Road Hazard Alert Signal Detected

Road Hazard

Train Alert Signal Detected

Train

**NOTE**  
There are different tones for each Safety Alert.

## Spectre I & IV+ Alert Signal, Voice and Visual Display

Type of Signal	Voice	Visual Display
Spectre I	<b>Spectre Alert</b>	Spectre1
Spectre IV+	<b>Spectre Alert</b>	Spectre4

Spectre I Alert Signal Detected

Spectre1

Spectre IV+ Alert Signal Detected

Spectre4

## VG-2 Alert Signal, Voice and Visual Display

Type of Signal	Voice	Visual Display
Interceptor VG-2	<b>VG-2 Alert</b>	VG-2

VG-2 Alert Signal Detected

VG-2

**NOTE**  
There are different tones for each radar detector alert.



## Instant-On Detection

Your detector is designed to detect **Instant-On** speed monitoring signals, which can suddenly appear at full strength.

**NOTE**  
You should take appropriate action immediately whenever an instant-on alert is given.

## Responding to Alerts

Description	Interpretation	Recommended Response
Tone repeats slowly at first, then speeds up rapidly.	Probably police radar.	FULL ALERT
Tone sounds one time only.	Probably a false alarm, but possibly pulsed radar, Spectre I or IV+ or VG-2 nearby.	Exercise caution
Tone instantly begins repeating rapidly.	Radar, Spectre I or IV+ or VG-2 nearby has been activated suddenly.	FULL ALERT
Tone repeats slowly as you approach a hill or bridge, then speeds up sharply as you reach it.	Probably police radar beyond the hill or bridge.	FULL ALERT
Tone repeats slowly for a short period.	Probably a false alarm.	Exercise caution
Any type of laser alert.	Laser alerts are never false alarms.	FULL ALERT
Any Safety Alert.	You are nearing an emergency vehicle, railroad crossing or road hazard (construction, accident, etc.).	Exercise caution

## Understanding Radar and Laser

### Radar Speed Monitoring Systems

Three band frequencies have been approved by the Federal Communications Commission (FCC) for use by speed monitoring radar equipment:

<b>X band</b>	10.525 GHz
<b>K band</b>	24.150 GHz
<b>Ka band</b>	33.400 – 36.00 GHz

Your detector detects signals in all three radar bands, plus Ku band (13.435 GHz), which is an approved frequency used in parts of Europe and Asia.

### VG-2 and Spectre I & IV+

**VG-2** and **Spectre I & IV+** are radar detector detectors (RDDs) that work by detecting low-level signals emitted by most radar detectors. Your detector does not emit signals that can be spotted by VG-2 and Spectre I RDDs. However, your detector **can** be spotted by Spectre IV+ RDDs. Your unit detects signals from these or similar devices and will alert you when such a device is in use near your vehicle.

### Safety Alert Traffic Warning System

FCC-approved **Safety Alert** transmitters emit microwave radar signals that indicate the presence of a safety-related concern. Depending on the frequency of the signal emitted, it can indicate a speeding emergency vehicle or train, or a stationary road hazard.

Because these microwave signals are within the K band frequency, most conventional radar detectors will detect Safety Alert signals as standard K band radar. Your detector, however, is designed to differentiate between standard K band and Safety Alert signals, and give separate alerts for each.

Safety Alert technology is relatively new. Safety Alert transmitters can be found in limited numbers in all 50 states, but the number is growing. Depending on your location, you may not receive these alerts regularly and may often encounter emergency vehicles, trains and road hazards without being alerted. As the number of transmitters increases, these alerts will become more common.

When you receive such an alert, please watch for emergency vehicles ahead of you, on cross streets and behind you. If you see an emergency vehicle approaching, please pull over to the right side of the road and allow it to pass.

## LIDAR (Laser)

The correct name for the technology that most people refer to as laser is actually **LIDAR**, which stands for Light Detection and Ranging.

LIDAR operates much like radar. Its signal spreads out like a radar signal, though not as widely. Unlike radar, LIDAR must have a clear line of sight to its target vehicle throughout the entire measurement interval. Obstructions such as sign posts, utility poles, tree branches, etc., will prevent valid speed measurement.

### Some common questions about LIDAR include:

- **Does weather have any affect on LIDAR?**  
Yes. Rain, snow, smoke, fog or airborne dust particles will reduce the effective range of LIDAR and can, if dense enough, prevent its operation.
- **Can LIDAR operate through glass?**  
Yes. Newer LIDAR guns can obtain readings through most types of glass. However, the laser pulse also can be received through glass to trigger an alarm by your detector.
- **Can LIDAR operate while in motion?**  
No. Because LIDAR operates by line of sight, the person using it cannot drive the vehicle, aim and operate the gun all at the same time.
- **Is LIDAR legal to use?**  
Yes. It is legal in all 50 states.

## Maintenance

### Maintenance of Your Radar Detector

Your detector is designed and built to give you years of trouble-free performance without the need for service. No routine **Maintenance** is required.

If your unit does not appear to be operating properly, please follow these troubleshooting steps:

- Make sure the power cord is properly connected.
- Make sure the socket of your vehicle's cigarette lighter is clean and free of corrosion.
- Make sure the power cord's cigarette lighter adapter is firmly seated in your cigarette lighter.
- Check the power cord fuse. (Unscrew the ribbed end cap of the cigarette lighter adapter and examine the fuse. If required, replace it with a 2-amp fuse only.)



## Specifications

### Band and Frequencies

Band	Frequencies		
X Band	10.525	± 0.050	GHz
K Band	24.125	± 0.125	GHz
Safety Alert Traffic Warning System	24.070	± 0.010	GHz
	24.110	± 0.010	GHz
	24.190	± 0.010	GHz
	24.230	± 0.010	GHz
Ka Band	34.700	± 1.300	GHz
Ku Band	13.435	± 0.050	GHz
VG-2	11.500	± 0.250	GHz
Spectre I	13.300	± 0.200	GHz
Spectre IV+	Not Disclosed		
Laser	910	± 50	nm

This radar detector is covered by one or more of the following U.S. patents: 5,497,148; 5,594,432; 5,612,685; 6,078,279; 6,094,148. Additional patents may be listed inside the product or pending.

## Limited 1-Year Warranty

### For Products Purchased in the U.S.A.

Cobra Electronics Corporation warrants that its Cobra 14 Band Radar/Laser Detectors, and the component parts thereof, will be free of defects in workmanship and materials for a period of one year from the date of first consumer purchase. This warranty may be enforced by the first consumer purchaser, provided that the product is utilized within the U.S.A.

Cobra will, without charge, repair or replace, at its option, defective 14 Band Radar/Laser Detectors, products or component parts upon delivery to the Cobra Factory Service Department, accompanied by proof of the date of first consumer purchase, such as a duplicated copy of a sales receipt.

## Warranty (continued)

You must pay any initial shipping charges required to ship the product for warranty service, but the return charges will be at Cobra's expense, if the product is repaired or replaced under warranty.

This warranty gives you specific rights, and you may also have other rights which vary from state to state.

### Exclusions: This limited warranty does not apply:

1. To any product damaged by accident.
2. In the event of misuse or abuse of the product or as a result of unauthorized alterations or repairs.
3. If the serial number has been altered, defaced or removed.
4. If the owner of the product resides outside the U.S.A.

All implied warranties, including warranties of merchantability and fitness for a particular purpose are limited in duration to the length of this warranty.

Cobra shall not be liable for any incidental, consequential or other damages; including, without limitation, damages resulting from loss of use or cost of installation.

Some states do not allow limitations on how long an implied warranty lasts and/or do not allow the exclusion or limitation of incidental or consequential damages, so the above limitations may not apply to you.

## Product Service

For any questions about operating or installing this new Cobra product, or if parts are missing...**PLEASE CALL COBRA FIRST...**do not return this product to the store. See customer assistance on page A1.

If this product should require factory service, please call Cobra first at 773-889-3087 BEFORE sending the product. This will ensure the fastest turnaround time on any repair.

continued on page 24





### Product Service (continued)

If Cobra asks that the product be sent to its factory, the following must be furnished to have the product serviced and returned:

1. Send the complete unit, including power cord. (It is not necessary to include the mounting bracket.)
2. For warranty repair, enclose some form of proof-of-purchase, such as a photocopy or carbon copy of a sales receipt. If you send the original receipt, it cannot be returned.
3. Enclose a typed or clearly written description of the problem you are having with your unit, plus the name and address where you want the unit returned.
4. Pack the unit securely to prevent damage during transit. If possible, use the original packing materials.
5. Ship prepaid and insured using a traceable carrier such as United Parcel Service (UPS), Federal Express or Priority mail with delivery confirmation. Ship to: Cobra Factory Service, Cobra Electronics Corporation, 6500 West Cortland Street, Chicago, IL 60707 U.S.A.
6. Please allow three to four weeks before contacting us about the status of your service. Call 773-889-3087 for assistance. If your unit is under warranty, it will either be repaired or replaced upon receipt, depending on the model. If your unit is out of warranty, you will receive a letter informing you of the repair or replacement charge.

### Optional Accessories

You can find quality Cobra products and accessories at your local Cobra dealer, or in the U.S.A., you can order directly from Cobra. See ordering info on page 25.



#### Straight 12V DC Power Cord

Includes plug  
and fuse  
Item # 420-030-N-001



#### Windshield Mounting Bracket

Includes suction cups  
Item # 545-159-N-001



#### Coiled 12V DC Power Cord

Includes plug  
and fuse  
Item # 420-026-N-001



#### Dual Port Power Adapter

Includes adjustable  
plug (up to 90°)  
and fuse  
Item # CLP-2B