

COBY®

CV890

Wireless Stereo Headphone



Thank you for selecting the COBY CV-890 Wireless Stereo Headphone System.

Before operating the unit, please read this manual thoroughly and retain it for future reference, some features are:

- Wireless system that allows you to listen to a program free from the restriction of a cord.
- High fidelity sound reproduction.
- A compact transmitter with an AC power adaptor (supplied) enables simple charging of the headphone batteries. Just by placing the headphones on the transmitter, headphone batteries can be charged.
- Comfortable Circum-aural headphones with self adjusting head band.
- As power saving feature, the transmitter automatically turns ON when the audio signal is detected and OFF when the signal is not received.

Notes on Receiving Performance

The system for this equipment utilizes very high frequency signals in the 2.4GHz band so the receiving performance may deteriorate due to the surroundings. Some illustrate conditions that may reduce the possible receiving range or cause interference with reception.

- Inside a building with walls containing steel beams.
- Area with many steel file cabinets, etc.
- Area with many electrical appliances capable of generating electromagnetic noise.
- Transmitter is placed on a metal instrument.
- Area facing roadways.
- Noise or interfering signals exist in the surroundings due to radio transceivers in trucks, etc.
- Noise or interfering signals exist in the surroundings due to wireless communication systems installed along roadways.

Unpacking

Check that you have the following items when you :

Description

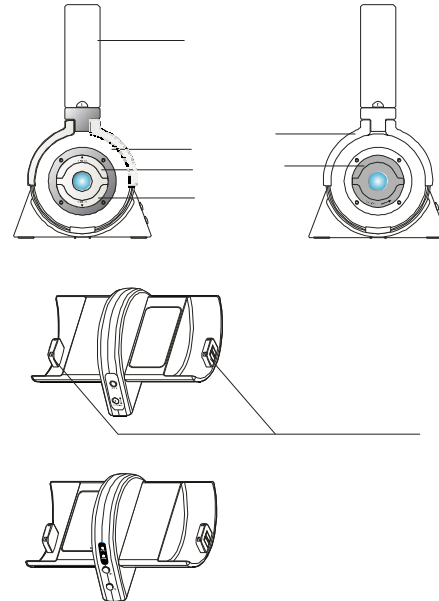

Warning

To prevent fire or shock hazard, do not expose the unit to rain or moisture.

To avoid electrical shock, do not open the cabinet. Refer servicing to qualified personnel only.

You are cautioned that any changes or modifications not expressly approved in this manual could void your authority to operate this equipment.

If you have any questions about this product, you may call: COBY Customer Service Department 1-800-681-2629, 1-718-416-3197 Or e-mail to: techsupport@cobysusa.com

FCC Rules

This equipment has been tested and found to comply with the limits for a Class B digital device, pursuant to Part 15 of the FCC rules. These limits are designed to provide reasonable protection against harmful interference in a residential installation. This equipment generates, uses and can radiate radio frequency energy and, if not installed and used in accordance with the instructions, may cause harmful interference to radio communications. However, there is no guarantee that interference will not occur in a particular installation. If this equipment does cause harmful interference to radio or television reception, which can be determined by turning the equipment off and on, the user is encouraged to try to correct the interference by one or more of the following measures:

- Reorient or relocate the receiving antenna.
- Increase the separation between the equipment and receiver.
- Connect the equipment into an outlet on a circuit different from that to which the receiver is connected.
- Consult the dealer or an experienced radio/TV technician for help.

Battery Caution

To reduce the risk of fire or injury to persons, read and follow these instructions:

- For the cordless handset, use only 3AAA 1.2V 600mAh Nickel Metal Hydride(Ni-MH), cordless telephone batteries (included).
- Do not dispose of the batteries in a fire. The cells may explode. Check with local codes for possible special disposal instructions.
- Do not open or mutilate the batteries. Released electrolyte is corrosive and may cause damage to the eyes or skin. It may be toxic if swallowed.
- Exercise care in handling batteries in order not to short the battery with conducting materials such as rings, bracelets, and keys. The battery or conductor may overheat and cause burns.
- Do not attempt to rejuvenate the batteries identified for use with this product by heating them. Sudden release of the battery electrolyte may occur causing burns or irritation to eyes or skin.
- When inserting batteries into this product, the proper polarity or direction must be observed. Reverse insertion of batteries can cause charging, and that may result in leakage or explosion.
- Remove the batteries from this product if the product will not be used for a long period of time (several months or more) since during this time the battery could leak in the product.
- Do not store this product, or the batteries identified for use with this product, in high temperature areas. Batteries that are stored in a freezer or refrigerator for the purpose of extending shelf life should be protected from condensation during storage and defrosting.

Install the batteries

The supplied rechargeable Ni-MH batteries are not charged from the first time you use them. Be sure to charge them before use. To charge, the headphones, place them on the transmitter.

- 1 Turn the battery cover according to the way of the arrowhead silk and open it.



- 2 Insert the supplied rechargeable Ni-MH batteries into the battery compartment matching the correct terminals between the batteries and the compartment.



- 3 Close the battery compartment cover according to the reverse way of the arrowhead silk.



- 4 Connect the supplied AC power adaptor to the transmitter.

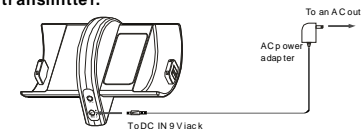

- 5 Put the headphone on the transmitter so that the headphone's contact meets the transmitter's contact pin while making sure that the charging indicator lights in red.

Charging is completed in about 16 hours and the charging indicator goes off.

When placing the headphones on the transmitter, be sure to hold them level with both hands and that the right and left housings are placed straight down on the transmitter, and then tilt them back as illustrated above.

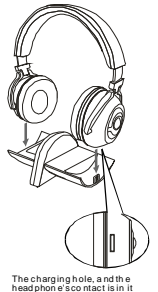

When the indicator does not light in red

Check if the right and left headphones are rested on the transmitter correctly. The indicator will not light up if the headphone's contact does not meet the transmitter's contact pin. Remove the headphones and replace them on the transmitter again so that the indicator lights in red.

Notes on Batteries

- Do not charge the dry battery.
- Do not carry a dry battery together with coins or other metallic objects. It can generate heat if the positive and negative terminals of the battery accidentally come into contact with metallic objects.
- If you are not going to use the unit for a long time, remove the battery to avoid damage from battery leakage or corrosion.

Setting up the transmitter

1 Connect the transmitter to audio/video equipment.

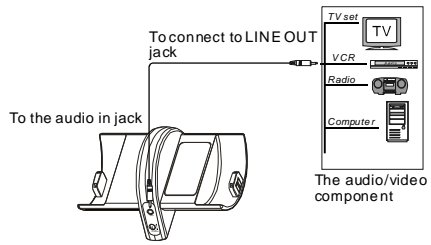

NOTE: If your audio/video component have right&left sound track stereo plug system, you can use the audio connect line and the audio conversion line to connect it.

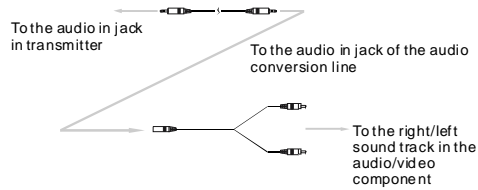

NOTE: The transmitter at a frequency that may causes interference to nearby TVs, Cordless Telephone or other wireless systems. In such case, place the transmitter away from the wireless system.

5 Turn up the volume to a moderate level with the volume UP/DOWN button.

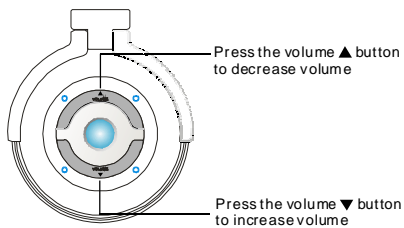

The effective areas of the transmitter

2 Connect the supplied AC power adapter to the transmitter.

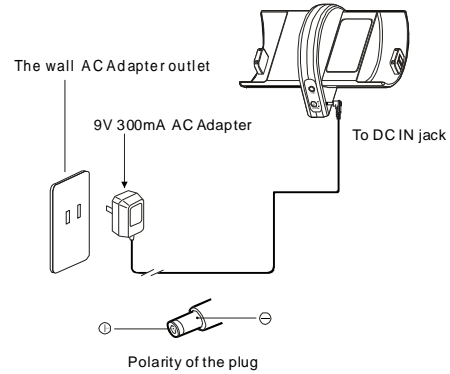

NOTE: Use only the supplied AC power adapter. Do not use any other AC power adapter. Connect the AC power adapter to a continuous power supply. Place the transmitter close the AC outlet so that you can plug the AC power adapter easily.

You can also supply the transmitter power by batteries.

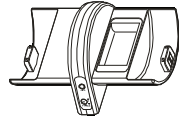

Replacing the ear pads

The ear pads are replaceable. If the ear pads become dirty or worn out, replace them as show below.

1 Remove the ear pad by pulling it out of the speaker plate.

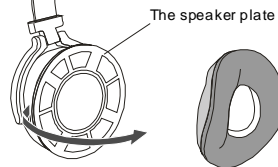

2 Clean the ear pad and replace it on the speaker plate and insert the hem of the ear pad into the groove between the plate and speaker cup.

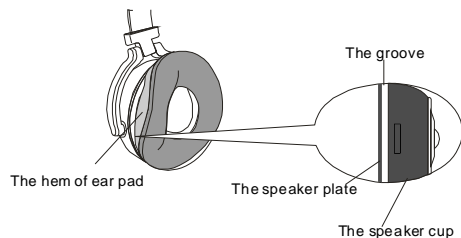

Make sure that the entire hem of the ear pad is securely inserted into the groove.

Operating the system

Listening to a program

Before listening

To prevent your ears from being damaged, first lower the volume of headphones.

- 1 Turn on the audio/video equipment connected to the transmitter. Setting the volume control of the audio source equipment as high as possible but not so high that the audio signal becomes distorted.

- 2 Remove the headphones from the transmitter and press the \uparrow button to turn on the power of transmitter.

The transmitter's IN USE indicator will light in green.

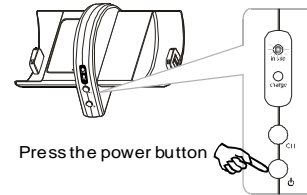

- 3 Turn on the power of headphone and put on the headphones.

The power ON/OFF switch is locate in the right headphone. You can adjust the size of the headband by pull the end of headband so that you can wire the headphones comfortably.(see the attached picture on the left page)

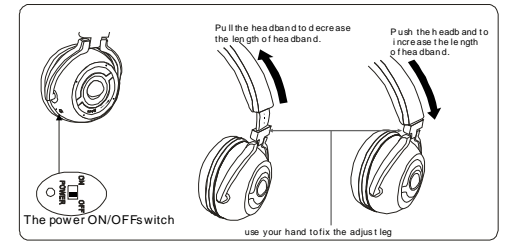

- 4 Select the radio frequency with the CHANNEL selector button.

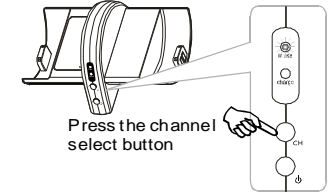

Press the CH button on the transmitter to select the clearest one to provide the best possible reception. There are 10 channels to selected.

Troubleshooting