

1.6 User Manual

BLUETREK[®]-CAR KIT



USER MANUAL

EC – Declaration of Conformity

We, Innovi Technologies Ltd of
Suite 501-3, 5/F, Chinachem Leighton Plaza,
29 Leighton Road, Causeway Bay, Hong Kong

Declare under our sole responsibility that our product

BLUETREK-CAR KIT

to which this declaration refers is in conformity with the appropriate standards

EN300 328-02
EN301 489-17
EN301 489-01
EN50371
EN60950

and follows the provisions of Radio Equipment and Telecommunication Equipment directive
1999/5/EC

April 2005

(Guillaume's signature)
Guillaume Ponticelli, Director of Development

FCC Statement

This device complies with Part 15 of the FCC rules. Operation is subject to the following two conditions. (1) This device must not cause harmful interference. (2) This device must accept any interference received, including interference that may cause undesired operation.

Caution: Changes or modifications to this Bluetooth® Car Kit not expressly approved by the party responsible for compliance could void the user's authority to operate it.

Industry Canada notice to users and product statements

To prevent radio interference with the licensed service, this device is intended for operation indoors and away from windows to provide maximum shielding. Equipment (or its transmission antenna) that is installed outdoors is subject to licensing.

In compliance with Industry Canada regulations, technical specifications have been provided in a declaration of conformity. This does not imply that Industry Canada approved the equipment.

Bluetooth® is a trademark owned by Bluetooth SIG, Inc. and is used by the manufacturer under license

1. Introduction



The BLUETREK[®]-CAR KIT is a wireless hands-free car kit based on Bluetooth[®] technology. Bluetooth[®] technology is a standard for wireless short distance radio communications, whereby devices such as hands-free kits and mobile phones can communicate with each other within approximately 10 metres.

The BLUETREK[®]-CAR KIT supports a Headset profile and a Hands-free profile, and will work with any qualified Bluetooth[®] device that supports such profiles.

The Headset and Hands-free profiles are the two audio communication profiles used by Bluetooth[®] devices such as mobile phones. Some mobile phones support only one of these profiles, while others support both. When pairing your BLUETREK[®]-CAR KIT with a dual-profile mobile phone, the Hands-free profile will normally be selected during the pairing stage. However, you can configure the device to pair in the Headset profile (please refer to the "Pairing the BLUETREK[®]-CAR KIT" section of this manual. Some mobile phones such as those from SONY ERICSSON* only have the Headset profile, whereas some, such as those from NOKIA*, only have the Hands-free profile. To find out which profile your mobile phone has, please visit our website at www.bluetrek.com or consult the mobile phone manufacturer.

Your BLUETREK[®]-CAR KIT will allow you to receive calls, initiate calls (if your phone has voice recognition), and adjust the volume without the need to touch your mobile phone. Before using your BLUETREK[®]-CAR KIT, you must pair it with a mobile phone. Please refer to the "Pairing the BLUETREK[®]-CAR KIT" section of this manual.

The BLUETREK[®]-CAR KIT has 4 buttons:

- CALL ACCEPT Button 
- CALL REJECT Button 
- VOL+ button,
- VOL- button.

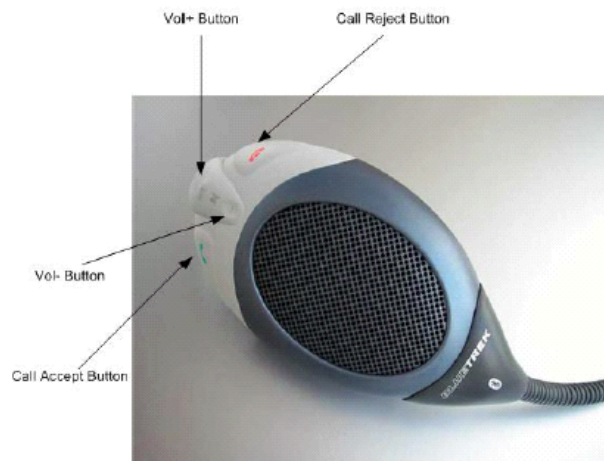

* Note: all brand names are the property of their respective owners.

2. Installing the BLUETREK®-CAR KIT

This is a plug and play Bluetooth® device that requires no installation. Simply plug your BLUETREK®-CAR KIT into the car cigarette lighter. If there is power in the car cigarette lighter (even if the car engine is not running), then the BLUETREK®-CAR KIT will start.

When the BLUETREK®-CAR KIT starts, the blue indicator light turns on briefly and a sound can be heard from the speaker.

3. Pairing the BLUETREK®-CAR KIT

Before using the BLUETREK®-CAR KIT, you must pair it with your Bluetooth® mobile phone. Pairing is the process of linking 2 Bluetooth® devices so that they can communicate. If you pair your Bluetooth® mobile phone with another Bluetooth® device, then you will have to pair the BLUETREK®-CAR KIT with your mobile phone again before using it.

IMPORTANT:

Before pairing, ensure that all other Bluetooth® devices are switched off.

To initiate the pairing,

- Place the BLUETREK®-CAR KIT and your mobile phone within 0.3 metre (1 foot) of each other.
- Make sure that no Wi-Fi equipment is operating in the vicinity.
- Switch on your phone and select its Bluetooth® discover mode (refer to the Bluetooth® mobile phone user manual).
- Press and hold the “Call Accept” button and the “Call Reject” button on the BLUETREK®-CAR KIT for about 5 seconds until a sound can be heard in the speaker and the blue indicator light flashes twice.
- Once the mobile phone detects the BLUETREK®-CAR KIT, a "BLUETREK CAR KIT" message will be displayed. Follow the phone instructions to accept the pairing. The PIN code (or passkey) is **0000**.

When the pairing is completed, the blue indicator light on your BLUETREK®-CAR KIT will flash on and off progressively, meaning that it is in standby mode and ready to use.

If your mobile phone has both the Headset and Hands-free profiles and you would like to make a pairing in the Headset profile, please take the following steps.

- Place the BLUETREK®-CAR KIT and your mobile phone within 0.3 metre (1 foot) of each other.
- Make sure that no Wi-Fi equipment is operating in the vicinity.
- Switch on your mobile phone and select its Bluetooth® discover mode (refer to the Bluetooth® mobile phone user manual).
- Press and hold the “Call Reject” button and “Vol+” button on the BLUETREK®-CAR KIT for about 5 seconds until a sound can be heard in the speaker and the blue indicator light flashes twice.
- Once the mobile phone detects the BLUETREK®-CAR KIT, a "BLUETREK CAR KIT" message will be displayed. Follow the phone instructions to accept the pairing. The PIN code (or passkey) is **0000**.

When the pairing is completed, the blue indicator light on your BLUETREK®-CAR KIT will flash on and off progressively, meaning that it is in standby mode and ready to use.

IMPORTANT:

Once the BLUETREK[®]-CAR KIT starts you can enter the pairing stage at any time by pressing the “**Call Accept**” button and the “**Call Reject**” button for about 5 seconds, or by pressing the “**Call Reject**” button and the “**Vol+**” button for about 5 seconds if you would like to pair in the Headset profile.

If you have not activated the discovery mode within 5 minutes, then the BLUETREK[®]-CAR KIT will restart and enter its standby mode. You must then begin the pairing process again.

A very limited number of Bluetooth[®] mobile phones require pairing processes that are different to those explained above. If you encounter any difficulties in pairing your BLUETREK[®]-CAR KIT with your mobile phone, then visit our website www.bluetrek.com or consult your dealer.

4. Switching the BLUETREK[®]-CAR KIT ON and OFF

Switching ON the BLUETREK[®]-CAR KIT

Simply plug your BLUETREK[®]-CAR KIT into the car cigarette lighter. If there is power in the car cigarette lighter (even if the car engine is not running), then the BLUETREK[®]-CAR KIT will start.

Switching OFF the BLUETREK[®]-CAR KIT

Remove the BLUETREK[®]-CAR KIT from the cigarette lighter. If there is no power in the car cigarette lighter, then the BLUETREK[®] Car Kit will be switched off.

5. Connecting the BLUETREK[®]-CAR KIT to your mobile phone

If the BLUETREK[®]-CAR KIT is paired to a mobile phone in the Headset profile

The connection will be automatically established when you switch the car kit off and then on again, or when you switch your mobile phone off and then on again.

If the BLUETREK[®]-CAR KIT is paired to a mobile phone in the Hands-free profile

When you switch the car kit off and then on again, the connection will be established.

If you switch the mobile phone off and then on again and the connection might not be automatically established (this depends on your mobile phone), then you need to press the “**Call Accept**” button on the BLUETREK[®]-CAR KIT to establish the connection manually.

6. Making a call

The voice recognition feature is not available on all mobile phones. However, you can always dial directly from your keypad. If your mobile phone offers the voice recognition feature, the you can make a call directly from the BLUETREK[®]-CAR KIT without touching your mobile phone.

Mobile phone with voice recognition

- Make sure the voice recognition function on your mobile phone is activated and your voice tags have been recorded with the phone. To enter these, please refer to your phone manual.
- Quickly press the **“Call Accept”** button on your BLUETREK[®]-CAR KIT (when there are no incoming or active calls) to establish the connection.
- Wait for the audio signal sent by the mobile phone (generally a short tone).
- Speak the name of the person you wish to call, as recorded in the phone’s voice tags.
- The mobile phone will dial the stored number.

Mobile without voice recognition

- Make sure that both the BLUETREK[®]-CAR KIT and the mobile phone are ON and in standby mode.
- Dial the phone number you wish to call on your mobile phone.
- After approximately 2 seconds the audio connection will be established.

7. Answering a call

When the BLUETREK[®]-CAR KIT rings, quickly press the “Call Accept” button on the BLUETREK[®]-CAR KIT.

8. Rejecting a call

Quickly press the “Call Reject” button on the BLUETREK[®]-CAR KIT to reject the call.

This function only works in the Hands-Free profile.

9. Ending a call

Quickly press the **“Call Reject”** button on the BLUETREK[®]-CAR KIT to end an active call.

10. Redialling the Last Number

Press the **“Call Accept”** button for approximately 2 seconds until you hear a beep when there are no active or incoming calls.

This function only works in the Hands-Free Profile.

11. Adjusting the volume

To increase the volume during an active call, quickly press the **“VOL+”** button on the BLUETREK[®]-CAR KIT.

To decrease the volume during an active call, quickly press the **“VOL-”** button on the BLUETREK[®]-CAR KIT.

12. Muting the microphone

To mute the microphone during an active call

Press and hold the “VOL+” button or the “VOL-” button on the BLUETREK[®]-CAR KIT for approximately 2 seconds.

A periodic tone can be heard in the speaker when the microphone is muted.

To end the mute function

When the microphone is muted, quickly press the “VOL+” button or the “VOL-” button on the BLUETREK[®]-CAR KIT. The periodic tone will end.

13. Call Waiting

The “**Call Waiting**” feature allows the user to receive a second call during a conversation. To answer the second call during an active call, quickly press the “**Call Accept**” button on the BLUETREK[®]-CAR KIT.

To toggle between the two calls quickly press the “**Call Accept**” button on the BLUETREK[®]-CAR KIT.

This function only works in the hands-free profile.

14. Transferring a call from the BLUETREK[®]-CAR KIT to your mobile phone

During an active call, press the “**Call Accept**” button on the BLUETREK[®]-CAR KIT for approximately 2 seconds. A beep will be heard in the speaker.

This function only works in the Hands-free profile.

In the Headset profile, you can simply transfer the call from your mobile phone (if this feature is provided), or turn off the BLUETREK[®]-CAR KIT by removing it from the car cigarette lighter.

15. Transferring a call from your mobile phone to the BLUETREK[®]-CAR KIT

During an active call on your mobile phone, press the “**Call Accept**” button on the BLUETREK[®]-CAR KIT for approximately 2 seconds until you hear a beep.

16. Multi-Pairing

The BLUETREK[®]-CAR KIT can be paired with two mobile phones.

To be able to use the multi-pairing function, you must first pair your BLUETREK[®]-CAR KIT with 2 mobile phones. (Please refer to the “Pairing the BLUETREK[®]-CAR KIT” section in this manual.)

16.1 Both phones paired in the Headset profile

Making a call

Mobile phones with voice recognition

Press the “Call accept” button on your BLUETREK[®]-CAR KIT when there are no incoming or active calls to establish the connection. Wait for the audio signal sent by the mobile phone (generally a short tone) then speak the name of the person you wish to call.

This function only works on the mobile phone paired last.

Mobile phones without voice recognition

Dial the phone number you wish to call on either mobile phone. After approximately 2 seconds the audio connection will be established.

Answering a call

All incoming calls on both paired phones can be picked up on the BLUETREK[®]-CAR KIT by quickly pressing its “Call accept” button.

Important:

For some mobile phones, mostly those from Nokia*, there is always a continuous connection between the BLUETREK[®]-CAR KIT and the mobile phone, in which case you will not be able to pick up a call or dial on the other phone using the BLUETREK[®]-CAR KIT. You will need to establish the connection manually on the other phone (please refer to the mobile phone user manual) but will not need to re-pair the devices.

*Note: all brand names are the property of their respective owners.

16.2 Both phones paired in the Hands-free profile or one phone paired in the Headset profile and the other paired in the Hands-free profile

In the Hands-free profile, there is always a continuous connection between your BLUETREK[®]-CAR KIT and one of the paired mobile phones. This means that you can only answer calls and dial out using the BLUETREK[®]-CAR KIT with the mobile phone that is connected. If you want to use the BLUETREK[®]-CAR KIT with the other mobile phone, then you will need to establish the connection manually (please refer to the mobile phone user manual).

17. Troubleshooting guide

The first thing you should do when encountering a problem that you cannot solve with this manual is to switch off your BLUETREK[®]-CAR KIT and your mobile phone, and switch them on again.

To find out more, please consult our website: www.bluetrek.com.

18. Guidelines for safe use

Read these guidelines before using your BLUETREK[®]-CAR KIT.

- Do not drop or try to alter the shape of your Car Kit.
- Do not expose your Car Kit to liquid or moisture.
- Do not expose your Car Kit to extreme temperatures. Temperature range: 0-40°C.
- Do not expose your Car Kit to fire or open flames.
- Do not try to disassemble your Car Kit. Service and maintenance can only be performed by authorised Bluetrek[®] dealers.
- Keep your Car Kit away from dust and dirt.
- Do not let children play with your Car Kit, because it contains small parts that could become detached and cause choking.
- Check the regulations in your area if you plan to use your Car Kit while driving.