

**User Manual**  
**OF**  
**CONTINENTAL**  
**WMI**  
**Wireless Mobile Interface**  
**D-WMI2017A**  
**D-WMI2017B**

## 1 System Description

Continental Wireless Power Charger is developed for automotive applications under the name WMI which includes three functions like:

- WPC: Wireless power charger
- NFC: Near field communication
- Coupler: GSM coupler – passive PCB structure not part of RF certification

The WMI module is shown in Fig. 1a and their implementation within a vehicle is depicted in Fig. 1b. The block diagram of WMI module is shown in Fig.3.

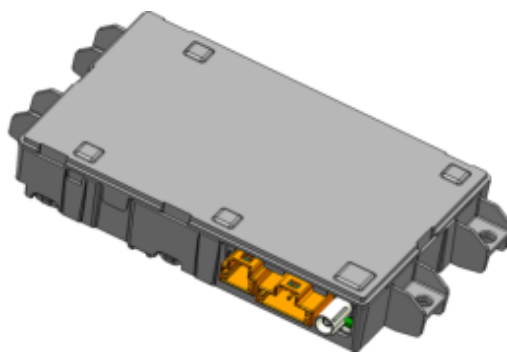

(a) Front variant

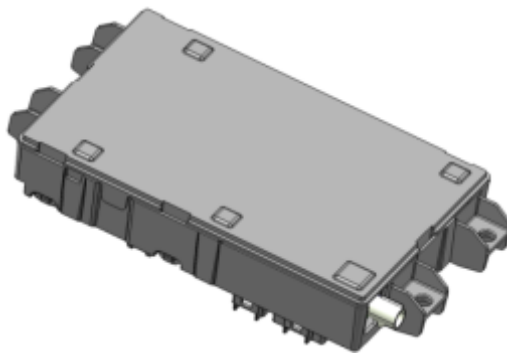

(b) Rear variant



Fig. 1 : WMI module and WMI automotive implementation on front (a) and rear (b) variants

## 2 Variants of “D-WMI2017A” and “D-WMI2017B”

The WMI Wireless Power Charger is proposed in 10 variants which are called “Platins”.

“D-WMI 2017A” includes the platins with WPC and NFC functions.

“D-WMI 2017B” includes the platins with WPC only.

The passive antenna trace of the GSM coupler on the antenna PCB is identically for all the Variants with antenna PCB but some lumped components around the Fakra connector are not populated. In addition, the NFC antenna trace is identically for all the Variants with antenna PCB. Depending on the variant, the NFC function is given by the population of the NFC stage on the main PCB.

Model Name	Variants included
<b>D-WMI2017A</b>	A2C1094850 A2C1094860 A2C1101490 A2C1101500 A2C1648860
<b>D-WMI2017B</b>	A2C1104930 A2C1104940 A2C1384530 A2C1384540 A2C1714380

## 3 System Usage

- ▶ Always stow and secure heavy, hard, pointed, sharp-edged, fragile or bulky objects in the boot/load compartment.

Observe the notes on loading the vehicle.

**⚠ WARNING** Risk of fire from placing objects in the mobile phone storage compartment

If you place objects in the mobile phone storage compartment, they may heat up excessively and even catch fire.

- ▶ Do not place additional objects, especially those made of metal, in the mobile phone storage compartment.

**ⓘ NOTE** Damage to objects caused by placing them in the mobile phone storage compartment

If you place objects in the storage compartment, these may be damaged by electromagnetic fields.

- ▶ Do not place credit cards, storage media or other objects sensitive to electromagnetic fields in the mobile phone storage compartment.
- ▶ Do not spill liquids into the mobile phone storage compartment.

### Requirements:

- Your mobile phone must be suitable for wireless charging (Qi-compatible mobile phone). You can find a list of Qi-compatible mobile phones online at: <http://www.mercedes-benz.com/connect>
- Depending on the vehicle equipment, the mobile phone is connected to the vehicle's exterior aerial via the charging module.
- The charging function and wireless connection of the mobile phone to the vehicle's exterior aerial are only available if the ignition is switched on.
- To ensure more efficient charging and connection with the exterior aerial, remove the protective cover from the mobile phone.

- Small mobile phones may not be able to be charged in every position of the stowage compartment.
- Large mobile phones which do not fit into the stowage compartment may not be able to be charged or connected with the exterior aerial.



- ▶ Place the mobile phone as close to the centre of mat **1** as possible with the display facing upwards. The mobile phone is charged automatically, as is apparent from the way in which the mobile phone reacts and from the charging symbol in the multimedia system display.

Malfunctions during the charging process are shown in the multimedia system display.

- i** The mobile phone may heat up during the charging process, especially if data services are being used at the same time. For this reason, it is possible to cool the mobile phone depending on the operating status of the air conditioning system. Cooling output depends on the position of the controller for the glove compartment cooling system (cooling output is higher when the controller is closed).
- i** To clean, mat **1** can be removed. If possible, use the mat when charging.

## NFC (only for D-WMI2017A)

Using the mobile phone with Near Field Communication (NFC)

**Requirements:**

- NFC is activated on the mobile phone (see the manufacturer's operating instructions).
- The mobile phone's screen is switched on and unlocked (see the manufacturer's operating instructions).

NFC enables short-range wireless data transfer.



▶ **To connect a mobile phone:** open storage compartment cover ①.

▶ Lightly press NFC area ② on the inside of the cover.  
The mobile phone is connected to the multimedia system.

▶ **To switch mobile phones:** lightly press the NFC area of the mobile phone (see the manufacturer's operating instructions).  
If the mobile phone has already been authorised on the multimedia system, it is now connected.

If the mobile phone is authorised on the multimedia system for the first time, it is connected after confirming the mobile phone instructions (see the manufacturer's operating instructions).

Further functions without having a mobile phone authorised on the multimedia system:

- Transferring a contact or a business card, e.g. for direct navigation to an entered address.
- Transferring a URL to the enlarged view in the multimedia system.

## 4 Regulatory Statements

This device complies with Part 15 of the FCC Rules.

Operation is subject to the following two conditions:

- (1) This device may not cause harmful interference, and
- (2) This device must accept any interference received, including interference that may cause undesired operation.

This device complies with Industry Canada license-exempt RSS standard(s).

Operation is subject to the Following two conditions :

- (1) this device may not cause interference, and
- (2) This device must accept any interference, including interference that may cause undesired operation of the device.

Le présent appareil est conforme aux CNR d'Industrie Canada applicables aux appareils radio exempts de licence.

L'exploitation est autorisée aux deux conditions suivantes :

- (1) l'appareil ne doit pas produire de brouillage, et
- (2) l'utilisateur de l'appareil doit accepter tout brouillage radioélectrique subi, même si le brouillage est susceptible d'en compromettre le fonctionnement.

**CAUTION:** Any changes or modifications not expressly approved by the party responsible for compliance could void the user's authority to operate the equipment.

This equipment should be installed and operated with minimum distance 10 cm between the radiator & your body.

Changes or modifications not expressly approved by the party responsible for compliance could void the user's authority to operate the equipment.

**ATTENTION:** Tout changement ou modification non expressément approuvé par la partie responsable de la conformité pourrait annuler l'autorisation de l'utilisateur d'utiliser l'équipement. Cet équipement doit être installé et utilisé avec une distance minimale de 10 cm entre le radiateur et votre corps.

Changement ou modification non expressément approuvé par la partie responsable de la conformité pourrait annuler l'autorisation de l'utilisateur d'utiliser l'équipement.