





## user manual



### Wireless Rear View System

Please read this manual thoroughly before operating the unit,  
and keep it for further reference.

## 1 Accessories

 <p>Sun Shield</p>		 <p>DC cable</p>
 <p>Remote Control</p>	 <p>Mount Bracket</p>	 <p>Cigarette lighter</p>

## 2 Guarantee

The statutory warranty period will be valid of one year after sold

In case of defaulted product, please contact:

- > Your retailer
- > your fitter

For repair and maintenance after sold, please include the following documents when you send back:

- A copy of the receipt with purchasing date
- A reason for the claim or description of the fault

### 3. Precautions

#### ● Storage and keeping

1. Do not expose the monitor to excessive heat or cold. The storage temperature of this device is  $-30 \sim +80^{\circ}\text{C}$ , and the operating temperature is  $-10 \sim +65^{\circ}\text{C}$ . The Humidity is Rh90%.
2. Never use this device near a bathtub, wash basin, kitchen, damp basement, swimming pool or similar place.
3. Never use this device in environments with excessive moisture, dust or smoke.
4. Avoid dropping or striking this device.
5. Avoid using this device in enclosed spaces, areas with excessive vibration or subject to severe impacts.
6. Never puncture, scratch or use abrasive cleaning materials on this device.
7. Do not place cables where they may be pinched or stepped on.
8. Leave at least a 2" space between the monitor and walls, cabinets or other objects to allow adequate air circulation around the unit.
9. The monitor is not designed to be waterproof.

#### ● Operating Precautions

1. The device may be powered by a 12 volt automotive battery or vehicle electrical system.

Make sure all cables are connected properly observe polarity. Improper cable connections may damage the monitor. Remove the power cable connections when you do not intend to use the unit

#### Warning!

1. High voltage is present within the monitor. The opening of the case should be by professionals.
2. Do not watch the video while driving unless you are monitoring the rear view camera display.

#### Special Notice

Occasionally, a few highlights or dark spots may occur on the LCD screen. This is a very common phenomenon in active matrix display technology, and doesn't necessarily indicate any defects or faults. Never try to repair this device by yourself. In case of any problems, please turn off the display at once and notify our company or authorized dealer. The monitor is a complex device. Any disassembly or modification may lead to damage and void the warranty.

#### 4.Connection Diagram

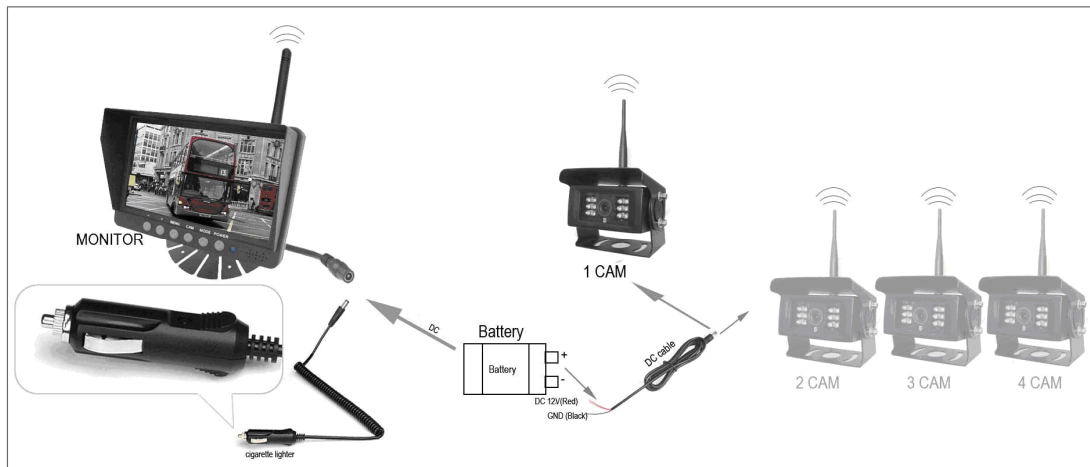

#### 5. Camera

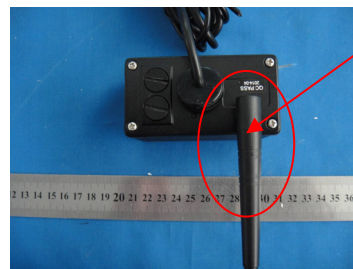

Antenna

#### Technical Specification

1/4" SONY CCD color camera

2.4GHz Digital FHSS Hopping and Pairing Technology

Resolution: NTSC: 510\*492 pixels , PAL: 510\*582 pixels\

Lens: 2.8mm

Min illumination: 0 Lux(LED on)

IR LED: 12 pcs

Night Vision distance: 15M

Waterproof rating: IP 69K

Viewing angle: 120°

Power voltage: 12V

Operation temp: -20°C ~ + 70°C

Red Light: Power indicator (Powered always bright)

Green Light: Pairing indicator (flashes when paired, successful pairing the light always bright)

Port: DC

Shell material: aluminum alloy

Bracket material: iron

Dustproof, waterproof, hydrochloric acid prevention, explosion prevention

## 6. Maintenance

1. Remove all the cable connections from the monitor before cleaning the unit.
2. Use a mild household detergent and clean the unit with a slightly damp, soft cloth. Never use strong solvents such as thinner or benzene, as they might damage the finish of the device.

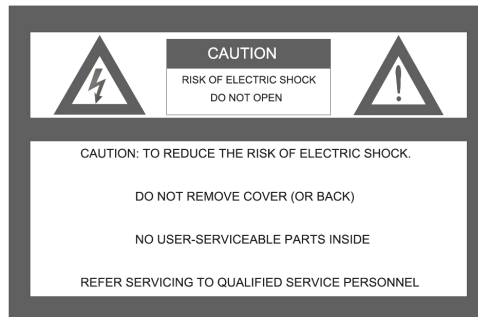

This symbol is intended to alert the user to the presence of uninsulated “dangerous voltage” within the product’s enclosure that may be of sufficient magnitude to constitute risk of electric shock to persons.



This symbol is intended to alert the user to the presence of important operating and maintenance (servicing) instructions in the literature accompanying the appliance.



This symbol is intended to alert the user not to waste electrical and electronic equipment.

## **FCC Certification Requirements**

**Caution: Any changes or modifications in construction of this device which are not expressly approved by the party responsible for compliance could void the user's authority to operate the equipment.**

**This device complies with part 15 of the FCC Rules. Operation is subject to the following two conditions: (1) This device may not cause harmful interference, and (2) This device must accept any interference received, including interference that may cause undesired operation.**

**The manufacturer is not responsible for any radio or TV interference caused by unauthorized modifications to this equipment. Such modifications could void the user's authority to operate the equipment.**

**This equipment has been tested and found to comply with the limits for a Class B digital device, pursuant to Part 15 of the FCC Rules. These limits are designed to provide reasonable protection against harmful interference in a residential installation. This equipment generates, uses and can radiate radio frequency energy and, if not installed and used in accordance with the instructions, may cause harmful interference to radio communications. However, there is no guarantee that interference will not occur in a particular installation. If this equipment does cause harmful interference to radio or television reception, which can be determined by turning the equipment off and on, the user is encouraged to try to correct the interference by one or more of the following measures:**

- Reorient or relocate the receiving antenna.**
- Increase the separation between the equipment and receiver.**
- Connect the equipment into an outlet on a circuit different from that to which the receiver is connected.**
- Consult the dealer or an experienced radio/TV technician for help.**