



pantone 432 c

HALO HOME™

SMART LIGHT ADAPTER

Control your standard light fixture with the HALO Home™ smart app



Smart Light Adapter

+



Standard Light Fixtures



HALO Home™ App



HWAD1BLE40AWH



eaton.com/halohome

1 Installation

- Install the wireless adapter in your desired location.
(See enclosed instructions sheet.)

Note: Each wireless adapter enables you to turn on, turn off, and dim a lighting device up to 15 watts.

2 Download the HALO Home app to your smart mobile device.



3 Create a user account and validate via email

- Enter your email address as your user account name.
- Select a password of at least 8 characters from the mobile application "register" screen.

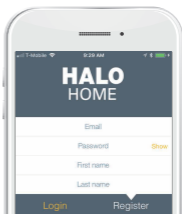

4 Adding the wireless adapter

- Select "+" on the HALO Home App screen to add the wall plug.*

** At least one HALO Home wireless adapter (or compatible device) will need to be installed and powered in order to add it to the HALO Home App device list.*

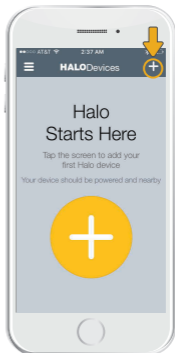

5 Adding the wireless adapter (continued)

5a) The app will search for your installed wireless adapter.

5b) Select the device and click **“Done”** to complete the pairing process.

Once the adapter has been successfully claimed, the light that it is connected to it will blink.

** During setup, ensure your HALO Home device is powered and within about 30 feet of your smart mobile device.*

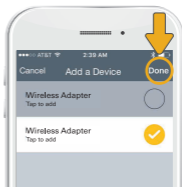

Setting up a schedule

To set up a new schedule, follow these steps:

- Once you have claimed a device, select the “⋮” icon to the right of your device’s name.
- Select the calendar icon on the slider and then select the “+” button.
- Using the dial, set your desired time.
- Select the days of the week that you want the schedule applied to.
- Select “Save” and give your schedule a unique name.



Creating a group

- At the top left, press the “⋮” menu icon and select Groups to access the new grouping page.
- Select the “+” in the center of the screen, or in the top right corner, to make your first group. Then enter a unique name for your group and select “Done.”
- Touch and drag devices from the bottom of the screen towards the top of the screen to add them to your Group. Repeat to add more and select next.
- After your group is saved, you will be brought to the “Group Settings” menu.

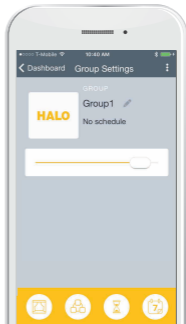

Reset to Factory Setting

- Using the wall switch, cycle the power 4 times
 - OFF for 1/2 second and ON for 5 seconds
- The light will flash twice after a successful reset.
- This procedure will unclaim the adapter.

Dimming

- Dimming in the app will match the performance of the light that the wireless adapter is installed within.

FCC

This equipment has been tested and found to comply with the limits for a Class B digital device, pursuant to part 15 of the FCC Rules. These limits are designed to provide reasonable protection against harmful interference in a residential installation. This equipment generates, uses and can radiate radio frequency energy and, if not installed and used in accordance with the instructions, may cause harmful interference to radio communications. However, there is no guarantee that interference will not occur in a particular installation. If this equipment does cause harmful interference to radio or television reception, which can be determined by turning the equipment off and on, the user is encouraged to try to correct the interference by one or more of the following measures:

- Reorient or relocate the receiving antenna.
- Increase the separation between the equipment and receiver.
- Connect the equipment into an outlet on a circuit different from that to which the receiver is connected.
- Consult the dealer or an experienced radio/TV technician for help.

This device complies with FCC radiation exposure limits set forth for an uncontrolled environment. This equipment must be installed and operated in accordance with provided instructions and the antenna(s) used for this transmitter must be installed to provide a separation distance of at least 20 cm from all persons.

This device complies with Part 15 of the FCC Rules. Operation is subject to the following two conditions:

- (1) this device may not cause harmful interference, and
- (2) this device must accept any interference received, including interference that may cause undesired operation.

CAUTION!

Any changes or modifications not expressly approved by the party responsible for compliance could void the user's authority to operate the equipment.

Bluetooth

The Bluetooth® word mark and logos are registered trademarks owned by Bluetooth SIG, Inc. and any use of such marks by Eaton is under license. Other trademarks and trade names are those of their respective owners.

Industry Canada

This device complies with Industry Canada's licence-exempt RSSs. Operation is subject to the following two conditions:

- (1) This device may not cause interference; and
- (2) This device must accept any interference, including interference that may cause undesired operation of the device.

Le présent appareil est conforme aux CNR d'Industrie Canada applicables aux appareils radio exempts de licence.

L'exploitation est autorisée aux deux conditions suivantes :

- (1) l'appareil ne doit pas produire de brouillage, et
- (2) l'utilisateur de l'appareil doit accepter tout brouillage radioélectrique subi, même si le brouillage est susceptible d'en compromettre le fonctionnement.

The device meets the exemption from the routine evaluation limits in section 2.5 of RSS 102 and compliance with RSS-102 RF exposure, users can obtain Canadian information on RF exposure and compliance.

Le dispositif rencontre l'exemption des limites courantes d'évaluation dans la section 2.5 de RSS 102 et la conformité à l'exposition de RSS-102 rf, utilisateurs peut obtenir l'information canadienne sur l'exposition et la conformité de rf.

This transmitter must not be co-located or operating in conjunction with any other antenna or transmitter. This equipment should be installed and operated with a minimum distance of 20 centimeters between the radiator and your body.

Cet émetteur ne doit pas être Co-placé ou ne fonctionnant en même temps qu'aucune autre antenne ou émetteur. Cet équipement devrait être installé et actionné avec une distance minimum de 20 centimètres entre le radiateur et votre corps.

5-Year Limited Warranty

THE FOLLOWING WARRANTY IS EXCLUSIVE AND IN LIEU OF ALL OTHER WARRANTIES, WHETHER EXPRESS, IMPLIED OR STATUTORY INCLUDING, BUT NOT LIMITED TO, ANY WARRANTY OF MERCHANTABILITY OR FITNESS FOR ANY PARTICULAR PURPOSE.

Eaton warrants to customers that, for a period of five years from the date of purchase, Eaton products will be free from defects in materials and workmanship. The obligation of Eaton under this warranty is expressly limited to the provision of replacement products. This warranty is extended only to the original purchaser of the product. A purchaser's receipt or other proof of date of original purchase acceptable to Eaton. This is required before warranty performance shall be rendered. This warranty does not apply to Eaton products that have been altered or repaired that have been subjected to neglect, abuse, misuse or accident (including shipping damages). This warranty does not apply to products not manufactured by Eaton which have been supplied, installed, and/or used in conjunction with Eaton products. Damage to the product caused by replacement bulbs or corrosion or discoloration of brass components are not covered by this warranty.

LIMITATION OF LIABILITY:

IN NO EVENT SHALL EATON BE LIABLE FOR SPECIAL, INDIRECT, INCIDENTAL, OR CONSEQUENTIAL DAMAGES

(REGARDLESS OF THE FORM OF ACTION, WHETHER IN CONTRACT, STRICT LIABILITY, OR IN TORT INCLUDING NEGLIGENCE), NOR FOR LOST PROFITS; NOR SHALL THE LIABILITY OF EATON FOR ANY CLAIMS OR DAMAGE ARISING OUT OF OR CONNECTED WITH THESE TERMS OR THE MANUFACTURE, SALE, DELIVERY, USE, MAINTENANCE, REPAIR OR MODIFICATION OF EATON PRODUCTS, OR SUPPLY OF ANY REPLACEMENT PARTS THEREFORE, EXCEED THE PURCHASE PRICE OF EATON PRODUCTS GIVING RISE TO A CLAIM. NO LABOR CHARGES WILL BE ACCEPTED TO REMOVE OR INSTALL FIXTURES.

To obtain warranty service, please contact Eaton, at 1-800-334-6871, press option 2 for Customer Service, or via e-mail ConsumerProducts@eaton.com and include the following information:

- Name, address and telephone number
- Date and place of purchase
- Catalog and quantity purchase
- Detailed description of problem

All returned products must be accompanied by a Return Goods Authorization Number issued by the Company and must be returned freight prepaid. Any product received without a Return Goods Authorization Number from the Company will be refused. Eaton is not responsible for merchandise damaged in transit. Repaired or replaced products shall be subject to the terms of this warranty and are inspected when packed. Evident or concealed damage that is made in transit should be reported at once to the carrier making the delivery and a claim filed with them. Reproductions of this document without prior written approval of Eaton are strictly prohibited.

Changes or modifications not expressly approved by the party responsible for compliance could void the user's authority to operate the equipment.

NOTE: THE MANUFACTURER IS NOT RESPONSIBLE FOR ANY RADIO OR TV INTERFERENCE CAUSED BY UNAUTHORIZED MODIFICATIONS TO THIS EQUIPMENT. SUCH MODIFICATIONS COULD VOID THE USER'S AUTHORITY TO OPERATE THE EQUIPMENT.

App Features

Características de la aplicación

HALO
HOME

EAT·N

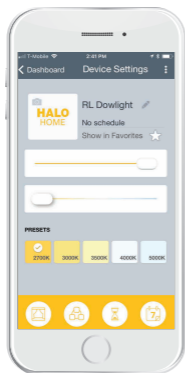

On/Off/Dim

Encendido / Apagado / Atenuado



Groups

Grupos



Schedules

Horarios



Scenes

Escenas



Adjustable Color Temperature

Temperatura de color ajustable
(2700K - 5000K)

Search for "HALO Home" in your app store.

Busque "HALO Home" en su tienda de aplicaciones.



Note: System limits user to 100 nodes, 10 scenes, 10 groups and 10 schedules.

Nota: El sistema limita al usuario a 100 productos, 10 escenas, 10 grupos y 10 programas.

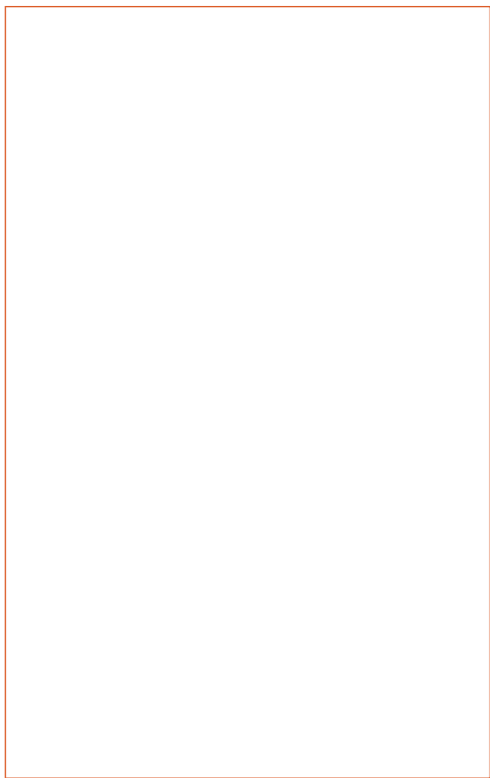

See more products at eaton.com/HALOhome

Vea más productos en eaton.com/HALOhome



Eaton is a registered trademark.
All trademarks are property
of their respective owners.

Product availability,
specifications, and compliances
are subject to change without
notice.

Eaton
1121 Highway 74 South
Peachtree City, GA 30269
P: 800-334-6871
www.eaton.com/lighting

The Eaton logo is the word 'EATON' in a bold, white, sans-serif font. The letter 'O' is stylized with a white dot in the center, and the entire logo is set against a dark blue background.

© 2018 Eaton
All Rights Reserved
Printed in China
Publication No. IB518131EN
June 20, 2018 4:28 PM