

# Operator's Manual

# CRAFTSMAN®

## PROFESSIONAL

4.4 HP (Max. Developed)

10" Inch Blade

4000 R.P.M.

## JOB SITE TABLE SAW

Model No.

137.218300

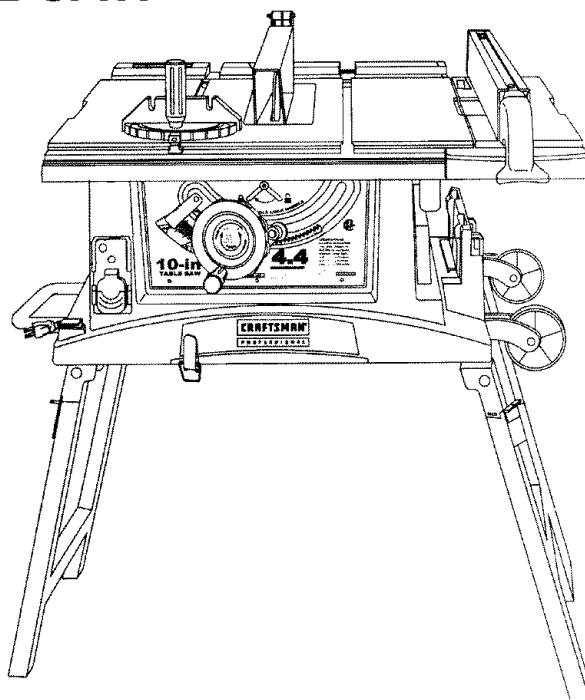

### CAUTION:

Before using this Table Saw, read this manual and follow all its Safety Rules and Operating Instructions

- Safety Instructions
- Installation
- Operation
- Maintenance
- Parts List

**Customer Help Line**  
**1-800-843-1682**

Sears, Roebuck and Co., Hoffman Estates, IL 60179 USA

Visit our Craftsman website: [www.sears.com/craftsman](http://www.sears.com/craftsman)

Part No. 13721830001

# TABLE OF CONTENTS

SECTION	PAGE	SECTION	PAGE
Warranty .....	2	Glossary of Terms .....	9
Product Specifications .....	2	Assembly and Adjustments.....	10
Power Tool Safety .....	3	Operation.....	17
Table Saw Safety.....	4	Maintenance .....	21
Electrical Requirements and Safety.....	5	Troubleshooting Guide.....	22
Accessories and Attachments.....	6	Push Stick Pattern.....	23
Tools Needed For Assembly.....	6	Parts List.....	24
Carton Contents .....	6		
Know Your Table Saw.....	8		

## WARRANTY

### FULL ONE YEAR WARRANTY

If this Table Saw fails due to a defect in material or workmanship within one year of date of purchase, Sears will at its option repair or replace it free of charge.

Return this Table Saw to a Sears Service Center for repair, or to place of purchase for replacement.

This warranty gives you specific legal rights, and you may also have other rights which may vary from state to state.

Sears, Roebuck and Co., Dept. 817 WA, Hoffman Estates, IL 60179

### WARNING

Some dust created by power sanding, sawing, grinding, drilling and other construction activities contains chemicals known to the state of California to cause cancer, birth defects or other reproductive harm. Some examples of these chemicals are:

- Lead from lead-based paints
- Crystalline silica from bricks, cement and other masonry products
- Arsenic and chromium from chemically treated lumber

Your risk from these exposures varies, depending on how often you do this type of work. To reduce your exposure to these chemicals, work in a well-ventilated area and work with approved safety equipment such as dust masks that are specially designed to filter out microscopic particles.

## PRODUCT SPECIFICATIONS

### MOTOR

HP (Maximum developed).....	4.4
Type .....	Universal
Amps .....	15
Voltage .....	120
Hz .....	60
RPM (no load).....	4000
Overload Protection.....	YES

### SAW

Table Size.....	24" x 21"
Table Extensions.....	Right & Rear
Extension Fence Capacity...	24-1/2" Right
Blade Size.....	10"
Rip Scale .....	YES
Rip Fence .....	YES
Miter Gauge.....	YES
Maximum Cut Depth @ 90°..	3-1/8"
Maximum Cut Depth @ 45°..	2-1/4"
Maximum Dado Cut Width...	13/16"
Net Weight.....	98 LBS

### WARNING

To avoid electrical hazards, fire hazards or damage to the table saw, use proper circuit protection.

This table saw is wired at the factory for 110-120 Volt operation. It must be connected to a 110-120 Volt / 15 Ampere time delay fuse or circuit breaker. To avoid shock or fire, replace power cord immediately if it is worn, cut or damaged in any way.

Before using your table saw, it is critical that you read and understand these safety rules. Failure to follow these rules could result in serious injury to you or damage to the table saw.

# POWER TOOL SAFETY

## ▲ WARNING

**Before using your table saw, it is critical that you read and understand these safety rules. Failure to follow these rules could result in serious injury or damage to the table saw.**

Good safety practices are a combination of common sense, staying alert and understanding how to use your power tool. To avoid mistakes that could cause serious injury, do not plug in your power tool until you have read and understood the following safety rules:

1. READ and become familiar with this entire Operator's Manual. LEARN the tool's applications, limitations and possible hazards.
2. **▲ WARNING**  
**Look for this symbol that identifies important safety precautions. It means CAUTION! BECOME ALERT! YOUR SAFETY IS INVOLVED!**
3. **NEVER OPERATE THIS MACHINE WITHOUT THE SAFETY GUARD IN PLACE FOR ALL THROUGH SAWING OPERATIONS.**
4. DO NOT USE IN A DANGEROUS ENVIRONMENT such as damp or wet locations or exposure to rain. Keep work area well lit.
5. DO NOT use power tools in the presence of flammable liquids or gases.
6. KEEP WORK AREA CLEAN. Cluttered areas and benches invite accidents.
7. KEEP CHILDREN AWAY. All visitors should be kept at a safe distance from the work area.
8. DO NOT FORCE THE TOOL. It will do the job better and safer at the rate for which it was designed.
9. USE THE RIGHT TOOL. Don't force the tool or attachment to do a job for which it is not designed.
10. WEAR PROPER APPAREL DO NOT wear loose clothing, gloves, neckties, rings, bracelets or other jewelry that may get caught in moving parts. Non-slip footwear is recommended. Wear protective hair covering to contain long hair.
11. WEAR A FACE MASK OR DUST MASK. Sawing, cutting and sanding operations produce dust.
12. DISCONNECT TOOLS before servicing and when changing accessories such as blades, cutters, etc.
13. REDUCE THE RISK OF UNINTENTIONAL STARTING. Make sure the switch is in the OFF position before plugging into the power supply.
14. USE ONLY RECOMMENDED ACCESSORIES. Consult the Operator's Manual for recommended accessories. The use of improper accessories may cause injury to you or damage to the tool.
15. REMOVE ADJUSTING KEYS AND WRENCHES. Form the habit of checking to see that keys and adjusting wrenches are removed from the tool before turning ON.
16. NEVER LEAVE TOOL RUNNING UNATTENDED. TURN THE POWER "OFF". Do not leave the tool before it comes to a complete stop.
17. NEVER STAND ON TOOL. Serious injury could occur if the tool is tipped or if the cutting tool is unintentionally contacted.
18. DO NOT OVERREACH. Keep proper footing and balance at all times.
19. MAINTAIN TOOLS WITH CARE. Keep tools sharp and clean for most efficient and safest performance. Follow instructions for lubricating and changing accessories.
20. CHECK FOR DAMAGED OR LOOSE PARTS. Before further use of the tool, a guard or other part that is damaged should be carefully checked to ensure it will operate properly and perform its intended function. Check for alignment of moving parts, loose binding of moving parts, mounting and any other conditions that may affect its safe operation. A guard or other part that is loose or damaged should be properly adjusted repaired or replaced.
21. MAKE WORKSHOP CHILD PROOF with padlocks, master switches or by removing starter keys.
22. DO NOT operate the tool if you are under the influence of any drugs, alcohol or medication that could impair your ability to use the tool safely.
23. USE DUST COLLECTION SYSTEM wherever possible. Dust generated from certain materials can be hazardous to your health and in some cases, a fire hazard. Always operate the power tool in a well-ventilated area with adequate dust removal.
24. ALWAYS WEAR EYE PROTECTION. Any power tool can throw foreign objects into your eyes that could cause permanent eye damage. ALWAYS wear safety goggles (not glasses) that comply with ANSI safety standard Z87.1. Everyday glasses have only impact resistant lenses. They ARE NOT safety glasses.  
**NOTE:** Glasses or goggles not in compliance with ANSI Z87.1 could cause serious injury when they break.
25. DIRECTION OF FEED. Feed work into a blade or cutter against the direction of rotation of the blade or cutter only.

# TABLE SAW SAFETY

1. ALWAYS USE SAW BLADE GUARD, splitter and anti-kickback pawls for every operation for which they can be used, including through sawing. Through sawing operations are those in which the blade cuts completely through the workpiece when ripping or crosscutting.
2. ALWAYS HOLD WORK FIRMLY against the miter gauge or rip fence.
3. USE A PUSH STICK when required. Always use a push stick especially when ripping narrow stock. Refer to ripping instructions in this Operator's Manual where the push stick is covered in detail. A pattern for making your own push stick is included on page 23.
4. **NEVER PERFORM ANY OPERATION "FREE HAND", which means using only your hands to support or guide the workpiece. Always use either the fence or the miter gauge to position and guide the work.**  
**WARNING: FREEHAND CUTTING IS THE MAJOR CAUSE OF KICK-BACK & FINGER/HAND AMPUTATIONS.**
5. NEVER STAND or have any part of your body in line with the path of the saw blade. Keep your hands out of the saw blade path.
6. NEVER REACH behind or over the cutting tool for any reason.
7. REMOVE the rip fence when crosscutting.
8. DO NOT USE a molding head with this saw.
9. FEED WORK INTO THE BLADE against the direction of rotation only.
10. NEVER use the rip fence as a cut-off gauge when crosscutting.
11. NEVER ATTEMPT TO FREE A STALLED SAW BLADE without first turning the saw OFF. Turn power switch OFF immediately to prevent motor damage.
12. PROVIDE ADEQUATE SUPPORT to the rear and the sides of the saw table for long or wide workpieces.
13. AVOID KICKBACKS (work thrown back towards you) by keeping the blade sharp, the rip fence parallel to the saw blade and by keeping the splitter, anti-kickback pawls and guards in place, aligned and functioning. Do not release work before it has passed all the way past the saw blade. Do not rip work that is twisted, warped or does not have a straight edge to guide it along the fence.
14. AVOID AWKWARD OPERATIONS and hand positions where a sudden slip could cause your hand to move into the saw blade.
15. NEVER USE SOLVENTS to clean plastic parts. Solvents could possibly dissolve or otherwise damage the material. Only a soft damp cloth should be used to clean plastic parts.
16. MOUNT your table saw on a bench or stand before performing any cutting operations. Refer to ASSEMBLY AND ADJUSTMENTS on page 10.
17. NEVER CUT METALS or materials which may make hazardous dust.
18. ALWAYS USE IN WELL-VENTILATED AREA. Remove sawdust frequently. Clean out sawdust from the interior of the saw to prevent a potential fire hazard. Attach a vacuum to the dust port for additional sawdust removal.
19. NEVER LEAVE THE SAW running unattended. Do not leave the saw until it comes to a complete stop.
20. For proper operation follow the instructions in this Operator's Manual entitled ASSEMBLY AND ADJUSTMENTS (Page 10). Failure to provide sawdust fall-through and removal hole will allow sawdust to build up in the motor area resulting in a fire hazard and potential motor damage.

# ELECTRICAL REQUIREMENTS AND SAFETY

## POWER SUPPLY REQUIREMENTS

### ▲ WARNING

To avoid electrical hazards, fire hazards or damage to the table saw, use proper circuit protection. Always use a separate electrical circuit for your tools. This power tool is wired at the factory for 120V operation. Connect it to a 120V, 15 Amp circuit and use a 15 Amp time delay fuse or circuit breaker. To avoid shock or fire, replace the cord immediately if it is worn, cut or damaged in any way.

## EXTENSION CORD REQUIREMENTS

### ▲ WARNING

Any extension cord must be **GROUND**ED for safe operation.

MINIMUM GAUGE FOR EXTENSION CORDS (AWG type / 120 Volt only)					
Ampere Rating		Total length in feet			
More Than	Not More Than	25'	50'	100'	150'
0	6	18	16	16	14
6	10	18	16	14	12
10	12	16	16	14	12
12	16	14	12	Not Applicable	

## GUIDELINES FOR EXTENSION CORDS

Any extension cord used for power tools **MUST** be grounded (3-wire with two flat prongs and one round ground prong).

Make sure the extension cord is in good condition. When using an extension cord, make sure you use one heavy enough to carry the current the tool will draw. An undersized cord will cause a drop in line voltage resulting in loss of power and overheating. The table above shows the correct size to use according to extension cord length and nameplate ampere rating. If in doubt, use the next heavier gauge cord. The smaller the gauge number the heavier the cord.

**NOTE:** The 12 to 16 amp rating is correct for this tool. It is highlighted in the table above.

Be sure your extension cord is properly wired and in good condition. Always replace a damaged extension cord or have it repaired by a qualified person before using it. Protect your extension cords from sharp objects, excessive heat and damp or wet areas.

Before connecting the saw to the extension cord, make sure the saw switch is turned OFF.

## GROUNDING INSTRUCTIONS

IN THE EVENT OF A MALFUNCTION OR BREAKDOWN, grounding provides a path of least resistance for electric current and reduces the risk of electric shock. This saw is equipped with an electric cord that has an equipment grounding conductor and a grounding plug. The plug **MUST** be plugged into a matching receptacle that is properly installed and grounded in accordance with ALL local codes and ordinances.

**DO NOT MODIFY THE PLUG PROVIDED.** If it will not fit the receptacle, have the proper receptacle installed by a qualified electrician.

**IMPROPER CONNECTION** of the equipment grounding conductor can result in risk of electric shock. The conductor (wire) with the green insulation (with or without yellow stripes) is the equipment grounding conductor. If repair or replacement of the electric cord or plug is necessary, **DO NOT** connect the equipment grounding conductor to a live terminal.

**CHECK** with a qualified electrician or service personnel if you do not completely understand the grounding instructions, or if you are not sure the saw is properly grounded.

Use only 3-wire extension cords that have 3-prong grounding plugs and 3-pole grounding receptacles that accept the saw's plug. Repair or replace damaged or worn cords immediately.

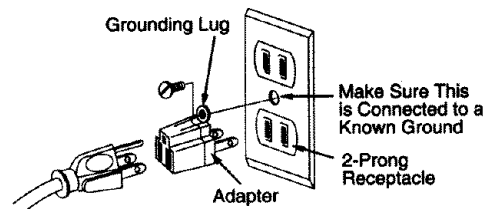
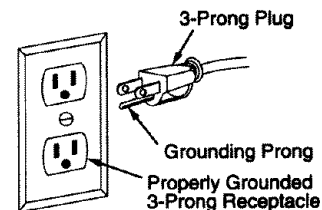

## ACCESSORIES AND ATTACHMENTS

### RECOMMENDED ACCESSORIES

#### ▲ WARNING

Visit your Sears Hardware Department or see the Craftsman Power and Hand Tools Catalog to purchase recommended accessories for this power tool.

#### ▲ WARNING

To avoid the risk of personal injury:

- Do not use a dado with a diameter larger than 8".
- Maximum dado width is 13/16". DO NOT USE WIDER COMBINATIONS.
- Do not use molding head set with this saw.
- Do not modify this power tool or use accessories not recommended by Sears.

## TOOLS NEEDED FOR ASSEMBLY

### TOOLS NEEDED

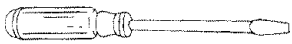

Medium screwdriver

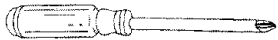

#2 Phillips screwdriver



Straight edge



4mm Hex wrench

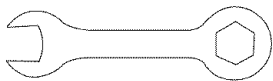

17mm Hex wrench



Adjustable wrench

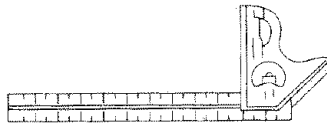

Combination square



5mm Hex wrench

## CARTON CONTENTS

### UNPACKING AND CHECKING CONTENTS

Separate all parts from packing materials. Check each part with the illustration on the next page and the "Table of Loose Parts" to make certain all items are accounted for, before discarding any packing material.

#### ▲ WARNING

If any part is missing or damaged, do not attempt to assemble the table saw, plug in the power cord, or turn the switch ON until the missing or damaged part is obtained and is installed correctly.

### TABLE OF LOOSE PARTS

<u>ITEM</u>	<u>DESCRIPTION</u>	<u>QUANTITY</u>
A.	Table saw assembly	1
B.	Rear table extension	1
C.	Rear table extension tube	2
D.	Location seat	4
E.	Blade guard and splitter	1
F.	Rubber Pad & screw	1 each
G.	Rip fence	1
H.	Dado table insert	1
I.	Miter gauge	1
J.	Push stick	1
K.	Blade wrench	1
L.	Push stick storage	1
M.	Blade	1
N.	Knob & flat washer	1 each
O.	Handwheel handle	1
P.	Hex. wrenches	2
Q.	Washers	4
R.	STAND	
	Stand assembly	1
	Hex head bolts & flat washers	4

**NOTE:** To make assembly easier, keep contents of box together. Apply a coat of automobile wax to the table. Wipe all parts thoroughly with a clean dry cloth. This will reduce friction when pushing the workpiece.

# UNPACKING YOUR JOB SITE TABLE SAW

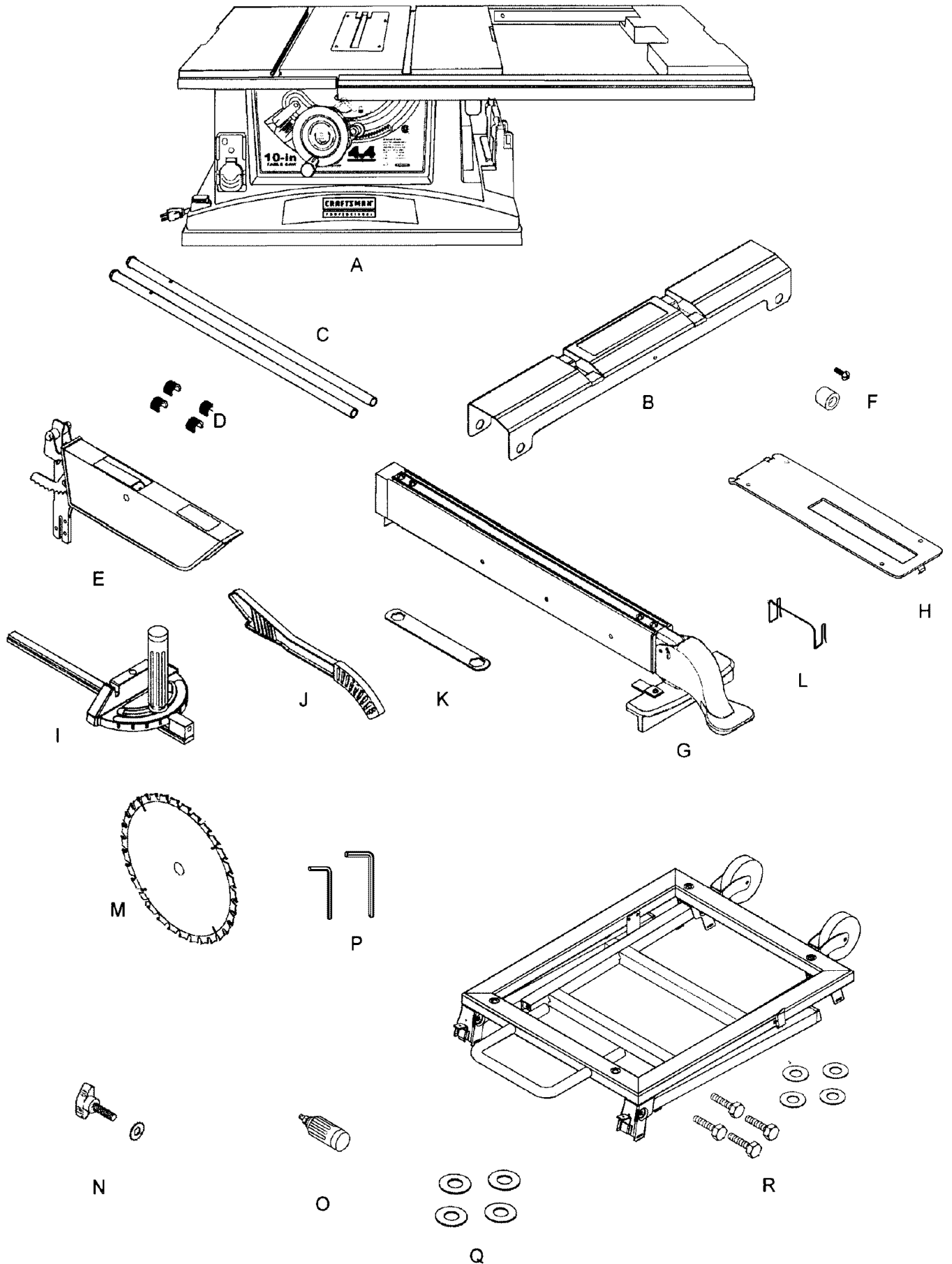

# KNOW YOUR JOB SITE TABLE SAW

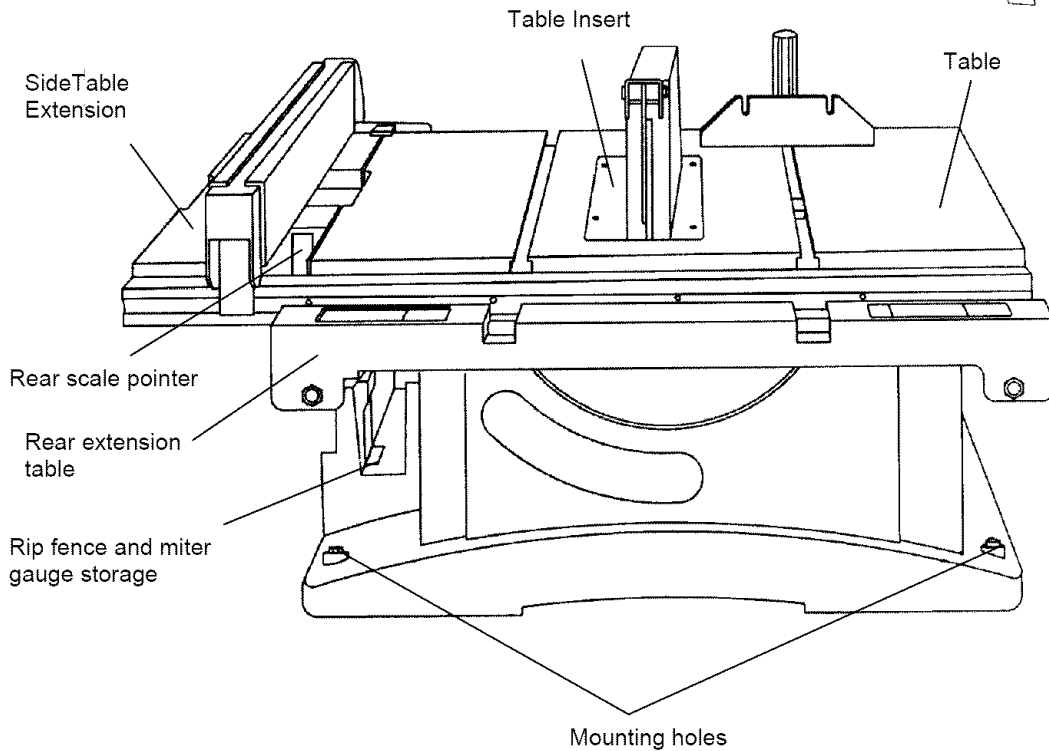
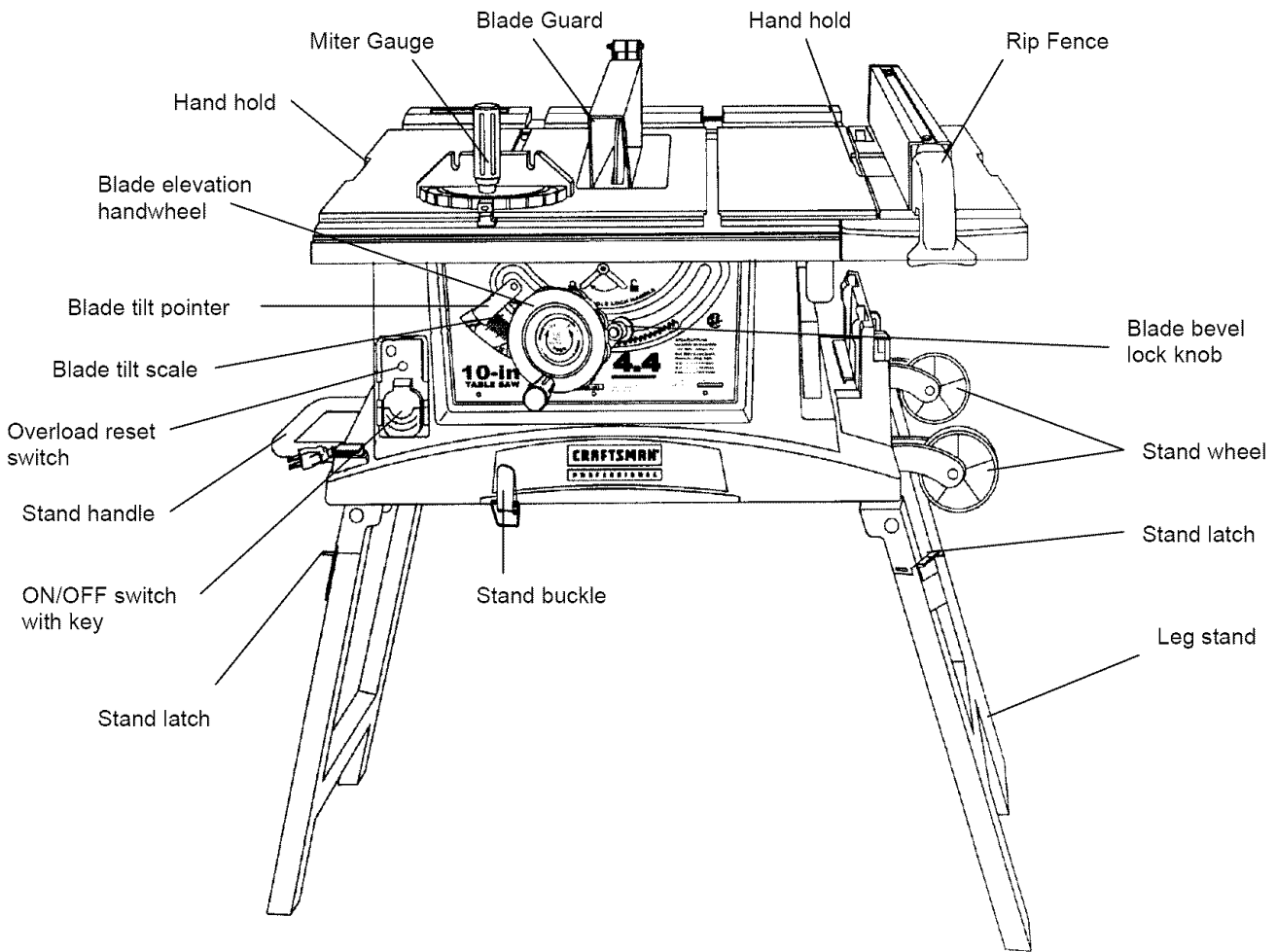



## GLOSSARY OF TERMS

### CRAFTSMAN PROFESSIONAL TABLE SAW TERMS

**MITER GAUGE** – A guide used for crosscutting operations that slides in the tabletop channels located on either side of the blade. It helps make accurate straight or angle cuts.

**RIP FENCE** – A guide used for rip cutting that clamps to the tabletop. It allows the workpiece to be straight.

**TABLE INSERT** – Provides access to the blade arbor for changing blades.

**OVERLOAD RESET SWITCH** – Resets the thermocouple and provides a way to restart the saw motor if it overheats or overloads.

**BLADE BEVEL SCALE** – Measures the angle the blade is tilted when set for a bevel cut.

**TABLE SCALE** – Measures the distance the rip fence is set from the blade, allowing quick setups.

**ANTI-KICKBACK PAWLS** – Prevents the workpiece from being kicked upward or back toward the front of the table saw by the spinning blade.

**SPLITTER** – Keeps the workpiece spread apart after being cut, to prevent binding on the blade and workpiece.

**BLADE ELEVATION HANDWHEEL** – Raises and lowers the blade.

**BLADE TILTING HANDWHEEL** – Tilts the blade to any angle between 0° to 45° for bevel cuts.

### WOODWORKING TERMS

**ARBOR** – The shaft on which a blade is mounted.

**BEVEL CUT** – An angle cut made through the face of the workpiece.

**COMPOUND CUT** – A simultaneous bevel and miter cut.

**CROSSCUT** – A cut made across the width of the workpiece.

**FREEHAND** – Performing a cut without using a fence (guide), hold down or other proper device to prevent the workpiece from twisting during the cutting operation.

**GUM** – A sticky sap from wood products.

**HEEL** – Misalignment of the blade.

**KERF** – The amount of material removed by a blade cut.

**MITER CUT** – An angle cut made across the width of the workpiece.

**RESIN** – A sticky sap that has hardened.

**REVOLUTIONS PER MINUTE (RPM)** – The number of turns completed by a spinning object in one minute.

**SAW BLADE PATH** – The area of the workpiece or table top directly in line with the travel of the blade or the part of the workpiece that will be cut.

**SET** – The distance between two saw blade tips, bent outward in opposite directions to each other. The further apart the tips are, the greater the set.

**WORKPIECE** – The item being cut. The surfaces of a workpiece are commonly referred to as faces, ends and edges.

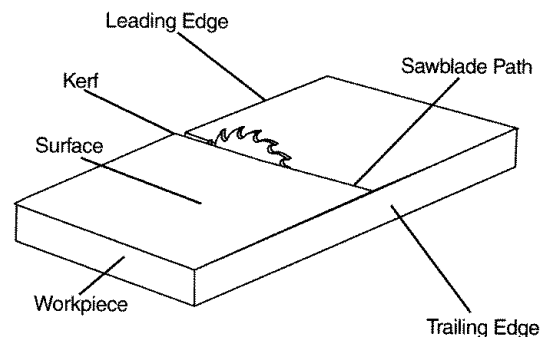

## ASSEMBLY AND ADJUSTMENTS

### ASSEMBLE THE TABLE SAW TO THE STAND (FIG. B)

1. Release the stand buckle (1) as shown.
2. Unfold the leg sets and push the two latches (2) downward to lock them in place.
3. Place the stand on a level surface and adjust the front-right adjustable foot, so all legs are contacting the floor and are at similar angles on the floor.
4. Match the holes of the stand to the holes on the bottom flange of the saw base. (Fig. B)
5. Fasten the saw to the stand using the four hex. head bolts (3) and the four flat washers (4) provided, then tighten securely with a 17mm wrench.
6. Position the saw on a clean, level surface.

Fig. B

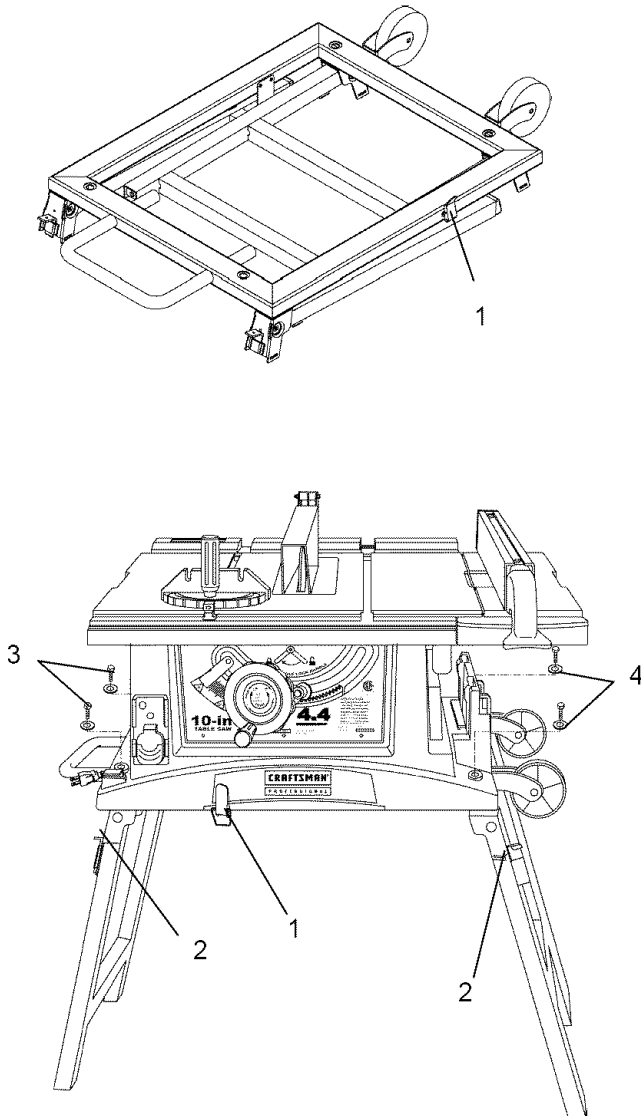

### ASSEMBLE THE HANDWHEEL HANDLE (FIG. C)

Thread the handwheel handle (1) into the handwheel hole (2), and then tighten the nut against the handwheel with a 10mm wrench. Note: If the handle bolt becomes loose, remove the plastic end cap and this will allow you to tighten securely.

Fig. C

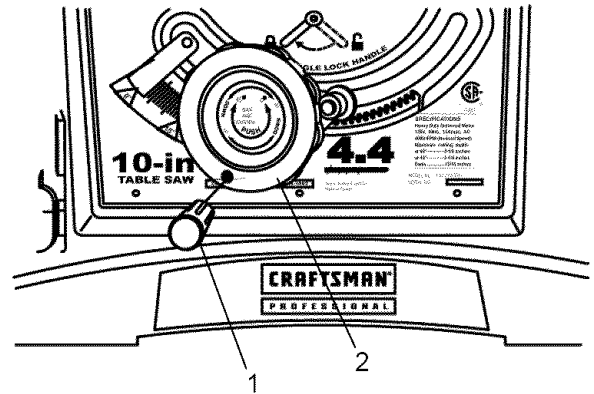

### INSTALLING THE REAR TABLE EXTENSION (FIG. D)

1. Slide the two rear table extension tubes (2) into the rear table extension (1).
2. Snap the two location seats (5) over the two rear table extension tubes (2). Make sure the locating pin in the location seat fits into the matching hole in the extension tube.
3. Insert the rear table extension tubes (2) into the two extension tube brackets under the table. Position rear table support so the hole for the rubber pad (7) is between the extension and the table (see Fig. D).
4. Insert the bolt into the rear table extension (1). Then place the rubber pad (7) onto the bolt (8) and tighten.

Fig. D

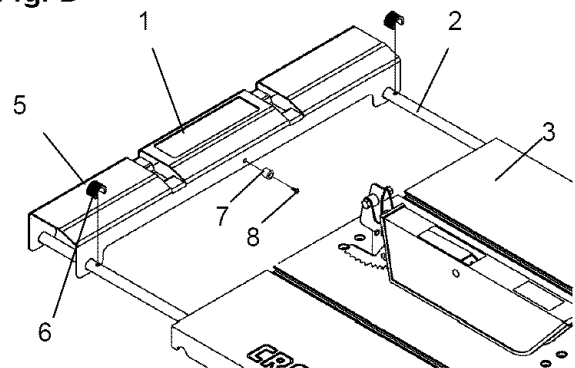

## BLADE GUARD ASSEMBLY (FIG. E, F)

### **▲ WARNING**

To avoid injury from an accidental start, make sure the switch is in the OFF position and the plug is disconnected from the power source outlet.

- When installing the blade guard, cover the blade teeth with a piece of folded cardboard to protect yourself from possible injury.
- Never operate this machine without the safety guard in place for all through sawing operations.

### Installing the blade guard assembly (Fig. E)

1. Remove the table insert.
2. With the blade elevation handwheel (1), raise the blade to the maximum height.
3. Loosen the blade lock handle (2) and move the handwheel (1) to 45° on the bevel scale.
4. Tighten the bevel lock handle.
5. Locate the splitter assembly mounting bracket (3) at the rear of the blade.
6. Cover the blade teeth with a folded cardboard or position the plastic blade guard over the blade to protect your hands.
7. Place the two kickback pawls (4) toward the rear of the table, and align the splitter mounting holes to the holes in the bracket.
8. Place the flat washer onto the blade guard lock knob and thread the knob (5) into the mounting hole, then tighten securely.
9. Return the blade to 90° and replace the table insert.

**Note:** Make sure the “anti-kick back pawls do not get caught between the insert and the guard, but rest on top of the insert.

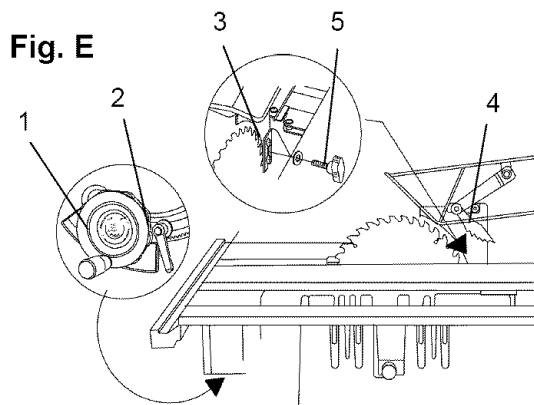

### Removing the blade guard assembly (Fig. H)

### **▲ WARNING**

To avoid injury from an accidental start, make sure the switch is in the OFF position and the plug is disconnected from the power source outlet.

1. Remove the table insert.
2. With the blade elevation handwheel (1), raise the blade to the maximum height.
3. Loosen blade lock handle (2) and move the handwheel (1) to 45° on the bevel scale.
4. Tighten the bevel lock handle.
5. Cover the blade teeth with a piece of folded cardboard or position the plastic blade guard over the blade to protect your hands.

6. Loosen the knob (5) and remove the blade guard assembly, then retighten the knob.
7. Return the blade to 90° and replace the table insert.

**Note:** Make sure the “anti-kick back pawls do not get caught between the insert and the guard, but rest on top of the insert.

### ALIGNING THE BLADE GUARD SPLITTER (FIG. F)

### **▲ WARNING**

To avoid injury from an accidental start, make sure the switch is in the OFF position and the plug is disconnected from the power source outlet.

- When installing the blade guard, cover the blade teeth with a piece of folded cardboard to protect yourself from possible injury.
- Never operate this machine without the safety guard in place for all through sawing operations.

**IMPORTANT:** The splitter must always be correctly aligned with the blade so the cut workpiece will pass on either side without binding or twisting.

1. Remove the table insert and raise the blade to the maximum height by turning the blade elevation handwheel clockwise.
2. Lift the blade guard and position it toward the rear of the table.
3. Adjust the blade to the 90° vertical position by unlocking the blade tilting lock knob and turning the bevel tilting handwheel counterclockwise, and then lock into position.
4. To see if the blade (1) and splitter (2) are correctly aligned, lay a combination square along the side of the blade and against the splitter (making sure the square is between the teeth of the blade).
5. Tilt the blade to the 45° position and check the alignment again.
6. If the blade and splitter are not correctly aligned:
  - a. Remove the blade guard by removing the wing bolt that locks the guard in place.
  - b. Loosen and remove the two bolts (3) from the mounting bracket (7).
7. Place two adhesive washers (5) on the guard mounting bracket (attached to the saw). Position them over the corresponding mounting bolt holes (refer to step 6-b) after removing the adhesive backing affixed to the washers.
8. Replace the two guard mounting bolts (3) and tighten securely. Also reattach the blade guard assembly, affixing it to the machine by its corresponding wing bolt.
9. Check the splitter and blade alignment again at both 90° and 45°.
10. Add or remove the adhesive washers until the alignment is correct.
11. Replace the table insert.

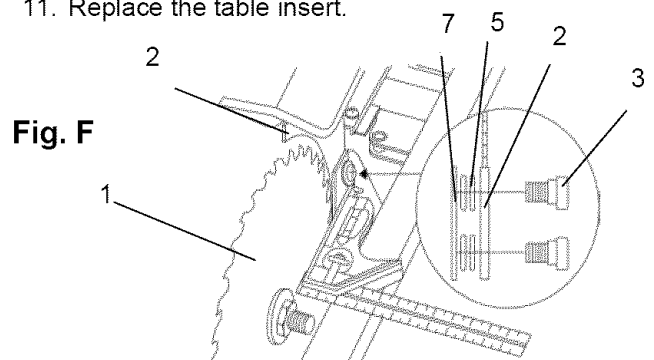

## REMOVING THE BLADE (FIG. G)

### **▲ WARNING**

To avoid injury from an accidental start, make sure the switch is in the OFF position and the plug is disconnected from the power source outlet.

1. Remove the table insert and raise the blade to the maximum height by turning the blade elevation handwheel clockwise.
2. Lift the blade guard and position it toward the rear of the table.
3. Adjust the blade to the 90° vertical position by unlocking the blade tilting lock knob and turning the bevel tilting handwheel counterclockwise, and then lock into position.
4. Pull the motor locking lever (1) toward the front of the machine while spinning the blade until the latch locks into place and the blade will no longer turn.
5. Place the blade wrench (3) on the arbor nut (4).
6. Loosen and remove the arbor nut and the flange by pulling the wrench toward the front of the machine (5).
7. Then remove the blade (6). Clean but do not remove the inner blade flange (5) before reassembling the blade.

**Fig. G**

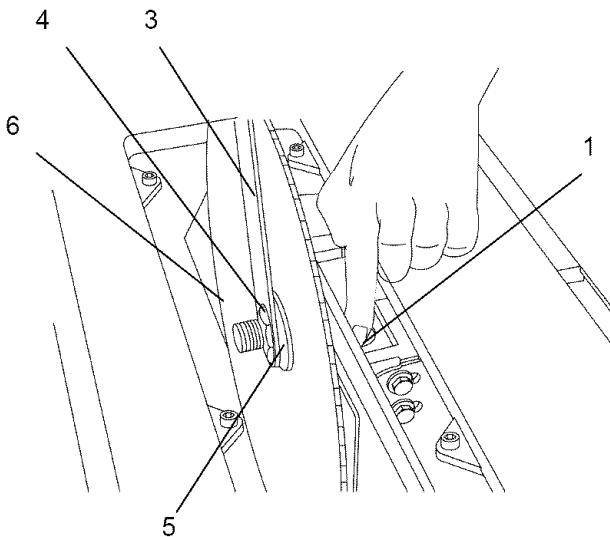

## INSTALLING A BLADE (Fig. G)

### **▲ WARNING**

To avoid injury from an accidental start, make sure the switch is in the OFF position and the plug is disconnected from the power source outlet.

1. Place the blade onto the arbor with the blade teeth pointing forward to the front of the saw.
2. Make sure the blade fits flush against the inner flange.
3. Clean the outer blade flange and install it onto the arbor and against the blade.
4. Thread the arbor nut onto the arbor, making sure the flat side of the nut is against the blade, then hand-tighten.
5. Pull the motor locking lever (1) toward the front of the machine while spinning the blade until the latch locks into place and the blade will no longer turn.
6. Place the wrench on the arbor nut and turn clockwise (toward the rear of the saw table).
7. Replace the table insert and blade guard assembly. Verify that the blade and blade guard splitter are aligned. If they are not, refer to page 12, Aligning The Blade Guard Splitter.

**IMPORTANT: Do not operate this saw until the blade and blade guard splitter are aligned and in working order.**

## ADJUSTING THE 90° AND 45° POSITIVE STOPS (FIG. H, I)

Your saw has positive stops that will quickly position the saw blade at 90° and 45° to the table. Make adjustments only if necessary.

### **90° Stop**

1. Disconnect the saw from the power source.
2. Raise the blade to the maximum elevation.
3. Loosen the blade bevel lock handle and move the blade to the maximum vertical position and tighten the bevel lock handle.
4. Place a combination square on the table and against the blade (1) to determine if the blade is 90° to the table. (Fig. H)
5. If the blade is not 90° to the table, loosen or tighten (depending on increasing or decreasing the degree) the hex screw (3) with a 5mm hex wrench until you achieve 90°. (Fig. I)
6. Then, re-loosen the bevel lock handle and reset the blade at the maximum vertical position, then tighten the bevel lock handle.
7. Check again to see if the blade is 90° to the table. If not, repeat step 5.
8. Lastly, check the bevel angle scale. If the pointer does not read 90°, loosen the screw holding the pointer and move the pointer so it is accurate at 0° and retighten the pointer screw.

**Fig. H**

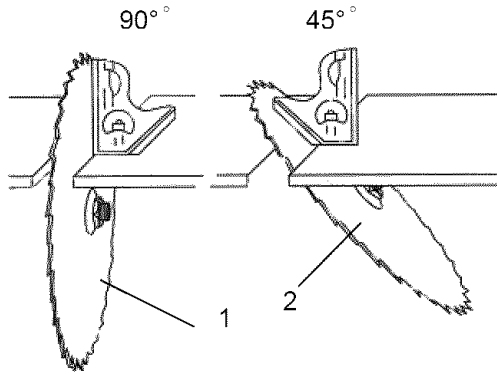

**45° Stop**

1. Disconnect the saw from the power source.
2. Raise the blade to the maximum elevation.
3. Loosen the blade bevel lock handle and move the blade to the maximum bevel position (45°) and tighten the bevel lock handle.
4. Place a combination square on the table and against the blade (1) to determine if the blade is 45° to the table. (Fig. H)
5. If the blade is not 45° to the table, loosen or tighten (depending on increasing or decreasing the degree) the hex screw (4) with a 5mm hex wrench until you achieve 45°. (Fig. I)
6. Then, re-loosen the bevel lock handle and reset the blade at the maximum bevel position (45°), then tighten the bevel lock handle.
7. Check again to see if the blade is 45° to the table. If not, repeat step 5.

**Fig. I**

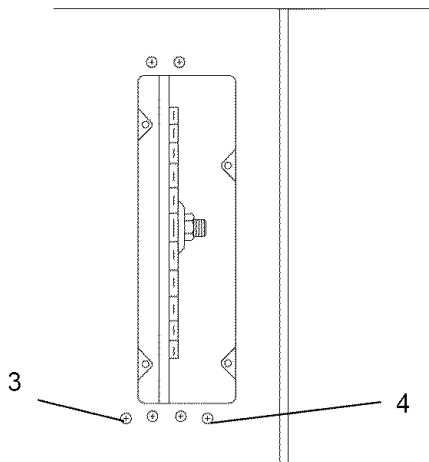

**BLADE TILTING INDICATOR**

1. When the blade is positioned at 90°, adjust the blade tilt pointer to read 0° on the scale.
2. Loosen the holding screw, position the pointer over 0° and re-tighten the mounting screw.

**NOTE:** Make a trial cut on scrap wood before making critical cuts. Measure for accuracy.

**BLADE PARALLEL TO THE MITER GAUGE GROOVE (FIG. J)**

To avoid injury from an accidental start, make sure the switch is in the OFF position and the plug is disconnected from the power source outlet.

This adjustment was made at the factory, but it should be rechecked and adjusted if necessary.

This adjustment must be correct or kickback could result in a serious injury and accurate cuts cannot be made.

1. Remove the yellow switch key and unplug the saw.
2. Raise the blade guard away from the blade.
3. Raise the blade to the maximum height and set the bevel angle at 0°
4. Select and mark with a felt tip marker, one blade tooth with a "right set" angle and position this tooth at the front of the saw approximately 1/2" above the table.
5. Place the combination square base (1) into the right side miter gauge groove (2) flush against the inside of the miter gauge groove. (Fig. J)
6. Adjust the ruler so it touches the front marked tooth and lock ruler so it holds its position in the square assembly.
7. Rotate the blade to the rear of the saw bringing the marked tooth approximately 1/2" above the blade.
8. Carefully slide the combination square to the rear until the ruler touches the marked tooth.
9. If the ruler touches the marked tooth at the front and rear position, no adjustment is needed at this time. If not, perform adjustment procedure described in next section.

**Fig. J**

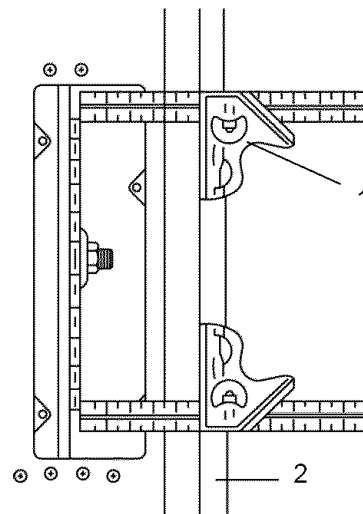

### Additional blade adjustments (Fig. K)

1. If the front and rear measurements are not the same, remove the combination square and loosen the four adjusting screws (1) on the top of the table about a half turn.
2. With a folded piece of cardboard covering the blade to protect your hands, move the blade and motor mounting rod carefully to the left or right as much as needed to align the blade correctly.
3. Tighten the four screws (1) and re-measure, as described in steps 4 to 9 in the prior section.
4. If sufficient adjustment cannot be made by the four adjusting screws (1), then also loosen the two adjusting screws (2) and repeat all previous steps. Loosen these screws only if necessary as they are set for accurate 90° and 45° settings.
5. Recheck blade clearance making sure that the blade does not hit the table insert or other parts when at the 90° and 45° settings.
6. Re-tighten all four adjusting screws (1) and reset the 90° and 45° setting as stated on page 13.

Fig. K

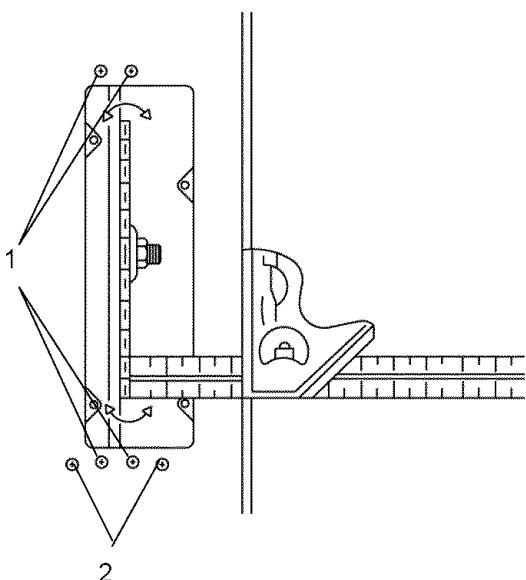

### INSTALLING THE PUSH-STICK STORAGE (FIG. L)

Attach the push-stick storage (1) into the right side of the body shell.

Fig. L

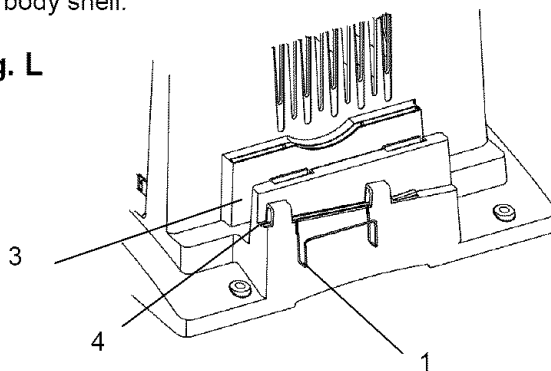

### STORAGE (FIG. L, M)

#### Rip fence and miter gauge (Fig. L)

Storage brackets for the rip fence (3) and miter gauge (4) are located on the right side of the saw housing.

#### Blade (Fig. M)

1. Loosen and remove the knob (1) on the left side of the saw housing.
2. Place extra blades onto the arbor. Replace the knob and tighten.

Fig. M

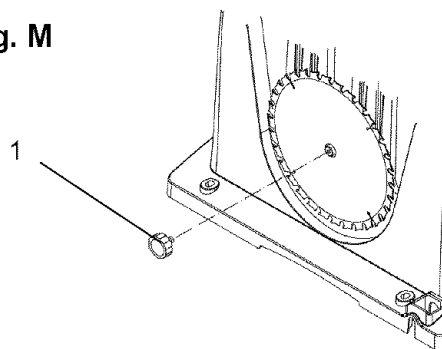

### INSTALLING THE TABLE INSERT (FIG. M-1)

The table insert has been previously installed on your unit. However, you must verify that the table insert is flush with the table top surface on all four corners of the insert.

If the table insert is not flush with the table, adjust the four bolts (1) with a 4mm hex. wrench until it is parallel with the table. **Note:** To raise the insert, turn the hex screws counterclockwise, to lower the insert, turn the hex screws clockwise.

Fig. M-1

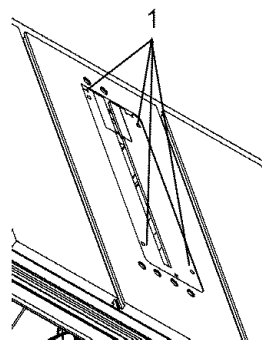

### RIP FENCE ADJUSTMENT (FIG. N)

1. For adjustments, position the fence to the right of the blade, parallel with the miter gauge groove.
2. Place the rear clamp (1) of the fence on the back rail of the table, and lower the front end over the front rail (2). Push the handle (3) down to lock.
3. To change the position of the fence, lift up on the handle to unlock, and slide the fence to the desired position, then push the handle down to lock.
4. To check the rip fence adjustment, place the fence along one edge of the miter gauge groove, and lock the handle. It should be parallel to the miter gauge groove to provide accurate cuts.

#### If adjustment is needed to make it parallel:

1. Loosen the two hex wrench bolts (4) on the top of the rip fence, and lift up on the handle (3).
2. Adjust the fence (5) so it is parallel to the miter gauge groove and lock the handle (3) into position.
3. Make sure the fence (5) is parallel to the groove and tighten the two hex wrench bolts (4) securely.
4. Unlock the fence handle (3) and slide the fence left and right, then reposition it against the miter gauge groove again lock into position to double check its' alignment.

#### If the fence is loose when the handle is in the locked position:

1. Move the handle upward to the unlocked position. Turn the adjusting screw (6) clockwise until the rear clamp is snug.
2. DO NOT turn the adjusting screw more than 1/4 turn at a time.
3. Over-tightening the screw will cause the rip fence to come out of alignment.

### **▲ WARNING**

Failure to properly align the fence can cause "kickback" and serious injury could occur.

Fig. N

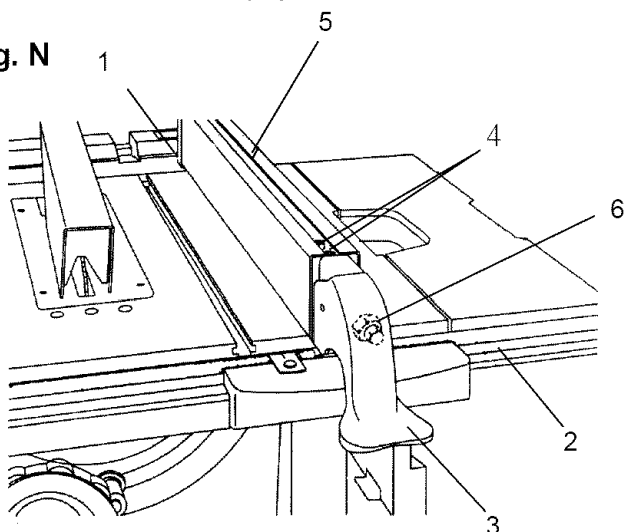

### RIP FENCE INDICATOR (FIG. O)

**NOTE:** The rip fence indicator points to the scale on the front of the table saw. Measurement shown by the indicator will provide the user with accuracy up to 1/16 of an inch. Measurement shown is the distance from the blade to the side of the fence closest to the blade.

1. To check the accuracy, measure the actual distance (1) to the side of the rip fence. If there is a difference between the measurement and the indicator, adjust the indicator as shown next.
2. Loosen the indicator screw (2). Slide the indicator to the correct measurement position on the scale, then retighten the screw (2).

Fig. O

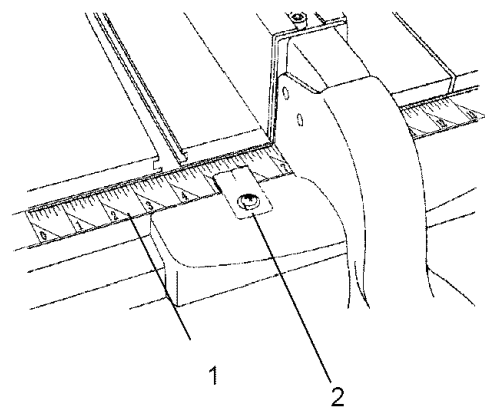

### TABLE EXTENSION SCALE POINTER (FIG. P)

The table extension scale pointer (1) should be at 13 inches on the scale when the extension is in the closed position. If not, loosen the holding screw (2), position the pointer over 13 inches and re-tighten the screw.

Fig. P

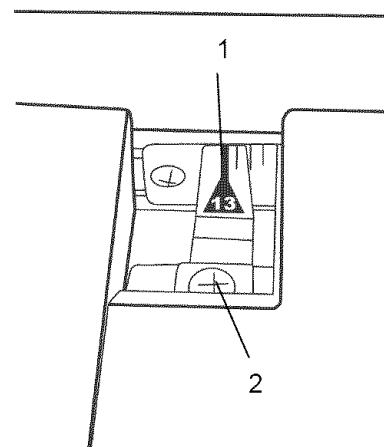

## AUTOMATIC POWER CORD RECOIL SYSTEM

### (FIG. Q)

1. To extend the power cord, release by lifting up on the locking lever, then pull the power cord to the desired length and then lock lever in position.
2. To return the cord to storage, release the locking lever, softly pull the power cord out to retract the cord fully, then lock the lever.

Fig. Q

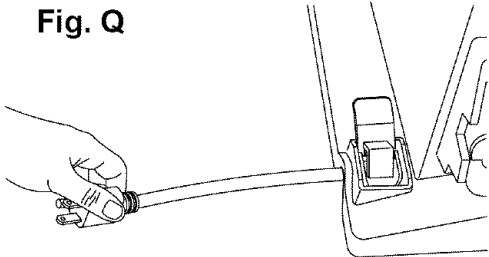

## ADJUSTING THE REAR TABLE EXTENSION

1. The rear table extension should be positioned as close as possible to the rear of the table when ripping short work pieces.
2. The rear table extension should be pulled out fully when ripping long work pieces that require extra support.

## ADJUSTING CAM LOCKING LEVER (FIG. Q-1)

If the extension table moves when it is open and locked, then the cam locking lever (1) may be loose and need adjustment, therefore, adjustment to the cam locking lever is necessary. To adjust the locking lever tension, turn the bar (2) with a 10mm wrench until it is tightened, but do not over tighten.

Fig. Q -1

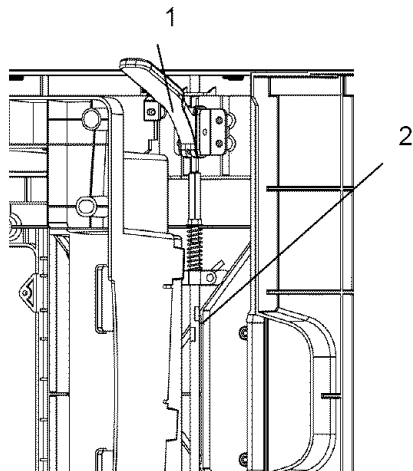

## ▲ WARNING

### SETTING UP AND FOLDING TABLE (FIG. Q-2)

Max. load 300 lbs.

1. Do not stand on, sit, or use for a ladder.
2. Make sure all four legs are locked firmly in place before using the saw.
3. Injury may occur if the user does not follow the proper procedures and warnings.

## Folding the table

1. Release the latches on the narrower (shorter) leg set (1). Hold the table and lift the saw up just above the ground and fold up the narrower (shorter) leg set. Note: The narrow leg set is held with a "spring-clip".
2. Then reposition the saw onto the ground. Release the latches (2) on the wider leg set then fold the other leg set up into position.
3. Then fasten the legs with stand buckle (3).

## Setting up the table

1. Release the stand buckle (3).
2. Unfold the wider leg set and lock the latches (2) in place.
3. With the wider leg set touching the ground, lift the saw up and unfold the narrower leg set.
4. Push the latches downward and lock into place. Make sure the saw is stable and locked in position before operation.

Fig. Q -2

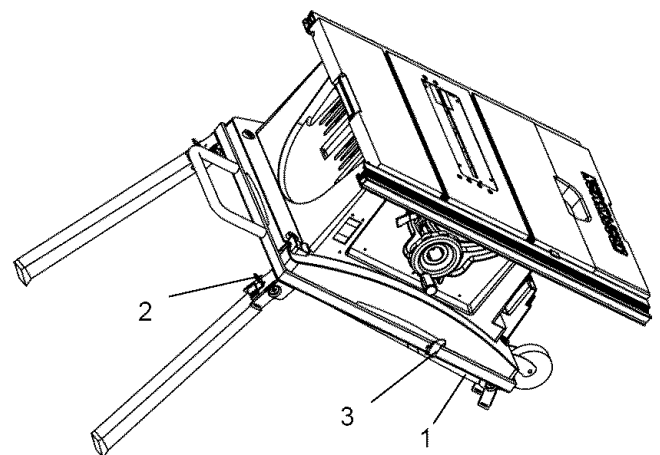

## FOLDING

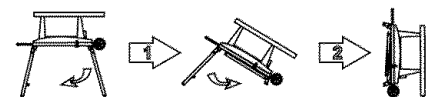

## SET-UP

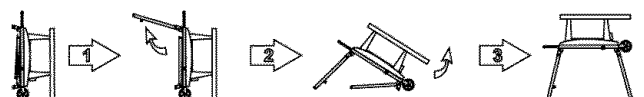

## ▲ WARNING

Injury may occur if the user does not follow proper procedures.



# OPERATION

## BASIC SAW OPERATIONS

### RAISE THE BLADE (FIG. R)

To raise or lower the blade, turn the blade elevation handwheel (1) to the desired blade height, and then tighten the bevel lock handle (2) to maintain the desired blade angle.

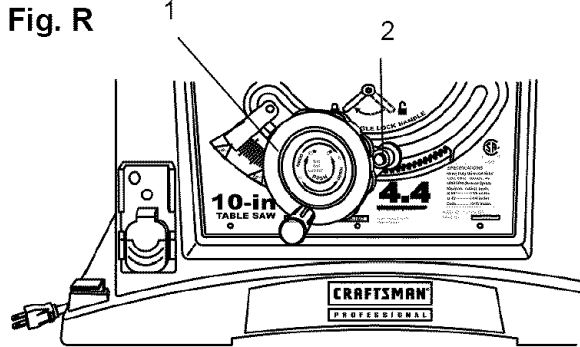

### TILTING THE BLADE

Two methods are available for tilting the saw blade.

#### Rapid blade tilting:

Loosen bevel lock handle (2), move the hand wheel (1) to the desired angle then tighten the bevel lock handle.

#### Fine adjustment blade tilting:

Loosen the bevel lock handle (2), push in the hand wheel (1) and at the same time turn the hand wheel (1) to tilt the saw blade. When the saw blade is at the desired angle, tighten the bevel lock handle (2).

### ON/OFF SWITCH (FIG. S)

The ON / OFF switch has a removal key. With the key removed from the switch, unauthorized and hazardous use by children and others is minimized.

1. To turn the saw ON, insert the safety switch key (1) into the slot in the switch (2). Move the switch upward to the ON position.
2. To turn the saw OFF, move the switch downward.
3. To lock the switch in the OFF position, grasp the end (or yellow part) of the safety switch (1), and pull it out.
4. With the switch key removed, the switch will not operate.
5. If the switch key is removed while the saw is running, it can be turned OFF but cannot be restarted without inserting the switch key (1).

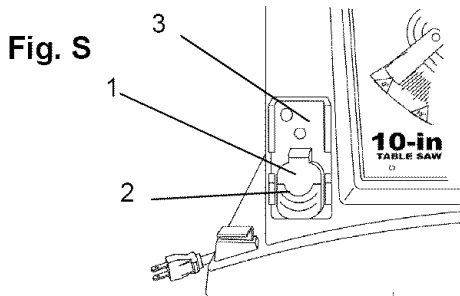

### OVERLOAD PROTECTION (FIG. S)

This saw has an overload relay button (3) that resets the motor after it shuts off due to overloading or low voltage. If the motor stops during operation, turn the ON / OFF switch to the OFF position. Wait about five minutes for the motor to cool, the push in on the reset button (3) and turn the switch to the ON position.

### USING THE DUST CHUTE (FIG. T)

#### ▲ WARNING

To prevent fire hazard, clean and remove sawdust from under the saw frequently.

To prevent sawdust buildup inside the saw housing, attach a vacuum hose (1) to the dust chute (2) at the rear of the table saw. DO NOT operate the saw with the hose in place unless the vacuum is turned on.

Fig. T

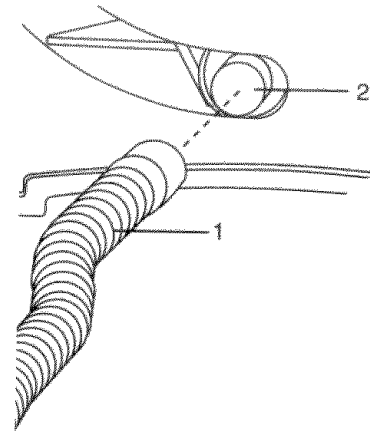

### USING THE TABLE EXTENSION (FIG. U)

**NOTE:** Use the scale on front rail for rip cuts up to 13". For rip cuts greater than 13", set and lock the fence on the 13" mark, unlock the extension table, and slide the table with the fence to the desired dimension using the scale on rear rail.

1. Release cam locking lever.
2. Slide the table extension to the desired measurement and then tighten the cam locking lever.

Fig. U

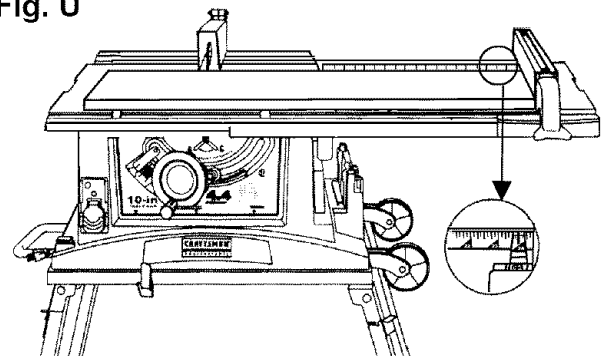

## CUTTING OPERATIONS

There are two basic types of cuts: ripping and crosscutting. Ripping is cutting along the length and the grain of the workpiece. Crosscutting is cutting either across the width or across the grain of the workpiece. Neither ripping nor crosscutting may be done safely freehand. Ripping requires the use of the rip fence, and crosscutting requires the miter gauge.

### **▲ WARNING**

Before using the saw each and every time, check the following:

1. The blade is tightened to the arbor.
2. The bevel angle lock knob is tight.
3. If ripping, the fence is locked into position & is parallel to the miter gauge groove.
4. The blade guard is in place and working properly.
5. Safety glasses are being worn.

The failure to adhere to these common safety rules, and those printed in the front of this manual, can greatly increase the likelihood of injury.

## RIPPING (FIG. V, W)

### **▲ WARNING**

To prevent serious injury:

- Never use a miter gauge when ripping.
- Do not allow familiarity or frequent use of your table saw to cause careless mistakes. Remember that even a careless fraction of a second is enough to cause a severe injury.
- Keep both hands away from the blade and clear from the path of the blade.
- The workpiece must have a straight edge against the fence and must not be warped, twisted, or bowed when ripping.

1. Remove the miter gauge and store it in the "storage" compartment in the base of the saw.
2. Secure the rip fence to the table.
3. Raise the blade so it is about 1/8" higher than the top of the workpiece.
4. Place the workpiece flat on the table and against the fence. Keep the workpiece away from the blade.
5. Turn the saw ON and wait for the blade to come to full speed.
6. Slowly feed the workpiece into the blade by pushing forward only on the workpiece section (1) that will pass between the blade and the fence. (Fig. V)

### **▲ WARNING**

**AVOID KICKBACK** by pushing forward on the section of the workpiece that passes between the blade and the fence. Never perform any freehand operations.

Fig. V

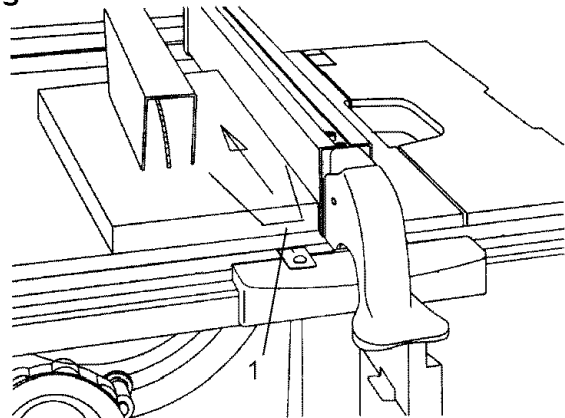

**NOTE:** Always use a push stick. When width of the rip is narrower than 2" the push stick cannot be used because the guard will interfere...therefore, use the auxiliary fence so the push stick can be used as shown on page 20.

7. Keep your thumbs off the table top. When both of your thumbs touch the front edge of the table (2), finish the cut with a push stick. To make an additional push stick, use the pattern on page 23.
8. The push stick (3) should always be used. (Fig. W)
9. Continue pushing the workpiece with the push stick (3) until it passes through the blade guard and clears the rear of the table.
10. Never pull the piece back when the blade is turning. Turn the switch OFF. When the blade completely stops, you can then remove the workpiece.

Fig. W

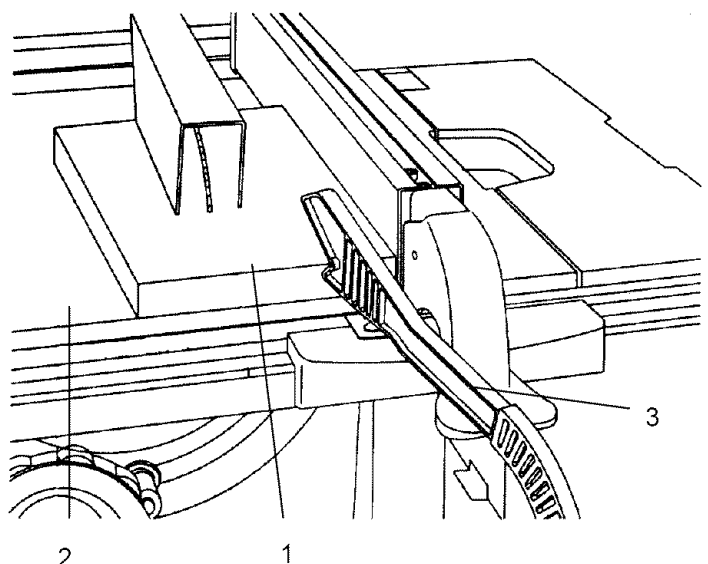

## BEVEL RIPPING

This cut is the same as ripping except the blade bevel angle is set to an angle other than "0°".

## RIPPING SMALL PIECES

To avoid injury from the blade contact, never make cuts narrower than 1/2" wide.

1. It is unsafe to rip small pieces. Instead, rip a larger piece to obtain the size of the desired piece.
2. When a small width is to be ripped and your hand cannot safely pass between the blade and the rip fence, use one or more push sticks to move the workpiece. Always use a push stick during ripping operations.

## CROSSCUTTING (FIG. X)

To prevent serious injury:

- Do not allow familiarity or frequent use of your table saw to cause careless mistakes. Remember that even a careless fraction of a second is enough to cause a severe injury.
- Keep both hands away from the blade and the path of the blade.

### ▲ WARNING

1. Remove the rip fence and place it in the "storage" compartment of the table saw base.
2. Place the miter gauge either groove in the table top.
3. Adjust the blade height so it is 1/8" higher than the top of the workpiece.
4. Hold the workpiece firmly against the miter gauge with the blade path in line with the desired cut location.
5. Start the saw and wait for the blade (1) to come up to full speed.
6. Keep the workpiece (2) against the face of the miter gauge (3) and flat against the table. Then slowly push the workpiece through the blade.
7. Do not try to pull the workpiece back with the blade turning. Turn the switch OFF, wait for the blade to come to a complete stop, then carefully slide the workpiece.

## Fig. X

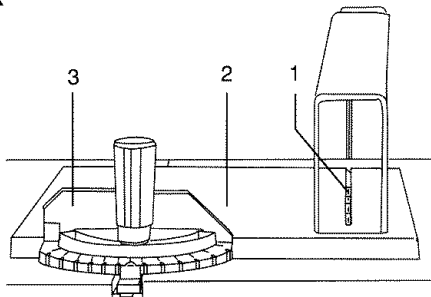

## USING WOOD FACING ON THE MITER GAUGE (Fig. X-1)

Slots are provided in the miter gauge for attaching an auxiliary facing (1) to make it easier to cut very long or short pieces. Select a suitable piece of smooth wood, drill

two holes through it and attach it to the miter gauge with screws. Make sure the facing does not interfere with the proper operation of the sawblade guard. When cutting long workpieces, you can make a simple outfeed support by clamping a piece of plywood to a sawhorse.

Fig. X-1

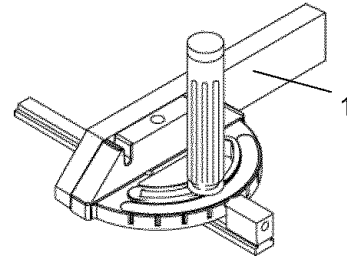

## BEVEL CROSSCUTTING (FIG. Y)

This cutting operation is the same as crosscutting except the blade is at bevel angle other than 0°.

1. Adjust the blade (1) to the desired angle, and tighten the blade bevel lock knob.
2. Always work to the left side of the blade. The miter gauge (3) must be in the right side groove unless the miter angle is very sharp, as it will interfere with the blade guard.

Fig. Y

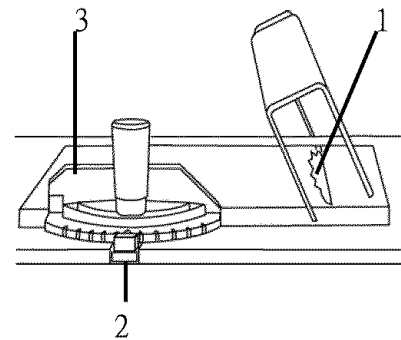

## COMPOUND MITER CROSSCUTTING (FIG. Z)

This sawing operation is combining a miter angle with a bevel angle.

1. Set the miter gauge (3) to the desired angle. Use only the left side groove for this specific operation(2).
2. Set the blade (1) bevel to the desired angle.
3. Carefully push the miter gauge to begin the cutting operation.

Fig. Z

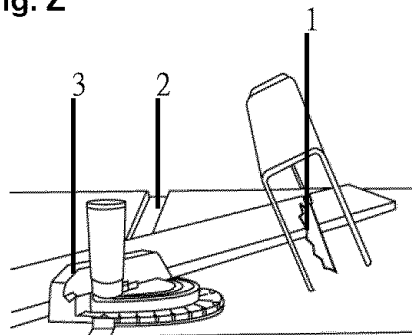

## MITERING (FIG. AA)

This sawing operation is the same as crosscutting except the miter gauge is locked at an angle other than 90°

1. Hold the workpiece (2) firmly against the miter gauge (3).
2. Feed the workpiece slowly into the blade (1) to prevent the workpiece from moving.

Fig. AA

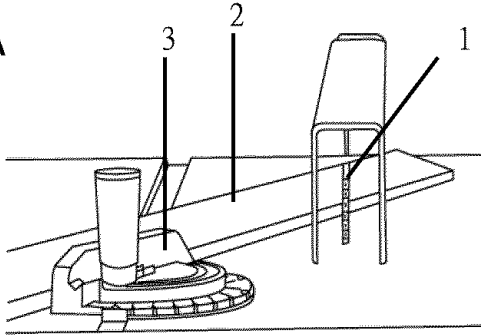

## USING WOOD FACING ON THE RIP FENCE (FIG. BB)

When performing some special cutting operations, add a wood facing (1) to the side of the rip fence between the fence and the blade where you will be cutting (2).

1. Use a smooth & straight 3/4" thick wood board (1) measure as long as the rip fence is.
2. Attach the wood facing to the fence with wood screws (3) through the holes in the fence. A wood fence should be used when ripping material such as thin paneling to prevent the material from catching between the bottom of the fence and the table.

Fig. BB

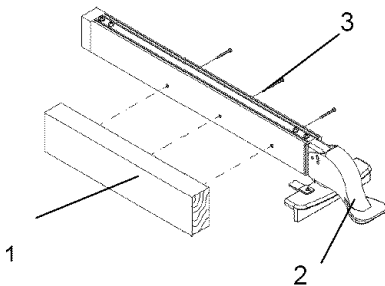

## AUXILIARY FENCE (FIG. BB-1)

### Making the base:

- Start with a piece of 3/8" plywood at least 5-1/2" wide or wider and 30" long or longer.
- Cut the piece to shape and size shown:

### Making the side:

- Start with a piece of 3/4" plywood at least 2-3/8" wide or wider and 27" long or longer
- Cut the piece to shape and size shown:

### Putting it together:

- Put the pieces together, as shown:

## ▲ WARNING

Make sure the screw heads do not stick out from the bottom of the base, they must be flush or recessed. The bottom must be flat and smooth enough to rest on the saw table without rocking.

Fig. BB-1

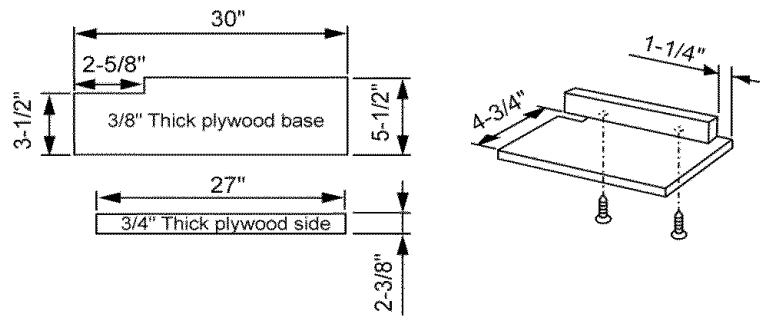

Attach auxiliary fence to rip fence with two "C" clamps. (Fig. BB-2)

Fig. BB-2

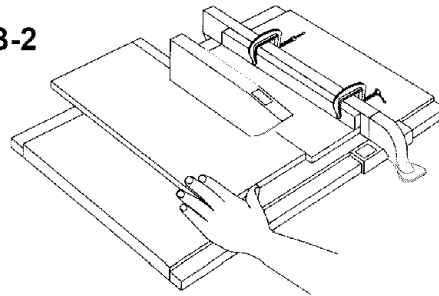

## DADO CUTS (FIG. CC)

1. The dado blade insert is included with this saw. Remove the saw blade, original table inser and blade guard. Install the dado and dado blade insert.
2. Instruction for operating the dado is packed with the separately purchased dado set.
3. The arbor (1) on this saw restricts the maximum width of the cut to 13/16".
4. When making full 13/16" dado cuts, it is not necessary to install the outside flange (2) before screwing on the arbor nut (3). Make sure that the arbor nut (3) is tight, and that at least one thread of the arbor sticks out past the nut.
5. Do not exceed 8" diameter dadoes and keep the width 13/16" or less. It will be necessary to remove the blade guard and splitter when using a dado blade. Always use caution when operating a dado blade.
6. Use only the correct number of round outside blades and inside chippers as shown in the dado set's instruction manual. Blade or chipper must not exceed 13/16".
7. Check saw to ensure that the dado will not strike the housing, insert, or motor when in operation.

## ▲ WARNING

For your own safety, always replace the blade, blade guard assembly, and blade insert when you are finished with the dado operation.

Fig. CC

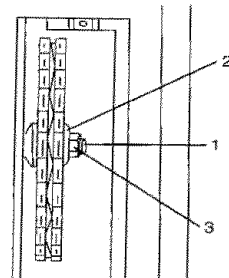

# MAINTENANCE

## MAINTAINING YOUR TABLE SAW

### GENERAL MAINTENANCE

#### **▲ WARNING**

For your own safety, turn the switch OFF and remove the switch key. Remove the plug from the power source outlet before maintaining or lubricating your saw.

1. Clean out all sawdust that has accumulated inside the saw cabinet and the motor.
2. Polish the saw table with an automotive wax to keep it clean and to make it easier to slide the workpiece.
3. Clean cutting blades with pitch and gum remover.
4. A worn, cut, or damaged power cord should be replaced immediately.

#### **▲ WARNING**

All electrical or mechanical repairs should be attempted only by a trained repair technician. Contact the nearest Sears Service Center for service. Use only identical replacement parts. Any other parts may create a hazard.

5. Use liquid dish washing detergent and water to clean all plastic parts.

**NOTE:** Certain cleaning chemicals can damage plastic parts.

6. Avoid use of cleaning chemicals or solvents, ammonia and household detergents containing ammonia.

### BLADE RAISING AND TILTING MECHANISM (FIG. DD)

After each five hours of operation, the blade raising mechanism and tilting mechanism should be checked for looseness, binding, or other abnormalities.

1. With the saw disconnected from the power source, turn the saw upside down and alternately pull upward and downward on the motor unit.
2. Observe any movement of the motor mounting mechanism. Looseness or play in the blade raising screw rod (1) should be limited to 1/8" or less.
3. If excessive looseness is observed in any other part of the blade raising mechanism or tilting mechanism, contact your local Sears Service Center immediately.

Fig. DD

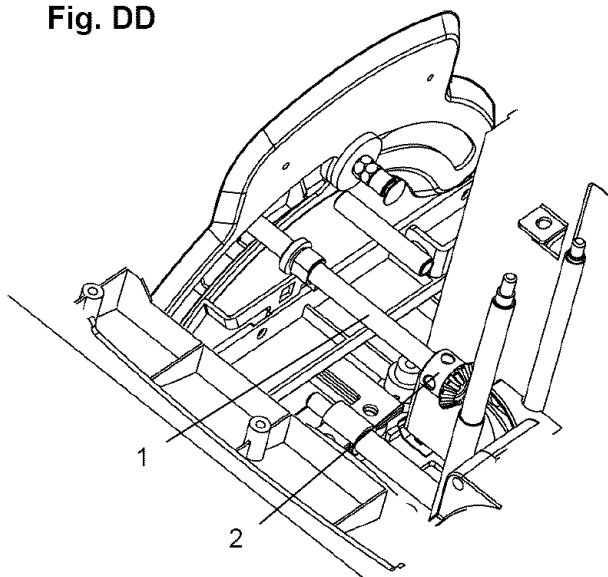

Place a small amount of dry lubricant on the bevel gear (2). The screw rod (1) must be kept clean and free of sawdust, gum, pitch, and other contaminants for smooth operations.

If excessive looseness is observed in any parts of the blade raising mechanism or tilting mechanism, contact your local Sears Service Center immediately.

### LUBRICATION

All motor bearings are permanently lubricated at the factory and require no additional lubrication.

On all mechanical parts of your table saw where a pivot or threaded rod are present, lubricate using graphite or silicone. These dry lubricants will not hold sawdust as would oil or grease.

## TROUBLESHOOTING GUIDE

### ▲ WARNING

To avoid injury from an accidental start, turn the switch OFF and always remove the plug from the power source before making any adjustments.

- Consult your local Sears Service Center if for any reason the motor will not run.

SYMPTOM	POSSIBLE CAUSES	CORRECTIVE ACTION
Saw will not start	<ol style="list-style-type: none"> <li>1. Saw not plugged in</li> <li>2. Fuse blown or circuit breaker tripped</li> <li>3. Cord damaged</li> </ol>	<ol style="list-style-type: none"> <li>1. Plug in saw</li> <li>2. Replace fuse or reset circuit breaker</li> <li>3. Have cord replaced by a Sears Service Center</li> </ol>
Does not make accurate 45° and 90° rip cuts	<ol style="list-style-type: none"> <li>1. Positive stop not adjusted correctly</li> <li>2. Tilt angle pointer not set accurately</li> </ol>	<ol style="list-style-type: none"> <li>1. Check blade with square and adjust positive stop</li> <li>2. Check blade with square and adjust to zero</li> </ol>
Material pinched blade when ripping	<ol style="list-style-type: none"> <li>1. Rip fence not aligned with blade</li> <li>2. Warped wood, edge against fence is not straight</li> </ol>	<ol style="list-style-type: none"> <li>1. Check and adjust rip fence</li> <li>2. Select another piece of wood</li> </ol>
Material binds on splitter	<ol style="list-style-type: none"> <li>1. Splitter not aligned correctly with blade</li> </ol>	<ol style="list-style-type: none"> <li>1. Check and align splitter with blade</li> </ol>
Saw makes unsatisfactory cuts	<ol style="list-style-type: none"> <li>1. Dull blade</li> <li>2. Blade mounted backwards</li> <li>3. Gum or pitch on blade</li> <li>4. Incorrect blade for work being done</li> <li>5. Gum or pitch on blade causing erratic feed</li> </ol>	<ol style="list-style-type: none"> <li>1. Replace blade</li> <li>2. Turn the blade around</li> <li>3. Remove blade and clean with turpentine and coarse steel wool</li> <li>4. Change the blade</li> <li>5. Clean table with turpentine and steel wool</li> </ol>
Material kicked back from blade	<ol style="list-style-type: none"> <li>1. Rip fence out of adjustment</li> <li>2. Splitter not aligned with blade</li> <li>3. Feeding stock without rip fence</li> <li>4. Splitter not in place</li> <li>5. Dull blade</li> <li>6. The operator letting go of material before it is past saw blade</li> <li>7. Miter/bevel angle lock knob is not tight</li> </ol>	<ol style="list-style-type: none"> <li>1. Align rip fence with miter gauge slot</li> <li>2. Align splitter with blade</li> <li>3. Install and use rip fence</li> <li>4. Install and use splitter (with guard)</li> <li>5. Replace blade</li> <li>6. Push material all the way past saw blade before releasing work</li> <li>7. Tighten knob</li> </ol>
Blade does not raise or tilt freely	<ol style="list-style-type: none"> <li>1. Sawdust and dirt in raising and tilting mechanisms</li> </ol>	<ol style="list-style-type: none"> <li>1. Brush or blow out loose dust and dirt</li> </ol>
Blade does not come up to speed	<ol style="list-style-type: none"> <li>1. Extension cord too light or too long</li> <li>2. Low house voltage</li> </ol>	<ol style="list-style-type: none"> <li>1. Replace with adequate size cord</li> <li>2. Contact your electric company</li> </ol>
Machine vibrates excessively	<ol style="list-style-type: none"> <li>1. Saw not mounted securely to workbench</li> <li>2. Bench on uneven floor</li> <li>3. Damaged saw blade</li> </ol>	<ol style="list-style-type: none"> <li>1. Tighten all mounting hardware</li> <li>2. Reposition on flat level surface Fasten to floor if necessary</li> <li>3. Replace blade</li> </ol>
Does not make accurate 45° and 90° cross cuts	<ol style="list-style-type: none"> <li>1. Miter gauge out of adjustment</li> </ol>	<ol style="list-style-type: none"> <li>1. Adjust miter gauge</li> </ol>

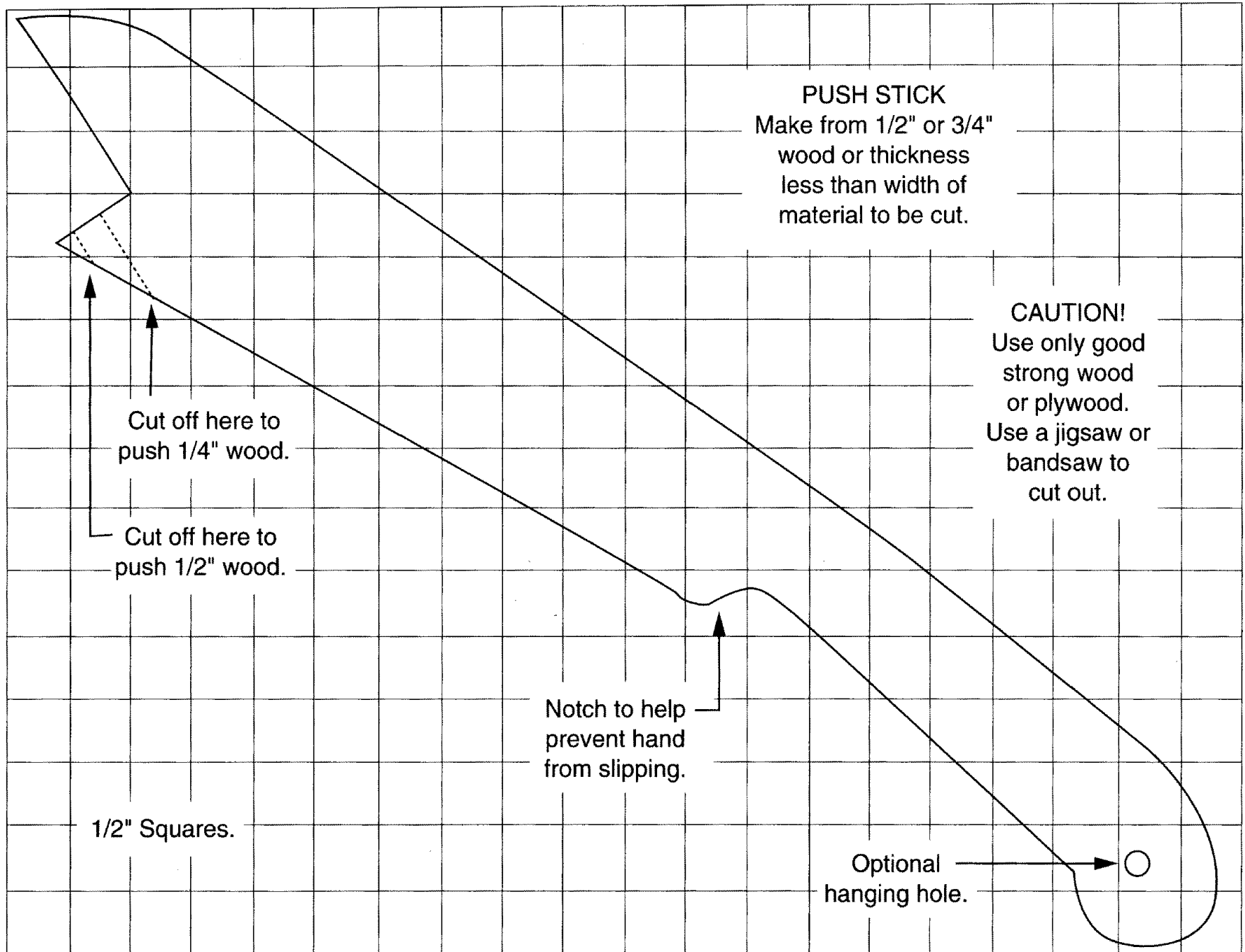

# PARTS LIST

## 10" JOB SITE TABLE SAW PARTS LIST

MODEL NO. 137.218300

### ▲ WARNING

When servicing use only CRAFTSMAN replacement parts. Use of any other parts may create a HAZARD or cause product damage.

### ▲ WARNING

Any attempt to repair or replace electrical parts on this Table Saw may create a HAZARD unless repair is done by a qualified service technician. Repair service is available at your nearest Sears Service Center.

Always order by PART Number, not by key number.

### Schematic A

I.D.	Description	Size	Qty	I.D.	Description	Size	Qty
08ZK	FLAT WASHER		4	10JR	LOCATING BAR		1
09XJ	COMPRESSION SPRING		1	10JS	ROLL PIN		1
0B8A	WARNING STICK LABEL		1	10JT	HANDLE		1
0B9M	STRAP		1	10JU	ANCHOR PLATE		2
0BC2	LOCATION SEAT	#06	4	10JV	LOCATING BAR		1
0BCK	SLIDING BASE	#06	1	10JW	LOCATING BAR		1
0BCW	UPER TUBE		2	10JX	INSERT		1
0FLT	ANCHOR BLOCK	#06	2	10JY	SPACER		2
0J4D	FLAT WASHER	φ 5*10-1	2	10JZ	SIDE COVER	#06	2
0J4D	FLAT WASHER	φ 5*10-1	4	10K0	RAIL		1
0J4E	FLAT WASHER	φ 6*13-1	1	10K1	INSERT		1
0J78	FLAT WASHER	1/4*1/2-3/32	1	10K2	BUSH	#06	2
0J95	SPRING WASHER	φ 6	1	10K4	PARALLEL PIN		2
0JED	C-RING	A-16	2	10K5	HEX. SOC. HD. CAP BOLT	M5*0.8-8	4
0JYN	HEX. SOC. COUNTERSUNK HD. SCREW	M6*1.0-25	4	10K6	HEX. SOC. HD. CAP BOLT	M6*1.0-30	2
0K2B	HEX.SOCKET HD.CAP SCREWS	M6*1.0-16	4	10K8	RIP FENCE ASS'Y		1
0K3F	CR.RE. PAN HD. SCREW & WASHER	M5*0.8-20	1	10L8	BLADE GUARD ASS'Y		1
0K6U	CR.-RE. TRUSS HD. SCREW	M4X0.7-8	1	10L9	SPLITTER		1
0K71	CR.-RE. TRUSS HD. SCREW	M5*0.8-8	1	10LB	BOLT CLAMP	#06	1
0KCX	CR-RE PAN HD PLAIN WASHER TAPPING SCREW	M5*0.8-10	6	10LE	CR. RE. TRUSS HD. ROUND NECK SCREW	M5*0.8-16	2
0KCX	CR-RE PAN HD PLAIN WASHER TAPPING SCREW	M5*0.8-10	2	20GJ	BRACKET STOP	#06	1
0KCY	CR-RE PAN HD PLAIN WASHER TAPPING SCREW	M5*0.8-12	4	20Y0	SLIDING BASE ASS'Y		1
0KCY	CR-RE PAN HD PLAIN WASHER TAPPING SCREW	M5*0.8-12	4	20YR	CAUTION LABEL		1
0K CZ	CR-RE PAN HD PLAIN WASHER TAPPING SCREW	M5*0.8-16	2	20YS	CAUTION LABEL		1
0KDJ	CR. RE. PAN HD. SCREW	M5*0.8-12	1	20YX	SLIDING BASE ASS'Y		1
0KDL	CR. RE. PAN HD. SCREW	M5*0.8-18	1	213B	SPACER	40*5	4
0KDM	CR. RE. PAN HD. SCREW	M5*0.8-20	2	21CX	FOLLOWER PLATE		1
0KMS	HEX. NUT	M6*1.0 T=5	1	22JY	RAIL		1
0KQW	NUT CHUCK	M5*0.8 T=5	1	239T	CR.RE. PAN HEAD TAPPING & WASHER SCREW	M5*0.8-16	2
0KQW	NUT CHUCK	M5*0.8 T=5	2	239T	CR.RE. PAN HEAD TAPPING & WASHER SCREW	M5*0.8-16	2
0T01	RUBBER PAD	#06	1	28BN	COVER	#06	1
10J7	SPLITTER BRACKET		1	28C3	RACK		1
10JF	EXTENTION WING		1	28EX	NEEDLE POINTER		1
10JH	HANDLE	#23	3	28FL	SCALE ASS'Y		1
10JJ	TABLE		1	28LE	SCALE		1
10JK	SIDE COVER	#06	1	29R2	WARNING LABEL		2
10JL	RACK		1	29R5	WARNING LABEL		1
10JN	SET PLATE		2	29R8	LABEL		1
10JP	SIDE COVER	#06	1	29R9	CUSHION	#06	1
10JQ	TABLE		1				



10" JOB SITE TABLE SAW  
Schematic A

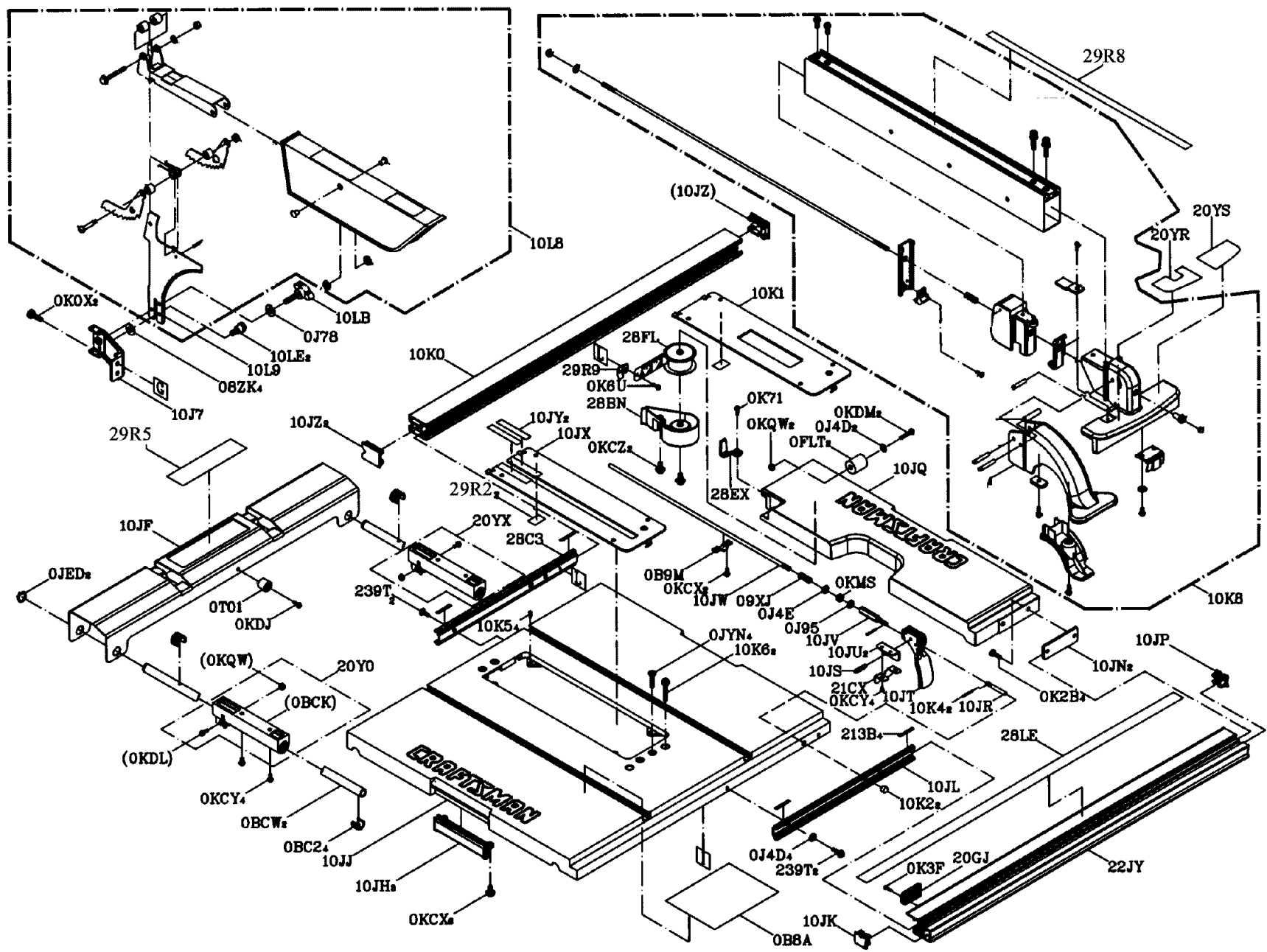

MODEL NO. 137.218300

10" JOB SITE TABLE SAW PARTS LIST

MODEL NO. 137.218300

Schematic B

I.D.	Description	Size	Qty	I.D.	Description	Size	Qty
2149	KNOB	#23	1	OKB9	CR.RE. PAN HD. TAPPING SCREW	M5X16-10	1
08W1	BRACKET		1	OKC6	CR. RE. TRUSS HD. TAPPING SCREW	M4*16-12	6
08W2	SPACER		1	OKCA	CR. RE. TRUSS HD. TAPPING SCREW	M5*12-12	4
08WG	ANGLE ROD BRACKET		1	OKCX	CR-RE PAN HD PLAIN WASHER TAPPING SCREW	M5*0.8-10	2
08WN	FRONT COVER		1	OKDJ	CR. RE. PAN HD. SCREW	M5*0.8-12	1
08WS	STRAP		3	OKDJ	CR. RE. PAN HD. SCREW	M5*0.8-12	2
08YB	PUSH -BLOCK	#19	1	OKDN	CR. RE. PAN HD. SCREW	M5*0.8-25	1
08ZK	FLAT WASHER		2	OKJ0	CAP HD. SQ.NECK BOLT	M6*1.0-16	2
08ZW	LOCATION SEAT		1	OKJ7	CAP HD. SQ.NECK BOLT	M8*1.25-16	1
0901	BUSH	#06	1	OKMY	HEX. NUT	M8*1.25 · T=6.5	1
0908	FLAT WASHER		1	OKNE	HEX. NUT	M6*1.0 T=5	2
0909	FLAT WASHER		1	OKP8	HEX. NUT	9/16*18UNF T=8	1
090Q	PLUNGER HOUSING		1	OKQX	Nut	M6*1.0 T=6	1
09JK	WRENCH HEX.	#06	1	OKQY	NUT CHUCK	M8*1.25 T=8	2
0B48	WARNING LABEL		1	OKQY	NUT CHUCK	M8*1.25 T=8	1
0B98	BEVEL GEAR		1	OKQY	NUT CHUCK	M8*1.25 T=8	1
0B9E	BUSH		3	OKRJ	U-TYPE NUT	M4*0.7	6
0B9N	STRAP		4	OKRQ	SERRATED TOOTHED HEXAGON FLANGE NUT	M6*1.0 T=6	4
0BA1	COMPRESSION SPRING		1	OKRQ	SERRATED TOOTHED HEXAGON FLANGE NUT	M6*1.0 T=6	2
0BA3	ANCHOR BLOCK		1	OKRQ	SERRATED TOOTHED HEXAGON FLANGE NUT	M6*1.0 T=6	2
0BA4	SPACER		1	OKTA	STRAIN RELIEF		2
0BA5	ARBOR COLLAR		1	OLMG	LOCKING CABLE TIE		1
0BAC	SET NUT		1	OLSL	CIRCUIT BREAKER SWITCH		1
0BAE	ARBOR COLLAR		1	OLWG	ROCKER SWITCH		1
0G7V	SPONGE		2	10HV	SWITCH BOX COVER	#06	1
0GCM	BEVEL GEAR		1	10HW	SWITCH BOX	#06	1
0J3P	WRENCH HEX.		1	10HX	BODY SHELL	#AW	1
0J3Q	WRENCH HEX.		1	10HY	FRONT PANEL		1
0J4F	FLAT WASHER	φ 8X16-2.5	1	10HZ	SEGMENT GEAR	#06	1
0J4F	FLAT WASHER	φ 8X16-2.5	3	10J0	POINTER BRACKET		1
0J4Q	FLAT WASHER	φ 12*21-2	1	10J1	NEEDLE POINTER		1
0J6G	FLAT WASHER	φ 8.2*18-2.0	2	10J2	WHEEL	#AW	1
0J6K	FLAT WASHER	φ 6*30-4	1	10J4	ANGLE ROD		1
0J6T	FLAT WASHER	3/16*3/4-1/16	4	10J5	DUST COLLECTOR JOINT	#06	1
0J6U	FLAT WASHER	3/16*1/2-3/64	4	10J6	SCREW BAR		1
0J78	FLAT WASHER	1/4*1/2-3/32	1	10J9	CAP HD. SQ.NECK BOLT	M6*1.0-40	1
0J88	FLAT WASHER	#10	1	10JA	MITER GAUGE ASS'Y		1
0J8D	FLAT WASHER	3/8*3/4-5/64	1	10JD	TILTING SCALE		1
0J8D	FLAT WASHER	3/8*3/4-5/64	1	10KQ	BRACKET TRAY ASS'Y		1
0JAF	EXTERNAL TOOTH LOCK WASHER	φ 5	2	10KW	REEL PLATE ASS'Y		1
0JAF	EXTERNAL TOOTH LOCK WASHER	φ 5	1	10LG	MOTOR		1
0JPM	HEX. HD. BOLT	M6X1.0-70	1	10LJ	LABEL		1
0JX7	HEX. SOC. SET SCREW	M6*1.0-6	2	10LN	TILTING SCALE		1
0JX7	HEX. SOC. SET SCREW	M6*1.0-6	2	20SJ	LEAD WIRE ASS'Y		1
0JX7	HEX. SOC. SET SCREW	M6*1.0-6	2	20SM	BODY		1
OK4R	CR.-RE. TRUSS HD. SCREW	M5*0.8-12	3	20W7	BLADE		1
OK7F	CR. RE. ROUND WASHER HD. SCREW	M5*0.8-8	2	20WH	LOCKING HANDLE ASS'Y		1
OK7F	CR. RE. ROUND WASHER HD. SCREW	M5*0.8-8	1	20XZ	HEIGHT REGULATING BOLT ASS'Y		1
OK7K	CR. RE. ROUND WASHER HD. SCREW	M6*1.0-12	6	20YB	HANDLE BAR ASS'Y		1
OK9S	HEX. HD. TAPPING SCREW	M5*0.8-25	4	26E8	FLAT WASHER	φ 5*9.5-1.2	1
OKA4	CR.RE. PAN HD. TAPPING SCREW	M4*16-16	1	29R3	TRADE-MARK LABEL		1
OKA5	CR.RE. PAN HD. TAPPING SCREW	M4*16-20	2	29R4	LABEL		1
OKA5	CR.RE. PAN HD. TAPPING SCREW	M4*16-20	1	29R7	CAUTION LABEL		1
OKB9	CR.RE. PAN HD. TAPPING SCREW	M5X16-10	4	29R6	STICKER		1

Schematic B

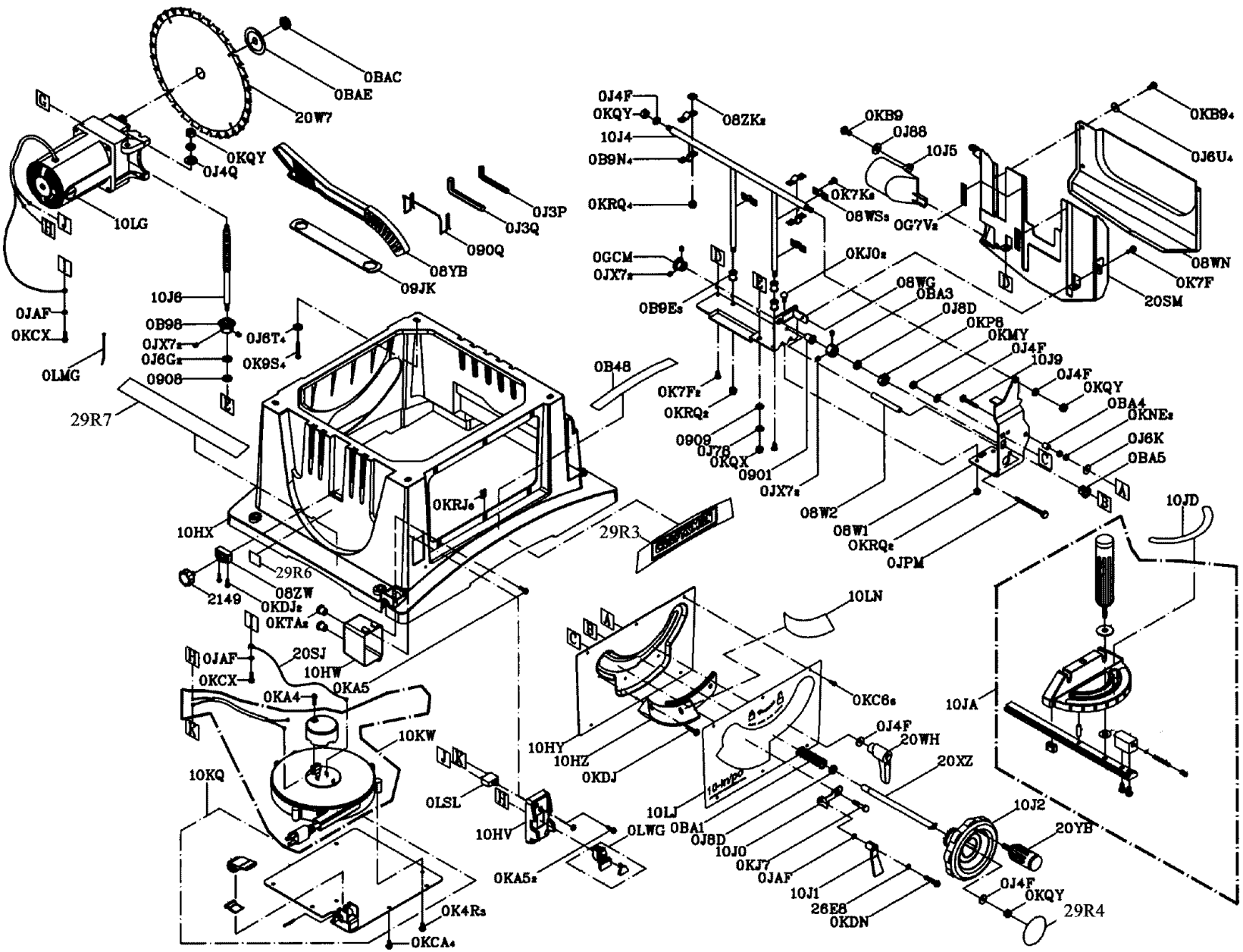

10" JOB SITE TABLE SAW

MODEL NO. 137.218300

Part list for STAND

I.D. No.	Description	Size	Qty
01AD	WING NUT		1
01AE	LEVELING PAD		1
0J4J	FLAT WASHER	φ 10X20-2	4
0JQ2	HEX. HD. BOLT	M10*1.5-55	4
0JZB	HEX. SOC. SET SCREW	M4X0.7-6	1
0K7D	CR. RE. ROUND WASHER HD. SCREW	M6*1.0-10	2
0KCX	CROSS-RECESSED PAN HD PLAIN WASHER TAPPING SCREW	M5*0.8-10	1
0KQY	NUT CHUCK	M8*1.25 T=8	6
20FM	HANDLE		1
20FX	BRACKET ASS'Y(LEFT)		1
20G4	BRACKET ASS'Y(RIGHT)		1
20GE	FOOT		3
20GH	FOOT		4
20Y7	FOAM		1
213T	ROLLING WHEEL		2
214H	PLATE CLAMP ASS'Y		1
21AD	FOLLOWER PLATE		1
21B7	HANDLE		4
21B9	PRESSING		4
21BL	HEX. SOC. HD. CAP BOLT	M4*0.7-4	4
21EG	BLIND RIVET	1/8"-7/32"	2
220Q	CUSHION		1
222K	SUPPORT ASS'Y		1
22FZ	CAP HD. SQ.NECK BOLT	M8*1.25-45	6
28BX	CR.RE. PAN HD. TAPPING SCREW	M5*0.8-10	4

STAND

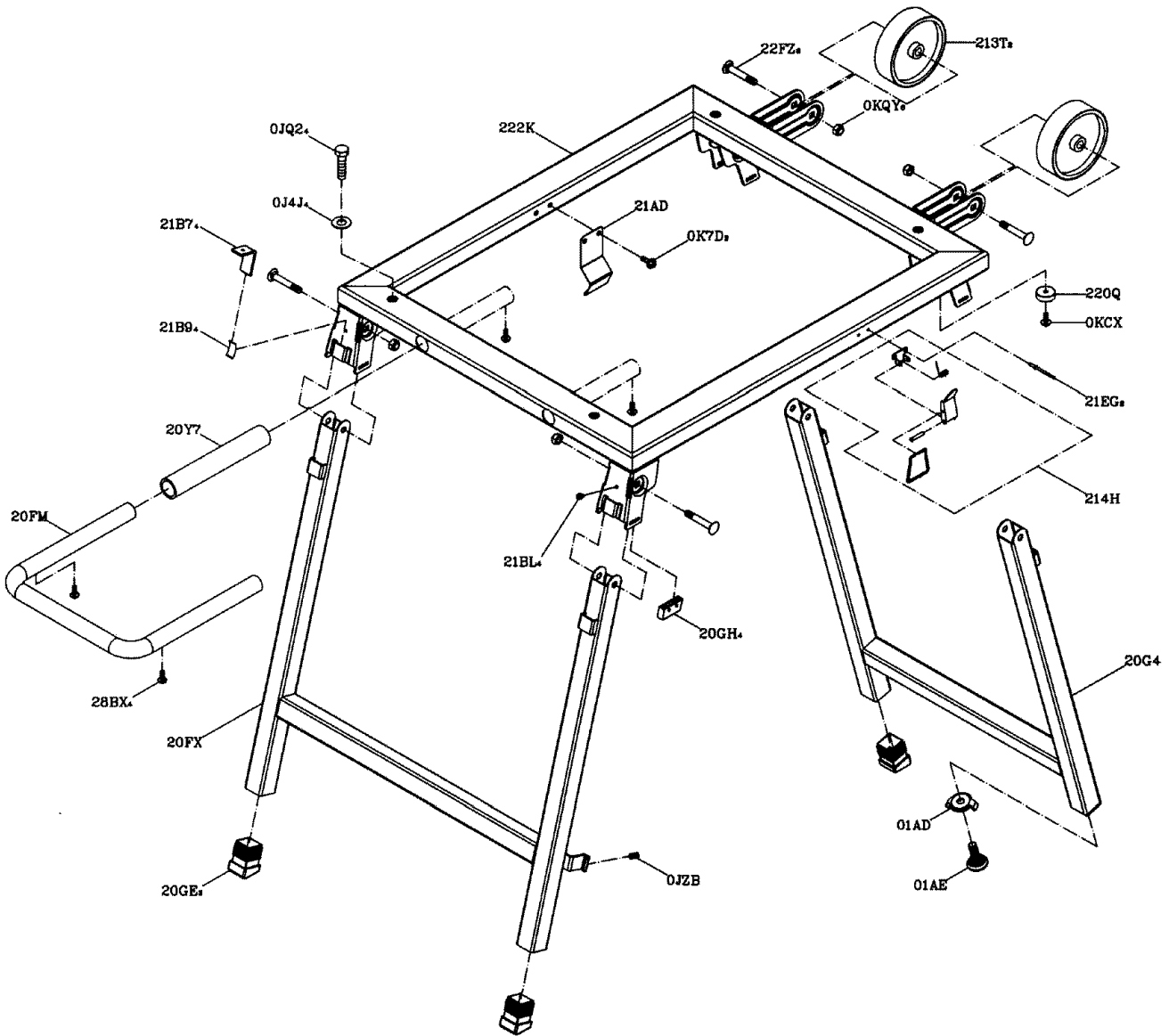

## Part list for MOTOR

I.D.	Description	Size	Qty
0J92	SPRING WASHER	$\varphi 5$	3
0JB8	WAVE WASHER		1
0JX3	HEX. SOC. SET SCREW	M5*0.8-8	2
0K3A	CR.RE. PAN HD. SCREW & WASHER	M5*0.8-30	4
0KDJ	CR. RE. PAN HD. SCREW	M5*0.8-12	2
0KDL	CR. RE. PAN HD. SCREW	M5*0.8-18	1
0KTH	STRAIN RELIEF		1
0QET	BRACKET		1
0QEU	HELIX GEAR		1
0QM2	BRUSH HOLDER ASS'Y	$\Phi 27*26.5$	2
0QQT	BRUSH ASS'Y		1
0QR0	BRUSH COVER		2
0R20	BAFFLE		1
10ZC	MOTOR HOUSING		1
10ZD	FIELD ASS'Y		1
10ZK	ARMATURE ASS'Y		1
10ZQ	NEEDLE BEARING		1
10ZY	ARBOR SHAFT ASS'Y		1
20U2	CR.RE. PAN HEAD TAPPING & WASHER SCREW	M5*12-80	2
20VH	CR. RE. COUNT HD. SCREW	M4*0.7-10	2

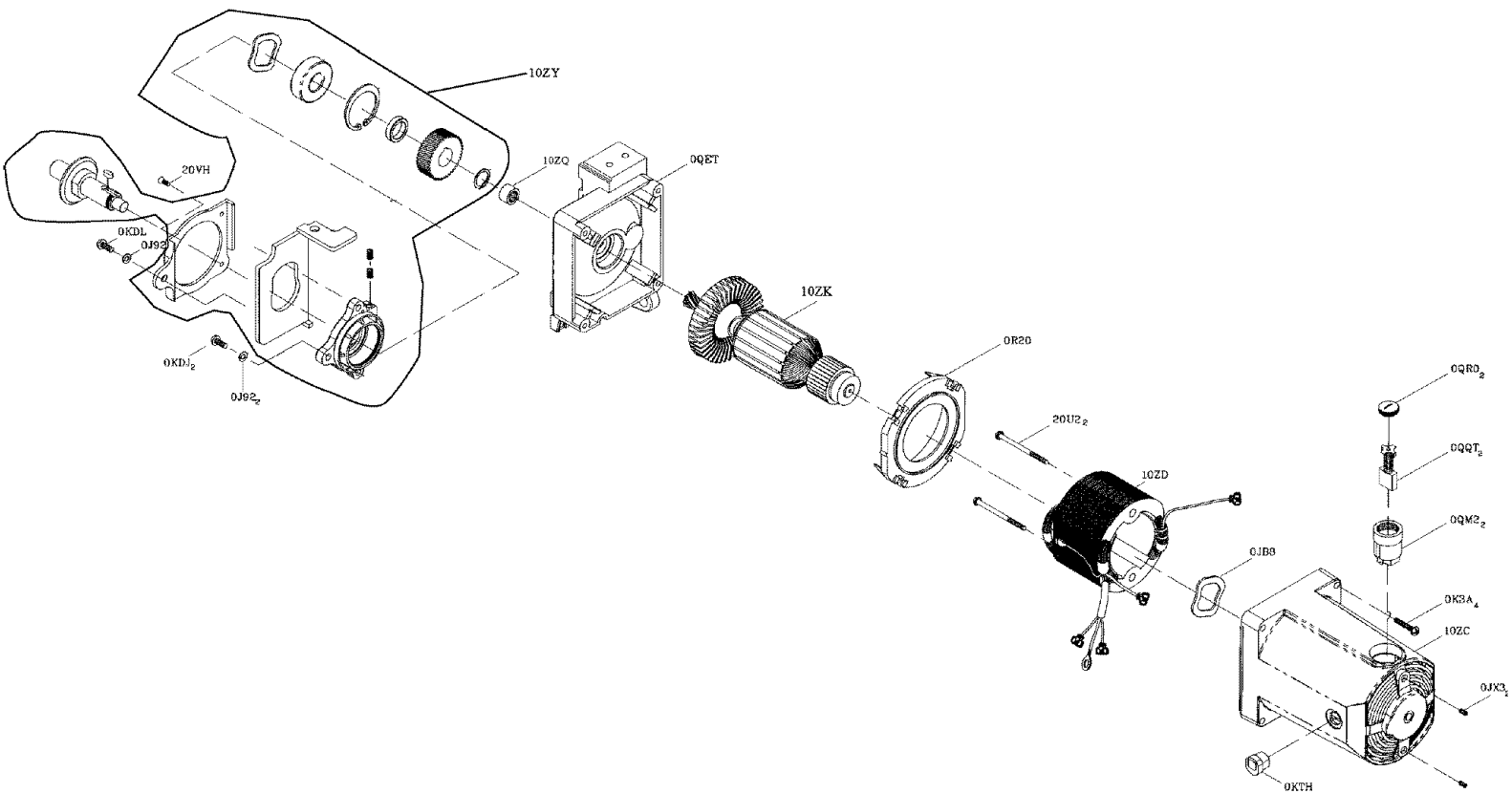

# Get it fixed, at your home or ours!

## Your Home

For repair – **in your home** – of **all** major brand appliances, lawn and garden equipment, or heating and cooling systems, **no matter who made it, no matter who sold it!**

For the replacement parts, accessories and Operator's Manuals that you need to do-it-yourself.

For Sears professional installation of home appliances and items like garage door openers and water heaters.

**1-800-4-MY-HOME® (1-800-469-4663)**

Call anytime, day or night (U.S.A. and Canada)

[www.sears.com](http://www.sears.com)    [www.sears.ca](http://www.sears.ca)

---

## Our Home

For repair of carry-in items like vacuums, lawn equipment, and electronics, call or go on-line for the location of your nearest

**Sears Parts & Repair Center.**

**1-800-488-1222**

Call anytime, day or night (U.S.A. only)

[www.sears.com](http://www.sears.com)

---

To purchase a protection agreement on a product serviced by Sears:

**1-800-827-6655** (U.S.A.)

**1-800-361-6665** (Canada)

---

Para pedir servicio de reparación a domicilio, y para ordenar piezas:

**1-888-SU-HOGAR<sup>SM</sup>**

(1-888-784-6427)

Au Canada pour service en français:

**1-800-LE-FOYER<sup>MC</sup>**

(1-800-533-6937)

[www.sears.ca](http://www.sears.ca)

# SEARS

© Registered Trademark / <sup>TM</sup> Trademark / <sup>SM</sup> Service Mark of Sears, Roebuck and Co.

© Marca Registrada / <sup>TM</sup> Marca de Fábrica / <sup>SM</sup> Marca de Servicio de Sears, Roebuck and Co.

<sup>MC</sup> Marque de commerce / <sup>MD</sup> Marque déposée de Sears, Roebuck and Co.

© Sears, Roebuck and Co.

2004/08