

# Owner's Manual/Manual Del Propietario



**GARAGE DOOR OPENER**  
**Abridor de puerta de cochera**  
**MODEL/MODELO 200.57933**

**For Residential Use Only**  
**Sólo para uso residencial**



**Read and follow all safety rules and operating instructions before first use of this product.**

**Fasten the manual near the garage door after installation.**

**Periodic checks of the opener are required to ensure safe operation.**

**DO NOT install on a one-piece door.**

Write down the Craftsman® serial number located on the garage door opener:



**Sears Brands Management Corporation, Hoffman Estates, IL 60179 U.S.A**  
**www.craftsman.com**

**Leer y seguir todas las reglas de seguridad y las instrucciones de operación antes de usar este producto por primera vez.**

**Guardar este manual cerca de la puerta de la cochera.**

**Se deben realizar revisiones periódicas del abridor de puertas para asegurar su operación segura.**

**Los dispositivos y funciones automáticas deben usarse ÚNICAMENTE con puertas seccionales.**

**Spanish Section Begins Page: 27**  
**Manual en Español empieza en la pagina: 27**

# Table of Contents

## Introduction

Symbols and Icons	2
Inventory	3
Preparation / Tools Required	4

## Assembly

Rail and Trolley Assembly	5
Installing the Cable and Chain	6
Mounting Header Bracket	7

## Installation

Attaching Rail to Header Bracket and Mounting Door Bracket	8
Mounting Opener to Ceiling	9
Attaching Door Arms	10
Installing Light and Emergency Release Handle	11

## Wiring

Wiring Instructions	12
Connecting Photo Eye Safety System	13
Connecting Large Push Button	14
Connecting Power	15

## Adjustment

Aligning the Photo Eye Safety System	15
Travel Limit Adjustment	16
Force Adjustment	17
Final Adjustment and Testing	18

## Operation

Programming 1 Button Remote	19
Programming Keyless Entry Pad*	20
Operating the Opener	21-22
Maintenance	23
Troubleshooting	23

## Repair Parts and Service

Rail Assembly Parts / Installation Parts / Accessories	24
Opener Assembly parts	25

## Warranty

26

# Symbols and Icons



### WARNING

READ WARNINGS CAREFULLY to prevent **SERIOUS INJURY** or **DEATH** caused by electrocution or mechanical hazard.



DO NOT connect power

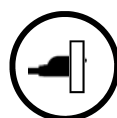

Please connect power



Courtesy light turns on/flashes with audible 'click'.  
(If light bulb is not installed, 'click' represents the light)

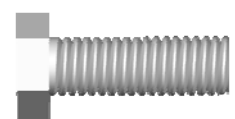

Installation hardware

# Inventory

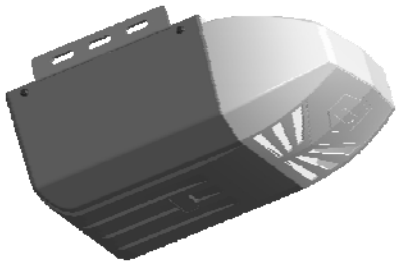

Opener Unit + Light Lens Cover

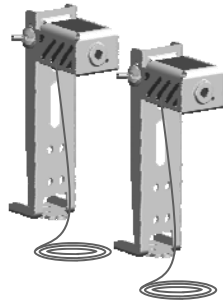
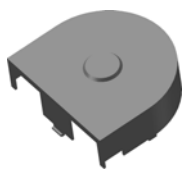

Photo Eye Safety System



Rail — Header Segment  
Rail — Middle Segments x3  
Rail — End Segment with Trolley Stop Bolt



Sprocket Cover



1-Button Remote



Push Button



OPTIONAL  
Keyless Entry Pad\*



OPTIONAL  
3-Button Mini Remote\*



Emergency Release Knob + Rope

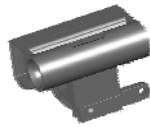

Trolley



Hanging Brackets

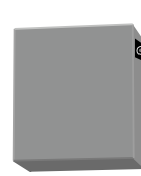

Chain



Header Bracket



Literature + Safety Labels

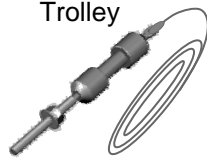

Trolley Shaft and Cable



Door Bracket

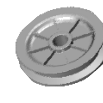

Pulley

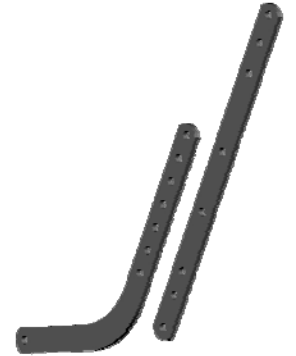

Door Arms

\*See Accessories in Repair Parts section of this manual for purchase information.

## INSTALLATION HARDWARE, LOCATED IN HARDWARE BAG (SHOWN IN ACTUAL SIZE)

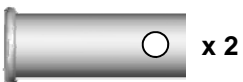

Clevis Pin — Door arms  
5/16" x 1"



Clevis Pin — Header Bracket  
5/16" x 1-1/2"



Clevis Pin — Pulley  
3/8" x 1-3/4"



Hitch Pin — Locking Clevis Pins



Self-Threading Screw 1/4" x 5/8"  
Door Bracket

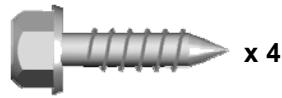

Lag Screw #12 x 1" — Photo Eye System

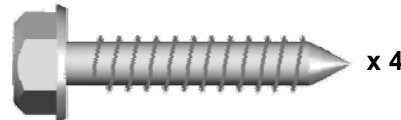

Lag Screw 5/16" x 1-1/2"  
— Header Bracket / Mounting Opener

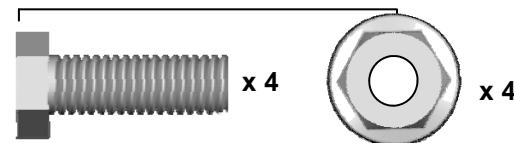

Bolt 5/16" x 1"      5/16" Flange Nut  
— Door arms / Mounting Opener



Screw #6 x 1"  
- Large Push Button



Drywall Anchor  
- Large Push Button

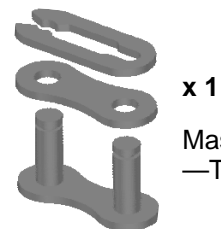

x 1  
Master Link Set  
— Trolley Shaft



x 30  
Insulated Staples  
— Securing wires

# Preparation

## **WARNING**

To prevent **SERIOUS INJURY** or **DEATH**:

- Before beginning installation of the opener please complete the following test to ensure that your door is balanced and in good working condition.
- A poorly balanced door can cause serious injury and damage to the opener.
- Always have a qualified garage door service technician make any required adjustments and/or repairs to your door before proceeding with installation.
- **DISABLE ALL LOCKS** and **REMOVE ALL ROPES** connected to the garage door **BEFORE** installing and/or operating the opener.



To prevent damage to the door and opener:

- **DO NOT** connect power until instructed.
- Operate this opener with AC 120V/60Hz power supply **ONLY**.

**DO NOT REUSE PARTS FROM ANOTHER BRAND OF OPENER!!!**

### **BEFORE beginning Installation:**

1. **Disable locks and remove all ropes connected to the garage door.**
2. **Perform the following door test to ensure your door is balanced and in good working condition.**

### **To Test Your Garage Door**

1. Raise and lower the door to check if there is any sticking or binding.
2. Check for loose hinges, damaged rollers, frayed cables and damaged or broken springs.
3. Lift the door approximately halfway and release. The door should stay at the point under proper spring tension.

Call a qualified garage door service technician if your door binds, sticks or is unbalanced.

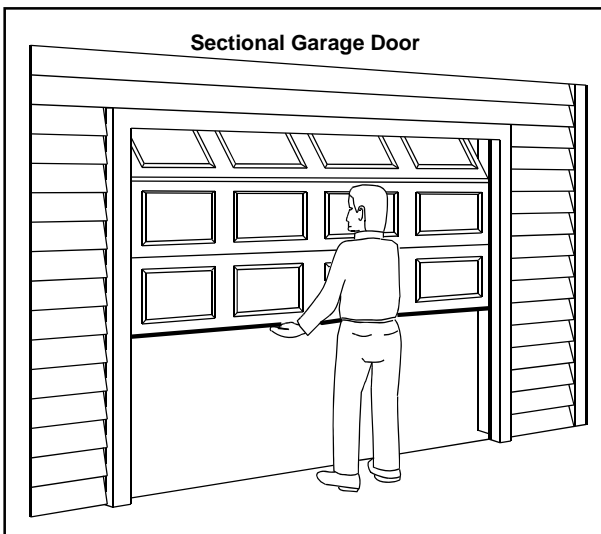

# Tools Required

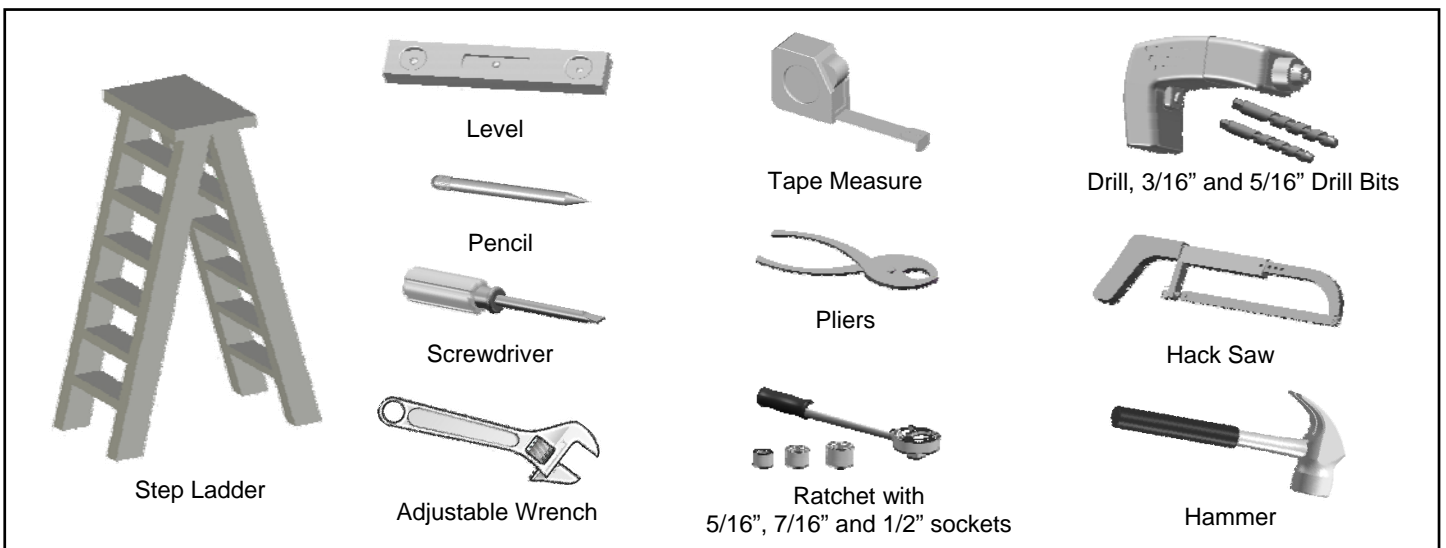

# Rail and Trolley Assembly

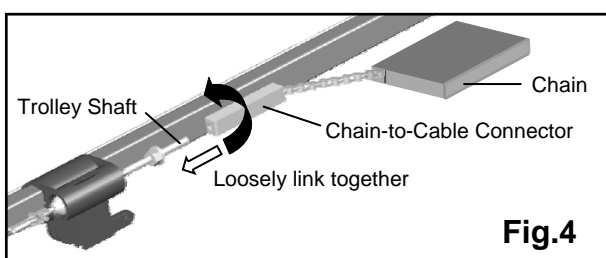
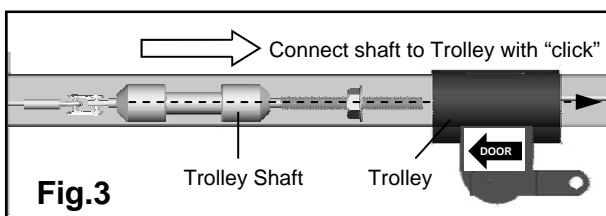
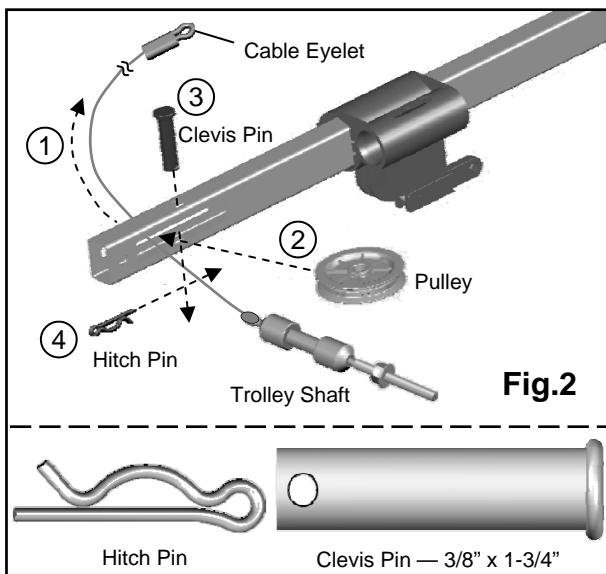
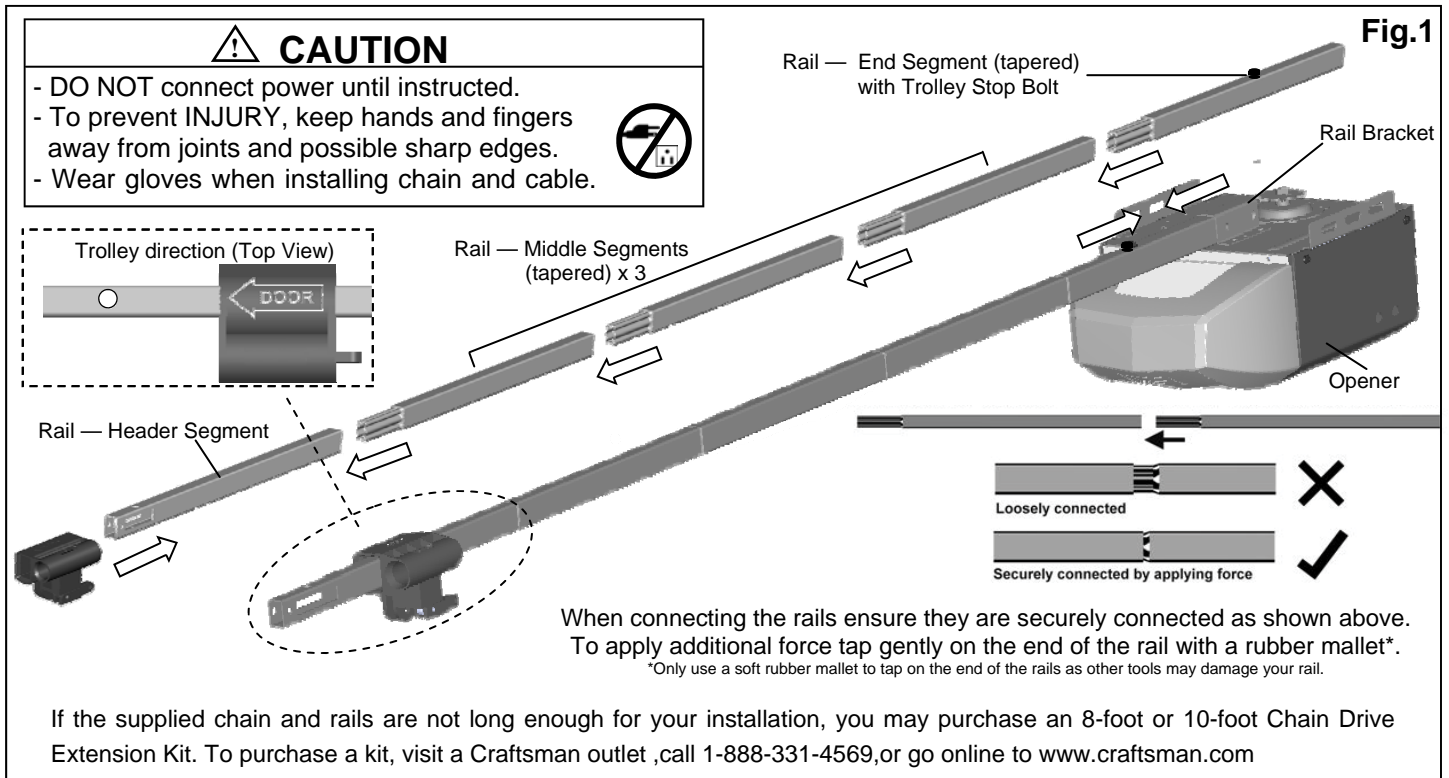

## To Assemble Rail and Opener

1. Prepare the rails as shown in Fig.1.
2. Connect the rails starting with the header segment. Insert the tapered ends into open ends, apply any additional force necessary by tapping the rail on padded flooring. Ensure the end segment has trolley stop bolt facing up. Make sure the rails are securely joined together as shown.
3. Slide the trolley onto the rail from the header segment. Make sure the arrow is pointing towards the door as shown in Fig.1.
4. Connect the rail assembly to the rail bracket on the opener.

## To Assemble the Header Section of Rail

Follow steps shown in Fig.2:

1. Remove the "trolley shaft and cable" from the chain carton and lay it beside the rail assembly. Hold cable eyelet on the end of cable and thread about 20" (50cm) through the slot on the Header Segment of the rail.
2. Insert the pulley into the opening while the cable is hanging.
3. Secure the pulley by inserting the 3/8" x 1-3/4" clevis pin through the top of the rail.
4. Lock the clevis pin with a hitch pin. Rotate the pulley to ensure it spins smoothly.

Refer to Fig.3 to connect the trolley shaft to the trolley. Slide both the trolley shaft and trolley towards each other. A "click" will be heard when they are connected.

## To Link Cable with Chain

Refer to Fig.4. Place the chain carton beside the rail, hold the "chain to cable connector" and pull about 8" (20cm) of chain from the box. Thread the chain to cable connector onto the trolley shaft so that they are loosely linked together.

# Installing Cable and Chain

## WARNING

To prevent **SERIOUS INJURY**:

- DO NOT connect power until instructed.
- Keep hands and fingers clear from sprocket during operation.
- Wear gloves when installing chain and cable.
- Keep hands and fingers away from joints and possible sharp edges.

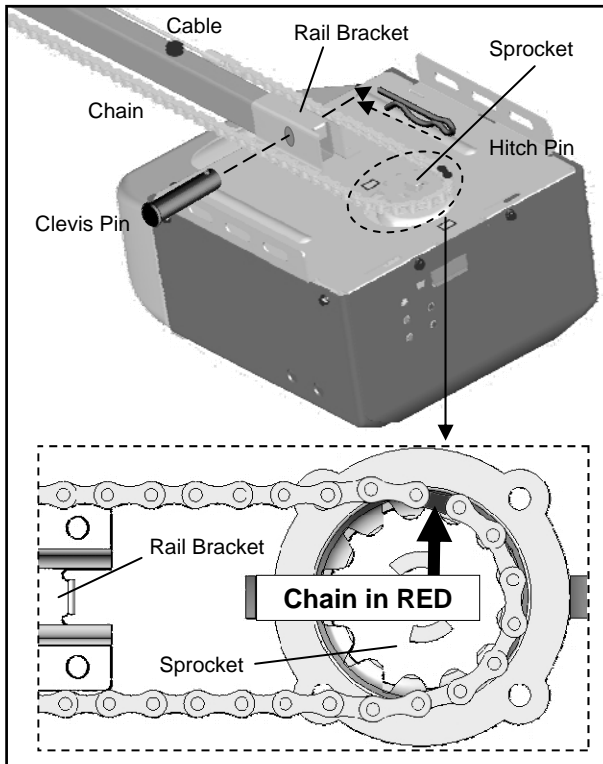

**Fig.1**

### To Install Chain

1. Pull the remaining chain along the rail toward the opener.
2. A segment of chain marked in RED will be seen. Place this segment in the approximate location on the sprocket as shown in Fig.1.
3. When the chain is aligned properly around the sprocket, pull the chain-to-cable connector towards the trolley shaft.

Follow steps shown in Fig.2 to connect & tighten the chain:

1. Align the open end of the chain to the cable eyelet and connect together using the master link set.
2. Turn the chain-to-cable connector on the trolley shaft until the chain is about 1/4" (6mm) above the base of the rail. Compare with the illustration below.
3. Tighten the flange nut on trolley shaft against the chain-to-cable connector.

When the chain and cable are tightened around the rail and sprocket on the opener, check and make sure the chain is properly aligned and not twisted. Attach the sprocket cover to the opener as shown in Fig.3.

### Notice

During operation, it is normal for the chain to appear loose when the door is closed. If the chain returns to the position as shown below when the door is opened, the chain is adjusted properly. DO NOT re-tighten the chain.

When performing maintenance, always PULL the emergency release to DISCONNECT the door from opener before adjusting the chain.

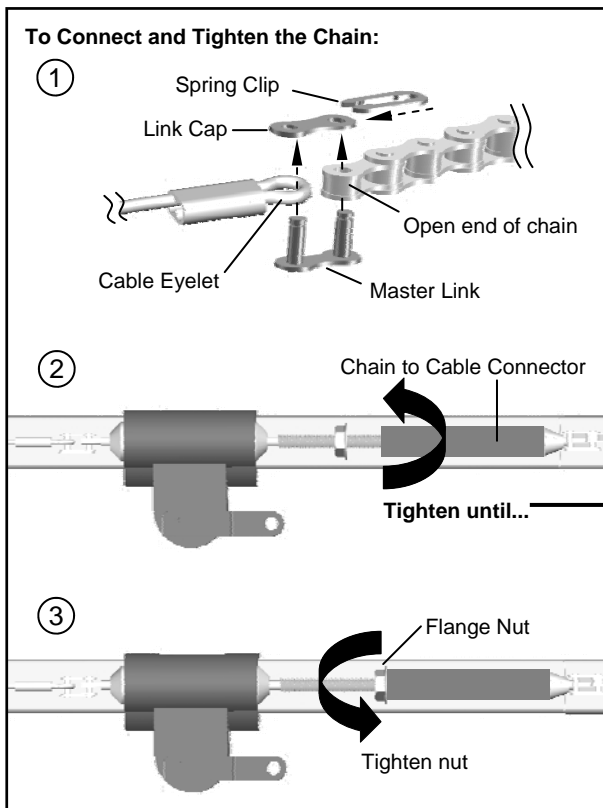

**Fig.2**

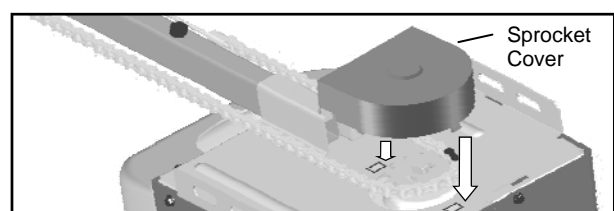
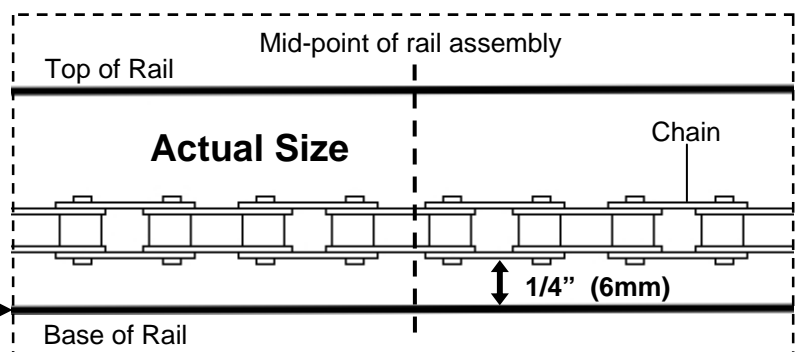

**Fig.3**

# Mounting Header Bracket

## ⚠ WARNING

To prevent **SERIOUS INJURY**:

- DO NOT connect power until instructed.
- The header bracket **MUST** be **SECURELY** fastened to the structural support on the mounting wall or ceiling, otherwise the door may not reverse when required. DO NOT install the header bracket over drywall.
- Concrete anchors **MUST** be used when mounting the header bracket into masonry.
- **NEVER** try to loosen, move or adjust garage door springs, cables, pulleys, brackets, or hardware.
- Contact a qualified garage door service technician if your door binds, sticks or is unbalanced. An unbalanced door might not reverse when required.

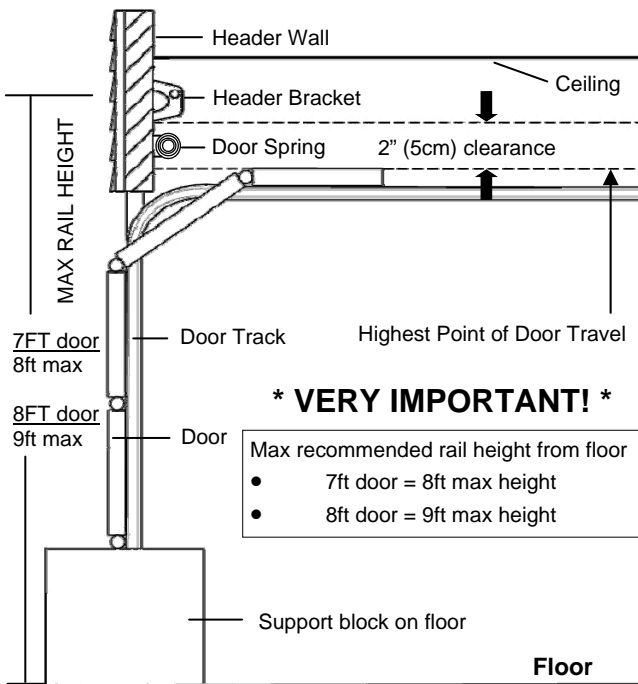

**Fig.1**

### To Install Header Bracket

**Note:** Installation procedures may vary according to door type.

1. While inside your garage, close the door and mark the vertical centerline of the garage door. Extend the line onto the header wall above the door spring.
2. Open the door to the highest point of travel. Mark a line on the header wall 2" (5cm) above the highest point of travel.

**Note:** DO NOT install the header bracket over drywall. In some installations, it may be necessary to install a 2x4 across two wall studs to create a suitable location for the header bracket.

If installing into masonry, use concrete anchors (not provided).

### Wall-Mounting

As shown in Fig.2, place the header bracket on the vertical centerline in direction shown.

Mark and drill two 3/16" holes. Fasten the header bracket securely to a structural support using two 5/16" x 1-1/2" lag screws.

### Alternative Ceiling-Mounting

Ceiling-mounting is suggested **ONLY** when clearance is minimal.

Extend the vertical centerline onto the ceiling as shown in Fig.3. center the header bracket on the vertical mark, no more than 6" (15cm) from the header wall. Mark and drill holes to fasten the header bracket securely to a structural support.

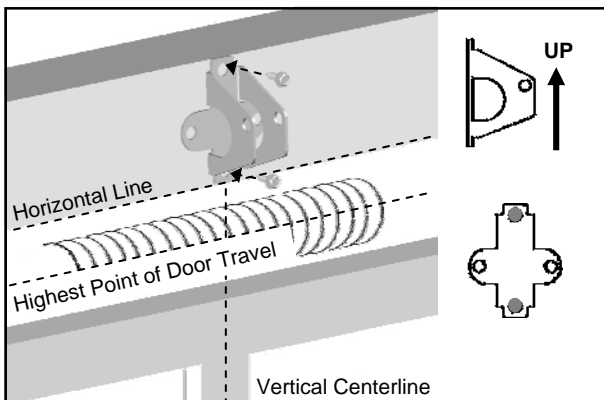

**Fig.2 (Wall-Mounting)**

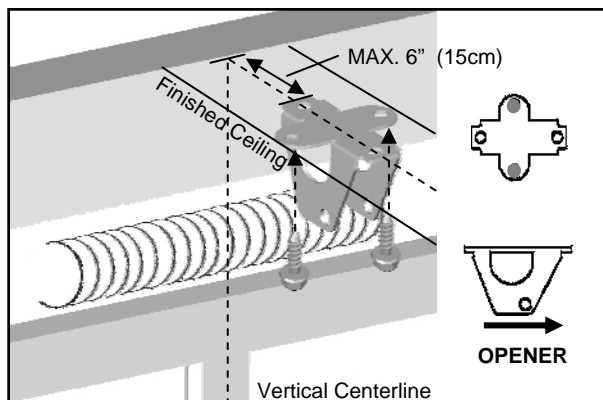

**Fig.3 (Ceiling-Mounting)**

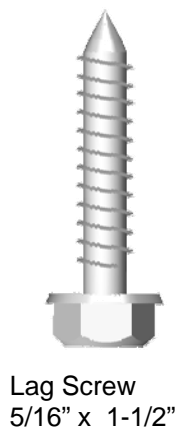

# Attaching Rail to Header Bracket and Mounting Door Bracket

## CAUTION

To prevent SERIOUS INJURY:

- DO NOT connect power until instructed.
- REINFORCEMENT is recommended for fiberglass, aluminum or lightweight steel garage doors BEFORE installing the door bracket. Contact your door manufacturer for reinforcement options.

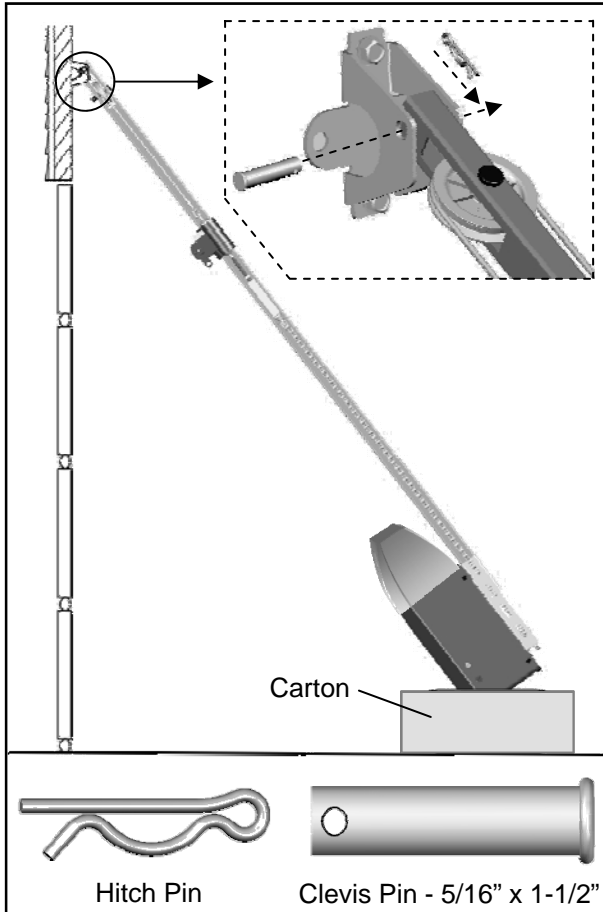

**Fig.1**

### To Attach the Opener to the Header Bracket

1. As shown in Fig.1, use the packaging carton as temporary support for the opener. Place the opener on carton to prevent damage.
2. Align the mounting hole on the header rail to the mounting hole on the Header Bracket.
3. Connect the header rail and the door bracket together with a 5/16" x 1-1/2" clevis pin and lock it in place with a hitch pin.

### To mount the Door Bracket

**Note:** Some door reinforcement kits may provide direct attachment of the door arm to the reinforcement bracket. If you have a door reinforcement bracket with this option, skip this step and proceed with the next step "mounting opener to ceiling".

1. Position the door bracket on the centerline of the door approximately 2" - 4" (5-10cm) below the top edge of the door, as shown in Fig.2.
2. Depending on the construction of your door, install using one of the steps shown in Fig. 3 below:

#### For steel / lightweight doors with vertical steel reinforcements / factory reinforced.

(a) Mark and drill two 3/16" holes. Make sure not to drill through the garage door. Secure the door bracket with two 1/4" x 5/8" self-threading screws (provided) as shown in Fig.3(a).

(b) Alternative installation: Drill two 5/16" holes through the door. Secure the door bracket using two 5/16" bolts, lock washers and nuts (not provided) as shown in Fig.3(b). The length of bolts will depend on the thickness of your door.

#### Wood door

(c) Mark and drill two 5/16" holes through the garage door. Secure the door bracket using two 5/16" carriage bolts, washers and nuts (not provided) as shown in Fig.3(c). The length of bolts will depend on the thickness of your door.

**Note: DO NOT use Self-Threading Screws on a wood door.**

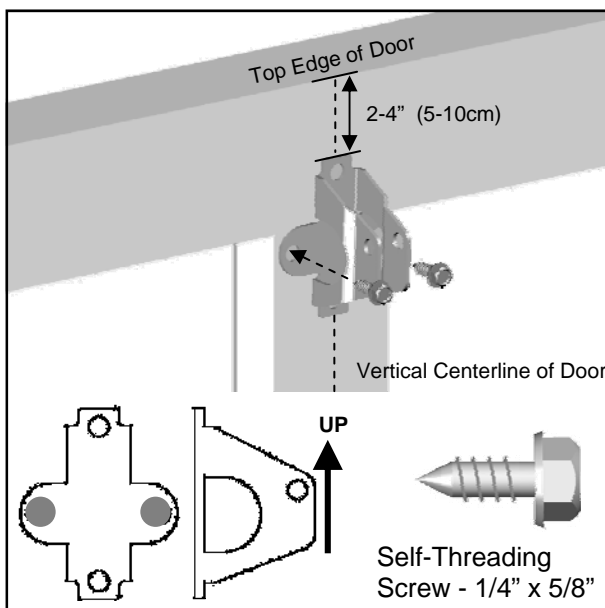

**Fig.2**

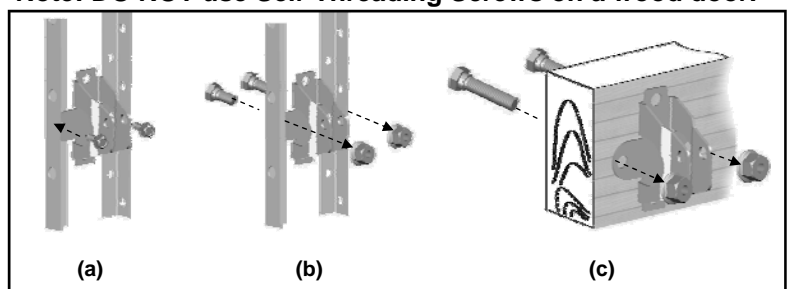

**Fig.3**



# Mounting Opener to Ceiling

## WARNING

To prevent SERIOUS INJURY or DEATH:

- DO NOT connect power until instructed.
- Install the opener at least 7 feet (2.13m) above the floor.
- Fasten the opener SECURELY to STRUCTURAL SUPPORTS of the garage to prevent falling.
- If installing brackets to masonry, concrete anchors (not provided) MUST be used.

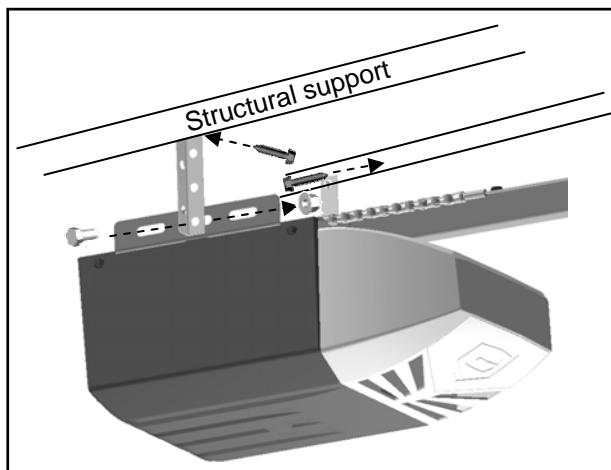

Fig.1

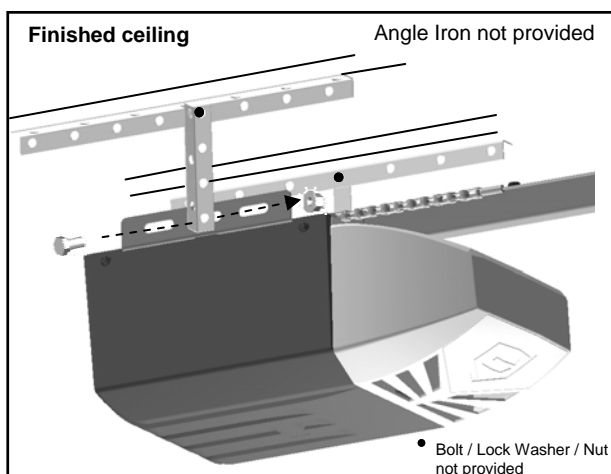

Fig.2

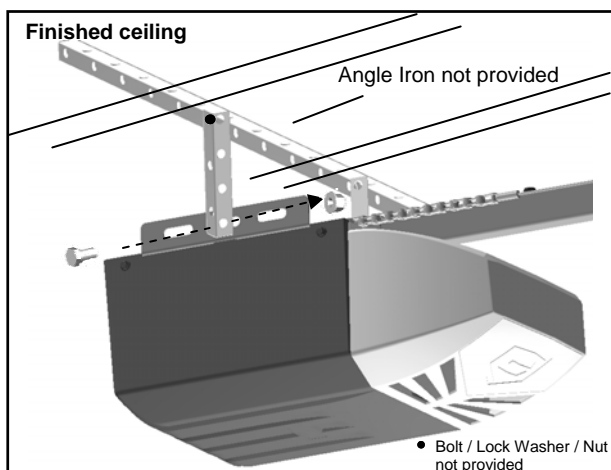

Fig.3

## To Mount the Opener to Ceiling

The three most common installation options are shown in Fig.1-3.

Fig.1 shows mounting the opener directly to structural support on the ceiling. Fig.2 and 3 show mounting on a finished ceiling, with heavy duty angle iron\*. \*(angle iron not included)

Determine the mounting option that works best for your application and follow installation steps below:

1. Raise the opener and rail assembly and temporarily place it on a stepladder.
2. Position the opener and rail assembly so that it is aligned to the center line of the garage door. If the header bracket was mounted off center, align the opener with the header bracket.
3. Measure the distance from each side of the opener to the structural supports.
4. Cut both hanging brackets to appropriate length.
5. Drill 3/16" holes in the structural supports.
6. Secure one end of each of the hanging brackets to the structural supports using 5/16" x 1/2" lag screws (provided).
7. Secure the opener to the hanging brackets and secure each side with a 5/16" x 1" bolt and flange nut (provided).
8. Move the door manually to check clearance between highest point of travel of the door and rail. If the door hits the rail, raise the header bracket or adjust the mounting of opener.
9. Remove the ladder ONLY when the opener is securely mounted to the structural supports.

### Fastening Hanging Brackets to structural supports

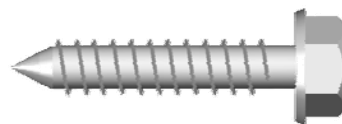

Lag Screw 5/16" x 1-1/2"

### Securing Opener to Hanging Brackets

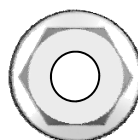

Flange Nut

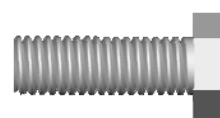

Bolt 5/16" x 1"

# Attaching Door Arms

## **WARNING**

To prevent **SERIOUS INJURY**:

- DO NOT connect power until instructed.
- Keep hands and fingers away from the sprocket during operation.
- Wear gloves when installing chain/belt and cable.
- Keep hands and fingers away from joints and possible sharp edges.

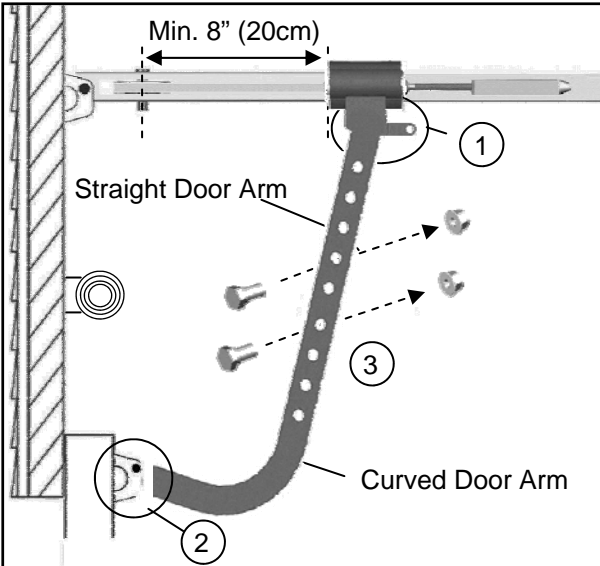

**NOTE:** The trolley must be a minimum of 8" (20cm) away from the pulley.

### To Connect Door Arm

Follow the steps shown in Fig. 1

1. Fasten the straight door arm to the trolley with a 5/16" x 1" clevis pin and lock it with a hitch pin.
2. Fasten the curved door arm to the door bracket with 5/16" x 1" clevis pin and lock it with a hitch pin.
3. To connect the door arms together, choose two pairs of holes which are as far apart as possible. Fasten the arms using two 5/16" x 1" bolts and flange nuts.

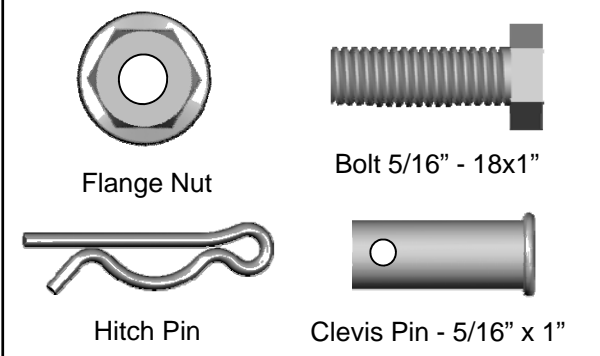
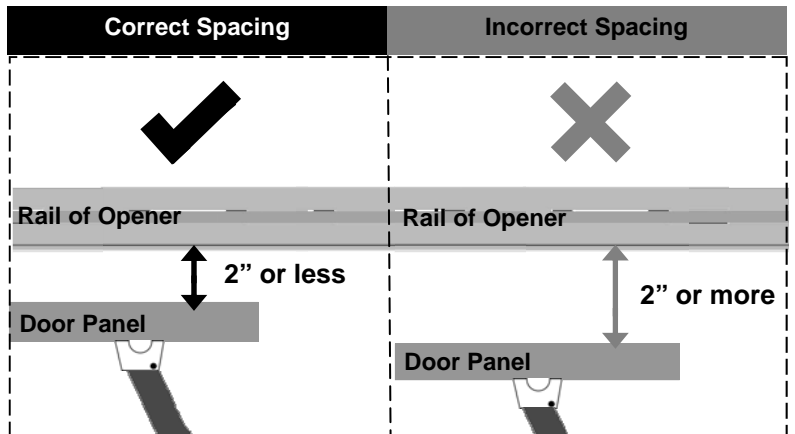
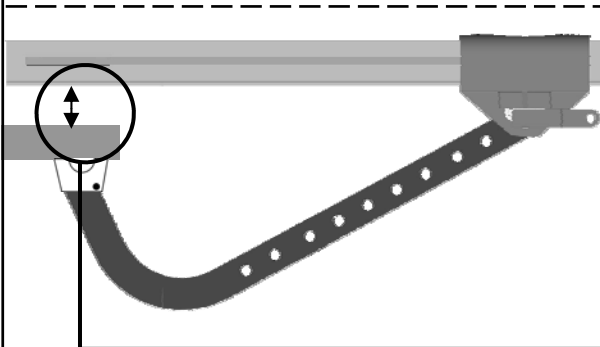
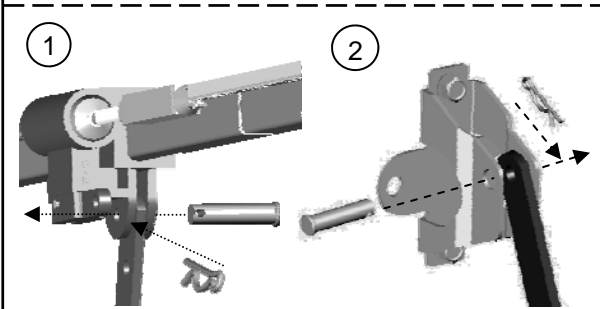

**Fig.1**

# Installing Light and Emergency Release Knob

## **WARNING**

To prevent **SERIOUS INJURY** or **DEATH** from electrocution:

- Disconnect power cord before installing/replacing light bulb.

To prevent possible **OVERHEATING** or damage to opener:

- Use **ONLY** A19 (E26) incandescent bulbs\* (100W max.).

- **DO NOT** use short neck or specialty light bulbs.

- **DO NOT** use halogen bulbs.

\* CFL or LED light bulbs will work but may interfere with hand-held remotes.

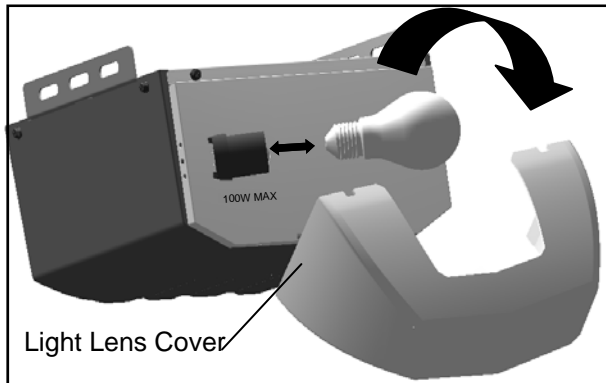

**Fig. 1**

### **To install the light:**

1. Insert screw driver between lens and the cover at the detents, pry and pull the light lens cover from the top and detach it from the opener.
2. Install a standard A19 (E26) 100 watt maximum light bulb.
3. Re-attach the light lens cover.

### **Notice**

When replacing the light bulb, make sure the bulb on the opener has cooled down to prevent injury.

## **WARNING**

To prevent **SERIOUS INJURY** or **DEATH** from a falling garage door:

- In case of power failure or door obstruction, **PULL EMERGENCY HANDLE** to release door from opener.

- When emergency release is in the released position, the door can be operated manually.

- To reconnect, flip the lever on the trolley towards opener, back to connect position, it will reconnect automatically upon pressing wall panel or remote control.

- **DO NOT** use emergency handle to pull the door open or closed.

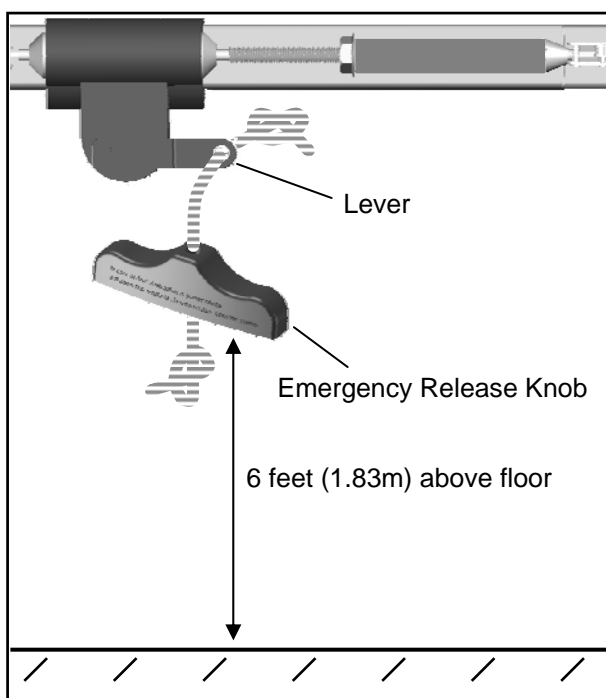

**Fig. 2**

### **To attach the Emergency Release Knob:**

1. Thread one end of the rope through the hole of the emergency release Knob and secure with an overhand knot.
2. Thread the other end of the rope through the hole in the trolley lever.
3. Measure the rope length so that the knob is 6 feet (183cm) above the floor and is clear from the top of your vehicle. Secure with a overhand knot.

### **\* VERY IMPORTANT! \***

**Emergency release knob must clear all vehicles. An Emergency release knob set too low may get caught by the vehicle and cause damage to the opener. Measure from the floor to the top of your vehicle and set the emergency release knob above this measurement.**

# Wiring Instructions

## **WARNING**

To prevent **SERIOUS INJURY** or **DEATH** from electrocution:

- Power **MUST NOT** be connected until instructed.
- **NO** exposed part of the wire should be visible outside of the terminal for proper connection.



**\* VERY IMPORTANT! \***

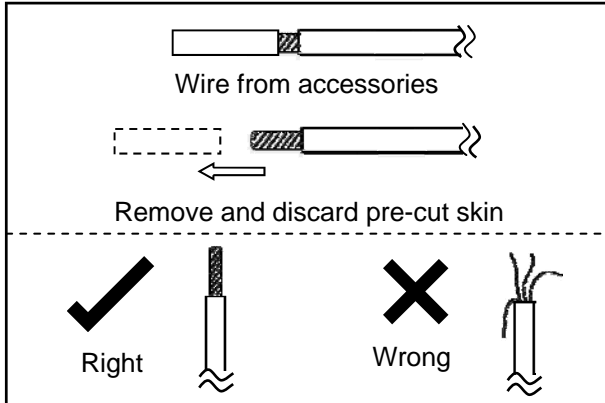

**Fig. 1**

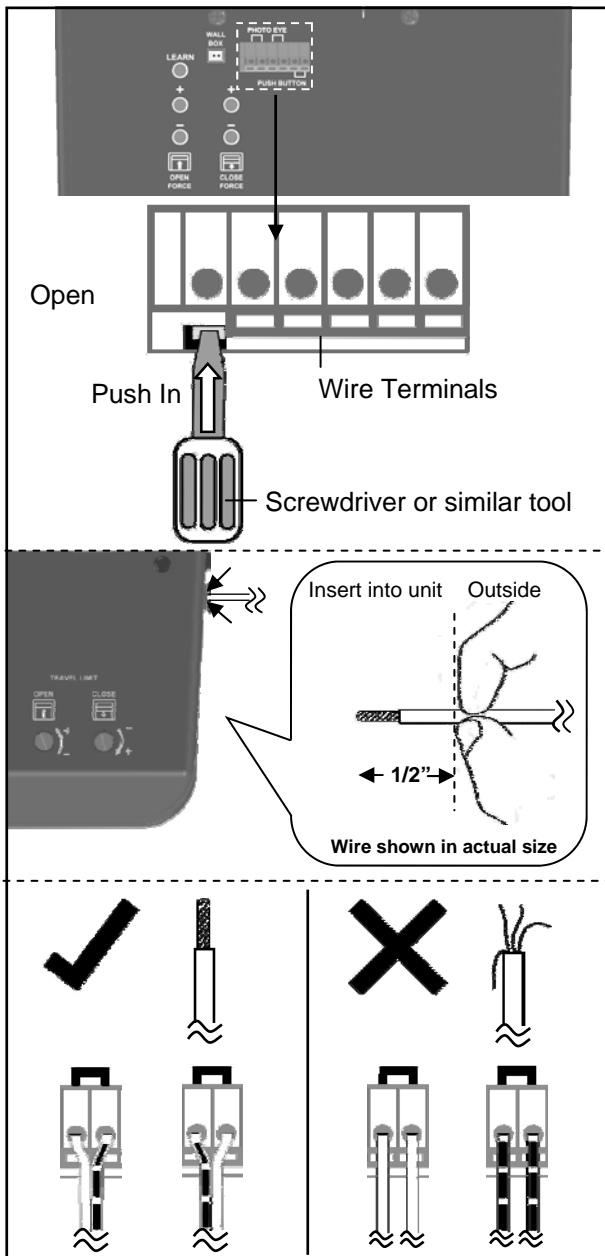

**Fig. 2**

In the following section, the photo eye safety system and large push button will be connected to the opener. Please read and understand the wiring instructions before connecting wires.

1. Remove the pre-cut skin on the open end of wire from accessories. Wires **MUST NOT** be frayed. Wires must be connected as shown in Fig.1.
2. To connect a wire to an assigned terminal, use a small "flat head" screwdriver to push in the orange tab on the Wire terminal as shown in Fig.2.
3. Insert approximately 1/2" (13mm) of the wire into the terminal while pushing in the tab as shown in Fig.2.
4. Each accessory requires a pair of terminals. Each pair of terminals **MUST** be connected with one white wire and one striped wire (non-polarized) from the **SAME** accessory as shown in Fig.2.
5. Check for proper connection by gently pulling on the wire. The wire should not come out of the terminal. **NO** exposed part of the wire should be visible outside of the terminal.
6. Use the insulated staples provided to secure the wires to the wall and/or ceiling. Be careful not to damage the wires while securing the staples.

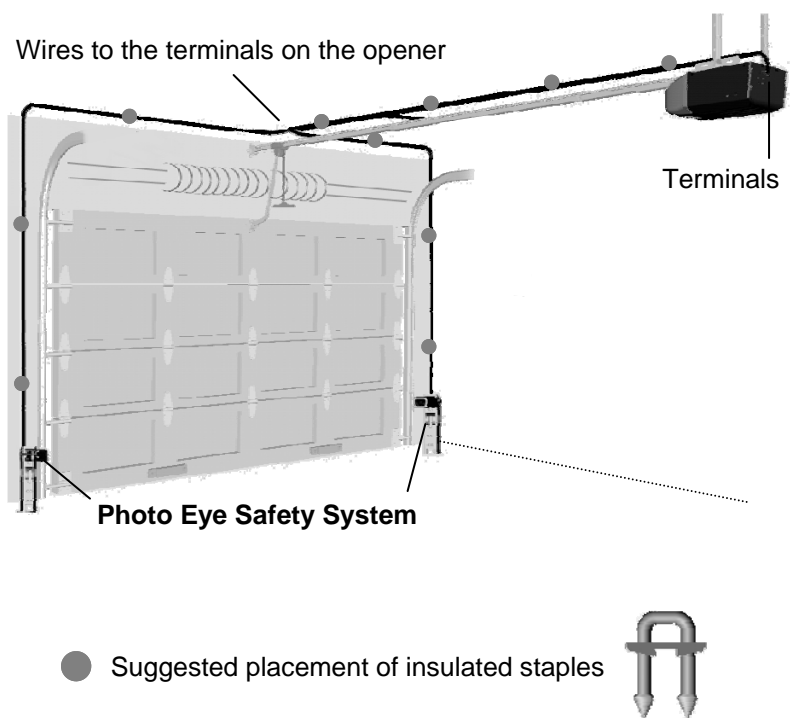

# Connecting Photo Eye Safety System

## **WARNING**

To prevent **SERIOUS INJURY** or **DEATH** from electrocution:

- Power **MUST NOT** be connected **BEFORE** photo eye safety system is connected and aligned.
- The opener will not operate until the photo eye safety system is properly connected and aligned.
- Install the photo eyes **NO** higher than 6" (15cm) above the floor.

No part of garage door or other objects should obstruct the photo eye safety system during door-closing.

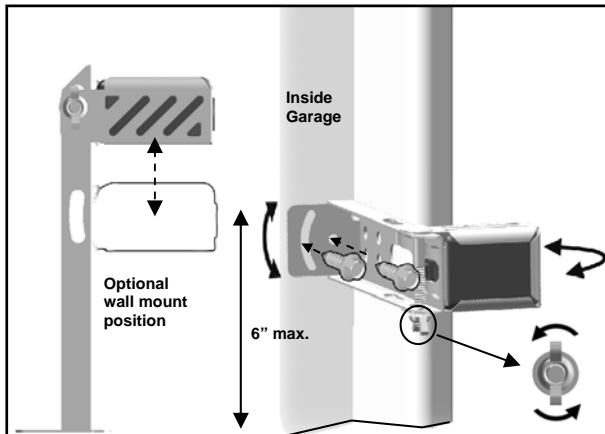

**Fig. 1 (Wall Mount)**

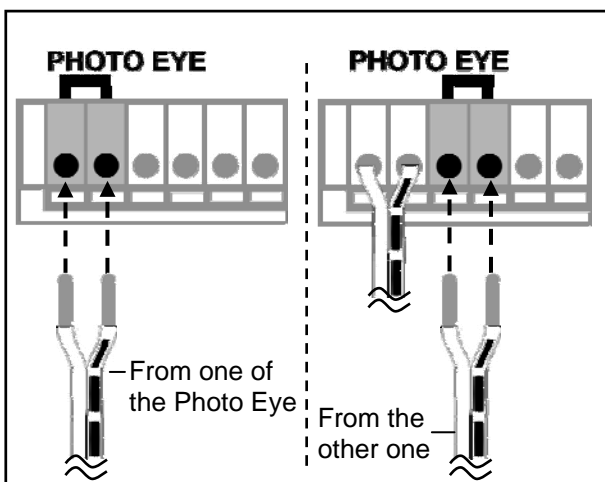
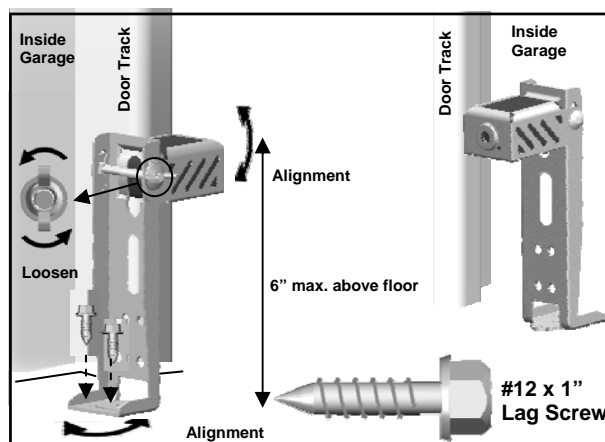

**Fig. 3**

## **About the Photo Eye Safety System**

The photo eye safety system provides protection against entrapment while the door is closing. When properly connected and aligned, the emitter photo eye emits an invisible infrared light beam while the sensor photo eye monitors that beam.

If the beam is obstructed during door-closing, the entrapment protection will be triggered and the door will stop and reverse to the open position. The courtesy light will flash for 30 seconds indicating an obstruction.

## **Installing The Photo Eye Safety System**

### **Wall-mounting**

1. Place the photo eyes facing each other on each side of the garage door. Position the sensors so they are no higher than 6" (15cm) above the floor, as shown in Fig.1.
2. Drill 3/16" holes using the mounting holes on the bracket as a template. Secure with #12 x 1" lag screws (provided).
3. Be sure brackets, when mounted, are **NOT** in contact with the door track.
4. If necessary use the optional wall-mount position (Fig.1) to better fit your door-track and improve obstacle avoidance. To adjust the position, loosen the wing nut, disassemble the bracket and move the photo eye to the lower position on the holder.
5. If necessary, align the photo eyes by loosening the wing nut. (This step may be further required in **Aligning the Photo Eye Safety System** on page 15.)

### **Alternative Floor-mounting**

1. Place the photo eyes facing each other on each side of the garage door, as shown in Fig.2.
2. If attaching to concrete, secure the photo eyes using concrete anchors and bolts (not provided).
3. Be sure brackets, when mounted, are **NOT** in contact with the door track.
4. If necessary, align the photo eyes by loosening the wing nut. (This step may be further required in **Aligning the Photo Eye Safety System** on page 15.)

### **To Connect Photo Eye Safety System**

1. Connect a pair of wires from either one of the photo eyes to a pair of "PHOTO EYE" terminals on the rear of the opener as shown in Fig. 3. Refer to **Wiring Instructions** on page 12 for proper connections.
2. Repeat above step to connect the other photo eye.
3. Refer to **Wiring Instructions** on page 12 to ensure wires are connected properly.

# Connecting Push Button

## **WARNING**

To prevent **SERIOUS INJURY** or **DEATH** from electrocution:

- Power **MUST NOT** be connected until instructed.

To prevent **SERIOUS INJURY** or **DEATH** from using the push button and a closing door:

- Install the push button within sight of the door at a minimum height of 5 feet (1.5m) above the floor. Make sure it is out of the reach of children and moving parts of door and hardware.
- **NEVER** permit children to access the push button or remote controls.
- Operate the door **ONLY** when it is adjusted properly with no obstructions present and is in clear sight.
- **ALWAYS** keep a moving door in sight until it's completely closed.
- **NEVER** cross the path of a moving door.



**NOTICE:** Only use the Push Button included with this GDO model or identical replacement part. See **Accessories in Repair Parts** section of this manual.

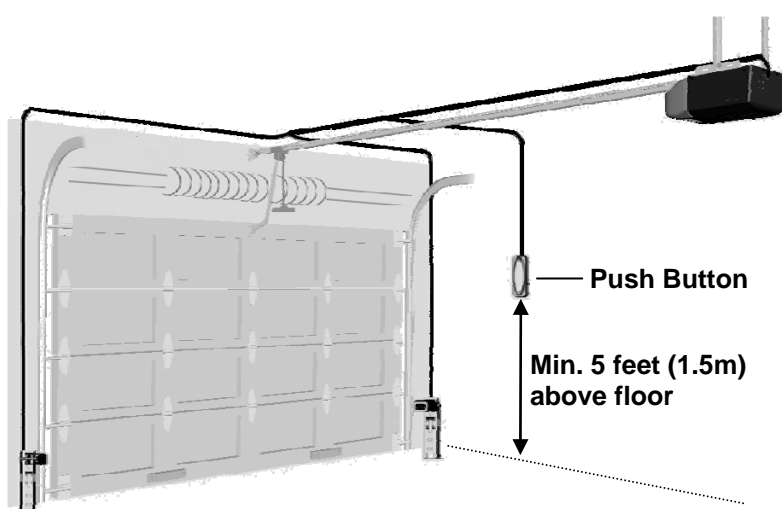
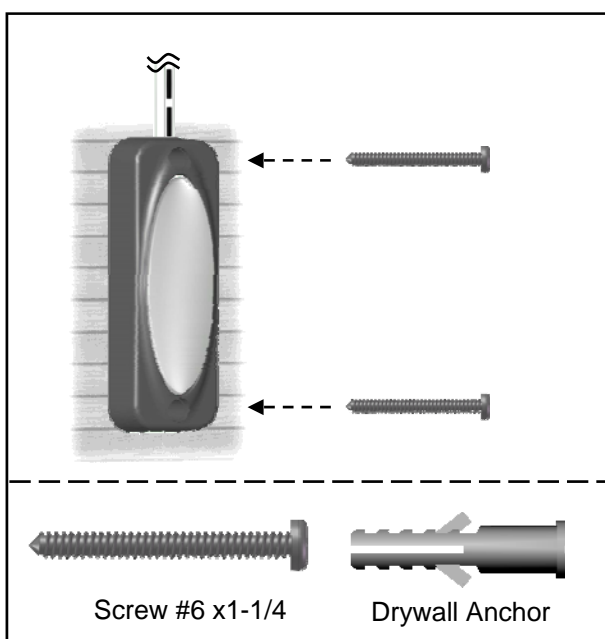

The push button is a wired, illuminated door control placed inside your garage.

### To install the Push Button:

1. Inside your garage, install push button within sight of the door at a minimum height of 5 feet (1.5m) off the ground. Ensure it is installed out of the reach of children and free from the moving parts of the door and hardware.
2. Securely fasten it to a solid surface with 1" screws. If attaching to drywall or other hollow surface, drill 3/16" holes and use the provided drywall anchors.

### To Connect the Push Button to the Opener

Connect the pair of wires from the push button to the pair of "PUSH BUTTON" terminals on the rear of the opener. Refer to **Wiring Instructions** on page 12 to ensure wires are properly connected.

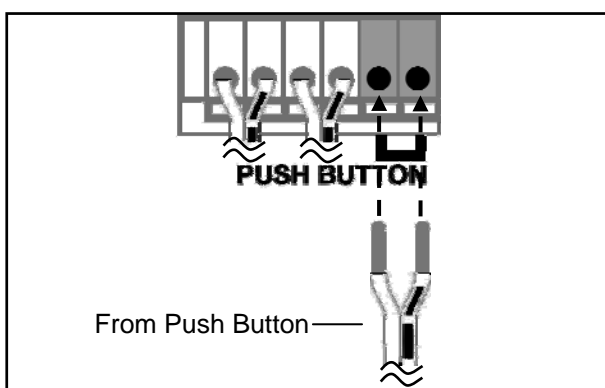

# Connecting Power

## **WARNING**

To prevent **SERIOUS INJURY** or **DEATH** from electrocution or fire:

- Power **MUST** be **DISCONNECTED BEFORE** proceeding with permanent wiring procedures.
- Garage door opener installation and wiring **MUST** be in compliance with all local electrical and building codes. Make sure the opener is **ALWAYS** grounded.
- **NEVER** use an extension cord, 2-wire adapter or modify the power plug in any way to make it fit the outlet.



Ordinary Power Connection

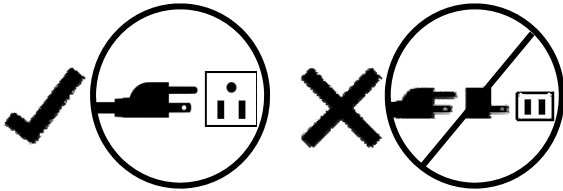

**DO NOT OPERATE OPENER AT THIS TIME.**

### To Connect Power

Plug the opener into a grounded outlet **ONLY**. If there is no grounded outlet present, call a qualified electrician to replace the outlet. Use of a surge protector is highly recommended page 4.

### Permanent Wiring (If Required by Local Code)

1. Remove the enclosure by removing the 6 screws located on the sides and rear of the opener.
2. Cut the two cable pressure connectors connecting line (black) and neutral (white) wire from the power cord.
3. Remove the grounding screw connecting the green wire.
4. Remove the power cord.
5. Group neutral (white) wires from power source with 2 white wires from light cable, and logic board, and yellow wire from motor, inside the opener. Connect them with a wire nut.
6. Group line (black) wires from power source with another black wires from logic board inside the opener. Connect them with a wire nut.
7. Secure the ground (green or bare) wire from the power source with a grounding screw.
8. Reinstall the enclosure.
9. Turn on power supply. If the wiring is properly connected, a "click" should be heard and the light will illuminate (if a bulb is installed). If there is no response from the opener, check power source and wiring.

For Permanent Wiring **ONLY**

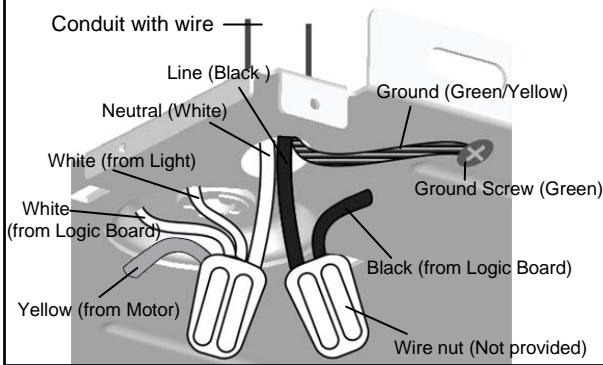

# Aligning the Photo Eye Safety System

## **WARNING**

To prevent **SERIOUS INJURY** or **DEATH** from a closing garage door:

- The photo eye safety system **MUST** be installed **BEFORE** connecting power.
- The photo eye safety system **MUST** be properly connected and aligned **BEFORE** operating the opener.

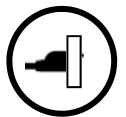

**NOTICE: The opener will not close until the photo eyes are installed. Photo eyes are required by federal law to be installed on all openers.**

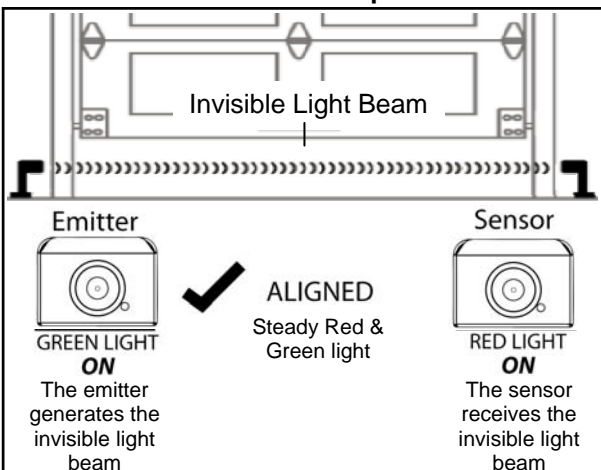

### Aligning the Photo Eye Safety System:

1. When power is supplied, the green photo eye (Emitter) will flash until it is aligned with the red photo eye (sensor). The red photo eye will not light until it is aligned with the green eye.
2. When the photo eye system is properly aligned the green photo eye (emitter) will emit a steady green light and the red photo eye (sensor) will emit a steady red light.
3. If either of the photo eye lights are unsteady, flash or dim, check for an obstruction and carefully adjust the position of the photo eyes until they give a steady green light and steady red light.

**Note: The path of the invisible light beam **MUST NOT** be obstructed. No part of the garage door or any hardware should interfere or block either sensor.**

# Travel Limit Adjustment

## **WARNING**

To prevent **SERIOUS INJURY** or **DEATH** from improper force adjustment:

- Improper adjustment of travel limits will cause operation of safety reversal mechanism.
- If travel limit adjustment is made, force adjustment may also be needed.
- After **ANY** adjustments, the safety reverse test **MUST** be performed to ensure the door reverses on contact with a 1-1/2" thick object (2x4 laid flat).

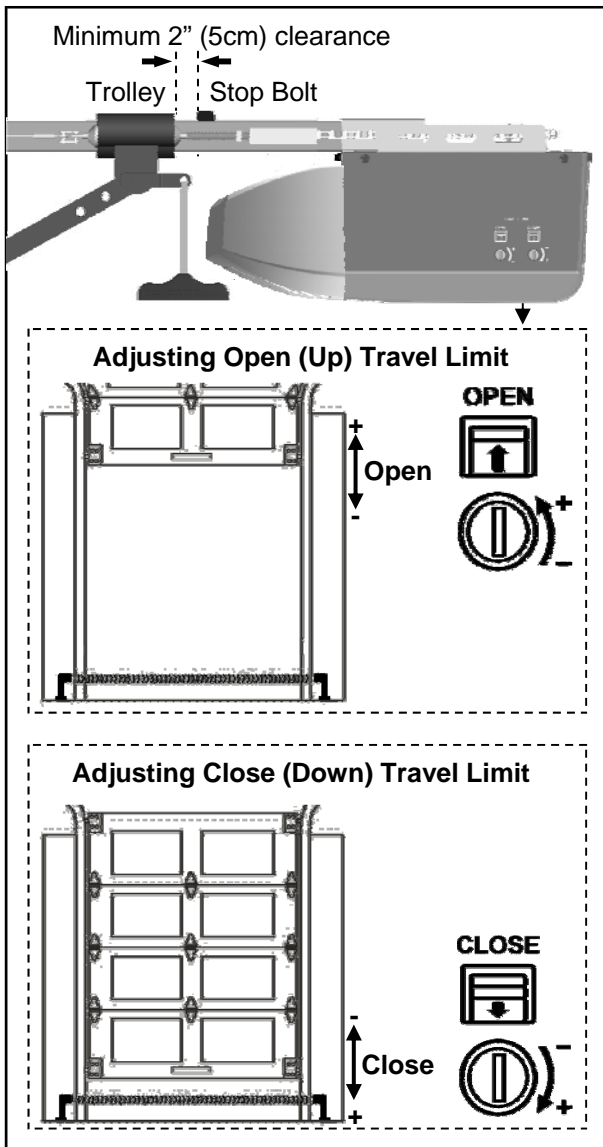

**If the door reverses unintentionally during closing, check below symptoms:**

1. The photo eye system may be improperly connected, misaligned or obstructed. The courtesy light will flash continuously for 30 seconds. Refer to **Troubleshooting** on P.22.
2. Binding door — disconnect the door from the opener by using the emergency release handle. Open and close the door manually and check the following steps.
  - 2.1 If the door is balanced, refer to **Force Adjustment** on Page 17 to adjust Close force.
  - 2.2 If the door is unbalanced, binding or jammed, call a trained service person to adjust the door.

### **About Travel Limits**

Limit adjustments regulate the position at which the door will stop when opening and closing.

**BEFORE** making any adjustments, operate the door by using the large push button or remote. Run the opener through a complete cycle.

*If the door opens and closes completely without unintended reversing upon closing — NO adjustment is necessary.*

If the door does not open or close at desired positions, proceed with the instructions below to adjust the travel limits.

### **Adjusting Travel Limits**

Open and close limits can be increased (+) or decreased (-) by turning the corresponding screws on the opener. Use a "flat head" screwdriver to make adjustments. One full turn of the screw is about 2" (5cm) of actual travel.

**NOTE:** The opener motor includes an automatic thermal protection system which will shut down the motor in an overheat situation. The thermal protector will reset itself once the motor cools down. Opening and closing the opener multiple times (in a short period of time) may cause the motor to overheat and shut down. If this happens, wait about 15 minutes for the motor to cool and retry operation.

### **Setting OPEN (UP) Travel Limit**

1. **CLOSE** the garage door by using either the remote or large push button .
2. Adjust the OPEN limit screw.
3. **OPEN** garage door and check for proper adjustment.
4. Repeat steps 1-3 until the door opens to the desired position. When the door is in the open position, make sure there is enough clearance for your vehicle(s), and there is a minimum 2" (5cm) gap between trolley and stop bolt.
5. Perform **Safety Reverse Test** on page 18.

If the door does not open past 5 feet (1.5m), follow **Force Adjustment** on page 17 to adjust the open force.

### **Setting CLOSE (DOWN) Travel Limit**

1. **OPEN** the garage door by using either the remote or large push button .
2. Adjust the CLOSE limit screw.
3. **CLOSE** the garage door and check for proper adjustment.
4. Repeat steps 1-3 until door closes to the desired position.
5. Perform **Safety Reverse Test** on page 18.



# Force Adjustment

## **WARNING**

To prevent **SERIOUS INJURY** or **DEATH** from improper force adjustment:

- **DO NOT** adjust force to compensate for binding or sticking of the garage door. Call a qualified garage door service technician to make necessary adjustments in case of binding.
- **DO NOT** increase the force beyond minimum force required for closing the door. Too much force will cause improper operation of safety reversal mechanism.
- If either the force or travel limit adjustment is made, the other adjustment may also be needed.
- After **ANY** adjustments, the safety reverse test **MUST** be performed to ensure the door reverses on contact with a 1-1/2" thick object (2x4 laid flat).

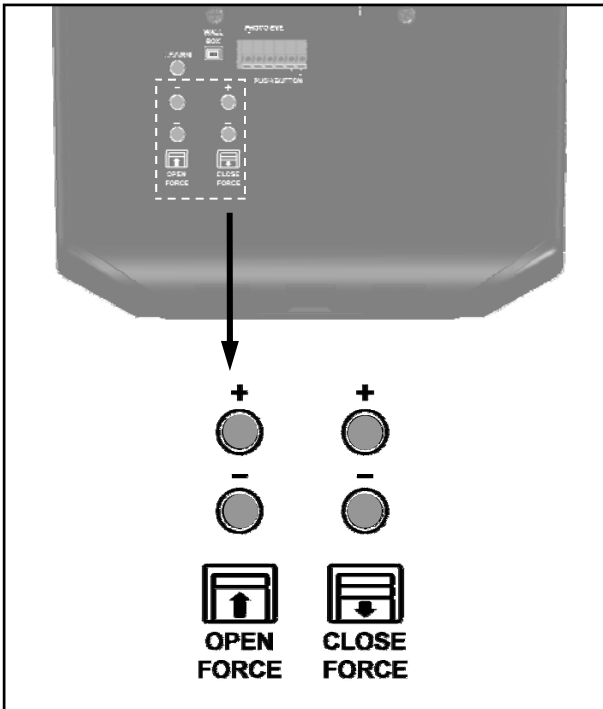

***For safe operation, the force setting should always be set at the MINIMUM FORCE required to run the door.***

## **Adjusting Force**

1. Force adjustment controls are located on the rear panel of the opener. The force adjustments regulate the amount of force required to open or close the door.
  2. Force adjustment is applied only to compensate for the minor resistance caused by weather or other means.
- Note: Force is preset at level 6 for both open and close adjustments. The size and operating conditions of the garage door will determine the correct level of force/sensitivity. Weather conditions may also affect the operation of the door requiring further adjustments as needed.
  - Note: If the close force is set too light the opener will reverse the door during closing. If the open force is set too light the opener will stop the door during opening.
  - Note: There are 12 levels for open and close force settings. When either the maximum or minimum level is reached, the light will flash 6 times.
  - Never adjust the force setting by more than 1 level (1 press) at a time.

## **Setting Force**

### **Setting Close Force**

1. If the door completes a full close cycle without reversing, decrease (-) the close force by 1 level at a time until the door reverses. If the door reverses during closing, increase (+) close force by 1 increment. The close force is now properly adjusted.
2. During the "door-close" cycle, the opener will reverse if the force required to close the door is exceeded.

### **Setting Open Force**

1. If the door completes a full open cycle without stopping, decrease (-) the amount of force by 1 level until the door stops during the opening. Once the door stops during opening, increase (+) open force by 1 increment. The close force is now properly adjusted.
2. During the "door-open" cycle the opener will stop if the force required to open the door is exceeded.

# Final Adjustments and Testing

## **WARNING**

To prevent **SERIOUS INJURY** or **DEATH** from a closing garage door:

- The Safety Reversal Test **MUST** be conducted **ONCE A MONTH**.
- **NO ONE** should cross the path of moving door during operation and/or testing.
- If either force or travel limit adjustment is made, the other adjustment may also be needed.
- After **ANY** adjustments to the door system, the Safety Reverse Test **MUST** be performed to ensure the door reverses on contact with a 1-1/2" thick (2x4 laid flat) object.
- The photo eye safety system **MUST** be properly aligned, and tested regularly.

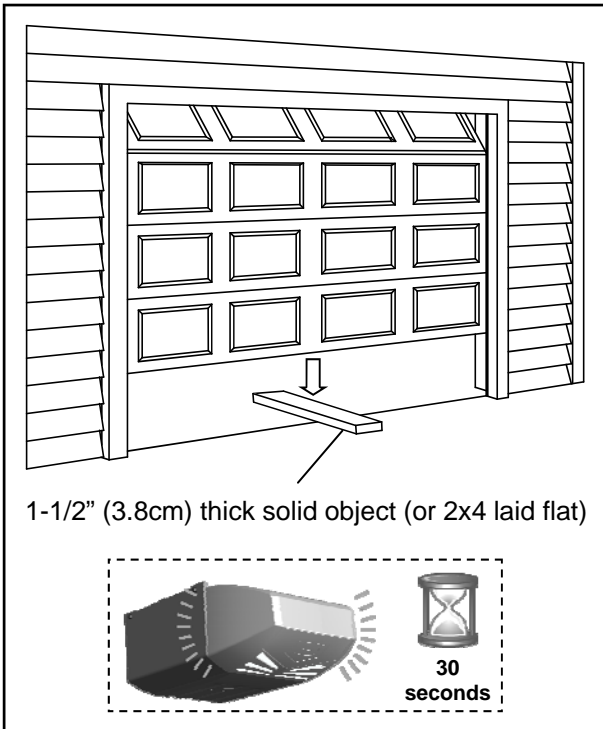

### Testing the Safety Reverse System

**The Safety Reverse System prevents the door from closing when an obstruction is present.**

1. Open the door by using the large push button or remote
2. Place a 1-1/2" (3.8cm) thick solid object (or 2x4 laid flat) on floor under the center of garage door.
3. Keeping the door in sight, use the large push button or remote to close the door.
4. The door **MUST REVERSE** upon striking the object within 1.5 seconds, and stop at the fully opened position.
5. The courtesy light will start flashing for 30 seconds upon triggering the Safety Reverse System.

If the door just stops on the object, adjust the opener as follows:

The close travel maybe inadequate, Increase close travel limit by 1/4 turn (See **Limit Adjustment** on page 16)

Conduct the test again. If the door reverses on contact, remove the object and run at least 3 **COMPLETE** travel cycles to ensure proper adjustment.

If the door still does not reverse on the object, decrease the close force (see **Force Adjustment** on page 17) and repeat the test.

If the opener still fails the safety reverse test, call a qualified technician for door adjustment.

### Testing the Photo Eye Safety System

1. Open the door by using the large push button or remote
2. Make sure both photo eyes steadily emit the green and red indicator lights. (If not, check alignment)
3. Place an object under the door about 8" (20cm) high by 12" (30cm) wide (the opener carton can be used),
4. The red indicator light on the sensor eye should be dimmed.
5. Keep the door in sight and use the large push button or remote to try to close the door.
6. The door should **NOT** move more than 1" (2.5cm) and the courtesy light should flash for 30 seconds.

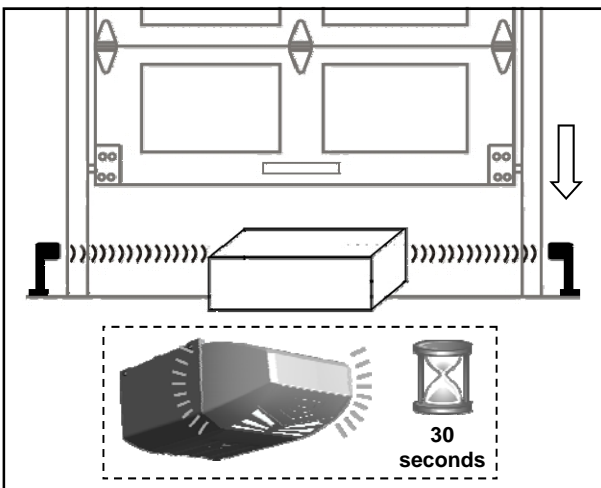

# Programming 1– Button Remote

## WARNING

To prevent SERIOUS INJURY or DEATH:

- Keep remote and battery out of reach of children.
- NEVER permit children to access the wall panel nor remotes.
- Operate the door ONLY when it is properly adjusted, and there are no obstructions present.
- ALWAYS keep a moving door in sight until completely closed. NEVER cross the path of a moving door.



To reduce risk of fire, explosion or electric shock:

- DO NOT short circuit, recharge, disassemble or heat the battery.
- Replace with 23AE 12 volt batteries ONLY. Dispose of batteries properly.

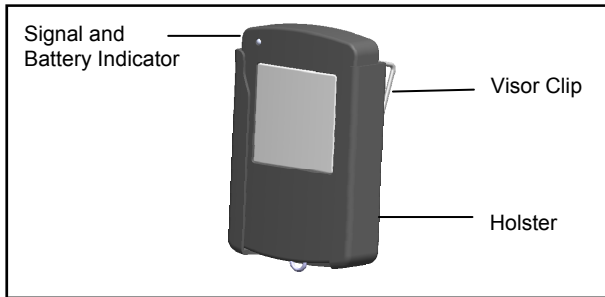

Fig.1

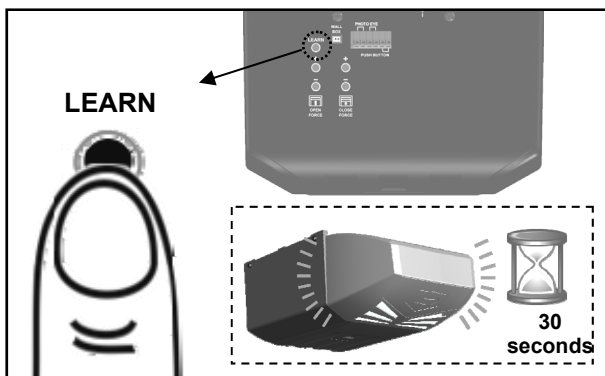

Fig.2

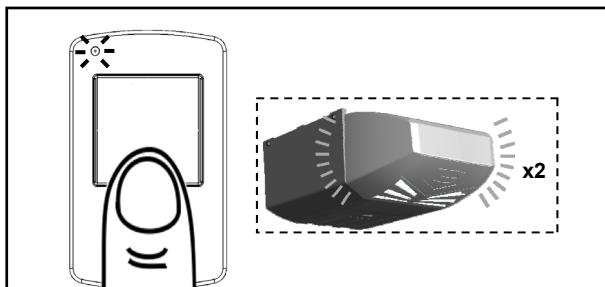

Fig.3

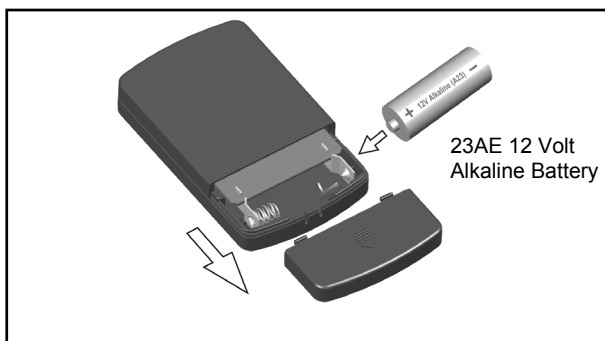

Fig.4

### To Program Remote(s):

1. See Fig.2 to add a remote. Press the “LEARN” button on the rear control panel of the opener. The courtesy light will illuminate with an audible click\*. The unit is now ready to learn a remote.
2. Within 30 seconds, press the button on the remote.
3. The courtesy light will flash twice indicating remote has been stored successfully\*\*.

Up to 20 remotes (including keyless entry pad codes) can be added to the unit by repeating the above procedures.

If more than 20 remotes are stored, the first stored remote will be replaced. (i.e. the 21st remote replaces the 1st stored remote.)

\* If the courtesy light is already on, it will flash once and stay illuminated for 30 seconds.

\*\* If a remote is not accepted, the courtesy light will stay on for 30 seconds, flash 4 times and then stay on for 2-1/2 minutes. Retry programming the remote by repeating the steps above.

### Removing all Remotes:

To remove all remotes from memory, press and hold the “LEARN” button for 5 seconds. The courtesy light will flash 7 times indicating all remotes have been removed from memory.

### Replacing Remote Battery:

When the battery of the hand held remote is low, the indicator light will become dim and/or the range of the remote will diminish. To replace the battery, remove the battery cover from the remote as shown in Fig 4. Replace with a 23AE 12 volt alkaline battery with polarity shown in Fig.4.

This device complies FCC rules for HOME OR OFFICE USE. Operation is subject to the following two conditions: (1) this device may not cause harmful interference, and (2) this device must accept any interference received, including interference that may cause undesired operation.

# Programming Keyless Entry Pad \*

To purchase a keyless entry pad, visit a Craftsman outlet, call 1-888-331-4569, or go online to [www.craftsman.com](http://www.craftsman.com).



## WARNING

To prevent SERIOUS INJURY or DEATH:

- Keep remote and battery out of reach of children.
- NEVER permit children to access the wall panel, push button nor remotes.
- Operate door only when it is adjusted properly with no obstructions to door travel and is in clear sight.
- ALWAYS keep a moving door in sight until completely closed. NO ONE should cross the path of a moving door.



To reduce risk of fire, explosion or electric shock:

- DO NOT short circuit, recharge, disassemble or heat battery.
- Replace with 1.5 volt AAA batteries ONLY. Dispose of batteries properly.

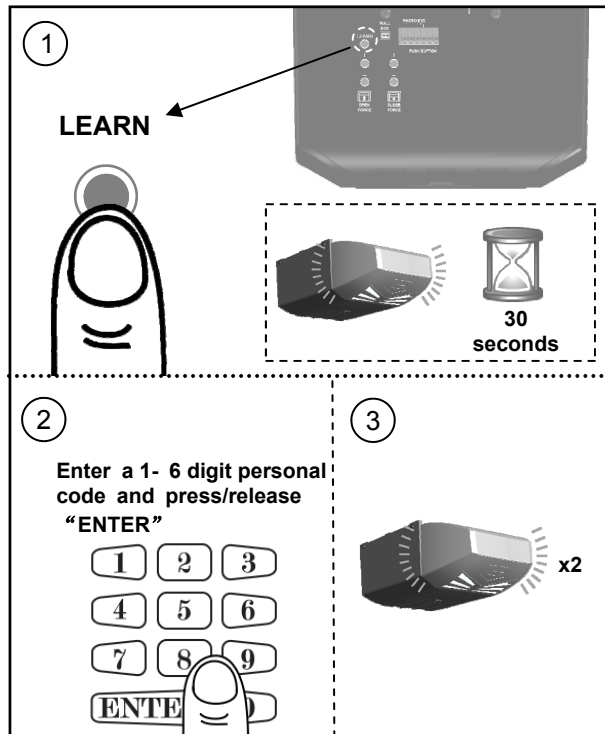

Fig.1

### To Add Personal Codes:

1. Press the "LEARN" button on the rear control panel, "OK" LED will glow and beep. The unit is ready to accept a remote in the next 30 seconds as shown in Fig. 1.
2. Enter a 1 - 6 digit personal code on the keyless entry within 30 seconds and press/release "ENTER" button. "OK" LED will flash and beep twice indicating personal code is stored in memory.

Up to 20 personal codes (including 1-button remotes) can be added to the unit by repeating the above procedures.

If more than 20 personal codes are stored, the previously stored one from the very beginning will be replaced, (i.e. the 21st remote replaces the 1st stored one.)

### Operation:

To access the door, enter a pre-stored personal code and press "ENTER" to transmit code, and within 20 seconds, "ENTER" button can be used to stop or reverse the door.

If the code is entered incorrectly, correction can be made by pressing "ENTER" to reset and re-enter code.

When dark, "ENTER" may be pressed in advance to turn on back light.

### Removing ALL Personal Code(s):

To remove ALL personal code(s) and/or remotes from memory, press and hold the "LEARN" button for 5 seconds. "OK" LED will flash and beep, indicating all codes/remotes have been removed from memory.

### Mounting the Keyless Entry:

Keyless entry may be secured on door jamb face outside your garage. Locate keyless entry within sight of door at minimum height of 5 feet (1.5m), ensure it is away from reach of children and moving parts of door and hardware. Test the reception of the keyless entry before mounting. Change location for better reception if necessary.

Use the mounting holes on the keyless entry as template to mark position on the mounting surface. To attach to a wooden surface use the screws provided. In case of a drywall surface, drill holes and use drywall anchors provided.

### Replacing Keyless Entry Battery:

When the battery of keyless entry is low, dimmed illumination is observed. To replace battery, remove the battery cover by loosening the screws underneath, and replace the battery with two 1.5 volt AAA batteries.

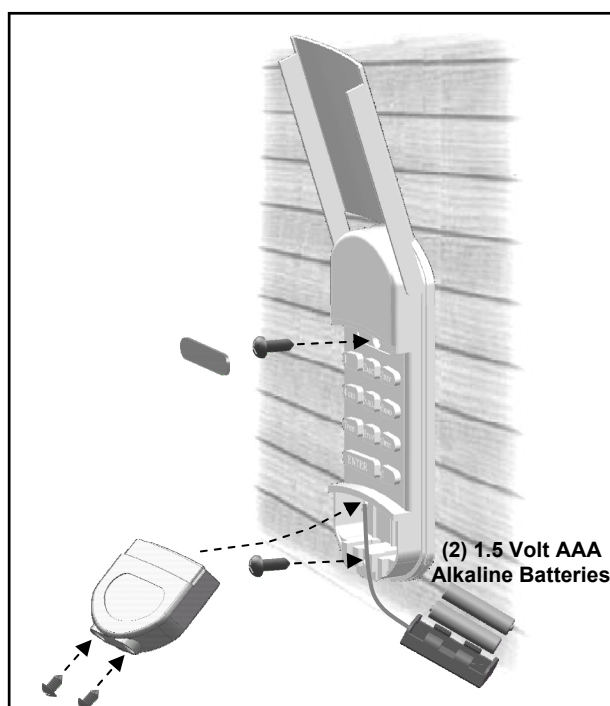

Fig.2

\*Optional

# Operating the Opener

## **WARNING**



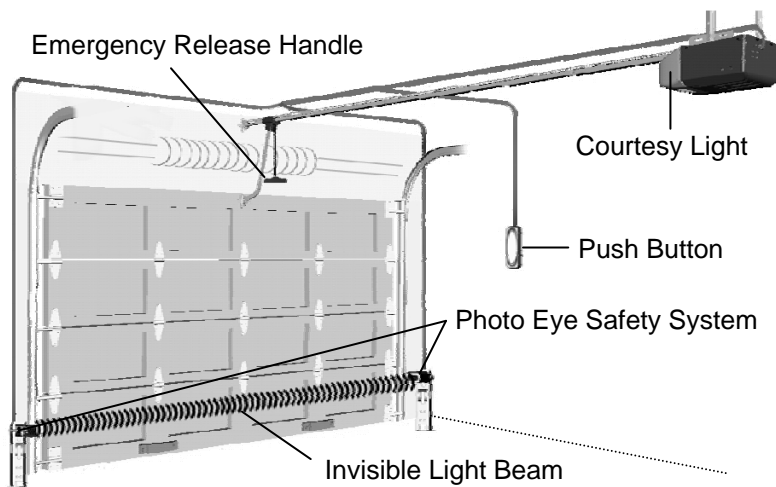

To prevent **SERIOUS INJURY** or **DEATH**:

- **READ AND FOLLOW ALL INSTRUCTIONS AND WARNINGS IN THE OWNER'S MANUAL AND LABELS**
- Keep remote and battery out of reach of children.
- **NEVER** permit children to access the wall panel or remotes.
- Operate the door **ONLY** when it is properly adjusted, and there are no obstructions and is in clear sight.
- **ALWAYS** keep a moving door in sight until completely closed. **NEVER** cross the path of a moving door.
- If travel limit adjustment is made, force adjustment may also be needed.
- After **ANY** adjustments, the safety reverse test **MUST** be performed to ensure the door reverses on contact with a 1-1/2" thick object (2x4 laid flat).
- **ALWAYS** ensure that your door is balanced and in good working condition.



**Actual Operating Scenario**

### Activating the Opener

Controls	Operation
 <p>Push Button (Indoor)</p>	<p>Press and hold the push button until the door starts to move, and controls as follows:</p> <ul style="list-style-type: none"> <li>- Open or close the door.</li> <li>- Reverse the door while it is closing</li> <li>- Stops the door while it is opening.</li> <li>- Close the door when the photo eye safety system is not installed, misaligned or obstructed <b>INTENTIONALLY</b>.</li> </ul>
 <p>1- Button Remote</p>	<p>Same functions* as the push button with remote distance up to 100 ft. in open field. *For safety concerns, the 1– button remote <b>WON'T</b> work if the photo eye safety system is not properly installed and aligned.</p>
 <p>Keyless Entry Pad *</p>	<p>Program the keyless entry pad accordingly and access the door using the PIN code.</p>
 <p>3-Button Mini Remote*</p>	<p>Remote distance up to 100 ft. in open field. For safety concerns, the hand-held remote <b>WILL NOT</b> work if the photo eye safety system is not properly installed and aligned.</p>

**\*Optional**

See Accessories in Repair Parts section of this manual for purchase.

## Door Status vs. Activation

Door status	 Activation using Push Button / Remote
Door at fully open / close position	Door will move to fully close / open position
Door is closing	Door will reverse
Door is opening	Door will stop
Door is stopped as intended in partially open position	Close
Door is obstructed while closing	Door will reverse while flashing courtesy light
Door is obstructed while opening	Door will stop
Door is fully opened and photo eye system is obstructed	Door will not close

## Courtesy Light Responses

Operation / Condition	 Courtesy Light Response
Opener is initially plugged-in / Power restored	Flashes five times
Upon opener activation	Turns on for 4-1/2 minutes and turns off automatically
"LEARN" button is pressed	Turns on for 30 seconds
Remote / Keyless entry PIN code accepted	Flashes twice
The photo eye system is obstructed during door-closing or door is obstructed during opening	Flashes for 30 seconds (Re-align and clear obstruction)
Opener motor overheat (Thermal Protection)	Flashes 5 times (Wait about 15 minutes to cool down)

## Manual Operation

### **WARNING**

To prevent **SERIOUS INJURY** or **DEATH**:

- Use emergency release to disconnect trolley **ONLY** when the door is **CLOSED** to prevent unexpected rapid falling in case of a unbalanced / poor-conditioned door.
- Use emergency release **ONLY** when doorway is clear of persons and obstructions.
- **DO NOT** use emergency release to pull the door open or closed.

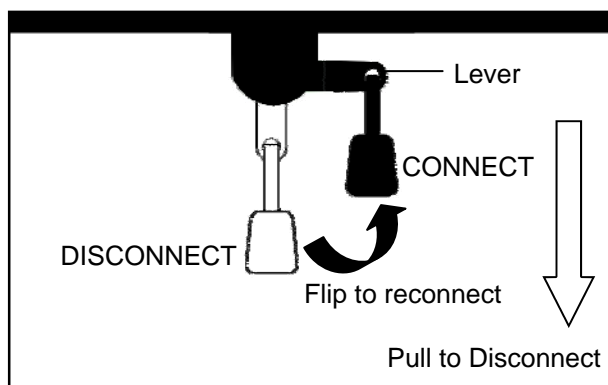

In case of a power failure or door obstruction, **PULL EMERGENCY knob** to release door from opener.

### **To Disconnect Trolley for Manual Operation**

With the door closed, pull down the emergency release knob to the **DISCONNECT** position. The door can be raised / lowered manually.

### **To Re-connect Trolley**

Pull the knob toward the opener so that the lever will flip up to the **CONNECT** position. The trolley will reconnect itself when the opener is activated or when the door is manually opened/ closed

## Maintenance

Schedule	Maintenance
Once a month	Door balance test, refer to page 4. Safety reverse test, refer to page 18.
Twice a year	Check chain tension ( refer to page 6 for adjustment if necessary).
Once a year	- Limit and force adjustment may be necessary due to weather conditions. Refer to pages 16-17 for adjustment. Conduct safety reverse test after ANY adjustments. - Lubricate door rollers, bearings and hinges. The opener is permanently lubricated, DO NOT lubricate or grease the opener, rail or door tracks.

## Troubleshooting

Problem	Possible Cause / Solution
Opener does not close and light flashes	The photo eye safety system is misaligned or obstructed, refer to pages 15 for proper alignment.
Opener does not respond to remote	- Refer page 19 to reprogram remote. - Check remote battery
Opener stops before reaching full open / close position	Either the travel limit or force is not properly adjusted, check adjustment referring to pages 16-17. Conduct safety reverse test after ANY adjustment.
The door reverses unintentionally	- Make sure the photo eye safety system is aligned and clear of obstructions. - Refer to page 4 to check the door balance - Refer to page 17 to re-adjust the force
The door reverses upon touching the floor and the courtesy light flashes	Refer to page 16 to decrease close limit by 1/4 turn until door stops as intended at the fully closed position. Conduct safety reverse test after ANY adjustment.
The courtesy light flashes 5 times and the Opener does not start	Opener motor overheat, please wait about 15 minutes and retry.
The opener does not close the door and the green LED on the photo eyes flashes	The photo eye safety system is misaligned or obstructed, refer to page 14 for proper alignment.
The opener is working properly but the courtesy light does not turn on	Replace light bulb (A19 incandescent Max. 100W).
The courtesy light does not turn off	Defective logic board.
The opener hums as the trolley hits the trolley stop bolt in open travel	<ol style="list-style-type: none"> <li>1. Make sure the trolley is towards the trolley stop bolt.</li> <li>2. Disconnect the trolley by using the emergency release.</li> <li>3. Close the door manually</li> <li>4. Relieve the chain tension by loosening both the chain-to-cable connector and the flange nut (see page 6)</li> <li>5. Operate the opener so the trolley shaft travels towards the door (Trolley should be kept disconnected)</li> <li>6. Refer to page 16 to decrease open travel limit by 2 full turns</li> <li>7. Refer to page 6 to re-tighten the chain until it is 1/4" (6mm) above the base of rail (reference the figure shown on page 6).</li> <li>8. Repeat the above steps if the trolley still hits the stop bolt.</li> </ol>

# Repair Parts

To purchase repair parts, call 1-888-331-4569.

## Rail Assembly Parts

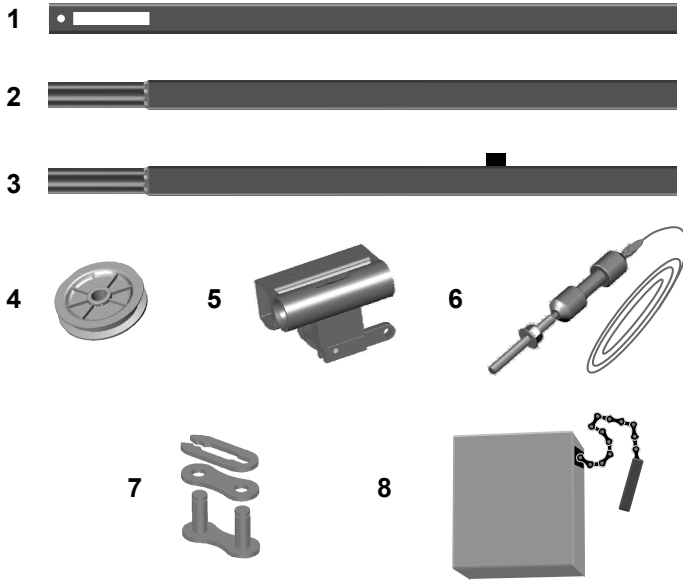

Item	Part No.	Name / Description
1	RP-001	Rail—Header Segment
2	RP-002	Rail—Middle Segments
3	RP-003	Rail—End Segment with Stop Bolt
4	GUT-840	Pulley
5	RP-004	Trolley
6	RP-005	Trolley Shaft and Cable
7	GUT-410	Master Link Set
8	RP-006	Chain

## Installation Parts

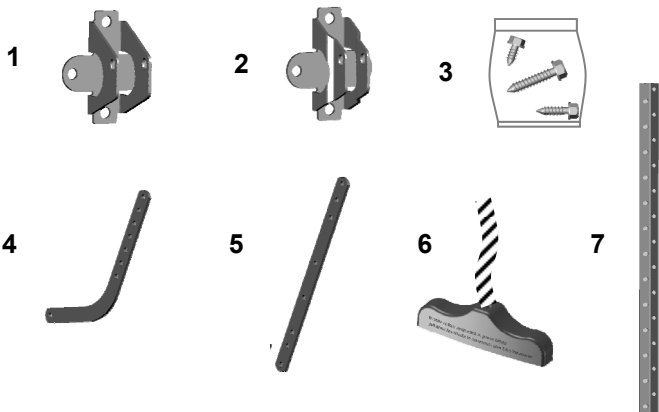

Item	Part No.	Name / Description
1	RP-007	Header Bracket
2	GUAT-022	Door Bracket
3	RP-008	Hardware Bag with Emergency Release Handle & Rope (Installation hardware shown on P.3)
4	GUAT-024	Curved Door Arm
5	GUAT-025	Straight Door Arm
6	GUAT-026	Emergency Release Handle + Rope
7	RP-009	Hanging Bracket

## Accessories

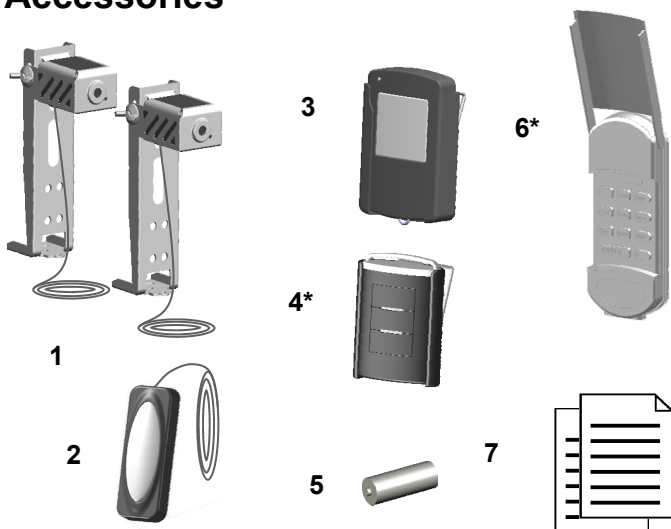

Item	Part No.	Name / Description
1	GUAT-201	Photo Eye Safety System (Emitter + Sensor with Brackets)
2	STDPX	Push Button
3	58502	1-Button Remote
4	57938	3-Button Mini Remote
5	GUAT-203	23AE 12 Volt Alkaline Battery
6	57939	Keyless Entry Pad
7	CR-001	Owner's Manual

### \*Optional

To purchase optional accessories, visit a Craftsman outlet, call 1-888-331-4569, or go online to [www.craftsman.com](http://www.craftsman.com)



## Opener Assembly Parts

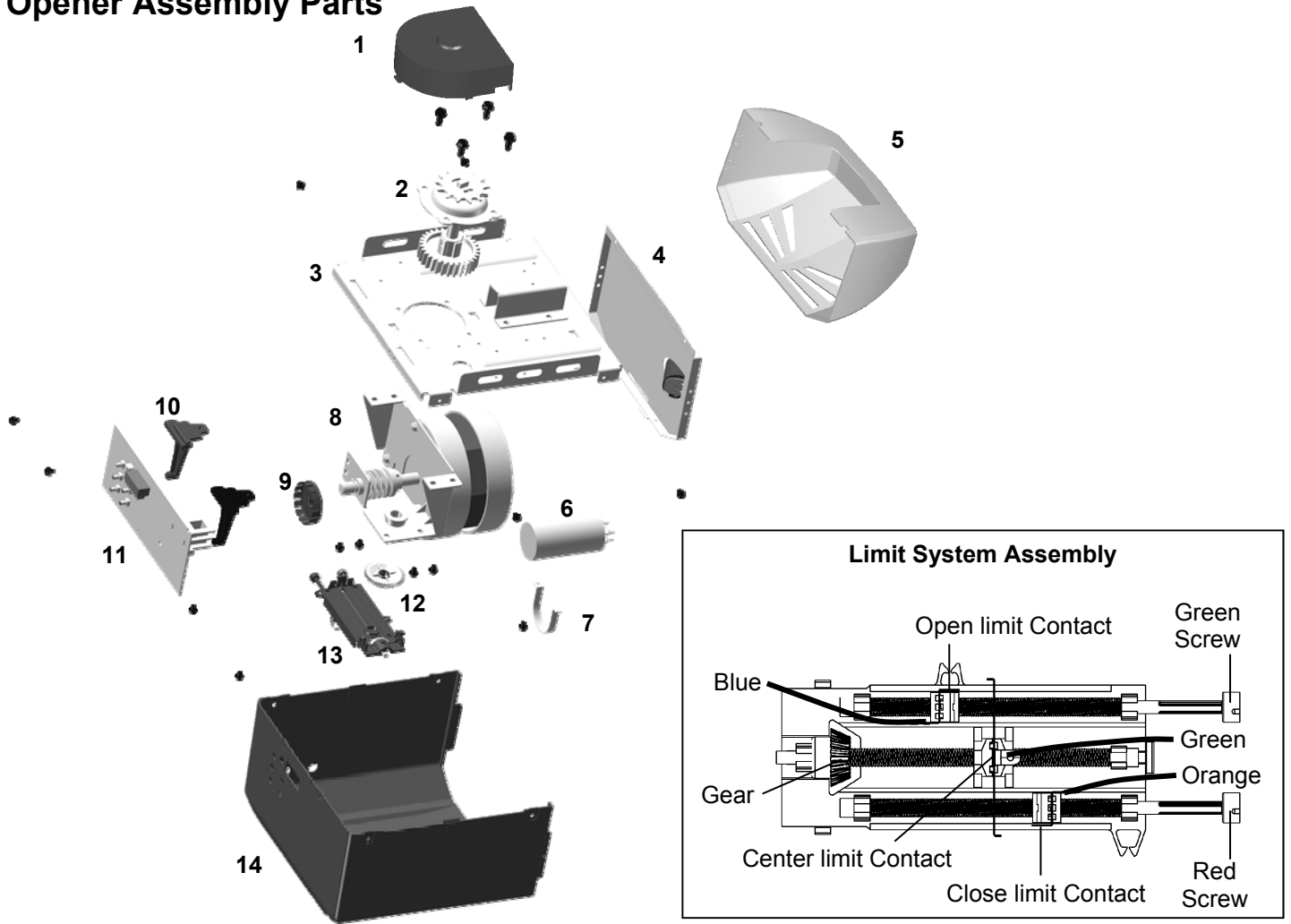

Item	Part No.	Name / Description
1	GUAT-327	Sprocket Cover
2	GUAT-323	Sprocket and Gear Assembly
3	GUAT-341	Chassis
4	GUAT-303	Light Plate
5	CR-003	Light Lens Cover
6	GUAT-305	Capacitor
7	GUAT-306	Capacitor Holder
8	CR-004	AC Service Motor & Bracket Assembly
9	GUAT-308	Garage Door Opener RPM Wheel
10	GUAT-309	Logic Board Holder
11	GUAT-310	Logic Board with Holder
12	GUAT-311	Limit System Driving Gear
13	GUAT-312	Limit System Assembly
14	CR-002	Opener Cover

\* Should be replaced by qualified technician only

# CRAFTSMAN WARRANTY

## **90-DAY IN-HOME LIMITED WARRANTY**

FOR 90 DAYS from the date of sale this product is warranted against defects in material or workmanship. With proof of purchase a defective product will be repaired free of charge.

## **LIMITED WARRANTY ON PARTS**

FROM THE 91st DAY THROUGH 1 YEAR from the date of sale this product is warranted against defective parts. With proof of purchase a new part will be furnished to replace a defective one free of charge. Any costs for professional installation are not included.

## **LIMITED WARRANTY ON MOTOR**

FROM THE 91st DAY THROUGH 4 YEARS from the date of sale the motor on this product is warranted against defects in material or workmanship. With proof of purchase a new motor will be furnished to replace a defective one free of charge. Any costs for professional installation are not included.

## **WARRANTY SERVICE**

For warranty coverage details to obtain product repair or replacement parts, visit the web page: [www.craftsman.com/warranty](http://www.craftsman.com/warranty)

## **WARRANT RESTRICTION**

This warranty does not cover light bulbs, which are expendable parts, or repair parts necessary because of operator abuse or negligence, including the failure to install, adjust and operate this garage door opener according to instructions contained in the owner's manual. This warranty also does not cover any problems caused by interference.

## **LIMITATION ON LIABILITY**

Seller will not be liable for loss or damage to property or any incidental or consequential loss or expense from property damage due directly or indirectly to the use of this product. Some states do not allow the exclusion or limitation of incidental or consequential damages, so the above limitation or exclusion may not apply to you.

## **DISCLAIMER OF IMPLIED WARRANTIES**

Except for the motor, all implied warranties for this product, including but not limited to any implied warranties of merchantability and fitness for a particular purpose, are limited in duration to the 90 day and 91st day through 1-year limited warranty period set forth above. All implied warranties with respect to the motor are limited in duration to the 91st day through 4-year limited warranty period set forth above. No implied warranties will exist or apply after such periods. Some states do not allow limitations on how long an implied warranty lasts, so the above limitations may not apply to you.

This warranty applies only while this product is in use in the United States.

This warranty gives you specific legal rights, and you may also have other rights which vary from state to state.

Sears Brands Management Corporation, Hoffman Estates, IL 60179

# **CRAFTSMAN®**

**Product questions or problems?**

# **1-888-331-4569**

## **Customer Care Hot Line**

**Get answers to questions, troubleshoot problems,  
order parts, or schedule repair service.**

Para respuestas a preguntas o problemas, y ordenar  
piezas o pedir servicio para la reparación de su equipo.

**To help us help you, register your product at [www.craftsman.com/registration](http://www.craftsman.com/registration)**

Para poderte ayudar mejor, registra tu producto en [www.craftsman.com/registration](http://www.craftsman.com/registration)

---

**Join the Craftsman Club today!**

# **CRAFTSMAN CLUB®**

**[www.craftsman.com/signup](http://www.craftsman.com/signup)**

**Receive exclusive member benefits including special pricing and offers,  
project sharing, expert advice, and SHOP YOUR WAY REWARDS!**

Como miembro exclusivo, recibe diversos beneficios como ofertas, precios especiales, proyectos nuevos, consejos de expertos y nuestro programa de puntos SHOP YOUR WAY REWARDS!

® Registered Trademark / ™ Trademark of KCD IP, LLC in the United States, or Sears Brands, LLC in other countries

® Marca Registrada / ™ Marca de Fábrica de KCD IP, LLC en Estados Unidos, o Sears Brands, LLC in otros países