



Thank you for purchasing the **Arbor Lounge Chair**. This page lists all the contents included in the box. Please take time to identify the hardware as well as the individual components of this product. As you unpack and prepare for assembly, place the contents on a carpeted or padded area to protect them from damage. **Note:** 2 people are required to safely assemble this product.

## HARDWARE



4 - bolts **(A)**  
6 x 75



4 - bolts **(B)**  
6 x 45



4 - barrel  
cams **(C)**

Missing hardware?  
Please call **800.606.6387** for replacements.

## TOOLS REQUIRED

allen wrench (included)

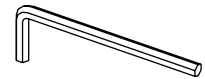

flat head screwdriver

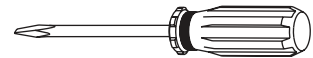

## ASSEMBLY

**STEP 1:** Insert 2 **barrel cams (C)** into **seat frame**. Make sure barrel cam holes are aligned with corresponding holes in seat frame. Attach **right side frame** to **seat frame** with **bolt (A)**, using an **allen wrench**. Make sure **bolt (A)** is fully engaged with **barrel cam (C)**. Using a **flat head screwdriver**, turn **barrel cam (C)** clockwise to secure.

**STEP 2:** Attach **right side frame** to **back frame** with 2 **bolts (B)**, using an **allen wrench**. Repeat step 1 and 2 for **left side frame**. Assembly is now complete.

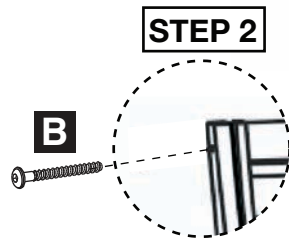
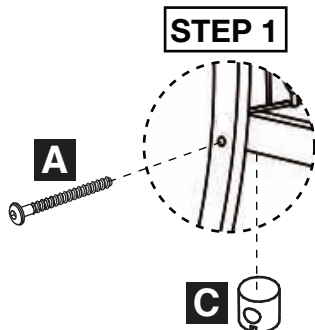
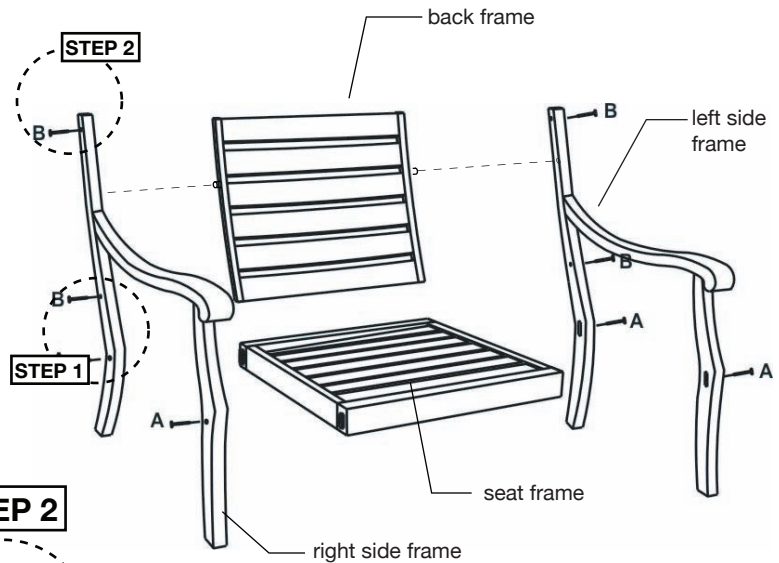

## CLEANING AND CARE

Clean surfaces with a dry or damp soft cloth. Do not use abrasive cleaners. We recommend the use of outdoor furniture covers during inclement weather. Treat with Crate and Barrel's Roble Protector or allow the finish to weather to a silver gray.