

Thank you for purchasing the **Loop 3 Drawer Chest**. This page lists all the contents included in the box. Please take time to identify the hardware as well as the individual components of this product. As you unpack and prepare for assembly, place the contents on a carpeted or padded area to protect them from damage. NOTE: 2 people are required to safely assemble this product.

HARDWARE



17 - cams



17 - cam screws

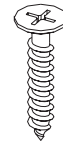

6- silver screws

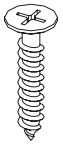

9 - black screws



12 - wood dowels



17 - cam covers



12 - glide screws



3 - pulls

Missing hardware? Please call **800.606.6387** for replacements.

TOOLS REQUIRED

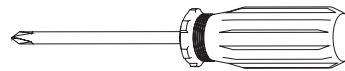

Phillips Head Screwdriver

COMPONENTS

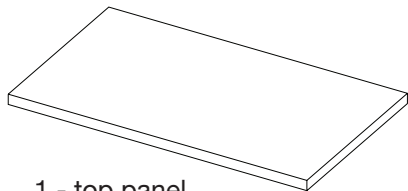

1 - top panel

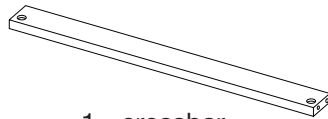

1 - crossbar

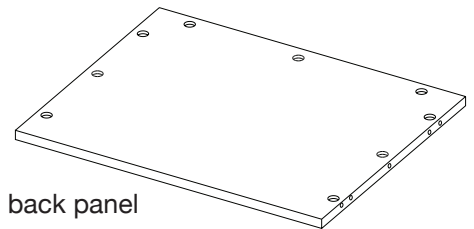

1 - back panel

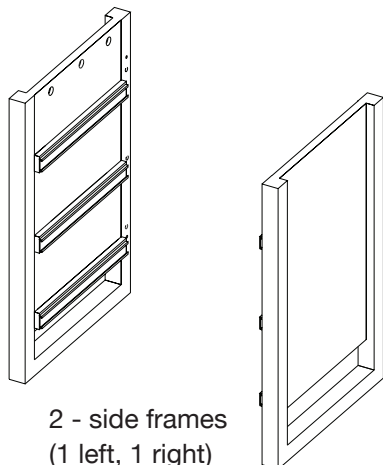

2 - side frames
(1 left, 1 right)

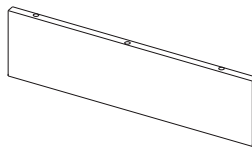

3 - drawer backs

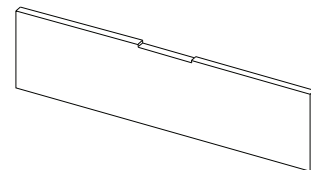

3 - drawer fronts

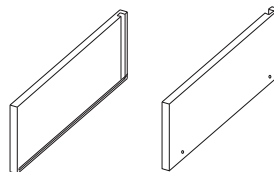

6 - drawer sides
(3 right , 3 left)

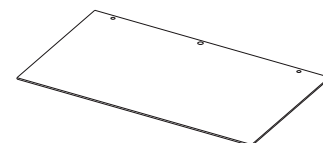

3 - drawer bottoms

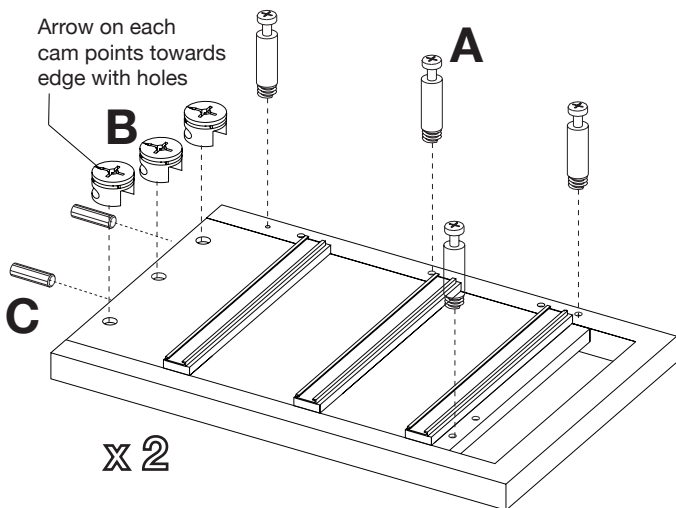

- ① A) Place **left side panel** face down on a padded surface. Insert 4 **cam screws** into the holes as shown. Secure, but do not over tighten with a **phillips head screwdriver**.
 B) Insert 3 **cams** into the large holes as shown, making sure the arrow on each cam points towards the nearest edge with holes.
 C) Insert 2 **wood dowels** into the top edge of the panel. Repeat Steps A, B & C for the **right side panel**.

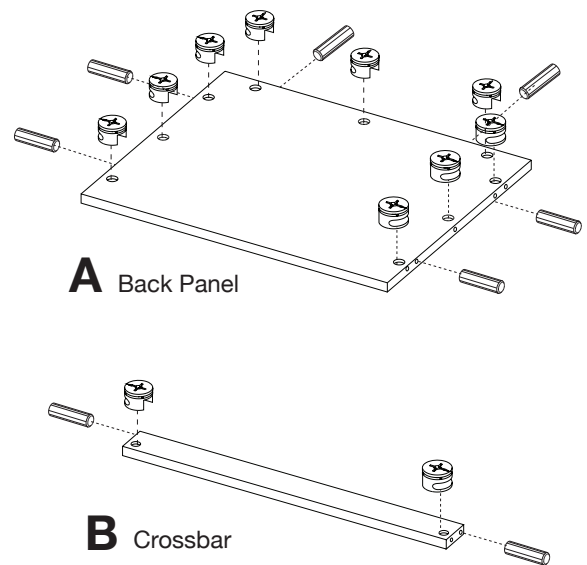

- ② A) Insert 6 **wood dowels** and 9 **cams** into **back panel** as shown.
 B) Insert 2 **wood dowels** and 2 **cams** into **crossbar** as shown.

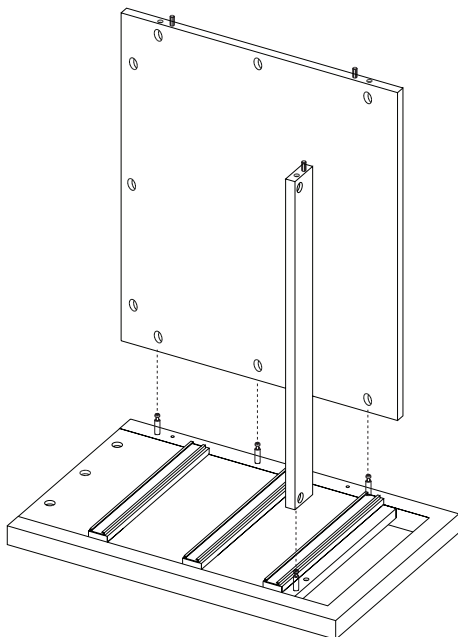

- ③ With the assistance of another adult, carefully align dowels of **back panel** and **crossbar** with cam screws of **left side frame** and firmly fit into position.

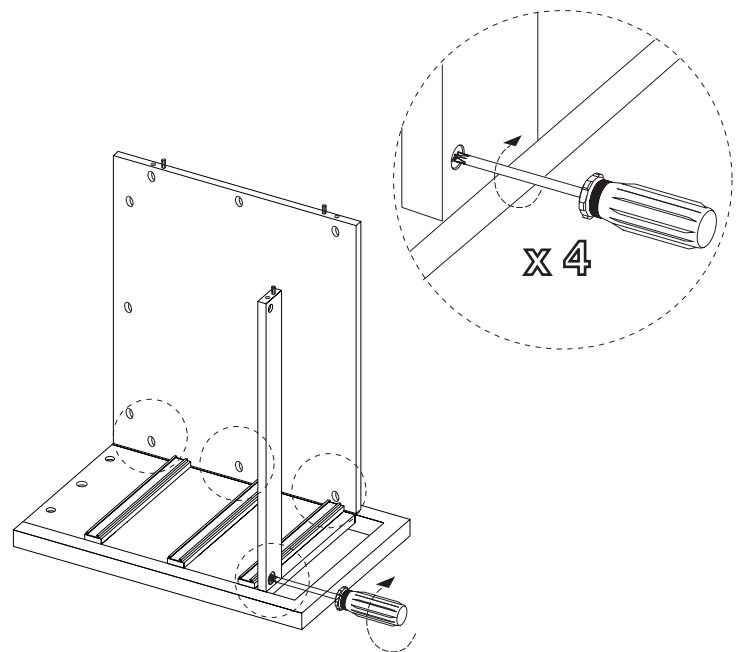

- ④ Secure 4 **cams** at the base of the back panel and crossbar with a **phillips head screwdriver**. Turn each cam clockwise until it securely engages each cam screw.

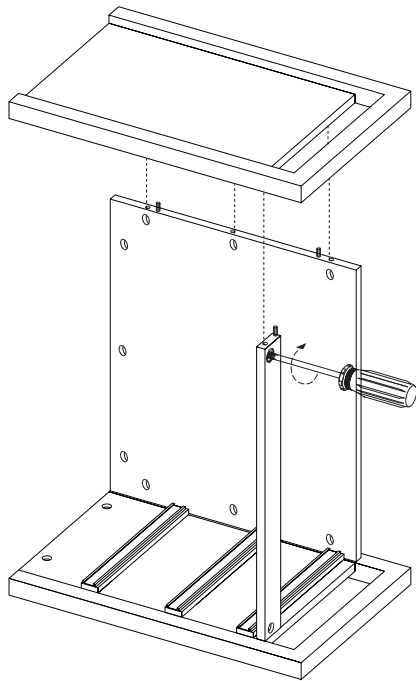

- ⑤ Fit cam screws of **right side panel** into corresponding holes in the back panel and crossbar. Secure each **cam** with a **phillips head screwdriver**.

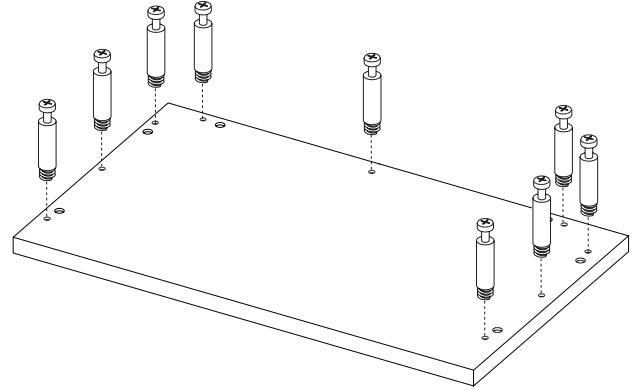

- ⑥ Insert **9 cam screws** into the underside of the **top panel** as shown.

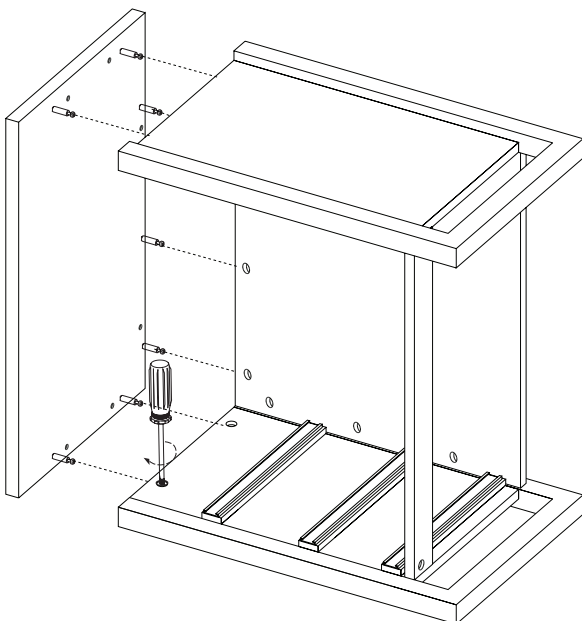

- ⑦ Fit top panel onto dowels of the assembly and secure each **cam** with a **phillips head screwdriver**.

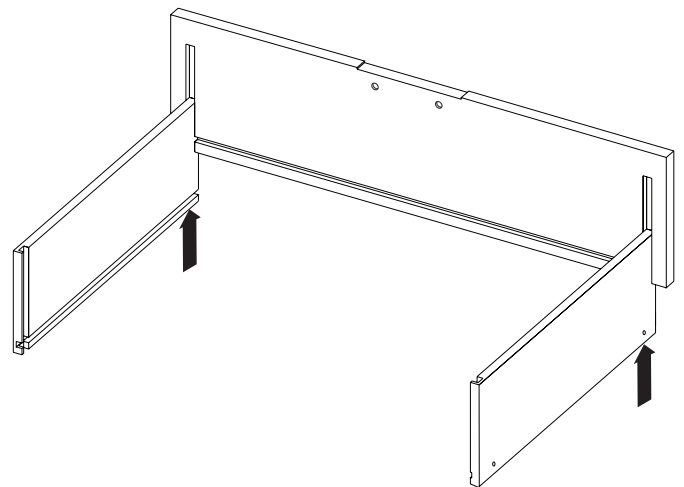

- ⑧ Slide **left and right drawer sides** up into slots on back of the **drawer front**. Make sure glide hardware is on the outside of the drawer sides and the vertical slots are at the back of the assembly as shown.

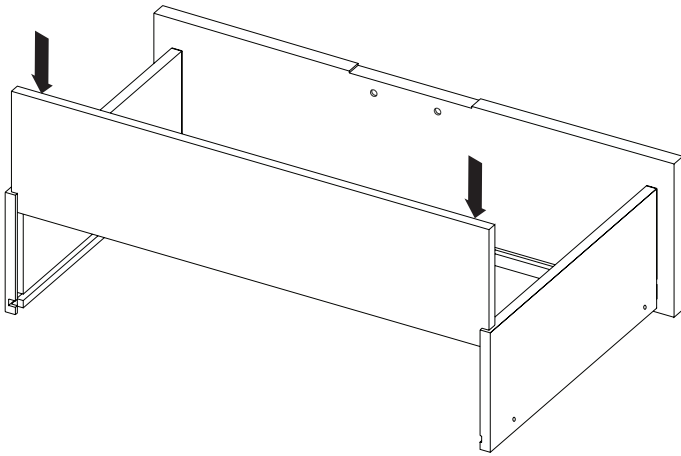

9 Slide **drawer back** into vertical slots at rear of drawer sides.

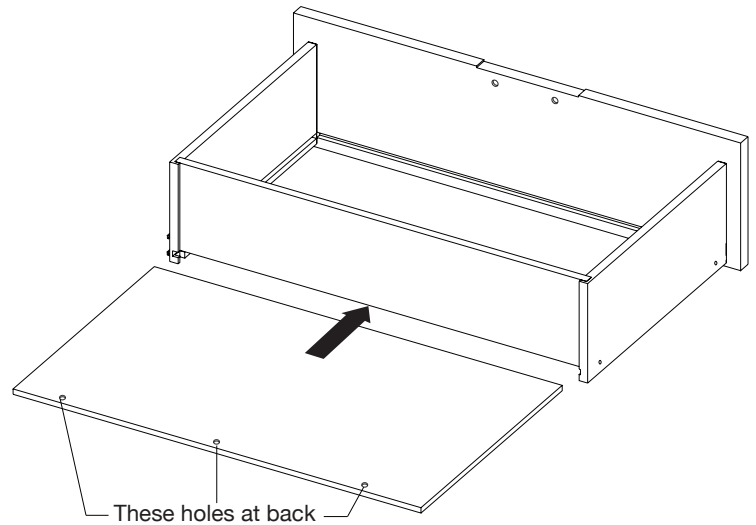

10 Slide **drawer bottom** into slot at base of drawer sides and drawer front. Make sure pilot holes are at the back of the drawer bottom as shown.

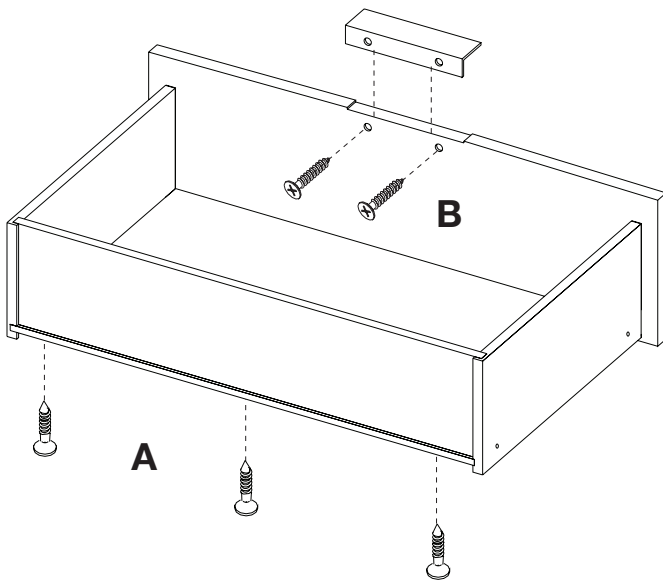

11 A) Secure underside of drawer bottom to drawer back with 3 **black screws**. Secure, but do not over tighten with the **phillips head screwdriver**.
 B) Fit **drawer pull** into position as shown and secure with 2 **silver screws**.
 Repeat Steps 8 - 11 for remaining 2 drawers.

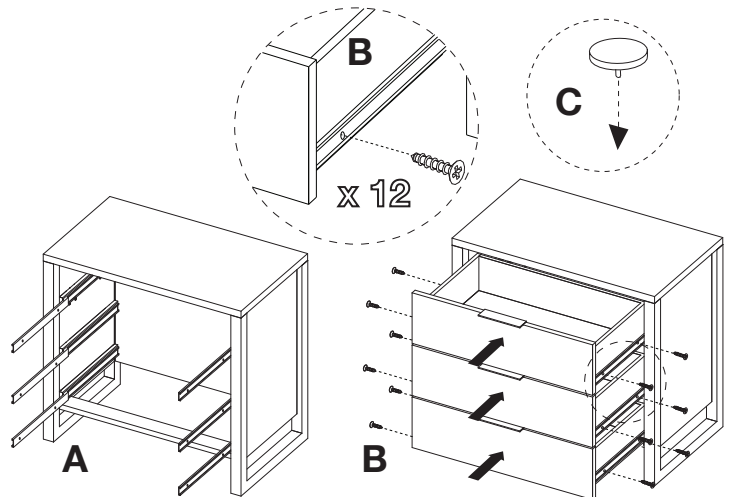

12 A) Fully extend drawer glides from assembled unit as shown.
 B) Position drawer assembly and rest the drawer assembly on top of the tabs as shown. Attach each glide to drawer with 2 **glide screws** as shown. Secure with a screwdriver. Repeat steps for each drawer.
 C) Conceal all exposed cams with **cam covers**.
 Assembly is now complete.

CLEANING AND CARE

Clean surfaces with a dry or damp soft cloth. Do not use abrasive cleaners. Do not use furniture wax or polish as the wood is finished with a protective clear lacquer.