

Thank you for purchasing the **Madison Small Buffet**. This page lists all the contents included in the box. Please take the time to identify the hardware as well as the individual components to this product. As you unpack and prepare for assembly, place the contents on a carpeted or padded area to protect them from damage. Note: 2 people are required to safely assemble this product.

HARDWARE

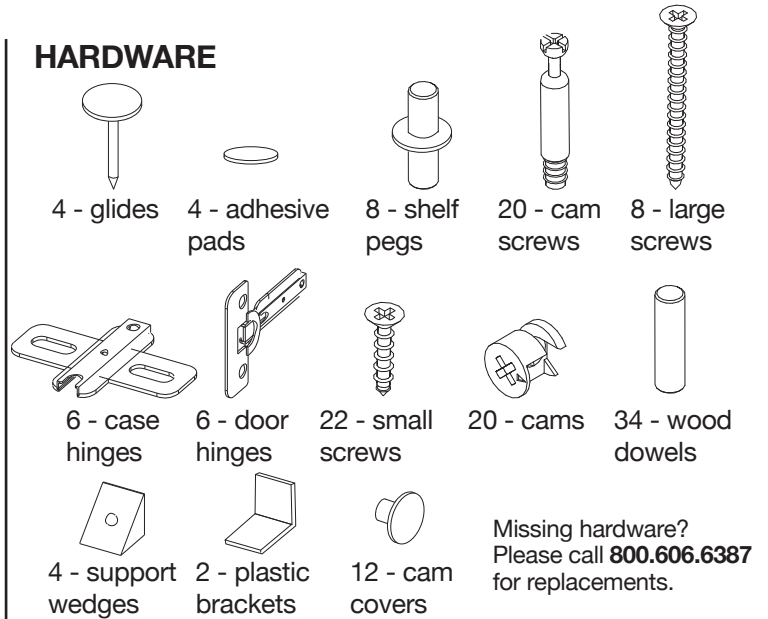

TOOLS REQUIRED

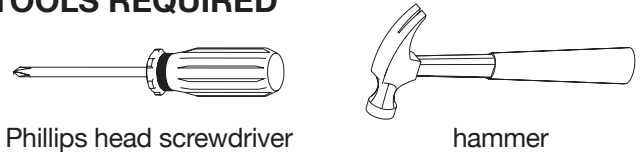

COMPONENTS

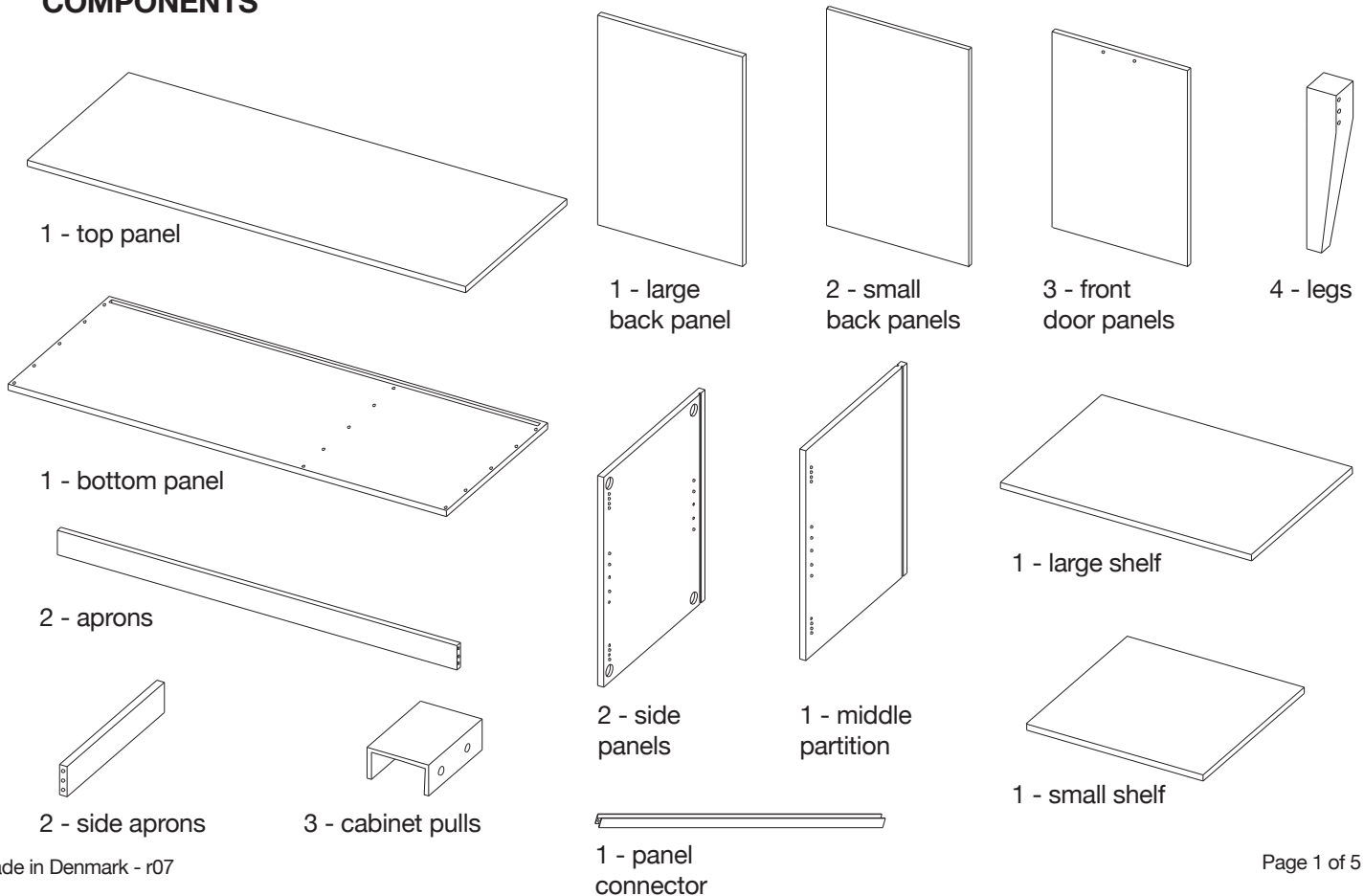

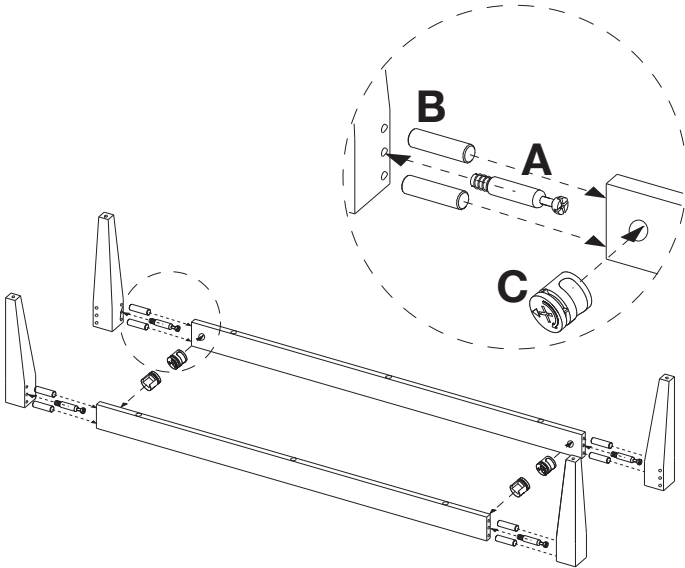

- ① A. Insert 1 **cam screw** per **leg** and tighten with a **phillips head screwdriver**.
- B. Insert 2 **wood dowels** into the ends of each **long apron**.
- C. Insert 2 **cams** into the face of each **long apron**. Make sure the arrow on each cam points to the closest short end of the the apron.

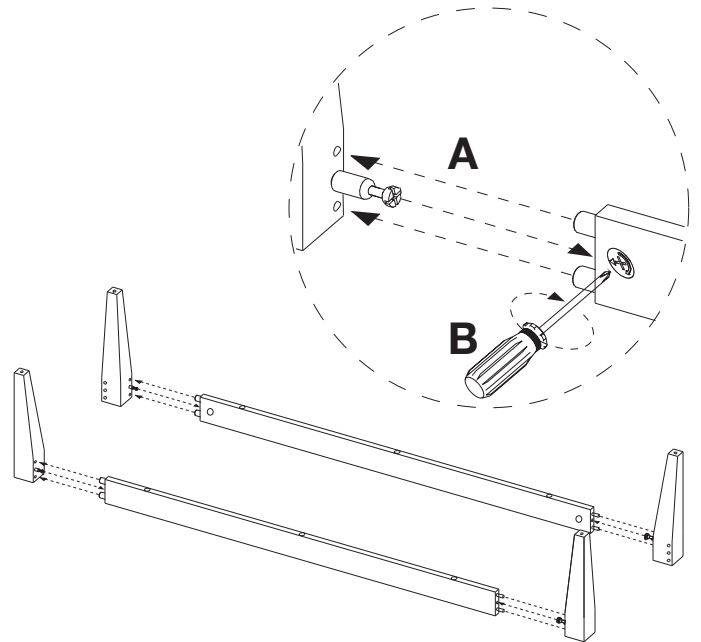

- ② A. Fit 1 **leg** on the end of each **long apron**, aligning dowels and cam screws with corresponding holes.
- B. Secure legs by turning each **cam** 180° clockwise with a **phillips head screwdriver**.

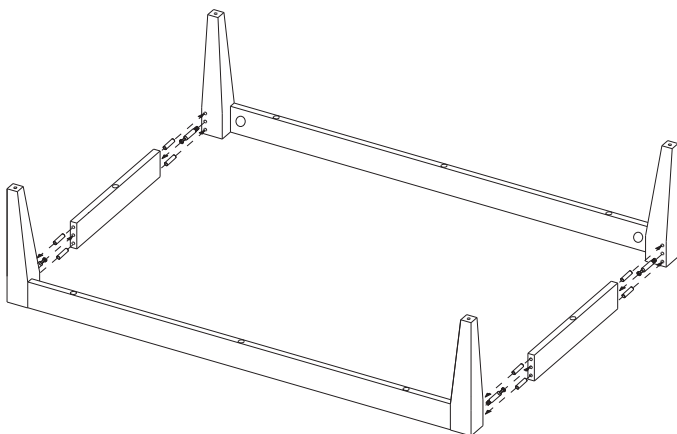

- ③ Repeat assembly method in Steps 1 and 2 for the attachment of the 2 **short aprons**, using 4 **wood dowels**, 2 **cam screws**, and 2 **cams** per apron. Secure all cams with a phillips head screwdriver.

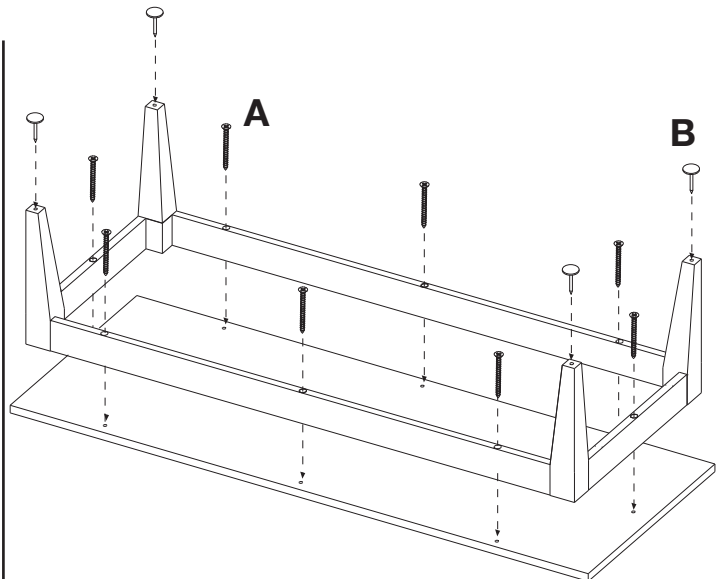

- ④ A) Align pre-drilled holes on **apron** with pre-drilled holes on **bottom panel**. Insert 8 **large screws** through **front, back and side aprons** into bottom panel as shown. Secure each screw with a **phillips head screwdriver**.
- C) Using a **hammer**, gently tap in 1 **glide** onto the bottom of each leg.

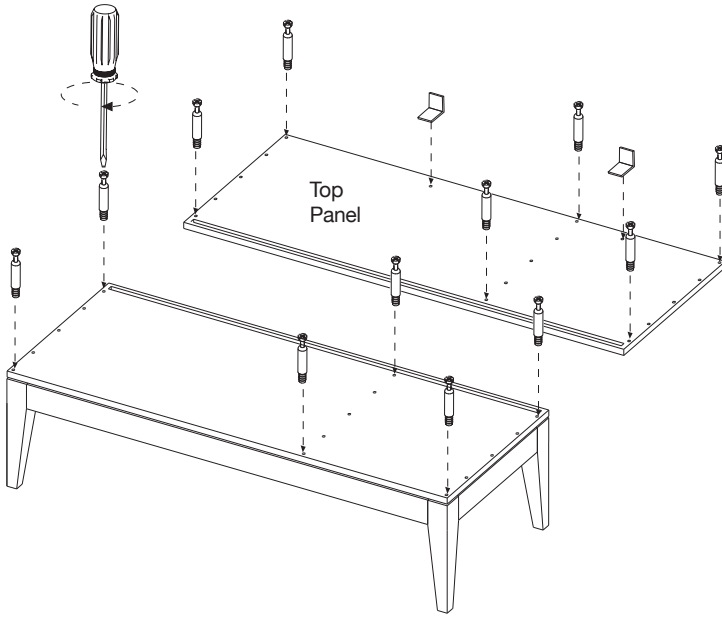

- ⑤ A) Position assembled unit upright. Insert 6 **cam screws** to the **bottom panel** as illustrated. Secure with a **phillips head screwdriver**.
 B) Attach 6 **cam screws** and 2 **plastic brackets** to the underside of **top panel**. Set top panel aside.

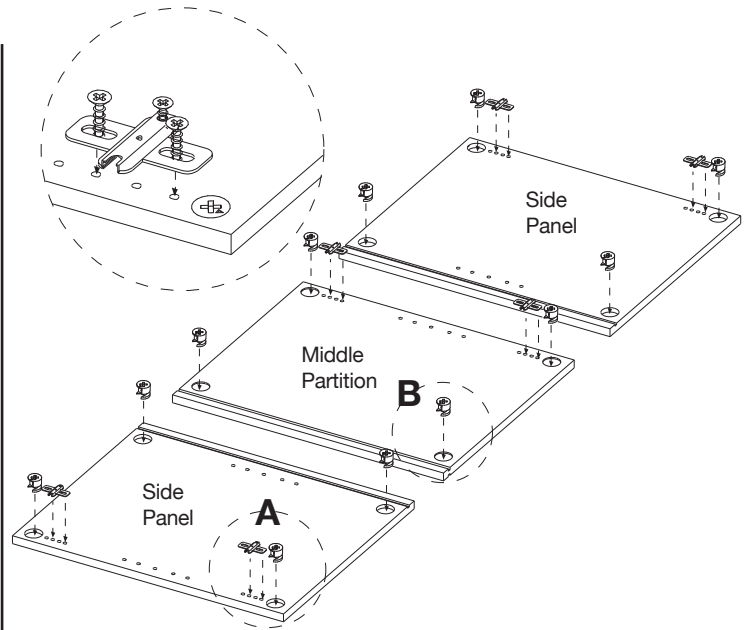

- ⑥ A) Insert 4 **cams** into 2 **side panels** and 1 **middle partition**. Make sure arrows on each cam point towards the short end of each panel.
 B) Attach 2 **case hinges** to 2 **side panels** and 1 **middle partition** with 2 **small screws** per hinge. Secure all screws with a **phillips head screwdriver**.

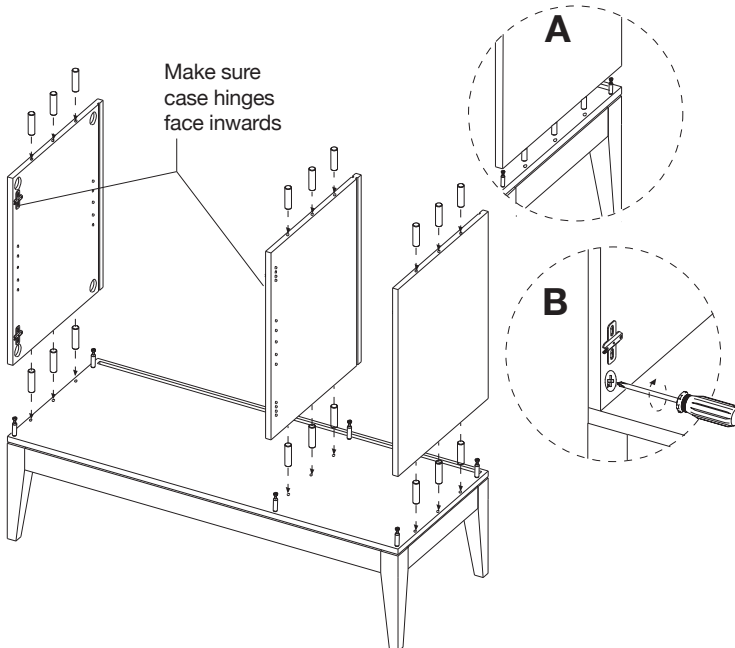

- ⑦ A) Insert 6 **wood dowels** into 2 **side panels** and 1 **middle partition**. Press firmly to secure.
 B) Fit 2 **side panels** and 1 **middle partition** onto **cam screws** and **bottom panel**. Using a **phillips head screwdriver**, turn bottom 6 **cams** 180° clockwise to secure panels as illustrated above.

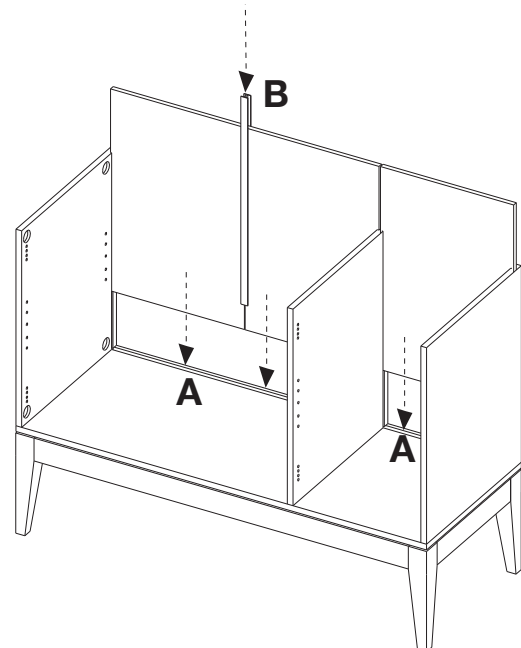

- ⑧ A) Slide **large** and **small back panels** into grooves at rear of side panels and middle partition.
 B) Slide **panel connector** between 2 **small back panels**.

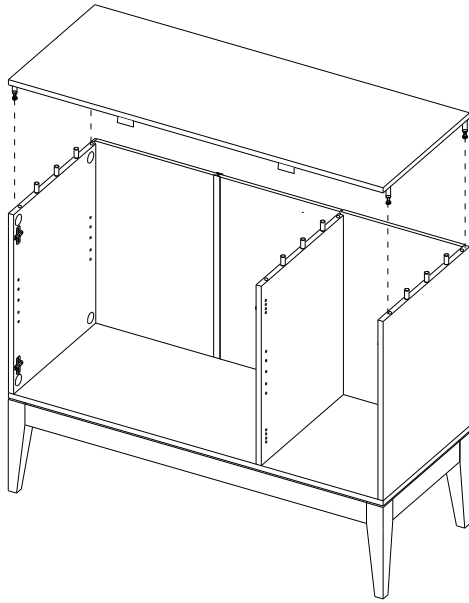

- ⑨ Carefully position **top panel** over assembled unit. Align **cam screws** and **wood dowels** with corresponding holes in the **top** and **side panels**. Make sure the **top panel brackets** face the front of the assembled unit.

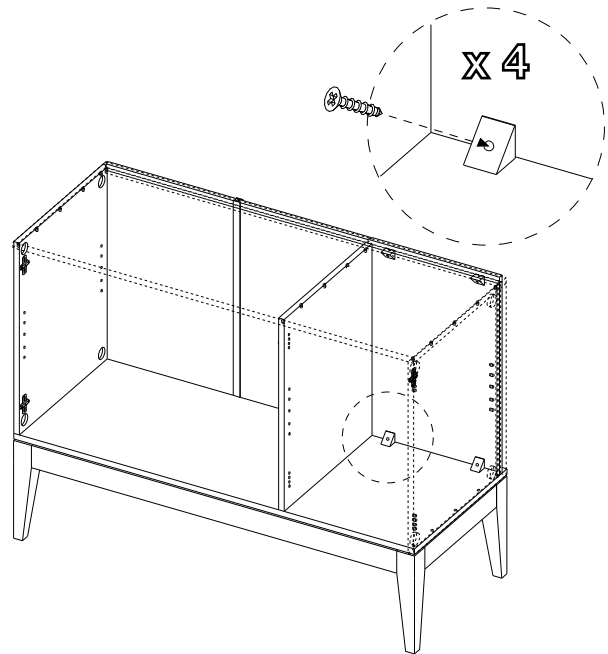

- ⑩ Position 4 **support wedges** onto the back edges of the assembled unit as shown. Secure each **support wedge** with 1 **small screw**.

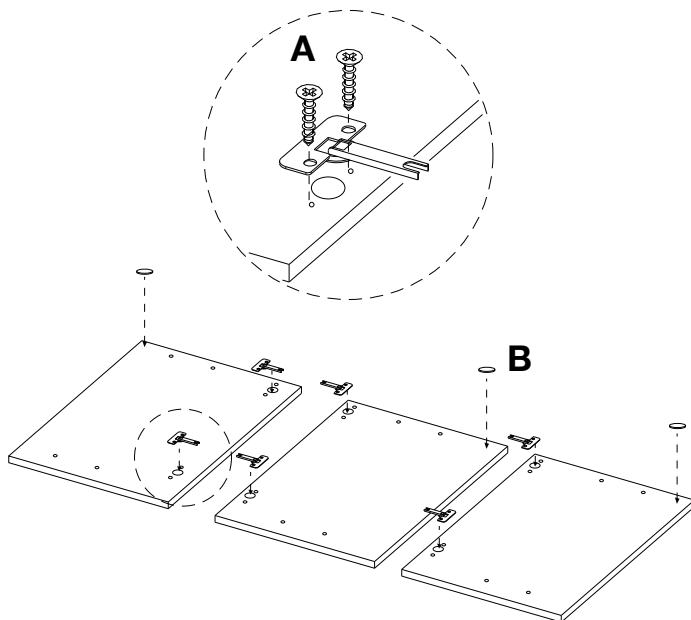

- ⑪ A) Attach 2 **door hinges** to 3 **door panels** with 2 small screws per hinge. Secure all screws with a **Phillips head screwdriver**.
B) Adhere 1 **adhesive pad** to top corner of each **door panel** opposite of **case hinge**, as illustrated above.

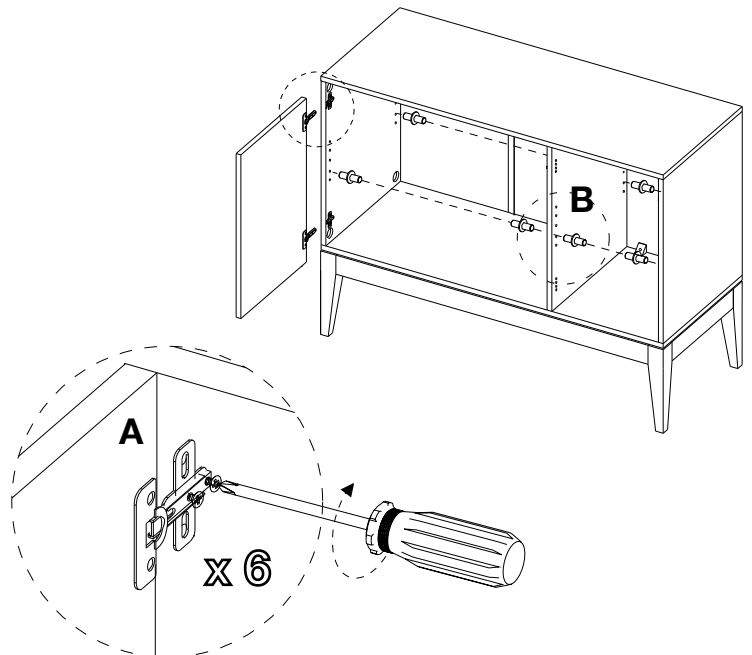

- ⑫ A) Attach 3 **front door panels** to assembled unit. Fit each **door hinge** into corresponding case hinge and secure by tightening preinstalled screws in case hinge with a screwdriver.
B) Insert 8 **shelf pins** to **side panels** and **middle partition** at desired shelf height (adjustable).

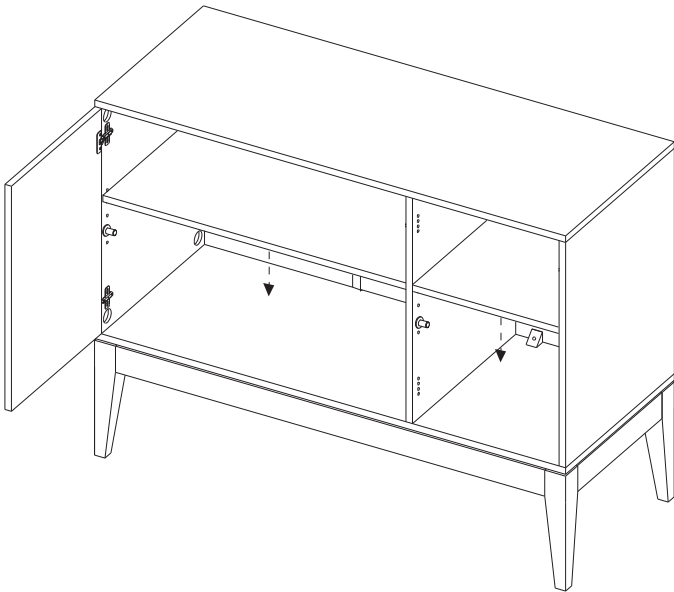

- ⑬ Position 1 **large shelf** and 1 **small shelf** onto **shelf pegs** in assembled unit.

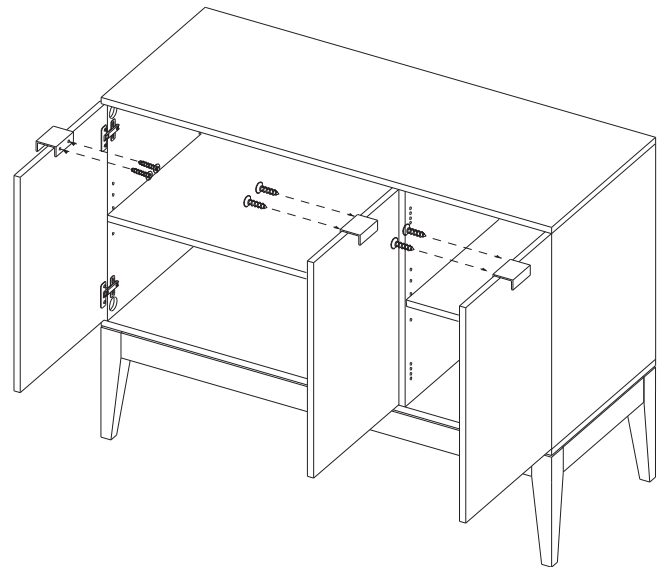

- ⑭ Attach 3 **door pulls** to 3 **door panels** with 2 **small screws** per door. Using a **Phillips head screwdriver**, turn screws clockwise to secure.

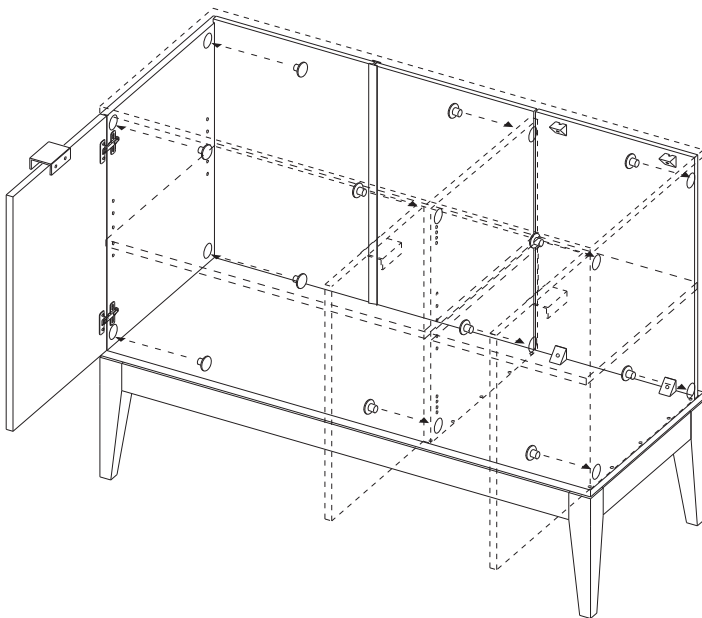

- ⑮ Attach 12 **cam covers** onto **cams**, as illustrated above. Press firmly to secure. Assembly is now complete.

CLEANING AND CARE

Clean surfaces with a dry or damp soft cloth. Do not use abrasive cleaners. Do not use furniture wax or polish as the wood is finished with a protective clear lacquer.

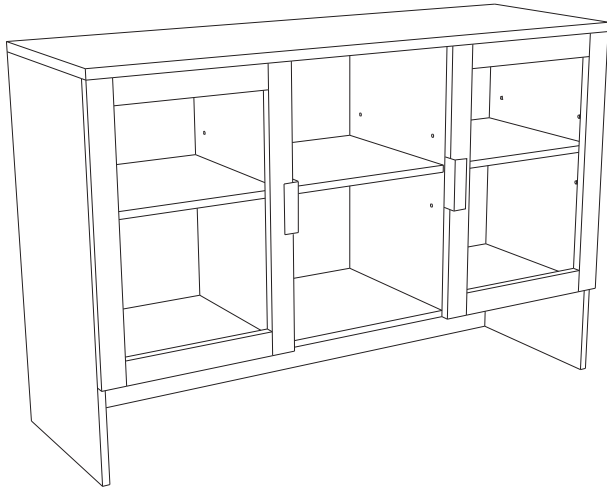

Thank you for purchasing the **Madison Small Hutch**. This page lists all the contents included in the box. Please take time to identify the hardware as well as the individual components of this product. As you unpack and prepare for assembly, place the contents on a carpeted or padded area to protect them from damage. Note: 2 people are required to safely assemble this product.

ASSEMBLY HARDWARE

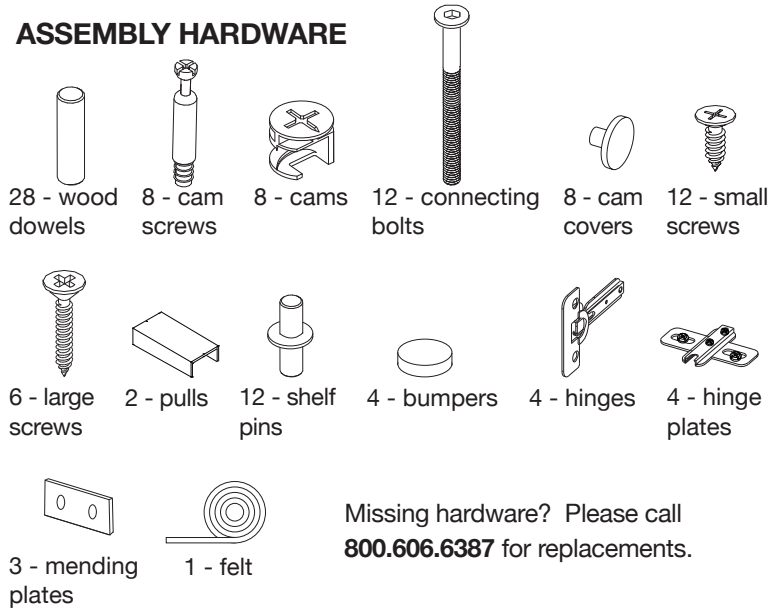

Missing hardware? Please call **800.606.6387** for replacements.

WALL MOUNTING HARDWARE

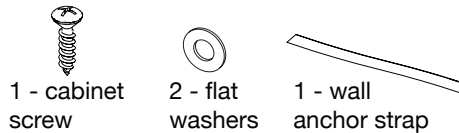

COMPONENTS

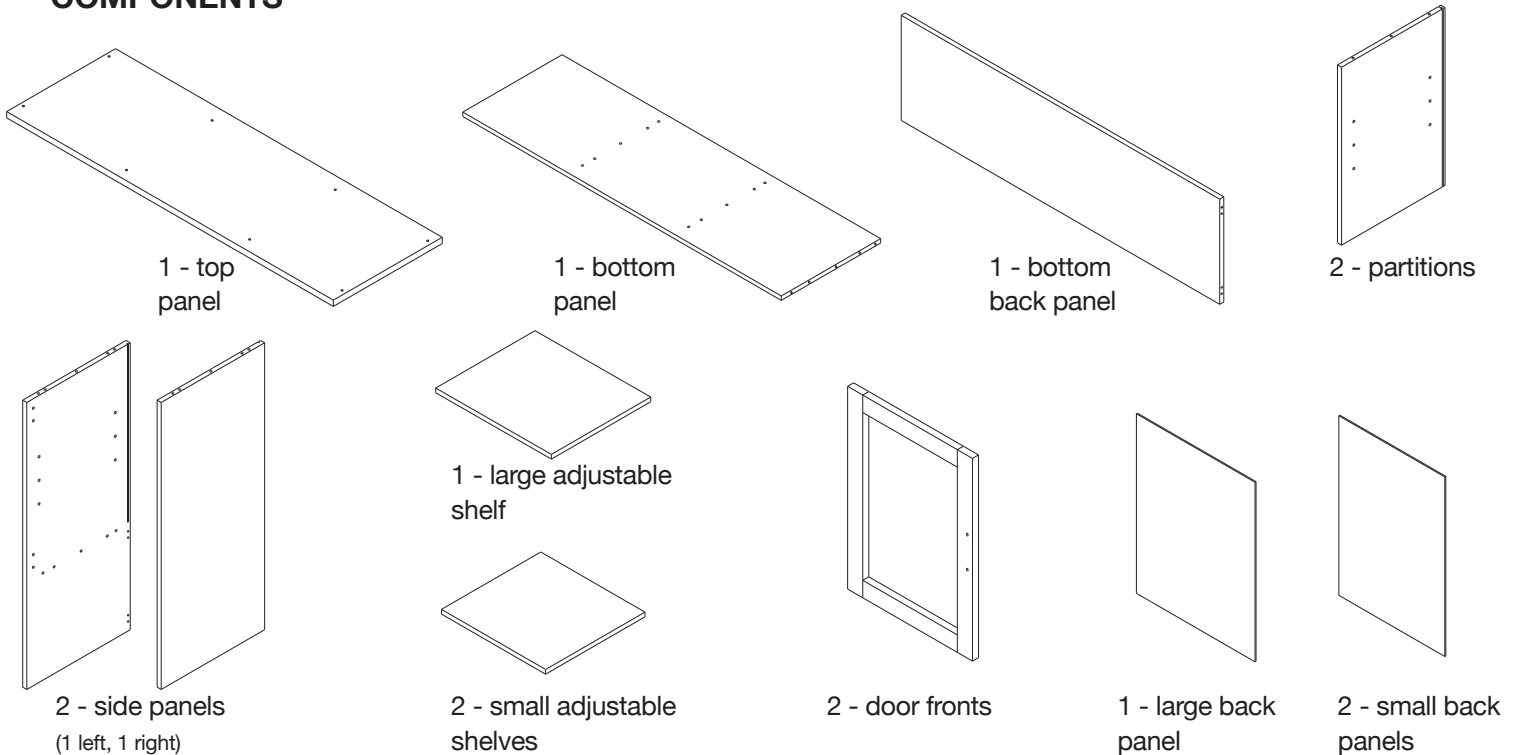

TOOLS REQUIRED

phillips head screwdriver

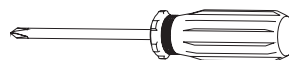

allen wrench



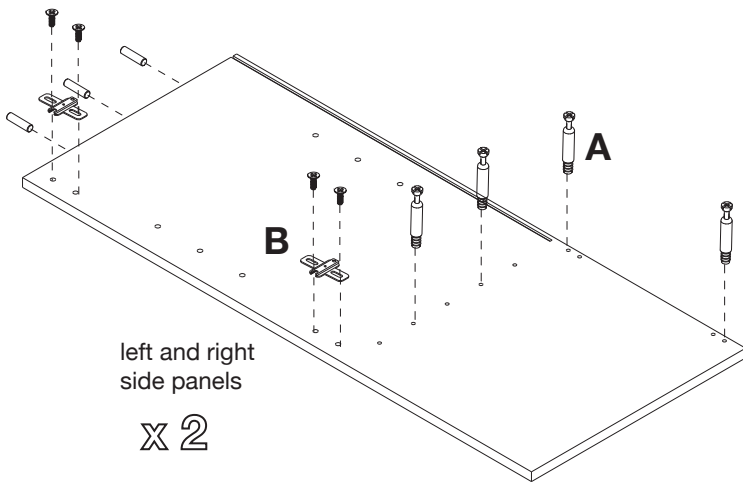

- ① A) Insert 4 **cam screws** and 3 **wood dowels** into **left and right side panels** as shown. Secure cam screws with a **Phillips head screwdriver**.
- B) Position each **hinge plate** over corresponding holes in **side panels**. Secure hinges with pre-attached bolts, using a screwdriver.

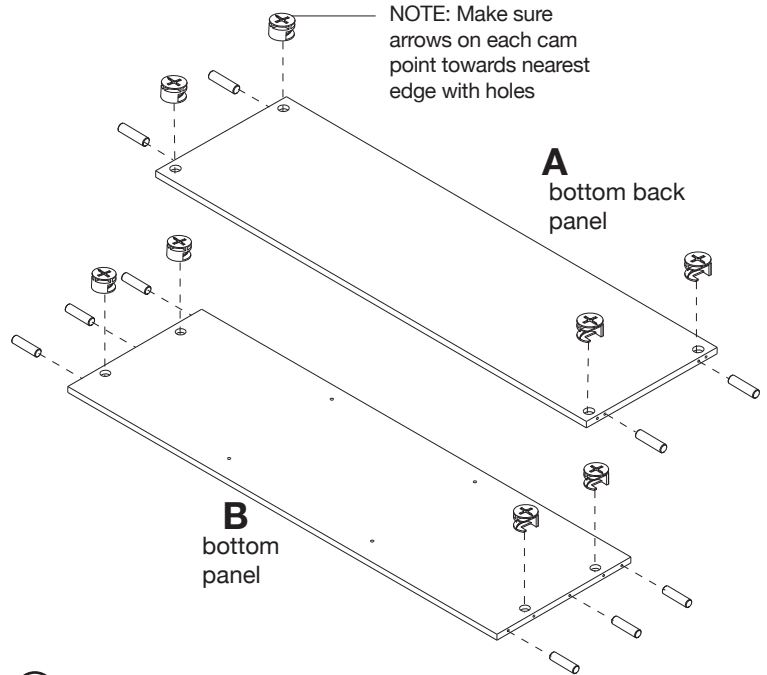

- ② A) Insert 4 **cams** and 4 **wood dowels** into **bottom back panel** as shown. Make sure arrows on each cam point towards nearest edge with holes.
- B) Insert 4 **cams** and 6 **wood dowels** into **bottom panel** as shown.

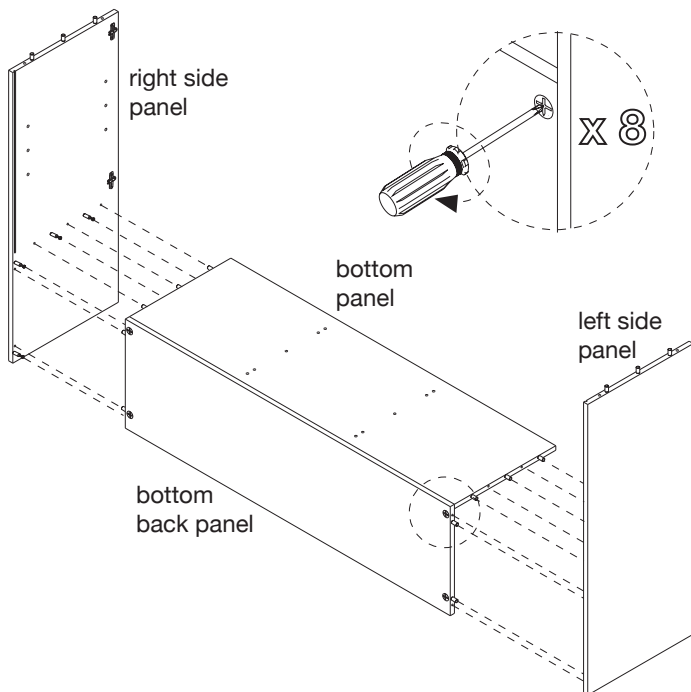

- ③ Fit dowels of **bottom panel** and **bottom back panel** into corresponding holes of **right and left side panel** as shown. With a screwdriver, turn **cams** clockwise until it securely engages each cam screw.

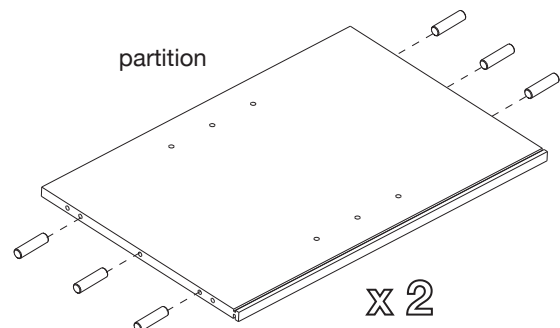

- ④ Insert 6 **wood dowels** into 2 **partitions** as shown.

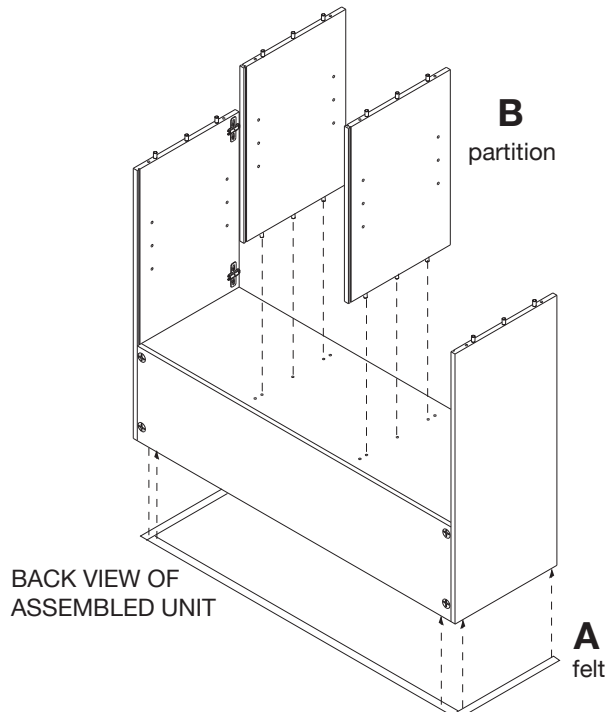

- ⑤ A) Adhere **felt** along bottom edge of assembled unit as shown.
 B) Fit dowels of **partitions** into corresponding holes of assembled unit as shown.

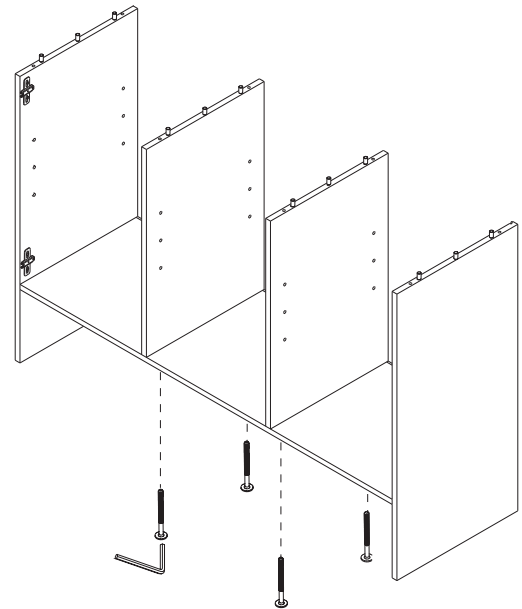

- ⑥ Secure **bottom panel** to assembled unit with 4 **connecting bolts** as shown, using an **allen wrench**.

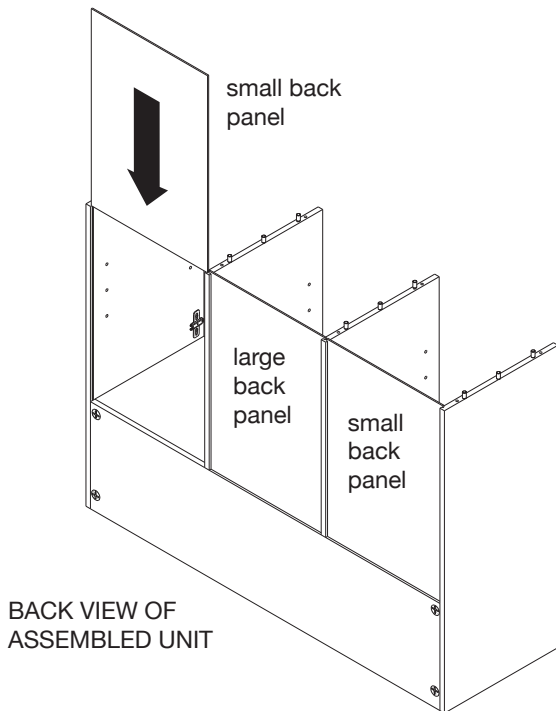

- ⑦ Slide 2 **small back panels** and 1 **large back panel** through grooves of assembled unit as shown.

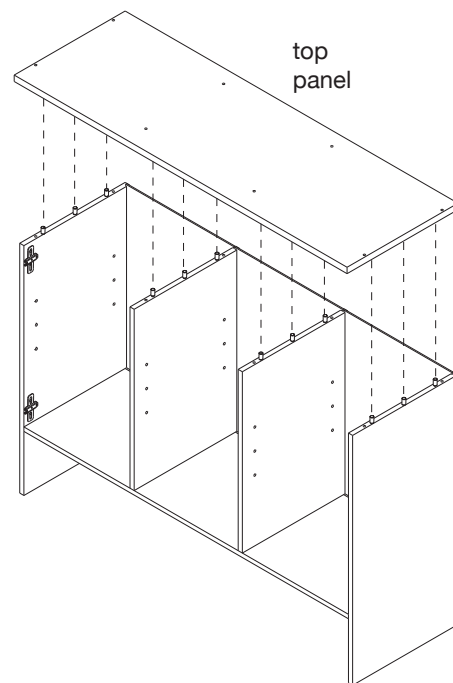

- ⑧ Fit dowels of assembled unit into corresponding holes of **top panel** as shown.

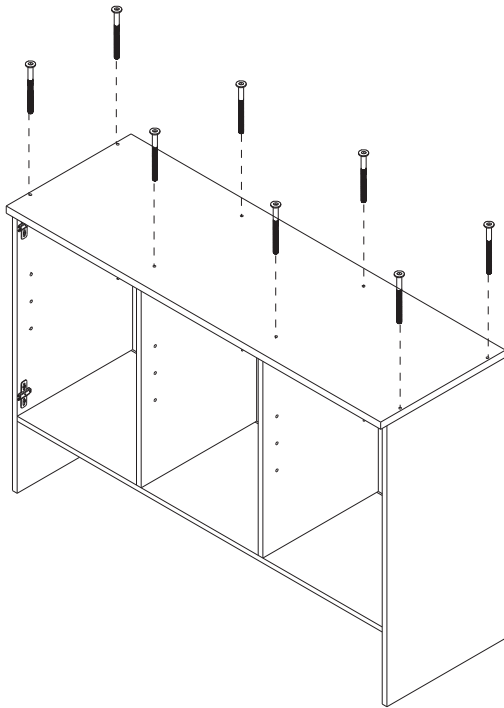

- ⑨ Secure **top panel** to assembled unit with 8 **connecting bolts** as shown.

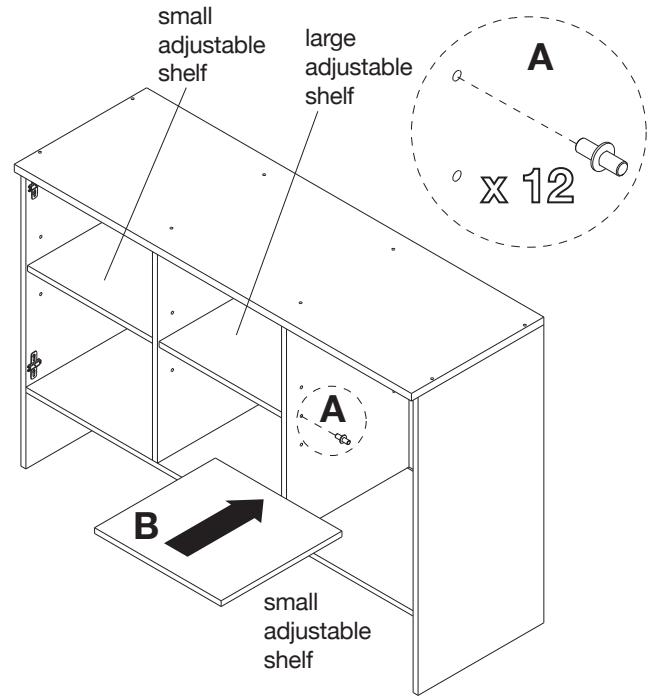

- ⑩ A) Insert 12 **shelf pins** at desired shelf heights as shown. B) Place 2 **small adjustable shelves** and 1 **large adjustable shelf** into assembled unit. Make sure each shelf is securely supported by shelf pins.

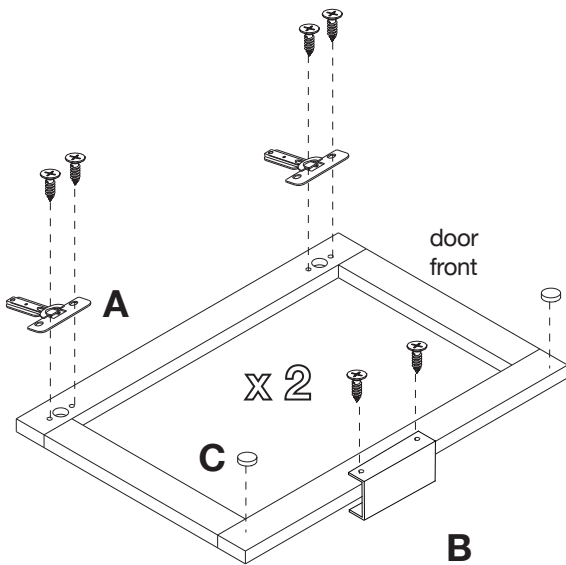

- ⑪ A) Attach 2 **hinges** to each **door front** with 2 **small screws** per hinge as shown. Secure screws with a screwdriver.
 B) Attach 1 **pull** to each **door front** with 2 **small screws** as shown. Secure screws with a screwdriver.
 C) Adhere 2 **bumpers** to each **door front** as shown.

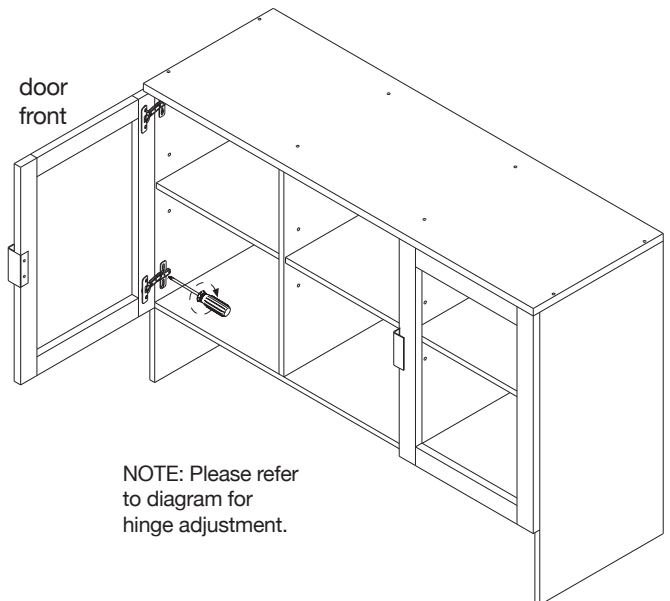

NOTE: Please refer to diagram for hinge adjustment.

- ⑫ Attach hinges of 2 **door fronts** to hinge plates of assembled unit as shown. Refer to diagram on page 5 for hinge adjustment.

- ⑬ With the assistance of another adult, carefully place hutch on top of buffet as shown. Attach 3 **connecting brackets** to back of hutch/buffet assembly with 2 **large screws** per bracket as shown. Secure screws with a screwdriver. Assembly is now complete.

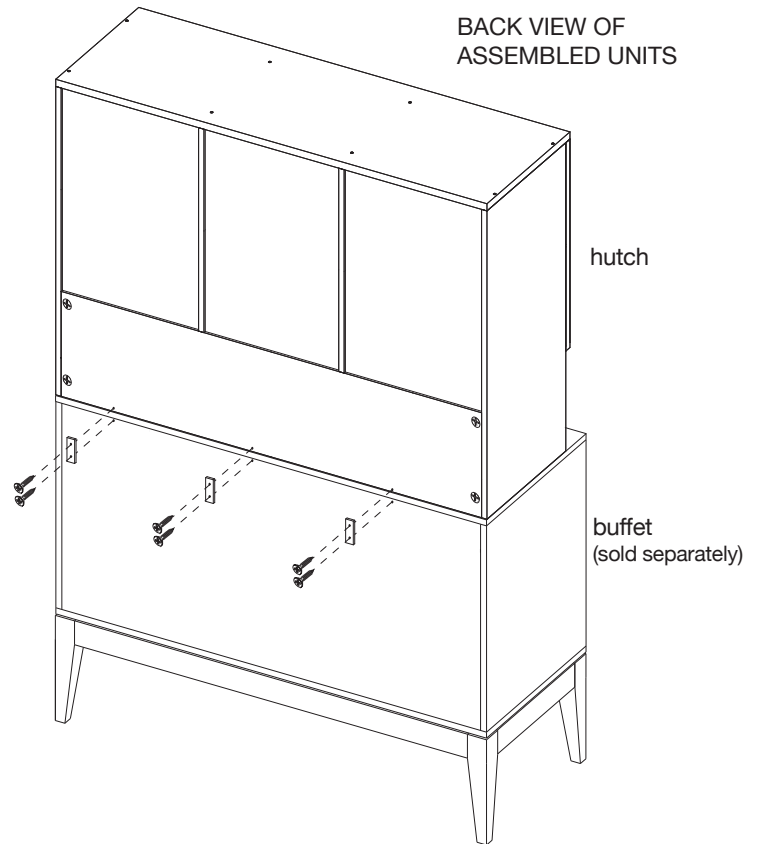
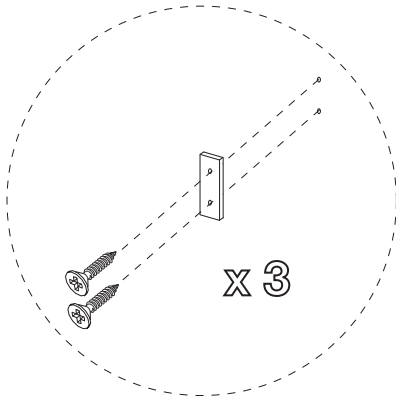

CLEANING AND CARE

Clean surfaces with a dry or damp soft cloth. Do not use abrasive cleaners. Do not use furniture wax or polish as the wood is finished with a protective clear lacquer.

HINGE ADJUSTMENT

If the doors do not appear square or aligned, loosen or tighten the appropriate screws on each case hinge as illustrated.

- 1) **Side to side adjustment:**
Loosen screw **A**, adjust gap with screw **B** and re-tighten screw **A**.

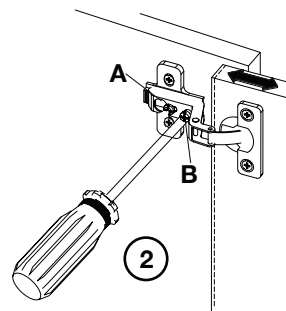
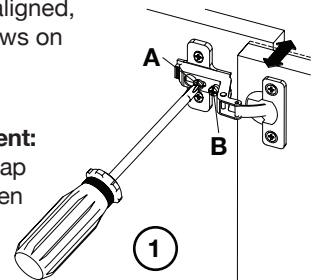

- 2) **Depth adjustment:**
Loosen screw **A**, push hinge arm forwards or backwards, re-tighten screw **A** and secure screw **B** with a 1/4 turn clockwise.

- 3) **Height adjustment:**
Loosen screw **C**, adjust door height and re-tighten screw **C**.

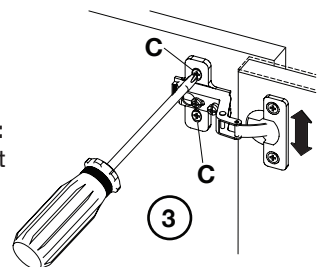

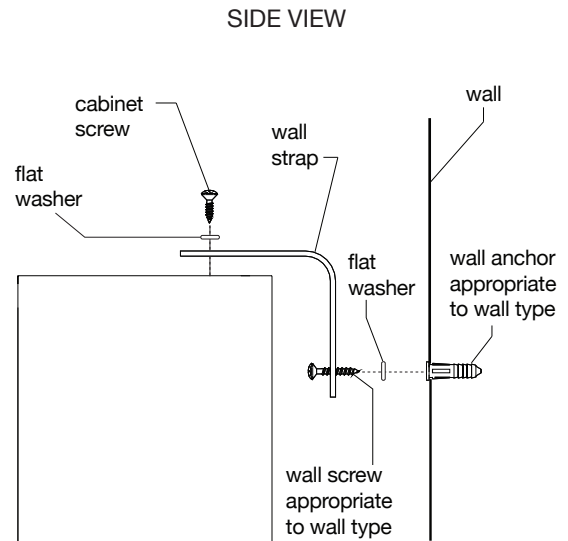
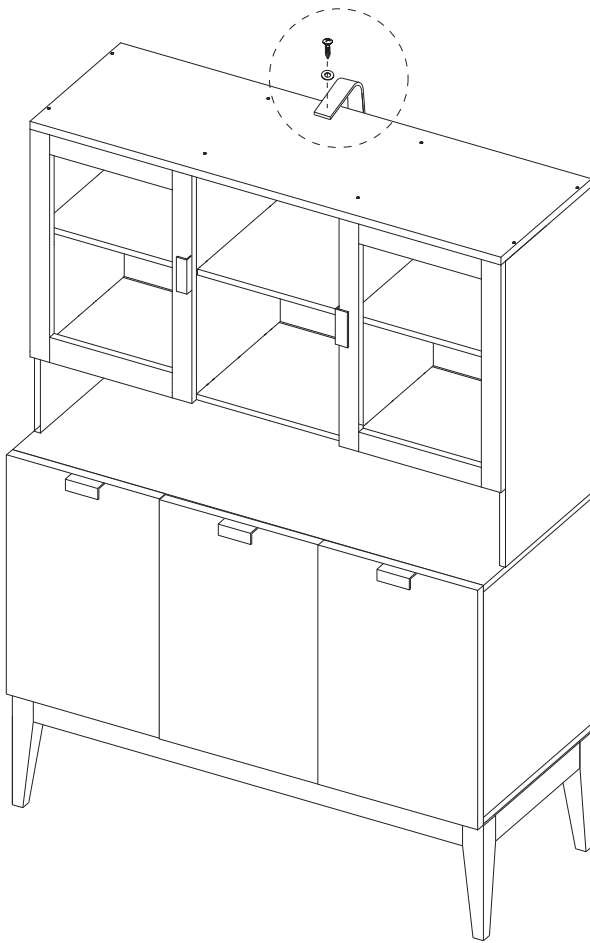

NOTE: Insert screws 3/4" - 1" from the edge of the strap

WALL MOUNTING ASSEMBLY

For added safety and stability, it is recommended that the wall mounting hardware be installed. For safe mounting, it is essential to use wall anchors made for your wall type (i.e. plaster, drywall, concrete, etc.). Mount to wood studs whenever possible.

The included hardware is used for attaching wall strap to unit only. You will need to purchase the appropriate screw and anchor for your wall type.

NOTE: If you are unsure about your wall type or what mounting method you should use, consult a qualified professional or your local hardware store.

A. Drill a hole in the wall slightly smaller than the diameter of the wall anchor (not included). Lightly tap with a **hammer** until the face is flush with the wall.

B. Insert 1 wall screw (not included) and 1 **flat washer** through **wall strap** and into the wall anchor.

C. Insert 1 **cabinet screw** and 1 **flat washer** through wall anchor strap and into the top of unit.