

Thank you for purchasing the **Pivot Table**. This page lists all the contents included in the box. Please take the time to identify the hardware as well as the individual components to this product. As you unpack and prepare for assembly, place the contents on a carpeted or padded area to protect them from damage. Note: 2 people are required to safely assemble this product.

HARDWARE



8 - leg bolts



8 - spring washers

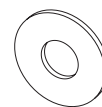

9 - flat washers



8 - wood plugs

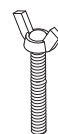

1 - wing bolt

Missing hardware?
Please call **800.606.6387** for replacements.

TOOLS REQUIRED

Phillips head screwdriver

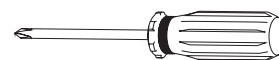

COMPONENTS

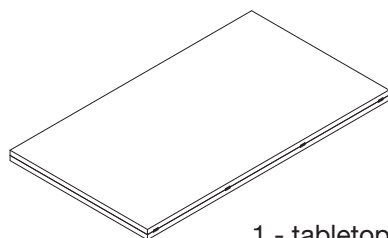

1 - tabletop



4 - legs

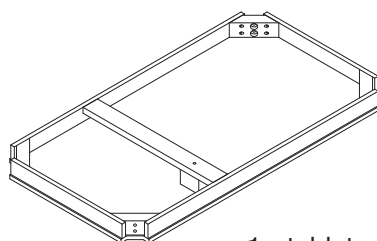

1 - tabletop frame

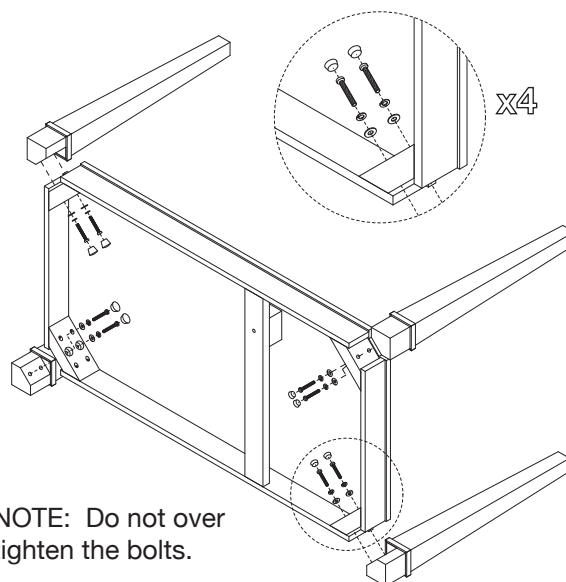

NOTE: Do not over tighten the bolts.

- 1 With assistance of another adult, attach **legs** onto **tabletop frame** with 2 **leg bolts**, 2 **spring washers**, and 2 **flat washers** per **leg** as shown. Secure with **Phillips head screwdriver**, but do not over tighten bolts. Cover all exposed bolt holes with the **wood plugs**.

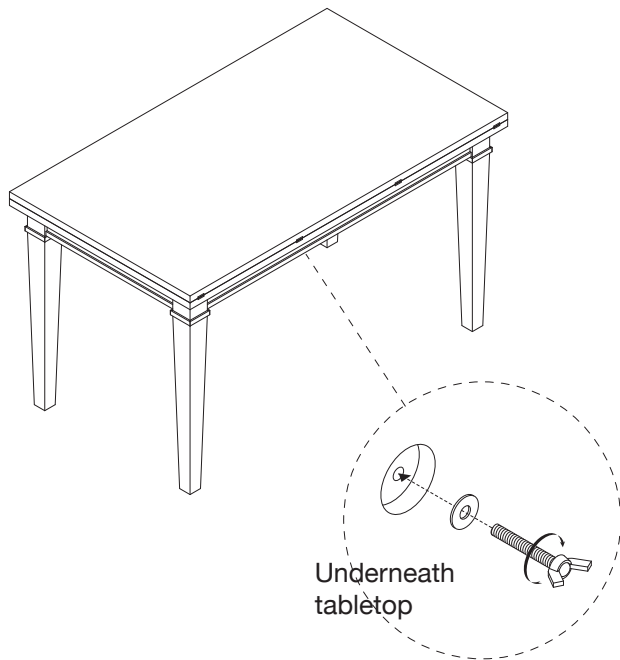

- ② With assistance of another adult, place **table top** on top of assembled unit. Underneath **tabletop**, insert 1 **wing bolt** and 1 **flat washer**, and turn clockwise to secure.

INSTRUCTIONS TO EXPAND TABLETOP

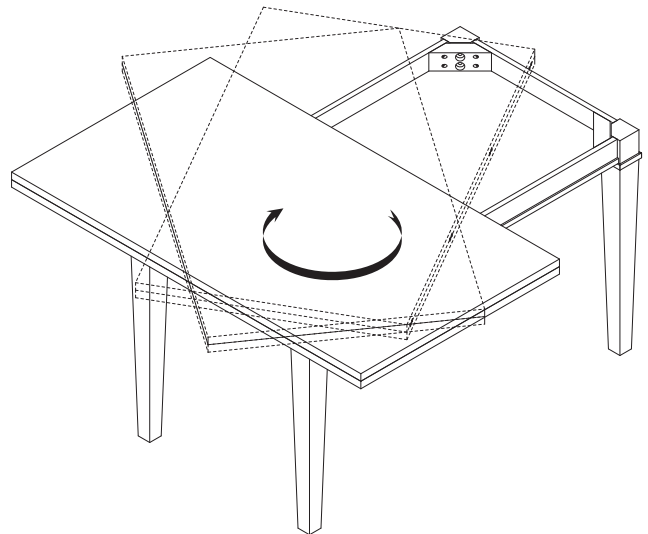

- ③ With assistance of another adult, carefully turn **tabletop** counter clockwise 90 degrees as shown.

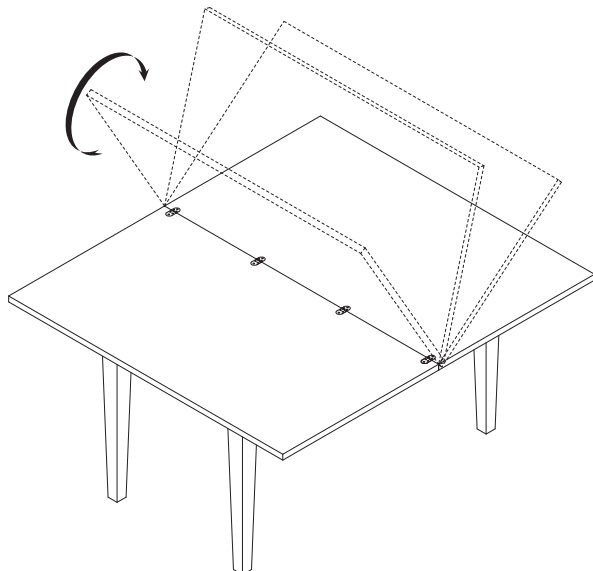

- ④ Carefully unfold **tabletop** 180 degrees as shown. Assembly is now complete.

CLEANING AND CARE

Clean surfaces with a dry or damp soft cloth. Do not use abrasive cleaners. Do not use furniture wax or polish as the wood is finished with a protective clear lacquer.