

Thank you for purchasing the **Springdale Wall Hanging Cabinet**. This page lists all the contents included in the box. Please take time to identify the hardware as well as the individual components of this product. As you unpack and prepare for hanging, place the contents on a carpeted or padded area to protect them from damage.

Note: 2 people are required to safely install this unit.

## HARDWARE

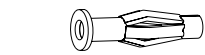

4 - drywall anchors



4 - screws

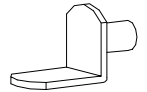

4 - shelf pins

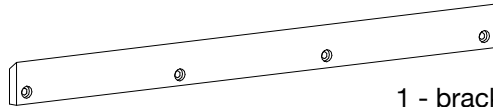

1 - bracket

Missing hardware? Please call **800.606.6387** for replacements.

## TOOLS REQUIRED

Phillips head screwdriver

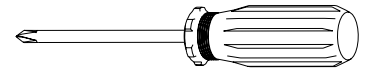

## CLEANING AND CARE

Clean surfaces with a dry or damp soft cloth. Do not use abrasive cleaners. Do not use furniture wax or polish as the wood is finished with a protective clear lacquer.

## MOUNTING INSTRUCTIONS

### Important Note:

The wall mounting hardware included with this unit is intended for **drywall installation only**. Be sure to use hardware appropriate for your wall type. Whenever possible, attach mounting screw directly into a wall stud. If you are unsure about your wall type or what mounting method you should use, consult a qualified professional or your local hardware store.

1. Determine the wall location and place the **wall bracket** into position. Make sure the pointed side of the bracket points up. Align at least 1 hole with a wall stud if possible. Level and mark the 4 hole locations on the wall.
2. If attaching directly into wall studs, skip to Step 4. Do not use drywall anchor if attaching directly to wall studs.
3. For drywall installation, drill 4 pilot holes at each marked hole location slightly smaller in diameter than the drywall anchor. Insert 1 **drywall anchor** into each hole until the head is flush with the wall surface.
4. Insert 1 **screw** through each hole in the **wall bracket** and into the corresponding anchors or studs in the wall. If attaching directly into wall studs, be sure to use an appropriate fastener (not included). Fully tighten each screw with a **Phillips head screwdriver** but do not over tighten.
5. With the assistance of another adult, lift unit into position, fitting the angled bracket on the back of the unit onto the wall bracket. Make sure the unit is firmly seated in the wall bracket.
6. Insert 4 shelf pins at desired shelf height and place shelf into position. Installation is now complete.

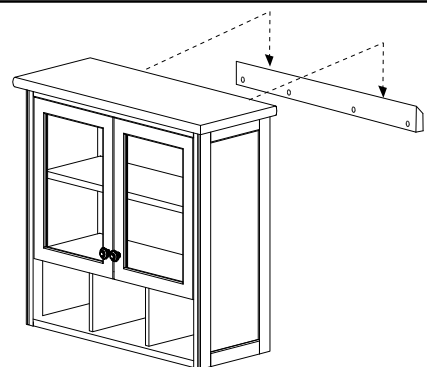
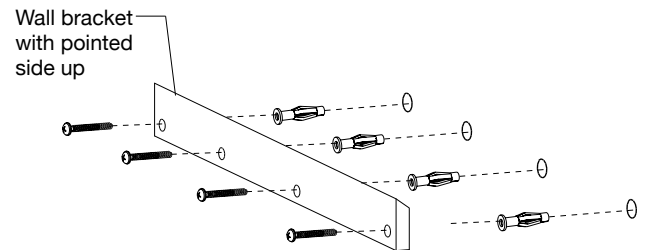

X 4

