

Safety And Regulatory Information

Safety & Regulatory Information

The following sections contain notices for various countries:

Caution

This product is intended for use with FCC/CE certified computer equipment. Please check the equipment operating/installation manual and/or with the equipment manufacturer to verify/confirm if your equipment is suitable prior to the installation or use of the product.

Notice for USA

FCC Part 15: This equipment has been tested and found to comply with the limits for a Class B digital device, pursuant to Part 15 of the FCC Rules. These limits are designed to provide reasonable protection against harmful interference in a residential installation. This equipment generates, uses and can radiate radio frequency energy and, if not installed and used in accordance with the instructions, may cause harmful interference to radio communications. However, there is no guarantee that interference will not occur in a particular installation. If this equipment does cause harmful interference to radio or television reception, which can be determined by turning the equipment off and on, the user is encouraged to try to correct the interference by one or more of the following measures:

- Reorient or relocate the receiving antenna.
- Increase the separation between the equipment and receiver.
- Connect the equipment to an outlet on a circuit different from that to which the receiver is connected.
- Consult the dealer or an experienced radio/TV technician for help.

This device complies with part 15 of the FCC Rules. Operation is subject to the following two conditions:

1. This device may not cause harmful interference, and
2. This device must accept any interference received, including interference that may cause undesired operation.

Caution

To comply with the limits of the Class B digital device, pursuant to Part 15 of the FCC Rules, this device must be installed with computer equipment certified to comply with Class B limits. All cables used to connect to the computer and peripherals must be shielded and grounded. Operation with non-shielded computers or non-shielded cables may result in interference to radio or television reception.

Federal Communication Commission (FCC) Radiation Exposure Statement

This equipment complies with FCC radiation exposure limits set forth for an uncontrolled environment. This equipment should be installed and operated with minimum distance 20cm between the radiator & your body. This transmitter must not be co-located or operating in conjunction with any other antenna or transmitter.

Modification

Any changes or modifications not expressly approved by the grantee of this device could void the user's authority to operate the device.

Notice for Canada

This Class B digital apparatus complies with Canadian ICES-003. Cet appareil numérique de la classe B est conforme à la norme NMB-003 du Canada.

Operation is subject to the following two conditions:

- (1) This device may not cause harmful interference, and
- (2) This device must accept any interference received, including interference that may cause undesirable operation.

Son Fonctionnement est soumis aux deux conditions suivantes :
(1) Le matériel ne peut être source d'interférences et
(2) Doit accepter toutes les interférences reçues, Y compris celles pouvant provoquer un fonctionnement indésirable.

Canadian Class B Statement

This digital device does not exceed the Class B limits for radio noise emissions from digital apparatus as set out in the interference-causing equipment standard entitled "Digital Apparatus," ICES-003 of the Department of Communications.

Cet appareil numérique respecte les limites de bruits radioélectriques applicables aux appareils numériques de Classe B prescrites dans la norme sur le matériel brouilleur: "Appareils Numériques," NMB-003 édictée par le ministre des Communications.

MODIFICATION:

Any changes or modifications not expressly approved by the grantee of this device could void the user's authority to operate the device. Toute modification non approuvée explicitement par le fournisseur de licence de l'appareil peut entraîner l'annulation du droit de l'utilisateur à utiliser l'appareil.

State of California Proposition 65:

WARNING: Handling this product may expose you to chemicals known to the State of California to cause cancer and birth defects or other reproductive harm. Wash hands after handling.

Explanatory Note

California Safe Drinking Water and Toxic Enforcement Act of 1986 (Proposition 65) requires special product labeling for products containing certain chemicals known to the State of California to cause cancer, birth defects or other reproductive harm. Creative has chosen to provide a warning based on its knowledge about the presence of one or more listed chemicals without attempting to evaluate the level of exposure. With Creative's products, the exposure may be below the Proposition 65 level of concern, or could even be zero. However, due to an abundance of caution, Creative has elected to place the Proposition 65 warning on its products.

Wireless Device

Switch off the device where it is prohibited, or when its use may cause danger or interference such as inside an aircraft, hospitals, or near refueling points.

Périphérique sans fil

Éteignez le périphérique lorsqu'il est interdit ou lorsque son utilisation peut entraîner un danger ou des interférences, comme dans un avion, un hôpital ou près de postes d'avitaillement.

Declaration Of Conformity

Manufacturer / Importer's Name: **Creative Labs, Inc.**
Manufacturer / Importer's Address: **1901 McCarthy Boulevard
Milpitas, CA, 95035
United States
Tel: (408) 428-6600**

declares under its sole responsibility that the product
Trade Name: **Zii Sound**
Model Numbers: **MF0390**

has been tested according to the FCC/CISPR22/97 requirement for class B devices and found compliant with the following standards:

**EM/EMC: ANSI C63.4 2003, FCC Part 15 Subpart B & C
Complies with Canadian ICES-003 Class B & RSS-210 Standards**

This device complies with part 15 of the FCC Rules. Operation is subject to the following two conditions:

1. This device may not cause harmful interference, and
2. This device must accept any interference received, including interference that may cause undesirable operation.

Ce matériel est conforme à la section 15 des règles FCC. Son Fonctionnement est soumis aux deux conditions suivantes:
1. Le matériel ne peut être source d'interférences et
2. Doit accepter toutes les interférences reçues, Y compris celles pouvant provoquer un fonctionnement indésirable.

Compliance Manager
Creative Labs, Inc.
September 4, 2009

© 2009, Creative Technology Ltd. All rights reserved. The Creative logo, Sound Blaster, X-Fi, and GigaWorks are registered trademarks of Creative Technology Ltd. in the United States and other countries. All other brand or product names mentioned are trademarks or registered trademarks of their respective holders and are hereby recognised as such. All specifications are subject to change without prior notice. Use of this product is subject to a limited warranty. Actual contents may differ slightly from those pictured.

PN XXXXXXXXXXXXXXX Rev A

CREATIVE



EN

Connectivity Diagram & Quick Start Guide

FR

Connectivity Diagram & Quick Start Guide

DE

Connectivity Diagram & Quick Start Guide

IT

Connectivity Diagram & Quick Start Guide

ES

Connectivity Diagram & Quick Start Guide

NL

Connectivity Diagram & Quick Start Guide

PT

Connectivity Diagram & Quick Start Guide

NO

Connectivity Diagram & Quick Start Guide

FI

Connectivity Diagram & Quick Start Guide

SV

Connectivity Diagram & Quick Start Guide

DA

Connectivity Diagram & Quick Start Guide

CZ

Connectivity Diagram & Quick Start Guide

PL

Connectivity Diagram & Quick Start Guide

RU

Connectivity Diagram & Quick Start Guide

HU

Connectivity Diagram & Quick Start Guide

EL

Connectivity Diagram & Quick Start Guide

SK

Connectivity Diagram & Quick Start Guide

LT

Connectivity Diagram & Quick Start Guide

INSPIRE S2 WIRELESS

PN 03MF16200000 Rev. B

EN English

FR Français

DE Deutsch

IT Italiano

ES Español

NL Nederlands

User Instruction

Congratulations on purchasing your Creative Inspire S2 Wireless with Bluetooth® wireless technology. This speaker system allows you to enjoy music wirelessly from your Bluetooth enabled device with A2DP profile. You can also connect to your other audio devices via the AUX-in jack. Read on to find out how to set-up and experience this system at its best. Please keep this document for future reference.

User Instruction

Congratulations on purchasing your Creative Inspire S2 Wireless with Bluetooth® wireless technology. This speaker system allows you to enjoy music wirelessly from your Bluetooth enabled device with A2DP profile. You can also connect to your other audio devices via the AUX-in jack. Read on to find out how to set-up and experience this system at its best. Please keep this document for future reference.

User Instruction

Congratulations on purchasing your Creative Inspire S2 Wireless with Bluetooth® wireless technology. This speaker system allows you to enjoy music wirelessly from your Bluetooth enabled device with A2DP profile. You can also connect to your other audio devices via the AUX-in jack. Read on to find out how to set-up and experience this system at its best. Please keep this document for future reference.

User Instruction

Congratulations on purchasing your Creative Inspire S2 Wireless with Bluetooth® wireless technology. This speaker system allows you to enjoy music wirelessly from your Bluetooth enabled device with A2DP profile. You can also connect to your other audio devices via the AUX-in jack. Read on to find out how to set-up and experience this system at its best. Please keep this document for future reference.

User Instruction

Congratulations on purchasing your Creative Inspire S2 Wireless with Bluetooth® wireless technology. This speaker system allows you to enjoy music wirelessly from your Bluetooth enabled device with A2DP profile. You can also connect to your other audio devices via the AUX-in jack. Read on to find out how to set-up and experience this system at its best. Please keep this document for future reference.

User Instruction

Congratulations on purchasing your Creative Inspire S2 Wireless with Bluetooth® wireless technology. This speaker system allows you to enjoy music wirelessly from your Bluetooth enabled device with A2DP profile. You can also connect to your other audio devices via the AUX-in jack. Read on to find out how to set-up and experience this system at its best. Please keep this document for future reference.

Specifications

Creative Inspire S2 Wireless

Satellite speaker:
7 watts RMS per channel
Subwoofer:
19 watts RMS
Signal-to-Noise Ratio:
75dB
Frequency Response:
40Hz - 20kHz
Bluetooth Version:
Bluetooth 2.0 + EDR
Frequency:
2.4GHz
Supported Bluetooth profiles:
• **A2DP (Advanced Audio Distribution Profile)**
• **AVRCP (Audio/Video Remote Control Profile)**
Operating Range:
Up to 10 meters*

* Measured in open space. Walls and structures may affect range of device.

These specifications apply to Creative Inspire S2 operating from the supplied 15V DC 3.5A universal power adapter.

Note: Microwaves emitting from a Bluetooth device may affect the operations of other devices. Switch off the device where it is prohibited, or when its use may cause danger or interference such as inside an aircraft, hospitals or near refueling points. We are not responsible for any leakage of information or data during wireless transmission.

Spécifications

Creative Inspire S2 Wireless

Haut-parleur satellite:
7 watts RMS par canal
Caisson de basse:
19 watts RMS
Rapport signal/bruit:
75dB
Réponse en fréquence:
40Hz - 20kHz
Bluetooth Version:
Bluetooth 2.0 + EDR
Fréquence:
2.4GHz
Supported Bluetooth profiles:
• **A2DP (Advanced Audio Distribution Profile)**
• **AVRCP (Audio/Video Remote Control Profile)**
Operating Range:
Up to 10 meters*

* Measured in open space. Walls and structures may affect range of device.

Ces spécifications s'appliquent au modèle Creative Inspire S2 Wireless fonctionnant avec la prise d'alimentation 14V DC 1.9A fournie.

Note: Microwaves emitting from a Bluetooth device may affect the operations of other devices. Switch off the device where it is prohibited, or when its use may cause danger or interference such as inside an aircraft, hospitals or near refueling points. We are not responsible for any leakage of information or data during wireless transmission.

Technische Daten

Creative Inspire S2 Wireless

Satellitenlautsprecher:
7 Watt RMS pro Kanal
Subwoofer:
19 Watt RMS
Rauschabstand:
75dB
Frequenzgang:
40Hz bis 20kHz
Bluetooth Version:
Bluetooth 2.0 + EDR
Frequenz:
2.4GHz
Supported Bluetooth profiles:
• **A2DP (Advanced Audio Distribution Profile)**
• **AVRCP (Audio/Video Remote Control Profile)**
Operating Range:
Up to 10 meters*

* Measured in open space. Walls and structures may affect range of device.

Diese technischen Daten treffen auf das Inspire S2 Wireless zu, das von dem mitgelieferten Netzadapter (14V Wechselstrom 1.9A) betrieben wird.

Note: Microwaves emitting from a Bluetooth device may affect the operations of other devices. Switch off the device where it is prohibited, or when its use may cause danger or interference such as inside an aircraft, hospitals or near refueling points. We are not responsible for any leakage of information or data during wireless transmission.

Specifiche tecniche

Creative Inspire S2 Wireless

Altoparlante satellite:
7 Watt RMS per canale
Subwoofer:
19 Watt RMS
Rapporto segnale-rumore (SNR): **75dB**
Risposta in frequenza:
da 40Hz a 20kHz
Bluetooth Version:
Bluetooth 2.0 + EDR
Frequenza:
2.4GHz
Supported Bluetooth profiles:
• **A2DP (Advanced Audio Distribution Profile)**
• **AVRCP (Audio/Video Remote Control Profile)**
Operating Range:
Up to 10 meters*

* Measured in open space. Walls and structures may affect range of device.

Queste specifiche si riferiscono al modello Creative Inspire S2 Wireless alimentato con l'adattatore di corrente 14V DC 1.9A fornito.

Note: Microwaves emitting from a Bluetooth device may affect the operations of other devices. Switch off the device where it is prohibited, or when its use may cause danger or interference such as inside an aircraft, hospitals or near refueling points. We are not responsible for any leakage of information or data during wireless transmission.

Especificaciones

Creative Inspire S2 Wireless

Altavoz auxiliar:
7 vatios RMS por canal
Subwoofer:
19 vatios RMS
Relación señal a ruido:
75dB
Respuesta en frecuencia:
40Hz a 20kHz
Bluetooth Version:
Bluetooth 2.0 + EDR
Frecuencia:
2.4GHz
Supported Bluetooth profiles:
• **A2DP (Advanced Audio Distribution Profile)**
• **AVRCP (Audio/Video Remote Control Profile)**
Operating Range:
Up to 10 meters*

* Measured in open space. Walls and structures may affect range of device.

Estas especificaciones se aplican para el uso del Creative Inspire S2 Wireless con el adaptador de alimentación suministrado de 14V DC 1.9A.

Note: Microwaves emitting from a Bluetooth device may affect the operations of other devices. Switch off the device where it is prohibited, or when its use may cause danger or interference such as inside an aircraft, hospitals or near refueling points. We are not responsible for any leakage of information or data during wireless transmission.

Specificaties

Creative Inspire S2 Wireless

Altafvozluspreker:
7 Watt RMS per kanaal
Subwoofer:
19 Watt RMS
Signaal/ruisverhouding:
75dB
Frequentiebereik:
40Hz tot 20kHz
Bluetooth Version:
Bluetooth 2.0 + EDR
Frequentie:
2.4GHz
Supported Bluetooth profiles:
• **A2DP (Advanced Audio Distribution Profile)**
• **AVRCP (Audio/Video Remote Control Profile)**
Operating Range:
Up to 10 meters*

* Measured in open space. Walls and structures may affect range of device.

Deze specificaties hebben betrekking op de Creative Inspire S2 Wireless in combinatie met de meegeleverde voedingadapter 14V DC 1.9A.

Note: Microwaves emitting from a Bluetooth device may affect the operations of other devices. Switch off the device where it is prohibited, or when its use may cause danger or interference such as inside an aircraft, hospitals or near refueling points. We are not responsible for any leakage of information or data during wireless transmission.

PT Português

NO Norsk

FI Suomi

SV Svenska

DA Dansk

CZ Česky

User Instruction

Congratulations on purchasing your Creative Inspire S2 Wireless with Bluetooth® wireless technology. This speaker system allows you to enjoy music wirelessly from your Bluetooth enabled device with A2DP profile. You can also connect to your other audio devices via the AUX-in jack. Read on to find out how to set-up and experience this system at its best. Please keep this document for future reference.

User Instruction

Congratulations on purchasing your Creative Inspire S2 Wireless with Bluetooth® wireless technology. This speaker system allows you to enjoy music wirelessly from your Bluetooth enabled device with A2DP profile. You can also connect to your other audio devices via the AUX-in jack. Read on to find out how to set-up and experience this system at its best. Please keep this document for future reference.

User Instruction

Congratulations on purchasing your Creative Inspire S2 Wireless with Bluetooth® wireless technology. This speaker system allows you to enjoy music wirelessly from your Bluetooth enabled device with A2DP profile. You can also connect to your other audio devices via the AUX-in jack. Read on to find out how to set-up and experience this system at its best. Please keep this document for future reference.

User Instruction

Congratulations on purchasing your Creative Inspire S2 Wireless with Bluetooth® wireless technology. This speaker system allows you to enjoy music wirelessly from your Bluetooth enabled device with A2DP profile. You can also connect to your other audio devices via the AUX-in jack. Read on to find out how to set-up and experience this system at its best. Please keep this document for future reference.

User Instruction

Congratulations on purchasing your Creative Inspire S2 Wireless with Bluetooth® wireless technology. This speaker system allows you to enjoy music wirelessly from your Bluetooth enabled device with A2DP profile. You can also connect to your other audio devices via the AUX-in jack. Read on to find out how to set-up and experience this system at its best. Please keep this document for future reference.

User Instruction

Congratulations on purchasing your Creative Inspire S2 Wireless with Bluetooth® wireless technology. This speaker system allows you to enjoy music wirelessly from your Bluetooth enabled device with A2DP profile. You can also connect to your other audio devices via the AUX-in jack. Read on to find out how to set-up and experience this system at its best. Please keep this document for future reference.

Especificações

Creative Inspire S2 Wireless

Coluna satélite:
7 watts RMS por canal
Subwoofer:
19 watts RMS
Relação sinal/ruído:
75dB
Resposta de frequência:
40Hz a 20kHz
Bluetooth Version:
Bluetooth 2.0 + EDR
Frequência:
2.4GHz
Supported Bluetooth profiles:
• **A2DP (Advanced Audio Distribution Profile)**
• **AVRCP (Audio/Video Remote Control Profile)**
Operating Range:
Up to 10 meters*

* Measured in open space. Walls and structures may affect range of device.

Estas especificações aplicam-se ao Creative Inspire S2 Wireless utilizado com o adaptador de corrente de 14V DC 1.9A.

Note: Microwaves emitting from a Bluetooth device may affect the operations of other devices. Switch off the device where it is prohibited, or when its use may cause danger or interference such as inside an aircraft, hospitals or near refueling points. We are not responsible for any leakage of information or data during wireless transmission.

Spesifikasjoner

Creative Inspire S2 Wireless

Satelitt høyttaler:
7 W RMS per kanal
Subwoofer:
19 W RMS
Signalstyrkeforhold:
75dB
Frequensgang:
40Hz - 20kHz
Bluetooth Version:
Bluetooth 2.0 + EDR
Frequens:
2.4GHz
Supported Bluetooth profiles:
• **A2DP (Advanced Audio Distribution Profile)**
• **AVRCP (Audio/Video Remote Control Profile)**
Operating Range:
Up to 10 meters*

* Measured in open space. Walls and structures may affect range of device.

Dette spesifikasjon gjelder for Creative Inspire S2 Wireless drevet med strømforsyningen 14V DC 1.9A som følger med.

Note: Microwaves emitting from a Bluetooth device may affect the operations of other devices. Switch off the device where it is prohibited, or when its use may cause danger or interference such as inside an aircraft, hospitals or near refueling points. We are not responsible for any leakage of information or data during wireless transmission.

Tekniset tiedot

Creative Inspire S2 Wireless

Satelliittilätkä:
7 wattia RMS / kanava
Subwoofer:
19 wattia RMS
Signaali-ohinasuhde:
75dB
Taajuusalue:
40Hz - 20kHz
Bluetooth Version:
Bluetooth 2.0 + EDR
Frequenssi:
2.4GHz
Supported Bluetooth profiles:
• **A2DP (Advanced Audio Distribution Profile)**
• **AVRCP (Audio/Video Remote Control Profile)**
Operating Range:
Up to 10 meters*

* Measured in open space. Walls and structures may affect range of device.

Nämä tiedot koskevat mallia Creative Inspire S2 Wireless, 14V DC 1.9A virtalähtettä.

Note: Microwaves emitting from a Bluetooth device may affect the operations of other devices. Switch off the device where it is prohibited, or when its use may cause danger or interference such as inside an aircraft, hospitals or near refueling points. We are not responsible for any leakage of information or data during wireless transmission.

Uppgifter

Creative Inspire S2 Wireless

Satelliittilätkä:
7 Watt effektivvärde per kanal
Subwoofer:
19 Watt effektivvärde
Signal / störningsförhållande:
75dB
Frequensområde:
40Hz till 20kHz
Bluetooth Version:
Bluetooth 2.0 + EDR
Frequens:
2.4GHz
Supported Bluetooth profiles:
• **A2DP (Advanced Audio Distribution Profile)**
• **AVRCP (Audio/Video Remote Control Profile)**
Operating Range:
Up to 10 meters*

* Measured in open space. Walls and structures may affect range of device.

Desa upplifning över bifogade 14V DC 1.9A -strömadapter.

Note: Microwaves emitting from a Bluetooth device may affect the operations of other devices. Switch off the device where it is prohibited, or when its use may cause danger or interference such as inside an aircraft, hospitals or near refueling points. We are not responsible for any leakage of information or data during wireless transmission.

Spesifikationer

Creative Inspire S2 Wireless

Satelitt högtalare:
7 Watt RMS pr. kanal
Subwoofer:
19 Watt RMS
Signal/störförhåll:
75dB
Frequensrespons:
40Hz till 20kHz
Bluetooth Version:
Bluetooth 2.0 + EDR
Frequens:
2.4GHz
Supported Bluetooth profiles:
• **A2DP (Advanced Audio Distribution Profile)**
• **AVRCP (Audio/Video Remote Control Profile)**
Operating Range:
Up to 10 meters*

* Measured in open space. Walls and structures may affect range of device.

Dessa specifikationer gäller Creative Inspire S2 Wireless der får ström från en 14V/1.9A lysnetadapter.

Note: Microwaves emitting from a Bluetooth device may affect the operations of other devices. Switch off the device where it is prohibited, or when its use may cause danger or interference such as inside an aircraft, hospitals or near refueling points. We are not responsible for any leakage of information or data during wireless transmission.

Spesifikace

Creative Inspire S2 Wireless

Satelitní reproduktor:
RMS 7 W na kanál
Basový reproduktor (Subwoofer):
RMS 19W
Odstup signál/šum:
75dB
Frekv

• Connectivity Diagram • Schéma de connexion • Anschluss-Diagramm • Schema delle connessioni • Diagrama de conectividad • Aansluitingsschema • Diagrama de Ligações • Koplingsskjema • Liitäntäkaavio • Kopplingsbeskrivning • Tillslutningsdiagram • Schéma zapojení • Schemat połączef • Схема подключения • Csatlakoztatás • Διάγραμμα συνδεσιμότητας • Schéma zapojenia • Jungiamumo schema

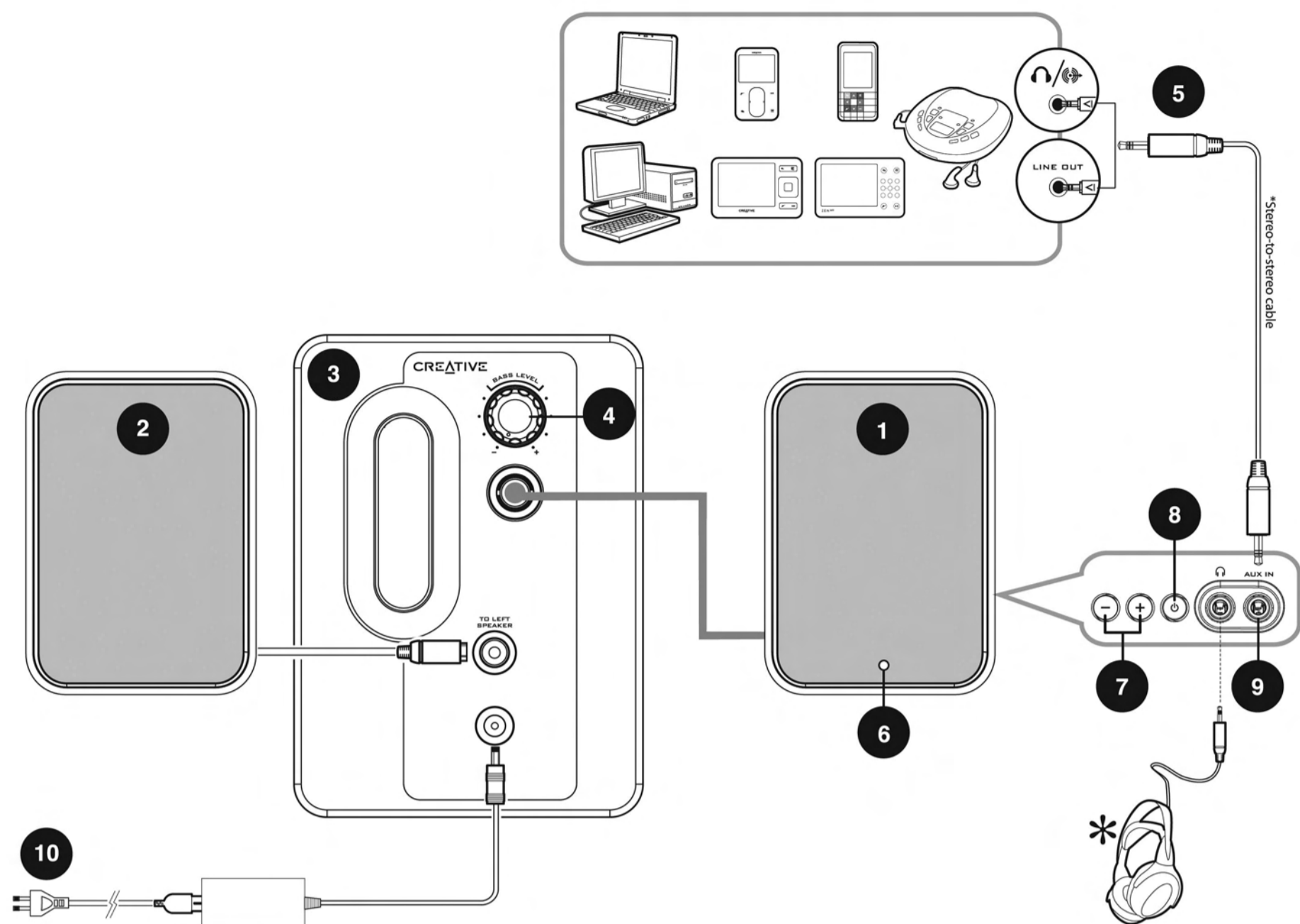

* Optional (sold separately) • Facultatif (vendu séparément) • Zusätzlicher (separat erhältlich) • Opzionale (venduto separatamente) • Opcional (se vende por separado) • Optioneel (wordt apart verkocht) • Opcional (vendido em separado) • Ekstrastruyt (selges separat) • Lisävarusteet (myydään erikseen) • Tillbehör (säljs separat) • Tilbehør (selges særskilt) • Volitelná (satelitních reproduktů) • Opcjonalne (do nabycia osobno) • Необязательно (приобретается отдельно) • Opcionalis (kullán kell megvásárolnia) • Προαιρετικά (Πωλείται ξεχωριστά) • Voliteľný doplnok (predáva sa samostatne) • Papildomai (párducodama atskiral)

EN English

Using with other audio devices via AUX-In
You can listen to music via the AUX-in jack with a stereo-to-stereo cable (provided). Setup the speaker system as shown above.
Note: Remove all Bluetooth links before proceeding.
To enjoy music wirelessly from this speaker system, refer to the **Wireless Setup Guide leaflet**.

FR Français

Using with other audio devices via AUX-In
You can listen to music via the AUX-in jack with a stereo-to-stereo cable (provided). Setup the speaker system as shown above.
Note: Remove all Bluetooth links before proceeding.
To enjoy music wirelessly from this speaker system, refer to the **Wireless Setup Guide leaflet**.

DE Deutsch

Using with other audio devices via AUX-In
You can listen to music via the AUX-in jack with a stereo-to-stereo cable (provided). Setup the speaker system as shown above.
Note: Remove all Bluetooth links before proceeding.
To enjoy music wirelessly from this speaker system, refer to the **Wireless Setup Guide leaflet**.

IT Italiano

Using with other audio devices via AUX-In
You can listen to music via the AUX-in jack with a stereo-to-stereo cable (provided). Setup the speaker system as shown above.
Note: Remove all Bluetooth links before proceeding.
To enjoy music wirelessly from this speaker system, refer to the **Wireless Setup Guide leaflet**.

ES Español

Using with other audio devices via AUX-In
You can listen to music via the AUX-in jack with a stereo-to-stereo cable (provided). Setup the speaker system as shown above.
Note: Remove all Bluetooth links before proceeding.
To enjoy music wirelessly from this speaker system, refer to the **Wireless Setup Guide leaflet**.

NL Nederlands

Using with other audio devices via AUX-In
You can listen to music via the AUX-in jack with a stereo-to-stereo cable (provided). Setup the speaker system as shown above.
Note: Remove all Bluetooth links before proceeding.
To enjoy music wirelessly from this speaker system, refer to the **Wireless Setup Guide leaflet**.

1	Right Satellite Speaker	Haut-parleur satellite droit	Rechter Satellitenlautsprecher	Altoparlante satellite destro	Altavoz satélite derecho	Rechter satellietluidspreker
2	Left Satellite Speaker	Haut-parleur satellite gauche	Linker Satellitenlautsprecher	Altoparlante satellite sinistro	Altavoz satélite izquierdo	Linker satellietluidspreker
3	Subwoofer	Caisson de basse	Subwoofer	Subwoofer	Subwoofer	Subwoofer
4	Bass Level Control	Bouton de réglage des basses	Basssteuerung	Controllo del livello dei bassi	Control de nivel de graves	Basregeling
5	To Analog Audio Source	Vers la source audio analogique	Analoge Audio-Quelle	Sorgente audio analogica	Fuente de sonido analógica	Analoge geluidsbron
6	LED in color Off - Standby Green - On	Diode électroluminescente POWER (le système reste connecté en permanence aux haut-parleurs principaux)	Netzschalter-LED (Das System ist ständig an das Netz angeschlossen)	Spia di accensione (il sistema è sempre collegato alla rete elettrica)	LED Power (el sistema siempre está conectado a la red eléctrica)	Aan/uit-LED (Power) (het systeem wordt altijd op de netvoeding aangesloten)
7	Volume +/- Button					
8	Power/Standby Button					
9	Auxiliary Line-in For Audio Devices	Vers la source audio analogique	Zu den analogen Audio-Quellen	Sorgente audio analogica	Fuente de sonido analoga	Analoge geluidsbron
10	To Wall Outlet (Disconnect when not in use for several days) (Type of adapter may vary in different countries)	Vers la prise murale (Déconnectez le système si vous n'avez pas l'intention de l'utiliser pendant plusieurs jours) (le modèle peut varier selon le pays)	Zur Steckdose (Trennen Sie das Gerät von der Stromquelle, wenn Sie es mehrere Tage lang nicht verwenden) (Adapter sind von Land zu Land unterschiedlich)	Presu a muro (collegare se non si utilizza per diversi giorni) (I tipi di adattatore possono variare a seconda dei paesi)	A la toma de corriente (desconectarlo cuando no se vaya a utilizar durante varios días) (los tipos de adaptadores pueden variar según el país)	Naar stopcontact (verwijder het apparaat uit het stopcontact als u dit gedurende meerdere dagen niet gebruikt) (typen adapter kunnen verschillend zijn in de verschillende landen)

PT Português

Using with other audio devices via AUX-In
You can listen to music via the AUX-in jack with a stereo-to-stereo cable (provided). Setup the speaker system as shown above.
Note: Remove all Bluetooth links before proceeding.
To enjoy music wirelessly from this speaker system, refer to the **Wireless Setup Guide leaflet**.

NO Norsk

Using with other audio devices via AUX-In
You can listen to music via the AUX-in jack with a stereo-to-stereo cable (provided). Setup the speaker system as shown above.
Note: Remove all Bluetooth links before proceeding.
To enjoy music wirelessly from this speaker system, refer to the **Wireless Setup Guide leaflet**.

FI Suomi

Using with other audio devices via AUX-In
You can listen to music via the AUX-in jack with a stereo-to-stereo cable (provided). Setup the speaker system as shown above.
Note: Remove all Bluetooth links before proceeding.
To enjoy music wirelessly from this speaker system, refer to the **Wireless Setup Guide leaflet**.

SV Svenska

Using with other audio devices via AUX-In
You can listen to music via the AUX-in jack with a stereo-to-stereo cable (provided). Setup the speaker system as shown above.
Note: Remove all Bluetooth links before proceeding.
To enjoy music wirelessly from this speaker system, refer to the **Wireless Setup Guide leaflet**.

DA Dansk

Using with other audio devices via AUX-In
You can listen to music via the AUX-in jack with a stereo-to-stereo cable (provided). Setup the speaker system as shown above.
Note: Remove all Bluetooth links before proceeding.
To enjoy music wirelessly from this speaker system, refer to the **Wireless Setup Guide leaflet**.

CZ Český

Using with other audio devices via AUX-In
You can listen to music via the AUX-in jack with a stereo-to-stereo cable (provided). Setup the speaker system as shown above.
Note: Remove all Bluetooth links before proceeding.
To enjoy music wirelessly from this speaker system, refer to the **Wireless Setup Guide leaflet**.

1	Alto-falante satélite direito	Høyre satellithøytaler	Oikea satelliittikaiutin	Höger satellithögtalare	Højre satellithøjtaler	Pravý satelitní reproduktor
2	Alto-falante satélite izquierdo	Venstre satellithøytaler	Vasen satelliittikaiutin	Vänster satellithögtalare	Venstre satellithøjtaler	Levý satelitní reproduktor
3	Subwoofer	Subwoofer	Subwoofer	Subwoofer	Subwoofer	Subwoofer
4	Controllo do nível de graves	Bassnivåregulering	Bassoitoiston tasonsäädin	Basnivå-kontrol	Basniveau Kontrol	Ovální držák basů
5	Fonte de áudio analógica	Til analoge lydtkilder	Analogislin äänlähteisiin	Til analoga ljudkällor	Til analog Lydtkilder	Analogový zvukový zdroj
6	LED de corrente (o sistema está sempre ligado à rede de alimentação)	Lysdioder for strøm (systemet er alltid koblet til strøm)	Virran merkkivalvoo (Järjestelmä on aina kytketty verkkoon.)	Ström-LED (Systemet är alltid anslutet till huvudkontakten)	Strøm-LED (systemet er alltid sluttet til hovedkontakten)	Dioda LED (Power) (System je trvale připojen k elektrické síti)
7	xxxxxxxxxxxxxxxxxxxx					
8	xxxxxxxxxxxxxxxxxxxx					
9	Fonte Áudio Analógica	Til analoge lydtkilder	Analogislin äänlähteisiin	Hjälplinjeringång: för ljudenheter	Auxiliary-indgang: Til lydenheder	Doplnkový liňkový vstup: Pro zvuková zařízení
10	Para ligação à tomada eléctrica (desligar se não for utilizado durante vários dias) (os tipos de transformador podem variar de país para país)	Til stikkontakt (Kople fra når enheten ikke er i bruk på flere dager) (Type adapter kan variere fra land til land)	Pistorasiaan (Húzza ki, ha huzamosabb ideig nem használja a készüléket) (verkoillaitteen tyyppi voi vaihdella eri maissa) (Type adapter kan variere fra land til land)	Til væggtag (Dra ur sladderen om anläggningen inte ska användas på ett par dagar) (adaptertyp kan variera beroende på land)	Til vægstatik (Frakoblés, hvis enheden ikke skal bruges i flere dage) (Adaptertypen kan variere fra land til land)	Do zásuvky ve zdi (odpojit, pokud zařízení nebude několik dní používáno) (zástrčky střídaného napájení se liší podle země použití)

PL Polski

Using with other audio devices via AUX-In
You can listen to music via the AUX-in jack with a stereo-to-stereo cable (provided). Setup the speaker system as shown above.
Note: Remove all Bluetooth links before proceeding.
To enjoy music wirelessly from this speaker system, refer to the **Wireless Setup Guide leaflet**.

RU Русский

Using with other audio devices via AUX-In
You can listen to music via the AUX-in jack with a stereo-to-stereo cable (provided). Setup the speaker system as shown above.
Note: Remove all Bluetooth links before proceeding.
To enjoy music wirelessly from this speaker system, refer to the **Wireless Setup Guide leaflet**.

HU Magyar

Using with other audio devices via AUX-In
You can listen to music via the AUX-in jack with a stereo-to-stereo cable (provided). Setup the speaker system as shown above.
Note: Remove all Bluetooth links before proceeding.
To enjoy music wirelessly from this speaker system, refer to the **Wireless Setup Guide leaflet**.

EL Ελληνικά

Using with other audio devices via AUX-In
You can listen to music via the AUX-in jack with a stereo-to-stereo cable (provided). Setup the speaker system as shown above.
Note: Remove all Bluetooth links before proceeding.
To enjoy music wirelessly from this speaker system, refer to the **Wireless Setup Guide leaflet**.

SK Slovensky

Using with other audio devices via AUX-In
You can listen to music via the AUX-in jack with a stereo-to-stereo cable (provided). Setup the speaker system as shown above.
Note: Remove all Bluetooth links before proceeding.
To enjoy music wirelessly from this speaker system, refer to the **Wireless Setup Guide leaflet**.

LT Lietuvių

Using with other audio devices via AUX-In
You can listen to music via the AUX-in jack with a stereo-to-stereo cable (provided). Setup the speaker system as shown above.
Note: Remove all Bluetooth links before proceeding.
To enjoy music wirelessly from this speaker system, refer to the **Wireless Setup Guide leaflet**.

1	Prawy głośnik satelitarny	Правый динамик	Jobb oldali satelit hangszóró	Μπροστινό δεξιό περιφερειακό ηχείο	Pravý satelitní reproduktor	Dešinis satelitinis garsiakalbis
2	Levy głośnik satelitarny	Левый динамик	Bal oldali satelit hangszóró	Μπροστινό αριστερό περιφερειακό ηχείο	Levý satelitní reproduktor	Kairysis satelitinis garsiakalbis
3	Subwoofer	Субвуфер	Mélysugázó	Subwoofer	Subwoofer	Žemųjų dažnių kolonėlė
4	Regulator poziomu basów	Регулятор уровня НЧ	Mély frekvenciaszint szabályozó	Διάταξη ελέγχου επιπέδου μπάσων	Ovládanie úrovně hluk	Žemų tonų valdiklis
5	Analogowe źródło dźwięku	Аналоговый входной звуковой сигнал	Az analog audioforráshoz	Πηγές ήχου για αναλογική μετατροπή	Zapojenie ku zdroju analogového signálu	Į analoginius garso šaltinius
6	Dioda LED (Power) (System jest zawsze podłączony do zasilania.)	Индикатор LED (система постоянно подключена к сети питания)	Power LED (A rendszer mindig kapcsolódik az elektromos hálózathoz)	Ενδεικτική λυχνία παροχής ρεύματος (Το σύστημα είναι μόνιμα συνδεδεμένο με ρεύμα δικτύου)	Indikator napájenia (System je trvale pripojený k hlavnému prívodu elektrickej energie)	Maitinimo šviesos dioda (Sistema visada būna prijungta prie maitinimo tinklo)
7	xxxxxxxxxxxxxxxxxxxx					
8	xxxxxxxxxxxxxxxxxxxx					
9	Węzła linowe urządzenia dodatkowego: dla urządzeń audio	Аналоговый входной звуковой сигнал	Kiegészítő vonalszintű bemenet: Audioeszközök számára	Βοηθητική είσοδος για διατάξεις ήχου	Prídavný vstup: pre audio zariadenia	Papildoma jungtis garso penguiniams
10	Do gniazda sieciowego (należy odłączyć, jeśli nie będzie używany przez kilka dni) (wtyczka różni się w zależności od kraju)	К сетевой розетке (отключить, если система не используется несколько дней) (Конструкция штепсельной вилки зависит от страны)	A fal áirzathoz (Húzza ki, ha huzamosabb ideig nem használja a készüléket) (Egyes országokban különbözőhet a tápegység típusa)	Πρίζα σύνδεσης σε τοίχο (Αποσυνδέστε, εάν δεν πρόκειται να χρησιμοποιηθεί για αρκετές ημέρες) (Ο τύπος του προσαρμογέα ενδέχεται να διαφέρει ανά χώρα)	Do elektrickej zásuvky (ik sústava nebuďte používať niekoľko dní, vytriahnite kábel zo zásuvky) (v jednotlivých krajinách sa typ adaptéru môže líšiť)	Į sieninį kištukinį lizdą (išjunkite, jei sistema nenaudojama) (skirtingose šalyse adapterių tipai gali skirtis)