

<b>EN</b>	Quick Start Guide .....	2
<b>FR</b>	Démarrage Rapide .....	27
<b>ES</b>	Guía Rápida .....	49
<b>PT</b>	Início Rápido .....	71
<b>JP</b>	クイックスタートガイド .....	93
<b>CT</b>	快速入門指南 .....	115
<b>TR</b>	Kullanım .....	137
<b>KO</b>	빠른 시작 안내서 .....	159

**Congratulations on purchasing the ZiiSound D5x, the modular wireless speaker system that you will ever need. Get ready to experience a whole new definition of audio nirvana with one or more D5x or DSx wireless subwoofer linked together for dynamics rivalling the very best in home audio set-ups.**

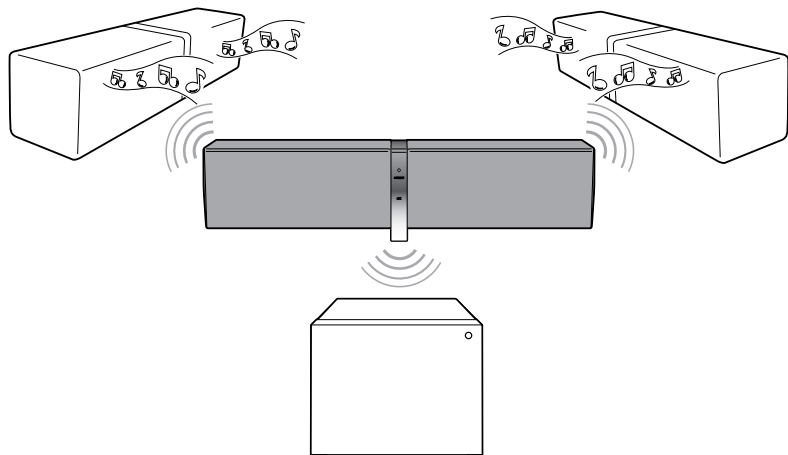

*Additional ZiiSound D5x and ZiiSound DSx shown here and throughout the user manual are for illustration purposes only. Sold separately. Not included.*



For detailed product information, instructions or to find out more about our speakers, visit [www.creative.com/speakers](http://www.creative.com/speakers)

#### **Safety Instruction**

Please read the following before using the Creative Products:

- Use a mains plug that is appropriate for your country or region.
- To be completely disconnected from the power input, the mains plug has to be disconnected /detached from the mains.
- Disconnect the mains plug when the device is expected to be unused for several days.

Additional guidelines for wireless devices

- The short wave radio frequency signals of a wireless device may impair the operation of other electronic and medical devices
- Switch off the device where it is prohibited. Do not use the device in medical facilities, aircraft, refueling points, close to automatic doors, automatic fire alarms or other automatically controlled devices
- Keep this device at least 20 cm from pacemakers and other medical devices. Radio waves may impair the operation of pacemakers and other medical devices

### Technical Specifications

- *Bluetooth* Version : *Bluetooth 2.1 + EDR (Enhanced Data Rate)*
- *Bluetooth* Operating Frequency : *2402 - 2480 MHz*
- Supported *Bluetooth* profiles\* : *A2DP (Wireless Stereo Bluetooth)*  
: *AVRCP (Bluetooth Remote Control)*
- Operating Range for *Bluetooth* : *Up to 10 meters (Measured in open space.*  
*Walls and structures may affect range of device.)*
- Operating Range for Wireless Link : *Up to 30 meters (Measured in open space.*  
*Walls and structures may affect range of device.)*
- Wireless Link Operating Frequency : *5725 - 5850 MHz*
- Device Operating Temperature range : *0°C to 45°C*
- Power Adapter Operating Temperature range : *0°C to 40°C*

These specifications apply to the ZiiSound D5x operating from the supplied 15V DC 3.5A universal power adapter. The BT-D5 wireless transmitter is powered directly from the iPhone/iPod players. (DC 3.3v 100mA)

**Note:** Compliance markings are located on the bottom of this product.

### Compatibility Disclaimer

- Wireless performance is dependent on your device's *Bluetooth* wireless technology. Refer to your device manufacturer's manual.
- Every electronic device is subjected to radio frequency (RF) interference from external sources. These include the connection between linked ZiiSound D5x and ZiiSound D5x wireless subwoofer.
- Creative will not be liable for any loss of data or leakage resulting from the use of these devices.

### Notes

\* Refer to your *Bluetooth* device (notebook<sup>1</sup>, PC<sup>1</sup>, mobile device<sup>2</sup>) manufacturer's documentation /website for supported profiles.

<sup>1</sup> Compatible with PC (Windows XP/Vista/7), Apple Macintoshes equipped with *Bluetooth* wireless stereo

<sup>2</sup> Compatible with most major brands of *Bluetooth* A2DP enabled mobile phones. (including iPhone<sup>3</sup>, Windows Mobile)

<sup>3</sup> Original iPhone not supported.

## 1.1 Product Overview / Connectivity Diagram

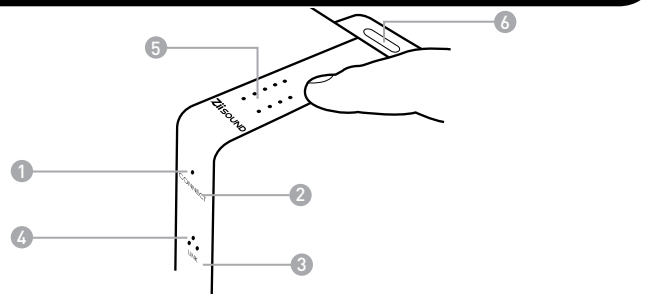

1	CONNECT LED Status Indicator	<p>Pairing Rapid blinking LED</p> <p>Bluetooth Connected Steady Lit</p>
2	CONNECT Touchpad / Button	For various <i>Bluetooth</i> Pairing activities
3	LINK TouchPad / Button	For various speakers linking activities
4	LINK LED Status Indicator	<p>(Slave) Left Speaker</p> <p>(Slave/Master*) Center Speaker</p> <p>(Master) Right Speaker</p> <p>Link discoverable mode Rapid blinking LED</p>
5	Volume Touchpad / Button and Volume Led Status Indicator	
6	Transmitter Bay with EZ-Charge™	

\* For a 1.1 setup, the ZiiSound D5x will light up the Center Speaker LED to indicate it is connected in a 1.1 setup.

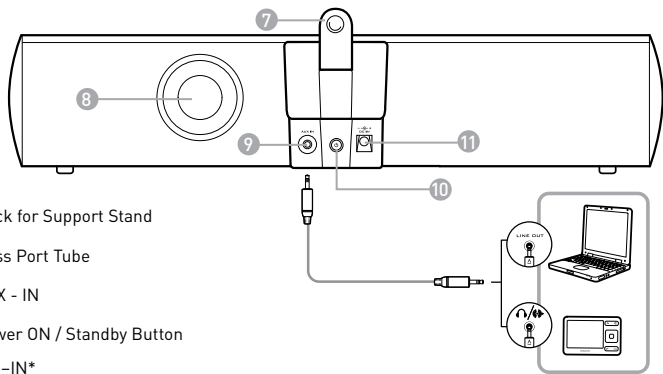

- 7 Dock for Support Stand
- 8 Bass Port Tube
- 9 AUX - IN
- 10 Power ON / Standby Button
- 11 DC -IN\*

\* All LEDs will light up for a few seconds when the mains are applied to the D5x. This is normal.

## 1.2 Overview of Wireless Transmitter

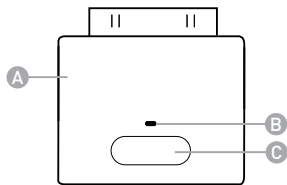

- A Wireless Bluetooth Transmitter (BT-D5)**  
To be used with iPhone/iPod. See Table 1 for a list of compatible iPhone and iPod models.
- B Transmitter LED Status Indicator**  
Blue LED blinks at different intervals to indicate wireless link status
- C Pairing Button**  
Press and hold this to initiate various Wireless Transmitter pairing activities

## 1.3 Dock and charge your player

Select the Backrest adapter that best suits your player.

1	<b>iPhone 3GS</b> 8 GB 16GB 32GB	<b>iPhone 3G</b> 8GB 16GB		
2	<b>iPhone</b> 4GB 8GB 16GB			
3	<b>iPod touch</b> 1st generation 8GB 16GB 32GB	<b>iPhone 4</b> 16GB 32GB	<b>iPod nano</b> 6th generation (video) 8GB 16GB	
4	<b>iPod touch</b> 2nd generation 8GB 16GB 32GB	<b>iPod touch</b> 3rd generation 32GB 64GB		
5	<b>iPod nano</b> 4th generation (video) 8GB 16GB	<b>iPod nano</b> 3rd generation (video) 4GB 8GB	<b>iPod nano**</b> 5th generation (video) 8GB 16GB	<b>iTouch</b> 4th generation 8GB 32GB 64GB
6	<b>iPod classic</b> 80GB			
7	<b>iPod classic</b> 160GB (2007)	<b>iPod classic</b> 160GB (2009)		

\*\*Disclaimer: 5th Generation iPod FM radio function is not supported

Table 1

**A** Insert backrest adapter fully into the support stand and ensure that it is secured

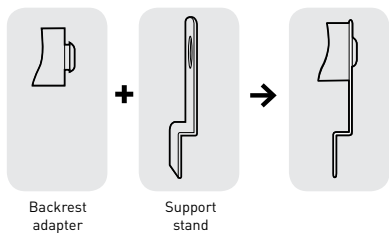

**B** Insert the support stand into the dock located at the rear of the speaker

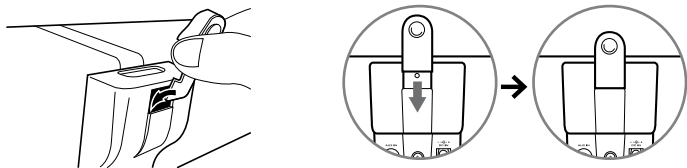

**C** You can now dock and charge your player

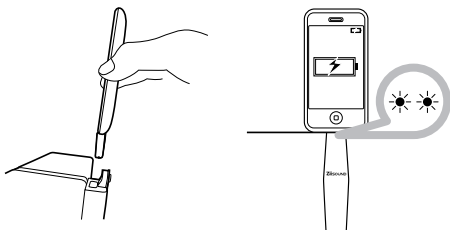

## 1.4 Enjoy audio from your iPhone/iPod via the *Bluetooth* wireless transmitter BT-D5

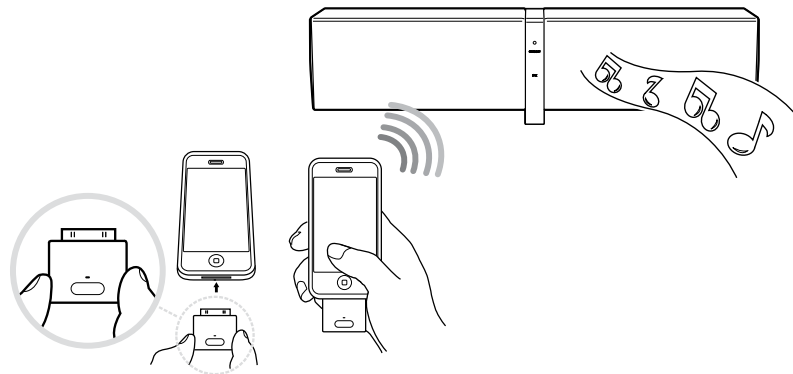

The *Bluetooth* wireless transmitter BT-D5 is paired with ZiiSound D5x at factory. Simply insert the BT-D5 into your iPhone/iPod to enjoy high quality wireless audio.

Action	LED status	Status
Power <u>ON</u> the speaker	Volume Touchpad / Button lit	Speaker is powered <u>ON</u>
Insert BT-D5 to your player	Transmitter LED blinks	Connection in progress
Wait for automated connection process to complete	CONNECT LED lit steady	Ready to stream music

## 1.5 Enjoy audio from Stereo *Bluetooth* devices

Enjoy your favourite music from other *Bluetooth* devices by following these steps to connect them.

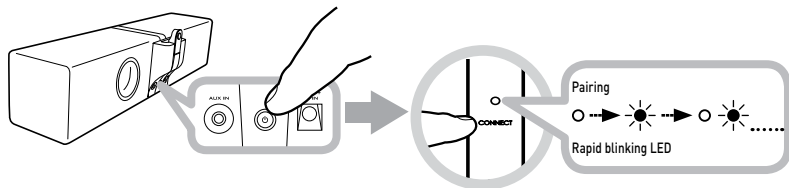

- A** Ensure the speaker is powered ON. Press and hold "CONNECT Touchpad / Button" for 4 seconds till CONNECT LED is rapidly flashing.

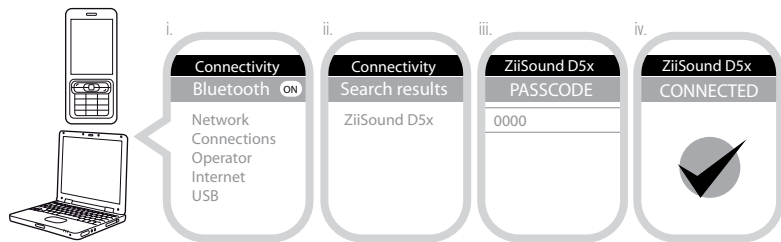

- B** i) Turn on the *Bluetooth* feature on your device  
 ii) Search for ZiiSound D5x  
 iii) Pair and connect to ZiiSound D5x, if prompted for passcode, enter 0000.  
 iv) Pairing successful, ready to stream music

**Note:** The above are generic steps to pair a *Bluetooth* device, for more specific instruction on *Bluetooth* connectivity for your device, please consult your manufacturer's manual.

## 1.6 Re-pairing with your iPhone/iPod via the Wireless Transmitter BT-D5

Follow these steps if there is a need to re-pair your iPhone/iPod via BT-D5 to the ZiiSound D5x.

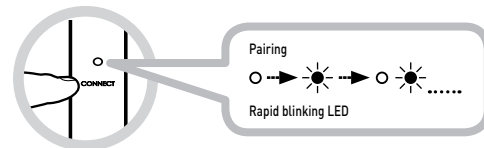

- A** Ensure the speaker is powered ON. Press and hold "CONNECT Touchpad / Button" for 3 seconds till CONNECT LED is rapidly flashing.

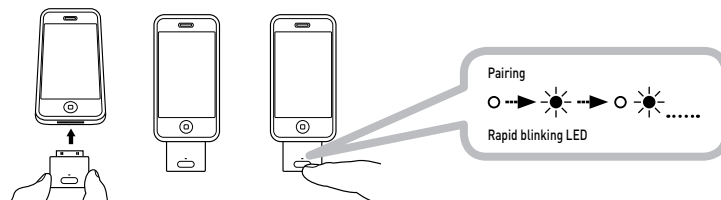

- B** Insert BT-D5 into your iPhone/iPod. Press and hold the "PAIRING Button" for 3 seconds till Transmitter LED is rapidly flashing.

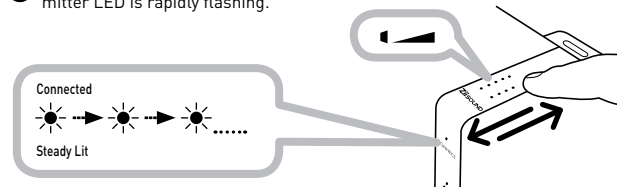

- C** Wait for automatic connection process to complete. CONNECT LED should be steady lit. Ready to stream music.

## 1.7 Switching between paired devices

Enjoy your favourite music from another paired *Bluetooth* device by following these steps to establish the connection.

Action	LED status	Status
—	—	Ensure that the next previously paired device has <i>Bluetooth</i> powered on and ready to accept connection
Press "CONNECT Touchpad / Button" once	CONNECT LED blinks and stays lit	<i>Bluetooth</i> connection switches. Ready to stream music.

## 2.1 Adding a subwoofer to the D5x

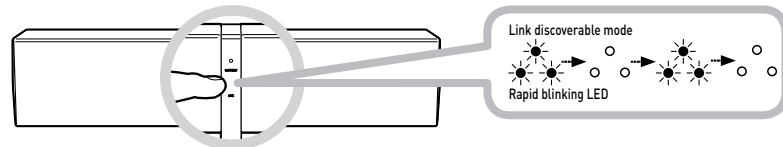

- A** Pick one ZiiSound D5x as your master speaker. Press and hold LINK Touchpad / Button for 4 seconds and release when LINK LEDs are rapidly blinking to enter LINK discoverable mode with no other speakers in this mode.

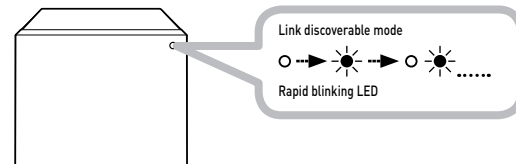

- B** Activate LINK discoverable mode on the ZiiSound DSx wireless subwoofer. For more details, refer to the ZiiSound DSx manual.

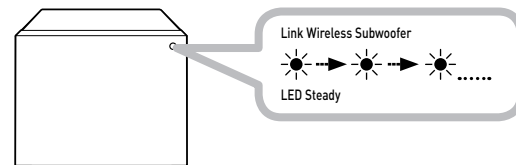

- C** The ZiiSound DSx are linked when the LED status indicator on the DSx are Lit Steady.

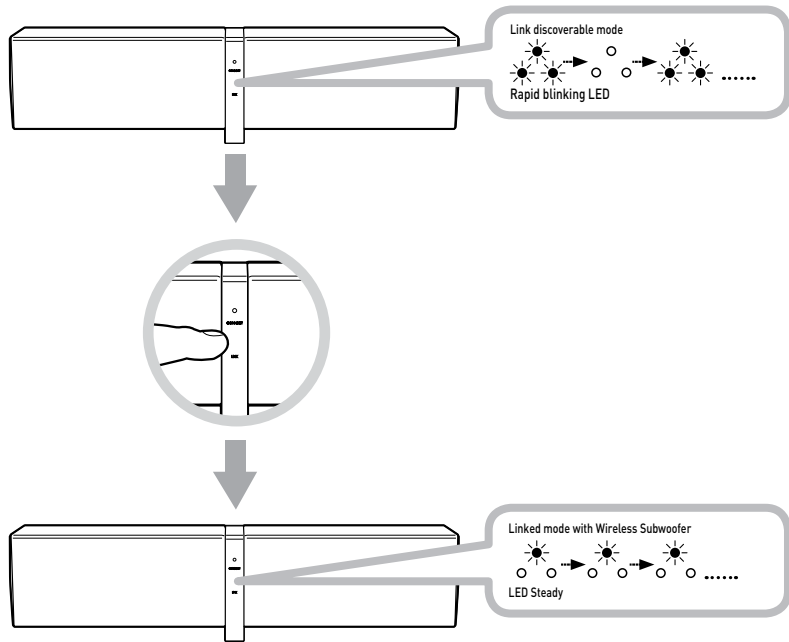

- D** Link establishment complete. If the ZiiSound D5x LINK LED is still Rapidly Blinking, Press the LINK Touchpad / Button once to stop or wait for it to timeout. Ready to Stream music.

## 2.2 Adding one or more ZiiSound D5x and DSx wireless subwoofer to the D5x\*

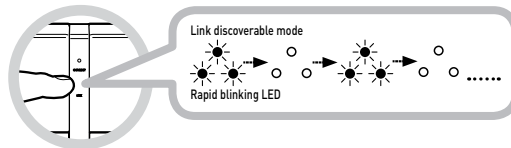

- A** Pick one ZiiSound D5x as your master speaker. Press and hold LINK Touchpad / Button for 4 seconds and release when LINK LEDs are rapidly blinking to enter LINK discoverable mode with no other speakers in this mode. This speaker will become the Master speaker and your RIGHT Channel Speaker.

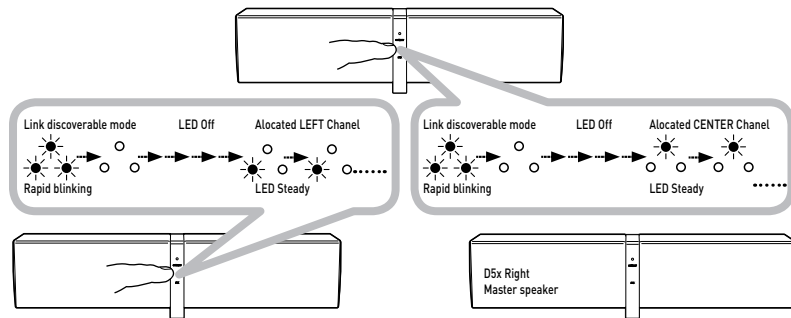

- B** Press and hold the LINK Touchpad / Button for 4 seconds until its LINK LEDs are rapidly blinking on the other ZiiSound D5x (s) speakers one after the other. They will be automatically be allocated as LEFT, then CENTER Channels by order of the activation of their LINK discovery mode. ie 2<sup>nd</sup> speaker to activate LINK discovery would be the LEFT Channel, 3<sup>rd</sup> speaker would be the CENTER Channel.

**Note:** Whenever a new speaker is added to the RIGHT Channel Master speaker, the LINK discoverable mode for the Master speaker extends for another 1 minute for other speakers to link in.



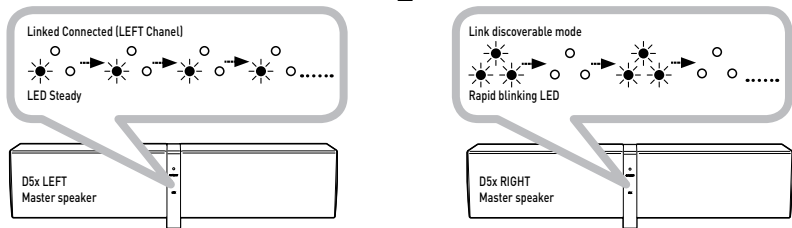
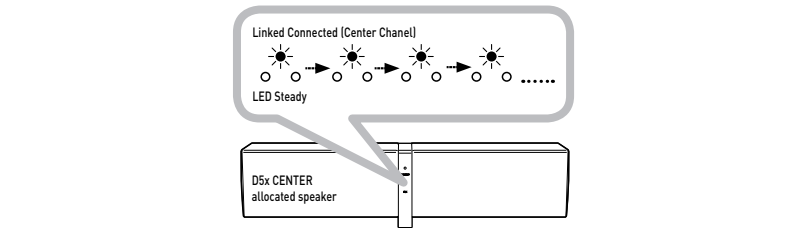

**C** LEFT and CENTER speakers are Linked when the LINK LED Status indicator of the LEFT and CENTER channel speakers shows their respective LEFT and CENTER LED Lit on its LINK LED.

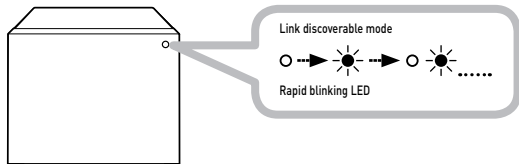

**D** Jump to step **F** should no wireless subwoofer are required to be linked.

Set the ZiiSound D5x wireless subwoofer to LINK Discoverable mode. For detailed instructions, refer to the ZiiSound D5x User manual. The Master D5x speaker will automatically connect the D5x wireless subwoofer while the D5x LINK LED is still rapidly blinking.

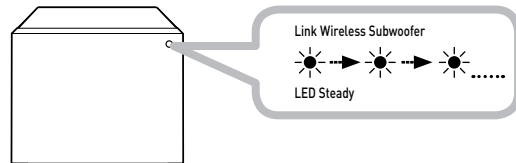

**E** The ZiiSound D5x are linked when the LED status indicator on the D5x are Lit Steady.

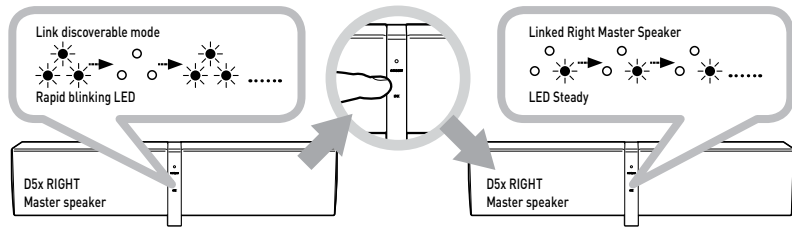

**F** Link establishment complete. If the ZiiSound D5x (Right Channel) Master speaker LINK LED is still Rapidly Blinking, Press the LINK Touchpad / Button once to stop or wait for it to timeout. The speakers are now in Multi Channel mode. Ready to Stream music.

**Note:**

- 1) The Link feature on this D5x is only compatible with other ZiiSound D5x speakers and ZiiSound D5x wireless subwoofer.
- 2) Volume control, AUX-IN, CONNECT Touchpad and Volume Touchpad / Button operations are not available for the LEFT and CENTER Channels when the LINK is active.

## Section 3 : Switching between MULTI-CHANNEL and PARTY mode

### 3.1 To engage PARTY Mode

In PARTY mode, each individual speaker will broadcast its LEFT, RIGHT channels information from the RIGHT Master speaker. This switching feature can only be performed on the RIGHT Master speaker when in MULTI-CHANNEL mode.

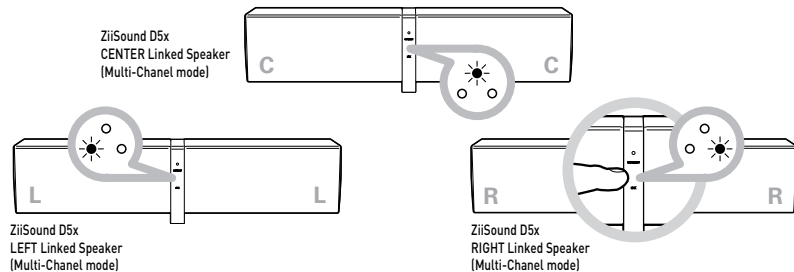

- A** Press and hold the LINK TouchPad / Button for 4 seconds and release on the RIGHT Master speaker. Now all LED on the LINK LED status indicator will light up, indicating they are in PARTY mode configuration.

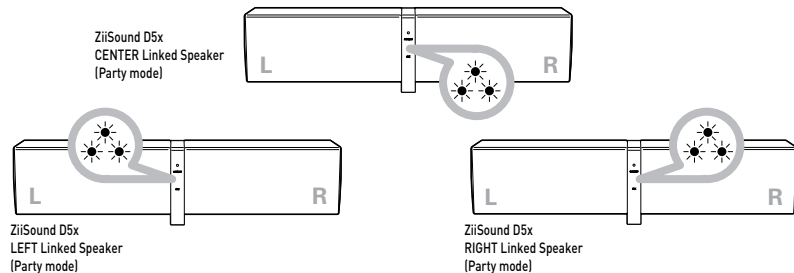

### 3.2 To engage MULTI CHANNEL Mode

In MULTI-CHANNEL mode, each individual speaker will play only its allocated channel information (eg LEFT, CENTER or RIGHT only) streamed from the RIGHT Master speaker. This switching feature can only be performed on the RIGHT Master speaker when in PARTY mode.

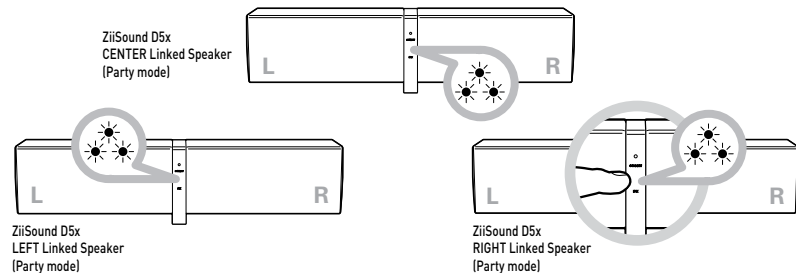

- A** Press and hold the LINK TouchPad / Button for 4 seconds and release on the RIGHT Master speaker. Now all LED on the LINK LED status indicator will disappear, only displaying their respective Channel LED indicator indicating they are in MULTI-CHANNEL mode.

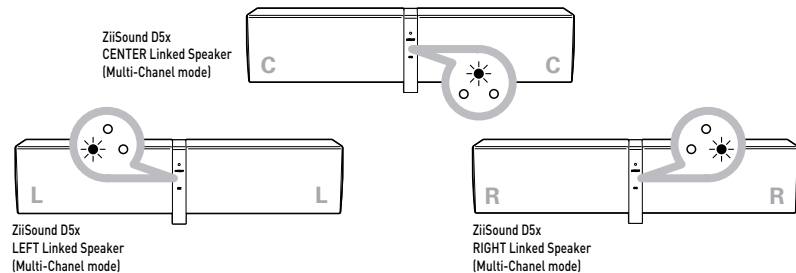

## Section 4 : Other speaker features

### 4.1 Returning to standby and Powering ON the D5x with active Links

#### A Returning to Standby

The Linked speakers can be brought to Standby in unison by pressing the Power ON/Standby Button located at the rear of the RIGHT Master speaker.

#### B Powering ON with active links

The Linked speaker can be Powered ON with active links to each other by pressing the Power ON/Standby Button of the RIGHT Master speaker with the mains powered ON on all the other speakers.\*

\*Powering ON with active links can only be done on the Master speaker as the slave speakers are listening to instructions from the Master speaker, even in standby.

### 4.2 Disabling / Restoring the link system for individual / Linked speaker usage (only for 2.0 and above setup)

#### A Disabling the LINK for individual D5x operation

You can disable the LINK connection to all the linked speakers by simply pressing the LINK Touchpad / Button once on the RIGHT Master speaker. This will bring down the LINK and restore the functions of the Volume control, AUX-IN, CONNECT Touchpad and Volume Touchpad / Button, which locked in link mode, back to each individual D5x. Once activated, there is no LED indication on the LINK LED status indicator for all D5x.

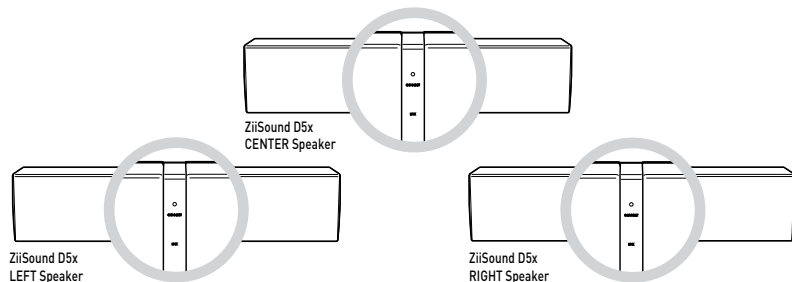

#### B Restoring LINK for linked speaker usage

To restore the LINK from the sets of individual speakers, you can Press the LINK Touchpad / Button once on either any of the speakers with all other D5x(s) and subwoofer Powered ON\*\*. This will result in restoring the state of the speakers shown by it LED indication in either Multi-channel or Party mode.

\*\* For the ZiiSound D5x, Powered ON is indicated with the Volume LED Status Indicator lit up.

### 4.3 Reset to factory setting

Follow these steps to return to factory settings to clear *Bluetooth* paired device memory and Link configurations in the ZiiSound D5x.

Action	LED status	Status
<b>Transmitter</b>		
Disconnect the Transmitter		
Press and hold the Pairing Button while inserting the Transmitter to iPhone/iPod and hold for 8 seconds	Transmitter LED fast blinks	Transmitter has been reset and is in pairing mode
<b>ZiiSound D5x</b>		
Return the speaker to Standby by pressing the Power ON/ Standby button. Press and hold Power button for 10 seconds.	CONNECT LED and LINK LED blinks twice and turns off. This indicates a successful Factory reset.	Powered On. Ready for next user action.

**Note:** The above can also be applied to LEFT and CENTER speaker to clear *Bluetooth* paired device memory and Link configurations should the need arise.

## Section 5 : Tips, Tricks and FAQ

Perform the following trouble-shooting steps before sending it for servicing.  
To download the user guide or find out more information about our product,  
please refer to [support.creative.com](http://support.creative.com)

### 5.1 Speaker FAQ

What are the indicators that indicate my ZiiSound D5x is Powered ON.

- A** For the master speaker, the Volume LED indicator are lit when the ZiiSound D5x is powered ON. This is the best indication your speaker is Powered ON.
- B** For the other linked speakers, press and hold the Power ON/Standby button for 4 seconds to initiate speaker identification mode. This will indicate what channel mode the speaker is in.

Is there any power saving features from the ZiiSound D5x?

Yes, the RIGHT Master speaker will enter standby automatically after more than 10 minutes of zero activity from both, the *Bluetooth\** and *AUX-IN\*\** sources. It will also instruct other speakers and subwoofer linked to the RIGHT master speaker to enter standby to save power.

\* Power saving mode only applicable when no *Bluetooth* connection is detected for 10 minutes.

\*\* Power saving mode only applicable when there is no audio on the *AUX-IN* input.

### 5.2 Bluetooth FAQ

There's no *Bluetooth* link between my device and the ZiiSound D5x. What should I do?

- Delete the ZiiSound D5x name entry from your *Bluetooth* device paired memory list and perform the steps in Section 1.5 [Enjoy audio from other *Bluetooth* devices] to re-pair your device with ZiiSound D5x
- Position them within 1 meter or closer to each other if you experience pairing difficulties
- Ensure that both your *Bluetooth* device and ZiiSound D5x are not connected to any other devices

**Bluetooth link is established and paired between the devices but there's no music. What should I do?**

With some built-in *Bluetooth* Stereo enabled computers, 3rd party USB *Bluetooth* dongles or other devices, you may be required to manually specify/ setup the audio output as ZiiSound D5x, e.g., (under sound and audio devices section on your computer's operating system) Please consult your manufacturer's documentation for further information

### 5.3 LINK Tips and Tricks

How to identify which speaker is the LEFT, CENTER, RIGHT speaker.

- Press and hold the Power ON/Standby button located at the rear of the speaker for 4 seconds. The Link LED indicator will blink its respective LED Channel it was configured for.

Link LED Status  
Indicator

(Slave)  
Left Speaker



(Slave/Master\*)  
Center Speaker



(Master)  
Right Speaker



Not Configured



**My LEFT and CENTER Channel D5x does not respond to my actions on either buttons or *Bluetooth* connections when they are in LINK mode.**

- This is normal. The D5x in slave mode does not respond to any button (except the Power ON/Standby to indicate the identity of the speaker via LED indication) as they are receiving cues from the RIGHT Master speaker. This includes *Bluetooth* connection, *AUX-IN* input and the Volume Touchpad.

**Can I add more speakers or remove speakers from a 2.1 Setup?**

Yes you can. However you would need to Factory Reset all the speakers and Subwoofer and reconfigure them again. Please refer to section **4.3. Reset to factory setting** and **section 2.1 or 2.2.** to reconfigure your system again. For operations on the ZiiSound DSx wireless subwoofer, please refer to its user manual for more information.

**I cannot re-connect my speakers together. All that is shown is all the LEDs blinking in unison and going off after 1 minute. What should I do?**

This is an error indicator to indicate that one of the links are not present in the defined previous setup. There are 2 ways to troubleshoot.

- a) Power ON all your speakers and press the LINK TouchPad / Button again to attempt to link the speakers together. Ensure that the Subwoofer have their mains Powered ON.
- b) Return to Factory default settings for all the speakers and wireless Subwoofer involved and re-link them again.

## Regulatory Information

The following sections contain notices for various countries:

**CAUTION:** This product is intended for use with FCC/CE certified computer equipment. Please check the equipment operating/installation manual and/or with the equipment manufacturer to verify/confirm if your equipment is suitable prior to the installation or use of the product.

### Federal Communication Commission (FCC) Interference Statement Notice for USA

**FCC Part 15:** This equipment has been tested and found to comply with the limits for a Class B digital device, pursuant to Part 15 of the FCC Rules. These limits are designed to provide reasonable protection against harmful interference in a residential installation. This equipment generates, uses and can radiate radio frequency energy and, if not installed and used in accordance with the instructions, may cause harmful interference to radio communications. However, there is no guarantee that interference will not occur in a particular installation. If this equipment does cause harmful interference to radio or television reception, which can be determined by turning the equipment off and on, the user is encouraged to try to correct the interference by one or more of the following measures:

- Reorient or relocate the receiving antenna.
- Increase the separation between the equipment and receiver.
- Connect the equipment into an outlet on a circuit different from that to which the receiver is connected.
- Consult the dealer or an experienced radio/TV technician for help.

### California Proposition 65 Statement

**WARNING:** Handling this product may expose you to chemicals known to the State of California to cause cancer and birth defects or other reproductive harm.

#### Wash hands after handling.

**Explanatory Note:** California Safe Drinking Water and Toxic Enforcement Act of 1986 (Proposition 65) requires special product labeling for products containing certain chemicals known to the State of California to cause cancer, birth defects or other reproductive harm. Creative has chosen to provide a warning based on its knowledge about the presence of one or more listed chemicals without

This device complies with part 15 of the FCC Rules. Operation is subject to the following two conditions:

1. This device may not cause harmful interference, and
2. This device must accept any interference received, including interference that may cause undesired operation.

**CAUTION:** To comply with the limits of the Class B digital device, pursuant to Part 15 of the FCC Rules, this device must be installed with computer equipment certified to comply with Class B limits.

All cables used to connect to the computer and peripherals must be shielded and grounded. Operation with non-certified computers or non-shielded cables may result in interference to radio or television reception.

**MODIFICATION:** Any changes or modifications not expressly approved by the grantee of this device could void the user's authority to operate the device.

### Federal Communication Commission (FCC) Radiation Exposure Statement (For Speaker MF8115)

This equipment complies with FCC radiation exposure limits set forth for an uncontrolled environment. This equipment should be installed and operated with minimum distance 20cm between the radiator & your body. This transmitter must not be co-located or operating in conjunction with any other antenna or transmitter.

\*Note: (For BT-D5 *Bluetooth* Transmitter MZ0450)

Power is so low that no RF exposure calculation is needed.

attempting to evaluate the level of exposure. With Creative's products, the exposure may be below the Proposition 65 level of concern, or could even be zero. However, out of an abundance of caution, Creative has elected to place the Proposition 65 warning on its products.

### Déclaration de la Proposition 65 de la Californie

**AVERTISSEMENT:** La manipulation de ce produit peut vous exposer à des produits chimiques qui sont reconnus par l'État de la Californie comme pouvant provoquer le cancer, des anomalies congénitales ou d'autres effets nuisibles à la reproduction.

**Veillez vous laver les mains après l'avoir manipulé.**

**Note explicative:** La Proposition 65 (California Safe Drinking Water and Toxic Enforcement Act of 1986) de la Californie sur les matières dangereuses et l'eau potable exige un étiquetage spécial pour les produits contenant certains produits chimiques qui sont reconnus par l'État de la Californie comme pouvant provoquer le cancer, des anomalies congénitales ou d'autres effets nuisibles à la reproduction. Creative a choisi d'inclure une mise en garde s'appuyant sur sa connaissance de la présence d'un ou de plusieurs de ces produits chimiques sans essayer d'en évaluer le niveau d'exposition. Pour les produits de Creative, le niveau d'exposition peut être inférieur au niveau critique établi par la Proposition 65 ou même être nul. Néanmoins, par souci extrême de prudence, Creative a choisi de placer l'avertissement de la Proposition 65 sur ses produits.

### Notice for Canada

This Class B digital apparatus complies with Canadian ICES-003 and RSS-210.

Cet appareil numérique de classe B est conforme aux normes canadiennes NMB-003 et CNR-210.

This device complies with Industry Canada licence-exempt RSS standard.

Operation is subject to the following two conditions:

- (1) This device may not cause harmful interference, and
- (2) this device must accept any interference received, including interference that may cause undesirable operation.

Cet appareil est conforme avec Industrie Canada RSS standard exempts de licence.

Son Fonctionnement est soumis aux deux conditions suivantes :

- (1) Le matériel ne peut être source D'interférences et
- (2) Doit accepter toutes les interférences reques, Y compris celles pouvant provoquer un fonctionnement indésirable.

**CANADIAN CLASS B STATEMENT:** This digital device does not exceed the Class B limits for radio noise emissions from digital apparatus as set out in the interference-causing equipment standard entitled "Digital Apparatus," ICES-003 of the Department of Communications.

Cet appareil numérique respecte les limites de bruits radioélectriques applicables aux appareils numériques de Classe B prescrites dans la norme sur le matériel brouilleur: "Appareils Numériques," NMB-003 édictée par le ministre des Communications.

**MODIFICATION:** Any changes or modifications not expressly approved by the grantee of this device could void the user's authority to operate the device.

Toute modification non approuvée explicitement par le fournisseur de licence de l'appareil peut entraîner l'annulation du droit de l'utilisateur à utiliser l'appareil.

## DECLARATION OF CONFORMITY

Manufacturer / Importer's Name :

**Creative Labs, Inc.**

Manufacturer / Importer's Address :

**1901 McCarthy Boulevard Milpitas,  
CA. 95035 United States  
Tel: (408) 428-6600**

declares under its sole responsibility that the product

Trade Name : **ZiiSound**  
Model Numbers : **MF8115**

has been tested accordingly to the FCC/CISPR22 requirement for class B devices and found compliant with the following standards:

EMI/EMC: ANSI C63.4, FCC Part 15 Subpart B & C  
Complies with Canadian ICES-003 Class B & RSS-210 Standards

This device complies with part 15 of the FCC Rules. Operation is subject to the following two conditions:

1. This device may not cause harmful interference, and
2. This device must accept any interference received, including interference that may cause undesirable operation.

Ce matériel est conforme à la section 15 des règles FCC. Son Fonctionnement est soumis aux deux conditions suivantes:

1. Le matériel ne peut être source D'interférences et
2. Doit accepter toutes les interférences reques, Y compris celles pouvant provoquer un fonctionnement indésirable.

**Compliance Manager  
Creative Labs, Inc.  
June 1, 2011**

## Notice for Taiwan

### 敬告使用者:

1. 本產品使用時,不致造成違反低功率電波輻射性電機管理辦法之控制、調整及開關之使用方法。
2. 本產品不得任意調整更改各項零件或對於發射之功率影響之作為,若有操作問題請與本公司人員聯繫;並由本公司負起監督及維修之責任。
3. 根據交通部低功率電波輻射性電機管理辦法規定:

### 第十二條

經型式認證合格之低功率射頻電機,非經許可,公司、商號或使用者均不得擅自變更頻率、加大功率或變更原設計之特性及功能。

### 第十四條

低功率射頻電機之使用不得影響飛航安全及干擾合法通信;經發現有干擾現象時,應立即停用,並改善至無干擾時方得繼續使用。

前項合法通信,指依電信法規定作業之無線電通信。

低功率射頻電機須忍受合法通信或工業、科學及醫療用電波輻射性電機設備之干擾。

## Notice for Korea

### Safety information

### B급 기기 (가정용 방송통신기자재)

### Class B Equipment

[For Home Use Broadcasting & Communication Equipment]

이 기기는 가정용(B급) 전자파적합기기로서 주로 가정에서 사용하는 것을 목적으로 하며, 모든 지역에서 사용할 수 있습니다.

This equipment is home use [Class B] electromagnetic wave suitability equipment and to be used mainly at home and it can be used in all areas.

## Notice for Singapore

Complies with  
IDA Standards  
DB00148

## Notice for Australia/New Zealand



This product complies with the requirements of the ACMA  
Radiocommunications [Electromagnetic Compatibility] Standard 2008.