

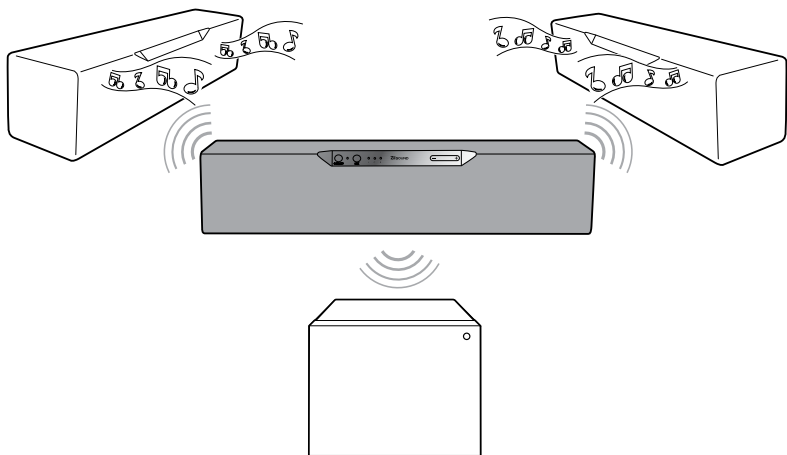

Model No./ 型号: MF8120

**Congratulations on purchasing the ZiiSound D3x, the modular wireless speaker system that you will ever need. Get ready to experience a whole new definition of audio nirvana with one or more D3x or DSx wireless subwoofer linked together for dynamics rivalling the very best in home audio set-ups.**



*Additional ZiiSound D3x and ZiiSound DSx shown here and throughout the user manual are for illustration purposes only. Sold separately. Not included.*



For detailed product information, instructions or to find out more about our speakers, visit [www.creative.com/speakers](http://www.creative.com/speakers)

### **Safety Instruction**

Please read the following before using the Creative Products:

- Use a mains plug that is appropriate for your country or region.
- To be completely disconnected from the power input, the mains plug has to be disconnected /detached from the mains.
- Disconnect the mains plug when the device is expected to be unused for several days.

Additional guidelines for wireless devices

- The short wave radio frequency signals of a wireless device may impair the operation of other electronic and medical devices
- Switch off the device where it is prohibited. Do not use the device in medical facilities, aircraft, refueling points, close to automatic doors, automatic fire alarms or other automatically controlled devices
- Keep this device at least 20 cm from pacemakers and other medical devices. Radio waves may impair the operation of pacemakers and other medical devices

## Technical Specifications

- *Bluetooth*® Version : *Bluetooth 2.1 + EDR (Enhanced Data Rate)*
- *Bluetooth* Operating Frequency : 2402 - 2480 MHz
- Supported *Bluetooth* profiles\* : A2DP (Wireless Stereo *Bluetooth*)  
: AVRCP (*Bluetooth* Remote Control)
- Operating Range for *Bluetooth* : Up to 10 meters (*Measured in open space.*  
*Walls and structures may affect range of device.*)
- Operating Range for Wireless Link : Up to 30 meters (*Measured in open space.*  
*Walls and structures may affect range of device.*)
- Wireless Link Operating Frequency : 5725 - 5850 MHz
- Device Operating Temperature range : 0°C to 45°C
- Power Adapter Operating Temperature range : 0°C to 40°C

**These specifications apply to the ZiiSound D3x operating from the supplied 14V DC 1.9A universal power adapter.**

**Note: Compliance markings are located on the bottom of this product.**

## Compatibility Disclaimer

- Wireless performance is dependent on your device's *Bluetooth* wireless technology. Refer to your device manufacturer's manual.
- Every electronic device is subjected to radio frequency (RF) interference from external sources. These include the connection between linked ZiiSound D3x and ZiiSound DSx wireless subwoofer.
- Creative will not be liable for any loss of data or leakage resulting from the use of these devices.

## Notes

\* Refer to your *Bluetooth* device (notebook<sup>1</sup>, PC<sup>1</sup>, mobile device<sup>2</sup>) manufacturer's documentation /website for supported profiles.

<sup>1</sup> Compatible with PC (Windows XP/Vista/7), Apple Macintosh computers equipped with *Bluetooth* wireless stereo

<sup>2</sup> Compatible with most major brands of *Bluetooth* A2DP enabled mobile phones. (including iPhone<sup>3</sup>, Windows Mobile)

<sup>3</sup> Original iPhone built in *Bluetooth* not supported

## Section 1 : D3x Basic operations

### 1.1 Product Overview / Connectivity Diagram

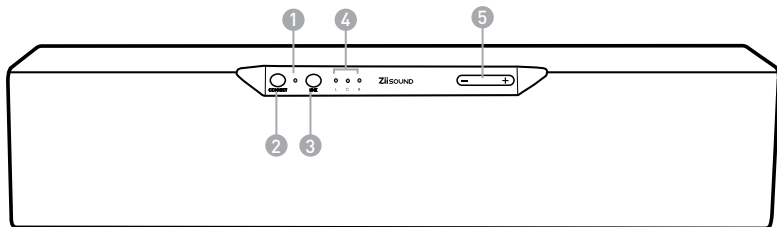

1 CONNECT LED Status Indicator

Pairing



Rapid blinking LED

Bluetooth Connected



Steady Lit

2 CONNECT Button

For various *Bluetooth* Pairing activities

3 LINK Button

For various speakers linking activities

4 LINK LED Status Indicator

(Slave) Left Speaker



L C R

(Slave/Master\*) Center Speaker



L C R

(Master) Right Speaker



L C R

Link discoverable mode



Rapid blinking LED

5 Volume Button and Volume Led Status Indicator

\* For a 1.1 setup, the ZiiSound D3x will light up the Center Speaker LED to indicate it is connected in a 1.1 setup.

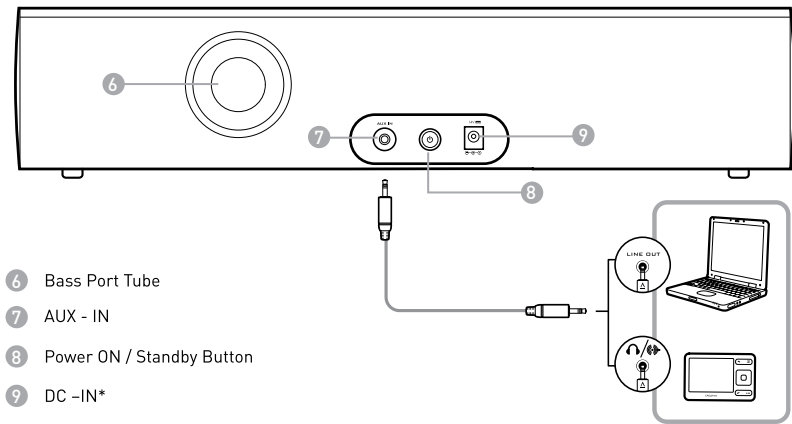
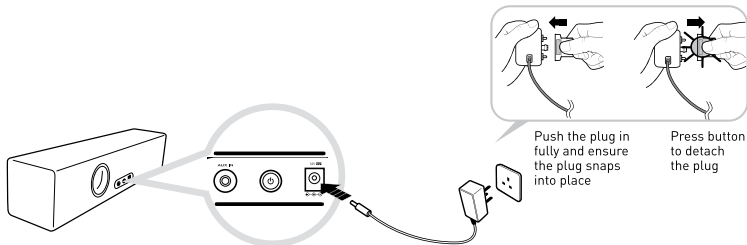

\* All LEDs will light up for a few seconds when the mains are applied to the D3x. This is normal.

## 1.2 Enjoy audio from Stereo *Bluetooth* devices

Enjoy your favourite music from other *Bluetooth* devices by following these steps to connect them.

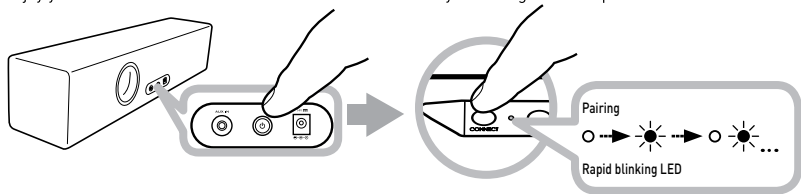

- A** Ensure the speaker is powered ON. Press and hold the “CONNECT Button” for 5 seconds. Release when the CONNECT LED blinks once.

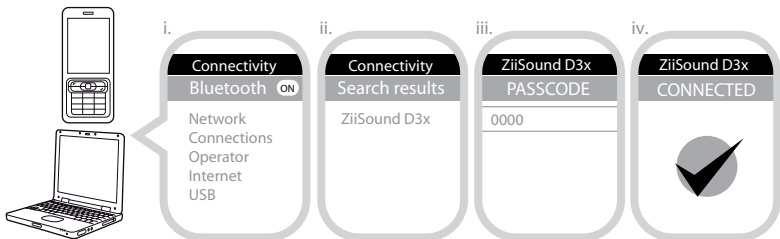

- B**
- Turn on the *Bluetooth* feature on your device
  - Search for ZiiSound D3x<sup>#</sup>
  - Pair and connect to ZiiSound D3x<sup>#</sup>, if prompted for passcode, enter 0000.
  - Pairing successful, ready to stream music

**Note:** The above are generic steps to pair a *Bluetooth* device, for more specific instruction on *Bluetooth* connectivity for your device, please consult your manufacturer’s manual.

<sup>#</sup> When pairing a *Bluetooth* device to a Linked speaker system in 1.1, 2.1 or 3.1 configuration, the Linked speaker system will appear as “ZiiSound D3x System”

## 1.3 Switching between paired devices

Enjoy your favourite music from another paired *Bluetooth* device by following these steps to establish the connection.

Action	LED status	Status
–	–	Ensure that the next previously paired device has <i>Bluetooth</i> powered on and ready to accept connection
Press "CONNECT Button" once	CONNECT LED blinks and stays lit	<i>Bluetooth</i> connection switches. Ready to stream music.

## Section 2 : Linking with another ZiiSound D3x or DSx Wireless subwoofer

### 2.1 Adding a subwoofer to the D3x to form a 1.1 speaker system

- A Note:** It is necessary to clear the memory of linked speakers (all D3x(s) and DSx) should you require to configure a new setup. (For example, adding another D3x or DSx)

Proceed to Step (B) if your D3x or DSx have not been linked with other speaker before.

If your D3x or DSx have been linked before, follow the instruction below to clear link system memory to reconfigure a new speaker setup.

#### For the D3x(s)

Ensure the speaker is in standby mode. Press and hold the Power ON/Standby button located at the rear of the speaker until LINK and CONNECT LED blinks 2 times and goes off. The D3x Link memory has been cleared.

#### For the DSx

Press and hold the LINK Button located at the rear of the subwoofer for 10 seconds until the Link LED blinks 2 times and goes off. The DSx Link memory has been cleared.



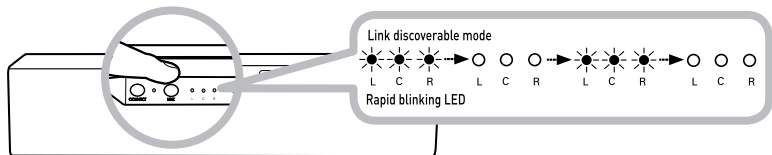

- B** Ensure your ZiiSound D3x is powered ON. Press and hold the LINK Button for 5 seconds and release when the Link LED blinks once. The D3x is now in Link discoverable mode.

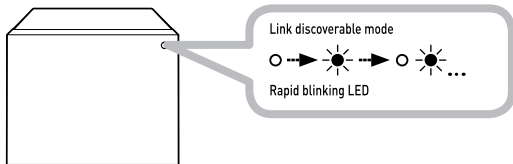

- C** Activate LINK discoverable mode on the ZiiSound DSx wireless subwoofer by holding the Link button for 4 seconds and releasing when the Link LED blinks once. For more details, refer to the ZiiSound DSx manual.

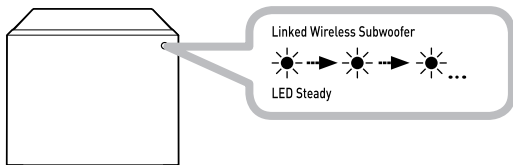

- D** The ZiiSound DSx are linked when the LED status indicator on the DSx are Lit Steady.

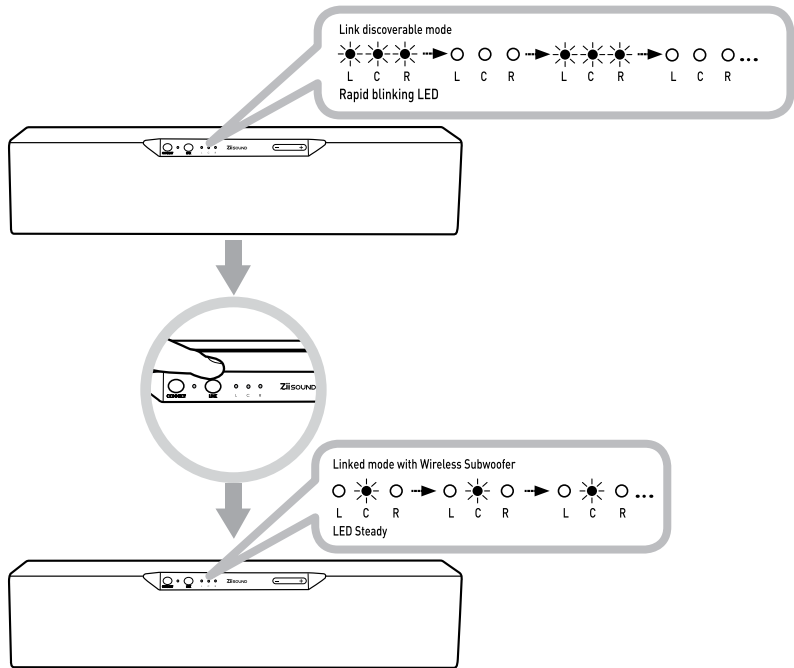

- E** If the ZiiSound D3x LINK LED is still Rapidly Blinking, Press the LINK Button once to stop or wait for it to timeout. Link establishment complete. Ready to Stream music.

## 2.2 Adding one or more ZiiSound D3x and DSx wireless subwoofer to form a 2.1 or 3.1 speaker system

- A Note:** It is necessary to clear the memory of linked speakers (all D3x(s) and DSx) should you require to configure a new setup. (For example, adding another D3x or DSx)

Proceed to Step (B) if your D3x or DSx have not been linked with other speaker before.

If your D3x or DSx have been linked before, follow the instruction below to clear link system memory to reconfigure a new speaker setup.

### For the D3x(s)

Ensure the speaker is in standby mode. Press and hold the Power ON/Standby button located at the rear of the speaker until LINK and CONNECT LED blinks 2 times and goes off. The D3x Link memory has been cleared.

### For the DSx

Press and hold the LINK Button located at the rear of the subwoofer for 10 seconds until the Link LED blinks 2 times and goes off. The DSx Link memory has been cleared.

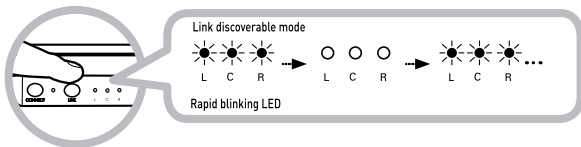

- B** Pick one ZiiSound D3x as your master speaker and ensure it is powered ON. Press and hold the LINK Button for 5 seconds and release when the LINK LED blinks once. The D3x is now in LINK discoverable mode and will be your RIGHT Channel Speaker.

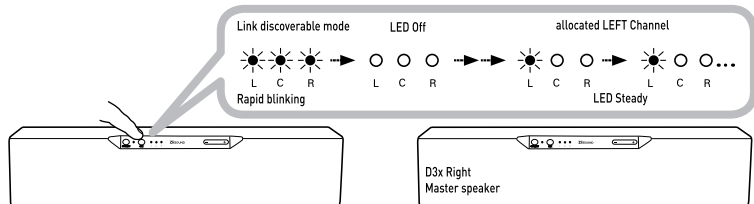
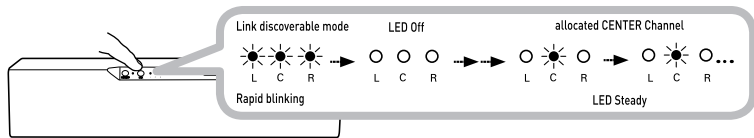

- C** Power ON another D3x. Press and hold the LINK Button for 5 seconds and release when the LINK LED blinks once. The LINK LED will blink until it stays lit up to indicate which channel the speaker is linked for, Repeat for another D3x to form a 3.1 setup.

The Speakers will automatically be allocated as LEFT, then CENTER channels by order of the activation of their Link Discoverable mode.

**Note:**

Whenever a new speaker is added to the RIGHT Channel Master speaker, the LINK discoverable mode for the Master speaker extends for another 1 minute for other speakers to link in.

To cancel Link discoverable mode, press the LINK Button once while the speakers / Subwoofer are still in Link discoverable mode.

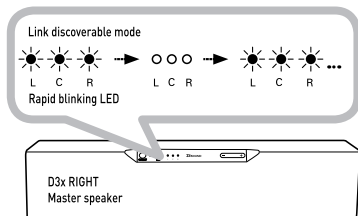
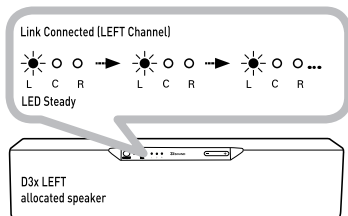
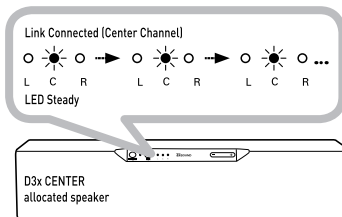

- D** LEFT and CENTER speakers are Linked when the LINK LED Status indicator of the LEFT and CENTER channel speakers shows their respective LEFT and CENTER LED Lit on its LINK LED.

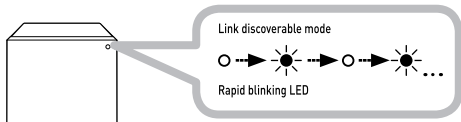

**E** Jump to step **G** should no wireless subwoofer are required to be linked.

Set the ZiiSound DSx wireless subwoofer to LINK Discoverable mode by holding the Link button for 4 second and releasing when the LINK LED blinks once. For detailed instructions, refer to the ZiiSound DSx User manual. The Master D3x speaker will automatically connect the DSx wireless subwoofer while the D3x LINK LED is still rapidly blinking.

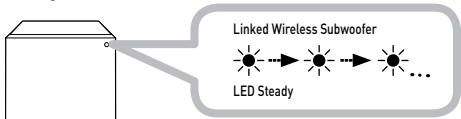

**F** The ZiiSound DSx are linked when the LED status indicator on the DSx are Lit Steady.

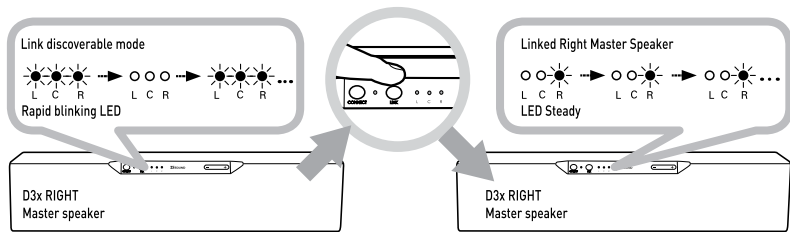

**G** If the ZiiSound D3x (Right Channel) Master speaker LINK LED is still Rapidly Blinking, Press the LINK Button once to stop or wait for it to timeout. The speakers are now in Multi Channel mode. Link establishment complete. Ready to Stream music.

**Note:**

- 1) The Link feature on this D3x is only compatible with other ZiiSound D3x speakers and ZiiSound DSx wireless subwoofer.
- 2) Volume control, AUX-IN, CONNECT and Volume Button operations are not available for the LEFT and CENTER Channels when the LINK is active.

## Section 3 : Switching between MULTI-CHANNEL and PARTY mode

### 3.1 To engage PARTY Mode

In PARTY mode, each individual speaker will broadcast its LEFT, RIGHT channels information from the RIGHT Master speaker. This switching feature can only be performed on the RIGHT Master speaker when in MULTI-CHANNEL mode.

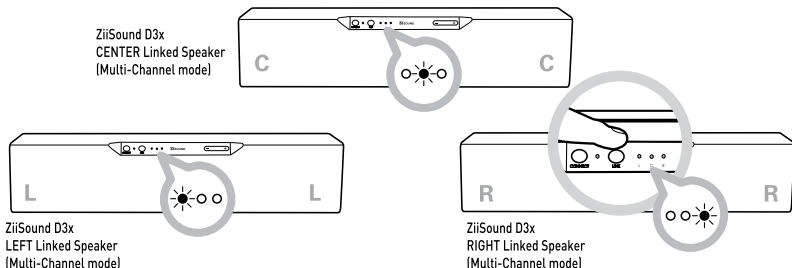

- A** Press and hold the LINK Button for 5 seconds and release when the LINK LED blinks once on the RIGHT Master speaker. Now all LED on the LINK LED status indicator will light up, indicating they are in PARTY mode configuration.

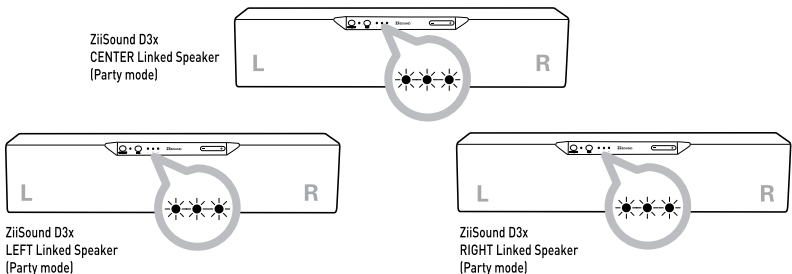

### 3.2 To engage MULTI CHANNEL Mode

In MULTI-CHANNEL mode, each individual speaker will play only its allocated channel information (eg LEFT, CENTER or RIGHT only) streamed from the RIGHT Master speaker. This switching feature can only be performed on the RIGHT Master speaker when in PARTY mode.

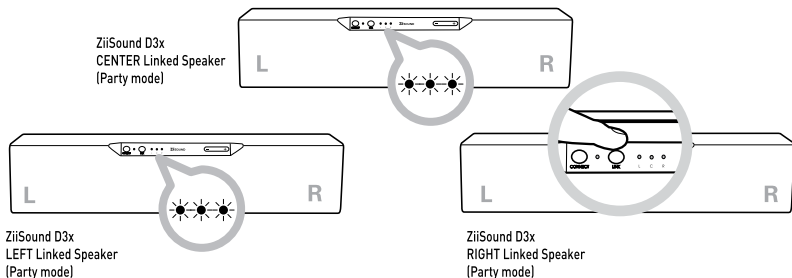

- A** Press and hold the LINK Button for 5 seconds and release when the LINK LED blinks only on the RIGHT Master speaker. Now all LED on the LINK LED status indicator will disappear, only displaying their respective Channel LED indicator indicating they are in MULTI-CHANNEL mode.

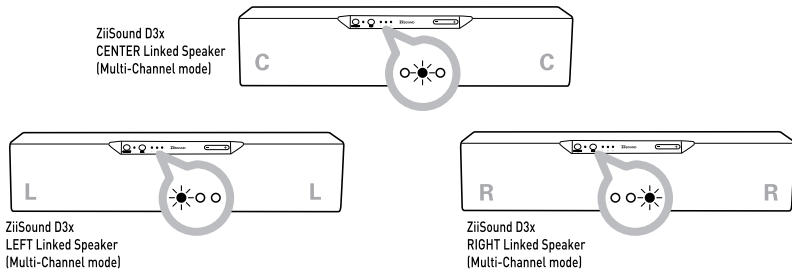



## Section 4 : Other speaker features

### 4.1 Returning to standby and Powering ON the D3x with active Links

#### A Returning to Standby

The Linked speakers can be brought to Standby in unison by pressing the Power ON/Standby Button located at the rear of the RIGHT Master speaker.

#### B Powering ON with active links

The Linked speaker can be Powered ON with active links to each other by pressing the Power ON/Standby Button of the RIGHT Master speaker with the mains powered ON on all the other speakers.\*

\*Powering ON with active links can only be done on the Master speaker as the slave speakers are listening to instructions from the Master speaker, even in standby.

### 4.2 Disabling / Restoring the link system for Standalone / Linked speaker usage (only for 2.0 and above setup)

#### A Disabling the LINK for individual D3x operation

You can disable the LINK connection to all the linked speakers by simply pressing the LINK Button once on the RIGHT Master speaker. This will bring down the LINK and restore the functions of the AUX-IN, CONNECT and Volume Button, which locked in link mode, back to each individual D3x. Once activated, there is no LED indication on the LINK LED status indicator for all D3x.

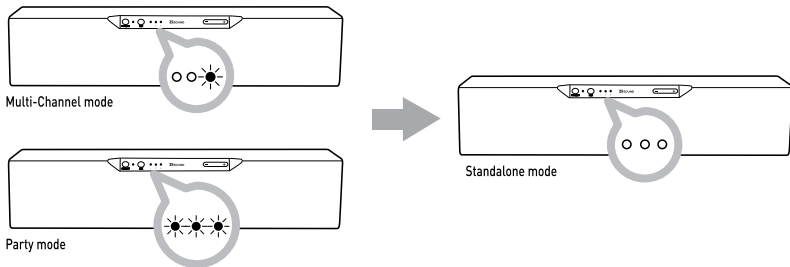

## **B Restoring LINK for linked speaker usage**

To restore the LINK from the sets of individual speakers, you can Press the LINK Button once on either any of the speakers with all other D3x(s) and subwoofer Powered ON\*\*. This will result in restoring the state of the speakers shown by it LED indication in either Multi-channel or Party mode.

\*\* For the ZiiSound D3x, Powered ON is indicated with the Volume LED Status Indicator lit up.

### **4.3 Reset to factory setting / clear LINK system**

Follow these steps to return to factory settings all D3x(s) to clear *Bluetooth* paired device memory and LINK system when a change of speaker configuration is required.  
(For example, linking additional D3x or DSx)

Action	LED status	Status
<b>ZiiSound D3x</b>		
Return the speaker to Standby by pressing the Power ON/ Standby button. Press and hold Power button for 10 seconds.	CONNECT LED and LINK LED blinks twice and turns off. This indicates a successful Factory reset.	Powered On. Speaker Bluetooth device list and Link system memory cleared. Ready for next user action

**Note:** The above can also be applied to LEFT and CENTER speaker to clear *Bluetooth* paired device memory and Link configurations should the need arise.

## Section 5 : Tips, Tricks and FAQ

Perform the following trouble-shooting steps before sending it for servicing.  
To download the user guide or find out more information about our product,  
please refer to [support.creative.com](http://support.creative.com)

### 5.1 Speaker FAQ

**What are the indicators that indicate my ZiiSound D3x is Powered ON.**

- A** For the master speaker, the Volume LED indicator are lit when the ZiiSound D3x is powered ON. This is the best indication your speaker is Powered ON.
- B** For the other linked speakers, press and hold the Power ON/Standby button to initiate speaker identification mode. This will indicate what channel mode the speaker is in.

**Is there any power saving features from the ZiiSound D3x?**

Yes, the RIGHT Master speaker will enter standby automatically after more than 10 minutes of zero activity from both, the *Bluetooth\** and *AUX-IN\*\** sources. It will also instruct other speakers and subwoofer linked to the RIGHT master speaker to enter standby to save power.

\* Power saving mode only applicable when no *Bluetooth* connection is detected for 10 minutes.

\*\* Power saving mode only applicable when there is no audio on the AUX-IN input.

### 5.2 Bluetooth FAQ

**There's no *Bluetooth* link between my device and the ZiiSound D3x. What should I do?**

- Delete the ZiiSound D3x or ZiiSound D3x System name entry from your *Bluetooth* device paired memory list and perform the steps in Section 1.2 (Enjoy audio from Stereo *Bluetooth* devices) to re-pair your device with ZiiSound D3x
- Position them within 1 meter or closer to each other if you experience pairing difficulties
- Ensure that both your *Bluetooth* device and ZiiSound D3x are not connected to any other devices

***Bluetooth* link is established and paired between the devices but there's no music. What should I do?**

With some built-in *Bluetooth* Stereo enabled computers, 3rd party USB *Bluetooth* dongles or other devices, you may be required to manually specify/ setup the audio output as ZiiSound D3x, e.g., (under sound and audio devices section on your computer's operating system) Please consult your manufacturer's documentation for further information

## 5.3 LINK Tips and Tricks

### How to identify which speaker is the LEFT, CENTER, RIGHT speaker.

- Press and hold the Power ON/Standby button located at the rear of the speaker. The Link LED indicator will light its respective LED Channel it was configured for.

Link LED Status  
Indicator

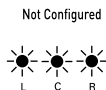

### My LEFT and CENTER Channel D3x does not respond to my actions on either buttons or *Bluetooth* connections when they are in LINK mode.

- This is normal. The D3x in slave mode does not respond to any button (except the Power ON/Standby to indicate the identity of the speaker via LED indication) as they are receiving cues from the RIGHT Master speaker. This includes *Bluetooth* connection, AUX-IN input and Volume control.

### Can I add more speakers or remove speakers from a 2.1 Setup?

Yes you can. However you would need to clear the LINK system on all the speakers and subwoofer and re-link them again. Please refer to section 4.3 Reset to factory setting / clear LINK System and section 2.1 or 2.2 to reconfigure your system again. For operations on the ZiiSound DSx wireless subwoofer, please refer to its user manual for more information.

### I cannot re-connect my speakers together. All that is shown is all the LEDs blinking in unison and going off after 1 minute. What should I do?

This is an error indicator to indicate that one of the links are not present in the defined previous setup. There are 2 ways to troubleshoot.

- a) Power ON all your speakers and press the LINK Button again to attempt to link the speakers together. Ensure that the Subwoofer have their mains Powered ON.
- b) Return to factory default settings to clear LINK system configuration for all your speakers and subwoofer involved and re-link them again.

## Regulatory Information

The following sections contain notices for various countries:

**CAUTION:** This product is intended for use with FCC/CE certified computer equipment. Please check the equipment operating/installation manual and/or with the equipment manufacturer to verify/confirm if your equipment is suitable prior to the installation or use of the product.

### Federal Communication Commission (FCC) Interference Statement

#### Notice for USA

**FCC Part 15:** This equipment has been tested and found to comply with the limits for a Class B digital device, pursuant to Part 15 of the FCC Rules. These limits are designed to provide reasonable protection against harmful interference in a residential installation. This equipment generates, uses and can radiate radio frequency energy and, if not installed and used in accordance with the instructions, may cause harmful interference to radio communications. However, there is no guarantee that interference will not occur in a particular installation. If this equipment does cause harmful interference to radio or television reception, which can be determined by turning the equipment off and on, the user is encouraged to try to correct the interference by one or more of the following measures:

- Reorient or relocate the receiving antenna.
- Increase the separation between the equipment and receiver.
- Connect the equipment into an outlet on a circuit different from that to which the receiver is connected.
- Consult the dealer or an experienced radio/TV technician for help.

### California Proposition 65 Statement

**WARNING:** Handling this product may expose you to chemicals known to the State of California to cause cancer and birth defects or other reproductive harm.

*Wash hands after handling.*

Explanatory Note: California Safe Drinking Water and Toxic Enforcement Act of 1986 (Proposition 65) requires special product labeling for products containing certain chemicals known to the State of California to cause cancer, birth defects or other reproductive harm. Creative has chosen to provide a warning based on its knowledge about the presence of one or more listed chemicals without

This device complies with part 15 of the FCC Rules. Operation is subject to the following two conditions:

1. This device may not cause harmful interference, and
2. This device must accept any interference received, including interference that may cause undesired operation.

**CAUTION:** To comply with the limits of the Class B digital device, pursuant to Part 15 of the FCC Rules, this device must be installed with computer equipment certified to comply with Class B limits.

All cables used to connect to the computer and peripherals must be shielded and grounded. Operation with non-certified computers or non-shielded cables may result in interference to radio or television reception.

**MODIFICATION:** Any changes or modifications not expressly approved by the grantee of this device could void the user's authority to operate the device.

### Federal Communication Commission (FCC) Radiation Exposure Statement

This equipment complies with FCC radiation exposure limits set forth for an uncontrolled environment. This equipment should be installed and operated with minimum distance 20cm between the radiator & your body. This transmitter must not be co-located or operating in conjunction with any other antenna or transmitter.

attempting to evaluate the level of exposure. With Creative's products, the exposure may be below the Proposition 65 level of concern, or could even be zero. However, out of an abundance of caution, Creative has elected to place the Proposition 65 warning on its products.

Déclaration de la Proposition 65 de la Californie

**AVERTISSEMENT:** La manipulation de ce produit peut vous exposer à des produits chimiques qui sont reconnus par l'État de la Californie comme pouvant provoquer le cancer, des anomalies congénitales ou d'autres effets nuisibles à la reproduction.

*Veillez vous laver les mains après l'avoir manipuler.*

Note explicative: La Proposition 65 (California Safe Drinking Water and Toxic Enforcement Act of 1986) de la Californie sur les matières dangereuses et l'eau potable exige un étiquetage spécial pour les produits contenant certains produits chimiques qui sont reconnus par l'État de la Californie comme pouvant provoquer le cancer, des anomalies congénitales ou d'autres effets nuisibles à la reproduction. Creative a choisi d'inclure une mise en garde s'appuyant sur sa connaissance de la présence d'un ou de plusieurs de ces produits chimiques sans essayer d'en évaluer le niveau d'exposition. Pour les produits de Creative, le niveau d'exposition peut être inférieur au niveau critique établi par la Proposition 65 ou même être nul. Néanmoins, par souci extrême de prudence, Creative a choisi de placer l'avertissement de la Proposition 65 sur ses produits.

Notice for Canada

This Class B digital apparatus complies with Canadian ICES-003 and RSS-210.

Cet appareil numérique de classe B est conforme aux normes canadiennes NMB-003 et CNR-210.

This device complies with Industry Canada licence-exempt RSS standard.

Operation is subject to the following two conditions:

- (1) This device may not cause harmful interference, and
- (2) this device must accept any interference received, including interference that may cause undesirable operation.

Cet appareil est conforme avec Industrie Canada RSS standard exempts de licence.

Son Fonctionnement est soumis aux deux conditions suivantes :

- (1) Le matériel ne peut être source D'interférences et
- (2) Doit accepter toutes les interférences reques, Y compris celles pouvant provoquer un fonctionnement indésirable.

CANADIAN CLASS B STATEMENT: This digital device does not exceed the Class B limits for radio noise emissions from digital apparatus as set out in the interference-causing equipment standard entitled "Digital Apparatus," ICES-003 of the Department of Communications.

Cet appareil numérique respecte les limites de bruits radioélectriques applicables aux appareils numériques de Classe B prescrites dans la norme sur le matériel brouilleur: "Appareils Numériques," NMB-003 edictée par le ministre des Communications.

MODIFICATION: Any changes or modifications not expressly approved by the grantee of this device could void the user's authority to operate the device.

Toute modification non approuvée explicitement par le fournisseur de licence de l'appareil peut entraîner l'annulation du droit de l'utilisateur à utiliser l'appareil.

## DECLARATION OF CONFORMITY

Manufacturer / Importer's Name :

**Creative Labs, Inc.**

Manufacturer / Importer's Address :

**1901 McCarthy Boulevard Milpitas,  
CA. 95035 United States  
Tel: (408) 428-6600**

declares under its sole responsibility that the product

Trade Name : **ZiiSound**

Model Numbers : **MF8120**

has been tested accordingly to the FCC/CISPR22 requirement for class B devices and found compliant with the following standards:

EMI/EMC: ANSI C63.4, FCC Part 15 Subpart B & C  
Complies with Canadian ICES-003 Class B & RSS-210 Standards

This device complies with part 15 of the FCC Rules. Operation is subject to the following two conditions:

1. This device may not cause harmful interference, and
2. This device must accept any interference received, including interference that may cause undesirable operation.

Ce matériel est conforme à la section 15 des règles FCC. Son Fonctionnement est soumis aux deux conditions suivantes:

1. Le matériel ne peut être source D'interférences et
2. Doit accepter toutes les interférences reques, Y compris celles pouvant provoquer un fonctionnement indésirable.

**Compliance Manager  
Creative Labs, Inc.  
August 18, 2011**

## Notice for Taiwan

敬告使用者:

1. 本產品使用時,不致造成違反低功率電波輻射性電機管理辦法之控制、調整及開關之使用方法。
2. 本產品不得任意調整更改各項零件或對於發射之功率影響之作為,若有操作問題請與本公司人員聯繫;並由本公司負起監督及維修之責任。
3. 根據交通部低功率電波輻射性電機管理辦法規定:

### 第十二條

經型式認證合格之低功率射頻電機,非經許可,公司、商號或使用者均不得擅自變更頻率、加大功率或變更原設計之特性及功能。

### 第十四條

低功率射頻電機之使用不得影響飛航安全及干擾合法通信;經發現有干擾現象時,應立即停用,並改善至無干擾時方得繼續使用。

前項合法通信,指依電信法規定作業之無線電通信。

低功率射頻電機須忍受合法通信或工業、科學及醫療用電波輻射性電機設備之干擾。

## Notice for Korea

Safety information

B급 기기

(가정용 방송통신기자재)

Class B Equipment

[For Home Use Broadcasting & Communication Equipment]

이 기기는 가정용(B급) 전자파적합기기로서 주로 가정에서 사용하는 것을 목적으로 하며, 모든 지역에서 사용할 수 있습니다.

This equipment is home use [Class B] electromagnetic wave suitability equipment and to be used mainly at home and it can be used in all areas.

## Notice for Singapore

Complies with  
IDA Standards  
DB00148

## Notice for Australia/New Zealand



This product complies with the requirements of the ACMA Radiocommunications [Electromagnetic Compatibility] Standard 2008.

CREATIVE®

© 2011 Creative Technology Ltd. All rights reserved. Creative, the Creative logo, Zii and ZiiSound are trademarks or registered trademarks of Creative Technology Ltd in the United States and/or other countries. The *Bluetooth*® word mark and logo are owned by the Bluetooth SIG, Inc. and any use of such marks by Creative Technology Ltd is under license. apt-X is a registered trademark of APT licensing Ltd. All other trademarks are the property of their respective owners and are hereby recognized as such. All specifications are subject to change without notice. Actual product may differ slightly from images shown.