

## Safety And Regulatory Information

### Safety & Regulatory Information

The following sections contain notices for various countries:

#### Caution

This product is intended for use with FCC/CE certified computer equipment. Please check the equipment operating/installation manual and/or with the equipment manufacturer to verify/confirm if your equipment is suitable prior to the installation or use of the product.

#### Notice for USA

FCC Part 15: This equipment has been tested and found to comply with the limits for a Class B digital device, pursuant to Part 15 of the FCC Rules. These limits are designed to provide reasonable protection against harmful interference in a residential installation. This equipment generates, uses and can radiate radio frequency energy and, if not installed and used in accordance with the instructions, may cause harmful interference to radio communications. However, there is no guarantee that interference will not occur in a particular installation. If this equipment does cause harmful interference to radio or television reception, which can be determined by turning the equipment off and on, the user is encouraged to try to correct the interference by one or more of the following measures:

- Reorient or relocate the receiving antenna.
- Increase the separation between the equipment and receiver.
- Connect the equipment into an outlet on a circuit different from that to which the receiver is connected.
- Consult the dealer or an experienced radio/TV technician for help.

This device complies with part 15 of the FCC Rules. Operation is subject to the following two conditions:

1. This device may not cause harmful interference, and
2. This device must accept any interference received, including interference that may cause undesired operation.

#### Caution

To comply with the limits of the Class B digital device, pursuant to Part 15 of the FCC Rules, this device must be installed with computer equipment certified to comply with Class B limits.

All cables used to connect to the computer and peripherals must be shielded and grounded. Operation with non-certified computers or non-shielded cables may result in interference to radio or television reception.

#### Modification

Any changes or modifications not expressly approved by the grantee of this device could void the user's authority to operate the device.

#### State of California Proposition 65:

WARNING: Handling the cord(s) on this product may expose you to lead, a chemical known to the State of California to cause cancer and birth defects or other reproductive harm. Wash your hands after handling.

#### Notice for Canada

This Class B digital apparatus complies with Canadian ICES-003. Cet appareil numérique de la classe B est conforme à la norme NMB-003 du Canada.

#### Canadian Class B Statement

This digital device does not exceed the Class B limits for radio noise emissions from digital apparatus as set out in the interference-causing equipment standard entitled "Digital Apparatus," ICES-003 of the Department of Communications.

Cet appareil numérique respecte les limites de bruits radioélectriques applicables aux appareils numériques de Classe B prescrites dans la norme sur le matériel brouilleur: "Appareils Numériques," NMB-003 édictée par le ministre des Communications.

#### MODIFICATION:

Any changes or modifications not expressly approved by the grantee of this device could void the user's authority to operate the device. Toute modification non approuvée explicitement par le fournisseur de licence de l'appareil peut entraîner l'annulation du droit de l'utilisateur à utiliser l'appareil.

## EN English

### Specifications

#### Creative Inspire M5300

Satellite speaker:  
6 watts RMS per channel  
Subwoofer:  
17 watts RMS  
Signal-to-Noise Ratio:  
80dB  
Frequency Response:  
40Hz - 20kHz

These specifications apply to Creative Inspire M5300 operating from the supplied 12V AC 2.9A power adapter.

## ES Español

### Especificaciones

#### Creative Inspire M5300

Altavoz auxiliar:  
6 vatios de carga eficaz por canal  
Altavoz de graves:  
17 vatios de carga eficaz  
Relación de señal a ruido:  
80dB  
Respuesta de frecuencias:  
40Hz a 20kHz

Estas especificaciones se aplican para el uso del Creative Inspire M5300 con el adaptador de alimentación de 12V AC 2.9A suministrado.

## TU Türkçe

### Spesifikasyonlar

#### Creative Inspire M5300

Satellite hoparlör:  
Kanal başına 6 watt RMS  
Subwoofer:  
17 watt RMS  
İşaret-Gürültü Gücü Oranı:  
80 dB  
Frekans Yanıtı:  
40 Hz ~ 20 kHz

Bu spesifikasyonlar, 12V DC, 2.9A güç adaptörüyle beslenen Creative Inspire M5300 cihazı için geçerlidir.

## JP 日本語

### 仕様

#### Creative Inspire M5300

サテライトスピーカー:  
6W RMS/チャンネル  
サブウーファー:  
17W RMS  
SNR(S/N比):  
80dB  
周波数特性:  
40Hz ~ 20kHz

これらの仕様は、付属の12V AC 2.9A電源アダプターで動作させた場合です。

#### December

© 2006. Creative Technology Ltd. All rights reserved. The Creative logo and Creative Inspire are either registered trademarks or trademarks of Creative Technology Ltd. in the United States and other countries. All other logos, brand or product names are trademarks or registered trademarks of their respective holders and are hereby recognised as such. All specifications are subject to change without notice. Use of this product is subject to a limited warranty. Actual contents may differ slightly from those pictured.

## FR Français

### Spécifications

#### Creative Inspire M5300

Haut-parleur satellite:  
6 watts RMS par canal  
Caisson de basse:  
17 watts RMS  
Rapport signal/bruit:  
80dB  
Réponse en fréquence:  
40Hz - 20kHz

Ces spécifications s'appliquent au modèle Creative Inspire M5300 fonctionnant avec la prise d'alimentation 12V AC 2.9A fournie.

## BP Português do Brasil

### Especificações

#### Creative Inspire M5300

Alto-falante:  
RMS de 6 watts por canal  
Subwoofer:  
RMS de 17 watts  
Relação sinal/ruído:  
80dB  
Resposta de frequência:  
40Hz a 20kHz

Estas especificações aplicam-se a Creative Inspire M5300 operando a partir do adaptador de alimentação de 12V AC 2.9A fornecido.

## CT 繁體中文

### 規格

#### Creative Inspire M5300

環繞喇叭:  
每聲道 6 瓦 RMS  
低音喇叭:  
17 瓦 RMS  
訊噪比:  
80dB  
頻率響應:  
40Hz ~ 20kHz

這些規格適用於 Creative Inspire M5300 由附帶的 12V AC 2.9A 變壓器供電時的工作狀態。

## CS 简体中文

### 规格

#### Creative Inspire M5300

卫星音箱:  
额定功率 6 瓦(每声道)  
低音炮:  
额定功率 17 瓦  
信噪比:  
80dB  
频率响应:  
40Hz ~ 20kHz

本规格只适用于 Creative Inspire M5300 由附带的 12V 2.9A 交流变压器提供电力的工作状态。

# CREATIVE INSPIRE® M5300

- EN Quick Start Guide
- FR Démarrage Rapide
- ES Guía Rápida
- BP Introdução rápida
- TU Hızlı Başlat Kılavuzu
- CT 快速入門指南
- JP クイックスタートガイド
- CS 快速安装指南

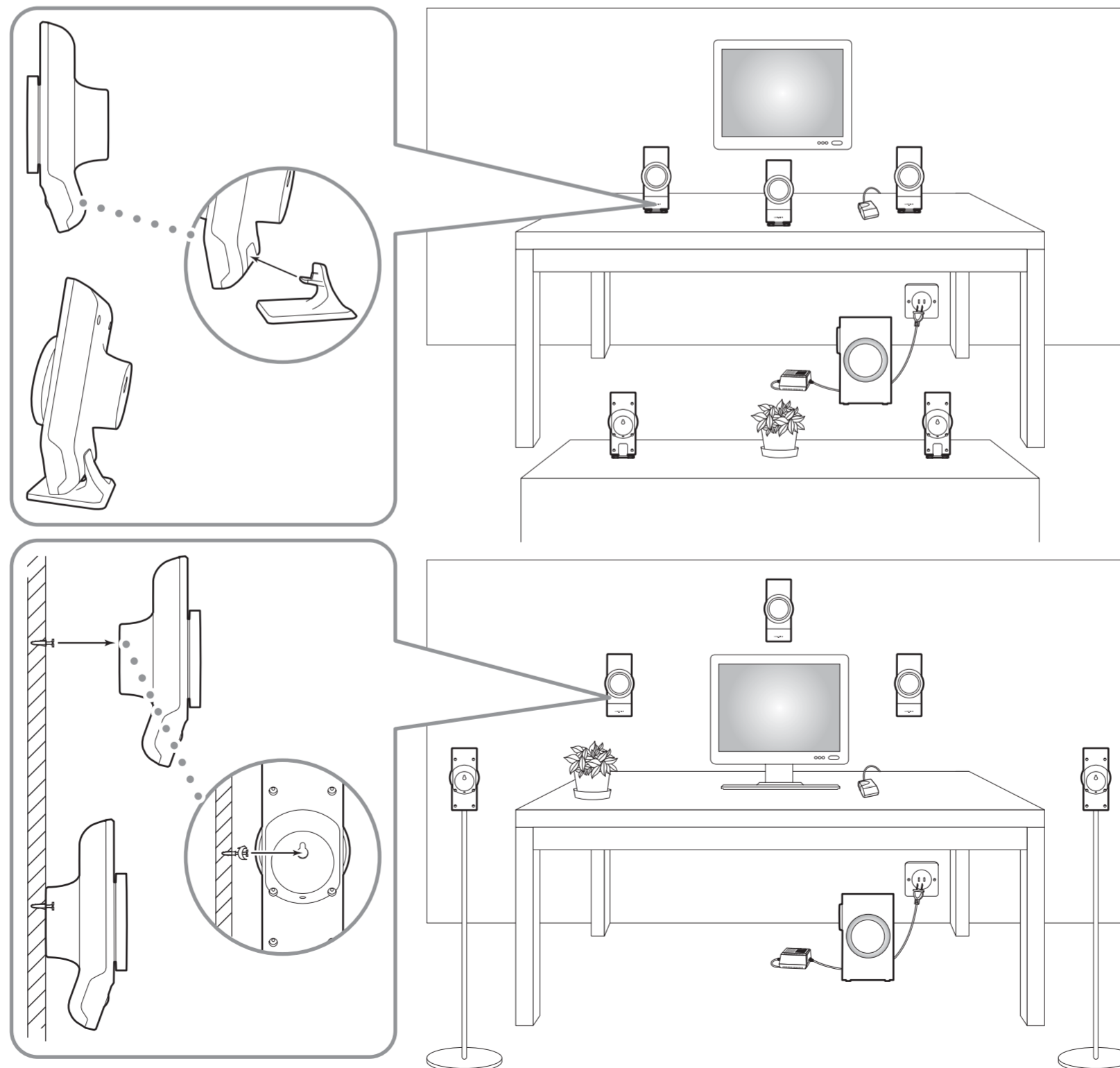

- (Optional) Rear satellite floor stands are sold separately. For more information, please refer to [ht tp://www.creative.com](http://www.creative.com)
- (Facultatif) Des socles pour haut-parleurs satellites arrières sont disponibles séparément. Pour plus d'informations, visitez notre site Web à l'adresse <http://www.creative.com>
- (Opcional) Puede adquirir por separado soportes para los altavoces traseros. Para más información, visite nuestro sitio en <http://www.creative.com>
- (Opcional) Os suportes de chão para as caixas acústicas satélites posteriores são vendidos separadamente. Para maiores informações, consulte <http://www.creative.com>
- (Seçenek dahilinde) Arka satellite hoparlör ayakları ayrı olarak satılmaktadır. Daha fazla bilgi için lütfen <http://www.creative.com> adresini ziyaret edin
- (選配) 後置環繞喇叭落地支架需另行選購。詳情請訪問 <http://www.creative.com>
- リアスピーカー用フロアスタンドはオプション(別売り)です。詳細は弊社ウェブサイト <http://www.creative.com>を参照して下さい。
- (选配件)后置音箱落地支架单独出售。详情请访问 <http://www.creative.com>

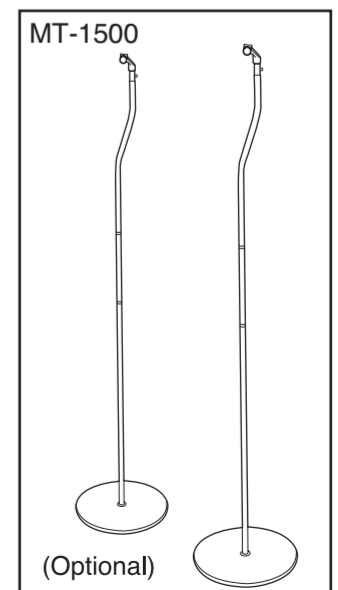

P/N 03MF40900000 Rev. B