



DRAPERY TRACK

Installation Manual and User Guide

TABLE OF CONTENTS

Diagram

List of Parts

Wall Mount Drapery Track Installation and Connecting the Motors
Ceiling Mount Drapery Track Installation and Connecting the Motors

Install the Facia (Optional)

Start Up

Optional Programming Steps for the Track Drapery

- Change Positions on the Track Drapery (Single)

- Change Positions on the Track Drapery (Dual)

- Enable or Disable Smart Assist

- Pair the Remote Control

- Grouping Multiple Drapery Together

- Switch the Open and Close Positions

- Change the Frequency

- Swap the Open and Close Directions on a Single Drapery

- Swap the Open and Close Directions on a Dual Drapery

- Switch Motor Response Controls for a Dual Drapery

- Master Reset the Drapery

Connect and Integrate the Drapery Track

- Pair or Unpair a Remote Control

- Connect the Bridge & App

- Integrate with Amazon Echo- 434 FM

- Integrate with Amazon Echo Plus- Zigbee with Current Products

Corp Bridge

- Integrate with Amazon Echo Plus- Zigbee Native Hub

Troubleshooting

Using the Drapery Track

- Using the TAU for Operation

- Using Smart Assist

- Using the Remote Control- Single Drapery

- Using the Remote Control- Dual Drapery

- Using the Light & Temperature Sensors on the Control Housing

Safety and Warning Statements

WALL MOUNT DRAPERY TRACK INSTALLATION AND CONNECTING THE MOTORS

For additional help during installation of your drapery track, visit www.currentproductscorp.com/support/drapery-track or call 1-844-307-7435.

1. Install the Brackets

Carefully measure to the center of the window and make a small mark with a pencil. Ideally a stud will be located here, but if not you may either use the anchors provided, or move to the closest stud to install the first bracket.

To be certain of bracket installation height, carefully measure the curtain, as some advertised curtain lengths are not precise. To locate the top of the center bracket protrusion, use the following formula alongside the corresponding chart.

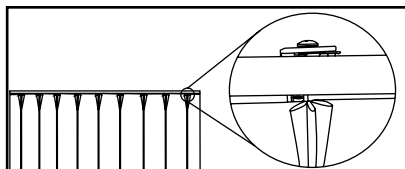

Fig. X

Install the centermost bracket first.

First, hold the center bracket up against the wall and mark, with a pencil, the location for each screw. Once the screw locations are marked, remove the bracket.

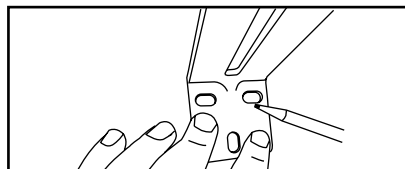

Fig. X

A) **If using wall anchors**, follow the manufacturer specifications for each wall anchor. Set the torque on your drill to the recommended level, and screw in the drywall anchors. Place the bracket against the wall, lining the holes up with the anchors. Screw in each screw to secure bracket. Do not over torque. There should be no movement by the bracket after installation.

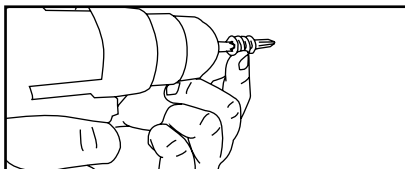

Fig. X

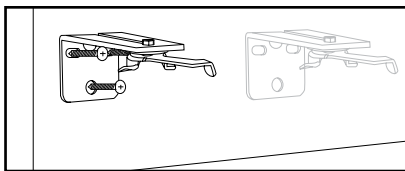

Fig. X

B) **If drilling into studs**, no wall anchors are necessary. Carefully drill a pilot hole for all three screws. Use a 5/32" drill bit for the pilot holes if using the provided screws. Place the bracket against the wall, lining the holes in the bracket up with the holes in the wall. Screw in each screw until secure. Make sure your screw has solid embedment into the stud. Do not over torque. There should be no movement by the bracket after installation.

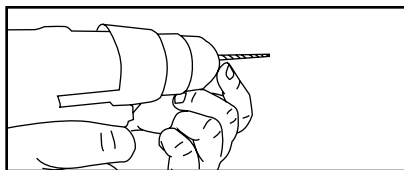

Fig. X

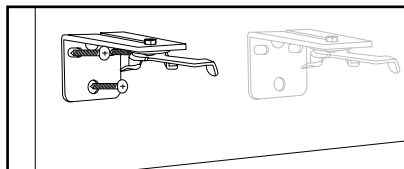

Fig. X

Once the center bracket has been installed, install each subsequent bracket.

Pro Tip: The track can be used as a straight edge to help locate the correct position of the brackets. Once the center bracket has been installed, balance the track on the top of the bracket with the carriers facing the inside of the room. Place a level on the track's side to make sure it is level. Use a pencil to draw a line on the bottom edge of the track where each bracket needs to go.

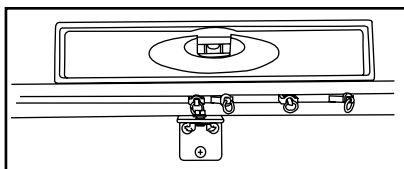

Fig. X

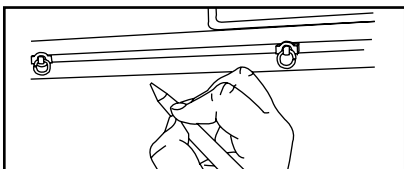

Fig. X

There should be a bracket as close as possible to each end of the track, an additional bracket 5" inboard from the motor end, 5" inboard from the idler end, and brackets every 16"-32" in between depending on drapery weight.

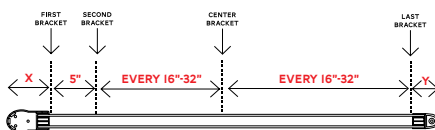

Fig. X

Follow steps A or B above to install the remaining brackets.

2. Install the Track

Starting in the middle, secure the track onto each of the brackets using each camlock. With the camlock arm open, or facing towards you, push the track upward so the camlock features rest in the groove on the top of the track.

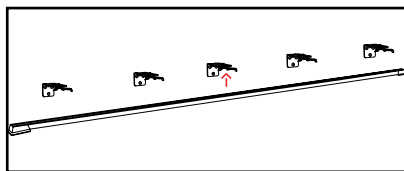

Fig. X

Turn the camlock arm to the left so the features inside the top track groove bite in and hold. Once all the camlocks are closed, use a screwdriver to tighten each camlock so the track is secure.

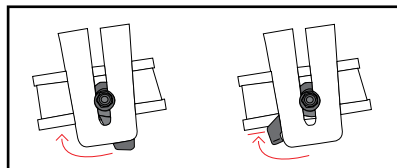

Fig. X

Pro Tip: If not using a fascia, the lip of the camlock arm may be visible. If this is an issue, camlocks can be turned around by detaching them from the brackets and reattaching them with the arm facing the back of the bracket. The track will be pushed up and rest on the camlock wings during install, and the camlock arms will need to be turned to the right, then tightened with a screwdriver to secure.

3. Adjust Number of Carriers and Orient the Carrier Arms

It may be necessary to add or remove carriers based on the curtain fullness.

To add or remove carriers, loosen the screw on the hardstop and slide it out of the track.

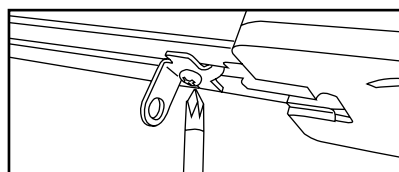

Fig. X

For drapery with pins, insert or remove carriers until the correct amount remain in the track. On a center draw, do this on each side.

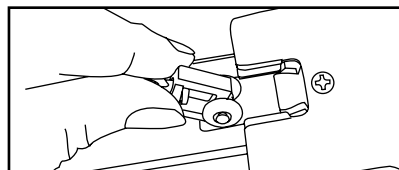

Fig. X

For drapery with snaps, the carriers are connected with a cord. To remove carriers simply slide the desired number to be removed from the track and cut the string. To add carriers the whole string will need to be replaced.

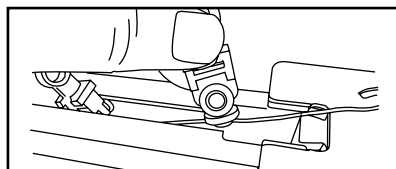

Fig. X

Slide the hardstop back into the track and tighten the screw.

4. Connect the Motors

On a **single drapery**, insert the motor shaft into the motor end of the drapery track and twist the motor into place. Push the locking tab up until it clicks into place.



Fig. X

On a **dual drapery**, insert Motor 1 (large) into the room-side track motor end and twist the motor into place. Push the locking tab up until it clicks into place.

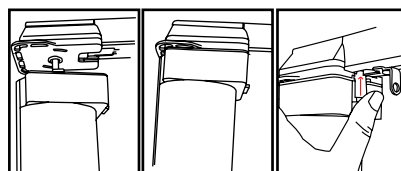

Fig. X

Next, insert Motor 2 (small) into the window-side track motor and twist the motor into place. Push the locking tab up until it clicks into place.

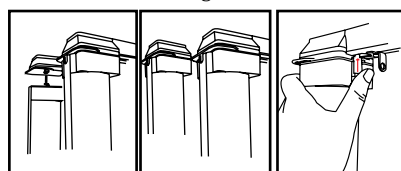

Fig. X

If you do not have a control box, plug the cord from Motor 2 into the bottom of Motor 1. If you do have a control box, proceed to Step 6.

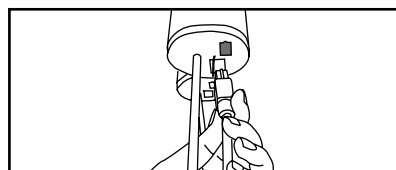

Fig. X

6. Connect the Control Box
(optional)

On a **single drapery**, plug the motor into the Motor 1 slot.

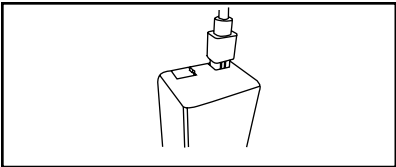

Fig. X

On a **dual drapery**, plug the room side drapery into the Motor 1 slot and window side drapery into the Motor 2 slot.

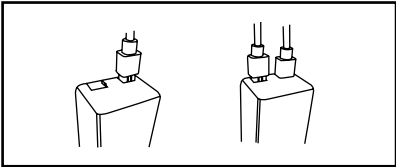

Fig. X

7. Attach the Drapery

Snap or hook the drapery into each carrier, starting with the master carrier arm(s) and ending with the end(s) of the track. Wrap and pin the remaining fabric around the motor, hiding it from plain sight, but making sure the TAU is accessible.



Fig. X

You are now ready to start up the drapery track.

8. Installing a Baton (optional)

On pleated drapery carrier arms with the baton attachment.....

On snap drapery carrier arms with the baton attachment....

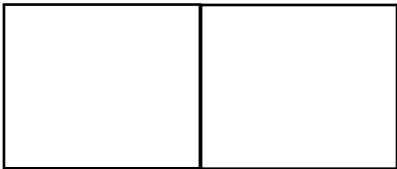

Fig. X

CEILING MOUNT DRAPERY TRACK INSTALLATION AND CONNECTING THE MOTORS

For additional help during installation of your drapery track, visit www.currentproductscorp.com/support/drapery-track or call 1-844-307-7435.

1. Install the Camlocks

The number of camlocks needed will depend on the desired length of the track. Mount a camlock every 16-32 inches along the ceiling. If installing a fascia, be sure to use the included small or large spacers. If not screwing into a joice, use the included anchors.

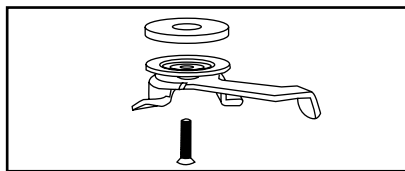

Fig. X

2. Install the Fascia Clips (optional)

If you are using a fascia, install all the fascia clips into the track before installing the track onto the camlocks.

Snap the fascia clips into the recess at the top of the track, one side at a time.

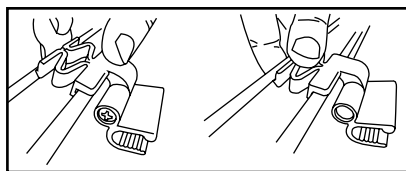

Fig. X

Insert fascia clips at each end of the track, then every 16-32 inches in between where the camlocks will rest.

3. Install the Track

Starting in the middle, secure the track onto each of the camlocks. With the camlock arm facing towards you, push the track so the camlock features rest in the groove on the top of the track.

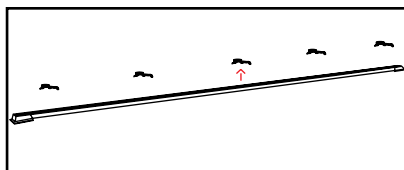

Fig. X

Turn the camlock arm to the left so the features inside the top track groove bite in and hold.

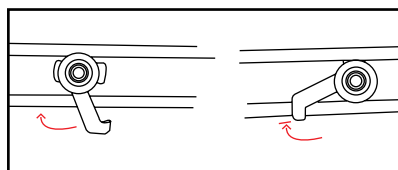

Fig. X

4. Adjust Number of Carriers

It may be necessary to add or remove carriers based on curtain.

To add or remove carriers, loosen the screw on the hardstop and slide it out of the track. Insert or remove carriers until the correct amount remain in the track. On a center draw, do this on each side.

Slide the hardstop back into the track and tighten the screw.

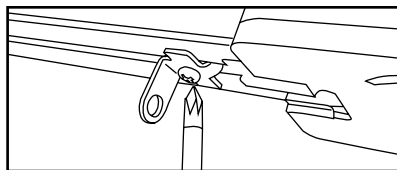

Fig. X

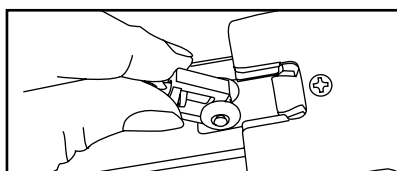

Fig. X

5. Connect the Motors

On a **single drapery**, insert the motor shaft into the motor end of the drapery track and twist the motor into place. Push the locking tab up until it clicks into place.

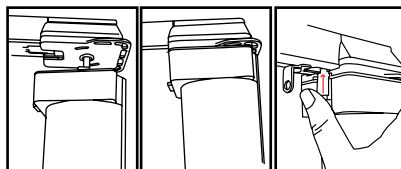

Fig. X

On a **dual drapery**, insert Motor 1 (large) into the room-side track motor end and twist the motor into place. Push the locking tab up until it clicks into place.



Fig. X

Next, insert Motor 2 (small) into the window-side track motor and twist the motor into place. Push the locking tab up until it clicks into place.

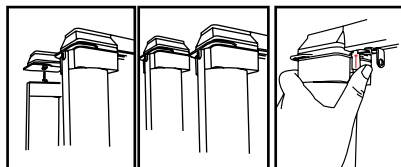

Fig. X

If you do not have a control box, plug the cord from Motor 2 into the bottom of Motor 1. If you do have a control box, proceed to Step 6.

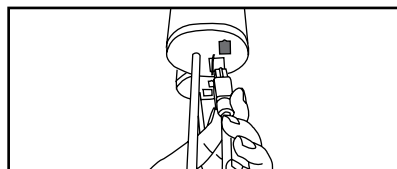

Fig. X

6. Connect the Control Box (optional)

On a **single drapery**, plug the motor into the Motor 1 slot.

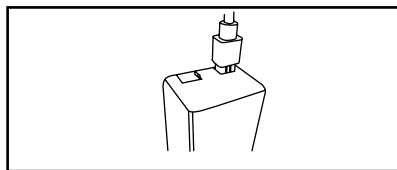

Fig. X

On a **dual drapery**, plug the room side drapery into the Motor 1 slot and window side drapery into the Motor 2 slot.

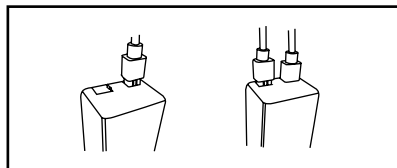

Fig. X

7. Attach the Drapery

Snap or hook the drapery into each carrier, starting with the master carrier arm(s) and ending with the end(s) of the track. Wrap and pin the remaining fabric around the motor, hiding it from plain sight, but making sure the pendant is accessible.

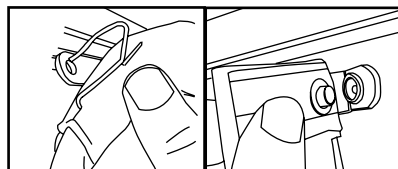

Fig. X

You are now ready to start up the drapery track.

8. Installing a Baton (optional)

On pleated drapery carrier arms with the baton attachment.....

On snap drapery carrier arms with the baton attachment....

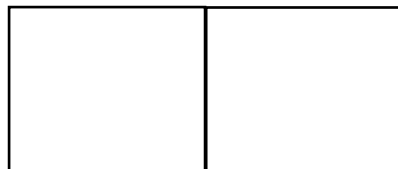

Fig. X

(OPTIONAL) INSTALL THE FACIA

1. Install the Clips

On ceiling mount installations the fascia clips will already be installed on the track drapery, so proceed to step 2.

On wall mounted track installations, snap the fascia clips into the recess at the top of the drapery track, one side at a time. Use a fascia clip between each set of brackets.

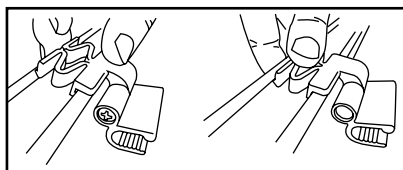

Fig. X

2. Snap on the Fascia

Orient the fascia so the protrusion is at the top. Starting in the middle, snap the protruding feature of the fascia into the “U” shaped clips until it snaps.

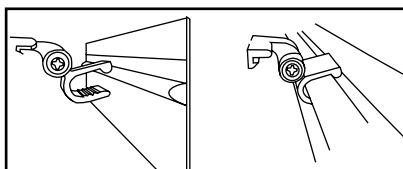

Fig. X

Snap the protrusion into all the remaining clips. Be sure the fascia is positioned where desired, with the proper amount of fascia left on each side of the track.

3. Adjust Fascia Angle

If desired, on fascias 3” and above, the angle of the fascia can be adjusted by using a phillips head screwdriver to pivot the angle of the clip mouth. Be sure to adjust the angle on all clips to create a uniform look.

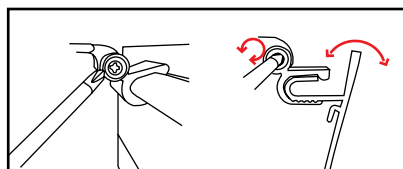

Fig. X

3. Style the Returns

The fascia style allows for returns to be bent in either a rounded or angled manner. By hand, gently bend the fascia ends into the desired shape.

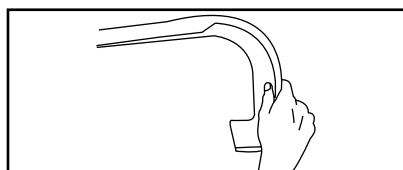

Fig. X

For hard bends, we recommend removing the fascia from the clips, then using a flat surface like a table to help bend the fascia.

START UP

1. Connect Power

On battery powered units, untwist the TAU and insert (6) or (8) D Alkaline batteries, negative end first. Twist the TAU lock to secure back onto the unit.

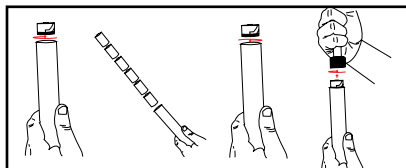

Fig. X

On rechargeable battery powered units, twist the TAU lock to secure onto the unit.

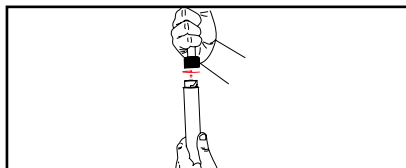

Fig. X

On low voltage units, power up by plugging the unit into the desired outlet.

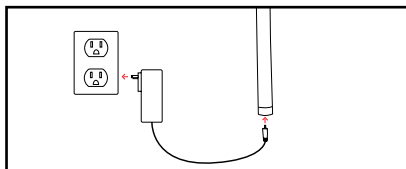

Fig. X

On units with power and control over CAT5, run the wire as desired to the power and communication port, then plug the ethernet cable into the port at the bottom of the control box housing.

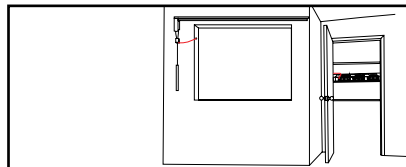

Fig. X



WARNING

Be sure to secure any excess cord, leaving no more than 8 inches unsecured, to reduce the risk of child strangulation.

2. Set Limits

The drapery track will naturally find it's preset limits the first time each curtain moves to the full open and full closed positions. These positions can be changed at any time. To change these positions, see the instructions on page .

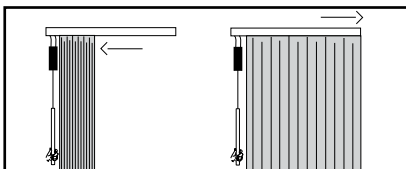

Fig. X

OPTIONAL PROGRAMMING STEPS FOR THE DRAPERY TRACK

CHANGE POSITIONS ON THE DRAPERY TRACK (SINGLE)

CHANGE THE OPEN POSITION

1. Enter Learn Mode

Pull down and release the TAU so the drapery moves towards the direction you would like to set as the “open” position. After the drapery reaches the position, it will stop moving. Pull down and hold the TAU for five seconds, or until the drapery jogs.

Release the TAU.

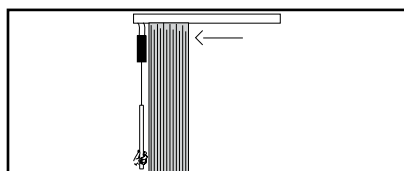

Fig. X

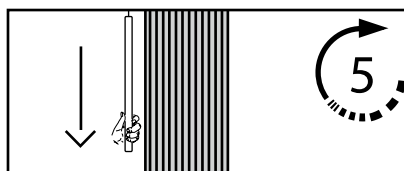

Fig. X

2. Set the Open Position

By hand, pull the curtain until it reaches the desired full open position.

Note: If you have a remote control paired to the device, you can use it to move the curtain into the desired full open position. A press and release will move the curtain half an inch in a direction while a press and hold will move the curtain continuously. **Does this feature still exist?**

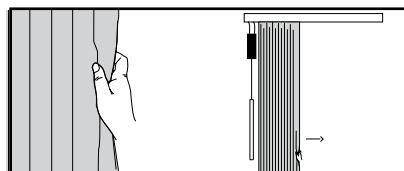

Fig. X

3. Exit Mode

Pull down on the TAU once to exit learn mode. The drapery will jog to confirm it has learned this position.

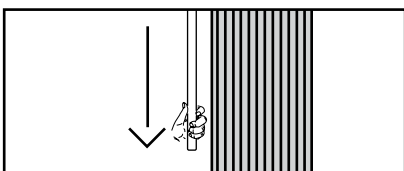

Fig. X

CHANGE THE CLOSE POSITION

1. Enter Learn Mode

Pull down and release the TAU so the drapery moves towards the direction you would like to set as the “close” position. After the drapery reaches the position, it will stop moving. Pull down and hold the TAU for five seconds, or until the drapery jogs.

Release the TAU.

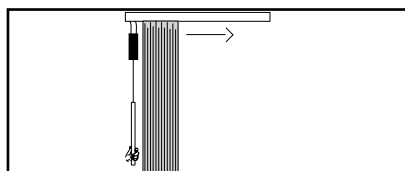

Fig. X

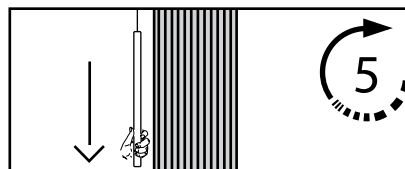

Fig. X

2. Set the Close Position

By hand, pull the curtain until it reaches the desired full close position.

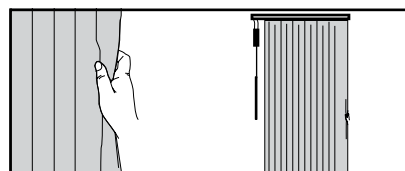

Fig. X

Note: If you have a remote control paired to the device, you can use it to move the curtain into the desired full close position. A press and release will move the curtain half an inch in a direction while a press and hold will move the curtain continuously.

3. Exit Mode

Pull down on the TAU once to exit learn mode. The drapery will jog to confirm it has learned this position.

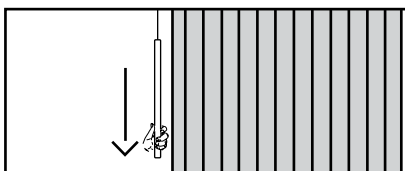

Fig. X

CHANGE POSITIONS ON THE DRAPERY TRACK (DUAL)

CHANGE THE OPEN POSITION FOR THE ROOM SIDE CURTAIN (MOTOR I)

1. Enter Learn Mode

Pull down and release the TAU so the room side drapery moves towards the direction you would like to set as the “open” position. After the drapery reaches the position, it will stop moving. Pull down and hold the TAU for five seconds, or until the drapery jogs.

Release the TAU.

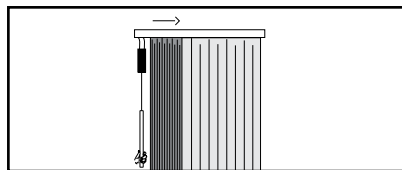

Fig. X

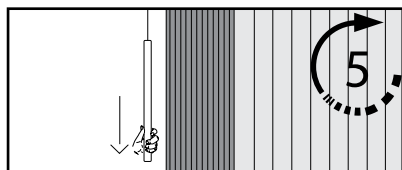

Fig. X

2. Set the Open Position

By hand, pull the curtain until it reaches the desired full open position.

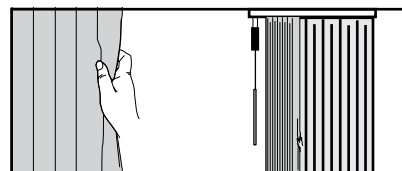

Fig. X

3. Exit Mode

Pull down and release the TAU once to exit learn mode. The drapery will jog to confirm it has learned this position.

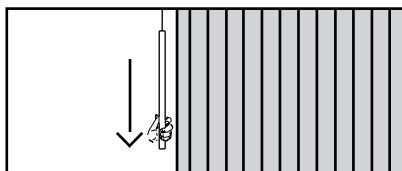

Fig. X

CHANGE THE CLOSE POSITION FOR THE ROOM SIDE CURTAIN

1. Enter Learn Mode

Pull down and release the TAU so the drapery moves towards the direction you would like to set as the “close” position. After the drapery reaches the position, it will stop moving. Pull down and hold the TAU for five seconds, or until the drapery jogs.

Release the TAU.

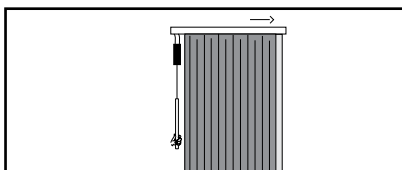

Fig. X

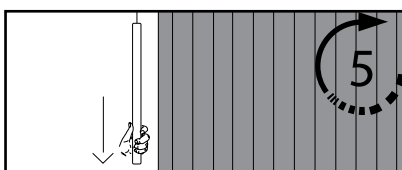

Fig. X

2. Set the Close Position

By hand, pull the curtain until it reaches the desired full close position.

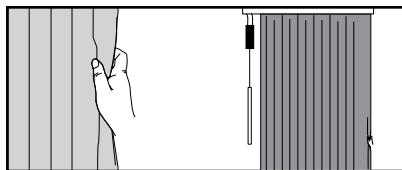

Fig. X

3. Exit Mode

Pull down on the TAU once to exit learn mode. The drapery will jog to confirm it has learned this position.

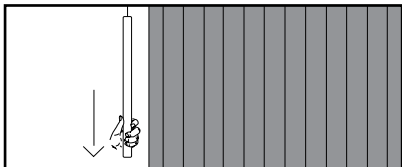

Fig. X

CHANGE THE OPEN POSITION FOR THE WINDOW SIDE CURTAIN (MOTOR 2)

1. Enter Learn Mode

Lift up and release the TAU so the drapery moves towards the direction you would like to set as the “open” position. After the drapery reaches the position, it will stop moving. Push up and hold the TAU for five seconds, or until the drapery jogs.

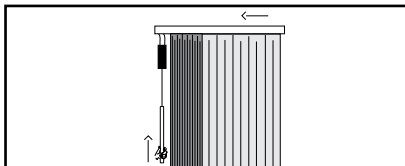

Fig. X

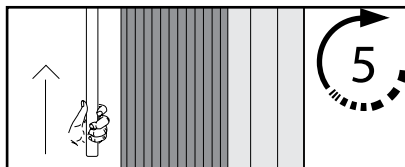

Fig. X

Release the TAU.

2. Set the Open Position

By hand, pull the curtain until it reaches the desired full open position.

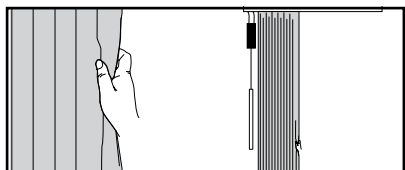

Fig. X

3. Exit Mode

Pull down and release the TAU once to exit learn mode. The drapery will jog to confirm it has learned this position.

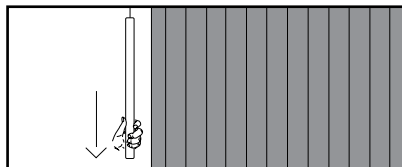

Fig. X

CHANGE THE CLOSE POSITION FOR THE WINDOW SIDE CURTAIN

1. Enter Learn Mode

Lift up and release the TAU so the drapery moves towards the direction you would like to set as the “close” position. After the drapery reaches the position, it will stop moving. Push up and hold the TAU for five seconds, or until the drapery jogs.

Release the TAU.

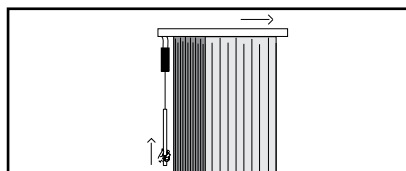

Fig. X

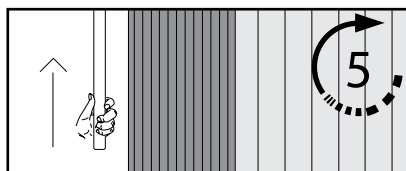

Fig. X

2. Set the Close Position

By hand, pull the curtain until it reaches the desired full close position.

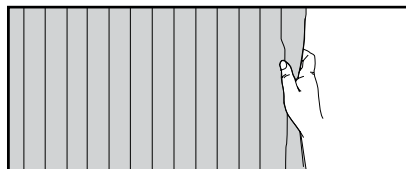

Fig. X

3. Exit Mode

Pull down and release the TAU once to exit learn mode. The drapery will jog to confirm it has learned this position.

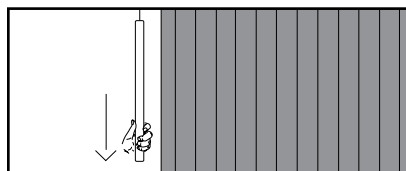

Fig. X

ENABLE OR DISABLE SMART ASSIST

Smart Assist allows users to pull the curtain manually and have the movement complete automatically. All drapery tracks come with Smart Assist enabled.

1. Move the Drapery Manually

Begin with the curtain in the full open or full closed position. Manually move the drapery more than a foot towards the opposite direction. If Smart Assist is enabled, the drapery will begin to complete the movement automatically. If Smart Assist is disabled, the curtain will remain in place.

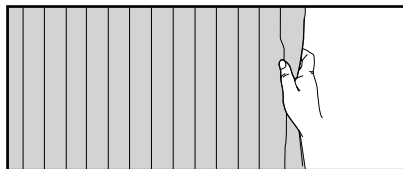

Fig. X

2. Enable or Disable Smart Assist

To disable Smart Assist pull down and hold the TAU for five seconds or until the drapery jogs, then release. Be sure to pull down on the TAU before the curtain reaches its limit.

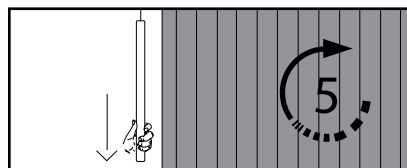

Fig. X

To enable Smart Assist, pull down on the TAU for five seconds or until the drapery jogs, then release.

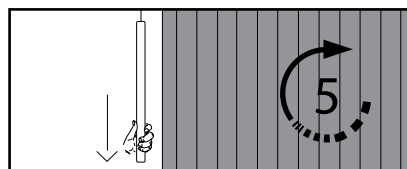

Fig. X

3. Confirm

Pull down and release the TAU once to confirm. The drapery will jog to confirm Smart Assist has been enabled or disabled.

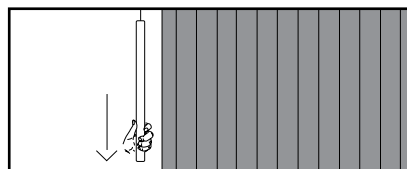

Fig. X

PAIR THE REMOTE TO THE DRAPERY (FM)

1. Initiate Learn Mode

Pull down and release the TAU twice to enter learn mode. After the first tug, the drapery should start moving. The second tug should stop it.

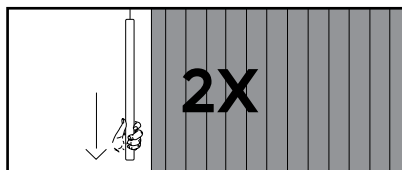

Fig. X

2. Connect the Remote

On multi-channel remotes, select the channel you wish to pair to by pressing the Channel button until the LED corresponding with the appropriate channel is lit.

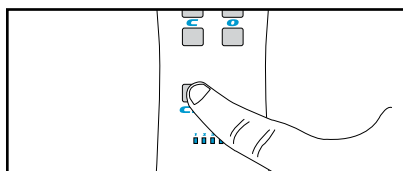

Fig. X

Depress the “pairing” button on the back of the remote by pushing a pen or other object through the hole in the back of the remote. The LEDs on the front will scroll.

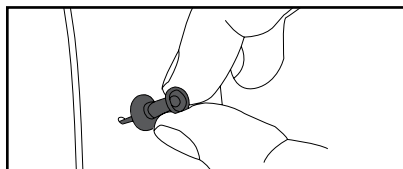

Fig. X

Press and release the top left button on the remote. The drapery will jog to confirm pairing has been successful.

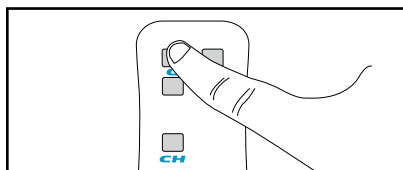

Fig. X

PAIR THE REMOTE TO THE DRAPERY (ZIGBEE)

1. Connect Remote to Bridge

If using the Current Products Corp. bridge, use a tack or other object to depress and release the recessed button on the bottom of the bridge to put the bridge into pairing mode. The LED should flash blue to show it is in pairing mode.

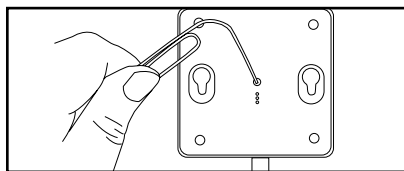

Fig. X

Pull the “Pull” tab from the bottom of the remote. If the tab has already been pulled, push any button on the face of the remote. The LEDs should scroll to show it is seeking a bridge.

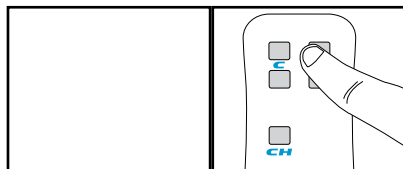

Fig. X

2. Initiate Learn Mode on Drapery

Pull down and release the Pendant twice to enter learn mode.

After the first tug, the drapery should start moving. The second tug should stop it.

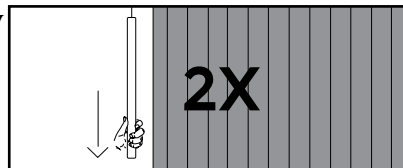

Fig. X

3. Connect the Remote to the Drapery

On multi-channel remotes, select the channel you wish to pair to by pressing the Channel button until the LED corresponding with the appropriate channel is lit.

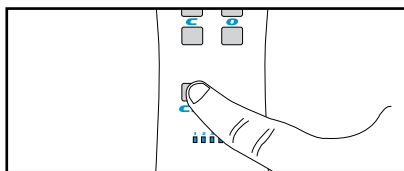

Fig. X

Depress the “pairing” button on the back of the remote by pushing a pen or other object through the hole in the back of the remote. The LEDs on the front will scroll.

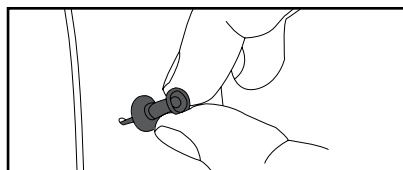

Fig. X

Press and release the top left button on the remote. The drapery will jog to confirm pairing has been successful.

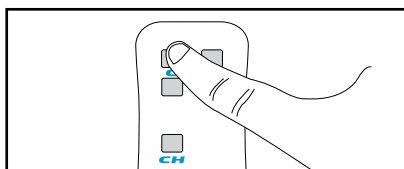

Fig. X

GROUPING MULTIPLE DRAPERY TOGETHER

The grouping feature is available on all units with a control box. Grouping allows users to control multiple units simultaneously with one manual command. Grouping also allows units to move together simultaneously when any one unit in the group has a sensor automated command triggered.

1. Enter Pairing Mode

On each drapery you would like to group, pull down on the Pendant twice.

After the first pull, the drapery should move. The second pull should stop it.

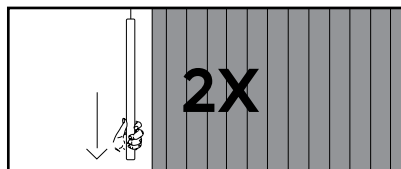

Fig. X

2. Confirm Grouping

On a central unit you would like to designate as the 'Master', press and hold the "Sensors On/Off" button until the LED flashes green.

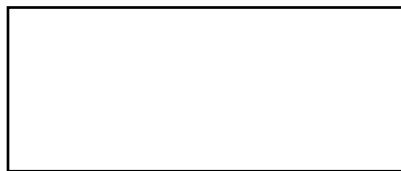

Fig. X

Each drapery will jog to confirm it has been successfully grouped.

SWITCH THE "OPEN" AND "CLOSE" POSITIONS



1. Set the Drapery Position

Move the drapery in the position you would like to be recognized as "open".



Fig. X

2. Learn the Position

Press and hold all three buttons on the control housing for five seconds or until you see the LEDs flash.

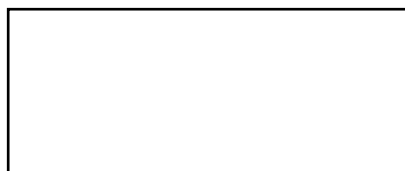

Fig. X

CHANGE THE FREQUENCY (FLOW WITH BRIDGE ONLY)

In rare instances it may become necessary to alter the frequency on which the device communicates. The frequency will need to be changed on both the unit and the remote. To do this, you must have the bridge and the multi-channel remote.

In most instances, when the frequency of the device needs to be changed, the user will receive an alert through the Smart Phone app.

1. Enter Frequency Change Mode through the app

Make sure the bridge is connected and the Smart Phone application has been downloaded.

Hit the gear icon to go to your device and app settings, then go to Frequency Settings.

Select “find new frequency”, and the bridge will scan and find a new frequency for your device.



Fig. X



Fig. X

2. Enter Frequency Change Mode on the Remote

Press a tack or pen through the hole in the back of the remote to depress the Program button (Fig. x). Press this button three times to enter frequency change mode. The LEDs will illuminate to a representation of the current frequency (Fig. x).

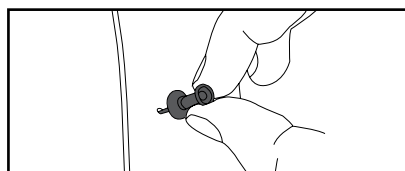

Fig. X

3. Change the Frequency

Use the full close and full open buttons on the remote to move the frequency up and down (Fig. X).

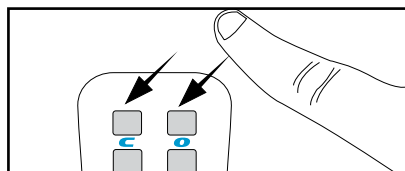

Fig. X

The LEDs will change to reflect the current frequency (Fig. X). Stop when you determine the frequency matches the frequency from the bridge.

Frequency Number	LED Pattern	Frequency
1		434.625
2		434.825
3		435.025
4		435.225
5		435.425
6		435.625
7		435.825
8		436.025

Fig. X

4. Exit Frequency Change Mode

When you reach the desired frequency, exit the mode by pressing and releasing one of the two lower remote buttons.

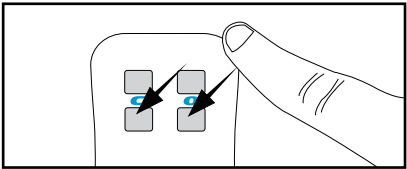

Fig. X

SWAP THE OPEN AND CLOSE DIRECTIONS ON A SINGLE DRAPERY

In some cases, to maximize functionality, users may want to swap which button on the remote control opens and closes the drapery.

1. Swap Directions

First, depress a tack or pin into hole in the back of the remote to press and release the recessed button twice. The LEDs on the front of the remote should blink to confirm you are in the correct mode.

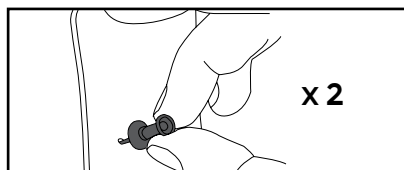

Fig. X

To swap the open and close directions, press and release the top left button.

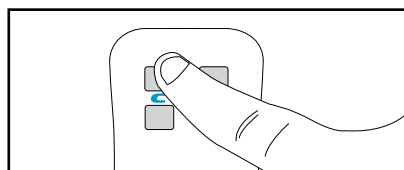

Fig. X

2. Confirm

On the drapery you wish to swap the open and close direction of, pull down and release the TAU once. The drapery will jog to confirm it has switched open and close directions.

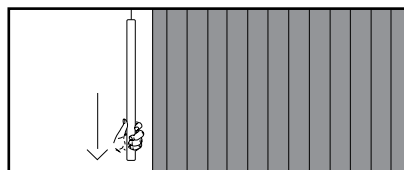

Fig. X

SWAP THE OPEN AND CLOSE DIRECTIONS ON A DUAL DRAPERY

In some cases, to maximize functionality, users may want to swap which button on the remote control opens and closes the drapery.

1. Swap Directions for Motor 1

First, depress a tack or pin into hole in the back of the remote to press and release the recessed button twice. The LEDs on the front of the remote should blink to confirm you are in the correct mode.

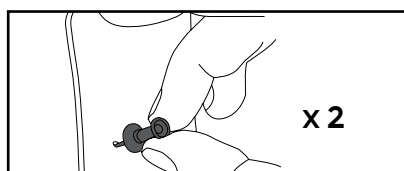

Fig. X

To swap the open and close directions, press and release the top left button.

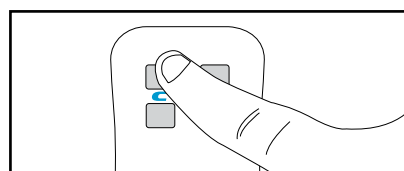
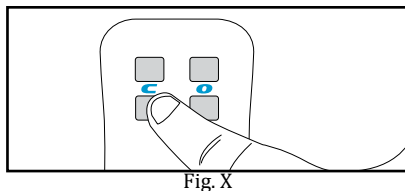

Fig. X

2. Swap Directions for Motor 2

To swap the open and close directions for motor 2, press and release the bottom left button.



3. Confirm

On the drapery you wish to swap the open and close direction of, pull down and release the TAU once. The drapery will jog to confirm it has switched open and close directions.

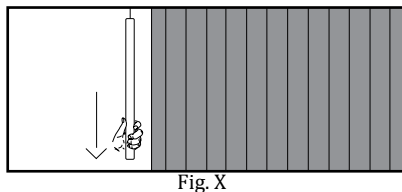

SWITCH MOTOR RESPONSE CONTROLS FOR A DUAL DRAPERY

In some cases, to maximize functionality, users may want to swap the control functions for the window side and room side curtains. Swapping this will change both the remote control and the TAU.

1. Swap Motors

First, depress a tack or pin into hole in the back of the remote to press and release the recessed button twice. The LEDs on the front of the remote should blink to confirm you are in the correct mode.

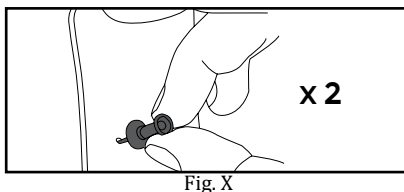

To swap the motor controls, press and release the top right button.

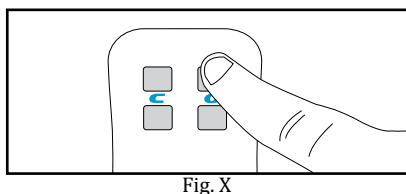

2. Confirm

On the drapery you wish to swap the window side and room side curtain response buttons, pull down and release the TAU once. The drapery will jog to confirm it has switched the response buttons.

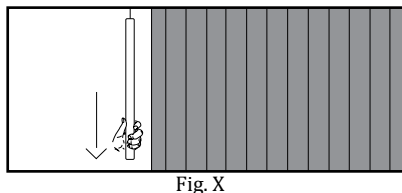

MASTER RESET THE DRAPERY

In some instances it may become necessary to master reset your drapery. Performing a master reset will restore the drapery to its factory settings, erasing saved open and closed positions, groups, and all paired remotes.

1. Remove Power

Disconnect power from the unit. For hardwired units, simply unplug the device. For battery powered units, remove the battery tube by twisting it off of the connection wire.

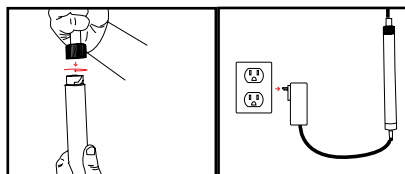

Fig. X

With power disconnected, pull down on the Pendant or cord and release once.

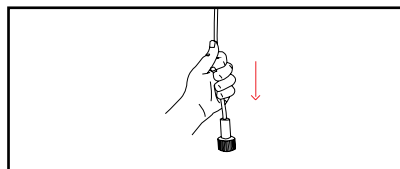

Fig. X

2. Setup The Drapery for Reset

Move the curtain(s) to a position halfway between full open and full closed.

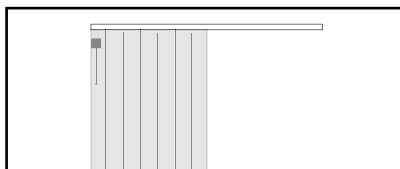

Fig. X

3. Reconnect Power

Reconnect power to the unit by plugging the unit back in or by reconnecting the battery tube.

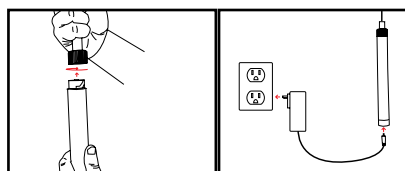

Fig. X

3. Perform Master Reset

Pull down on the TAU and hold for 10 seconds or until the drapery jogs.

Next, push up on the TAU for 10 seconds or until the drapery jogs.

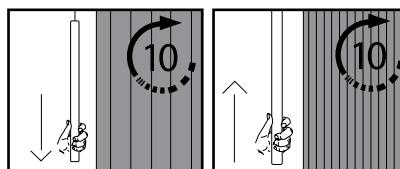

Fig. X

Your drapery has now been master reset.

CONNECT & INTEGRATE THE DRAPERY TRACK

PAIR OR UNPAIR A REMOTE CONTROL

1. Initiate Learn Mode

Pull down and release the TAU twice to enter learn mode. After the first tug, the drapery should start moving. The second tug should stop it.

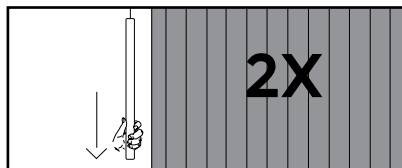

Fig. X

2. Connect the Remote

If the remote is multi-channel, select the channel you wish to pair to by pressing the Channel button until the LED corresponding with the appropriate channel is lit.

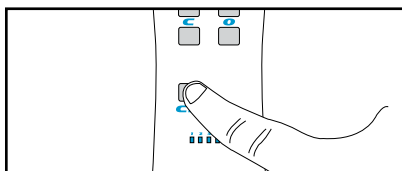

Fig. X

Depress the “pairing” button on the back of the remote by pushing a pen or other object through the hole in the back of the remote. The LEDs on the front should begin to scroll.

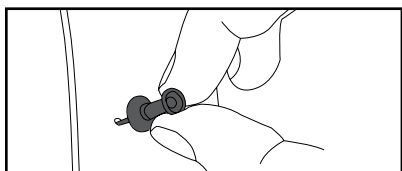

Fig. X

To Pair: Press the top left button on the remote to pair the new remote to the drapery.

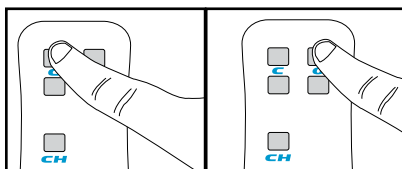

Fig. X

To Unpair: press the top right button on the remote.

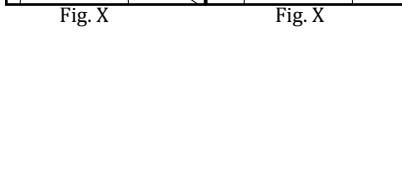

Fig. X

The drapery will jog to confirm pairing has been successful.

SETUP WITH THE BRIDGE AND APP

1. Download the App

Download the Current Products Corp. app from the Google Play Store or the App Store. Follow the prompts to set up your account.

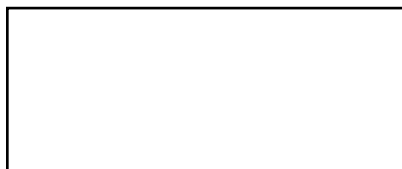

Fig. X

2. Connect Power to Bridge

Find an outlet in a location central to the drapery you are installing in the home. Insert the micro-usb end of the included power cable into the power port on the bridge. Plug the other end of the cable into an outlet.

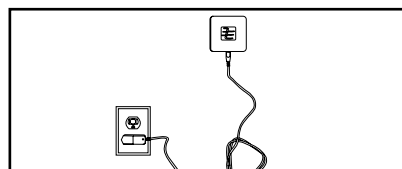

Fig. X

3. Connect the Bridge

Once you have input your credentials, the app will ask you to scan the QR code located on the bottom of the bridge.

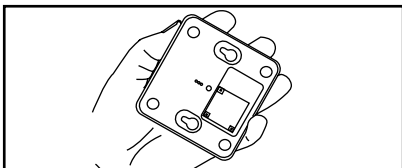

Fig. X

Your bridge is now connected to your account.

4. Learn the Devices

In the app under devices, hit the + sign.

Pull down and release the Pendant twice on the drapery you want to pair to the bridge. You will see the device pop up in the menu on your Smart Phone screen.

Select the appropriate device, using the “identify” button if needed.

Once the device has been selected, name the device.

Repeat step 4 for all new devices.

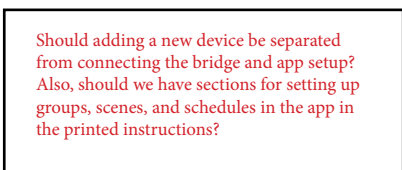

Fig. X

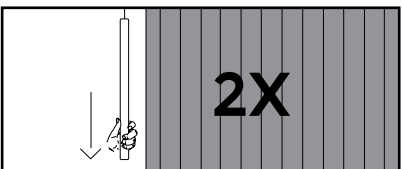

Fig. X



Fig. X

SETUP WITH THE BRIDGE (NO APP)

1. Connect Power to Bridge

Find an outlet in a location central to the drapery you are installing in the home. Insert the micro-usb end of the included power cable into the power port on the bridge. Plug the other end of the cable into an outlet.

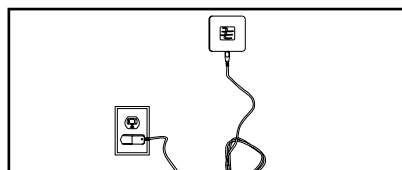

Fig. X

2. Put Bridge into Pairing Mode

Push a tack or pen into the hole in the back of the bridge to depress and release the recessed button. The blue LED should illuminate.

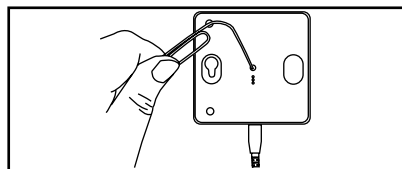

Fig. X

3. Pair Drapery

On any drapery you would like to pair to the bridge pull down and release the Pendant once to start the drapery, then once again to stop it. The green LED on the bridge should flash three times to indicate the drapery has been paired.

4. Pair Remote

On any drapery you would like to pair to the bridge pull down and release the Pendant once to start the drapery, then once again to stop it. The green LED on the bridge should flash three times to indicate the drapery has been paired.

INTEGRATE WITH AMAZON ECHO - 434 FM

1. Set up your Echo

If your Alexa device is not yet set up, do so now by following the instructions that came with your device.

Also be sure the bridge has been setup. For instructions on how to set up your bridge and app, go to page ____.

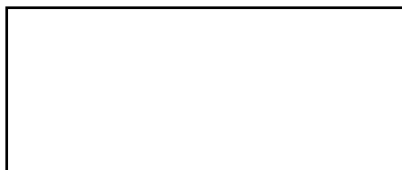

Fig. X

2. Download the Skill

Use the “add a skill” (+) button inside your Alexa App.

Search for the skill titled “My Curtains” or “Current Products”. If you want to be able to trigger Alexa using both phrases, be sure to download both skills.

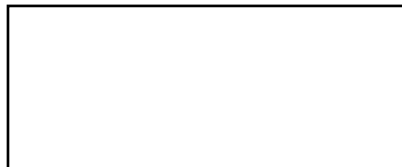

Fig. X

3. Sign In

Use the login credentials you created when you first set up your bridge and app. You are now able to control your devices via Amazon Alexa.



Fig. X

Using Alexa

Trigger Alexa using the trigger word selected when you installed the skill.

Say “Alexa, ask MyCurtains to ...” or “Alexa, ask Current Products to ...”. Use percentages to get your drapery to specific position, or say “open” and “close”.

You can control devices, groups, or trigger scenes through Alexa, and create custom names for each in the MyCurtains app.

INTEGRATE WITH AMAZON ECHO PLUS- ZIGBEE WITH CURRENT PRODUCTS CORP BRIDGE

1. Set up your Echo

If your Alexa device is not yet set up, do so now by following the instructions that came with your device.

Also be sure the bridge has been setup. For instructions on how to set up your bridge and app, go to page ____.



Fig. X

2. Download the Skill

Use the “add a skill” (+) button inside your Alexa App.

Search for the skill titled “My Curtains” or “Current Products”. If you want to be able to trigger Alexa using both phrases, be sure to download both skills.



Fig. X

3. Sign In

Use the login credentials you created when you first set up your bridge and app. You are now able to control your devices via Amazon Alexa.



Fig. X

Using Alexa

Trigger Alexa using the trigger word selected when you installed the skill.

Say “Alexa, ask MyCurtains to ...” or “Alexa, ask Current Products to ...”. Use percentages to get your drapery to specific position, or say “open” and “close”.

You can control devices, groups, or trigger scenes through Alexa, and create custom names for each in the MyCurtains app.

INTEGRATE WITH AMAZON ECHO PLUS- ZIGBEE

1. Set up your Echo

If your Alexa device is not yet set up, do so now by following the instructions that came with your device.



Fig. X

2. Add a Device

From the menu in the Alexa app, go to “Smart Home” and hit “Add a Device”. Alternately, you can say “Alexa, search for devices”.



Fig. X

After Alexa has completed her search, pull down and release the TAU twice on each drapery you want to pair to Alexa.

3. Customize in App

In the Alexa app, you can change the name of each device to better your control of the devices. You can also add custom commands. We suggest custom naming each device, and creating commands for “open” and “close”.



Fig. X

Is this everything???

INTEGRATE WITH GOOGLE HOME

INTEGRATE WITH CONTROL4

INTEGRATE WITH SAMSUNG SMARTTHINGS

TROUBLESHOOTING

USING THE DRAPERY TRACK

USING THE TAU FOR OPERATION

The TAU, or Tug Activation Unit, can be pulled down or pushed up, depending on the desired movement.

On a single drapery, pulling the TAU down activates the curtain. Pulling down once makes the curtain move towards the next position, depending on if the curtain is open or closed. Pushing the TAU up will stop it. Pulling down a second time after stopping will allow the curtain to move in the opposite direction.

On a dual drapery, pulling the TAU down activates the curtain plugged into the motor 1 slot. Pulling down once makes the curtain move towards the next position, depending on if the curtain is open or closed. Pulling down a second time will stop it. Pulling down a third time, shortly after stopping will allow the curtain to move in the same direction as before. Pulling down after several seconds will change the direction the curtain moves.

Pushing up on the TAU will activate the curtain plugged into the motor 2 slot. Pushing up once makes the curtain move towards the next position, depending on if the drapery is open or closed. Pushing up a second time will stop it. Pushing up a third time, shortly after stopping will allow the curtain to move in the same direction as before. Pulling down after several seconds will change the direction the curtain moves.

USING SMART ASSIST

Smart Assist is a drapery track feature to allow users the ability to begin an open or close movement manually, and have the drapery automatically complete the movement.

To trigger Smart Assist, simply pull the curtain approximately one foot towards the direction you would like to move the curtain. Upon release, the curtain will continue moving in that direction until it reaches the full open or closed position.

USING THE REMOTE CONTROL- SINGLE DRAPERY

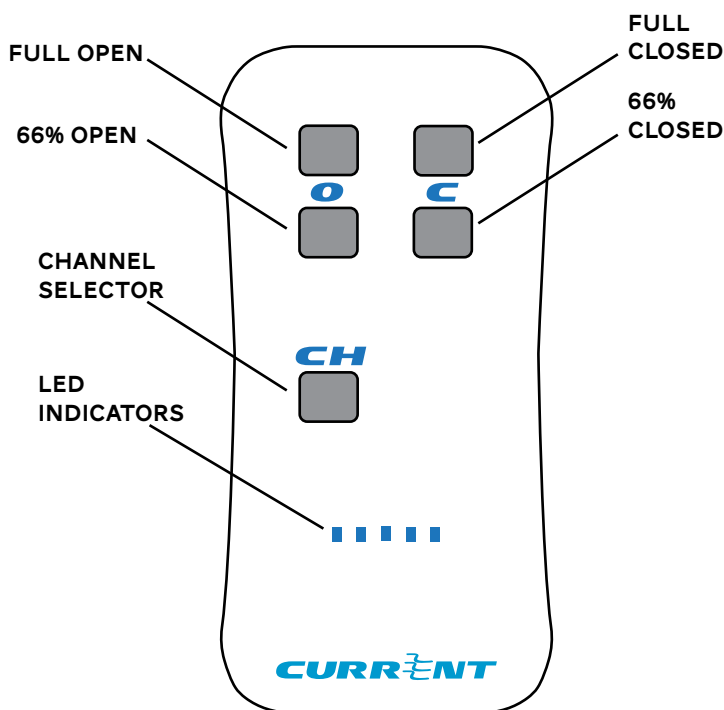

Full Open- A press and release moves the drapery to the full open position. A press and hold will move the drapery towards the open position, and stop it precisely upon release.

Full Closed- A press and release moves the drapery to the full closed position. A press and hold will move the drapery towards the closed position, and stop it precisely upon release.

66% Open- A press and release moves the drapery to the approximately 66% open position.

66% Closed- A press and release moves the drapery to the approximately 66% closed position.

Channel Selector- Successive presses and releases will change the remote channel. Current channel will be reflected on the LED indicators.

LED Indicators- Indicator lights for various remote functions.

USING THE REMOTE CONTROL- DUAL DRAPERY

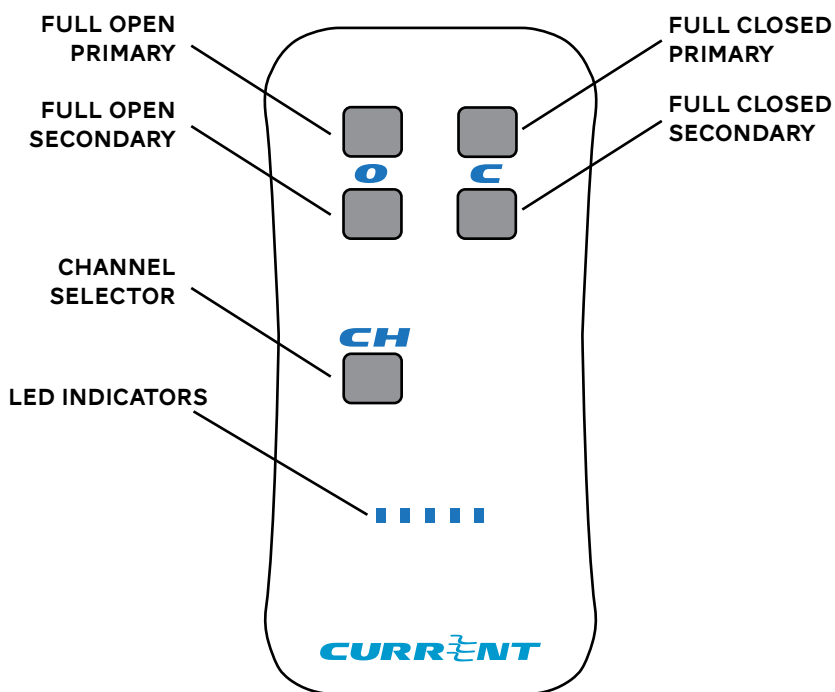

Full Open Primary- A press and release moves the drapery plugged into the motor 1 slot to the full open position.

Full Closed Primary - A press and release moves the drapery plugged into the motor 1 slot to the full closed position.

Full Open Secondary- A press and release moves the drapery plugged into the motor 2 slot to the full open position.

Full Closed Secondary- A press and release moves the drapery plugged into the motor 2 slot to the full closed position.

Channel Selector- Successive presses and releases will change the remote channel. Current channel will be reflected on the LED indicators.

LED Indicators- Indicator lights for various remote functions.

USING THE LIGHT & TEMPERATURE SENSORS ON THE CONTROL HOUSING

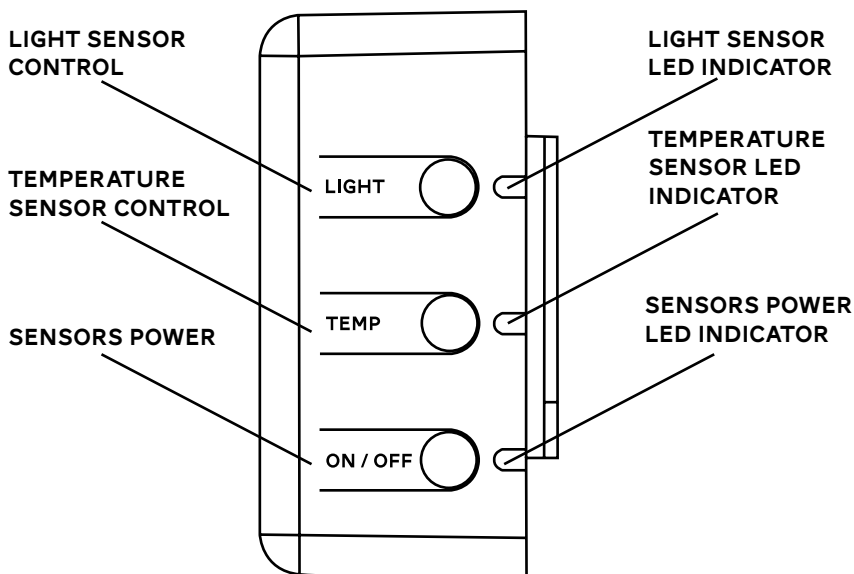

Light Sensor Control - A press and release displays the current mode of the light sensor. A second press and release changes the mode of the automated movements triggered by the light sensor.

Temperature Sensor Control- A press and release displays the current mode of the temperature sensor. A second press and release changes the mode of the automated movements triggered by the temperature sensor.

Sensors Power- A press and release displays the current mode. A second press and release will change the mode of all sensor enabled automated movements between enabled or disabled.

Light and Temperature Sensor LED Indicators- Indicates which mode the sensor is in when the corresponding button is pressed and released.

Sensors Power LED Indicator- Indicates which mode the sensors are in when the corresponding button is pressed and released. A red LED means the sensors are off. A green LED means they are on.

SENSOR MODES

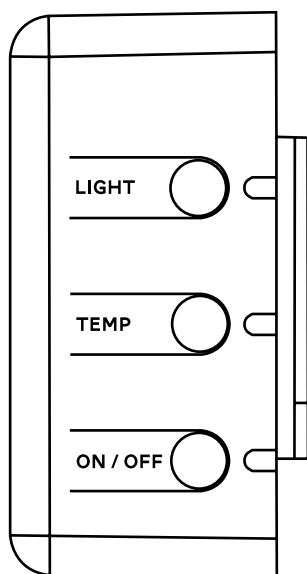

The integrated light and temperature sensors have three possible modes: Off, Fully Automatic, and Semi-Automatic.

Off- The device will not make any movement triggered by this sensor.

Fully Automatic- The device will open and close the curtains based on the sensor readings.

Semi-Automatic- The device will close the curtains based on sensor readings, but will not open them.

These modes are indicated using the LEDs on the right of the control box.

SAFETY INFORMATION



WARNING

Read all warnings and instructions prior to installing the E-Wand™. Failure to follow these instructions may result in property damage or serious personal injury.



CAUTION

Do not use this product for anything other than its intended use. Any usage of the parts of this kit outside of its intended purposes is not covered under the warranty.



CAUTION

Drapery parts may have sharp edges. Use gloves to prevent cuts or abrasions when ever removing or reinstalling drapery.

STATEMENTS

FCC STATEMENT

This device complies with Part 15 of the FCC Rules. Operation is subject to the following two conditions:

1. This device may not cause harmful interference, and
2. This device must accept any interference received, including interference that may cause undesired operation.

Warning: Changes or modifications not expressly approved by Current Products Co. could void the user's authority to operate the equipment.

NOTE: This equipment has been tested and found to comply with the limits for a Class B digital device, pursuant to Part 15 of the FCC Rules. These limits are designed to provide reasonable protection against harmful interference in a residential installation. This equipment generates, uses, and can radiate radio frequency energy and, if not installed and used in accordance with the instructions, may cause harmful interference to radio communications. However, there is no guarantee that interference will not occur in a particular installation. If this equipment does cause harmful interference to radio or television reception, which can be determined by turning the equipment off and on, the user is encouraged to try to correct the interference by one or more of the following measures:

- Reorient or relocate the receiving antenna.
- Increase the separation between the equipment and receiver.
- Connect the equipment into an outlet on a circuit different from that to which the receiver is connected.
- Consult the dealer or an experienced radio/TV technician for help.

RF WARNING STATEMENT

This equipment complies with FCC/ISED radiation exposure limits set forth for an uncontrolled environment. This equipment should be installed and operated to provide a separation distance of at least 20 cm from all persons.

Cet équipement est conforme aux limites d'exposition au rayonnement FCC / ISED établies pour un environnement non contrôlé. Cet équipement doit être installé et utilisé de manière à assurer une distance de séparation d'au moins 20 cm de toutes les personnes.

IC STATEMENT

This device complies with Industry Canada license-exempt RSS standard(s). Operation is subject to the following two conditions: (1) this device may not cause interference, and (2) this device must accept any interference, including interference that may cause undesired operation of the device.

Le présent appareil est conforme aux CNR d'Industrie Canada applicables aux appareils radio exempts de licence. L'exploitation est autorisée aux deux conditions suivantes: (1) l'appareil ne doit pas produire de brouillage, et (2) l'utilisateur de l'appareil doit accepter tout brouillage radioélectrique subi, même si le brouillage est susceptible d'en compromettre le fonctionnement.

WARRANTY INFORMATION

LIMITED WARRANTY

Current Products Corp. (the "Manufacturer") hereby warrants to Customer that the E-Wand™ (the "Product") is and will remain for a period of one (1) year from the date of delivery to Customer as evidenced by Customer's proof of purchase (the "Warranty Period"), free of defects in materials and workmanship, provided that the Product used for its intended purpose and is properly serviced in accordance with the User's Manual provided to Customer. Subject to the foregoing, if at any time during the Warranty Period the Product fails to conform to the foregoing warranty by reason of defects in materials or workmanship, Customer shall promptly notify Manufacturer in writing, and Manufacturer at its option shall repair or replace the defective Product or component part without charge to Customer, except for: (A) costs incurred in transporting the Products or component parts to and from Manufacturer's designated dealer or its manufacturing plant; and (B) charges for labor or other costs incidental to the removal or remounting of component parts repaired or replaced under this Warranty, both of which shall be borne by Customer. Notwithstanding any provision herein to the contrary, this Warranty shall not extend or obligate Manufacturer to take any action with respect to: (i) Products which have been modified, altered, installed, used or operated in a manner which is not recommended by Manufacturer, including any Products in which parts not manufactured or approved by Manufacturer have

been installed; (ii) Products which have not been regularly and properly serviced in accordance with the User's Manual or which have otherwise been neglected; and (iii) ordinary wear and tear, service and maintenance and replacement items; (iv) the Product has been used, or attempted to be used, for other than the customary usage or for other than the Product's intended use; (v) the Product has been subject to mishandling, misuse, or abuse; (vi) the product has suffered damage resulting from lightning, power surges, vandalism, fire, earthquake, acts of nature, or any other cause which the product was not designed to withstand; or (vii) damage to the Product cause by battery decay or corrosion.

This Limited Warranty extends only to the original owner. This Limited Warranty is not transferable. This Limited Warranty does not cover normal wear or tear or deterioration which occurs with the passage of time. Batteries originally provided with a new product, if any, are produced by a third party and are not warranted by Manufacturer. No employee, distributor, dealer, agent or representative is authorized to change the terms of this Limited Warranty in any way, to extend the warranty time periods, or to grant additional warranties, and no attempt to do any of the foregoing will be binding upon Manufacturer.

LIMITATION OF LIABILITY

EXCEPT AS SPECIFICALLY STATED IN THE PARAGRAPHS IMMEDIATELY ABOVE, MANUFACTURER MAKES NO WARRANTY OR REPRESENTATION, EXPRESS OR IMPLIED, INCLUDING, WITHOUT LIMITATION, ANY WARRANTY OF MERCHANTABILITY OR FITNESS FOR A PARTICULAR PURPOSE. THE WARRANTY SET FORTH ABOVE AND THE OBLIGATIONS AND LIABILITIES OF MANUFACTURER THEREUNDER REPRESENT CUSTOMER'S SOLE AND EXCLUSIVE REMEDIES AND ARE EXPRESSLY MADE IN LIEU OF ANY AND ALL OTHER REMEDIES, WARRANTIES, GUARANTIES OR LIABILITIES, EXPRESS OR IMPLIED, ALL OF WHICH ARE HEREBY EXPRESSLY WAIVED BY CUSTOMER. THERE ARE NO WARRANTIES WHICH EXTEND BEYOND THE DESCRIPTION ON THE FACE HEREOF. IN NO EVENT SHALL MANUFACTURER'S LIABILITY HEREUNDER EXCEED THE PURCHASE PRICE FOR THE PRODUCTS, NOR SHALL MANUFACTURER BE LIABLE FOR ANY SPECIAL, INDIRECT, INCIDENTAL OR CONSEQUENTIAL DAMAGES OF ANY NATURE WHATSOEVER.

OTHER LEGAL RIGHTS

This warranty gives you specific legal rights, and you may also have other rights, which vary from state to state.