

REMOTE CONTROL

Programming Manual and User Guide

PAIR OR UNPAIR A REMOTE CONTROL

1. Initiate Learn Mode

Pull down and release the TAU twice to enter learn mode. After the first tug, the drapery should start moving. The second tug should stop it.



Fig. X

2. Connect the Remote

On multi-channel remotes, select the channel you wish to pair to by pressing the Channel button until the LED corresponding with the appropriate channel is lit.

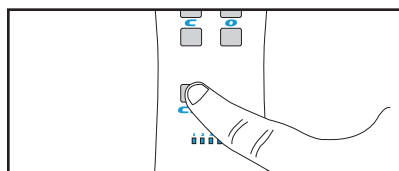

Fig. X

Depress the “pairing” button on the back of the remote by pushing a pen or other object through the hole in the back of the remote. The LEDs on the front should begin to scroll.

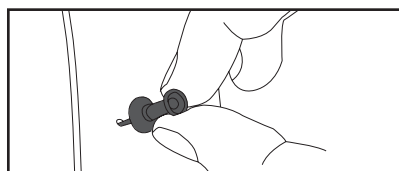

Fig. X

To Pair: Press the top left button on the remote to pair the new remote to the drapery.

To Unpair: press the top right button on the remote.

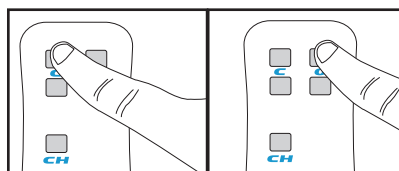
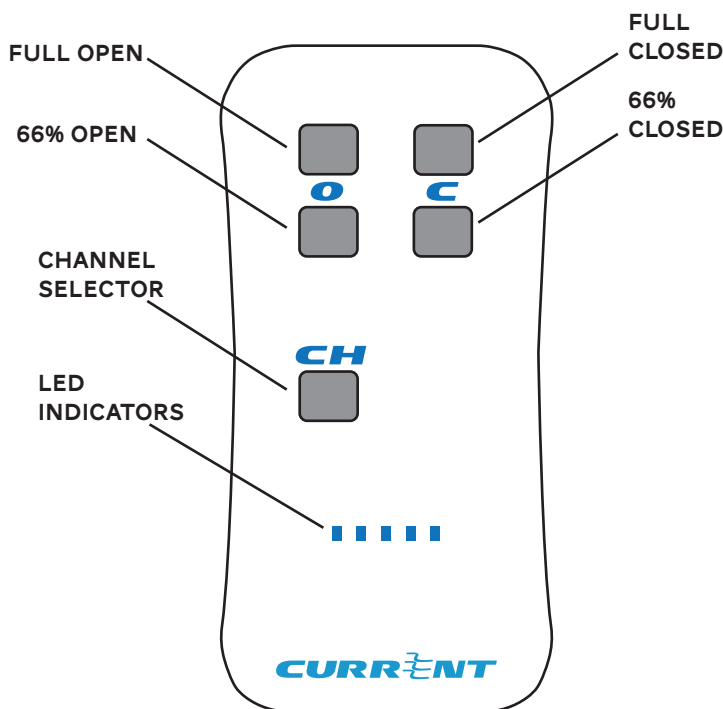

Fig. X

Fig. X

The drapery will jog to confirm pairing has been successful.

USING THE REMOTE CONTROL- SINGLE DRAPERY



Full Open- A press and release moves the drapery to the full open position. A press and hold will move the drapery towards the open position, and stop it precisely upon release.

Full Closed- A press and release moves the drapery to the full closed position. A press and hold will move the drapery towards the closed position, and stop it precisely upon release.

66% Open- A press and release moves the drapery to the approximately 66% open position.

66% Closed- A press and release moves the drapery to the approximately 66% closed position.

Channel Selector- Successive presses and releases will change the remote channel. Current channel will be reflected on the LED indicators.

LED Indicators- Indicator lights for various remote functions.

USING THE REMOTE CONTROL- DUAL DRAPERY

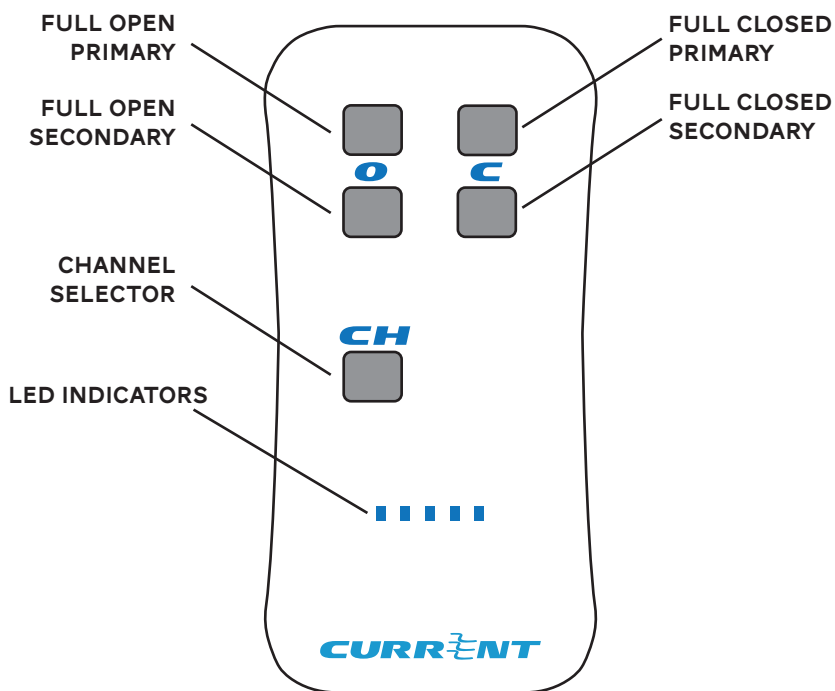

Full Open Primary- A press and release moves the drapery plugged into the motor 1 slot to the full open position.

Full Closed Primary - A press and release moves the drapery plugged into the motor 1 slot to the full closed position.

Full Open Secondary- A press and release moves the drapery plugged into the motor 2 slot to the full open position.

Full Closed Secondary- A press and release moves the drapery plugged into the motor 2 slot to the full closed position.

Channel Selector- Successive presses and releases will change the remote channel. Current channel will be reflected on the LED indicators.

LED Indicators- Indicator lights for various remote functions.

SAFETY INFORMATION



WARNING

Read all warnings and instructions prior to installing the E-Wand™. Failure to follow these instructions may result in property damage or serious personal injury.



CAUTION

Do not use this product for anything other than its intended use. Any usage of the parts of this kit outside of its intended purposes is not covered under the warranty.



CAUTION

Drapery parts may have sharp edges. Use gloves to prevent cuts or abrasions when ever removing or reinstalling drapery.

STATEMENTS

FCC STATEMENT

This device complies with Part 15 of the FCC Rules. Operation is subject to the following two conditions:

1. This device may not cause harmful interference, and
2. This device must accept any interference received, including interference that may cause undesired operation.

Warning: Changes or modifications not expressly approved by Current Products Co. could void the user's authority to operate the equipment.

NOTE: This equipment has been tested and found to comply with the limits for a Class B digital device, pursuant to Part 15 of the FCC Rules. These limits are designed to provide reasonable protection against harmful interference in a residential installation. This equipment generates, uses, and can radiate radio frequency energy and, if not installed and used in accordance with the instructions, may cause harmful interference to radio communications. However, there is no guarantee that interference will not occur in a particular installation. If this equipment does cause harmful interference to radio or television reception, which can be determined by turning the equipment off and on, the user is encouraged to try to correct the interference by one or more of the following measures:

- Reorient or relocate the receiving antenna.
- Increase the separation between the equipment and receiver.
- Connect the equipment into an outlet on a circuit different from that to which the receiver is connected.
- Consult the dealer or an experienced radio/TV technician for help.

RF WARNING STATEMENT

The device has been evaluated to meet general RF exposure requirements. The device can be used in portable exposure condition without restriction.

IC STATEMENT

This device complies with Industry Canada license-exempt RSS standard(s). Operation is subject to the following two conditions: (1) this device may not cause interference, and (2) this device must accept any interference, including interference that may cause undesired operation of the device.

Le présent appareil est conforme aux CNR d'Industrie Canada applicables aux appareils radio exempts de licence. L'exploitation est autorisée aux deux conditions suivantes: (1) l'appareil ne doit pas produire de brouillage, et (2) l'utilisateur de l'appareil doit accepter tout brouillage radioélectrique subi, même si le brouillage est susceptible d'en compromettre le fonctionnement.

This equipment complies with the radiation exposure limits in an uncontrolled environment. This equipment is in direct contact with the user's body under certain operating conditions. This transmitter must not be co-located or operating in conjunction with any other antenna or transmitter.

Cet équipement est conforme aux limites d'exposition aux radiations dans un environnement non contrôlé. Cet équipement est en contact direct avec le corps de l'utilisateur dans des conditions de fonctionnement normales. Cet émetteur ne doit pas être co-localisées ou opérant en conjonction avec toute autre antenne ou transmetteur.

WARRANTY INFORMATION

LIMITED WARRANTY

Current Products Corp. (the "Manufacturer") hereby warrants to Customer that the E-Wand™ (the "Product") is and will remain for a period of one (1) year from the date of delivery to Customer as evidenced by Customer's proof of purchase (the "Warranty Period"), free of defects in materials and workmanship, provided that the Product used for its intended purpose and is properly serviced in accordance with the User's Manual provided to Customer. Subject to the foregoing, if at any time during the Warranty Period the Product fails to conform to the foregoing warranty by reason of defects in materials or workmanship, Customer shall promptly notify Manufacturer in writing, and Manufacturer at its option shall repair or replace the defective Product or component part without charge to Customer, except for: (A) costs incurred in transporting the Products or component parts to and from Manufacturer's designated dealer or its manufacturing plant; and (B) charges for labor or other costs incidental to the removal or remounting of component parts repaired or replaced under this Warranty, both of which shall be borne by Customer. Notwithstanding any provision herein to the contrary, this Warranty shall not extend or obligate Manufacturer to take any action with respect to: (i) Products which have been modified, altered, installed, used or operated in a manner which is not recommended by Manufacturer, including any Products in which parts not manufactured or approved by Manufacturer have

been installed; (ii) Products which have not been regularly and properly serviced in accordance with the User's Manual or which have otherwise been neglected; and (iii) ordinary wear and tear, service and maintenance and replacement items; (iv) the Product has been used, or attempted to be used, for other than the customary usage or for other than the Product's intended use; (v) the Product has been subject to mishandling, misuse, or abuse; (vi) the product has suffered damage resulting from lightning, power surges, vandalism, fire, earthquake, acts of nature, or any other cause which the product was not designed to withstand; or (vii) damage to the Product cause by battery decay or corrosion.

This Limited Warranty extends only to the original owner. This Limited Warranty is not transferable. This Limited Warranty does not cover normal wear or tear or deterioration which occurs with the passage of time. Batteries originally provided with a new product, if any, are produced by a third party and are not warranted by Manufacturer. No employee, distributor, dealer, agent or representative is authorized to change the terms of this Limited Warranty in any way, to extend the warranty time periods, or to grant additional warranties, and no attempt to do any of the foregoing will be binding upon Manufacturer.

LIMITATION OF LIABILITY

EXCEPT AS SPECIFICALLY STATED IN THE PARAGRAPHS IMMEDIATELY ABOVE, MANUFACTURER MAKES NO WARRANTY OR REPRESENTATION, EXPRESS OR IMPLIED, INCLUDING, WITHOUT LIMITATION, ANY WARRANTY OF MERCHANTABILITY OR FITNESS FOR A PARTICULAR PURPOSE. THE WARRANTY SET FORTH ABOVE AND THE OBLIGATIONS AND LIABILITIES OF MANUFACTURER THEREUNDER REPRESENT CUSTOMER'S SOLE AND EXCLUSIVE REMEDIES AND ARE EXPRESSLY MADE IN LIEU OF ANY AND ALL OTHER REMEDIES, WARRANTIES, GUARANTIES OR LIABILITIES, EXPRESS OR IMPLIED, ALL OF WHICH ARE HEREBY EXPRESSLY WAIVED BY CUSTOMER. THERE ARE NO WARRANTIES WHICH EXTEND BEYOND THE DESCRIPTION ON THE FACE HEREOF. IN NO EVENT SHALL MANUFACTURER'S LIABILITY HEREUNDER EXCEED THE PURCHASE PRICE FOR THE PRODUCTS, NOR SHALL MANUFACTURER BE LIABLE FOR ANY SPECIAL, INDIRECT, INCIDENTAL OR CONSEQUENTIAL DAMAGES OF ANY NATURE WHATSOEVER.

OTHER LEGAL RIGHTS

This warranty gives you specific legal rights, and you may also have other rights, which vary from state to state.