

INSIGNIA™

QUICK SETUP GUIDE

2.1 Bluetooth
Speaker
System

NS-PSB4721

PACKAGE CONTENTS

- Satellite speakers (2)
- Subwoofer
- Control pod
- *Quick Setup Guide*

FEATURES

- Wirelessly stream from any Bluetooth device
- Volume and bass controls on the control pod
- Compatible with Bluetooth version V4.2/V4.1/V4.1 BLE, V3.0, & V2.1.



Control Pod

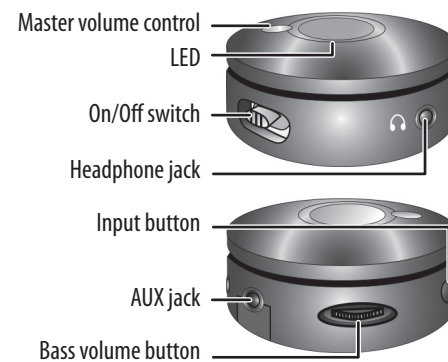

CONNECT THE SPEAKERS

- 1 Plug the satellite speakers into the **To Speaker** jack on the back of the subwoofer.
- 2 Plug the power cable into a power outlet or surge protector.

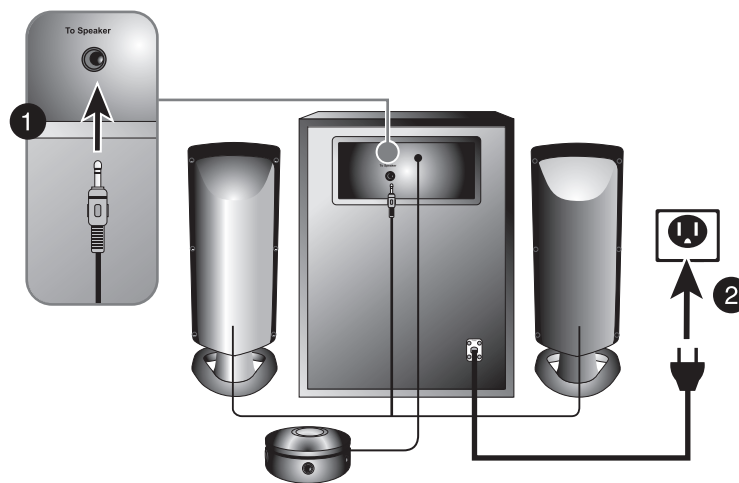

Before using your new product, please read these instructions to prevent any damage.

TURNING YOUR SPEAKERS ON AND OFF

Move the ON/OFF switch on the side of your Control Pod to the ON position. When you first turn on your speakers, they are in Bluetooth pairing mode and the indicator LED blinks blue.



CONNECTING WITH BLUETOOTH

- 1 Make sure that your Bluetooth device is turned on and within 33 feet (10 meters) of your speakers.
- 2 On your control pod, turn your speakers on. The indicator LED blinks blue to indicate that it's in pairing mode.
- 3 Turn on your Bluetooth device and turn on Bluetooth. Set your device to pairing mode, then select **NS-PSB4721**. See the instructions that came with your Bluetooth device for information about pairing.
- 4 If you are asked for a password, enter **0000**. When pairing is complete, the LED lights solid blue.
- 5 To disconnect from the paired Bluetooth device, turn your speakers off.

LED	DESCRIPTION
Blinks blue	Speakers are in pairing mode
Solid blue	Speakers are paired
Solid red	AUX mode

RECONNECTING TO A PAIRED DEVICE

When your speakers are not paired to a device, the LED blinks blue slowly.

Your speakers lose the Bluetooth connection if you...	To reconnect...
Turn off your speakers.	Turn on your speakers. Your speakers search for the last connected Bluetooth device and reconnect.
Move the Bluetooth device out of range.	Make sure that your Bluetooth device is within 33 feet of your speakers.
Turn off your Bluetooth device.	Turn on your Bluetooth device, then make sure that Bluetooth is on.
Turn off Bluetooth on your Bluetooth device.	Turn on Bluetooth on your Bluetooth device.
Connect your Bluetooth device to another Bluetooth device.	Disconnect your Bluetooth device from the other Bluetooth device, then set your device to pairing mode. Select NS-PSB4721 on your Bluetooth device.

LISTENING TO MUSIC

- 1 Turn on your speakers, then connect to your Bluetooth device.
- 2 Press the input select button to select the input you want. The blue LED indicates Bluetooth and the red LED indicates AUX mode.

- 3 Begin playback on your Bluetooth device.
- 4 Adjust the volume on your speakers by turning the master volume control. To control the bass, adjust the bass volume button.

PLAYBACK USING AUX IN

- 1 Connect an external sound source, such as an MP3 player, by plugging a 3.5 mm audio cable (not included) into the AUX jack on your control pod.

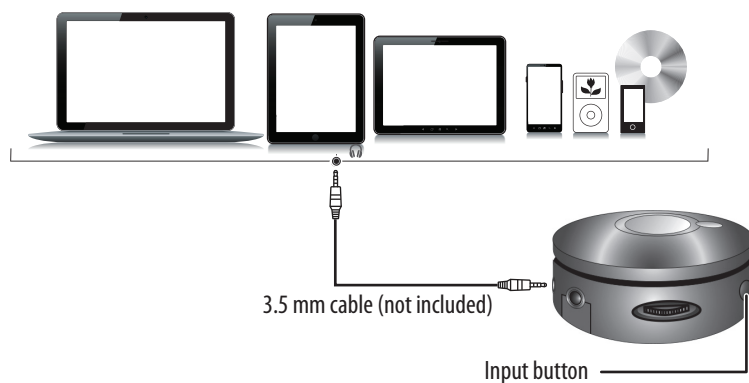

- 2 Press the **Input button** to enter AUX mode. The LED lights red.
- 3 Start playback on the external device.
- 4 Turn the master volume control to adjust the volume.
- 5 Control playback using the controls on the audio device.

TROUBLESHOOTING

PROBLEM	SOLUTION
No power	<ul style="list-style-type: none"> • Make sure that your speakers are plugged in. • Make sure that your speakers are turned on.
No sound or low volume	<ul style="list-style-type: none"> • Make sure that your Bluetooth device is turned on, Bluetooth is turned on, and NS-PSB4721 is selected. • Turn up the volume on your speakers. • Turn up the volume on your Bluetooth device. • Make sure that your Bluetooth device is not muted. • Make sure that your speakers are not paired to another Bluetooth device. • Make sure that your Bluetooth device is not paired to another Bluetooth device.
Cannot establish Bluetooth connection	<ul style="list-style-type: none"> • Shorten the distance between your speakers and your Bluetooth device. • Turn your devices off, then on. Re-pair your speakers and your Bluetooth device. • Make sure that your speakers are not paired to another Bluetooth device. • Make sure that your speakers and Bluetooth device are both in pairing mode. • Make sure that your Bluetooth device supports Bluetooth v4.0 and below. • Make sure that your Bluetooth device is not connected to any other device. • Make sure that you have selected NS-PSB4721 on your Bluetooth device. • If a passcode is needed, enter 0000.

TROUBLESHOOTING

PROBLEM	SOLUTION
My Bluetooth device keeps unpairing	<ul style="list-style-type: none"> • Shorten the distance between your speakers and your Bluetooth device. • If the battery on your Bluetooth device is low, recharge the battery.
"NS-PSB4721" does not appear on my Bluetooth device	<ul style="list-style-type: none"> • Shorten the distance between your speakers and your Bluetooth device. • Put your speakers into pairing mode, then refresh your list of Bluetooth devices. For more information, see the documentation that came with your Bluetooth device.
Sound is distorted	<ul style="list-style-type: none"> • Adjust the master volume control to the ¼ or ½ level. • Adjust volume settings on the output device (computer or portable audio source). • Make sure that all connections are correct and secure.
Sound is coming from one speaker	<ul style="list-style-type: none"> • If your speaker system is connected to a computer, adjust your computer's audio levels to balance the sound coming from the speakers. • Make sure that all connections are correct and secure.

SAFETY INSTRUCTIONS

- 1 Read, follow, and save all instructions and documentation.
- 2 Do not use this apparatus near water.
- 3 Clean only with a dry cloth.
- 4 Do not block any ventilation openings. Install in accordance with the manufacturer's instructions.
- 5 Do not install near any heat sources such as radiators, heat registers, stoves, or other apparatus (including amplifiers) that produce heat.
- 6 Do not defeat the safety purpose of the polarized or grounding-type plug. A polarized plug has two blades with one wider than the other. A grounding type plug has two blades and a third grounding prong. The wide blade or the third prong are provided for your safety. If the provided plug does not fit into your outlet, consult an electrician for replacement of the obsolete outlet.
- 7 Protect the power cord from being walked on or pinched particularly at plugs, convenience receptacles, and the point where they exit from the apparatus.
- 8 Only use attachments/accessories specified by the manufacturer.
- 9 Use only with the cart, stand, tripod, bracket, or table specified by the manufacturer, or sold with the apparatus. When a cart is used, use caution when moving the cart/apparatus combination to avoid injury from tip-over.
- 10 Unplug this apparatus during lightning storms or when unused for long periods of time.
- 11 Refer all servicing to qualified service personnel. Servicing is required when the apparatus has been damaged in any way, such as power-supply cord or plug is damaged, liquid has been spilled or objects have fallen into the apparatus, the apparatus has been exposed to rain or moisture, does not operate normally, or has been dropped.
- 12 Keep the unit in a well-ventilated environment. Do not install this equipment in a confined space such as a bookcase.
- 13 **WARNING:** To reduce the risk of fire or electric shock, do not expose this device to rain, moisture, dripping, or splashing, and no objects filled with liquids, such as vases, shall be placed on it.
- 14 **WARNING:** The wall plug is the disconnecting device. The plug must remain readily operable.
- 15 The apparatus is classified as a class II apparatus.

WARNING: To reduce the risk of fire or electric shock, do not expose this appliance to rain or moisture.



CAUTION: Use of controls or adjustments or performance of procedures other than those specified may result in hazardous radiation or exposure.

CAUTION: TO REDUCE THE RISK OF ELECTRIC SHOCK, DO NOT REMOVE COVER (OR BACK). NO USER-SERVICING TO QUALIFIED SERVICE PERSONNEL.



The lightning flash with arrowhead symbol, within an equilateral triangle, is intended to alert the user to presence of uninsulated "dangerous voltage" within the product's enclosure that may be sufficient magnitude to constitute a risk of electric shock to persons.



The exclamation point within an equilateral triangle is intended to alert the user to the presence of important operating and maintenance (servicing) instructions in the literature accompanying the appliance.

LEGAL NOTICES

This device complies with Part 15 of the FCC Rules. Operation is subject to the following two conditions: (1) this device may not cause harmful interference, and (2) this device must accept any interference received, including interference that may cause undesired operation.

FCC Caution:

This device complies with Part 15 of the FCC Rules. Operation of this product is subject to the following two conditions: (1) this device may not cause harmful interference, and (2) this device must accept any interference received, including interference that may cause undesired operation.

This equipment has been tested and found to comply within the limits for a class B digital device, pursuant to Part 15 of the FCC Rules. These limits are designed to provide reasonable protection against harmful interference in a residential installation. This equipment generates, uses, and can radiate radio frequency energy and, if not installed and used in accordance with the instructions, may cause harmful interference to radio communications. However, there is no guarantee that interference will not occur in a particular installation. If this equipment does cause harmful interference to radio or television reception, which can be determined by turning the equipment off and on, the user is encouraged to try to connect the interference by one or more of the following measures:

- Reorient or relocate the receiving antenna.
- Increase the separation between the equipment and receiver.
- Connect the equipment into an outlet on a circuit different from that to which the receiver is connected.
- Consult the dealer or an experienced radio/TV technician for help.

FCC warning

Changes or modifications not expressly approved by the party responsible for compliance with the FCC Rules could void the user's authority to operate this equipment.

The equipment complies with FCC Radiation exposure limits set forth for uncontrolled environment.

and your body.

Canada ICES-003 statement

This Class B digital apparatus complies with Canadian ICES-003.

This device complies with Industry Canada licence-exempt RSS standard(s). Operation is subject to the following two conditions: (1) this device may not cause interference, and (2) this device must accept any interference, including interference that may cause undesired operation of the device.

Cet appareil est conforme à Industrie Canada exempts de licence standard RSS (s). Le fonctionnement est soumis aux deux conditions suivantes: (1) ce dispositif ne peut pas provoquer d'interférences et (2) cet appareil doit accepter toute interférence, y compris les interférences qui peuvent causer un mauvais fonctionnement de l'appareil.

ONE-YEAR LIMITED WARRANTY

Visit www.insigniaproducts.com for details.

CONTACT INSIGNIA:

1-877-467-4289 (U.S. and Canada)

01-800-926-3000 (Mexico)

www.insigniaproducts.com

INSIGNIA is a trademark of Best Buy and its affiliated companies
Distributed by Best Buy Purchasing, LLC
7601 Penn Ave South, Richfield, MN 55423 U.S.A.
©2016 Best Buy. All rights reserved.
Made in China