



DCH-G601W/DCH-G601WA1

User's Manual

Version 1.0

March 23th, 2018

Table of Contents

1. PRODUCT DESCRIPTION3
2. APPEARANCE3
3. APPLICATIONS4
4. INSTALLATIONS5
5. SYSTEM REQUIREMENT.....13

1. PRODUCT DESCRIPTION

The DCH-G601W/DCH-G601WA1 Wi-Fi Bluetooth Hub is a high-performance and secure Connected Home Bluetooth gateway used the latest Bluetooth technology combined with Afero security chip, the Bluetooth Hub allows your devices to communicate with one another. The Hub built in with most secured Afero encryption chipset. You can pair with Afero’s Bluetooth equipped smart home devices to the hub to manage, operate, and enjoy the convenience of smart home. The hub has backup battery which keep you smart home devices online all the time.

2. APPEARANCE

DCH-G601W Hub



Status LED

Status	Description
Solid Green	Afero & Internet active
Solid Orange	Internet active
Solid Red	No internet



Front

- LED: Status indicator

Rear

- Micro USB: Power jack, Vdc $\overline{\text{---}}\overline{\text{---}}\overline{\text{---}}$ 5V/2A, Cable length: 1.5 meters
- Micro SD card: microSD slot, support SD/SDHC/SDXC, up to 128G
- Reset button: [1]Reset[2] Reset to factory default (>=press 10 seconds)
- WPS button: TBD
- Tripod: for external stand. (TBD)

3. APPLICATIONS

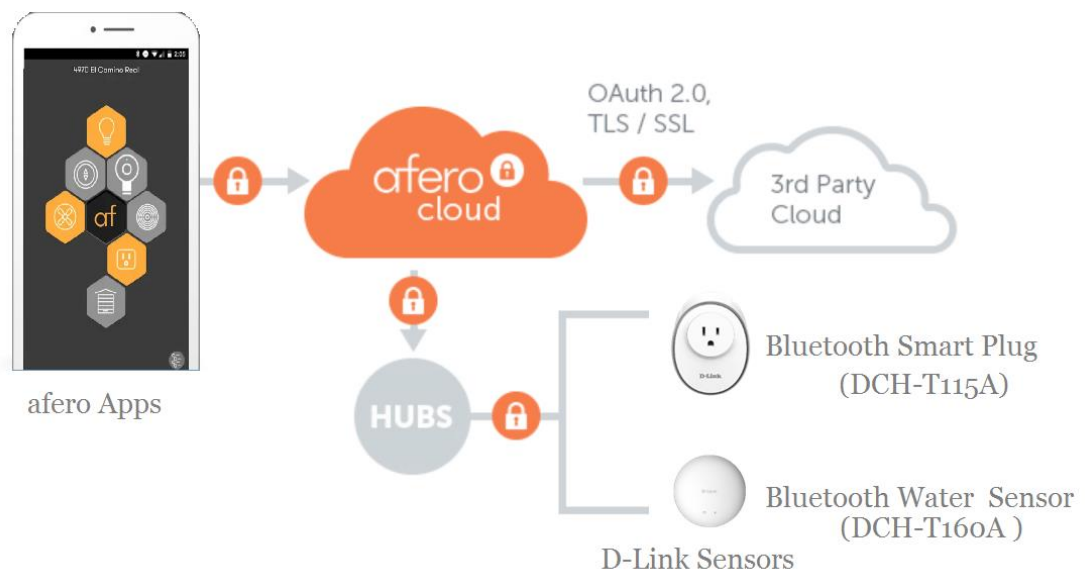

4. INSTALLATIONS

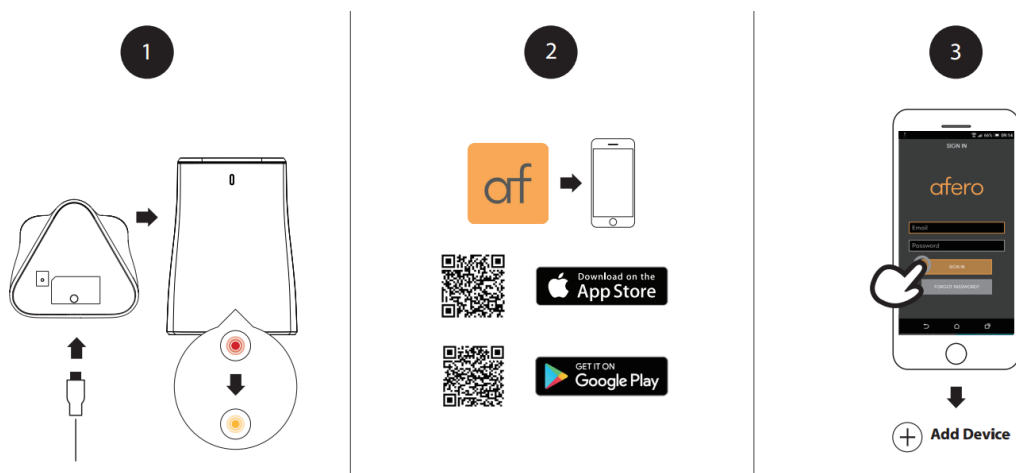

Step 1 Plug the included Power Adapter into the back of the hub.
Red LED: user ca binding, go to step 2.

Step 2. Download afero App to your smart phone and register an account to login.
or scan the QR code for your iOS or Android phone.



iOS



Android

Step 3 New users: Tap New users, sign up here to install your Hub.
Existing users: Sign in to your afero account and tap Add a Device on the next screen.

Step 4 Adding the Hub to your account

Note: The QR code on the bottom of the device is unique to the device itself.
Please be sure to scan each device individually during set up.

- I. Click on the (af) icon and then click on Add Device.



- II. Apply power to the Hub and Scan QR code located on the bottom of the device.



III. Give the device a name and click Save.

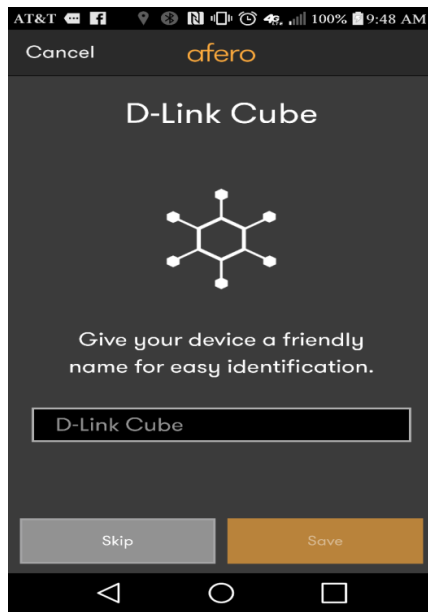

IV. Select WiFi network from list.



- V. Type in password of WiFi network and click connect.

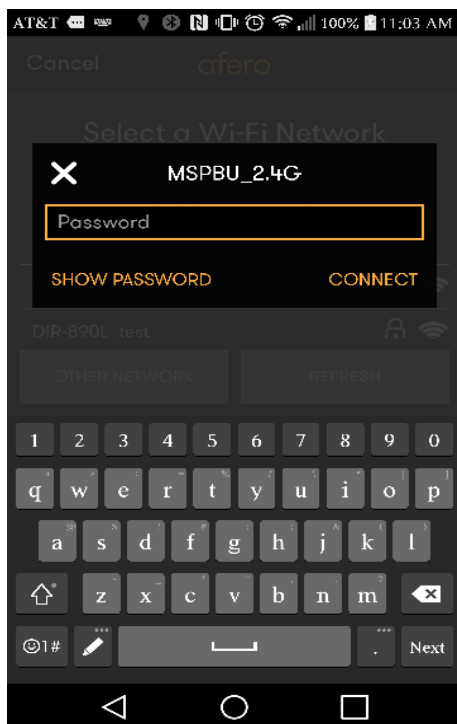

- VI. Your device is now connected.

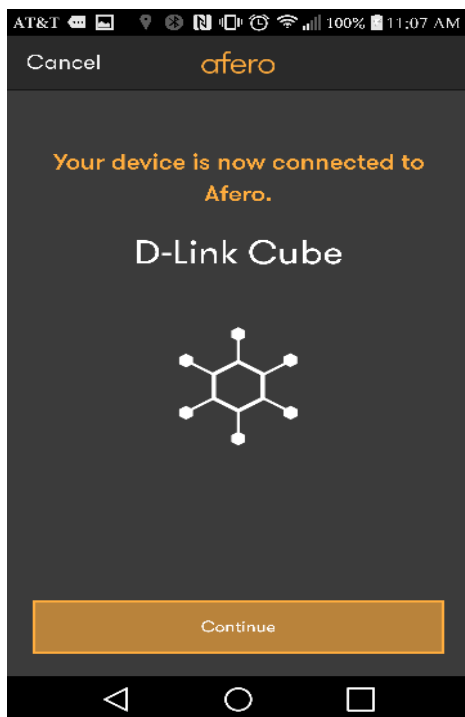

VII. Click continue to see Hub is Online.



Step 5 add sensor into your account

1. Adding Smart plug to account.

I. Click on Add Device.

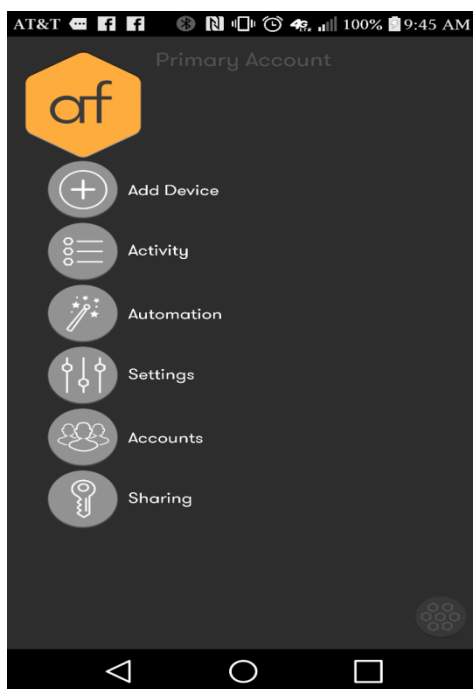

II. Scan QR code on bottom of Smart Plug and plug into outlet.



III. Give your device a name.

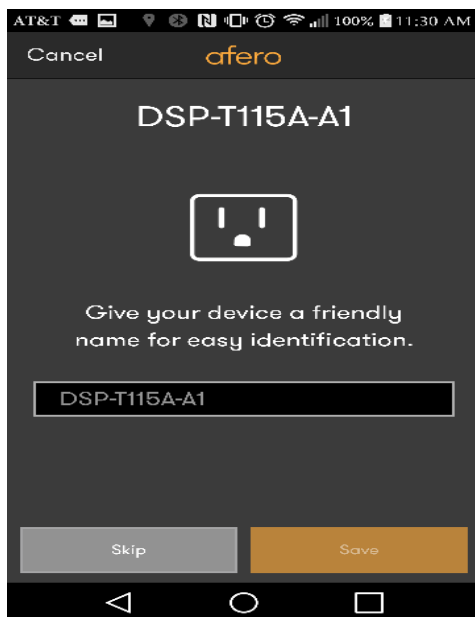

IV. Click save and see if your Device is Online/Active.



2. Adding Water Sensor to Account.

I. Click on Add Device.

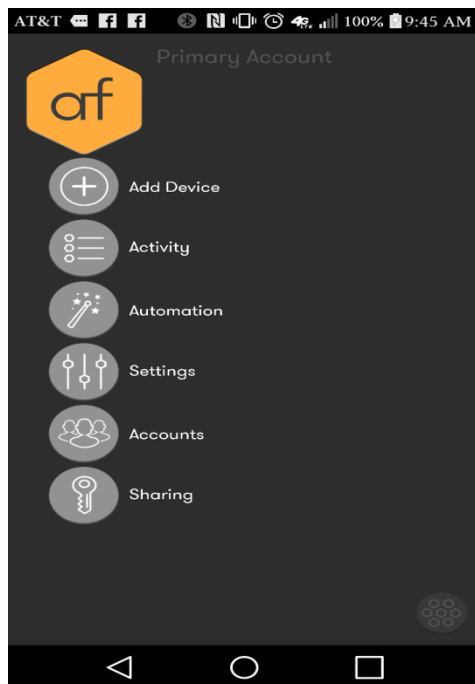

II. Scan QR code on bottom of Water Sensor.



III. Check to see if your Water Sensor is Online.



IV. After finishing setup, all 3 of your devices should now be showing Online/Active in the App. See above picture.

5. SYSTEM REQUIREMENTS

Minimum Requirements:

- Wireless router: 802.11 n/g
- Internet connection
- A mobile device with Bluetooth 4.0 is required for setup.
- The latest version of the afero app from your operating system's application store.
- The afero app is available for iPhone, iPad and Android devices.
Please refer to the mobile app's store page to check whether your device is compatible.
- An e-mail account (required to register for afero service).

Federal Communication Commission Interference Statement

This device complies with Part 15 of the FCC Rules. Operation is subject to the following two conditions: (1) This device may not cause harmful interference, and (2) this device must accept any interference received, including interference that may cause undesired operation.

This equipment has been tested and found to comply with the limits for a Class B digital device, pursuant to Part 15 of the FCC Rules. These limits are designed to provide reasonable protection against harmful interference in a residential installation. This equipment generates, uses and can radiate radio frequency energy and, if not installed and used in accordance with the instructions, may cause harmful interference to radio communications. However, there is no guarantee that interference will not occur in a particular installation. If this equipment does cause harmful interference to radio or television reception, which can be determined by turning the equipment off and on, the user is encouraged to try to correct the interference by one of the following measures:

- Reorient or relocate the receiving antenna.
- Increase the separation between the equipment and receiver.
- Connect the equipment into an outlet on a circuit different from that to which the receiver is connected.
- Consult the dealer or an experienced radio/TV technician for help.

FCC Caution: Any changes or modifications not expressly approved by the party responsible for compliance could void the user's authority to operate this equipment.

This transmitter must not be co-located or operating in conjunction with any other antenna or transmitter.

FOR MOBILE DEVICE USAGE (>20cm/low power)

Radiation Exposure Statement:

This equipment complies with FCC radiation exposure limits set forth for an uncontrolled environment. This equipment should be installed and operated with minimum distance **20cm** between the radiator & your body.

Industry Canada statement:

This device complies with ISED's licence-exempt RSSs. Operation is subject to the following two conditions: (1) This device may not cause harmful interference, and (2) this device must accept any interference received, including interference that may cause undesired operation.

Le présent appareil est conforme aux CNR d'ISED applicables aux appareils radio exempts de licence. L'exploitation est autorisée aux deux conditions suivantes : (1) le dispositif ne doit pas produire de brouillage préjudiciable, et (2) ce dispositif doit accepter tout brouillage reçu, y compris un brouillage susceptible de provoquer un fonctionnement indésirable.

FOR MOBILE DEVICE USAGE (>20cm/low power)

Radiation Exposure Statement:

This equipment complies with ISED radiation exposure limits set forth for an uncontrolled environment. This equipment should be installed and operated with minimum distance **20cm** between the radiator & your body.

Déclaration d'exposition aux radiations:
Cet équipement est conforme aux limites d'exposition aux rayonnements ISED établies pour un environnement non contrôlé. Cet équipement doit être installé et utilisé avec un minimum de 20 cm de distance entre la source de rayonnement et votre corps.