



**English**

**How to program the SurroundBar®3000 Instant Home Theater™ to work with your existing remote:**  
(Example shown is for "Volume Up" control.)

**Important Note:** If adjusting your TV's volume also adjusts the volume of your SurroundBar 3000, then following the instructions below is not necessary. Your remote will control the SurroundBar 3000 without programming.

**Programming Instructions:** Your SurroundBar 3000 is currently programmed to respond to the remote control that is included with the product. However, we strongly recommend that you program the SurroundBar 3000 to also respond to your existing remote control using the steps illustrated below thereby enabling you to operate everything using a single remote.

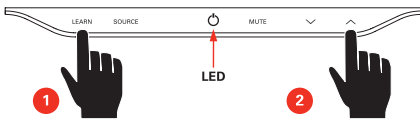

1 Press and hold "LEARN" on the SurroundBar 3000 until the LED blinks orange.

2 Press "Volume Up" (^). LED turns orange.

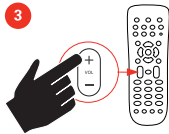

3 While holding your remote within 1-2 feet of the bar, press the "Volume Up" (^) button on your TV's remote control for 1 second and then release the button for 1 second. Repeat this process until the LED blinks green.

Repeat steps 1-3 to program Volume (v / ^), Mute and Power buttons (O).

Polk Audio Customer Service 1-800-377-7655 (M-F, 9-6 ET, USA & Canada only) or via email polkcs@polkaudio.com. (Worldwide: 1-410-358-3600).

**Français**

**Comment programmer le SurroundBar®3000 Instant Home Theater™ pour qu'il réponde à la télécommande courante:**  
(L'exemple illustré s'applique au contrôle «Volume Up».)

**Note importante:** Si la télécommande de votre téléviseur contrôle également le volume de votre SurroundBar 3000, les instructions ci-dessous ne sont pas nécessaires. Votre télécommande courante contrôle déjà le SurroundBar 3000 sans devoir être programmée.

**Programmation:** Votre SurroundBar 3000 est préprogrammée pour répondre à la télécommande qui est fournie avec le produit. Cependant, nous vous conseillons fortement de programmer le SurroundBar 3000 pour qu'il réponde aussi à la télécommande courante. En suivant les étapes illustrées ci-dessous vous pourrez tout contrôler en utilisant une seule télécommande.

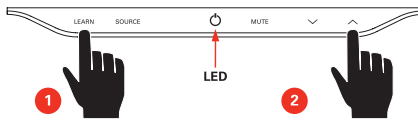

1 Appuyez et maintenez la touche «LEARN» du SurroundBar 3000. La DEL clignote orange.

2 Appuyez sur «Volume Up» (^). La DEL luit orange.

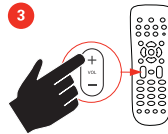

3 Tenant votre télécommande à 30 à 60 cm du SurroundBar, appuyez sur le bouton «Volume Up» (^) de la télécommande de votre téléviseur pour 1 seconde puis relâchez le bouton pour 1 seconde. Répétez cette opération jusqu'à ce que la DEL clignote vert.

Répétez les étapes 1 à 3 pour programmer les boutons Volume (v / ^), Mute (sourdisse) et Power (tension) (O).

Service à la Clientèle Polk Audio: 1-800-377-7655 (Lun. au ven., 9-18 HE, É.-U. et Canada seulement. International: 1-410-358-3600) ou par courriel: polkcs@polkaudio.com.

**Español**

**Programación del cine en casa instantáneo Instant Home Theater™ con barra de altavoces SurroundBar®3000 para que funcione con el control remoto existente:** (En el ejemplo se muestra el procedimiento para el control de subida de volumen.)

**Nota importante:** Si ajusta el volumen del televisor también ajusta el volumen de la barra de altavoces SurroundBar 3000, no es necesario seguir las instrucciones que aparecen a continuación. El control remoto controlará la barra de altavoces SurroundBar 3000 sin necesidad de programación.

**Instrucciones De Programación:** La barra de altavoces SurroundBar 3000 ha sido programada para que responda al control remoto que viene con el producto. Sin embargo, le recomendamos enfáticamente que, por medio de los pasos que se indican a continuación, usted programe el SurroundBar 3000 para que también responda al control remoto existente a fin de hacer funcionar todo con un solo control remoto.

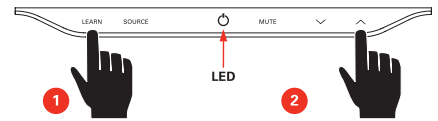

1 Oprima y mantenga oprimido el botón de aprendizaje LEARN de la SurroundBar 3000. El indicador LED parpadea de color naranja anaranjado.

2 Oprima el botón de subida de volumen (^). El indicador LED deja de parpadear.

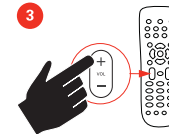

3 Con el control remoto a una distancia de 1 a 2 pies de la barra de altavoces, oprima el botón de subida de volumen (^) del control remoto del televisor, manténgalo oprimido durante 1 segundo, suéltelo y espere 1 segundo. Repita el proceso hasta que el indicador LED parpadee de color verde.

Repita los pasos 1 a 3 para programar los botones de volumen (v / ^), silenciador (Mute) y alimentación (Power) (O).

Servicio al cliente de Polk Audio: 1-900-377-7655 (9 a 6, hora Este, de lunes a viernes, sólo en Estados Unidos y Canadá), 1-410-358-3600 (en todo el mundo) o polkcs@polkaudio.com. HBP1976

**A English Panel**

**B French Panel**

**C Spanish Panel**

**Remote Control Guide Artwork**  
Scale: Full Size

polkaudio			
Date	22 Oct 2009	Approvals	Signature
Drawing #	HBP1976	Project Manager	
File Name	IHT3000_RCGuide_1976.eps	Product Line Manager	
Scale	Full Size	Mechanical Designer	
Drawn By	KLB	System Engineer	
Color	100% Black & PMS485	Electrical Engineer	
Emboss Ht.	n/a	Safety & Regulations	
Deboss Depth	n/a	Quality Assurance	
Finish	n/a	Creative Director	
Process	Offset lithography	Comments	
Notes	Prints on 8.5" x 14" Tri-Fold		
	Dieline and Folds DO NOT Print		
Artwork	Digital file		

Revision	Date	Description

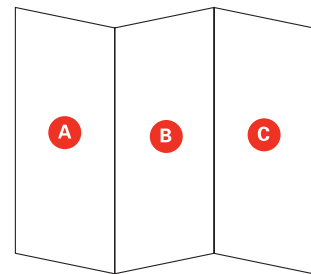

**Example of Tri-Fold Layout**  
Locations of Panels: A, B & C

## ENGLISH

### IMPORTANT SAFETY INSTRUCTIONS

This product was designed and manufactured to meet strict quality and safety standards. There are, however, some installation and operation precautions which you should be particularly aware of.

1. Read Instructions. All the safety and operating instructions should be read before the system is operated.
2. Retain Instructions. The safety and operating instructions should be retained for future reference.
3. Heed Warnings. All warnings on the appliances and in the operating instructions should be adhered to.
4. Follow Instructions. All operating and use instructions should be followed.
5. Cleaning. Unplug the appliance from wall outlet before cleaning. Do not use liquid cleaners or aerosol cleaners. Use a damp cloth for cleaning.
6. Attachments. Do not use attachments not recommended by the product manufacturer as they may cause hazards.
7. Water and Moisture. Do not use these appliances near water for example, near a bath tub, washbowl, kitchen sink, or laundry tub, in a wet basement, or near a swimming pool, and the like.
8. Accessories. Do not place these appliances on an unstable cart, stand, tripod, bracket, or table. The audio/video products may fall, causing serious injury to a child or adult, and serious damage to the products. Use only with a cart, stand, tripod, bracket, or table recommended by the manufacturer, or sold with the appliances. Any mounting of the appliances should follow the manufacturer's instructions, and should use mounting accessories recommended by the manufacturer.
9. Ventilation. Slots and openings in the cabinet are provided for ventilation and to ensure reliable operation of the appliances and to protect them from overheating, and these openings must not be blocked or covered. The openings should never be blocked by placing the products on a bed, sofa, rug, or other similar surface. This product should never be placed near or over a radiator or heat register. This product should not be placed in a built-in installation such as a bookcase or rack unless proper ventilation is provided or the manufacturer's instructions have been adhered to.
10. Power Sources. This product should be operated only from the type of power source indicated on the marking labels. If you are not sure of the type of power supply to your home, consult your appliance dealer or local power company.
11. Grounding or Polarization. This product is equipped with polarized alternating-current line plugs (plugs having one blade wider than the other). This plug will fit into the power outlet only one way. This is a safety feature. If you are unable to insert the plug fully into the outlet, try reversing the plug. If the plug should still fail to fit, contact your electrician to replace your obsolete outlet. Do not defeat the safety purpose of the polarized plug.
12. Power Cord Protection. Power-supply cord should be routed so that it is not likely to be walked on or pinched by items placed upon or against it, paying particular attention to cords at plugs, convenience receptacles, and the point where they exit from the appliances.
13. Lightning. For added protection for this audio/video product during a lightning storm, or when it is left unattended and unused for long periods of time, unplug it from the wall outlet and disconnect the antenna or cable system. This will prevent damage to the product due to lightning and power-line surges.
14. Power Lines. An outside antenna system should not be located in the vicinity of overhead power lines or other electric light or power circuits, or where it can fall into such power lines or circuits. When installing an outside antenna system, extreme care should be taken to keep from touching such power lines or circuits as contact with them might be fatal.
15. Overloading. Do not overload wall outlets and extension cords as this can result in a risk of fire or electric shock.
16. Object and Liquid Entry. Never push objects of any kind into this product through openings, as they may touch dangerous voltage points or short out parts that could result in a fire or electric shock. Never spill liquid of any kind on this audio/video product.
17. Servicing. Do not attempt to service this product yourself, as opening or removing covers may expose you to dangerous voltage or other hazards. Refer all servicing to qualified service personnel.
18. Damage Requiring Service. Unplug this product from wall outlets and refer servicing to qualified service personnel under the following conditions:
  - a. When the power supply cord or plug is damaged.
  - b. If liquid has been spilled, or objects have fallen into the product.

- c. If the product has been exposed to rain or water.
  - d. If the product does not operate normally by following the operating instructions. Adjust only those controls that are covered by the operating instructions, as an improper adjustment of other controls may result in damage and will often require extensive work by a qualified technician to restore the product to its normal operation.
  - e. If the product has been dropped or the cabinet has been damaged.
  - f. When the product exhibits a distinct change in performance this indicates a need for service.
19. Replacement Parts. When replacement parts are required, be sure the service technician has used replacement parts specified by the manufacturer or that the parts have the same characteristics as the original part. Unauthorized substitutions may result in fire, electric shock or other hazards.
  20. Safety Check. Upon completion of any service or repairs to this product, ask the service technician to perform safety checks to determine that the products are in proper operating condition.
  21. Carts and Stands. The appliances should be used only with a cart or stand that is recommended by the manufacturer. An appliance and cart combination should be moved with care. Quick stops, excessive force, and uneven surfaces may cause the appliance and cart combination to overturn. Use caution when moving the cart/apparatus combination to avoid injury from tip-over.
  22. This product is not intended for use outdoors.



The **CAUTION** marks shown here are located on the back of your SurroundBar® Speaker System



**CAUTION:** To prevent electric shock, match wide blade of plug to wide slot, insert fully.



**CAUTION:** No naked flame sources, such as candles, should be placed on the apparatus.

### Class B Emissions Limits

This Class B digital apparatus meets all requirements of the Canadian Interference—Causing Equipment Regulations.

### Operation

Operation is subject to the following two conditions:

- 1) This device may not cause interference, and
- 2) This device must accept any interference, including interference that may cause undesired operation of the device.

### Product Disposal

Certain international, national and/or local laws and/or regulations may apply regarding the disposal of this product. For further detailed information, please contact the retailer where you purchased this product or the Polk Audio Importer/Distributor in your country. A listing of Polk Audio Importer/Distributors can be found on the Polk Audio website [www.polkaudio.com](http://www.polkaudio.com) or by contacting Polk Audio at: 5601 Metro Drive, Baltimore, Maryland 21215, USA. Phone: +1-410-358-3600; in California: 1-800-377-7655.



### NOTE:

This equipment has been tested and found to comply with the limits for a Class B digital device, pursuant to part 15 of the FCC Rules. These limits are designed to provide reasonable protection against harmful interference in a residential installation. This equipment generates, uses and can radiate radio frequency energy, and, if not installed and used in accordance with the instructions, may cause harmful interference to radio communications. However, there is no guarantee that interference will not occur in a particular installation. If this equipment does cause harmful interference to radio or television reception, which can be determined by turning the equipment off and on, the user is encouraged to try to correct the interference by one or more of the following measures:

Reorient or relocate the receiving antenna.  
Increase the separation between the equipment and receiver.  
Connect the equipment into an outlet on a circuit different from that to which the receiver is connected.  
Consult the dealer or an experienced radio/TV technician for help.

## LIMITED WARRANTY

Polk Audio, Inc., warrants to the original retail purchaser only. This warranty will terminate automatically prior to its stated expiration if the original retail purchaser sells or transfers the Product to any other party. Polk Audio, Inc., warrants, to the original retail purchaser only, that the LOUDSPEAKER(S), PASSIVE CROSSOVER COMPONENT(S) and ENCLOSURE on this Polk Audio Loudspeaker Product will be free from defects in material and workmanship for a period of three (3) years from the date of original retail purchase from a Polk Audio Authorized Dealer. Furthermore, Polk Audio, Inc., warrants, to the original retail purchaser only, that any AMPLIFIER OR OTHER ELECTRONIC COMPONENT that may be included in this Polk Audio Loudspeaker Product will be free from defects in material and workmanship for a period of one (1) year from the date of original retail purchase from a Polk Audio Authorized Dealer. To allow Polk Audio to offer the best possible warranty service, please fill out the Product Registration Card(s) and send it to the Factory at the address provided on the Product Registration Card(s) within ten (10) days of the date of original purchase. Defective Products must be shipped, together with proof of purchase, prepaid insured to the Polk Audio Authorized Dealer from whom you purchased the Product, or to the Factory at 1 Viper Way, Vista, California 92081. Products must be shipped in the original shipping container or its equivalent; in any case the risk of loss or damage in transit is to be borne by you.

If upon examination at the Factory or Polk Audio Authorized Dealer it is determined that the unit was defective in materials or workmanship at any time during this Warranty period, Polk Audio or the Polk Audio Authorized Dealer will, at its option, repair or replace this Product at no additional charge, except as set forth below. All replaced parts and Products become the property of Polk Audio. Products replaced or repaired under this warranty will be returned to you, within a reasonable time, freight prepaid. This warranty does not include service or parts to repair damage caused by accident, disaster, misuse, abuse, negligence, inadequate packing or shipping procedures, commercial use, voltage inputs in excess of the rated maximum of the unit, cosmetic appearance of cabinetry not directly attributable to defect in materials or workmanship, or service, repair, or modification of the Product which has not been authorized or approved by Polk Audio. This warranty shall terminate if the serial number on the Product has been removed, tampered with or defaced.

This warranty is in lieu of all other expressed Warranties. If this Product is defective in materials or workmanship as warranted above, your sole remedy shall be repair or replacement as provided above. In no event will Polk Audio, Inc. be liable to you for any incidental or consequential damages arising out of the use or inability to use the Product, even if Polk Audio, Inc., or a Polk Audio Authorized Dealer, has been advised of the possibility of such damages, or for any claim by any other party. Some states do not allow the exclusion or limitation of consequential damages, so the above limitation and exclusion may not apply to you. All implied warranties on this Product are limited to the duration of this expressed Warranty. Some states do not allow limitation on how long an implied Warranty lasts, so the above limitations may not apply to you. This Warranty gives you specific legal rights, and you also may have other rights which vary from state to state. This Warranty applies only to Products purchased in the United States of America, its possessions, and U.S. and NATO armed forces exchanges and audio clubs.

The Warranty terms and conditions applicable to Products purchased in other countries are available from the Polk Audio Authorized Distributors in such countries.

## CUSTOMER SERVICE

Thank you for buying the Polk Audio SurroundBar 3000 Instant Home Theater. If you have a question or comment, please feel free to call us or email us. In North America and Canada, call Polk Audio Customer Service 800-377-7655 (M-F, 9-6 EST) or via email [polkcs@polkaudio.com](mailto:polkcs@polkaudio.com). Outside the US, call 410-358-3600.

## WARNING: LISTEN CAREFULLY

**Polk Audio loudspeakers and subwoofers are capable of playing at extremely high volume levels, which could cause serious or permanent hearing damage. Polk Audio, Inc. accepts no liability for hearing loss, bodily injury or property damage resulting from the misuse of its products.**

Keep these guidelines in mind and always use your own good judgment when controlling volume:

- You should limit prolonged exposure to volumes that exceed 85 decibels(dB).
- High volume in an automobile can hinder your ability to safely operate a vehicle.
- You are responsible for knowing the local laws governing acceptable mobile volume levels.

For more about safe volume levels, go to: [www.polkaudio.com/education/article/SPL/](http://www.polkaudio.com/education/article/SPL/).

Or refer to the Occupational Health and Safety Administration (OSHA) guidelines at: [www.osha.gov/dts/osta/otm/noise/standards\\_more.html](http://www.osha.gov/dts/osta/otm/noise/standards_more.html).

**polkaudio**<sup>®</sup>

5601 Metro Drive  
Baltimore, MD 21215



HBP1981

***FCC Caution:*** To assure continued compliance, any changes or modifications not expressly approved by the party responsible for compliance could void the user's authority to operate this equipment. (Example - use only shielded interface cables when connecting to computer or peripheral devices).

***FCC Radiation Exposure Statement***

This equipment complies with FCC RF radiation exposure limits set forth for an uncontrolled environment. This equipment should be installed and operated with a minimum distance of 20 centimeters between the radiator and your body.

This transmitter must not be co-located or operating in conjunction with any other antenna or transmitter.

The antennas used for this transmitter must be installed to provide a separation distance of at least 20 cm from all persons and must not be co-located or operating in conjunction with any other antenna or transmitter.