



## Color Changing LED Bulb

### App Controlled



Operation Manual FB-BAPP

Thank you for purchasing the Vibe™ Color Changing Light Bulb with App Control. Please read all instructions carefully before using and retain this manual for future reference.

#### SAFETY INSTRUCTIONS

Keep the unit away from heat sources, direct sunlight, humidity, water and any other liquids.

Do not operate the unit if it has been exposed to water, moisture or any other liquids to prevent against electric shock, explosion and/or injury to yourself and damage to the unit.

Do not use the unit if it has been dropped or damaged in any way.

Repairs to electrical equipment should only be performed by a qualified electrician. Improper repairs may place the user at serious risk.

Do not puncture or harm the exterior surface of the product in any way.

Keep the unit free from dust, lint, etc.

Do not use this unit for anything other than its intended use or purpose. Doing so may damage the device.

This product is not a toy. Keep out of reach of children.

CAUTION: Risk of Electrical Shock – Use in Dry Locations Only.

This device is not intended for use with emergency exit fixtures or emergency exit lights.

#### SPECIFICATIONS

- Socket Type: E26 Standard
- Voltage: AC 100-240V
- Wattage: 1.5W
- Light Color: RGB
- Light Source: SMD 5050
- Dimension: 1.93 in. x 3.08 in.
- Remote Battery: CR2025 (Battery included with remote)
- Remove safety strip before use.
- FCC ID: 2AANZBAPP

#### CARE AND MAINTENANCE

- Do not expose the bulb to liquid, moisture, or humidity to avoid damage to the product's internal circuitry.
- Do not use abrasive cleaning solvents to clean the unit.
- Do not expose the bulb to extremely high or low temperatures as this will shorten the life of the electronic device, destroy the battery, and/or distort certain plastic parts.
- Do not dispose of the bulb in fire as they may explode or combust.
- Do not expose the bulb to contact with sharp objects as this will cause scratches and damage.
- Do not let the bulb fall from high places, as doing so may damage the internal circuitry.
- Do not attempt to disassemble the bulb.

In the event that the bulb does not function properly, return it to the store where it was purchased.

#### PREPARING THE REMOTE CONTROL

The battery has been pre-loaded into the battery compartment for your convenience.

When using the remote for the first time, pull out the insulation sheet. 2

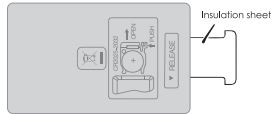

#### REPLACING THE BATTERY IN REMOTE

Remove the rear battery compartment door and open the battery compartment.

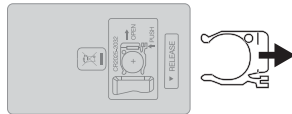

Insert a new CR2025 battery into the compartment by matching the correct polarity. Replace the battery compartment and secure door with a screw.

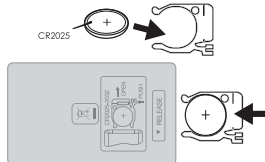

#### NOTES

If you are not using the remote for an extended period of time, remove the battery to prevent corrosion in the event of battery leakage.

When disposing of batteries, please take into account the protection of the environment and strictly follow your local laws and regulations for disposal of these batteries.

#### CAUTION

- Do not dispose of batteries in a fire, as doing so may cause them to explode or leak.
- Batteries must not be exposed to excessive heat such as sunlight, fire, or other similar things.
- Risk of explosion if the battery is replaced with an incorrect type. Use only an identical battery or equivalent.

#### BULB MODES & CONTROLS

After you install your bulb, you can choose your own light color, light mode and brightness.

The four pre-programmed modes changes colors automatically:

- Flash
- Strobe
- Fade
- Smooth

#### ⚠ WARNING: TO AVOID BATTERY LEAKAGE

- 1) Be sure to insert the battery correctly, and always follow battery manufacturers' instructions.
- 2) Always remove a weak or dead battery from the product.
- 3) Remove the battery if the product is left unused for a long period of time.

FCC Statement

This device complies with part 15 of the FCC Rules. Operation is subject to the following two conditions: (1) This device may not cause harmful interference, and (2) this device must accept any interference received, including interference that may cause undesired operation.

Please note that changes or modifications not expressly approved by the party responsible for compliance could void the user's authority to operate the equipment.

#### FCC INSTRUCTIONS FOR A CLASS B DIGITAL DEVICE OR PERIPHERAL FCC Radiation Exposure Statement:

This transmitter must not be co-located or operating in conjunction with any other antenna or transmitter. To maintain compliance with the FCC's RF exposure guidelines, place the equipment at least 20cm from nearby persons.

Note: This equipment has been tested and found to comply with the limits for a Class B digital device, pursuant to part 15 of the FCC Rules. These limits are designed to provide reasonable protection against harmful interference in a residential installation. This equipment generates, uses and can radiate radio frequency energy and, if not installed and used in accordance with the instructions, may cause harmful interference to radio communications. However, there is no guarantee that interference will not occur in a particular installation. If this equipment does cause harmful interference to radio or television reception, which can be determined by turning the equipment off and on, the user

is encouraged to try to correct the interference by one or more of the following measures:

- Reorient or relocate the receiving antenna.
- Increase the separation between the equipment and receiver.
- Connect the equipment into an outlet on a circuit different from that to which the receiver is connected.
- Consult the dealer or an experienced radio/TV technician for help.

#### SCAN OR CODE OR VISIT LINK BELOW TO DOWNLOAD THE FREE APP

App Link:  
<https://apps.apple.com/cn/app/mirror-light/id1512313215>

