

QUADRONE Scarab Instruction Manual

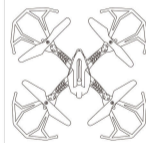

Introduction

- Thank you for choosing Quadro! This is a fun way to fly that can be enjoyed by everyone. In order to make it easier to control the Scarab, please read this manual before operating your Quadro. Please keep this manual for future reference.
- Before your first flight, please take the time to carefully read the manual containing important flight information which will help you first flight go more smoothly.

Table of Contents

Introduction	1
Table of Contents	1
Warning	1
Additional Warnings and Precautions	2
Safety Notes	2
Quadrone Diagram	3
Remote Controller Battery Installation	4
Charging Your Drone	4
Synchronizing the Quad and Remote	5
Practice Tip	7
Practical Tip	7
Speed Selection	8
Flight Mode	8
One Key Return	8
Headless Mode	9
Changing the Beeps	9
Troubleshooting	11
Notice	

Warning

Read the ENSTE instruction manual to become familiar with the features of the product before operating. Failure to operate the product correctly can result in damage to the product, personal property or cause serious injury. This is a sophisticated hobby product. It must be operated with caution and common sense, and requires some basic technical ability. Failure to operate the product in a safe and responsible manner could result in injury or damage to the product or property. This product is not intended for use by children without direct adult supervision. This manual contains instructions for safety, operation and maintenance. It is essential to read and follow all the instructions and warnings in this manual, prior to assembly, set up or use, in order to operate correctly and avoid damage or serious injury.

Additional Warnings and Precautions

1. Age Recommendation: Not for children under 14 years of age. This is not a toy.
2. Always operate in open spaces away from obstacles, people, animals, and structures.
3. Always follow directions and warnings for this and any optional equipment (camera, charger, rechargeable battery packs, etc.)
4. Always keep small parts and electrical parts out of the reach of children.
5. Always avoid water exposure to all equipment not specifically designed and protected for the purpose. Moisture can cause damage to electronics.
6. Never place any portion of the metal in your mouth as it could cause serious injury or even death.
7. Never operate your model with low batteries.

Safety Notes

- If this is your first time flying a quadcopter read the manual carefully. Seek the help of an experienced pilot to help you fly. These safety instructions are intended not only for the protection of your Quadro but also to protect your own safety. Improper operation can cause injury or property damage.
- This product is suitable for indoor and outdoor use. Please make sure you choose a flight area with no obstacles and maintain a safe distance from people and pets. Do not operate near power lines.

RC models are composed of many precise electrical components. It is important to keep the model and associated equipment away from moisture and other contaminants. The redistribution of moisture to water or moisture in any form can cause the model to malfunction or crash. Do not operate or expose to rain or moisture.

To avoid a potential fire hazard from batteries, do not short, reverse polarity, or puncture batteries. Battery charging should be done under adult supervision at all times, at a location out of reach of children. Do not mix Ni-Cad and alkaline batteries.

Make sure the batteries are installed correctly to ensure correct polarity. If you do not plan to use your Quadro for an extended period of time, remove the batteries from the controller to avoid battery leakage which may damage the controller. Please disassemble batteries according to local laws and ordinances.

Lithium polymer batteries have higher operational risks compared to other batteries. It is imperative to follow proper operational guidelines. The manufacturer and dealer assume no liability for accidents/damage caused by improper usage. Do not use any other charger other than the supplied charger included in the packaging in order to avoid potential fire or explosion. Do not crush, short-circuit, burn, or otherwise modify.

RC models are made from various forms of plastic very susceptible to damage or deformation due to extreme heat and cold temperatures. Make sure not to store the model near any heat source or extreme temperatures.

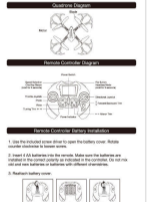

Charging Your Drone

1. To charge your Quadro, first disconnect the battery from the drone and slide it out of its holder. Plug the provided USB charger into a USB port. Now connect the USB charger to the battery. A light on the USB charger will turn off, indicating the battery is now charging. The light will turn on once the charging process has completed. Always charge your Quadro under adult supervision and out of the reach of children. Charging time is approximately 90 minutes. When you are ready to fly your Quadro again, reinsert the battery into its slot on the bottom of the drone.

Battery and Charger Specifications

Battery Type	Battery Specifications	Usage Duration	Charge Time
LiPo Battery	3.7V 1000mAh	Quadrone: 10-15 mins Headless: 10-15 mins	Approx. 45 minutes (with Quadrone)
Quadrone 2-in-1	1.50	Remote: 20-30 mins Quadrone: 15-20 mins	Near 180 minutes

Synchronizing the Quad and Remote

1. Turn on your Quadro by assembling the battery to the drone. Press it on a flat surface. The lights on the Quadro will begin to flash. Do not move the Quadro during the syncing process to ensure the gimbal stays balanced.
2. With the throttle joystick in its lowest position, turn on your remote controller. You will hear the remote beep and the power indicator light will flash.

3. Push the Throttle joystick to its highest position. Now move it back to its lowest position and the power indicator light will stop flashing and stay on. The Quadro and remote controller have been synced together. You are now ready to fly.

Flight Controls

Before flying your Quadro, it is highly recommended that you familiarize yourself completely with its controls. Read through the instruction manual completely before attempting your first flight.

Elevation: Push up on the throttle joystick. The Quadro will begin to ascend.

Descent: Pull down on the throttle joystick. The Quadro will begin to descend.

Turning: Push the directional joystick to the right. The Quadro will turn to the right. Push the directional joystick to the left. The Quadro will turn to the left.

Forward/Backward: Push the directional joystick forward. The Quadro will fly forward. Push the directional joystick to the left. The Quadro will turn to left.

Alert

Push the directional joystick to the right. The Quadro will fly to the right.

Push the directional joystick to the left. The Quadro will fly to the left.

Practice Tip

Use these recommended practice exercises to become a better Quadro pilot.

Elevation: Place the Quadro on the ground. Gradually lower the Quadro as it lands softly in the ground.

Direction: Move the Quadro in a series pattern along the directional joystick. Move forward, backward, left, right, and back to its original position.

Turning: Turn the Quadro in a circle joystick. Turn left and right repeatedly, and back to its original position.

Flying: Once you have mastered the previous three exercises, draw a circle on the ground. Practice flying within the confines of the circle. Narrow the circle as your skills progress.

Trimming the Quad

If your Quadro is leaning to the left or right, you may need to use the trim feature to balance it out as it flies straight.

Alert: If the Quadro leans to the right, press the Alt/One Key Return button to the left until it straightens out. If the Quadro leans to the left, press the Alt/One Key Return button to the right until it straightens out.

Forward/Backward: Push the Forward/Backward Trim button up until it straightens out. If the Quadro leans forward, press the Forward/Backward Trim button down until it straightens out.

Photo and Video

To take a photo, press the Photo Button as shown in the figure. The drone will take a photo and store it on the SD card.

To take a video, press the Video Button as shown in the figure. The drone will begin recording a video and store it on the SD card.

Speed Selection

Your Quadro can fly at three speeds. To select a speed, simply touch the Speed Selection button on your remote.

Low Speed - One Beep
Medium Speed - Two Beeps
High Speed - Three Beeps

One Key Return

When the Alt/One Key Return button is pressed, the Quadro will return to its home point. The home point is the location where the Quadro was last powered on. The Alt/One Key Return button can also be used to return the Quadro to its home point in the event of a loss of signal.

Flow and Hold

Your Quadro can perform precision fly and hold in order to do this, press the Fly button on your remote using light. Move the directional joystick in any direction and the aircraft will perform a constant fly.

Headless Mode

Headless mode allows the user to fly the Quadro without the need for a remote controller. This mode is ideal for beginners who are just starting to fly. To activate headless mode, press the Headless button on the remote. The Quad will enter headless mode and the lights will stop flashing.

Changing the Beeps

The beeps that the Quadro makes when it is powered on can be changed. To change the beeps, press the Beeps button on the remote. The Quad will enter beeps mode and the lights will stop flashing.

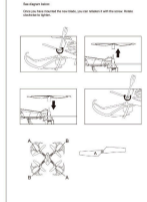

Troubleshooting

Problem	Cause	Solution
Drone will not fly or fly erratically	1. Improperly installed battery 2. Low battery 3. Low signal strength	1. Reinstall battery correctly 2. Charge battery 3. Move to an open area with a clear line of sight to the remote
Drone will not return to home point	1. Home point not set correctly	1. Set home point correctly
Drone will not respond to controls	1. Remote not powered on 2. Remote not in range 3. Remote not in line of sight	1. Power on remote 2. Move closer to drone 3. Move to an open area with a clear line of sight to the drone
Drone will not take off	1. Battery not fully charged 2. Low signal strength	1. Charge battery 2. Move to an open area with a clear line of sight to the remote
Drone will not land	1. Low signal strength 2. Low battery	1. Move closer to drone 2. Charge battery

Safety Guidelines

- Follow community-based safety guidelines, as developed by organizations such as the Academy of Model Aeronautics (AMA).
- Fly no higher than 400 feet and remain below any uncontrolled obstacles when possible.
- Always give priority to safety of all times, and use an observer to assist if needed.
- Never fly over people or property, and never fly over crowded areas or over water.
- Remove any components inside all assemblies. This warranty does not cover any repairs made or alterations made to third party individuals and losses, are hereby limited to RC/CV from the date of purchase. Component or individual damage resulting from alteration of any applicable system or related materials are hereby excluded. Some items do not allow installation or the function of original materials and do not allow activation of remote or component damage, as the above limitations and exclusions in these instructions may not apply.
- Ensure the operating environment is safe and that the operator is competent and proficient in the operation of the drone.
- Do not fly near or over sensitive infrastructure or property such as power stations, water treatment facilities, commercial facilities, heavily forested mountains, government facilities, etc.
- Quad and related accessories are not intended for use by children under 14 years of age. Do not use near children or property unless properly supervised by an adult.
- Do not conduct operations or photograph persons or areas where there is an expectation of privacy without the individual's permission.

Battery Disposal Guidelines

Do NOT litter or burn your old LiPo. Do NOT dispose of it in the trash. Do NOT dispose of it in the water. Do NOT dispose of it in the fire. Do NOT dispose of it in the ocean. Do NOT dispose of it in the ground. Do NOT dispose of it in the air. Do NOT dispose of it in the sky. Do NOT dispose of it in the earth. Do NOT dispose of it in the sky. Do NOT dispose of it in the earth.

Limited 90-Day Warranty

Quad, Scarab, and accessories are the original consumer that the product is free from any material or mechanical defects for a period of 90 days from the date of purchase. If any such defect is discovered within the warranty period, Quad, Scarab, and accessories will be repaired or replaced at no charge. This warranty does not cover any damage caused by misuse or abuse of the product. This warranty covers the product only and does not cover damage to the user's property or any other person or property. This warranty does not cover any damage caused by misuse or abuse of the product. This warranty covers the product only and does not cover damage to the user's property or any other person or property.

IMPORTANT NOTICE:
NEVER ATTEMPT TO SHIP YOUR PRODUCT BACK THROUGH FIRST CLASS MAIL. CONTACT THE SUPPORT DEPARTMENT AT: support@quad.com

Warning: Changes or modifications to this and not expressly approved by the party responsible for compliance could void the user's authority to operate the equipment.

NOTE: This equipment has been tested and found to comply with the limits for a Class B digital device, pursuant to Part 15 of the FCC Rules. These limits are designed to provide reasonable protection against harmful interference in a residential installation. This equipment generates, uses and can radiate radio frequency energy and, if not installed and used in accordance with the instructions, may cause harmful interference to radio communications.

Caution: There are some limitations that should be noted about this particular installation. If the equipment does not function properly, please refer to the troubleshooting section, which can be determined by turning the equipment off and on. The user is encouraged to fly in a controlled environment by one or more of the following measures:

- Receive or operate the receiving equipment.
- Increase the separation between the equipment and sensitive equipment.
- Consult the dealer or an experienced radio TV technician for help.

This device complies with Part 15 of the FCC Rules. Operation is subject to the following two conditions:

- (1) This device may not cause harmful interference, and
- (2) This device must accept any interference received, including interference that may cause undesired operation.