

LEDEEZ
MULTICOLOR SMART BULBS 2-PACK
 Bluetooth



APP OPERATED
 Download Free
 GET IT ON Google Play
 Download on the App Store

USER MANUAL

Thank you for purchasing the LEDEEZ™ Smart Color Changing Light Bulb via Bluetooth® and app. Please read all instructions carefully before using and retain this manual for future reference.

SAFETY INSTRUCTIONS
 Keep the unit away from heat sources, direct sunlight, humidity, water and any other liquids.

Do not operate the unit if it has been exposed to water, moisture or any other liquids to prevent against electric shock, explosion and/or injury to yourself and damage to the unit.

Do not use the unit if it has been dropped or damaged in any way.

Repairs to electrical equipment should only be performed by a qualified electrician. Improper repairs may place the user at serious risk.

Do not puncture or harm the exterior surface of the product in any way.

Keep the unit free from dust, lint, etc.

Do not use this unit for anything other than its intended use or purpose. Doing so may damage the device.

This product is not a toy. Keep out of reach of children.

CAUTION: Risk of Electrical Shock - Use in Dry Locations Only.

This device is not intended for use with emergency exit fixtures or emergency exit lights.

PRODUCT SPECS:

Power: 9W
 Voltage: 120V
 Lumen: 800LM
 Lifespan: >15000H
 Frequency: 60Hz
 Color Temp: 5000K + RGB
 Control Method: App
 BT ID : D058376
 FCC ID : ZAANZSWBU

CARE AND MAINTENANCE

- Do not expose the bulb to liquid, moisture, or humidity to avoid damage to the product's internal circuitry.
- Do not use abrasive cleaning solvents to clean the unit.
- Do not expose the bulb to extremely high or low temperatures as this will shorten the life of the electronic device and/or distort certain plastic parts.
- Do not dispose of the bulb in fire as they may explode or combust.
- Do not expose the bulb to contact with sharp objects as this will cause scratches and damage.
- Do not let the bulb fall from high places, as doing so may damage the internal circuitry.
- Do not attempt to disassemble the bulb.

In the event that the bulb does not function properly, return it to the store where it was purchased.

DOWNLOAD & INSTALL THE APP

Scan the QR code below or search "Tuya" or "Smart Life" in the Apple App store or Google Play



LOGIN

- Select your country, then log in with your email and tap "GET" to receive a verification code. Enter your verification then tap "LOGIN"
- Or sign in via social media account

ADD A DEVICE:

- Turn on your phone's Bluetooth
- Turn on lightbulb, device will flash after 3-5sec. If your device does not flash automatically turn it off and on 3x to preform a device reset
- When bulb is blinking open selected app and a pop-up will appear tap "find the device" and click Add to add your device to the list
- If pop-up does not appear automatically tap the "+" button in the upper right corner of the app home page, then tap "add a device" and select "Light source Bluetooth"

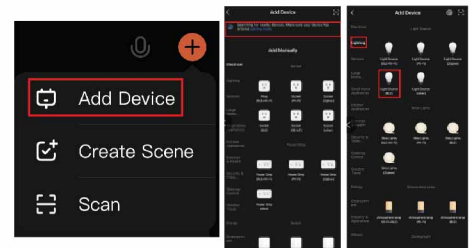

(see below for how to set up a group)



CREATE A GROUP:

- Click the light bulb device
- Click the setting dots in the upper right corner
- Click "Create a group"
- Click the "+" to add a device
- Create a group name and click "save"
- Now that your group has been created you can control multiple bulbs at the same time

Note:

- The bulb must be within 100ft (30m) of the device for a reliable bluetooth connection in the open space
- The time set function can be performed in group mode
- To reset the bulb perform the "on-off-on-off-on" action. If the bulb begins blinking quickly the reset was successful, if the bulb does not blink repeat the process

FCC Statement

This device complies with part 15 of the FCC Rules. Operation is subject to the following two conditions: (1) This device may not cause harmful interference, and (2) this device must accept any interference received, including interference that may cause undesired operation.

Please note that changes or modifications not expressly approved by the party responsible for compliance could void the user's authority to operate the equipment.

FCC INSTRUCTIONS FOR A CLASS B DIGITAL DEVICE OR PERIPHERAL

Note: This equipment has been tested and found to comply with the limits for a Class B digital device, pursuant to part 15 of the FCC Rules. These limits are designed to provide reasonable protection against harmful interference in a residential installation. This equipment generates, uses and can radiate radio frequency energy and, if not installed and used in accordance with the instructions, may cause harmful interference to radio communications. However, there is no guarantee that interference will not occur in a particular installation. If this equipment does cause harmful interference to radio or television reception, which can be determined by turning the equipment off and on, the user is encouraged to try to correct the interference by one or more of the following measures:

- Reorient or relocate the receiving antenna.
- Increase the separation between the equipment and receiver.
- Connect the equipment into an outlet on a circuit different from that to which the receiver is connected.
- Consult the dealer or an experienced radio/TV technician for help.

DGL Group guarantees the quality of this product. For questions or comments, please feel free to contact us via email at support@dglusa.com.

Model: LE-SWBU-2PK-MLT
 Ref: 20230118EL MFG Date: 01.23



DGL Group guarantees the quality of this product. For questions or comments, please feel free to contact us via email at support@dglusa.com

Distributed by DGL Group, LTD.
 2045 Lincoln Highway, Edison, NJ, 08817, USA.
 www.dglusa.com