

User Guide Smart Bracelet ID107L

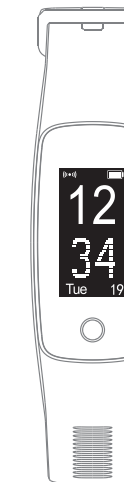

Thanks for choosing our device, please read the user guide carefully before using.

Setting

Use VeryFitPro on iOS or Android smart phone to set the wristband as follows:

Note: hardware and system of devices should meet the requirements:



1 Download VeryFitPro

Search and download

Search and download "VeryFitPro" from the Apple Store or Android App store .

Scan the QR code and download

It probably has a problem to open the link with WeChat or other scan tools, please copy the link and open it through browser.



12

2. Product activation and installation

The product must be activated by charging before initial use, and then charge the product to ensure normal power supply. The hand ring will automatically power on.

Take out: Pull open the strap and take out the bracelet body



Charge the battery: Insert the chip-mounted end of the bracelet body into the USB interface to activate the product by charging (be cautious not to reverse the polarity, and comply with the required voltage and current: 5V / 500mA)



Installation: Mount the bracelet body into the slot of the wrist strap.



Wear on: Adjust the length of the wrist strap until it is appropriate to wear on the wrist.



13

3. Touch key

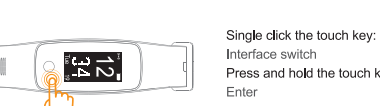

Single click the touch key: Interface switch
Press and hold the touch key: Enter

4. Make sure the Bluetooth of smart phone is ON, open app"VeryFitPro"

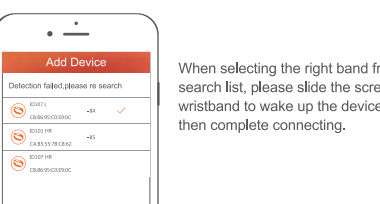

When selecting the right band from the search list, please slide the screen of wristband to wake up the device and then complete connecting.

Know your Device

1. Wearing Method

Wear the device on your wrist horizontally, about 2cm to carpal, the same method as wearing watches.

2. Heart Rate Monitoring

To monitor Heart Rate more accurately, please wear the device on the upper position of your wrist and a bit tighter than usual when you are taking exercise.

3. Heart Rate Monitoring

Automatic heart rate Monitoring is ON as default, monitor Heart Rate all the day automatically.

14

4. Working Time

Continuously working for 8 days under normal conditions

5. Interface

Click the touch key to display successively

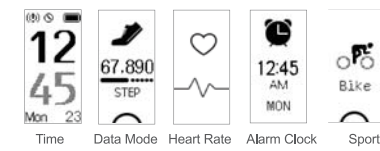

Function Introduction

1.1 Time Mode

Instructions
Time dial can be switched as follows:
APP Devices Mode>More
[Click the touch key] to enter the next mode:
Data Mode
(you can customize the shortcut through the app)

1.2 Data Mode

[Click the touch key] to enter the next mode: Heart Rate Mode
[Press and hold the touch key for 2s] to enter the sub-mode of "Data Reading"

15

1.2.1 Data Reading Sub-Mode

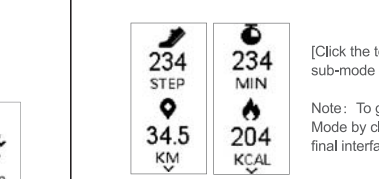

[Click the touch key] to enter the next sub-mode

Note: To go back to the Data Reading Mode by clicking the touch key on the final interface of Data Reading Sub-Mode

1.3 Heart Rate Mode



Note: Upon staying at the Heart Rate interface for 1s, start to monitor the heart rate, and a fig. like "89" is displayed before the correct data is monitored, and upon the correct data being monitored, data is displayed.
[Click the touch key] to enter the next mode: Alarm Clock Mode

1.4 Alarm Clock Mode

Note: Alarm clock function should be turned on in App for the alarm clock to be displayed.

16

1.5 Sports Mode

[Press and hold the touch key for 2s] to enter the Sports Mode
[Click the touch key] to enter the next sports mode; and in case there are no other sports modes, it will go back to the time mode.
Note: Types of Sports mode can be selected in App (App can handle 4 types of track recording sports and 10 types of other activities)

1.5.1 Sports Start Mode

After the countdown interface of 3-2-1-GO is the sports underway mode.

1.5.2 Sports Underway Mode

Heart Rate, Steps, Calories, Mile

17

1.5.3 Sports Stop Mode

[Click the touch key] to enter the next sub-mode of "Sports Underway" [Press and hold the touch key for 2s] to enter any interface of Data Reading, press and hold 2s to exit time sports mode.

1.5.4 Event Reminder in Sports Mode

1) Reminder of exiting from sports mode upon a period of no activity
[Click the touch key] to remove the reminder of automatic quitting from sports mode.

1.5.5 Abnormal operations during the

The reminder will be available soon

1.5.6 Reminder of force quit for low-battery

[Click the touch key] to accept the force quit from the sports mode.

18

1.5.7 Reminder of inaccessible sport mode for low-battery

[Click the touch key] to accept the inaccessible sports mode for low-battery

1.5.8 Reminder of full-ram force quit

Note: When the memory of wrist strap is full of sports data, the user will be reminded of exiting from the Sports Mode

1.5.9 Sports data display mode

Average pace, Pace/Speed, Pm

1.5.10 Target completion reminder

When some goals are achieved, shake the wrist strap to get the interface of target completion reminder displayed Click the touch key to quit from the reminder

19

1.5.11 Camera mode control

Entry mode: Start the camera entry by App, and the device will get in the camera mode successfully.
Photo taking methods: shake/wrist lifting/click the touch key

1.5.12 More modes of reminders

1) Call Reminder
Click the touch key to remove the call reminder Press and hold the touch key to hang up the call

1.5.13 Message Reminder

In case of pages of messages, Click the touch key to read the remained ones.
Note: The relevant settings need to be done in the App.

1.5.14 Alarm Clock

Alarm Clock: The relevant settings need to be done in the App.
Alarm Clock Types: Wake up, Medicine taking, Sleeping, Party, Appointment, Exercise, Meeting

20

1.5.15 Low battery reminder

Low-Battery! Please recharge timely!

1.5.16 Device Error Notification

Note: When the device is detected with an abnormality, the interface herein will be displayed each time the device is opened.

1.5.17 Status Code

-01 means the abnormality of acceleration sensor
-02 means the abnormality of heart rate sensor
-03 means the abnormality of touch key IC
-04 means the abnormality of flash

1.5.18 Basic Specifications

Model No.: ID107L
Battery Capacity: 65mAh
Working Voltage: 3.7V
Host weight: about 22.4g
Sync: Bluetooth 4.0
Working temperature: -20 C - 40 C
Waterproof: IP68
Working Time: 5-10days
Product frequency band: 2402-2480MHz
Maximum transmit power: -7.03dBm

21

1.5.19 Declaration of toxic and hazardous substances in electronic information products

The device meets the EU ROHS criterion. Please refer to IEC 62321, EU ROHS Directive 2011/65/EU and revised directive.

1.5.20 FAQ

◆ Failed to find the device when pairing
① Make sure the Bluetooth of smart phone is ON, and smart phone OS Android 4.4 & Above, iOS 7.0 & Above.
② Make sure the distance between phone and device is within 0.5meter, device is among the normal Bluetooth communication distance range(within 10meter) after pairing finished.
③ Make sure the device is not under low battery. If there is still a problem after fully charged, please contact us.

◆ Failed to connect with Bluetooth occasionally

① Caused by the abnormality of Bluetooth service when it restarted on the phone.
② Reboot mobile phone or re-start the Bluetooth service, then it works normal.

◆ How to restore factory defaults

Make sure the device is connected with smart phone, go in the App, enter "device-- System setting", and choose "reboot device".

22

1.5.21 Declaration of toxic and hazardous substances in electronic information products

The device meets the EU ROHS criterion. Please refer to IEC 62321, EU ROHS Directive 2011/65/EU and revised directive.

1.5.22 FAQ

◆ Failed to find the device when pairing
① Make sure the Bluetooth of smart phone is ON, and smart phone OS Android 4.4 & Above, iOS 7.0 & Above.
② Make sure the distance between phone and device is within 0.5meter, device is among the normal Bluetooth communication distance range(within 10meter) after pairing finished.
③ Make sure the device is not under low battery. If there is still a problem after fully charged, please contact us.

◆ Failed to connect with Bluetooth occasionally

① Caused by the abnormality of Bluetooth service when it restarted on the phone.
② Reboot mobile phone or re-start the Bluetooth service, then it works normal.

◆ How to restore factory defaults

Make sure the device is connected with smart phone, go in the App, enter "device-- System setting", and choose "reboot device".

23

1.5.23 Declaration of toxic and hazardous substances in electronic information products

The device meets the EU ROHS criterion. Please refer to IEC 62321, EU ROHS Directive 2011/65/EU and revised directive.

1.5.24 FAQ

◆ Failed to find the device when pairing
① Make sure the Bluetooth of smart phone is ON, and smart phone OS Android 4.4 & Above, iOS 7.0 & Above.
② Make sure the distance between phone and device is within 0.5meter, device is among the normal Bluetooth communication distance range(within 10meter) after pairing finished.
③ Make sure the device is not under low battery. If there is still a problem after fully charged, please contact us.

◆ Failed to connect with Bluetooth occasionally

① Caused by the abnormality of Bluetooth service when it restarted on the phone.
② Reboot mobile phone or re-start the Bluetooth service, then it works normal.

◆ How to restore factory defaults

Make sure the device is connected with smart phone, go in the App, enter "device-- System setting", and choose "reboot device".

24

1.5.25 Declaration of toxic and hazardous substances in electronic information products

The device meets the EU ROHS criterion. Please refer to IEC 62321, EU ROHS Directive 2011/65/EU and revised directive.

1.5.26 FAQ

◆ Failed to find the device when pairing
① Make sure the Bluetooth of smart phone is ON, and smart phone OS Android 4.4 & Above, iOS 7.0 & Above.
② Make sure the distance between phone and device is within 0.5meter, device is among the normal Bluetooth communication distance range(within 10meter) after pairing finished.
③ Make sure the device is not under low battery. If there is still a problem after fully charged, please contact us.

◆ Failed to connect with Bluetooth occasionally

① Caused by the abnormality of Bluetooth service when it restarted on the phone.
② Reboot mobile phone or re-start the Bluetooth service, then it works normal.

◆ How to restore factory defaults

Make sure the device is connected with smart phone, go in the App, enter "device-- System setting", and choose "reboot device".

25

1.5.27 Declaration of toxic and hazardous substances in electronic information products

The device meets the EU ROHS criterion. Please refer to IEC 62321, EU ROHS Directive 2011/65/EU and revised directive.

1.5.28 FAQ

◆ Failed to find the device when pairing
① Make sure the Bluetooth of smart phone is ON, and smart phone OS Android 4.4 & Above, iOS 7.0 & Above.
② Make sure the distance between phone and device is within 0.5meter, device is among the normal Bluetooth communication distance range(within 10meter) after pairing finished.
③ Make sure the device is not under low battery. If there is still a problem after fully charged, please contact us.

◆ Failed to connect with Bluetooth occasionally

① Caused by the abnormality of Bluetooth service when it restarted on the phone.
② Reboot mobile phone or re-start the Bluetooth service, then it works normal.

◆ How to restore factory defaults

Make sure the device is connected with smart phone, go in the App, enter "device-- System setting", and choose "reboot device".

26

1.5.29 Declaration of toxic and hazardous substances in electronic information products

The device meets the EU ROHS criterion. Please refer to IEC 62321, EU ROHS Directive 2011/65/EU and revised directive.

1.5.30 FAQ

◆ Failed to find the device when pairing
① Make sure the Bluetooth of smart phone is ON, and smart phone OS Android 4.4 & Above, iOS 7.0 & Above.
② Make sure the distance between phone and device is within 0.5meter, device is among the normal Bluetooth communication distance range(within 10meter) after pairing finished.
③ Make sure the device is not under low battery. If there is still a problem after fully charged, please contact us.

◆ Failed to connect with Bluetooth occasionally

① Caused by the abnormality of Bluetooth service when it restarted on the phone.
② Reboot mobile phone or re-start the Bluetooth service, then it works normal.

◆ How to restore factory defaults

Make sure the device is connected with smart phone, go in the App, enter "device-- System setting", and choose "reboot device".

27

1.5.31 Declaration of toxic and hazardous substances in electronic information products

The device meets the EU ROHS criterion. Please refer to IEC 62321, EU ROHS Directive 2011/65/EU and revised directive.

1.5.32 FAQ

◆ Failed to find the device when pairing
① Make sure the Bluetooth of smart phone is ON, and smart phone OS Android 4.4 & Above, iOS 7.0 & Above.
② Make sure the distance between phone and device is within 0.5meter, device is among the normal Bluetooth communication distance range(within 10meter) after pairing finished.
③ Make sure the device is not under low battery. If there is still a problem after fully charged, please contact us.

◆ Failed to connect with Bluetooth occasionally

① Caused by the abnormality of Bluetooth service when it restarted on the phone.
② Reboot mobile phone or re-start the Bluetooth service, then it works normal.

◆ How to restore factory defaults

Make sure the device is connected with smart phone, go in the App, enter "device-- System setting", and choose "reboot device".

28