

## FILE INFORMATION

DATE: 5/22/15

MODEL NUMBER:  
ES061B(MANUAL)

## PRINTER SPECIFICATIONS

FILE NAME: ES061B-Manual\_052215

SCALE: 100%

SIZE: Trim: W 431mm x H 165mm

PAPER STOCK: 80g Art Paper

## COMMENTS (Internal reference only)

File created by Michelle Samuels

- Please include this manual in all packaging for ES061B
- Greyscale
- Double sided printing

Works wirelessly with these devices:



### Technical Support:

Please do not attempt to fix the product by yourself. If you are experiencing any problems with the product, please do not return it to the store you bought it from. You can contact our technical support representatives and they will assist you with any questions you might have.

For assistance operating your product, please consult the User's Manual first, then feel free to contact Mercurry Innovations technical support:

### ©2015 Innovations.

To explore our full selection of products, visit us at: [www.mercurryinnovations.com](http://www.mercurryinnovations.com)  
Bluetooth is a registered trademark of Bluetooth SIG, Inc. The illustrated product and specifications may differ slightly from those supplied. All other trademarks and trade names are those of their respective owners.  
Made in China

## LIMITED PRODUCT WARRANTY

Your Mercurry Innovations Products are covered by a limited product warranty (Limited Warranty) for the 1-year period following the original date of purchase (Warranty Period). If a substantial defect in material or workmanship arises with your Mercurry Innovations Product, and a valid warranty claim is received by Mercurry Innovations within the Warranty Period, you will be entitled to one of the remedies provided in the Sole and Exclusive Remedy section below.  
This Limited Warranty is non-transferable and covers only the original end purchaser of the applicable Mercurry Innovations Product. Proof of purchase in the form of the original purchase receipt or packaging slip is required for warranty validation and service. Warranty claims must be made directly to Mercurry Innovations. Please note that Mercurry Innovations cannot be held liable, in any manner, for damages to your personal property resulting from any misuse or improper care and maintenance of the Mercurry Innovations Product case and O-ring seals.

### Exclusions and Limitations

This Limited Warranty does not cover any Mercurry Innovations Product purchased through non-authorized dealers and/or online auction websites. Non-authorized dealer receipts and/or online sales auction confirmations are NOT accepted for warranty verification.  
This Limited Warranty applies only to the Mercurry Innovations Product. The Limited Warranty does not extend to or otherwise apply to any non-Mercurry Innovations Product, even if packaged or sold with the Mercurry Innovations Product. This Limited Warranty applies only to the normal use of the covered Mercurry Innovations Product, normal wear and tear excepted, in accordance with the written use instructions provided with the Mercurry Innovations Product. This Limited Warranty does not apply to damage to the Mercurry Innovations Product caused by accident, abuse, misuse, use for any purpose other than its intended purpose, acts of God, or any alteration or modification of the Mercurry Innovations Product.

### Sole and Exclusive Remedy

Your sole and exclusive remedy for any breach by Mercurry Innovations of this Limited Warranty, and Mercurry Innovations' sole and entire liability for such breach, is, at Mercurry Innovations' option, to repair or replace the defective Mercurry Innovations Product or, if the warranty claim is submitted during the first thirty (30) calendar days of the Warranty Period, refund the purchase price of the defective Mercurry Innovations Product. Repair or replacement of the applicable Mercurry Innovations Product (including parts and labor as well as re-shipping costs) shall be made at Mercurry Innovations' expense. Mercurry Innovations reserves the right to send you a replacement Mercurry Innovations Product that is the same or of a similar style to the Mercurry Innovations Product you returned under the Limited Warranty or a substitute equivalent to your original Mercurry Innovations Product that may not be of like kind (depending on availability). Replacement Mercurry Innovations Products will be furnished only on an exchange basis. Replacement or repaired Mercurry Innovations Products are warranted as above only for the remainder of the original applicable Warranty Period.

### Obtaining Warranty Service

To make a warranty claim please contact customer support: [support@mercurryinnovations.com](mailto:support@mercurryinnovations.com)

## Warranty Disclaimers

EXCEPT AS EXPRESSLY SET FORTH ABOVE IN THIS LIMITED PRODUCT WARRANTY SECTION, EACH MERKURY INNOVATIONS PRODUCT IS PROVIDED SOLELY ON AN "AS IS" BASIS AND MERKURY INNOVATIONS MAKES NO OTHER WARRANTIES OF ANY KIND, TO THE MAXIMUM EXTENT PERMITTED BY APPLICABLE LAW. MERKURY INNOVATIONS SPECIFICALLY DISCLAIMS AND EXCLUDES ANY AND ALL OTHER WARRANTIES, WHETHER EXPRESS, IMPLIED OR STATUTORY, INCLUDING, WITHOUT LIMITATION, ANY IMPLIED WARRANTIES OF NON-INFRINGEMENT, QUIET ENJOYMENT, MERCHANTABILITY OR FITNESS FOR A PARTICULAR PURPOSE. IF SUCH DISCLAIMER OF ANY IMPLIED WARRANTY IS NOT PERMITTED BY LAW, THE DURATION OF ANY SUCH IMPLIED WARRANTY IS LIMITED TO THE DURATION OF THE WARRANTY PERIOD OF THE LIMITED WARRANTY AS SET FORTH ABOVE. SOME JURISDICTIONS DO NOT ALLOW THE EXCLUSION OF IMPLIED WARRANTIES OR LIMITATIONS ON HOW LONG AN IMPLIED WARRANTY MAY LAST, SO SUCH LIMITATIONS OR EXCLUSIONS MAY NOT APPLY TO YOU. IF APPLICABLE LAW SPECIFIES A MINIMUM WARRANTY PERIOD THAT IS LONGER THAN THE WARRANTY PERIOD SET FORTH IN THE LIMITED WARRANTY, THEN THE WARRANTY PERIOD FOR LIFEPROOF PRODUCTS SUBJECT TO SUCH APPLICABLE LAW SHALL BE CONFORMED TO THE MINIMUM PERIOD SO REQUIRED. THIS WARRANTY GIVES YOU SPECIFIC LEGAL RIGHTS AND YOU MAY ALSO HAVE OTHER RIGHTS WHICH VARY FROM JURISDICTION TO JURISDICTION.

## LIMITATION OF LIABILITY

IN NO EVENT, UNDER ANY CAUSE OF ACTION OF THEORY OF LIABILITY, SHALL MERKURY INNOVATIONS ITS DISTRIBUTORS OR SUPPLIERS BE LIABLE TO YOU OR ANY THIRD PARTY FOR ANY INDIRECT, INCIDENTAL, CONSEQUENTIAL, SPECIAL, EXEMPLARY OR PUNITIVE DAMAGES, OF ANY NATURE WHATSOEVER, ARISING OUT OF THE USE OF OR INABILITY TO USE ANY MERKURY INNOVATIONS PRODUCT, INCLUDING, WITHOUT LIMITATION, PROPERTY DAMAGE, LOSS OF VALUE OF THE MERKURY INNOVATIONS PRODUCT OR ANY THIRD PARTY PRODUCTS THAT ARE USED IN OR WITH THE MERKURY INNOVATIONS PRODUCT, OR LOSS OF USE OF THE MERKURY INNOVATIONS PRODUCT OR ANY THIRD PARTY PRODUCTS THAT ARE USED IN OR WITH THE MERKURY INNOVATIONS PRODUCT, EVEN IF MERKURY INNOVATIONS HAS BEEN ADVISED OF THE POSSIBILITY OF SUCH DAMAGES. WITHOUT LIMITING THE FOREGOING, YOU UNDERSTAND AND AGREE THAT MERKURY INNOVATIONS HAS NO LIABILITY FOR ANY DAMAGE OR DESTRUCTION TO CONSUMER ELECTRONICS DEVICES OR OTHER PERSONAL PROPERTY THAT ARE CONTAINED INSIDE OR OUTSIDE THE MERKURY INNOVATIONS PRODUCTS, INCLUDING, WITHOUT LIMITATION, LAPTOPS, CELLULAR PHONES, OR OTHER HANDHELD DEVICES, OR ANY LOSS OF DATA CONTAINED IN THE FOREGOING DEVICES. NOTWITHSTANDING ANY DAMAGES THAT YOU MIGHT INCUR FOR ANY REASON WHATSOEVER (INCLUDING, WITHOUT LIMITATION, ALL DAMAGES REFERENCED HEREIN AND ALL DIRECT OR GENERAL DAMAGES IN CONTRACT, TORT (INCLUDING NEGLIGENCE) OR OTHERWISE), THE ENTIRE AGGREGATE LIABILITY OF MERKURY INNOVATIONS AND ANY OF ITS DISTRIBUTORS AND/OR SUPPLIERS SHALL BE LIMITED TO THE AMOUNT ACTUALLY PAID BY YOU FOR THE MERKURY INNOVATIONS PRODUCT GIVING RISE TO LIABILITY. SOME STATES AND/OR JURISDICTIONS DO NOT ALLOW THE EXCLUSION OR LIMITATION OF INCIDENTAL OR CONSEQUENTIAL DAMAGES, SO THE ABOVE LIMITATIONS OR EXCLUSIONS MAY NOT APPLY TO YOU. THE LIMITATIONS OF LIABILITY SET FORTH ABOVE SHALL APPLY TO THE MAXIMUM EXTENT PERMITTED UNDER APPLICABLE LAW.

IPX4 Weather-Proof

**IMPORTANT**

**PLEASE READ BEFORE USING THIS PRODUCT**



# SPLASH

Splash-Resistant Wireless Speaker  
User's manual for ES061B



**Package Includes:**  
1 Bluetooth Speaker  
1 USB to Micro USB Charging Cable

### Features:

- Durable, shock and weather-resistant silicone wrap
- On-board playback and volume controls
- Up to 4 hours of continuous playback on a single charge
- The USB port can charge the speaker, or transmit analogue signal

## Charge It

- Plug the micro USB cable into the micro USB port under the silicone cover on the back of the speaker, and connect the other end of the cable to either a computer USB port or to a USB-compatible car or wall charger.
- A solid red LED light will appear above the micro USB port to indicate when the Splash speaker is charging, even while speaker is turned off.
- When charging is complete, the red LED light will turn off.
- Charging time is approximately 3 hours.

## Power On/Off

- Flip the power switch behind the silicone cover on the back of the speaker to the "ON" position to power on the Splash speaker.
- The Splash will emit a tone, and the LED light on the back of the speaker will glow blue to indicate that the speaker is now powering on.
- To turn the Splash speaker off, flip the power switch into the "OFF" position. The speaker will emit a tone to indicate that the Splash speaker is now powering off.

## Pair & Connect with a New Device

- Power on the Splash speaker (refer to the "Turn it On" section).
- The Splash will emit a tone, and then LED light on the back of the speaker will begin glow blue as it tries to reconnect with a previous device. If it cannot reconnect, the LED light will begin to quickly flash blue to indicate that the speaker is now ready to be paired with a new device.
- On your Bluetooth-enabled smartphone, tablet or media player, navigate to the Bluetooth settings menu, turn on the Bluetooth feature, and search for new devices.
- After a few seconds you will see "ES061B" listed.
- Tap this model to select it. The LED will turn a solid blue. You are now paired, connected and ready to play!

## Reconnect to Bluetooth

- You only need to pair your Bluetooth device with the Splash once.
- With your previously paired device's Bluetooth turned on and in range, power on the Splash.
- The speaker will automatically reconnect to the last Bluetooth device it was connected to.
- If you have a previously paired device that does not auto-reconnect, navigate to the Bluetooth settings menu on your device, turn on the Bluetooth feature, and select "ES061B" from your list of paired Bluetooth devices.

## Play

- Connect your device to the Splash over Bluetooth (refer to "Pair & Connect" section).
- Open your favorite music app and press play.
- You can control the music, volume, and tracks from your device, as well as control the playback and volume from the speaker. Note: Volume on your device and on the speaker are controlled separately.
- Press the play button to play/pause music, or to answer/end phone calls. Press the "+" or "-" buttons to adjust volume, or press & hold to skip tracks.
- The speaker will emit a tone when the maximum or minimum volume on the speaker has been reached. If volume is still too low, you can also adjust the volume on your device.
- All audio, including music, games, videos, and notifications will be routed through the Splash.

## Product Diagram

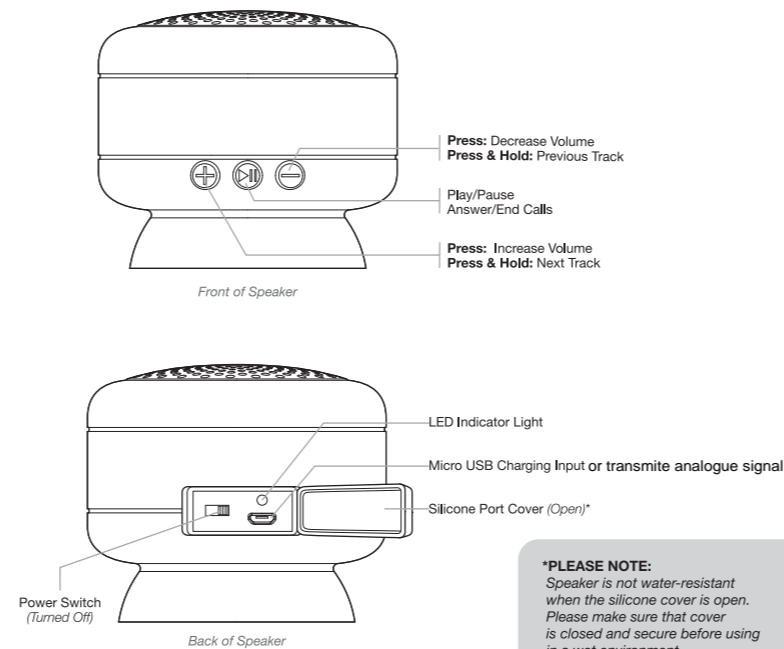

**\*PLEASE NOTE:**  
Speaker is not water-resistant when the silicone cover is open. Please make sure that cover is closed and secure before using in a wet environment

## Important Waterproof/Safety Information

**IMPORTANT: DO NOT submerge the Splash speaker in water. This device is not intended to function properly after being under water.**

- Before using the Splash in a wet environment, make sure the silicone cover over the power switch and micro USB input port on the back of the speaker is fully closed and secured. If water gets into the power switch or micro USB port, the speaker may not function properly.
- The Splash is rated IPX4, which means the speaker can be splashed with water or left in the rain (but not submerged in water) for approximately 5 minutes.
- If the Splash gets wet, it is recommended that you dry the speaker completely before using it again.
- All actions done with the Splash speaker are done at your own risk. While the speaker is weather-proof and has a protective silicone case, it is not a guarantee for complete damage protection.

## Troubleshooting

No power	Recharge your speaker using the included micro USB cable. Try using a different cable.
Music is not playing over Bluetooth	Make sure your Bluetooth device has A2DP profile. Check if both devices are paired and connected over Bluetooth. Restart the Splash speaker to reconnect your Bluetooth device.
Speaker will not pair with your device	Make sure to put the speaker into pairing mode first, then try pairing your device again. Make sure your device has Bluetooth enabled.
Bluetooth device will not reconnect with the speaker	Navigate to your Bluetooth settings menu on your Bluetooth device, tap "ES061B", and select "Forget". Now follow the steps to pair your device again.

## Speaker Specifications:

Output Power: 2.5W (mono channel)  
Speaker Driver Size: 40mm  
Impedance: 4Ω  
Frequency Response: 20Hz to 20KHz  
Waterproof Level: IPX4

## Battery Information:

Built-in Battery: Lithium-ion  
Input: DC 5V/300mA  
Battery Capacity: 200mAh  
Music playing time: Up to 4 Hours\*  
Charging time: 3 hours  
\*Approximate playback time. Battery life depends on individual use and may be slightly more or less than the time specified.

## Bluetooth Information:

Bluetooth Specification: V2.1  
Operating Distance: 10 Meters (Class II)  
System Requirements: Bluetooth-capable device

## Additional Connection Sources:

Power Source: Built-in rechargeable battery or via USB cable

## FCC Notice:

This device complies with Part 15 of the FCC Rules. Operation is subject to the two following conditions:  
1. This device may not cause harmful interference.  
2. This device must accept any interference received, including interference that may cause undesired operation.

## FCC Statement:

The equipment has been tested and found to comply with the limits for a Class B digital device, pursuant to Part 15 of the FCC Rules. These limits are designed to provide reasonable protection against harmful interference in a residential installation. This equipment generates, uses, and can radiate Radio frequency energy and, if not installed and used in accordance with the instructions, may cause harmful interference to Radio communications.

However, there is no guarantee that interference will not occur in a particular installation. If this equipment does cause harmful interference to Radio or television reception, which can be determined by turning the equipment off and on, the user is encouraged to try to correct the interference by one or more of the following measures:

- Reorient or relocate the receiving antenna.
- Increase the separation between the equipment and receiver.
- Connect the equipment into an outlet on a circuit different from that to which the receiver is connected.
- Consult the dealer or an experienced Radio/television technician for assistance.

OUTSIDE

INSIDE