

# Use and Care Guide

## TOOLS REQUIRED

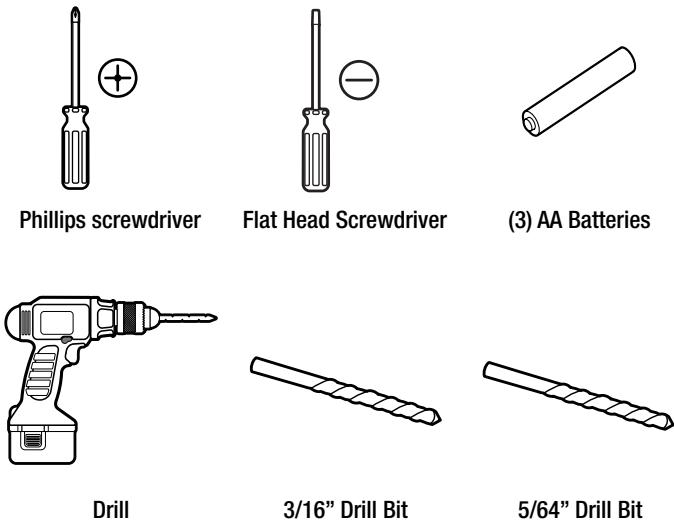

## HARDWARE INCLUDED

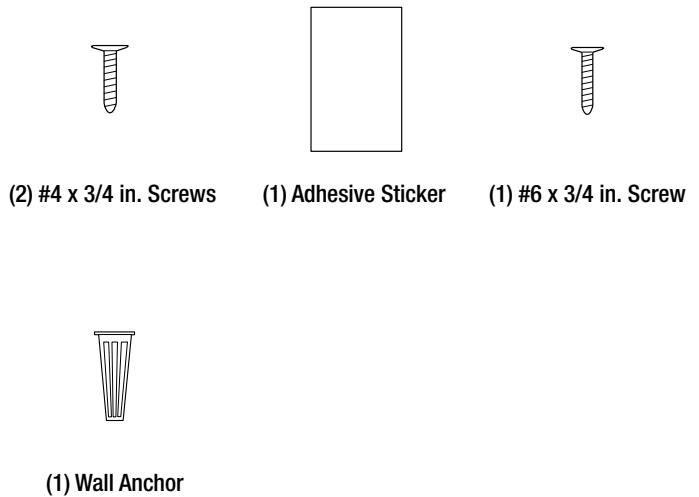

## Installation

### 1 ACTIVATING THE PUSH BUTTON BATTERY

- Remove the front cover of the push button by inserting a flat head screwdriver in the slot on the bottom of the button and pulling up slightly.
- Remove the plastic tab from the battery compartment to allow connection to the terminal.
- Snap the front cover onto the base by first hooking the tops together, then snapping the base on.

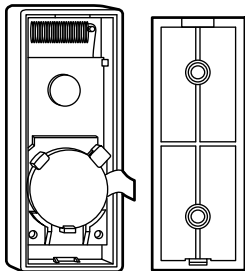

### 2 INSERTING THE CHIME BATTERIES

- Push the tab on the bottom of the chime and pull the back cover off of the chime.
- Insert (3) AA batteries as shown in the diagram on the chime.

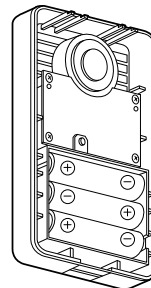

### 3 SYNCING CHIME AND PUSH BUTTON

- The chime and included push button already come synced. Follow the steps below if you need to resync, or sync additional push buttons.*
- Press and release the learning button on the inside of the chime.
  - Immediately following, press and release the push button to hear a 2-note tune. Press and release the push button again within five seconds to hear another tune. Continue pressing and releasing the push button until you reach the desired tune. To set that tune, do not push the push button for five seconds.

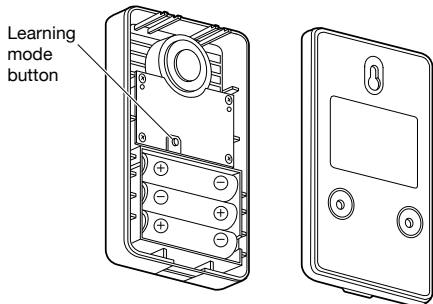

### 4 MOUNTING THE CHIME

- Snap the back cover onto the chime.
- Mark the desired screw location on a clean wall.
- Drill a pilot hole on the mark using a 3/16 in. drill bit and insert the wall anchor.
- Screw in the included #6 screw and mount the door chime to the screw.

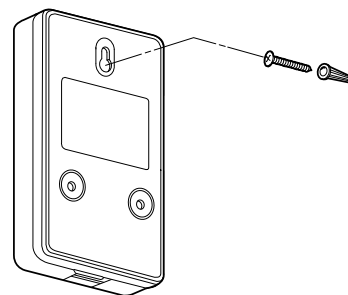

## 5 MOUNTING THE PUSH BUTTON

- ❑ Remove the front cover from the base by following step 1.
- ❑ Mount the push button base to a clean wall or door jamb with included #4 screws or mounting tape. If mounting with screws, predrill a pilot hole through the push button base in the desired location using a 5/64 in. drill bit.
- ❑ Snap the push button cover onto the base by first hooking the tops together, then snapping the base on.

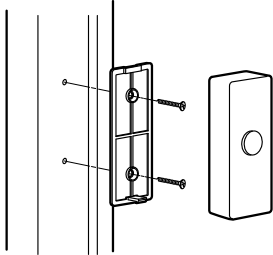

## 6 RESYNCING THE CHIME AND PUSH BUTTON

- ❑ Press and hold the learning mode button on the chime until you hear a ding sound. The chime is now reset and ready to be resynced.
- ❑ Follow step 3 to sync the chime and push button.

## Safety Information

**WARNING:** Keep batteries out of reach of children.

## Specifications

Doorbell Type	Wireless
Number of Push Buttons	1
Included Hardware	(2) #4 x ¾ in. Screws, (1) 18x31mm Adhesive Sticker, (1) #6 x ¾ in. Screw, and (1) Wall Anchor
Finished Product Dimensions	4.79 in. Height x 2.75 in. Width x 1.03 in. Depth
Transmission Range	100 ft.
Number of Sounds	2
Chime Power Source	(3) AA Batteries (not included)
Push Button Power Source	CR2032 Battery (included)

## Troubleshooting

Problem	Possible Cause	Solution
Chime does not sound when push button is pressed.	Push button battery has not been activated.	Confirm the activation tab has been removed and the battery is seated properly in the button.
	The chime and push button are out of transmission range.	Move the chime closer to the push button location. Ensure there are no metallic objects or concrete walls hindering the signal.
	Push button battery needs to be replaced.	Replace the push button battery with a CR2032 Lithium Coin battery.
	Chime batteries need to be replaced.	Replace the chime batteries with (3) AA batteries.
Chime is sounding without the push button being pushed.	An outside signal is interfering with the signal between the chime and push button.	Resync the chime and push button following the steps in the instructions.

## Warranty

### WHAT IS COVERED

The Warrantor is pleased to extend this Warranty to you, the original consumer/end user (“Consumer”) of the doorbell products and listed by model number below (“Doorbell Product”). This Warranty is valid for any Doorbell Product used in standard residential applications, and may not be assigned or transferred by you.

For a period of one (1) year from the date of purchase, Warrantor, at its sole option, will repair, replace or refund the purchase price for any Doorbell Product used in a standard residential application that malfunctions due to factory defective parts or defective workmanship in the manufacture or assembly of the Doorbell Product.

# WHAT IS NOT COVERED

Warrantor shall have no further liability or obligation except as expressly stated herein.

This Warranty does not apply to any Doorbell Product that has been abused, misused, modified, subjected to abnormal use conditions, stored improperly prior to installation, or otherwise used in any way not intended by Warrantor.

This Warranty is limited to repair, replacement or refund as set forth above and any additional reimbursement is expressly excluded from this Warranty, including but not limited to reimbursement for inconvenience, installation costs, loss of use, return shipping charges, and batteries or other expendable items.

If a claim is made under this Warranty on a product that is no longer available, Warrantor reserves the right to provide a similar product of comparable quality and value.

To make a claim under this Warranty, the Consumer must, within ninety (90) days of actual or constructive knowledge of damage covered by this Warranty, return the product to your local The Home Depot store, or call Customer Service at 1-855-556-1852.

Warrantor does not make any implied warranty of merchantability or fitness of the product for a particular purpose. There are no other warranties that extend beyond the description on the face hereof.

This Warranty gives you specific legal rights and you may have additional rights under applicable law.

Contact the Customer Service Team at 1-855-556-1852 or visit [www.HomeDepot.com](http://www.HomeDepot.com).

You are cautioned that changes or modifications not expressly approved by the party responsible for compliance could void your authority to operate the equipment.

This device complies with Part 15 of the FCC Rules. Operation is subject to the following two conditions:  
(1) this device may not cause harmful interference, and  
(2) this device must accept any interference received, including interference that may cause undesired operation.

This device complies with Industry Canada’s licence-exempt RSSs. Operation is subject to the following two conditions:  
(1) This device may not cause interference; and  
(2) This device must accept any interference, including interference that may cause undesired operation of the device.

Le présent appareil est conforme aux CNR d’Industrie Canada applicables aux appareils radio exempts de licence. L’exploitation est autorisée aux deux conditions suivantes :  
(1) l’appareil ne doit pas produire de brouillage, et  
(2) l’utilisateur de l’appareil doit accepter tout brouillage radioélectrique subi, même si le brouillage est susceptible d’en compromettre le fonctionnement.