

# xPRESS Audio Keypad 70800

## xPRESS Audio Keypad

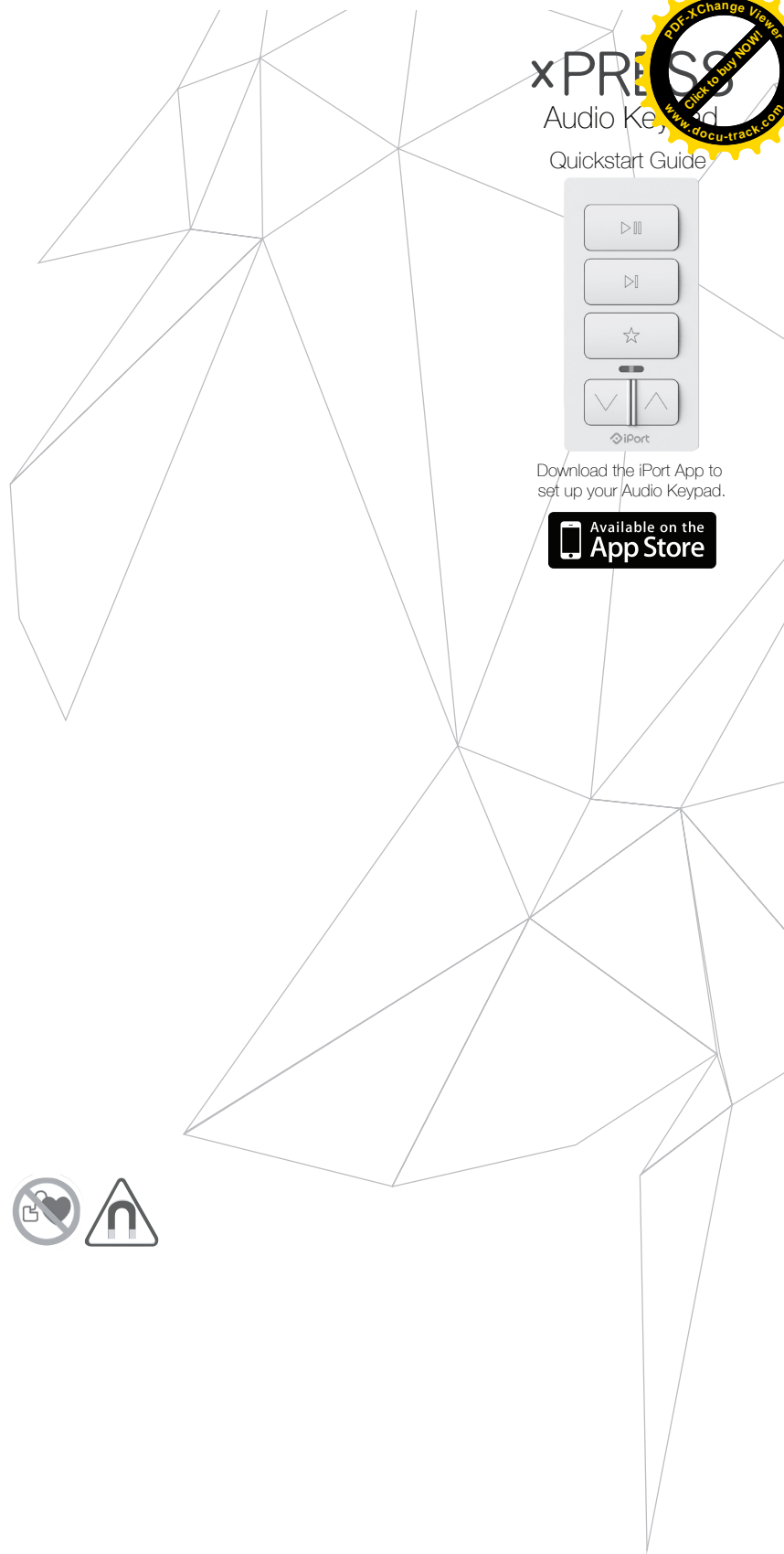

xPRESS  
Audio Keypad  
Quickstart Guide

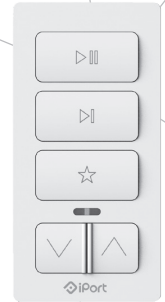

Download the iPort App to set up your Audio Keypad.



**CAUTION:** This product contains magnets. Do not place in direct proximity with magnetically sensitive objects such as credit cards or exposed hard drives. Persons with pace makers are not recommended to use this product.



**CAUTION:** Only use this product as directed. Do not dismantle product. Unspecified use could result in injury.

Designed and engineered in the USA.  
Assembled in the USA and in China.

Warranty at [iportproducts.com](http://iportproducts.com)

iPort  
212 Avenida Fabricante  
San Clemente, CA 92672 USA

+1.949.226.5222  
[iportproducts.com](http://iportproducts.com)

iPort is a trademark of Dana Innovations, registered in the U.S. and other countries. Copyright 2016, all rights reserved.  
Sonos is a trademark of Sonos Inc., registered in the U.S. and other countries. Copyright 2016, all rights reserved.

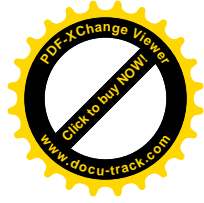
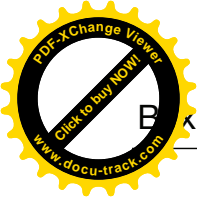

# Table of Contents

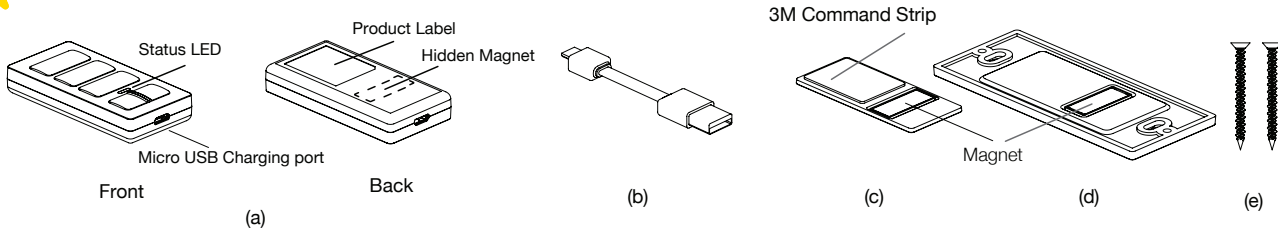

Quickstart Guide  
xPRESS Audio Keypad (a)

Micro USB Cable (b)  
Peel and Stick Plate (c)

Wall Plate Adapter (d)  
Mounting Screws (e)

## Audio Keypad Setup



To configure your Audio Keypad to work with your Sonos devices, download the iPort app from the app store and follow the steps within the App. Requires an iPhone, iPad or iPod touch.

For troubleshooting and questions on device setup with Sonos, visit [iPortProducts.com/xpress](http://iPortProducts.com/xpress).

## Audio Keypad LED Status

- Blue** - Configuration Mode
- White** - Device Functioning correctly on the network
- Yellow** - Fail State, could mean several things:
  1. Failed connection to the network
  2. Failed connection to Sonos device
  3. Sonos does not currently allow this function

- Blinking Red** - Low Battery
- Solid Red** - Battery Charging turns green when charging is complete.
- Purple** - Firmware Update mode, goes away when firmware update is complete.

## Installation on Wall

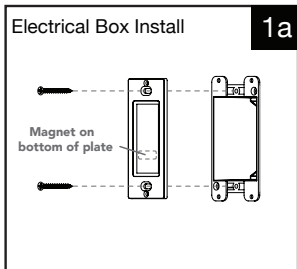

Screw the wall plate adapter to the wallbox with the provided screws. Be sure the magnet is on the bottom.

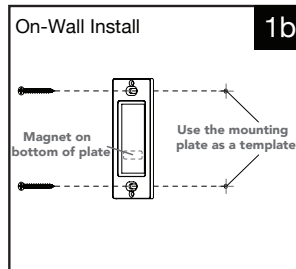

Mark the holes using the wall plate adapter and use the screws provided to screw the wall plate adapter to the wall. No other anchors are required.

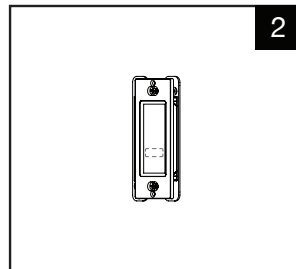

Be sure the wall plate adapter is level and tightened.

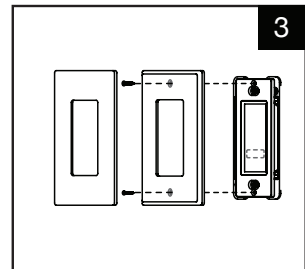

Use any Decora compatible wall plate (sold separately). Screw the wall plate base on with the trim screws provided with the wall plate.

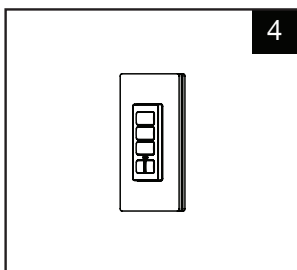

Snap the wall plate cover on and attach the xPRESS Audio Keypad. The keypad magnetically attaches to the wall plate adapter and can be removed at any time.

**NOTE: If keypad does not magnetically attract, check the orientation of the wall plate adapter.**

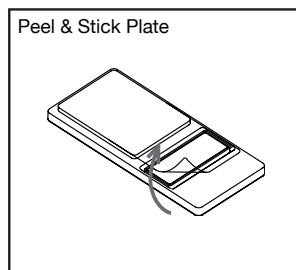

Peel plastic to reveal the adhesive strip. Stick onto a wall or furniture. The keypad magnetically attaches to the wall plate adapter and can be removed at any time.

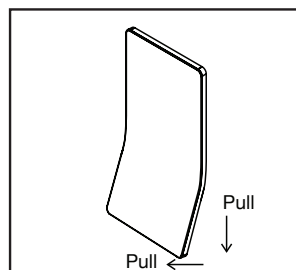

To remove the peel and stick plate, pry up the bottom and pull/stretch the adhesive strip downward.

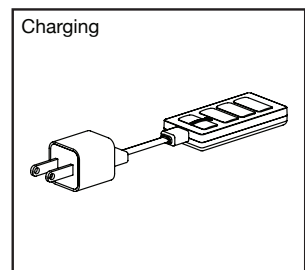

To charge, connect the micro USB cable to any 5v USB power adapter like a smart phone charger. Charging takes about 3 hours. When the red LED on the Keypad turns green, charging is complete.



PRODUCTS    APPLICATIONS

SUPPORT    COMPANY

STORE

## FCC IC

This device complies with part 15 of the FCC Rules and Industry Canada license-exempt RSS standard(s). Operation is subject to the following two conditions:

- (1) This device may not cause interference, and
- (2) this device must accept any interference, including interference that may cause undesired operation.

Modifications not expressly approved by Dana Innovations DBA iPort could void the user's authority to operate this equipment.

Note: This equipment has been tested and found to comply with the limits for a Class B digital device, pursuant to part 15 of the FCC Rules. These limits are designed to provide reasonable protection against harmful interference in a residential installation. This equipment generates, uses and can radiate radio frequency energy and, if not installed and used in accordance with the instructions, may cause harmful interference to radio communications. However, there is no guarantee that interference will not occur in a particular installation. If this equipment does cause harmful interference to radio or television reception, which can be determined by turning the equipment off and on, the user is encouraged to try to correct the interference by one or more of the following measures:

- Reorient or relocate the receiving antenna
- Increase the separation between the equipment and receiver
- Connect the equipment into an outlet on a circuit different from that to which the receiver is connected
- Consult the dealer or an experienced radio/TV technician for help

## Información FCC/ IC:

Este dispositivo cumple con las Reglas de la FCC, Parte 15 y con las normas RSS de Industry Canada para dispositivos exentos de licencia. La operación está sujeta a las dos condiciones siguientes:

- (1) Este dispositivo no debe causar interferencia perjudicial y
- (2) Este dispositivo debe aceptar cualquier interferencia recibida, incluyendo las que pueden causar una operación indeseada.

Cualquier cambio o modificación sin la aprobación explícita de Dana Innovations DBA iPort pueden anular la autorización del usuario para operar el equipo.

NOTA: Este equipo ha sido probado y se comprobó que cumple con los límites para un dispositivo digital de Clase B, de acuerdo con la Parte 15 de las Reglas de la FCC. Estos límites se han diseñado para proveer protección razonable contra interferencia dañina en una instalación residencial. Este equipo genera, usa y puede emitir energía de radio frecuencia y si no se instala y utiliza de acuerdo con las instrucciones, puede causar interferencia dañina a las comunicaciones de radio. Sin embargo, no hay garantía de que no ocurrirá interferencia en una instalación determinada. Si este equipo causa interferencia dañina a la recepción de la radio o la televisión, la cual se puede determinar encendiendo y apagando el equipo, el usuario puede tratar de corregir la interferencia mediante uno o más de los siguientes procedimientos:

- Volver a orientar o reubicar la antena receptora
- Aumentar la separación entre el equipo y el receptor
- Conectar el equipo a un tomacorriente que esté en un circuito diferente al del receptor
- Consultar al distribuidor o a un técnico experimentado en radio/TV

## Information de la FCC/ IC :

Ce dispositif est conforme à la section 15 des règlements du FCC et des standards CNR exempt de licence d'Industrie Canada. L'opération est sous réserve des deux conditions suivantes :

- (1) Cet appareil ne peut causer d'interférence nuisible, et
- (2) Cet appareil doit tolérer toute interférence, même celle pouvant affecter son fonctionnement.

Tout changement ou modification sans l'autorisation expresse de Dana Innovations DBA iPort pourrait annuler le droit d'utiliser cet équipement.

REMARQUE : Cet équipement a été testé et jugé conforme aux limites applicables aux dispositifs numériques Classe B, conformément à la section 15 des règles de la FCC. Ces limites sont conçues pour procurer une protection raisonnable contre les perturbations nuisibles en application résidentielle. Cet équipement génère, utilise et peut radier l'énergie de fréquences radiophoniques. S'il n'est pas installé et utilisé selon les directives, peut causer des interférences radiophoniques nuisibles. Cependant, il n'y a aucune garantie à l'effet qu'aucune interférence ne se produira dans une installation précise. Si votre équipement produit de l'interférence à la réception radiophonique ou télévisuelle, ce qui peut être détecté en coupant et refermant l'alimentation au système d'éclairage. Dans le cas d'interférence,

l'utilisateur sera contraint d'essayer de corriger la situation par un ou plusieurs des moyens suivants :

- Réorienter ou re-localiser l'antenne de réception
- Augmenter la distance séparant l'équipement et le récepteur
- Brancher l'équipement sur un circuit différent que celui sur lequel le récepteur est branché
- Demander l'aide du distributeur ou d'un technicien expérimenté en radio et télévision

## Informações da FCC/ IC:

Este dispositivo está em conformidade com a Parte 15 das normas FCC e com as normas RSS de isenção de licença da indústria do Canadá. A operação está sujeita às duas condições abaixo:

- (1) Este dispositivo não deve causar interferência prejudicial e
- (2) este dispositivo aceita qualquer interferência recebida, incluindo interferência que possa causar funcionamento indesejado.

Nota: Este equipamento foi testado e considerado adequado aos limites para a Classe B de dispositivos digitais, de acordo com a Parte 15 das normas da FCC. Esses limites foram criados para oferecer uma proteção razoável contra interferência nociva em uma instalação residencial. Este equipamento gera, usa e pode irradiar energia de radiofrequência e, caso não seja instalado de acordo com as instruções, pode causar interferência nociva às comunicações de rádio. No entanto, não há garantia de que tal interferência não vá ocorrer em uma determinada instalação. Se esse equipamento causar interferência nociva à recepção de rádio ou televisão, que pode ser percebida ao ligar e desligar o equipamento, o usuário é encorajado a tentar corrigir o problema por meio de uma ou mais das seguintes medidas:

- Mude a direção ou a localização da antena de recepção

- Aumente a separação entre o equipamento e o receptor
- Conecte o equipamento a uma saída em um circuito diferente daquele ao qual o receptor está conectado
- Consulte o distribuidor ou um técnico experiente de rádio/TV para obter ajuda

[+ Legal](#)[Enterprise](#)[Residential](#)[Warranty](#)[MAP Policy](#)[Sales Policy](#)

## iPort in the Press

CEProInc.The  
New York  
Times  
GAMES  
NYTIMES.COM

Sign up to receive periodic news & updates.

Contact Us  +1 949 226 5222

**SIGN UP**

We respect your privacy.

iPort is a brand of [Dana Innovations](#) | Copyright 2017 © iPort. All Rights Reserved.