

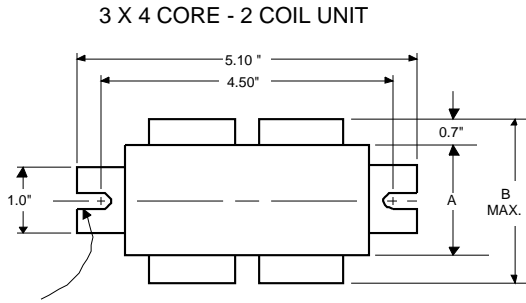

**Metal  
Halide  
Lamp Ballast**

**Catalog Number 71A5771  
For 250W M58  
60 Hz CWA  
Status: Active**

**DIMENSIONS AND DATA**



0.25" WIDE  
2 SLOTS

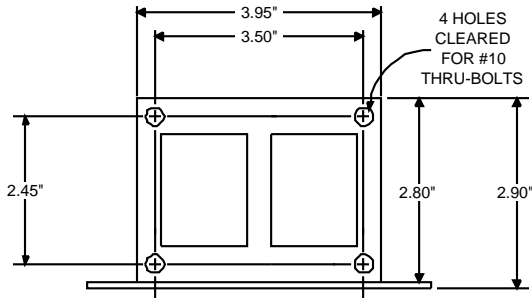

		120	208	240	277
<b>INPUT VOLTS</b>					
CIRCUIT TYPE	CWA				
POWER FACTOR (min)	90%				
<b>REGULATION</b>					
Line Volts	±10%				
Lamp Watts	±8%				
<b>LINE CURRENT (Amps)</b>					
Operating.....		2.60	1.50	1.30	1.10
Open Circuit.....		2.60	1.50	1.30	1.10
Starting.....		1.00	0.60	0.50	0.45
<b>UL TEMPERATURE RATINGS</b>					
Insulation Class	H(180°C)				
Coil Temperature Code	1029	C	C	D	D
MIN. AMBIENT STARTING TEMP.	-20°F or -30°C				
NOM. OPEN CIRCUIT VOLTAGE	300				
INPUT VOLTAGE AT LAMP DROPOUT.....		60	104	120	138
INPUT WATTS	294				
RECOMMENDED FUSE (Amps).....		8	5	5	3
<b>CORE and COIL</b>					
Dimension (A)	3.00				
Dimension (B)	4.20				
Weight (lbs.)	9				
Lead Lengths	12"				
<b>CAPACITOR REQUIREMENT</b>					
Microfarads	15.0				
Volts (min.)	400				
Fault Current Withstand (amps)					
<b>60 Hz TEST PROCEDURES (Refer to Advance Test Procedure for HID Ballasts - Form 1270)</b>					
<b>High Potential Test (Volts)</b>					
1 minute	2000				
2 seconds	2500				
Open Circuit Voltage Test (Volts)	270-330				
Short-Circuit Current Test (Amps)					
Secondary Current	2.00-3.00				
Input Current.....		1.20	0.70	0.60	0.50
		1.80	1.00	0.90	0.75

Capacitor: 7C150P40-R



Capacitance: 15  
Dia/Oval Dim: 1.75  
Height: 3.75  
Temp Rating: 105°C

Ignitor: NA

This ballast does not require the use of an ignitor.



**Wiring Diagram:**

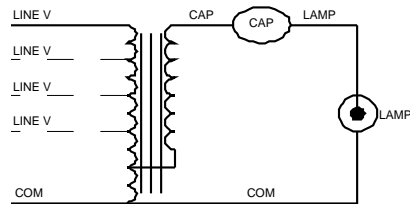

Fig. A

**Typical Ordering Information**

(please call Advance for suffix availability)

Order Suffix	Description

Data is based upon tests performed by Advance Transformer in a controlled environment and representative of relative performance. Actual performance can vary depending on operating conditions. Specifications are subject to change without notice.

**ADVANCE**

O'HARE INTERNATIONAL CENTER · 10275 WEST HIGGINS ROAD · ROSEMONT, IL 60018  
Customer Support/Technical Service: Phone: 800-372-3331 · Fax: 630-307-3071  
Corporate Offices: Phone: 800-322-2086

07/29/05