

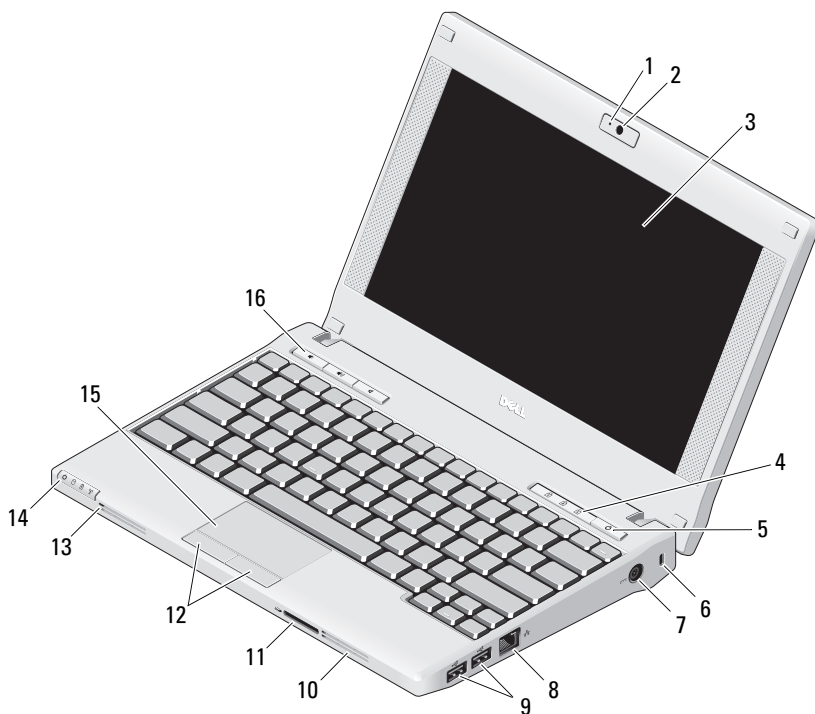

About Warnings

 **WARNING:** A WARNING indicates a potential for property damage, personal injury, or death.

Dell™ Latitude™ 2100 Setup and Features Information



- | | | | |
|---|--|---|----------------------------|
| 1 | camera status light (optional) | 2 | camera (optional) |
| 3 | display (touch screen feature is optional) | 4 | keyboard status lights (3) |
| 5 | power button | 6 | security cable slot |
| 7 | AC adapter connector | 8 | network connector |

March 2009



OG080NA00

Model P02T series

- | | | | |
|----|--|----|--------------------------|
| 9 | USB connectors (2) | 10 | cooling vents |
| 11 | Secure Digital (SD) memory-card reader | 12 | touch pad buttons (2) |
| 13 | microphone connector | 14 | device status lights (4) |
| 15 | touch pad | 16 | media controls (3) |

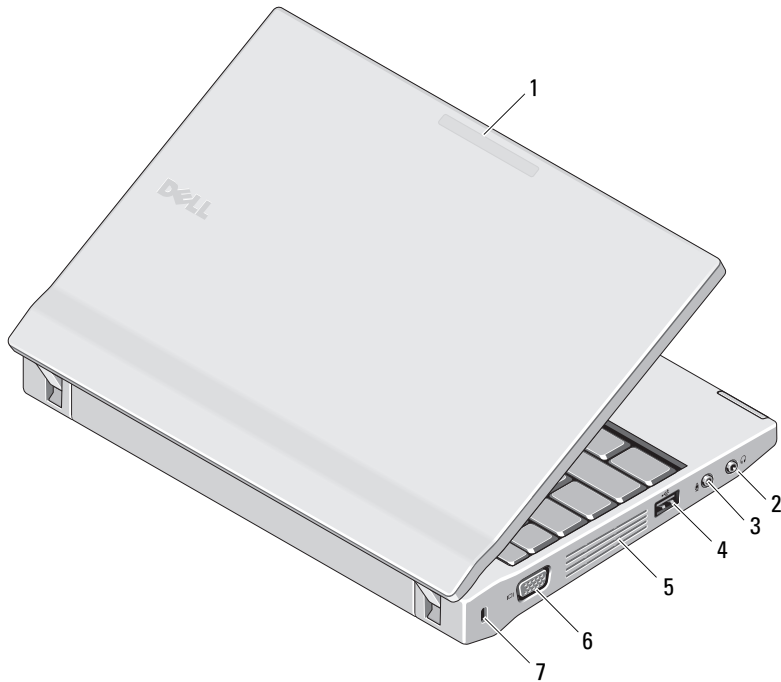

- | | | | |
|---|---|---|--|
| 1 | usage mode indicator | 2 | line-in connector (headphones connector) |
| 3 | line-out connector (microphone connector) | 4 | USB connector |
| 5 | cooling vents | 6 | video connector |
| 7 | security cable slot | | |





WARNING: Do not block, push objects into, or allow dust to accumulate in the air vents. Do not store your Dell™ computer in a low-airflow environment, such as a closed briefcase, while it is running. Restricting the airflow can damage the computer or cause a fire. The computer turns on the fan when the computer gets hot. Fan noise is normal and does not indicate a problem with the fan or the computer.

Quick Setup

 **WARNING:** Before you begin any of the procedures in this section, read the safety information that shipped with your computer. For additional best practices information, see www.dell.com/regulatory_compliance.

 **WARNING:** The AC adapter works with electrical outlets worldwide. However, power connectors and power strips vary among countries. Using an incompatible cable or improperly connecting the cable to the power strip or electrical outlet may cause fire or equipment damage.

 **CAUTION:** When you disconnect the AC adapter cable from the computer, grasp the connector, not the cable itself, and pull firmly but gently to avoid damaging the cable. When you wrap the AC adapter cable, ensure that you follow the angle of the connector on the AC adapter to avoid damaging the cable.

 **NOTE:** Some devices may not be included if you did not order them.

- 1 Connect the AC adapter to the AC adapter connector on the portable computer and to the electrical outlet.

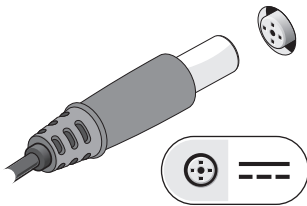

- 2 Connect the network cable (optional).

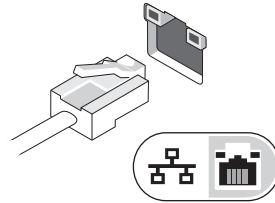

- 3 Connect USB devices, such as a mouse or keyboard (optional).

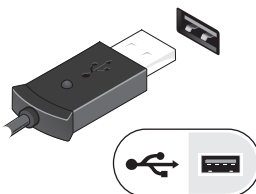

- 4 Open the computer display and press the power button to turn on the computer.

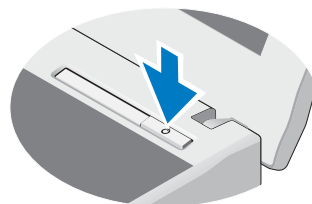

 **NOTE:** It is recommended that you turn on and shut down your computer at least once before you install any cards or connect the computer to a docking device or other external device, such as a printer.

Specifications



NOTE: Offerings may vary by region. For more information regarding the configuration of your computer, click **Start**→**Help and Support** and select the option to view information about your computer.

System Information

Processor type	Intel® Atom™ N270
Chipset	Intel 945GSE

Video

Video type	Intel UMA graphics integrated on the system board
Data bus	integrated video
Video controller	Intel Gen 3.5 Integrated Graphics Engine

Battery

Type	6-cell "smart" lithium ion (56 WHr) 3-cell "smart" lithium ion (28 WHr)
------	--

Dimensions:

6-cell lithium-ion batteries

Depth	48.13 mm (1.89 inches)
Height	42.46 mm (1.67 inches)
Width	204 mm (8.03 inches)

3-cell lithium-ion batteries

Depth	40.50 mm (1.59 inches)
Height	23.24 mm (0.92 inches)
Width	204 mm (8.03 inches)

Weight

6-cell lithium-ion batteries
minimum weight — 340 gms (0.74 lbs)
maximum weight — 350 gms (0.77 lbs)

3-cell lithium-ion batteries
minimum weight — 185 gms (0.40 lbs)
maximum weight — 190 gms (0.41 lbs)

Voltage
11.1 VDC (6-cell and 3-cell)

Battery (continued)

Temperature range:

Operating	0° to 35°C (32° to 95°F)
Storage	-40° to 60°C (-40° to 149°F)
Coin-cell battery	CR2032

AC Adapter

Input voltage	100–240 VAC
Input current (maximum)	1.5 A
Input frequency	50–60 Hz
Output power	65 W or 90 W
Output current :	
65 W	4.34 A (maximum at 4-second pulse) 3.34 A (continuous)
90 W	5.62 A (maximum at 4-second pulse) 4.62 A (continuous)
Rated output voltage	19.5 +/-1.0 VDC
Dimensions:	
65 W	
Height	27.2 mm (1.07 inches)
Width	137.2 mm (5.40 inches)
Depth	57.8 mm (2.27 inches)
90 W	
Height	34.2 mm (1.35 inches)
Width	60.8 mm (2.39 inches)
Depth	153.45 mm (6.04 inches)
Temperature range:	
Operating	0° to 35°C (32° to 95°F)
Storage	-40° to 65°C (-40° to 149°F)

Physical

Height	22.5 to 39.9 mm (0.89 to 1.57 inches) without touchscreen 24.1 to 41.5 mm (0.95 to 1.63 inches) with touchscreen
Width	265 mm (10.43 inches) with/without touchscreen
Depth	187 mm (7.36 inches) with/without touchscreen
Weight (3-cell battery without touch screen)	1.36 Kg (3.0 lbs)

Environmental

Temperature range:

Operating	0° to 35°C (32° to 95°F)
Storage	-40° to 65°C (-40° to 149°F)

Relative humidity (maximum):

Operating	10% to 90% (noncondensing)
Storage	5% to 95% (noncondensing)

Altitude (maximum):

Operating	-15.2 to 3048 m (-50 to 10,000 ft)
Storage	-15.2 to 10,668 m (-50 to 35,000 ft)

Finding More Information and Resources

If you need to:

Find safety best practices information for your computer, review Warranty information, Terms and Conditions (U.S. only), Safety instructions, Regulatory information, Ergonomics information, and End User License Agreement.

See:

The safety and regulatory documents that shipped with your computer and the Regulatory Compliance Homepage at www.dell.com/regulatory_compliance.

Information in this document is subject to change without notice.

© 2009 Dell Inc. All rights reserved. Printed in the U.S.A.

Reproduction of these materials in any manner whatsoever without the written permission of Dell Inc. is strictly forbidden.

Trademarks used in this text: *Dell*, the *DELL* logo, and *Latitude* are trademarks of Dell Inc.; *Intel* is a registered trademark and *Atom* is a trademark of Intel Corporation in the U.S. and other countries.

Other trademarks and trade names may be used in this document to refer to either the entities claiming the marks and names or their products. Dell Inc. disclaims any proprietary interest in trademarks and trade names other than its own.

