

# MyDeltaSolar DC1 and User Interface





## MyDeltaSolar

1. This APP should collocate with data collector and Delta Inverter.
2. If inverter is not connected to cloud, you still can monitor inverter operation by APP.

### Where can search for MyDeltaSolar APP?

- QR Code : Please scan the QR code to DSC cloud (web).
- IOS system : Please search “MyDeltaSolar” in App store.
- Android system : Please search “MyDeltaSolar” in Google Play.

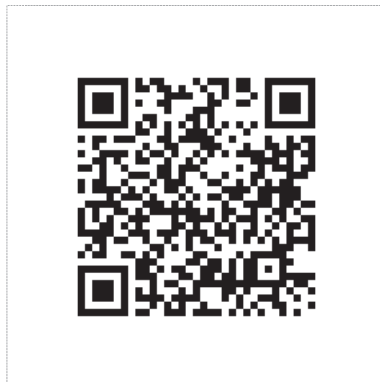

QR Code

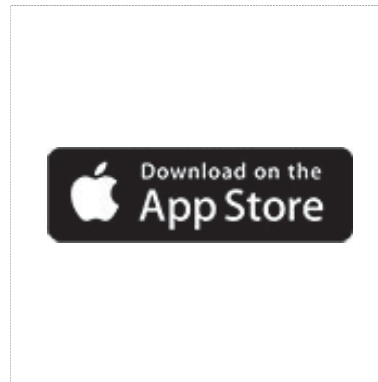

IOS

<https://itunes.apple.com/ng/app/mydeltasolar/id1271609228?mt=8>

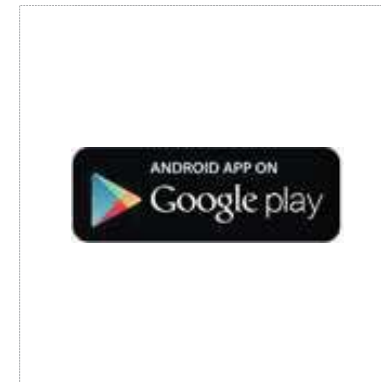

Android

[https://play.google.com/store/apps/details?id=com.mydeltasolar\\_1\\_0\\_0.app&hl=zh-TW](https://play.google.com/store/apps/details?id=com.mydeltasolar_1_0_0.app&hl=zh-TW)

The screenshot illustrates the registration process in three steps:

- Step 1:** The user is on the 'Login' page. They enter their email (E-mail@example.com) and a password (8-16 characters). A hand icon with the number '1' points to the 'Create account' link.
- Step 2:** A modal window titled 'Use MyDeltaSolar Service terms and conditions' is displayed. A hand icon with the number '2' points to the checkbox for 'I had read and agree this declaration as above.'
- Step 3:** A hand icon with the number '3' points to the 'Go to Register' button at the bottom of the modal.

- Login :

1. Please fill in user e-mail & password.

\*If you have registered, the mobile will remember account info. Then please fill in password.

2. Please click "Create account" to create an user's account.

3. User have to check the box  to enable "Go to Register" button.

4. Please click "Go to Register" to register.

**Go to Register**

**Cloud Register**

\* E-mail : Aska.chiu@deltaww.com

\* Password : .....

\* Confirm Password : .....

Do you want to use the MyDeltaSolar Cloud?  
 Yes  No

\* Plant Name : Plant 1

\* Country : France

\* Location :  No  Yes

\*The location will record in the cloud to service.

**Cloud Register**

\* E-mail : Aska.chiu@deltaww.com

\* Password : .....

\* Confirm Password : .....

Do you want to use the MyDeltaSolar Cloud?  
 Yes  No

**- REGISTER :**  
 One account can register many plants.

**- USE CLOUD / DC1 :**  
**Yes** -> Switch to cloud page.  
**No** -> Home page ( DC1 Monitor ).

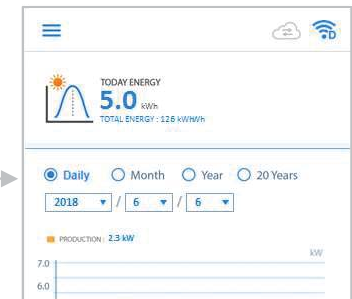

If one country have multi-grid code, user have to choose the correct grid code.  
 e.g. User choose France here :

**Connection**

Search  Auto  RS485  Wi-Fi  Sub-1G

DC1 SETTING SET INV GET INFO SYNC TIME

Country : CE

Grid Code : France

Frequency : 863.58 MHz

Scan Frequency **Quality : 100**

If the quality value is not 100, there might be some devises are using this frequency band. Communication may be disturbed by these devices.

Block Setting



Choose SSID :  
**Delta-serial number**



Enter default password :  
**DELTA SOL**

### Wi-Fi Connection Procedure by APP

1. Turn on DC1.
2. Turn on Wi-Fi function of mobile device. (cell phone, tablet)
3. Search and choose DC1' SSID (**Delta-serial number-DC1**).
4. Enter the default password "DELTA SOL" to get DC1 connected.
5. Open MyDeltaSolar APP.

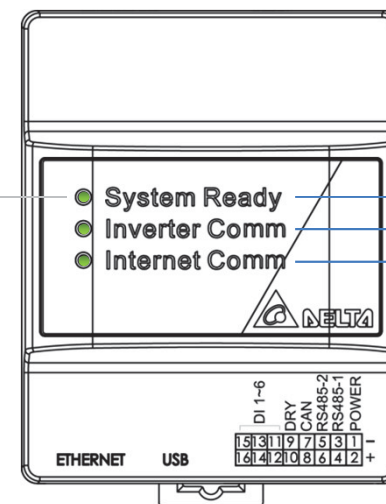

- Turn on DC1.
- Inverter connected.
- Internet is success.

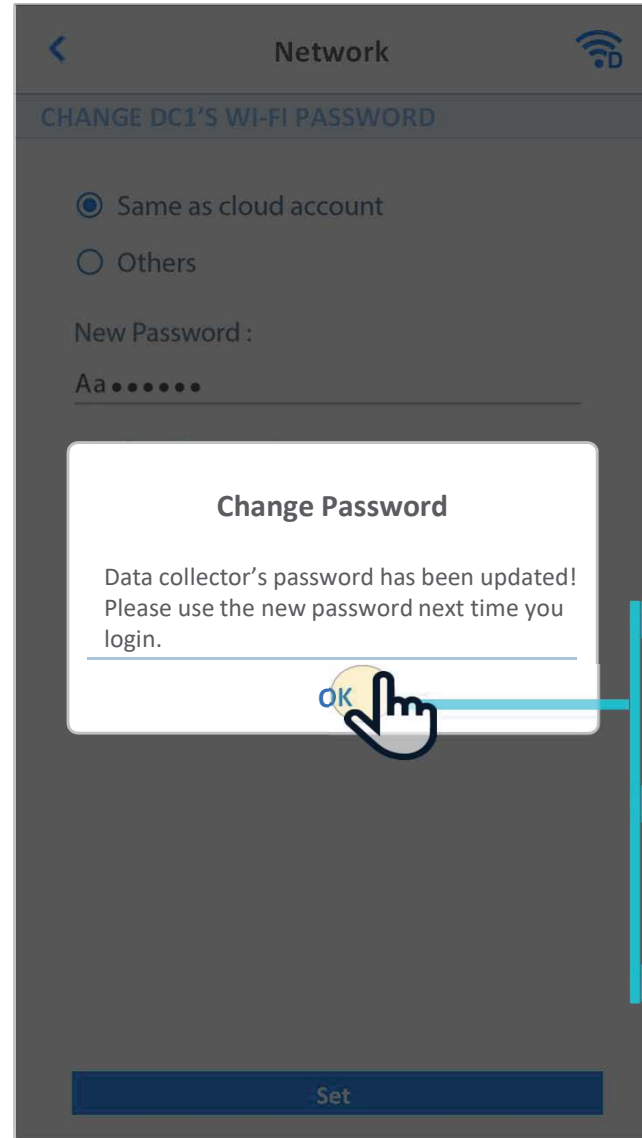
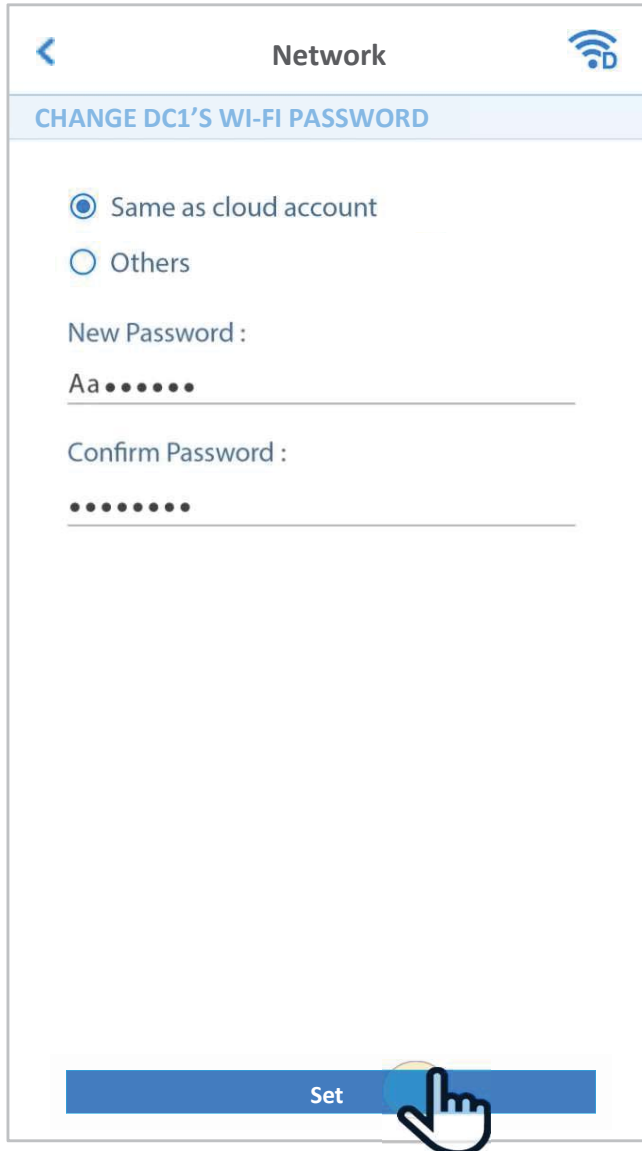

- **CHANGE DC1'S PASSWORD :**
  1. **Same as cloud account :** The system enter user's password automatically.
  2. **Others :** User can change password, and fill in "confirm password" to double confirm.

\*Change your password by using strong one what you don't use elsewhere immediately to protect your account.

- **Connection (page 9-13) :**  
If this data collector isn't set up yet, APP will direct to this page and start the following set up procedure.

- **Network (page 14) :**  
If user want this data collector uses delta cloud service, but it's network connection is not set up yet.

- **Cloud (page 15) :**  
If this data collector is completely set up, APP wilt direct to cloud page.

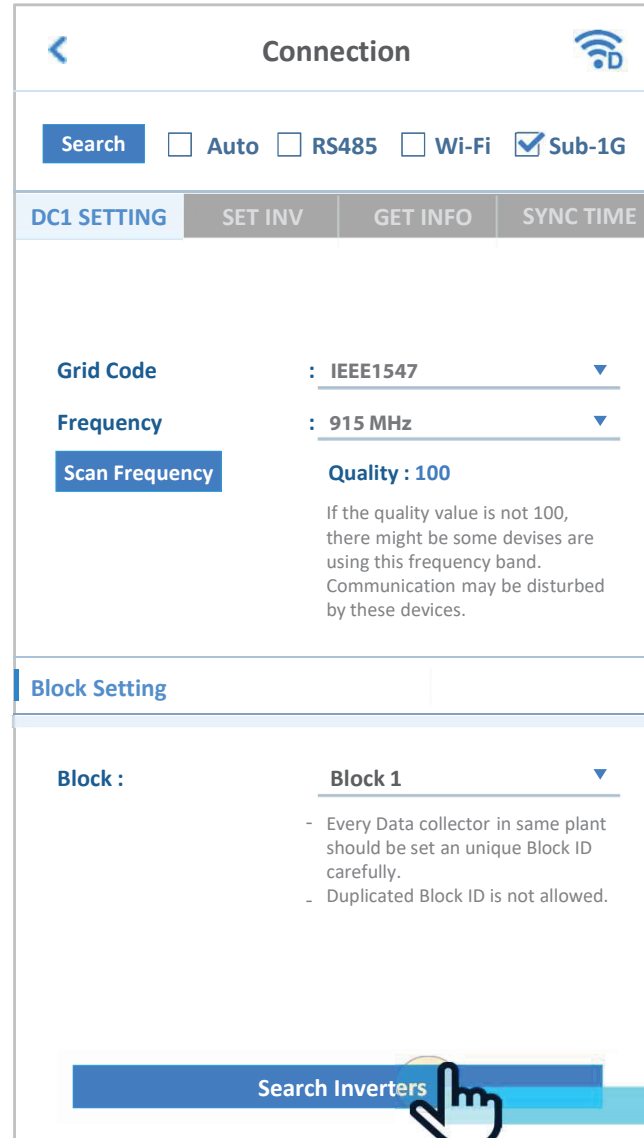
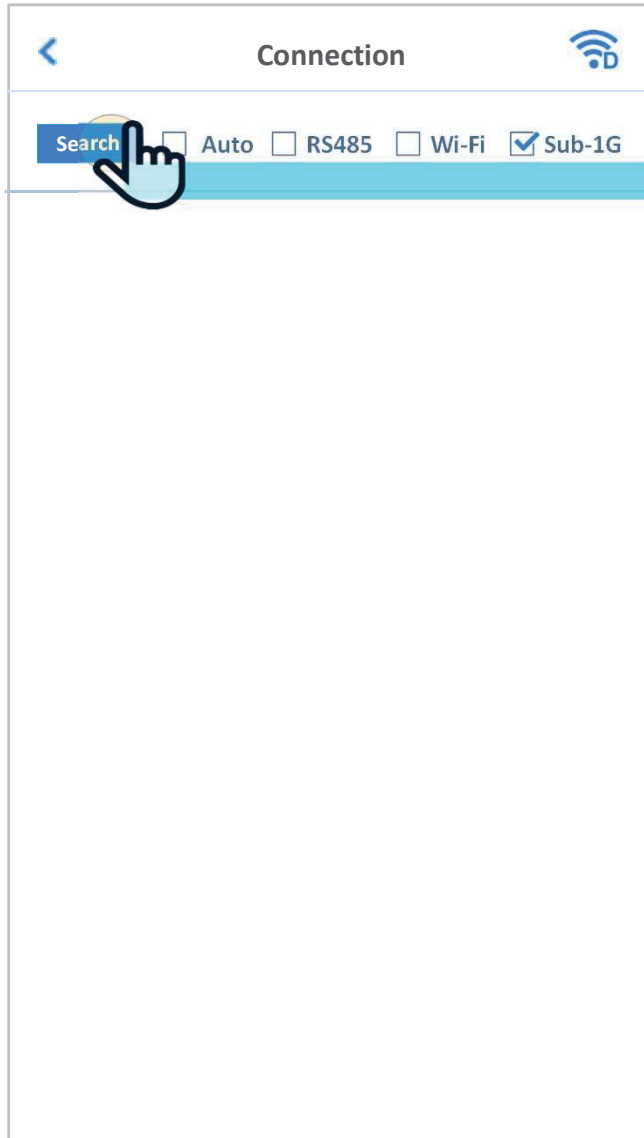

**- Search Button :**  
Select Sub-1G and click Search button to start DC1 setting process.

If this data collector isn't set up yet, APP will direct to this page and start the following set up procedure ( page 9-13 ).

**Grid Code :** Select specific grid codes for utility. Will be written into inverters.  
**Frequency :** Select the desired frequency to scan for quality.

1. Scan one frequency is 10 s.
2. Quality = 100 is OK to use.  
Quality < 100 has been used.
3. Sort : Good (top) → Bad (bottom)

**- Searching Inverters ...**

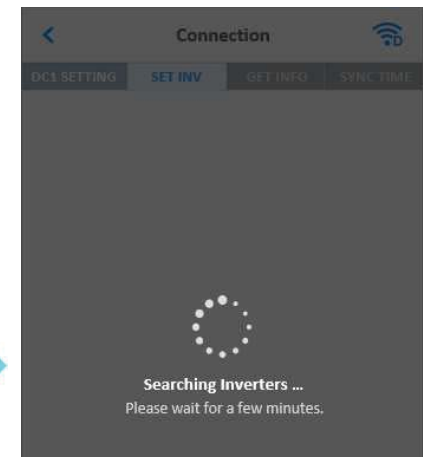

Connection

DC1 SETTING | SET INV | GET INFO | SYNC TIME

Select All Auto ID

Serial Number	ID	SNR	RSSI
<input type="checkbox"/> DE000000000801	1 ▼	7	-72
<input type="checkbox"/> DE000000000802	1 ▼	6	-76
<input type="checkbox"/> DE000000000803	1 ▼	7	-79
<input type="checkbox"/> DE000000000804	1 ▼	5	-82
<input type="checkbox"/> DE000000000805	1 ▼	3	-86
<input type="checkbox"/> DE000000000806	1 ▼	4	-89
<input type="checkbox"/> DE000000000807	1 ▼	5	-92
<input type="checkbox"/> DE000000000808	1 ▼	2	-93
<input type="checkbox"/> DE000000000809	1 ▼	-1	-96
<input type="checkbox"/> DE000000000810	1 ▼	1	-99
<input type="checkbox"/> DE000000000811	1 ▼	0	-101
<input type="checkbox"/> DE000000000812	1 ▼	-1	-103

Refresh Confirm Inverter



Connection

DC1 SETTING | SET INV | GET INFO | SYNC TIME

Select All Auto ID

Serial Number	ID	SNR	RSSI
<input checked="" type="checkbox"/> DE000000000801	1 ▼	7	-72
<input checked="" type="checkbox"/> DE000000000802	1 ▼	6	-76
<input checked="" type="checkbox"/> DE000000000803	1 ▼	7	-79
<input checked="" type="checkbox"/> DE000000000804	1 ▼	5	-82
<input checked="" type="checkbox"/> DE000000000805	1 ▼	3	-86
<input checked="" type="checkbox"/> DE000000000806	1 ▼	4	-89
<input checked="" type="checkbox"/> DE000000000807	1 ▼	5	-92
<input checked="" type="checkbox"/> DE000000000808	1 ▼	2	-93
<input checked="" type="checkbox"/> DE000000000809	1 ▼	-1	-96
<input checked="" type="checkbox"/> DE000000000810	1 ▼	1	-99
<input checked="" type="checkbox"/> DE000000000811	1 ▼	0	-101
<input checked="" type="checkbox"/> DE000000000812	1 ▼	-1	-103

Refresh Confirm Inverter

**- Select All :**  
 This button will select all inverters. When there are more than 25 inverters, the top most 25 inverters will be selected.

**- RSSI :**  
 Indicate the signal quality of every inverter. The larger is better.  
 \* The search result will be sorted by RSSI, the most recommended inverters will on the top of the list.



**Connection**

DC1 SETTING | SET INV | GET INFO | SYNC TIME

Select All **Auto ID**

Serial Number	ID	SNR	RSSI
<input checked="" type="checkbox"/> DE000000000801	1	7	-72
<input checked="" type="checkbox"/> DE000000000802	1	6	-76
<input checked="" type="checkbox"/> DE000000000803	1	7	-79
<input checked="" type="checkbox"/> DE000000000804	1	5	-82
<input checked="" type="checkbox"/> DE000000000805	1	3	-86
<input checked="" type="checkbox"/> DE000000000806	1	4	-89
<input checked="" type="checkbox"/> DE000000000807	1	5	-92
<input checked="" type="checkbox"/> DE000000000808	1	2	-93
<input checked="" type="checkbox"/> DE000000000809	1	-1	-96
<input checked="" type="checkbox"/> DE000000000810	1	1	-99
<input checked="" type="checkbox"/> DE000000000811	1	0	-101
<input checked="" type="checkbox"/> DE000000000812	1	-1	-103

Refresh **Confirm Inverter**



**Connection**

DC1 SETTING | SET INV | GET INFO | SYNC TIME

Select All **Auto ID**

Serial Number	ID	SNR	RSSI
<input checked="" type="checkbox"/> DE000000000801	1	7	-72
<input type="checkbox"/> DE000000000802	1	6	-76
<input checked="" type="checkbox"/> DE000000000803	2	7	-79
<input checked="" type="checkbox"/> DE000000000804	3	5	-82
<input checked="" type="checkbox"/> DE000000000805	4	3	-86
<input checked="" type="checkbox"/> DE000000000806	5	4	-89
<input checked="" type="checkbox"/> DE000000000807	6	5	-92
<input checked="" type="checkbox"/> DE000000000808	7	2	-93
<input checked="" type="checkbox"/> DE000000000809	8	-1	-96
<input checked="" type="checkbox"/> DE000000000810	9	1	-99
<input checked="" type="checkbox"/> DE000000000811	10	0	-101
<input checked="" type="checkbox"/> DE000000000812	11	-1	-103

Refresh **Confirm Inverter**



**- Auto ID :**  
This button will automatically assign an unique ID to every inverter which is selected.

**- Confirm Inverter:**  
User cannot select more than 25 inverters, and duplicated ID is not allowed.

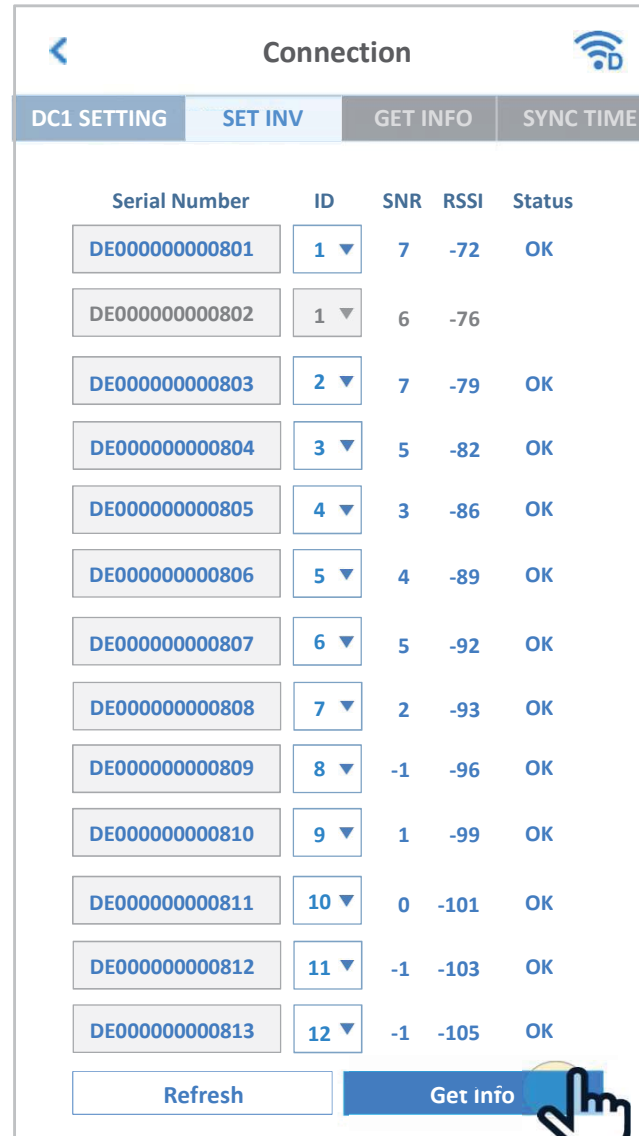
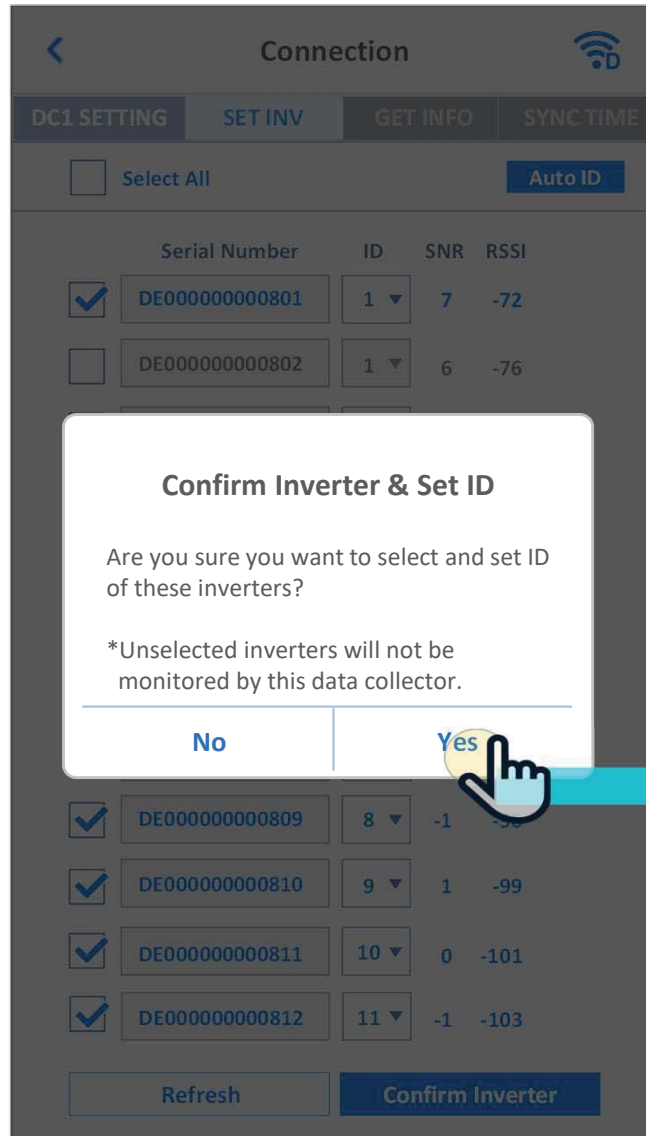

**- Status :**  
 OK : Set inverter ID success.  
 Fail : Set inverter ID fail, need refresh.

**- Get Info**  
 All selected inverters need to be set ID successfully.

**Connection**

DC1 SETTING | SET INV | GET INFO | SYNC TIME

Serial Number	ID	SNR	RSSI	Status
DE000000000801	1	7	-72	OK
DE000000000802	1	6	-76	
DE000000000803	2	7	-79	OK
DE000000000804	3	5	-82	OK
DE000000000805	4	3	-86	OK
DE000000000806	5	4	-89	OK
DE000000000807	6	5	-92	OK
DE000000000808	7	2	-93	OK
DE000000000809	8	-1	-96	OK
DE000000000810	9	1	-99	OK
DE000000000811	10	0	-101	OK
DE000000000812	11	-1	-103	OK
DE000000000813	12	-1	-105	OK

Refresh | Sync time

**Connection**

DC1 SETTING | SET INV | GET INFO | SYNC TIME

Serial Number	ID	SNR	RSSI	Status
DE000000000801	1	7	-72	OK
DE000000000802	1	6	-76	
DE000000000803	2	7	-79	OK
DE000000000804	3	5	-82	OK
DE000000000805	4	3	-86	OK
DE000000000806	5	4	-89	OK
DE000000000807	6	5	-92	OK
DE000000000808	7	2	-93	OK
DE000000000809	8	-1	-96	OK
DE000000000810	9	1	-99	OK
DE000000000811	10	0	-101	OK
DE000000000812	11	-1	-103	OK
DE000000000813	12	-1	-105	OK

Refresh | Next



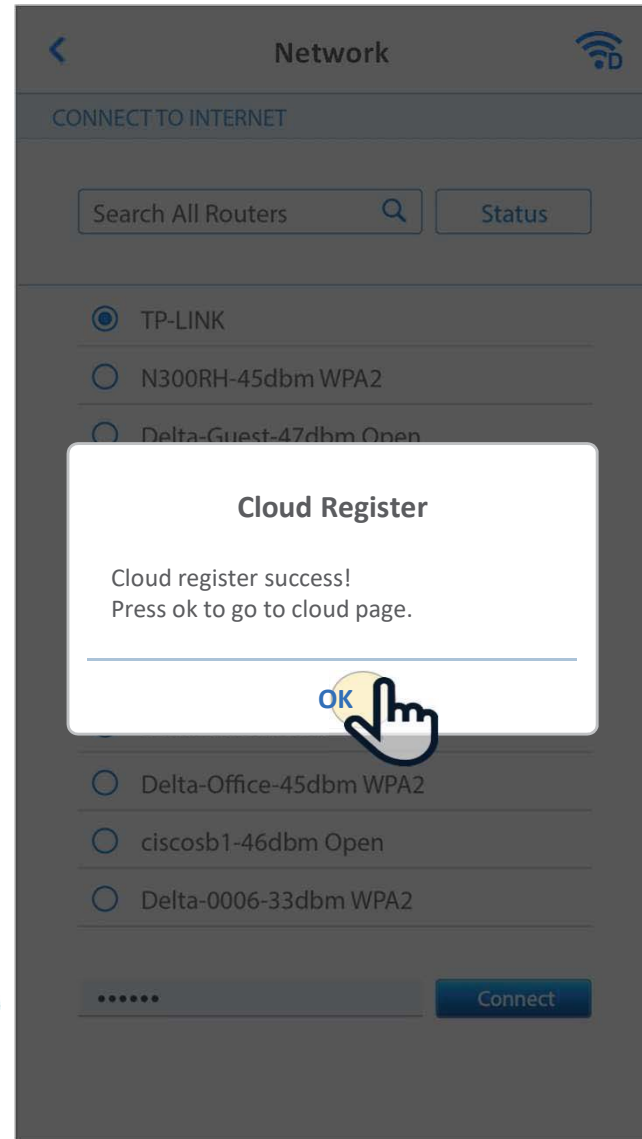
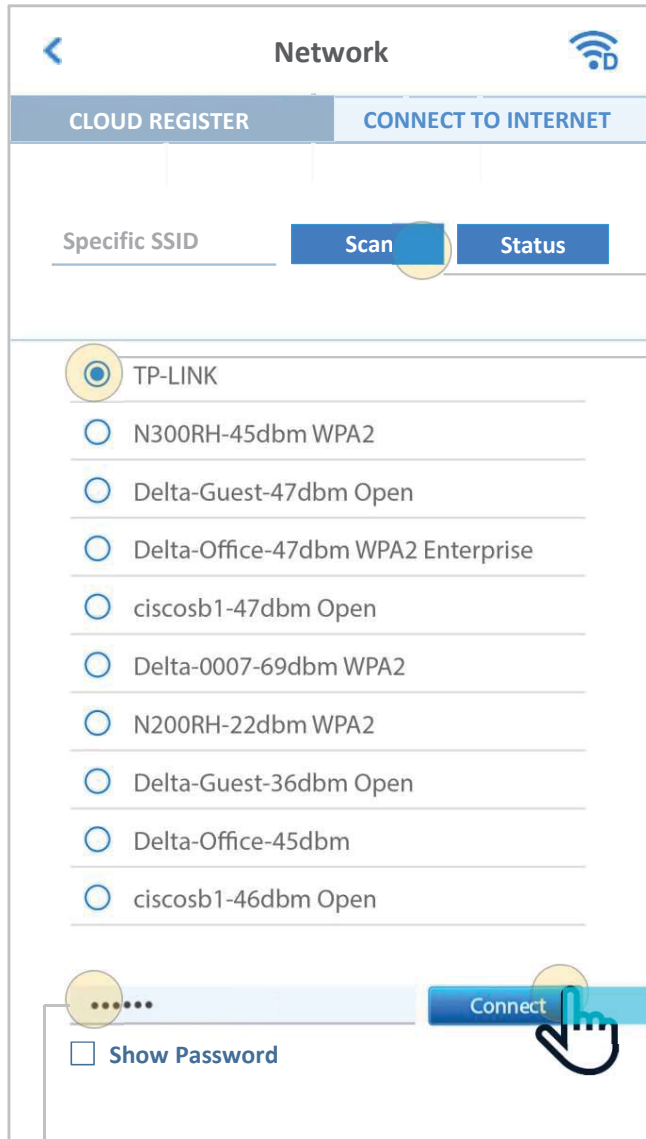

**- Search Internet :**  
1. User click "search" icon to search Wi-Fi access point.

2. Please choose an available Wi-Fi access point.

**- Register Fail :**  
The message box would indicate the reason why register was failed.

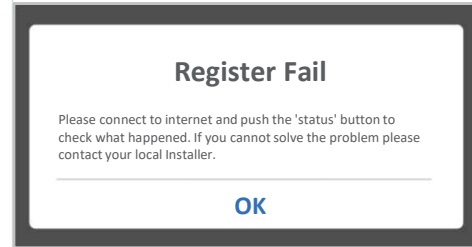

If user want this data collector uses delta cloud service, but it's network connection is not set up yet. Show this page.

Please fill in the Wi-Fi's password, then click "Connect" button.

**Use MyDeltaSolar Service terms and conditions :**

You must need a MyDeltaSolar account in order to use our cloud services. Delta may collect your personal data and protect your privacy when you use MyDeltaSolar service. By using MyDeltaSolar service, you agree that Delta can use such data and monitor your inverter's status if necessary. In some case, Delta employees, authorized contractors or agents may need to use your account to analyze any issue and problem you have while using Delta solar inverter or service. We restrict access to personal information to Delta employees, contractors and agents who need to know that information in order to process it for us, and who are subject to strict contractual confidentiality obligations and may be disciplined or terminated if they fail to meet these obligations.

I had read and agree this declaration

OK





# Antenna Type

<b>Delta Part No.</b>	<b>0990236424</b>	<b>0990242124</b>
<b>Frequency Range</b>	868~928 MHz	
<b>Impedance</b>	50Ω	
<b>VSWR</b>	≤2.5	≤2.0
<b>Radiation</b>	Omni	
<b>Gain</b>	2.0 dBi	1.5 dBi



### **For All device**

**(15.21) Warning:** Changes or modifications to this unit not expressly approved by the party responsible for compliance could void the user authority to operate the equipment.

### **For mobile device**

1. To comply with FCC RF exposure compliance requirements, a separation distance of at least 20 cm must be maintained between the antenna of this device and all persons. **(Not including low power device (below 20mW))**
2. This Transmitter must not be co-located or operating in conjunction with any other antenna or transmitter

### **For Class B digital device or peripheral or cordless phone (15.105)**

This equipment has been tested and found to comply with the limits for a Class B digital device, pursuant to Part 15 of the FCC Rules. These limits are designed to provide reasonable protection against harmful interference in a residential installation. This equipment generates, uses and can radiate radio frequency energy and, if not installed and used in accordance with the instructions, may cause harmful interference to radio communications.

However, there is no guarantee that interference will not occur in a particular installation. If this equipment does cause harmful interference to radio or television reception, which can be determined by turning the equipment off and on, the user is encouraged to try to correct the interference by one or more of the following measures:

- ◆ Reorient or relocate the receiving antenna.
  - ◆ Increase the separation between the equipment and receiver.
  - ◆ Connect the equipment into an outlet on a circuit different from that to which the receiver is needed.
  - ◆ Consult the dealer or an experienced radio/TV technician for help.



This device is intended only for OEM integrators under the following conditions:

- 1) The antenna must be installed such that 20 cm is maintained between the antenna and users. For laptop installations, the antenna must be installed to ensure that the proper spacing is maintained in the event the users places the device in their lap during use (i.e. positioning of antennas must be placed in the upper portion of the LCD panel only to ensure 20 cm will be maintained if the user places the device in their lap for use) and
- 2) The transmitter module may not be co-located with any other transmitter or antenna.

As long as the 2 conditions above are met, further transmitter testing will not be required. However, the OEM integrator is still responsible for testing their end-product for any additional compliance requirements required with this module installed (for example, digital device emissions, PC peripheral requirements, etc.).

**IMPORTANT NOTE:** In the event that these conditions can not be met (for example certain laptop configurations or co-location with another transmitter), then the FCC authorization is no longer considered valid and the FCC ID can not be used on the final product. In these circumstances, the OEM integrator will be responsible for re-evaluating the end product (including the transmitter) and obtaining a separate FCC authorization.

### End Product Labeling

This transmitter module is authorized only for use in devices where the antenna may be installed such that 20 cm

may be maintained between the antenna and users (for example access points, routers, wireless ASDL modems, certain laptop configurations, and similar equipment). The final end product must be labeled in a visible area with

the following: "Contains TX FCC ID: 2ARTOPPMN3U"





Un-license band: This device complies with Part 15 of the FCC Rules.

Operation is subject to the following two conditions:

- (1) this device may not cause harmful interference, and
- (2) this device must accept any interference received, including interference that may cause undesired operation.

# Smarter. Greener. Together.

To learn more about Delta, please visit [www.deltaww.com](http://www.deltaww.com).

