



DF-W5001

Wireless HDMI AV Transmission System

无线高清影音传输系统

Dfine Technology Co.,Ltd 成都九洲迪飞科技有限责任公司

Add(地址): Tianfu Software Park, No.1366, Mid Section Tianfu Avenue, Hi-tech Zone,  
Chengdu, Sichuan, China, 610041(四川省成都市高新区天府大道中段1366号天府软件园E6)  
Tel(电话): +86-28-8532-3511  
Fax(传真): +86-28-8530-6133  
Web(网址): www.dfine-ce.com

User Manual 用户手册



# Table of Contents

1 Important Information .....	1
1.1 Safety Precautions .....	1
1.2 Declaration of Conformity .....	2
1.3 Trademark Information .....	2
1.4 Special Notice .....	2
1.5 Cleaning .....	2
2 Briefing Operation Guide .....	3
2.1 Transmitter Installation Instructions .....	3
2.2 Receiver Installation Instructions .....	4
2.3 Operations .....	5
3 Product`s Overview .....	7
3.1 Product Specifications .....	7
3.2 Product Features .....	8
4 Product`s Function .....	8
4.1 HDMI Transmitter (DF-W5001 TX) Functions .....	8
4.2 HDMI Receiver (DF-W5001 RX) Functions .....	9
4.3 Indicating LED .....	9
4.4 Transmitter Connection .....	10
4.5 Reciver Connection .....	11
4.6 Equipment Pairing .....	11
5 Troubleshooting .....	12
6 Warranty Periods .....	12
7 FCC ID Warning .....	13
8 IC ID Warning .....	14

# 1 Important Information

Please take the time to read this user manual before using the Transmitter and Receiver. It contains important information about operating your Wireless HDMI AV Transmission System.

Our limited warranty applies when the product is handled properly for intended use, in accordance with its operating instruction. However, the warranty may be void in the following case.

- Product, repair modification or alteration have been performed by unauthorized service personnel.
- Damages caused by accidents, including but not limited to, lightning, water, fire, or moisture.
- Use non-original manufacturer DC adapter.
- Product model number got altered, removed or made illegible.

## 1.1 Safety Precautions

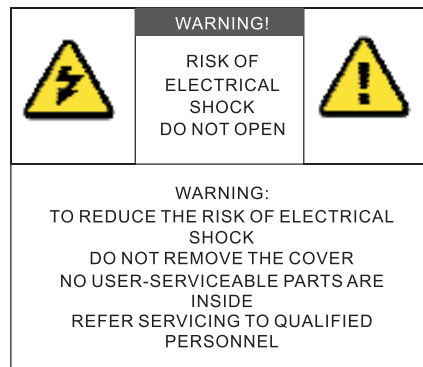

**Danger: Electricity Hazard**

- Power must be switched off when not in use, any power adaptors connected AV devices and TV should be plugged out.
  - Power outlet: To prevent electric shock, make sure to use the appropriate AC adaptors as power supply to the transmitter and the receiver.
  - Power cord: Be sure the power cord is routed so that it will not be stepped on or pinched by heavy items.
  - Power overloading: Avoid overloading electrical outlets or extension cords which otherwise could result in electric shock or fire.
  - Lightning: Disconnect the product from the power source if it is left unattended for a long period of time, and to protect the product from lightning.
  - Please switch off the power when you are not using your Wireless HDMI AV Transmission System.
- This reduces the risk of electric shocks or fire.



**Warning**

- Keep the product away from objects with liquids and splashing or dripping on this product is strictly prohibited.
- Put the product in a well-ventilated space and keep it away from direct sunlight or any source of heat.
- Do not expose the product to rain or moisture, otherwise electric shock or fire could happen.

## 1.2 Declaration of Conformity

This product complies with Part 15C and Part 15E of FCC Rules.  
Part 15: Subpart C—Radiated Emission Limits, Additional Provisions.  
Part 15: Subpart E—Unlicensed National Information Infrastructure Devices.  
This device complies with relative criteria CE Certification.  
EN 60950-1:2006  
Information Technology  
Equipment ---Safety---  
Part 1: General Requirements  
EN 300440-01(V1.6.1)  
Electromagnetic Compatibility and Radio Spectrum Matters (ERM)  
Short Range Devices.  
Radio equipment to be used in the 1GHz to 40 GHz frequency range.  
Part 1: Technical Characteristics and Test Methods  
EN 301489-03(V1.4.1)  
Electromagnetic Compatibility and Radio Spectrum Matters (ERM)  
Standard for Radio Equipment and Services.  
Part 3: Specific conditions for Short-Range Device (SRD)  
Operating on frequency between 9 KHz and 40 GHz.  
EN 301489-17(V2.1.1)  
Electromagnetic Compatibility and Radio Spectrum Matters (ERM)  
Standard for Radio Equipment and Services.  
Part 17: Specific conditions for Broadband Data Transmission Systems  
EN 301893(V1.5.1)  
Broadband Radio Access Network (BRAN)  
5 GHz high performance RLAN  
Harmonized EN covering the essential requirements of article 3.2 of the  
R&TTE Directive.

## 1.3 Trademark Information

HDMI, HDMI Logo and High Definition Multimedia Interface are registered trademarks of HDMI Licensing LLC in America and other countries.

## 1.4 Special Notice

Never use this product nearby an aircraft or medical facility. It can cause interference or undesirable effect on the operation result.

Please place this device carefully otherwise radio waves may cause the abnormal video and audio (noise, blocked image, etc).

- 1) Keep it away from refrigerator or other metal furniture, and also inflammable and explosive materials.
  - 2) Put it on a flat surface steadily.
  - 3) Confirm the joint of the connecting line will not cause other danger or inconvenience.
- This product is with DC power supply. Please make sure that the replacing power adapter with identification of 5V/3A to avoid irreparable fault.
  - For energy saving, please turn off the power switch or unplug the power adapter when the units are not in use.
  - This product has been manufactured and tested to comply with each country's safety regulations. However, it doesn't guarantee that interference would never happen in some specific environment. If interference does occur, please take away the interfering objects from transmitter and receiver.

## 1.5 Cleaning

Unplug power adaptor before performing any cleaning. To clean the device, wipe with a soft dry cloth or with a cloth moistened with alcohol.

## 2 Briefing Operation Guide

### 2.1 Transmitter Installation Instructions

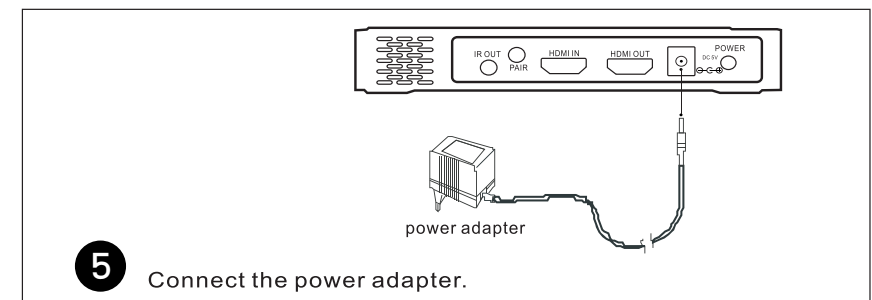
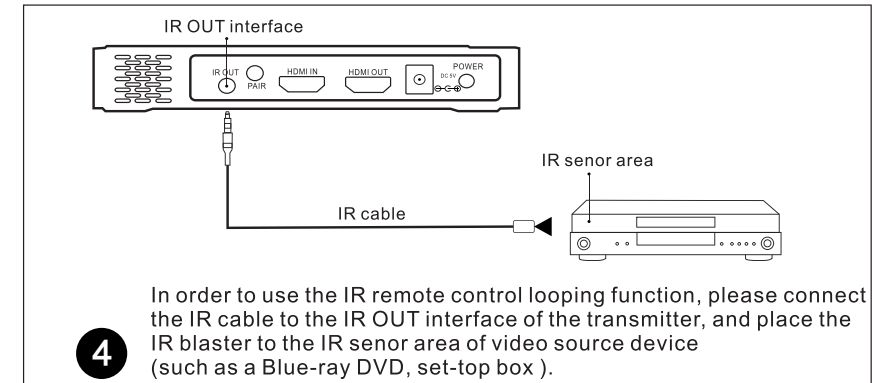
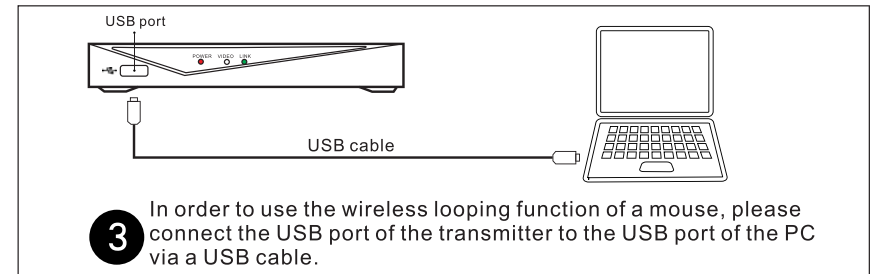
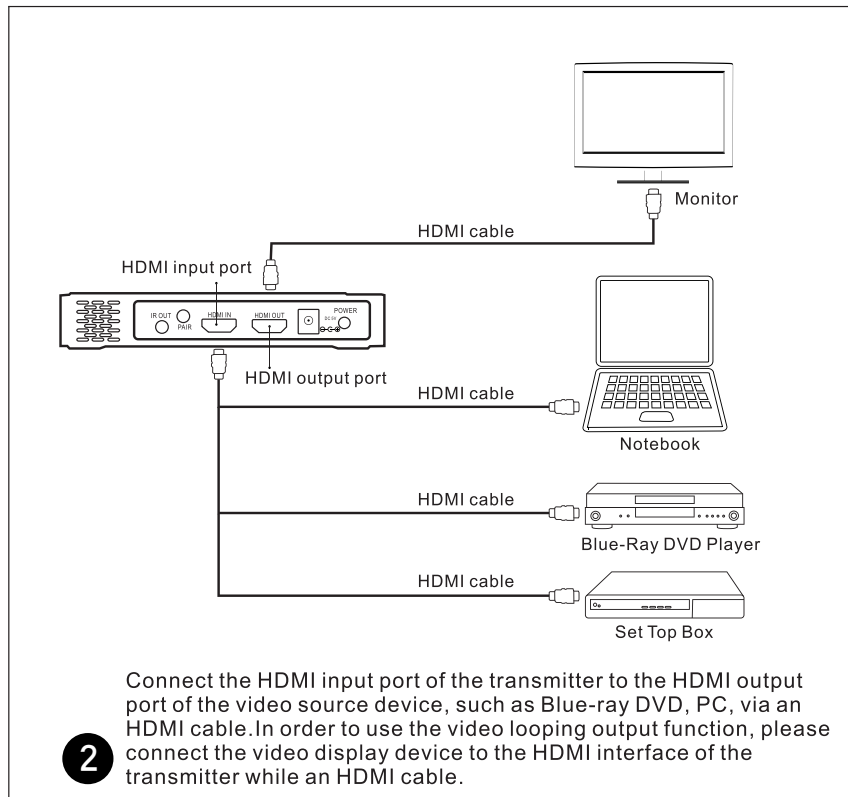
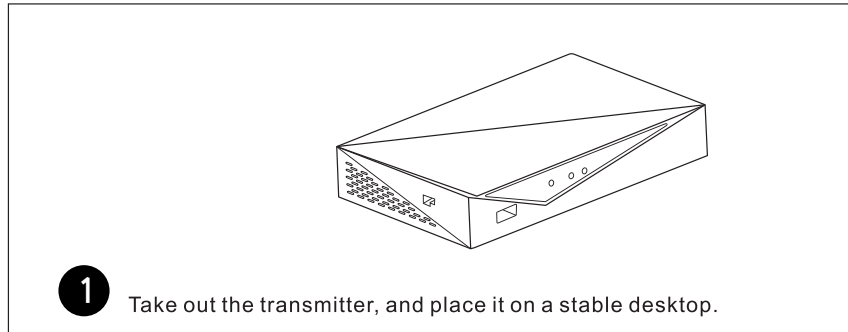

### 2.2 Receiver Installation Instructions

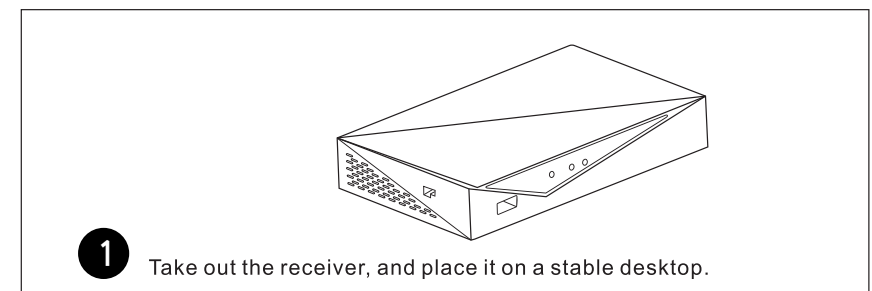

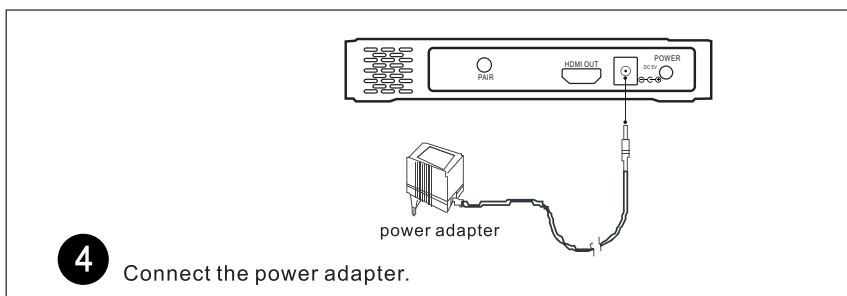
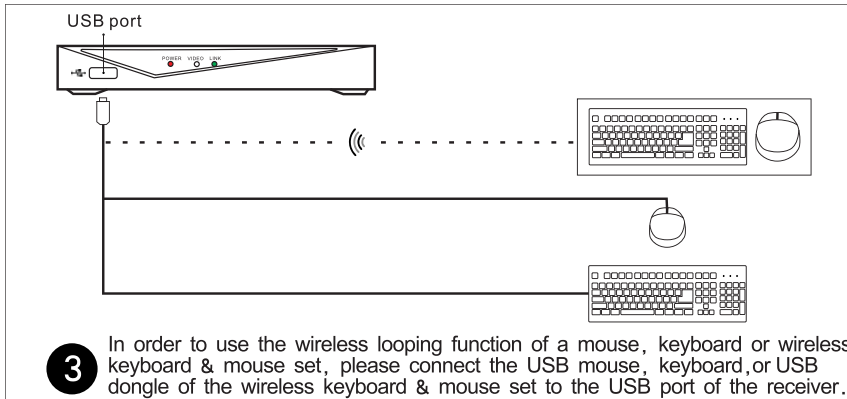
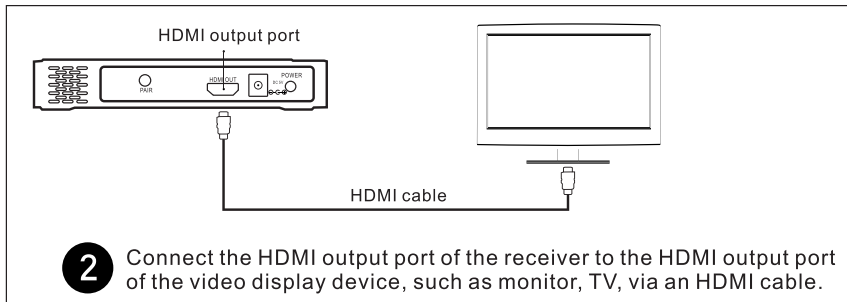

## 2.3 Operations

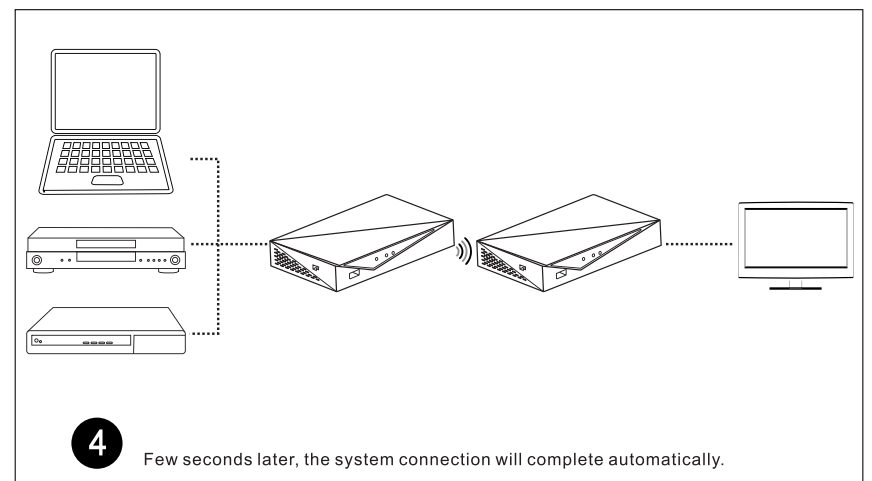
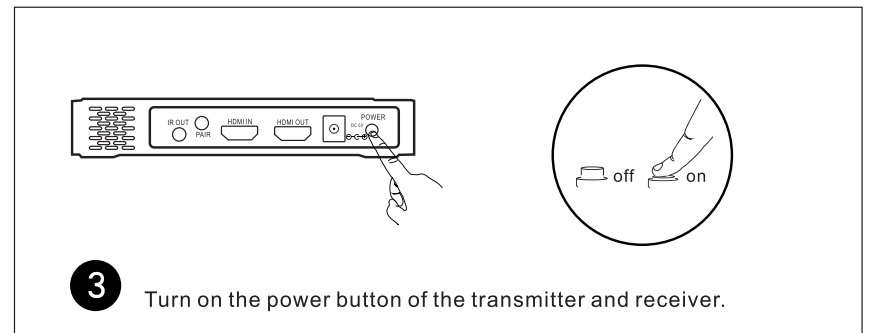
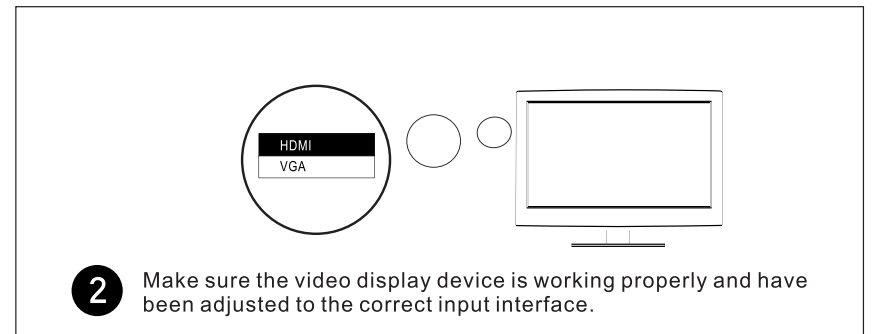
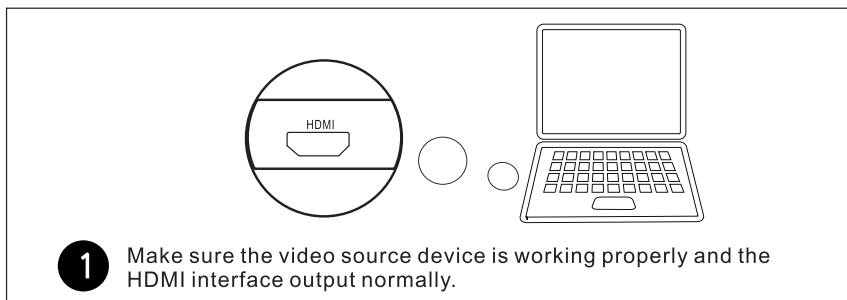

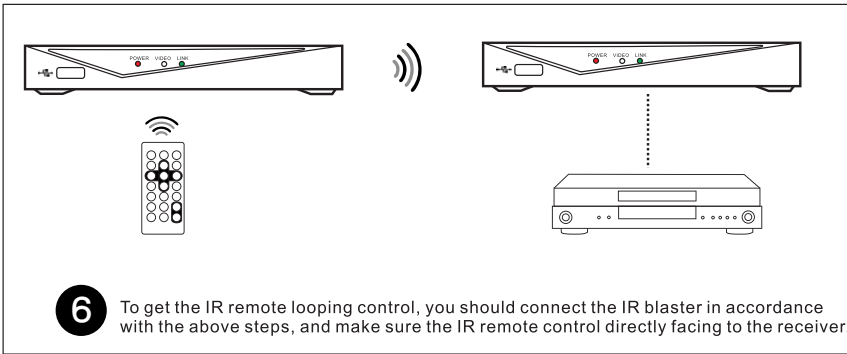
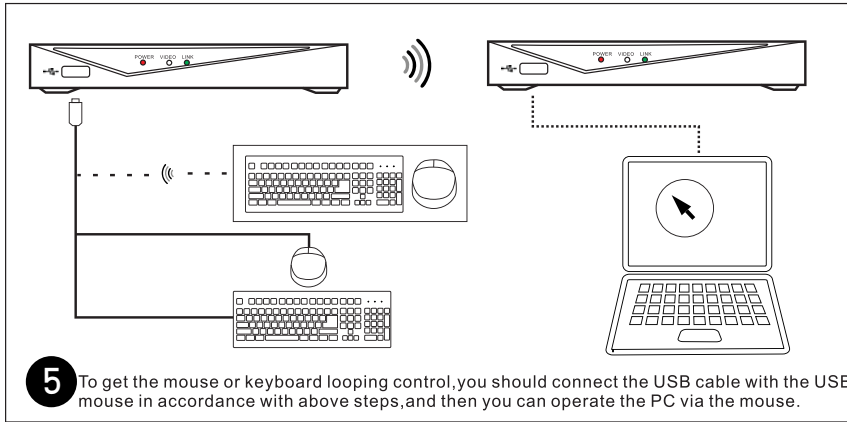

### 3 Overview

#### 3.1 Technical Specifications

Model	DF-W5001	
Working Frequency	5150 -- 5250MHz	5725 -- 5825MHz
Supported PC Resolution	1920 × 1080@60Hz, 1600 × 1200@60Hz, 1440 × 900@60Hz, 1360 × 768@60Hz, 1280 × 1024@60Hz, 1280 × 960@60Hz, 1280 × 800@60Hz, 1280 × 720@60Hz, 1024 × 768@60Hz, 800 × 600@60Hz	
Supported TV Resolution	1080p@60/50/30/25Hz, 1080i@30/25Hz, 720p@60/50Hz, 576i@50Hz	
HDMI Interface	Support HDMI 1.4 video/audio format and encrypted video format HDCP 1.4	
Transmission Distance	200ft(60m) line of sight	

Antenna	Omni bearing built-in antenna
Working Temperature	0°C-40°C
Certificates	FCC, CE, RoHS
Dimension	146 (L) * 93 (W) * 25 (H) mm
Power	100~ 240V AC input, 5V 2A DC output power adaptor

#### 3.2 Packing Contents

Please check whether the following contents are present in the package box. If any item is missed or damaged, please contact the distributor.

- 1 x Wireless Transmitter
- 1 x Wireless Receiver
- 1 x USB Cable
- 1 x IR Cable (Transmitter)
- 2 x DC Power Adaptor
- 1 x User Manual

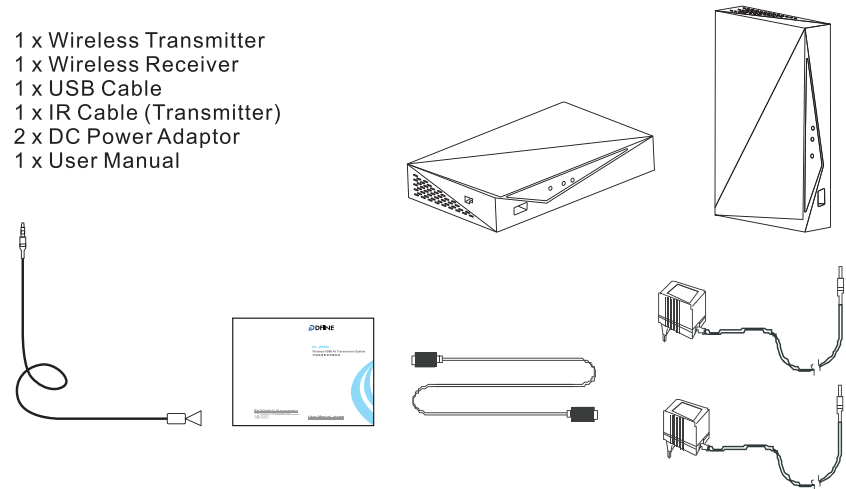

### 4 Function

#### 4.1 Wireless HDMI AV Transmission System DF-W5001 Function

1) LED front panel indication

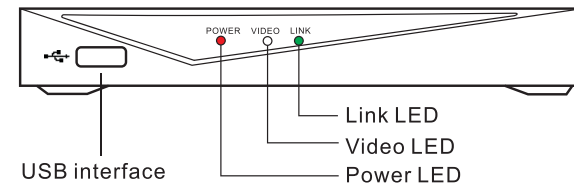

- Power LED: to indicate power status of the device.
- Video LED: to indicate video input status.
- Link LED: to indicate device connection status.
- USB interface: to connect PC or other source equipments.

## 2) Rear interface indication

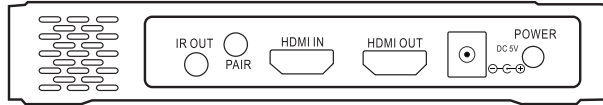

- Power button: to turn on/turn off device.
- Power interface: to connect power adaptor.
- Infrared expansion output slot: to connect the infrared emitter head.
- HDMI input interface: to connect HD playback device.
- HDMI loopback output interface: for local loop out, to connect a display device.
- Pairing button: used for device pairing.

## 4.2 Wireless HD Receiver Instructions

### 1) LED front panel indication

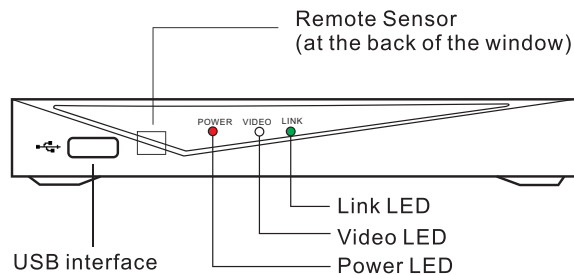

- Power LED: to indicate power status of the device.
- Video LED: to indicate video input status.
- Link LED: to indicate device connection status.
- USB interface: to connect USB mouse, keyboard or gamepad.
- Remote control sensor area: remote control sensor infrared area, please do not cover this area.

### 2) Rear interface indication

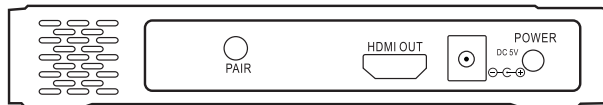

- Power button: to turn on/turn off device.
- Power input interface: to connect power adaptor.
- HDMI interface: to connect display device.
- Pairing button: used for device pairing.

## 4.3 Status Description



## Indicating LED status description

	Brighting	Off	Flashing
Power LED	Power on	Power off	
Video LED	Video input	No video input	
Link LED	Connected	Not connected	Pairing

## 4.4 Transmitter Connection

### 1) Applications on Blue-ray DVD, multi-media player, set top box

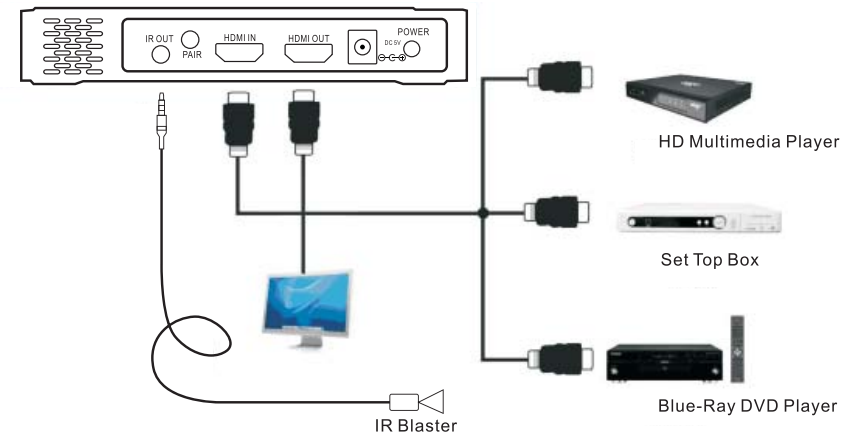

- Connect DF-W5001 with HDMI cable to source equipment, such as Blue Ray DVD, multi-media player, set top box and make sure they are correctly connected.
- Plug IR blaster to DF-W5001 transmitter, and make the transmitter connected with IR sensor of Blue-ray DVD, multi-media player, set top box and PS3.
- Connect display device with HDMI OUT interface, then the local videos come out.

### 2) Application on PC mainframe, game platform.

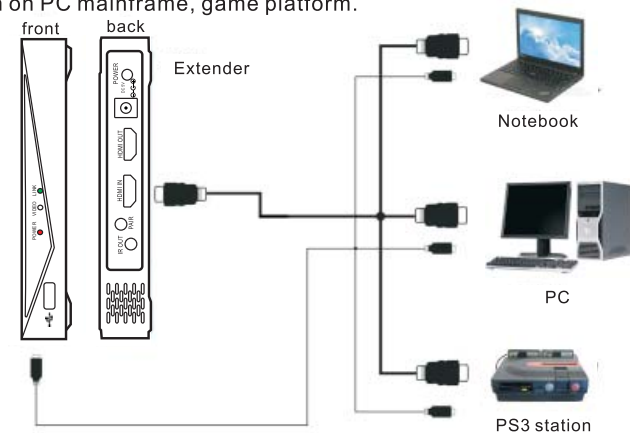

- Connect DF-W5001 transmitter with HDMI cable to devices, like notebook, mini-computer mainframe, game platform and make sure they are perfectly connected.
- Connect DF-W5001 transmitter and devices, like Blue-ray DVD, multi-media player, set top box with USB cable.

## 4.5 Receiver Connection

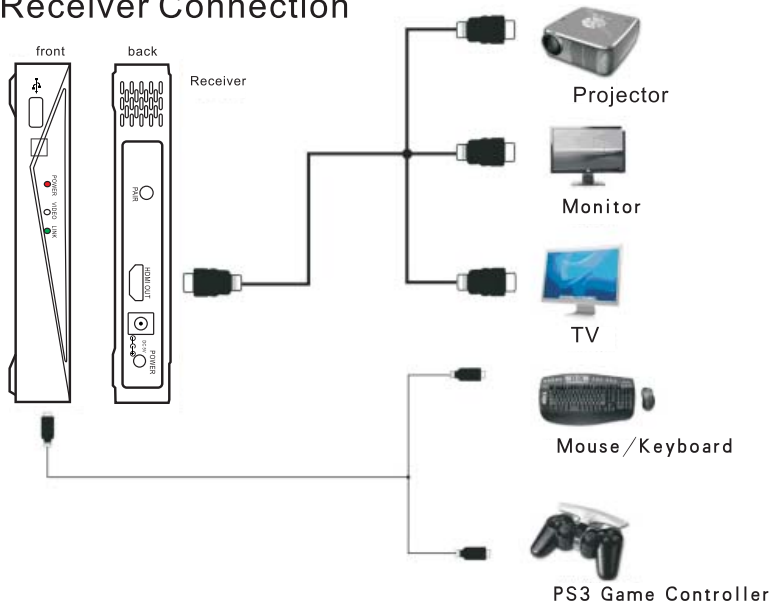

- Connect DF-W5001 to display equipment, TV, Projector, with HDMI cable and make sure it is correctly connected.
- Connect DF-W5001 to USB mouse, keyboard, and game controller and make sure it is correctly connected.

## 4.6 Equipment Pairing

- Connect DF-W5001 Transmitter to the source device, connect Receiver to the display equipment, turn on power.
- Press "PAIR" button of receiver, and Link LED flashes.

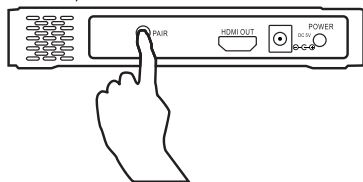

- Then press "PAIR" button of transmitter, and Link LED flashes.

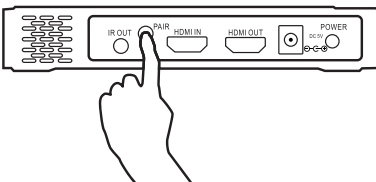

- The pairing will be completed within 2 minutes when the Link LED keeps on (depending on distance and surrounded environment)
- After the success of the matching, automatic connect ,and begin to transmitting AV signal.

## 5 Troubleshooting

Please make sure all the devices are properly connected and receiver is not in standby mode before you follow the troubleshooting guide below.

No video	<ol style="list-style-type: none"> <li>1. Check the status of LED, and check if the HD media player works normally.</li> <li>2. Check if the joints and wires are damaged and make sure they are correctly connected to corresponding interface.</li> <li>3. Ensure there is video on output devices.</li> <li>4. Check if the receiver is correctly connected to display equipment.</li> <li>5. Make sure all devices are working on supported distance. Put them closer and try it again.</li> </ol>
Power LED off	<ol style="list-style-type: none"> <li>1. Make sure the power adaptor is correctly connected and the voltage is 5V2A.</li> <li>2. Make sure the power supply would not be interrupted.</li> </ol>
Poor picture	<ol style="list-style-type: none"> <li>1. Check if the receiver is correctly connected to display equipment and there is no damage on joints and wires.</li> <li>2. Make sure all devices are working on supported distance. Move them closer and try it again.</li> </ol>
No sound or bad sound	<ol style="list-style-type: none"> <li>1. Make sure the source equipment output support audio format.</li> <li>2. Restart the transmitter and connect it again.</li> <li>3. Make sure there is no disturbance from the same frequency within 50 cm.</li> </ol>
Pairing failure	Ensure the distance between transmitter and receiver doesn't exceed supported distance. If it does, put them closer and try it again. Check if source device has been added on display equipment. If it has, delete it and pair again.
Connection failure	<ol style="list-style-type: none"> <li>1. Ensure the working distance doesn't exceed supported distance. If it does, put them closer and try it again.</li> <li>2. Ensure the transmitter and receiver have been paired.</li> <li>3. Pair the transmitter and receiver again after software update.</li> </ol>
Other issues	If any other issues occur, please restart the device and make connections again.

## 6 Warranty Periods

Transmitter & Receiver: 1 year  
Accessories: 6 months



This warranty shall not apply to:

- A. Any defects caused or repairs required as a result of abusive operation, negligence, accident, improper installation or inappropriate use as outlined in the owner's manual.
- B. Any Dfine product tampered with, modified, adjusted or repaired by any party other than Dfine or Dfine's Authorized Service Centre.
- C. Damage caused or repairs required as a result of the use with items not specified or approved by Dfine including but not limited to chemical cleaning agents.
- D. Any replacement of accessories, consumable or peripheral items required through normal use of the product including but not limited to AC adapters, cables, infrared connector.
- E. Any cosmetic damage to the surface or exterior that has been defaced or caused by normal wear and tear.
- F. Any damage caused by external or environmental conditions, including but not limited to transmission line/power line voltage or liquid spillage.
- G. Any product received without appropriate model, serial number.
- H. Any products used for rental or commercial purposes
- I. Any installation, setup and/or programming charges.

When returning the product, please return the product in its original packaging or in packaging that provides an equivalent degree of protection for the product. Please place your proof of purchase, such as a store receipt, inside the packaging. Return requests that do not contain a proof of purchase will not be processed. The serial number of the product must be shown clearly on surface of the package. Removal or alteration of the factory-supplied serial number invalidates this warranty. Customer will be responsible for the costs associated with the delivery for product repairing.

For more information, please visit [http://www.dfine-ce.com/?retuns\\_claim.html](http://www.dfine-ce.com/?retuns_claim.html)

Contact Us:

Dfine Technology Co.,Ltd  
support@dfine-ce.com  
www.dfine-ce.com

E6-1 Tianfu Software Park, Hi-tech Zone, Chengdu, China, 610041

## 7 FCC ID Warning

This device complies with Part 15 of the FCC Rules. Operation is subject to the following two conditions: (1) this device may not cause harmful interference, and (2) this device must accept any interference received, including interference that may cause undesired operation.

The user manual or instruction manual for an intentional or unintentional radiator shall caution the user that changes or modifications not expressly approved by the party responsible for compliance could void the user's authority to operate the equipment. In cases where the manual is provided only in a form other than paper, such as on a computer disk or over the Internet, the information required by this section may be included in the manual in that alternative form, provided the user can reasonably be expected to have the capability to access information in that form.

For a Class B digital device or peripheral, the instructions furnished the user shall include the following or similar statement, placed in a prominent location in the text of the manual:

NOTE: This equipment has been tested and found to comply with the limits for a Class B digital device, pursuant to Part 15 of the FCC Rules. These limits are designed to provide reasonable protection against harmful interference in a residential installation. This equipment generates uses and can radiate radio frequency energy and, if not installed and used in accordance with the instructions, may cause harmful interference to radio communications. However, there is no guarantee that interference will not occur in a particular installation. If this equipment does cause harmful interference to radio or television reception, which can be determined by turning the equipment off and on, the user is encouraged to try to correct the interference by one or more of the following measures:

- Reorient or relocate the receiving antenna.
- Increase the separation between the equipment and receiver.
- Connect the equipment into an outlet on a circuit different from that to which the receiver is connected.
- Consult the dealer or an experienced radio/TV technician for help.

## 8 IC ID Warning

Disclaimer:

Operation is subject to the following two conditions: (1) this device may not cause interference, and (2) this device must accept any interference, including interference that may cause undesired.

This equipment complies with FCC radiation exposure limits set forth for an uncontrolled environment. This equipment should be installed and operated with minimum distance 20cm between the radiator & your body.

Operations in the 5.15-5.25GHz band are restricted to indoor usage only.