

1101 Universal Transmitter

Description

The 1101 Universal Transmitter can be used with any magnetic contact or sensor and includes a case tamper. The transmitter printed circuit board (PCB) has two built-in magnetic reed switches. A separate magnet and housing mount up to 1/2" from the transmitter reed switch locations. The transmitter mounting bracket makes installation quick and easy.

Installing the Transmitter

Note: Prior to snapping the transmitter base onto the installed mounting bracket, record the serial number located on the back of the transmitter base. This number is required during programming.

FCC Note: The antenna(s) used for this transmitter must be installed to provide a separation distance of at least 20 cm from all persons. It must not be co-located or operated in conjunction with any other antenna or transmitter.

Snap the transmitter base off of the mounting bracket. Secure the mounting bracket to the wall using the supplied screws. Make sure the reed switch location markers are closest to the area where you plan to mount and install the magnet housing. Line the magnetic reed switch corner with the mounting bracket corner where the location marker information is printed. Snap the transmitter base onto the mounting bracket. Refer to Figure 1.

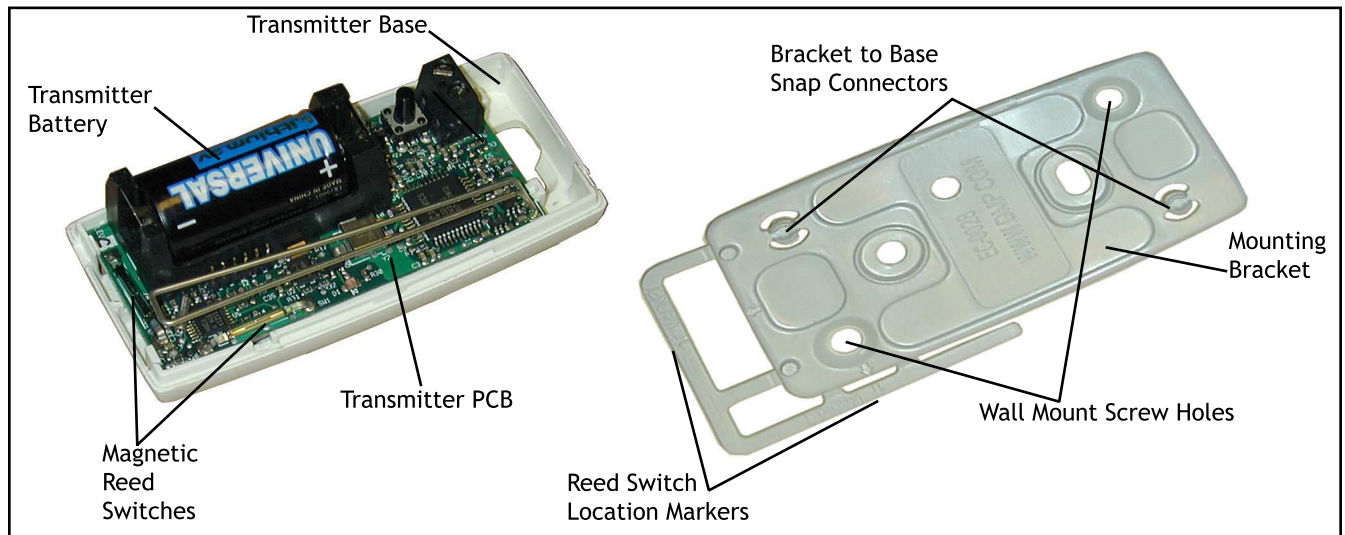

Figure 1: Transmitter PCB in case and mounting bracket

Place the magnet housing base on top of the mounting base. Line the holes up and secure the two brackets not more than 1/2" away from one of the transmitter reed switches. Place the magnet into the housing and snap the housing onto the housing base. Figure 2 identifies the magnet assembly.

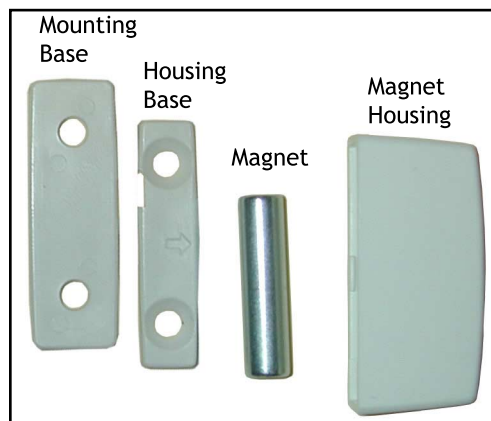

Figure 2: Magnet, mounting brackets and housing

Installing the Battery

Depress the latch on the transmitter housing cover to remove. Place the 3.0V, 1.4 Ah Lithium battery in the holder as shown in Figure 3. Observe polarity when installing the battery. Snap the cover back into place.

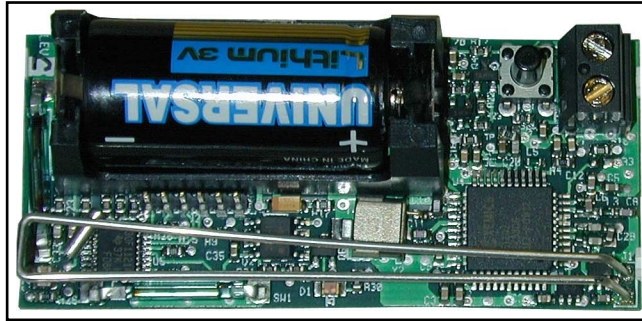

Figure 3: Transmitter PCB and battery location

Programming the Transmitter in the Panel

Program the 1101 Transmitter as a zone in **Zone Information** during panel programming. At the Serial Number: prompt, enter the serial number recorded from the transmitter base. Continue to program the zone as directed in the panel Programming Guide.

FCC Information

This device complies with Part 15 of the FCC Rules. Operation is subject to the following two conditions:

- (1) This device may not cause harmful interference, and
- (2) this device must accept any interference received, including interference that may cause undesired operation.

Changes or modifications made by the user and not expressly approved by the party responsible for compliance could void the user's authority to operate the equipment.

NOTE: This equipment has been tested and found to comply with the limits for a Class B digital device, pursuant to part 15 of the FCC Rules. These limits are designed to provide reasonable protection against harmful interference in a residential installation. This equipment generates, uses and can radiate radio frequency energy and, if not installed and used in accordance with the instructions, may cause harmful interference to radio communications. However, there is no guarantee that interference will not occur in a particular installation. If this equipment does cause harmful interference to radio or television reception, which can be determined by turning the equipment off and on, the user is encouraged to try to correct the interference by one or more of the following measures:

- Reorient or relocate the receiving antenna.
- Increase the separation between the equipment and receiver.
- Connect the equipment into an outlet on a circuit different from that to which the receiver is connected.
- Consult the dealer or an experienced radio/TV technician for help.