



Chloe

ROCKING BASSINET "WHITE"

#036106-003



**IMPORTANT:
RETAIN FOR FUTURE REFERENCE,
READ CAREFULLY**

Read all instructions before assembly and use of the bassinet. Keep instructions for future use.

⚠ WARNING ⚠

FAILURE TO FOLLOW THESE WARNINGS AND INSTRUCTIONS COULD RESULT IN SERIOUS INJURY OR DEATH.

FALL HAZARD - TO PREVENT FALLS; DO NOT USE THIS PRODUCT WHEN INFANT BEGINS TO PUSH UP ON HANDS AND KNEES OR HAS REACHED THE MANUFACTURER'S RECOMMENDED MAXIMUM WEIGHT OF 8KGS, WHICHEVER COMES FIRST.

SUFFOCATION HAZARD - INFANTS HAVE SUFFOCATED; IN GAPS BETWEEN AN EXTRA PAD AND THE SIDE OF THE BASSINET/CRADLE, AND ON SOFT BEDDING.

USE ONLY THE PAD PROVIDED BY MANUFACTURER.

NEVER ADD A PILLOW, COMFORTER, OR ANOTHER MATTRESS FOR PADDING.

CAUTION: RECOMMENDED MATTRESS (SUPPLIED) SIZE IS 385MM WIDE X 765MM LONG X 22MM IN THICKNESS MAXIMUM SIZE. IT IS RECOMMENDED THAT THE MATTRESS USED IN THIS ROCKING BASSINET BE A SNUG FIT AND NOT EXCESS 38MM IN THICKNESS.

This product is intended for use for babies aged between **0 and 6 months**, weighing up to a **maximum of 8kgs**.

IMPORTANT! Before assembly or each use, inspect this product for damaged hardware, loose joints, missing parts or sharp edges.

When a child is able to sit, kneel or pull itself up, the product should not be used anymore for this child.

DO NOT leave any object inside the product that could reduce its depth.

Be aware of the risk of open fires and other sources of strong heat, such as electric bar fires, gas fires etc.

Follow the manufacturer's assembly instructions in detail to ensure the safety features of the bassinet/ cradle are not compromised. Failure to follow these warnings and instructions could result in serious injury or death.

It is recommended that the mattress used in this rocking bassinet be a snug fit and not exceed 38mm in thickness.

DO NOT use if any parts are missing or broken. Contact manufacturer for replacement parts and instructions if needed. Never substitute parts.

This is to minimise the risk of a child's limb becoming caught in the gap.

- Read all instructions before assembly and use of the bassinet.
- Keep instructions for future use.
- Adult assembly is required.
- Tools required for assembly: (not included) Phillips Head Screwdriver and Wrench.
- Product features and styling may vary from photography.

SUFFOCATION HAZARD: Discard all packing materials immediately after opening. Plastic bags and ties may cause suffocation or choking. For safety reasons ensure that after assembly is complete, that all tools, excess parts including plastic packaging is removed from the bassinet vicinity to prevent from being accessed by children.

FALL HAZARD: To help prevent falls, do not use this product when infant begins to push up on hands and knees or has reached manufacturer's recommended maximum weight of 8kgs, whichever comes first.

If sheet is used with the pad, use only the one provided by the bassinet manufacturer or one specifically designed to fit the bassinet.

To reduce the risk of Sudden Infant Death Syndrome (SIDS), paediatricians recommend healthy infants be placed on their backs to sleep, unless otherwise advised by your physician.

Use bassinet with only one child at a time.

Always attach all provided fasteners (strings, straps, clamps etc) tightly to the bassinet according to the instructions. Check frequently.

Strings can cause strangulation! Do not place items with a string around a child's neck, such as hood strings or pacifier cords. Do not suspend strings over a bassinet or attach strings to toys.

DO NOT use the body of a bassinet/criadle without its frame.

Be aware of the risk of open fires and other sources of strong heat, such as electric bar fires, gas fires, etc. in the near vicinity of the crib/criadle.

DO NOT leave child unattended in the bassinet. Always make sure the wheels or stands are in the locked down position.

NEVER place bassinet near a window where cords from curtains can strangle a child.

Remove any tools or excess parts including plastic packaging from the bassinet vicinity after its assembly.

Discontinue use of the bassinet before the infant can sit up by themselves.

Padding and cushioning materials, including the mattress are to be sufficiently firm to preclude conforming to the contours of the infants face.

Ensure proper ventilation is maintained in and around the bassinet by limiting bed clothes, extra pillows or toys.

Ribbons or lace associated with the bedding may entangle the infant.

Promptly replace worn out or broken parts.

Young children should not be allowed to play unsupervised in the vicinity of the bassinet/ cradle.

Congratulations on your purchase of the **Chloe Rocking Bassinet**.

This product has been designed and developed with safety, comfort and functionality in mind. Please take the time to read this manual carefully before using this product and keep it in a safe place for future reference.

Contents

Assembly contents list

Assembly / Operating instructions

How to care for your **Chloe Rocking Bassinet**



Due to variations in the style and design of our products, the photographs and illustrations shown in this instruction manual are generic, therefore product fabrics, colour and design may vary from images shown. CNP Brands reserves the right to alter product specifications without notice as a result of our ongoing policy of product improvement.

Check what you have received...

You have received **1 box**. Please check the contents of the box against the list below. If anything is missing, please contact Customer Service.

In Australia, contact **CNP Brands on 1300 667 137**, in New Zealand contact **Wainhouse Distribution on 0800 567 5000**.

Supplied loose in box:

Top frame (do not remove foam)

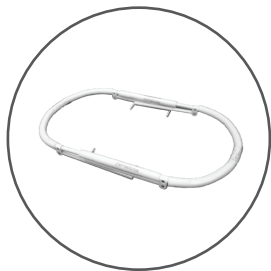

x 1

Mattress pad (with fitted sheet)

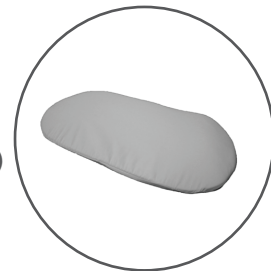

x 1

Leg frames
'A' x 2
'B' x 2

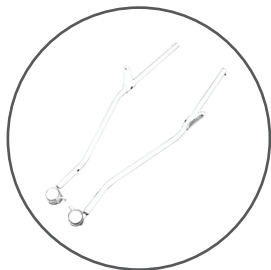

x 4

Bassinet liner



x 1

Basket crossbar

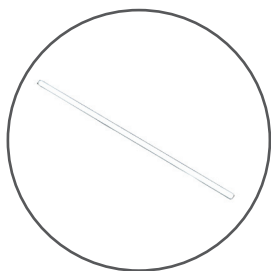

x 2

Basket



x 1

Mattress support board (with battery compartment)



x 1

Canopy



x 1

Supplied loose in box (continued):

Base with wheels



x 2

8mm screw

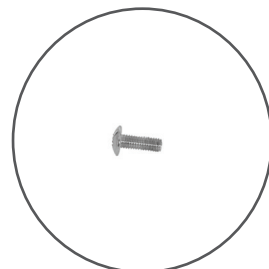

x 8

Mobile arm



x 1

33mm screw

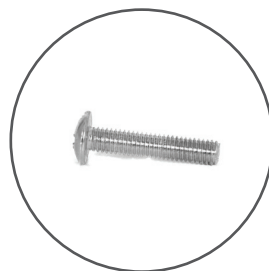

x 4

Mobile with toys



x 1

28mm screw
(pre-assembled
on mobile arm)

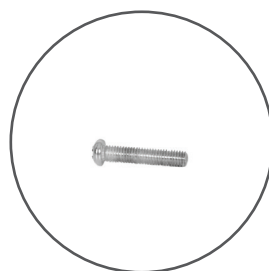

x 2

There are no accessories recommended for use with this Childcare Chloe Rocking Bassinet.

To install Battery...

1

- 1a. Locate the battery compartment on the underside of the mattress support board.
- 1b. Loosen the screws in the battery compartment cover with a Phillips head screwdriver.
- 1c. Lift and remove.

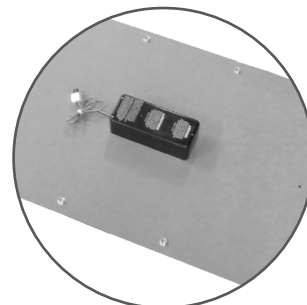

2

- 2a. Insert three "C" (LR14) alkaline batteries (not supplied) into the battery compartment.
- 2b. Replace the battery compartment cover and tighten the screws.

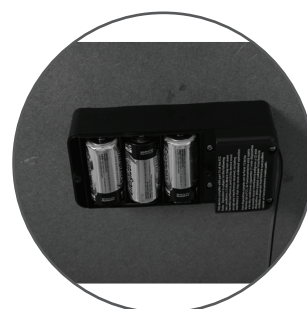

HINT: We recommend using alkaline batteries for longer battery life.

⚠ WARNING ⚠

In exceptional circumstances, batteries leak fluids that can cause a chemical burn injury or ruin your product. To avoid leakage:

DO NOT mix old and new batteries or batteries of different types: alkaline, standard (carbon zinc) or rechargeable (nickel-cadmium).

Insert batteries as indicated inside the battery compartment.

Remove batteries during long periods of non-use.

ALWAYS remove exhausted batteries from the product. Dispose of batteries safely. **DO NOT** dispose of this product in a fire. The batteries inside may explode or leak.

NEVER short-circuit the battery terminals.

Use **ONLY** batteries of the same equivalent type, as recommended.

DO NOT charge non-rechargeable batteries.

Remove rechargeable batteries from the product before charging.

If removable, rechargeable batteries are used, they are only to be charged under adult supervision.

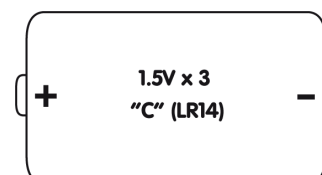

To insert Leg Frames...

1

- 1a. Insert one leg marked 'A' into one of the joint on the top frame marked 'A'.
- 1b. Push the pop pin in whilst inserting leg into joint, ensuring the pop pin clicks into position.

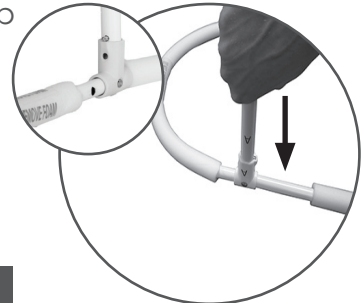

PLEASE NOTE: The assembly of this bassinet may require two people.

2

- 2a. Repeat for remaining three legs, ensuring the correct leg is placed in the correct position according to the corresponding letters.
- 2b. Ensure the plastic supports are facing inward, as shown in image.



To attach Base Frame...

1

- 1a. Turn the frame onto it's feet and place the mattress board into position.
- 1b. Ensure the battery box is facing downwards.



2

- 2a. Secure the mattress support board to the frame using the 8mm screw with a Phillips head screwdriver (not supplied).

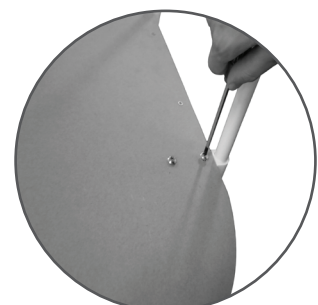

PLEASE NOTE: Do not tighten bolts completely

To assemble Bassinet Frame & Basket...

1

- 1a. Slide the basket loops over all four legs.
- 1b. Ensure to pull basket down far enough as not to obstruct cross bar holes.



2

- 2a. Slide cross bar through basket side openings.
- 2b. Attach basket cross bar using the 33mm screws.
- 2c. Repeat for other side.



PLEASE NOTE: Tighten all bolts now including mattress base

To attach Wheels...

1

- 1a. Turn the unit upside down and line up the base with wheels with the leg frame tubes.
- 1b. Push in pop pins while pushing down on the base with wheels until it clicks into place.
- 1c. Repeat for the other side.



To assemble Bassinet Liner...

1

- 1a. Turn the frame back onto it's feet.
- 1b. Place the bassinet liner into position.
- 1c. Ensure the mobile arm slot is lined up with the attachment holes as shown in the image.



2

- 2a. Stretch the elastic pockets in the bottom of the bassinet liner over the ends of the support board as shown.

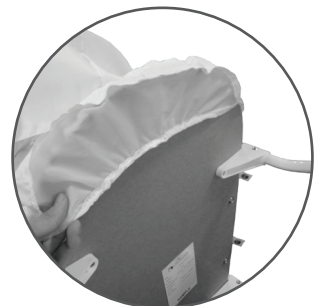

3

- 3a. Attach the press studs on the bottom of the bassinet liner to the corresponding press studs located on the underside of the support board as shown.
- 3b. There are a total of four press studs.
- 3c. Ensure the press studs are secure.

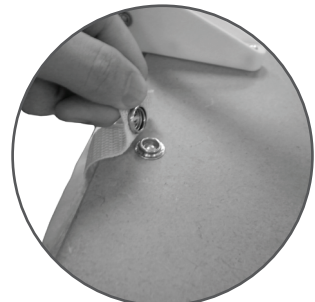

4

- 4a. Attach the press studs on the tabs of the bassinet liner to the press studs on the outside of the bassinet liner as shown.
- 4b. There are a total of eight press studs.
- 4c. Ensure the press studs are secure.



To insert Mattress Pad...

1

- 1a. Place mattress pad into bassinet.



To attach Canopy...

1

- 1a. Position the canopy over the top end of the bassinet with the warning label.
- 1b. Push the canopy ratchets onto the frame on both sides of the bassinet.

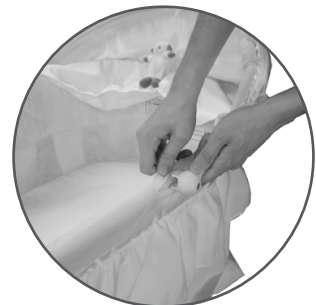

2

- 2a. Attach the Velcro on each canopy flap to the side of the bassinet liner.



3

- 3a. Attach the Velcro strips on the rear of the canopy liner edge to the Velcro strips on the rear outer edge of bassinet top rail liner.



To attach Mobile Arm...

1

- 1a. Remove the two pre-assembled 28mm screws from the mobile arm.
- 1b. Open the slot in the bassinet liner and position the mobile arm on the frame.
- 1c. Ensure there is no foam restricting the frame.



2

- 2a. Position the mobile arm on the frame ensuring the holes on the mobile arm line up with the holes in the frame.



3

- 3a. Re-insert two 5mm (28mm diameter) screws into the holes and tighten with a Phillips head screwdriver.

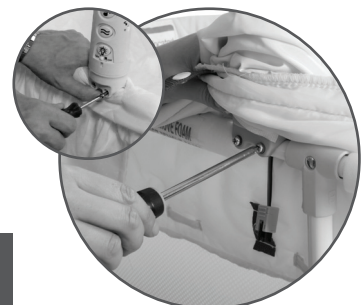

PLEASE NOTE! Ensure the mobile wire with connector is on the inside of the frame.

4

- 4a. Thread the battery wire with connector under the frame and up through the bottom two fabric loops.
- 4b. Push the mobile wire connector into the battery wire connector.

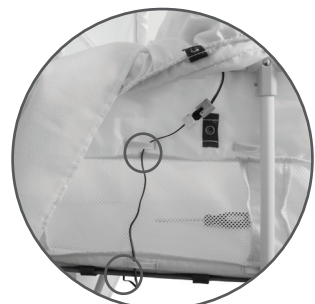

5

- 5a. Fit the mobile to the mobile arm by pushing it up firmly.



PLEASE NOTE! Always ensure the mobile is securely attached to the bassinet prior to each use.

To attach Mobile Arm (continued)...

⚠ WARNING ⚠

Failure to follow these warnings and the instructions could result in serious injury or death. The mobile is intended for visual stimulation and is not intended to be grasped by child. Remove mobile when baby begins to push up on hands and knees to prevent possible injury by entanglement.

Always attach all provided fasteners (strings, straps, clamps, etc.) tightly to the bassinet according to the instructions. Check frequently.

DO NOT add additional strings or straps to the mobile assembly.

To operate Mobile...

1

Mobile Function On/Off Switch

- 1a. Slide the Mobile Functions On/Off button at the base of the mobile arm to turn on power.
- 1b. This is the main power switch to the mobile arm and also turns on the power LED on the Night Light button.
- 1c. The LED will stay on in the dark.



2

Rotate Mobile Toys Button

- 2a. Press to begin a 5 minute cycle of rotation.
- 2b. Press again to stop the mobile.
- 2c. Press again to start a new 5 minute cycle. If this button is pressed while mobile is operating, the rotation cycle will restart.



3

Twinkling Lights Button

- 3a. Press to start a 5 minute light show.
- 3b. Press again to stop the light show.



To operate Mobile (continued)...

4

Music Button

- 4a. Press to start a 5 minute cycle of music.
- 4b. Press again to stop the music.



5

Music Volume Switch

- 5a. Push toward + for high volume.
- 5b. Push toward - for low volume.



6

Vibrations Button

- 6a. Press to start vibrations.
- 6b. Press to stop vibrations.



7

Vibration Volume Switch

- 7a. Push toward + for high vibration.
- 7b. Push toward - for low vibration.



8

Night Light

- 8a. Press to turn on mobile light for 5 minutes.
- 8b. Press again to turn light off.
- 8c. Press to begin a 5 minute cycle of rotation.



To operate Stationary and Rocking modes...

1

- 1a. To convert bassinet to stationary mode, extract wheel as shown in image.



2

- 2a. Make sure you hear a 'click' to ensure the wheel locks into place.
 2b. Repeat this procedure to lower the other three wheels.
 2c. To engage Rocking mode, reverse the above steps.
 2d. Ensure the wheels are firmly pushed into the base before engaging in rocking mode.



To lock and unlock Wheels...

1

- 1a. To lock wheels, press down firmly on the tab on the wheel as shown in the image.
 1b. Ensure this is repeated with each wheel.



2

- 2a. To unlock wheels, push up on the tab on the wheel as shown in the image.
 2b. Ensure this is repeated with each wheel.

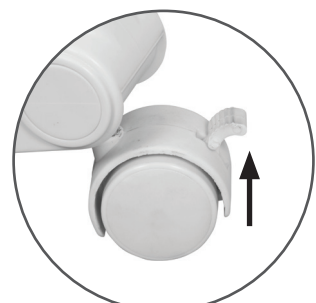



Cleaning

This product has been designed and developed with safety, comfort and functionality in mind. Please take the time to read this manual carefully before using this product and keep it in a safe place for future reference.

To ensure the long-lasting use of your bassinet, dry it with a soft absorbent cloth after use. Use a damp cloth to clean the frame. Do not use abrasive cleaners. Allow it to dry completely before folding or storing it away. Do not dry clean, or use bleach on fabrics or trims. Do not machine wash, tumble or spin dry, unless the care labelling on the product permits these methods. For washing fabric, carefully comply with the instructions indicated on the label.

Maintenance

Always check parts regularly for tightness of screws, nuts and other fasteners – tighten or replace if required. On a regular basis check the condition of the product and the presence of any possible damage. In the case of damage do not use and keep out of reach of children. To maintain the safety of your bassinet, seek prompt repairs for bent, torn, worn or broken parts. Use only those parts and accessories approved by **CNP Brands**.

If you have any difficulties in assembling the bassinet, please contact our Service Department.

In Australia, contact **CNP Brands on 1300 667 137**, in New Zealand contact **Wainhouse Distribution on 0800 567 5000**.



CNP BRANDS

CHILDCARE NURSERY PRODUCTS | EST. 1899

About CNP Brands

Currently, **CNP Brands** boasts one of the most diverse brand portfolios with a combination of company owned brands and distribution agreements. These include distribution lines for **4moms, Brica, Cybex, Evenflo, Good Baby, Lascal, Maclaren, Motorola, Munchkin, OiOi and Summer Infant.**

Our own brands, including **Childcare**, have gone from strength to strength in recent years. **Childcare**, and our premium brand **bebe care**, demonstrate our commitment to quality and continuing investment in product development.

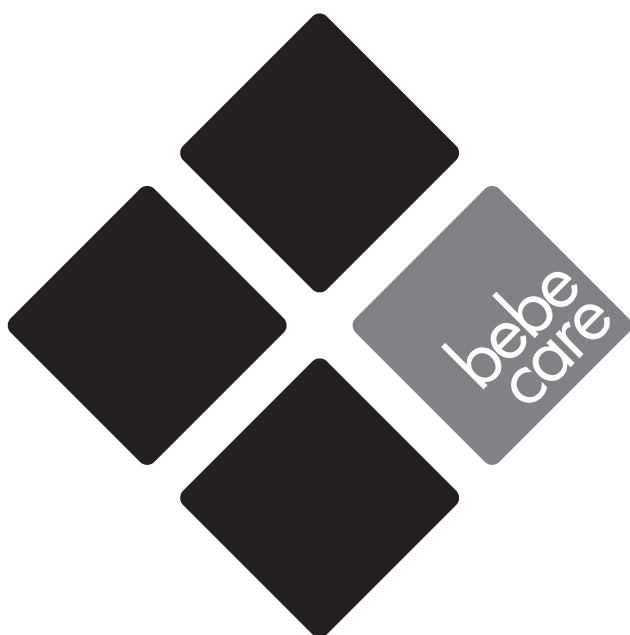



CNP BRANDS

CHILDCARE NURSERY PRODUCTS | EST. 1899

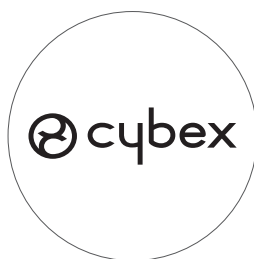

Distributed in Australia by CNP Brands
20 Calarco Drive,
Derrimut, VIC, 3030
Customer Service 1300 667 137

W: www.cnpbrands.com.au
E: info@cnpbrands.com.au
F: www.facebook.com/CNPBrands
I: @cnp_baby

Distributed in New Zealand by Wainhouse
Distribution
2-6 Argyle St, Morningside,
PO Box 41-014,
St Lukes, Auckland, New Zealand
Customer Service: 0800 567 5000

E: helpline@wainhousedist.co.nz

