

EXHIBITOR  
INFORMATION & CONTRACT



**2012 MINNESOTA PETROLEUM  
MARKETERS  
ASSOCIATION**

**89th  
CONVENTION AND TRADE SHOW**

April 9–11, 2012  
Saint Paul RiverCentre  
St. Paul, Minnesota

**MPMA  
3244 RICE STREET  
ST. PAUL, MN 55126  
(651)484-7227/(800)864-3813**

# 2012 Minnesota Petroleum Marketers Association 89th Convention and Trade Show

## Who is MPMA?

Minnesota Petroleum Marketers Association (MPMA) is a trade association consisting of more than 700 regular members and 230 associate members in the state of Minnesota and surrounding states. These members operate more than 1600 locations and many different types of businesses such as convenience stores, restaurants, car washes, tire, battery and accessories in addition to commercial, agricultural and home heating accounts.

## Who Exhibits?

MPMA exhibitors include companies who provide goods and services to the petroleum and convenience store industry. Petroleum equipment, computer software, cash registers, car washes, food and beverage products, and c-store equipment will be at the MPMA's 2012 Convention and Trade Show.

## Who Attends?



The 2011 trade show attracted about 1500 petroleum marketers from Minnesota, North Dakota, Wisconsin and Iowa. This is a majority of the area's oil jobbers and c-store operators who are the owners, operators and managers of independent businesses. The event attracts from branded and unbranded outlets as well as agents and supplying company personnel.



# EXHIBITOR INFORMATION

All booths are 10' x 10' and each contain back and side curtains and an exhibitor name plate.

## BOOTH RATES:

		<u>Member</u>	<u>Non-Member</u>
		\$ 750.00	\$ 950.00
		\$ 950.00	\$ 1,150.00
		MSSA	MSSA
Truck space— Tank Wagon	10' X 40'	\$ 1,000.00	\$ 1,200.00
Transport	10' X 70'	\$ 1,200.00	\$ 1,400.00

## BOOTH SPECIFICATIONS:

All booth space is 10' X 10'. All equipment and operation of equipment must be in the confines of the booth space. If in the opinion of the Convention Committee a booth setup is in conflict with another exhibitor, the Committee will make the final determination on the setup.

**TRUCK SPACE:** Combustion engines—Any autos, trucks, or motorized vehicles or other flammable fueled engines displayed shall conform to the following requirements:

*Fuel tanks, unless never having held fuel, shall be maintained between 1/3 and 1/2 full... Caps for fuel tank fill pipes shall be maintained locked. If it is not practical to attach such a cap, an alternate method shall be employed with prior permission from the facility Fire Marshal. No fueling may take place in the building (LSC 9—4.4.4) The electrical system shall be de-energized, either by: 1) Removing the battery (ies); 2) Removing the battery cables; or 3) Disconnecting both the battery cables and covering them with electrical tape or other similar insulating material. (LSC 9-4.4.4)*

Truck move-in will be determined closer to the Show. Trucks must be set prior to the rest of the show being set up. It will be most likely be Sunday, April 8, late afternoon.

**LOCATION:** Saint Paul RiverCentre  
175 West Kellogg Boulevard  
Saint Paul, MN 55102

## SCHEDULE:

**MOVE IN:** **Monday, April 9, 2012**  
Large equipment 11:00 am - 12:00 pm  
All others 12:00 pm - 4:00 pm  
Truck Move-in  
Sunday, April 8, 2012 TBD

**WELCOME RECEPTION\*** - Crowne Plaza—St. Paul 5:00 pm – 6:30 pm

**EXHIBIT HOURS:** **Tuesday, April 10, 2012** 10:00 am - 4:00 pm  
**Wednesday, April 11, 2012** 10:00 am - 2:00 pm

**MOVE OUT:** Wednesday, April 11, 2011 **AFTER 2:15 PM**

\* All Exhibitors are invited to attend the Welcome Reception and Silent Auction on Monday.

## **EXHIBIT SPACE RESERVATIONS:**

Enclosed is a floor plan of the Saint Paul RiverCentre Exhibit Hall and an order form for exhibit space. This year we have 225 booth & truck spaces. There is a maximum limit of six free exhibitor badges. Any additional badges will be billed at \$40 per badge.

**All booths will be assigned on a first-come, first serve basis. Booth spaces will be assigned by receipt of the signed contract and check via return mail, express mail or overnight mail (walk-ins will be processed following day). Space cannot be blocked out over the phone or by fax.**

To make your booth reservation, select three choices and complete the enclosed Exhibit Space Contract and return to MPMA, 3244 Rice Street, St. Paul, MN 55126-3047

### **MOVE OUT:**

*Move out begins after 2:15 pm on Wednesday, April 11, 2012. Move-out time will be monitored. Any exhibitor that begins taking their exhibit down prior to 2:15 pm will have their 2013 booth price doubled. This policy will be strictly enforced by the MPMA Board of Directors. All equipment must be out by 8:00 pm. Any costs incurred by the Association after that time will be assumed along with any liability by Exhibitor. (GES will remove aisle carpet at 2:00 pm. Exhibitors can be in the aisles at 2:15 or once the aisle carpet has been removed.)*

### **PAYMENT/REFUND:**

Booths must be paid in full to reserve a space. Refunds before January 1, 2012, will be in full. After January 1, 2012, refunds only if space is resold.

### **EXHIBITOR SERVICE KITS:**

Each exhibitor will receive an exhibitor service kit approximately 45 days prior to the show. Included in the kit will be forms for ordering booth furnishings, electricity and shipping forms. Mailing labels for MPM members will be available.

Pre-registration form for exhibitor badges and hotel reservations will be in your exhibit packet mailed 45 days prior to show.

### **Exposition Services:**

GES  
7624 Boone Avenue North  
Minneapolis, MN 55428  
(763) 488-5380 [www.ges.com](http://www.ges.com)

### **Electrical:**

Saint Paul RiverCentre  
175 West Kellogg Boulevard  
St. Paul, MN 55102-1299  
(651) 265-4800

### **Show Coordinator:**

Holly Werner, Convention Coordinator  
Minnesota Petroleum Marketers Association  
3244 Rice Street  
St. Paul, MN 55126-3047  
(651)484-7227 or (800)864-3813  
[hwerner@mpmaonline.com](mailto:hwerner@mpmaonline.com)

### **Hotel:**

Reservation forms will be in your exhibitor packet -  
Holiday Inn, Crowne Plaza—Saint Paul  
Riverfont, or Hilton Garden Inn  
Hilton Garden Inn

### **UTILITIES:**

Electrical service is available to all booths and must be ordered prior to show. Water is available on the show floor.

### **LIABILITY:**

Minnesota Petroleum Marketers Association or the Saint Paul RiverCentre are not responsible for lost, stolen or damaged equipment, supplies, etc.

# 2011 MPMA EXHIBITORS

1ST LINE GROUP  
3G ENTERPRISES - WASHWORLD - SONNY'S  
AA EQUIPMENT CO  
ACCUTRAK INVENTORY SPECIALISTS  
ADT SMALL BUSINESS SOLUTIONS  
AG STATES GROUP  
AIRLIFT DOORS INC  
AIR-serv  
ALLISON TRANSMISSIONS  
ALLSTATE PETERBILT GROUP  
AMCON DISTRIBUTING CO  
AMERICAN CAR WASH INDUSTRIES  
AMERIGAS  
ANTEA GROUP  
ARCTIC GLACIER ICE  
ARMADA COFFEE  
ATM SOURCE  
AUTOWASH SYSTEMS INC  
AXXIS PETROLEUM INC  
B & H PETROLEUM  
BANKER'S EQUIPMENT  
BAYWASH INC -  
BAYS BY SONNY'S  
BEALL CORPORATION  
BERNICK COMPANY  
BETALED  
BLENDCO SYSTEMS  
BLI LIGHTING INC  
BLUE SKY MIDWEST LLC  
BRAMS ENGINEERING LLC  
CAMVACUSA  
CANTEEN REFRESHMENTS  
CARLSON PROFESSIONAL SERVICES INC  
CASH DEPOT  
CAT SCALE COMPANY  
CBC LEARNING CENTER  
CEDAR CREST ICE CREAM  
CENEX  
CHAMBERS & OWEN  
CHASE PAYMENTECH  
CHEMQUEST INC  
CHESTER'S INTERNATIONAL  
CHS RETAIL TRAINING SOLUTIONS  
CINTAS  
CIVACON  
CLARK BRANDS LLC  
CLEAN AIR CHOICE  
CLEAN-BURN/DERSON MFG.  
CLS CUSTOM LAMINATING SPECIALISTS  
COCA-COLA  
COMMANDlabs  
CONWAY, DEUTH & SCHMIESING, PLLP - CPA'S  
CORE-MARK INTERNATIONAL  
D.M.F. BAIT COMPANY  
DAKOTA REFRIGERATION INC.  
DELI EXPRESS  
DETERMAN  
DICK'S SANITATION/TRUE BLUE DESIGNS  
DIGITAL SURVEILLANCE CONCEPTS

DIXON BAYCO  
DST NETWORKS  
EAST SIDE OIL COMPANIES  
EBY-BROWN  
EMC INSURANCE COMPANIES  
ENABLE C-STORE  
ENERGY DISTRIBUTION SOLUTIONS  
ET PRODUCTS  
ET VIDEO INC  
FARNER-BOCKEN COMPANY  
FAUSER ENERGY RESOURCES  
FEDERAL MOTOR CARRIER SAFETY ADMIN.  
FEDERATED INSURANCE CO.  
FIREKING SECURITY GROUP  
FRESHWAY FOOD SYSTEMS  
FUEL RIGHT  
GENERAL BUSINESS SERVICE INC  
GRAYBAR ELECTRIC CO INC  
HARTLAND FUEL PRODUCTS  
HENRY'S FOODS INC  
HERITAGE PROPANE EXPRESS  
HLC CAPITAL, A GREAT AMERICA CO  
HOLIDAY STATIONSTORES  
HOT STUFF FOODS - LETTIERI'S  
HUSKY CORP  
I-GOGS SUNGLASSES/SEAVER CO  
INTL FCSTONE  
KITCHEN FRESH FOODS  
KRISPY KRUNCHY CHICKEN  
LANDMARK DISTRIBUTION LLC  
LBT INC - OMAHA, NE  
LIBBY LAW OFFICE PA  
LSI INDUSTRIES INC  
LUBE TECH  
MARTIN BROS DISTRIBUTING CO  
MCLANE COMPANY  
MID AMERICA MFG & DIST INC  
MIDWEST FINANCIAL PROCESSING  
MIDWEST LABORATORIES INC.  
MIDWEST MAP  
MINNESOTA BIODIESEL COUNCIL  
MINNESOTA PETROFUND  
MINNESOTA PETROLEUM SERVICE  
MINNESOTA STATE LOTTERY  
MN DEPT OF REVENUE/PETROLEUM DIV.  
MN POLLUTION CONTROL AGENCY  
MN WEIGHTS & MEASURES DIVISION  
MN/DOT MOTOR CARRIER SERVICES  
MSSA  
NORTH AMERICAN TRAILER SALES  
NORTHLAND PETROLEUM SERVICE  
O'DAY EQUIPMENT LLC  
OLD DUTCH FOODS INC.  
PACIFIC LIFE 401(K) PLANS  
PARAMOUNT MARKETING  
PATRON POINTS/RIZUR REWARDS  
PEDIGREE TECHNOLOGIES  
PEPSI BEVERAGE COMPANY  
PERSONA INC

PETROLEUM CARD SERVICES  
PETROLEUM MARKETERS SERVICE INC  
PETROLEUM PARTS/PPI-DUREQUIP  
PICCADILLY CIRCUS PIZZA  
POLAR TANK TRAILER LLC  
POLKA DOT DAIRY INC  
POWER SERVICE PRODUCTS  
PREMIER SOLUTIONS INC  
PROFESSIONAL CAR WASH SYSTEMS  
PUMP & METER SERVICE  
R & R PETROLEUM EQUIPMENT SALES  
RDM INDUSTRIAL ELECTRONICS INC  
RECLAIM EQUIPMENT CO  
RED RIVER SOFTWARE  
RELIABLE PLUS CAR WASH SERVICES  
RELUMINATE INC  
REMOTE MAINTENANCE TECHNOLOGIES  
RIHM KENWORTH TRUCK SALES & PRODUCT SUPPORT  
ROBERTS BUSINESS FORMS  
ROCHESTER PETROLEUM EQUIPMENT  
ROLLIES SALES & SERVICE  
RONNOCO COFFEE  
ROSE CITY CANOPY, SIGN & VINYL  
ROVANCO PIPING SYSTEMS  
RYKO MANUFACTURING CO.  
S & R SALES INC  
S. ABRAHAM & SONS  
SCHAEFFER PREMIUM DIESEL WINTER ADDITIVES  
SCR  
SENECA TANK  
SHAMROCK GROUP  
SPLASH  
STAN MORGAN AND ASSOCIATES  
STUART TANK SALES  
SUNRISE AG SALES  
TANKNOLOGY, INC.  
TCDEALZ  
TFC CANOPY & FABRICATION  
TRIMART CORPORATION  
TRIPLE C TECHNOLOGIES  
TRIPLE E TECHNOLOGIES  
TSBL DISTRIBUTING  
TSC GLOBAL  
UNCLE LARRY'S BEEF SHTIX  
UPSTATE NIAGARA COOPERATIVE INC  
VALLEY NEWS MAGAZINES & MAPS  
VALLEY PETROLEUM EQUIPMENT INC  
WCEC ENVIRONMENTAL CONSULTANTS  
WEBB CANDY  
WESTERN PETROLEUM CO  
WESTMOR INDUSTRIES  
WESTSIDE EQUIPMENT  
WISC/MN PETROLEUM COUNCIL ADVISOR OF API  
WORLDPAY  
XPOFACT  
XTREME ENTERPRISES INC  
YES DISTRIBUTING  
YOCUM OIL  
ZAHLE-PETROLEUM MAINTENANCE

**Thank you  
for  
exhibiting in  
2011,  
we look  
forward to  
seeing you in  
2012.**

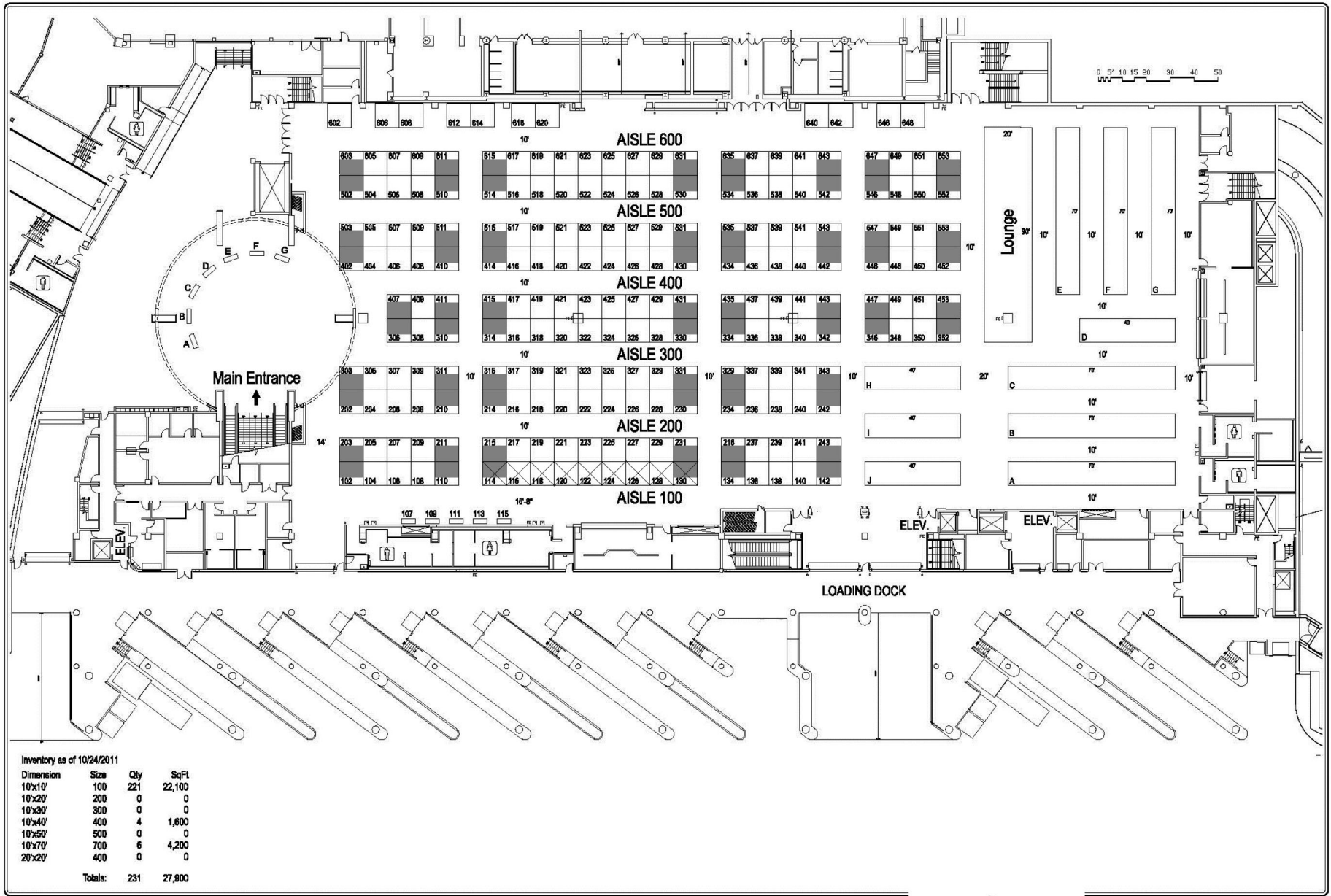

Inventory as of 10/24/2011

Dimension	Size	Qty	SqFt
10'x10'	100	221	22,100
10'x20'	200	0	0
10'x30'	300	0	0
10'x40'	400	4	1,600
10'x50'	500	0	0
10'x70'	700	6	4,200
20'x20'	400	0	0
<b>Totals:</b>		<b>231</b>	<b>27,900</b>

**GES** Global Experience Specialists

COPYRIGHT © BY GLOBAL EXPERIENCE SPECIALISTS. ALL RIGHTS RESERVED. NO PART OF THIS PUBLICATION MAY BE REPRODUCED, STORED IN ANY RETRIEVAL SYSTEM, OR TRANSMITTED IN ANY FORM OR BY ANY MEANS - ELECTRONIC, MECHANICAL, PHOTOCOPIING, RECORDING, OR OTHERWISE - WITHOUT EXPRESS WRITTEN CONSENT OF GLOBAL EXPERIENCE SPECIALISTS.

**MPMA**  
 April 9 - 11, 2012  
 St. Paul RiverCentre - Exhibit Halls A & B



**CONFIDENTIAL PROPERTY OF GES**  
 File: mpma-1204-rvrctr-ab.dwg  
 Plotted: Oct 24, 2011  
 By: HAYESA

EVERY EFFORT HAS BEEN MADE TO INSURE THE ACCURACY OF ALL INFORMATION CONTAINED ON THIS FLOOR PLAN. HOWEVER, NO WARRANTIES, EITHER EXPRESSED OR IMPLIED, ARE MADE WITH RESPECT TO THIS FLOOR PLAN. IF THE LOCATION OF BUILDING COLUMNS, UTILITIES OR OTHER ARCHITECTURAL COMPONENTS OF THE FACILITY IS A CONSIDERATION IN THE CONSTRUCTION OR USAGE OF AN EXHIBIT, IT IS THE SOLE RESPONSIBILITY OF THE EXHIBITOR TO PHYSICALLY INSPECT THE FACILITY TO VERIFY ALL DIMENSIONS AND LOCATIONS.



# MINNESOTA PETROLEUM MARKETERS ASSOCIATION

Saint Paul RiverCentre—Saint Paul, MN

April 9 - 11, 2012

## CONTRACT

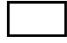
Please reserve \_\_\_\_\_ exhibit space(s) at the 2012 MPMA Convention and Trade Show to be held at the Saint Paul RiverCentre, St. Paul, MN. We agree to pay, in accordance with the following, per booth:

<b><u>BOOTH RATES:</u></b>	<b>10' X 10'</b>	<u>Member</u>	<u>Non-Member</u>	
		\$ 750.00	\$ 950.00	
		\$ 950.00	\$ 1,150.00	
		MSSA	MSSA	
<b>Truck Space—</b>	Tank Wagon	10' X 40'	\$ 1,000.00	\$ 1,200.00
	Transport	10' X 70'	\$ 1,200.00	\$ 1,400.00

**Booth Choice:** First \_\_\_\_\_ Second \_\_\_\_\_ Third \_\_\_\_\_

**Truck Space:** \_\_\_\_\_ Tank Wagon (10' X 40') \_\_\_\_\_ Transport (10' X 70')

Our check in the amount of \$ \_\_\_\_\_ to cover the cost of \_\_\_\_\_ space(s) is enclosed herewith.

*It is our understanding that exhibit spaces are allotted in the order in which contracts are received and will be assigned based on best available. We further understand that the Minnesota Petroleum Marketers Association or the Saint Paul RiverCentre are not responsible for lost, stolen or damaged equipment, supplies, etc. If in the opinion of the Convention Committee a booth setup is in conflict with another exhibitor, the Committee will make the final determination on the setup. Subletting of booth space or reselling is not allowed. MPM will do its best to assign competitors away from each other. All equipment and operation of equipment must be in the confines of the booth space. We also understand that every attempt will be made to protect the existing flooring (i.e. If mixing, preparing, or frying food, the existing carpet needs to be protected from flour, oil, etc).*

**MOVE OUT:** Move out begins after 2:15 pm on Wednesday, April 11, 2012. Move-out time will be monitored. Any exhibitor that begins taking their exhibit down prior to 2:15 pm will have their 2013 booth price doubled. All equipment must be moved out by 8:00 pm—any expenses and liability for violation of time will be assumed by exhibitor. This policy will be strictly enforced by the MPM Board of Directors. (GES will remove aisle carpet at 2:00 pm. Exhibitors can be in the aisles at 2:15 or once the aisle carpet has been removed.)



CONTINUED ON REVERSE...

## MPM Exhibit Contract cont.. Page 2

Check one of the following categories for the product being displayed:

- |  |   |
|--|---|
| <input type="checkbox"/> Additives/Lubricant         | <input type="checkbox"/> Environmental Companies      |
| <input type="checkbox"/> ATM's                       | <input type="checkbox"/> Fastfood/Deli                |
| <input type="checkbox"/> Beverage/Coffee             | <input type="checkbox"/> Insurance                    |
| <input type="checkbox"/> C-Store Equipment           | <input type="checkbox"/> Inventory Control            |
| <input type="checkbox"/> C-Store General Merchandise | <input type="checkbox"/> Petroleum Handling Equipment |
| <input type="checkbox"/> Candy, Tobacco, Magazines   | <input type="checkbox"/> Real Estate                  |
| <input type="checkbox"/> Car Wash/Chemicals          | <input type="checkbox"/> Signs & Awnings              |
| <input type="checkbox"/> Commodity Broker            | <input type="checkbox"/> Truck Sales                  |
| <input type="checkbox"/> Computer Equip/Software     | <input type="checkbox"/> Other _____                  |

**PRODUCT GUIDE INFORMATION (50 words or less giving a brief description of your company & products being displayed)**

---

---

---

---

Pre-registration form for exhibitor badges and hotel reservations will be in your exhibit packet mailed 45 days prior to show.

### PLEASE PRINT CLEARLY

We would like our BOOTH SIGN to read:

---

COMPANY NAME: \_\_\_\_\_

ADDRESS: \_\_\_\_\_

CITY/STATE/ZIP: \_\_\_\_\_

PHONE: \_\_\_\_\_

FAX: \_\_\_\_\_ EMAIL: \_\_\_\_\_

I have read and understand the Move-out Policy.

SIGNATURE \_\_\_\_\_ PRINT NAME \_\_\_\_\_

\*\*\*\*\*

RETURN TO:

**MN PETROLEUM MARKETERS ASSN  
ATTN: Holly Werner  
3244 Rice Street  
St. Paul, MN 55126-3047**