

**Double Tier Seated
Wall Installation**

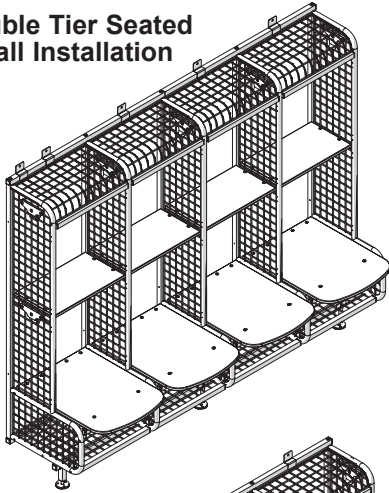

**Double Tier Seated
Island Installation**

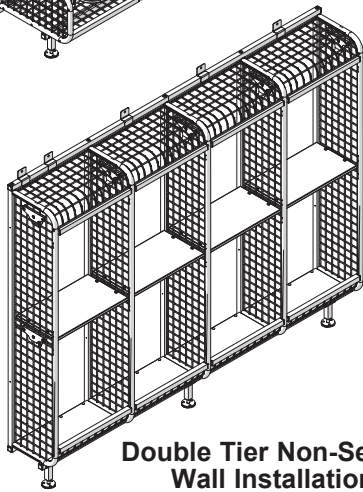
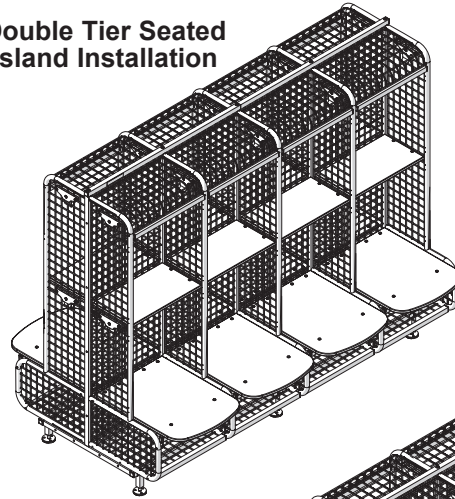

**Double Tier Non-Seated
Wall Installation**

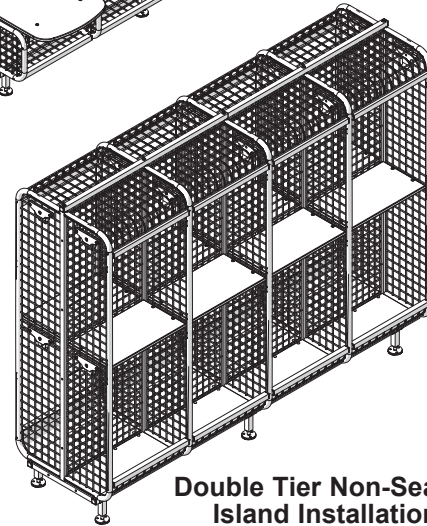

**Double Tier Non-Seated
Island Installation**

Contents

Important User Information	2	Non-Seated Wall Configuration Components	7
General	2	Seated Island Configuration Components	8
Manufacturer	2	Non-Seated Island Configuration Components	9
Intended Use	2	Starter, Extension and Base Variations	10
Warranty	2	Pre-Installation Assembly	11
Safety Precautions	3	Wall Configuration Installation	13
Maintenance	3	Island Configuration Installation	21
Required Tools	4	Final Assembly	30
Before Installation	4	Optional Grille Door Installation	36
Supplied Fasteners	5	Optional Wood Door Installation	40
Fasteners - Not Supplied	5	Optional Side Panel Installation	44
Seated Wall Configuration Components	6	Optional Back Panel Installation	47



Visit the GearBoss web page at www.gearboss.com for detailed instructions and videos.

Note: Please read and understand the instructions before starting the assembly or installation.
Note: If you need additional information, contact Wenger Corporation using the information below.

Important User Information

General

Copyright © 2017 by Wenger Corporation

All rights reserved. No part of the contents of this manual may be reproduced, copied, or transmitted in any form or by any means including graphic, electronic, or mechanical methods or photocopying, recording, or information storage and retrieval systems without the written permission of the publisher, unless it is for the purchaser's personal use.

Printed and bound in the United States of America.

The information in this manual is subject to change without notice and does not represent a commitment on the part of Wenger Corporation. Wenger Corporation does not assume any responsibility for any errors that may appear in this manual.

In no event will Wenger Corporation be liable for technical or editorial omissions made herein, nor for direct, indirect, special, incidental, or consequential damages resulting from the use or defect of this manual.

The information in this document is not intended to cover all possible conditions and situations that might occur. The end user must exercise caution and common sense when assembling or installing Wenger Corporation products. If any questions or problems arise, call Wenger Corporation at 1-800-887-7145.

Manufacturer

The GearBoss® AirPro™ Locker is manufactured by:

Wenger Corporation
555 Park Drive
Owatonna, MN 55060
(800) 4WENGER (493-6437) • +1 (507) 455-4100
www.wengercorp.com

Intended Use

- This product is intended for indoor use in normal ambient temperature and humidity conditions — it must not be exposed to outside weather conditions.
- This product is intended to be assembled only as described in these instructions.

Warranty

GearBoss AirPro Lockers are covered under a ten year Limited Warranty offered to you, the initial purchaser. This Warranty runs from the date of shipment and warrants that the Wenger product will be free of defects in materials or craftsmanship during the warranty period. This Warranty is your sole and exclusive remedy for any claim against Wenger related to your purchase, use, or ownership of a Wenger product. This Warranty does not apply to damage caused by common carrier, misuse or abuse, alterations to products not expressly authorized by Wenger. Exact matching of color, grain, texture and lighting is not guaranteed as these features are prone to change and fade over time. Our warranty assures you of, at the discretion of our Customer Service Department, either a full refund, or the repair or replacement of the defective product without charge. Just call a Customer Service Representative at 1-800-887-7145 and state the reason you are dissatisfied. If return of a product is necessary, your representative will issue a return authorization.

Safety Precautions

Throughout this manual you may find cautions and warnings which are defined as follows:

- **WARNING** means that failure to follow the instruction may result in serious injury or death.
- **CAUTION** means that failure to follow the instruction may result in serious injury or damage to property.

Read all of these safety instructions before assembling and installing the AirPro Lockers.

 CAUTION	 CAUTION	 CAUTION
<i>Make sure anyone assembling or installing the AirPro Locker has read and understands these instructions.</i>	<i>Failure to comply with Warnings and Cautions in this document can result in damage to property or serious injury.</i>	<i>To avoid damage and injury, more than one person is needed for installation.</i>

Overview

- This system should be installed only by skilled technical persons, and only after carefully studying these instructions.
- It is suggested that the lockers are setup in a space that is large enough to safely handle the cartons, parts and accessories.
- Inspect the condition of the wall and floor where the lockers will be located. If the wall is not straight, establish a reference line so that the fronts of all lockers will line up. Also, determine the highest point on the floor, which will establish the leveled height of each row of lockers.

Before You Begin

- Read the complete assembly procedure before beginning the assembly.
- Hardware packs may contain extra fasteners that will not be required on your lockers.
- At least two people are required to install the locker.

General Usage

- Never place more than 100 lbs (45 kg) on a single shelf.
- Never hang from or climb on lockers.
- Overloading or shock-loading lockers could cause a collapse, resulting in property damage or serious injury.

Maintenance

- Clean the locker and it's components with a mild detergent. Avoid using harsh or abrasive cleaning products.
- Check fasteners periodically to ensure they have not loosened or dislodged.

Required Tools

Two sets of tools are recommended as the installation requires a minimum of two primary installers and two additional people for support.

- Cordless Drill
- Phillips Drive Bit
- 7/16" and 1/2" Combination Wrench
- Carpenter's Level
- Tape Measure
- 50-foot Chalk Line
- Mallet
- Impact Driver
- Long Bit Extension (Optional)
- Hammer Drill
- Cement Bits (as required for anchors)
- 8+ Ratcheting Clamps
- 16' Ratchet Strap
- 4 mm Hex Wrench
- 3/16" Hex Wrench
- 7/16" Nut Driver
- 3/8" Nut Driver
- 1/4" Hex Wrench
- 3/32" Hex Wrench (included)

Before Installation

- Open all boxes and sort the components by like parts and sizes.
- Open the hardware packs and sort all hardware by like parts and sizes.
- Inventory the cartons to be sure that all required components are present.
- Clear away packaging waste.
- Use cardboard, carpet or packaging to prevent scratching the components during assembly.
- Make sure the area is free of any obstacles or obstructions.
- It is recommended that there are two primary installers and two support people for the installation.
- It is recommended to complete the wall section installation first.
- Review the architectural drawings provided by Wenger and understand the layout of the room before starting the installation.
- Take measurements of the room and wall lengths.
The wall must accommodate an additional 6" to allow the Extension Tubes for the final bay of lockers to slide into the run already installed on the wall.
- Determine the extension(s) needed for the layout and run of lockers.
Review the architectural drawings and the "Starter, Extension and Base Variations" section.

Supplied Fasteners

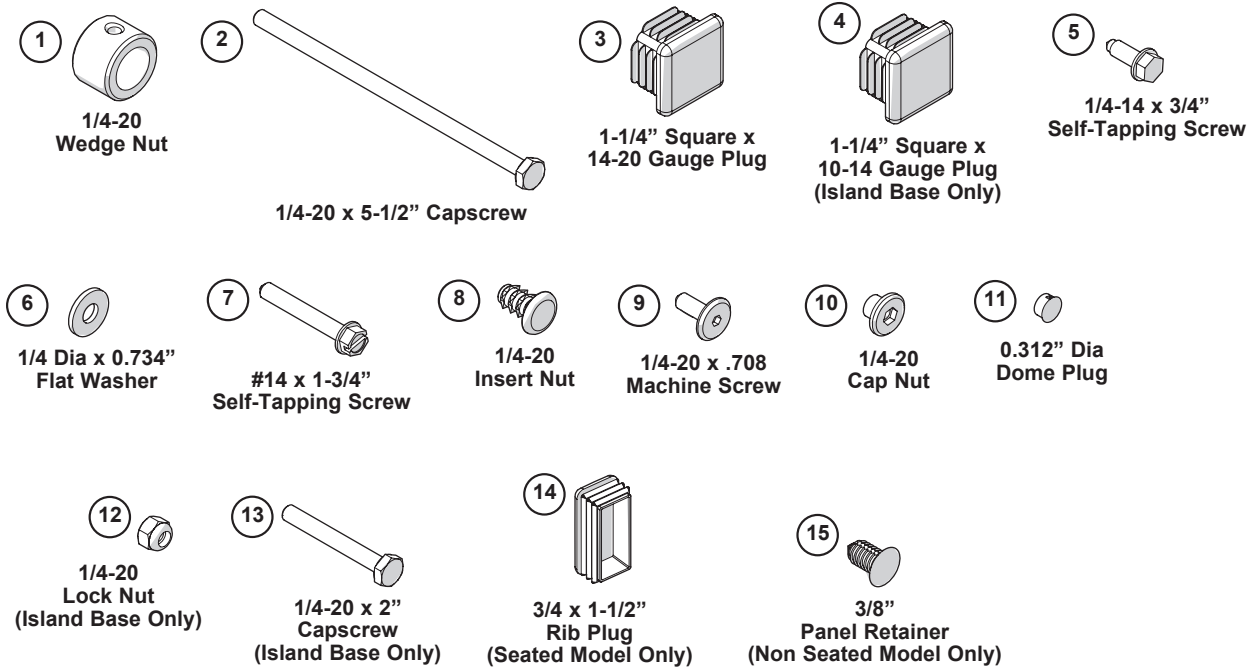

Structural Fasteners - Not Supplied

Because materials and construction of floors and walls can vary, fasteners for attaching the AirPro Locker to the structure are not provided. The installer must choose the appropriate fastener and follow the manufacturer's directions.

⚠ CAUTION

Inferior or improperly installed fasteners could cause the AirPro Locker to collapse.

AirPro Locker Fastener Guidelines:

- If concrete, attachment should be 1/4" concrete wedge anchor no more than 16" apart.
- If wood stud-and-drywall construction, attachment should be by lag screws (1/4" minimum) into every stud.
- If metal stud-and-drywall construction, attachment should be by toggle bolt (1/4" minimum) into every stud.
- If poured concrete construction, attachment should be concrete wedge anchor spaced no more than 24" apart.

Note: Each wall and floor connection must be rated for a minimum of 500 lbs (227 kg) of tension. Other fasteners may be used if the connection strength requirement is met.

Seated Wall Configuration Components

Item	Description	Item	Description
16	Top Grille	25	Wall Front Extension Connector
17	Seated Bottom Grille	26	Shelf Side Hook Bracket
18	Starter Connector	27	Hook Cover Plate
19	Extension Connector	28	Shelf Panel
20	Seated Wall Side Grille	29	Seat Panel
21	Wall Bracket	30	Seat Hinge
22	Adjustable Foot	31	Seat Support Weldment
23	Support Leg	32	Double Tier Side Hook Bracket
24	Wall Starter Tube	41	GearBoss Decal

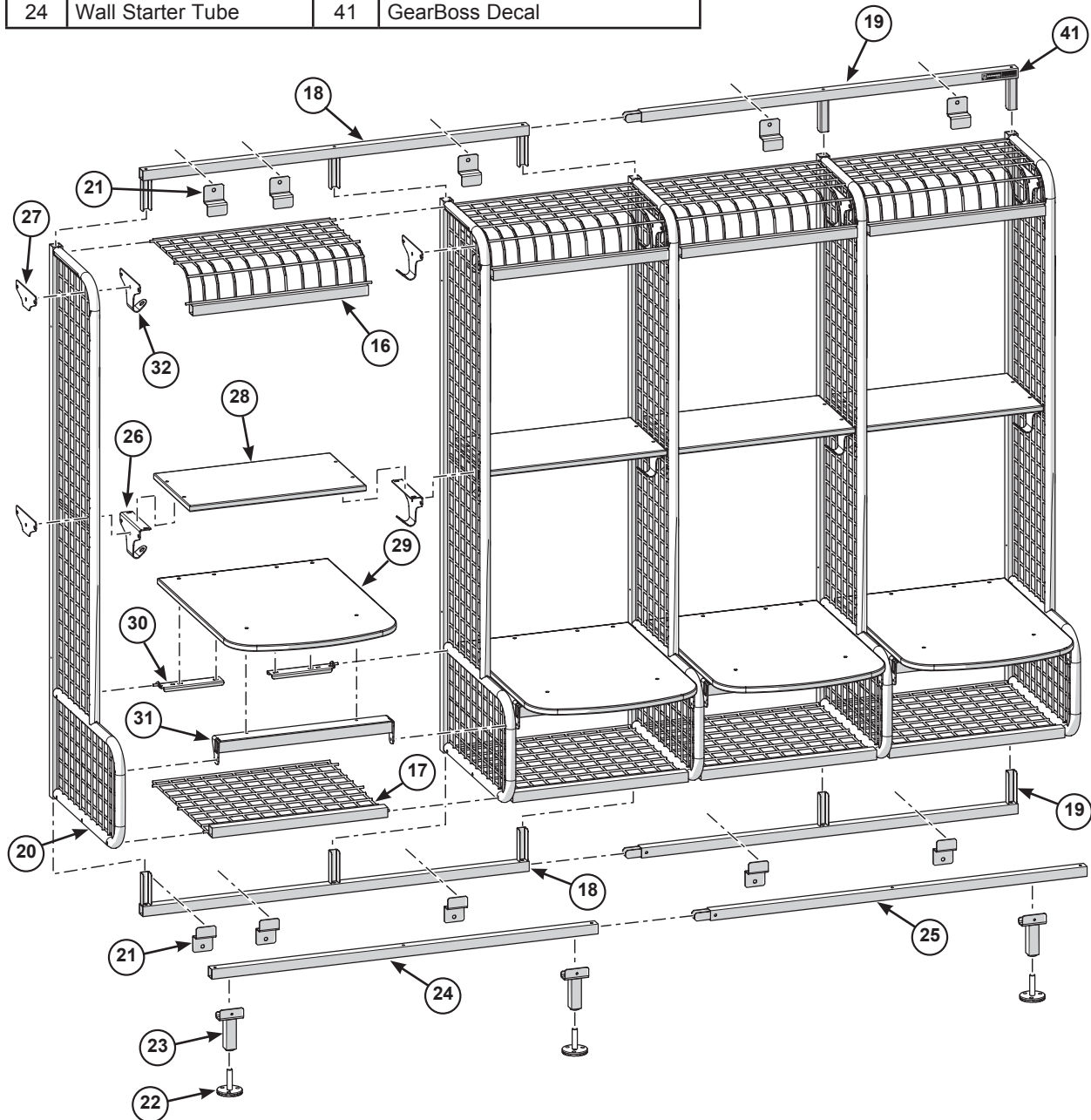

Non-Seated Wall Configuration Components

Item	Description	Item	Description
16	Top Grille	26	Shelf Side Hook Bracket
18	Starter Connector	27	Hook Cover Plate
19	Extension Connector	28	Shelf Panel
21	Wall Bracket	32	Double Tier Side Hook Bracket
22	Adjustable Foot	33	Wall Non-Seated Side Grille
23	Support Leg	34	Bottom Shelf Shield
24	Wall Starter Tube	39	Non-Seated Bottom Grille
25	Wall Front Extension Connector	41	GearBoss Decal

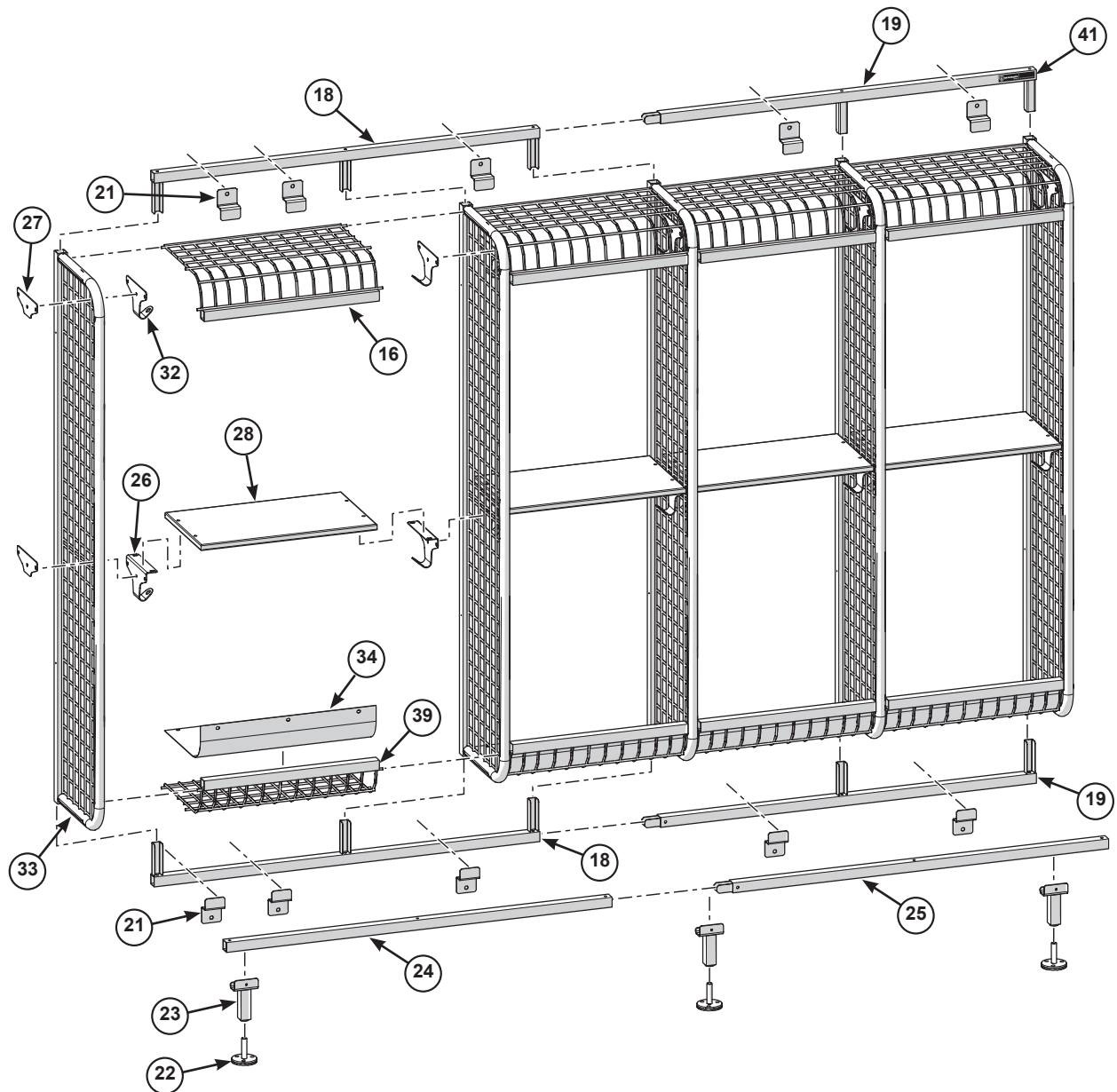

Seated Island Configuration Components

Item	Description	Item	Description
16	Top Grille	29	Seat Panel
17	Seated Bottom Grille	30	Seat Hinge
18	Starter Connector	31	Seat Support Weldment
19	Extension Connector	32	Double Tier Side Hook Bracket
22	Adjustable Foot	35	Seated Island Side Grille
23	Support Leg	36	Island Back Panel
26	Shelf Side Hook Bracket	37	Island Base Starter
27	Hook Cover Plate	38	Island Base Extension
28	Shelf Panel	41	GearBoss Decal

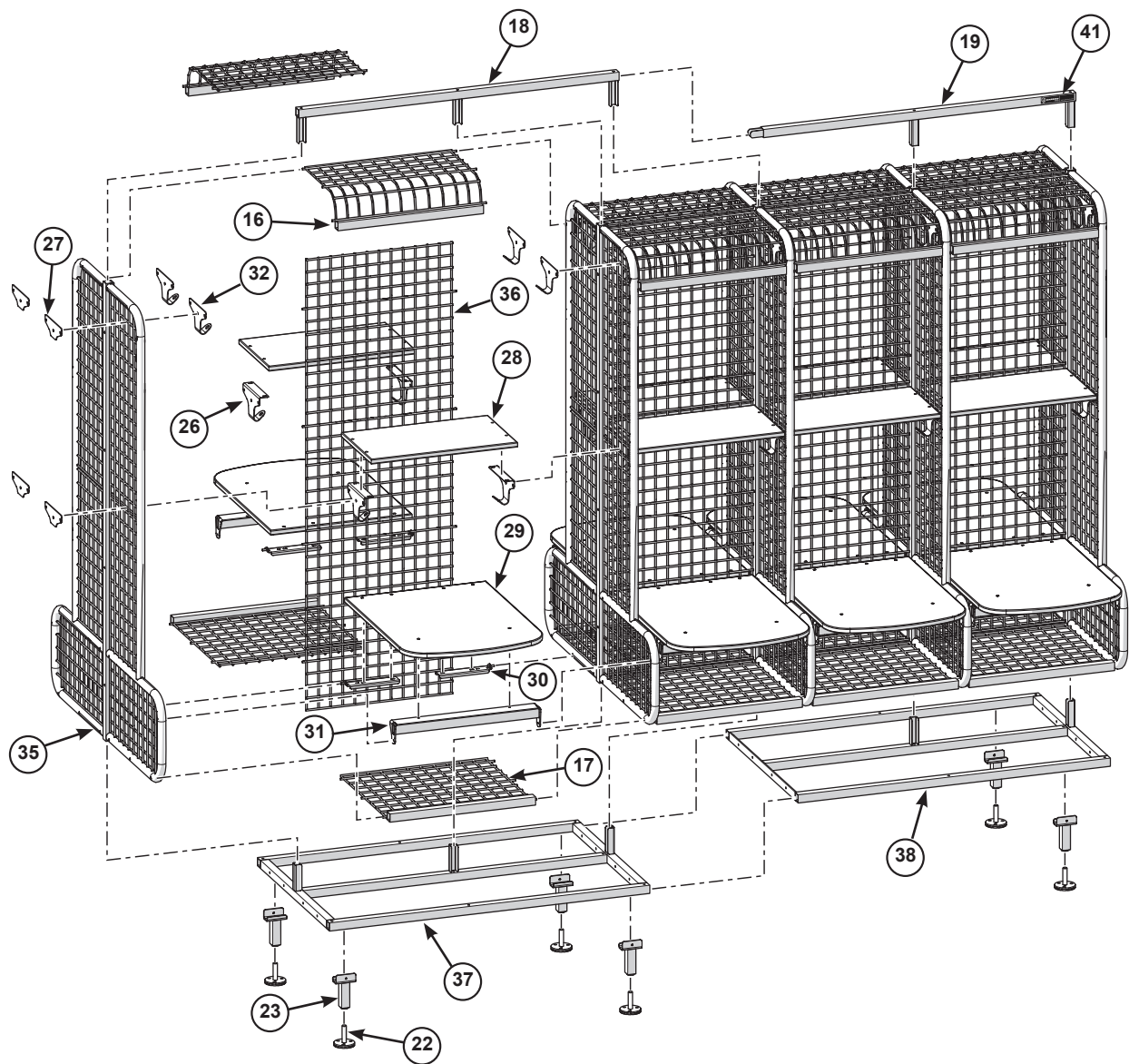

Non-Seated Island Configuration Components

Item	Description	Item	Description
16	Top Grille	32	Double Tier Side Hook Bracket
18	Starter Connector	34	Bottom Shelf Shield
19	Extension Connector	36	Island Back Panel
22	Adjustable Foot	37	Island Base Starter
23	Support Leg	38	Island Base Extension
26	Shelf Side Hook Bracket	39	Non-Seated Bottom Grille
27	Hook Cover Plate	40	Island Non-Seated Side Grille
28	Shelf Panel	41	GearBoss Decal

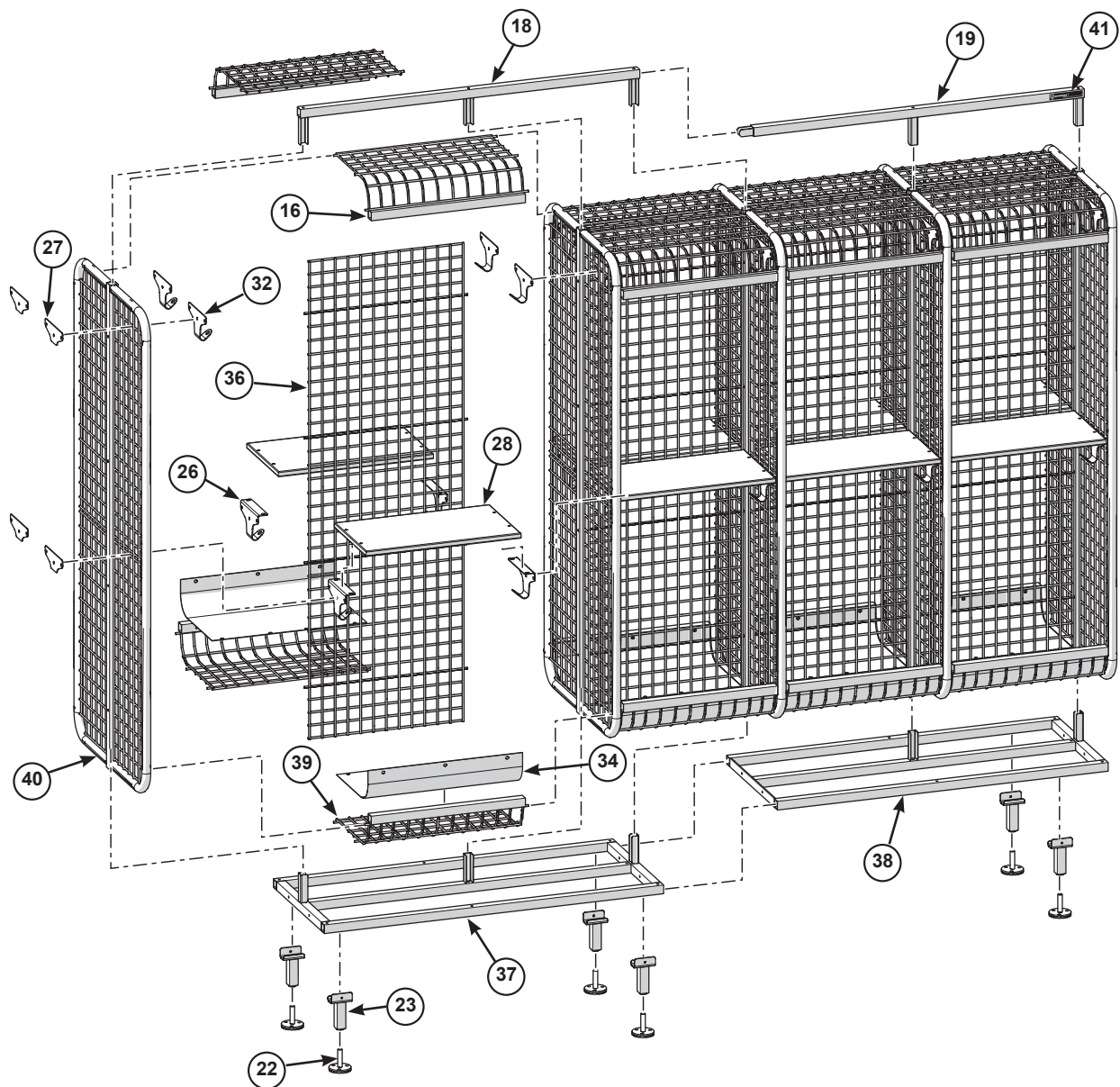

Starter, Extension and Base Variations

Starter, Extension and Base variations are dependant upon the intended locker configuration, see the installation drawings to determine which variation will apply.

Note: When a Locker configuration is not divisible by three, always begin with a 2-Locker Starter.

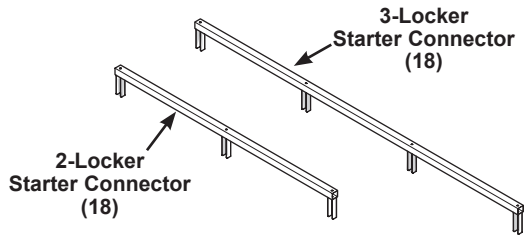

**Starter Connectors
(Wall and Island Configurations)**

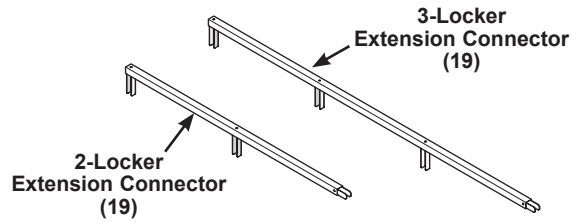

**Extension Connectors
(Wall and Island Configurations)**

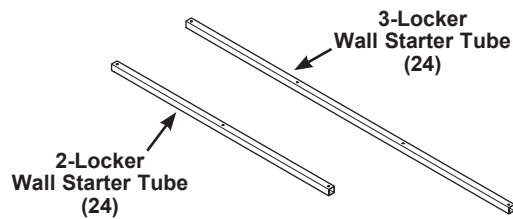

**Wall Starter Tubes
(Wall Configurations)**

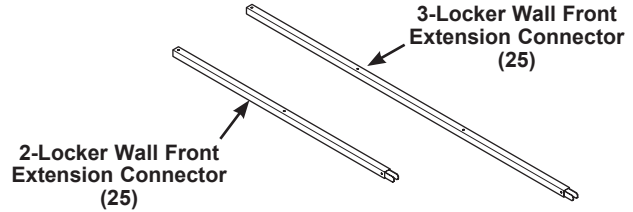

**Wall Front Extension Connectors
(Wall Configurations)**

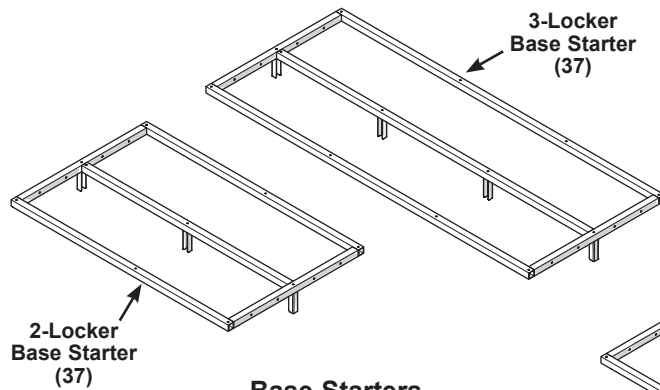

**Base Starters
(Island Configurations)**

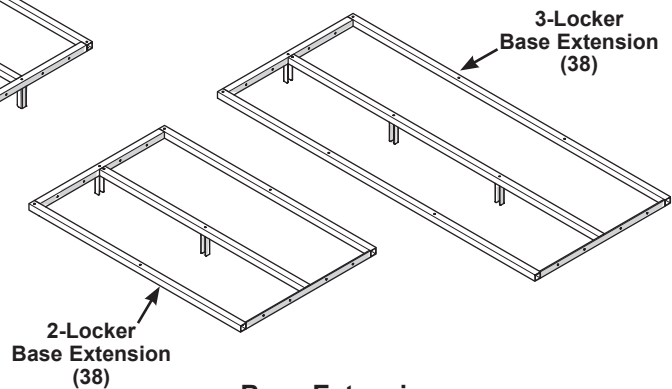

**Base Extensions
(Island Configurations)**

Pre-Installation Assembly

IMPORTANT: Quantities of the components in these instructions will vary with the length and configuration of each bank of lockers.

Top Grilles (all models)

1. Pound 1-1/4" Square x 14-20 Gauge Plugs (3) into the open ends of all Top Grilles (16).

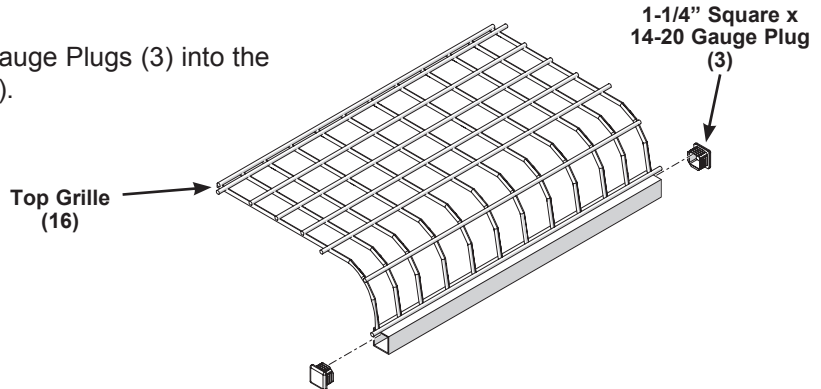

Bottom Grilles (seated models)

1. Pound 1-1/4" Square x 14-20 Gauge Plugs (3) into the open ends of all Seated Bottom Grilles (17).

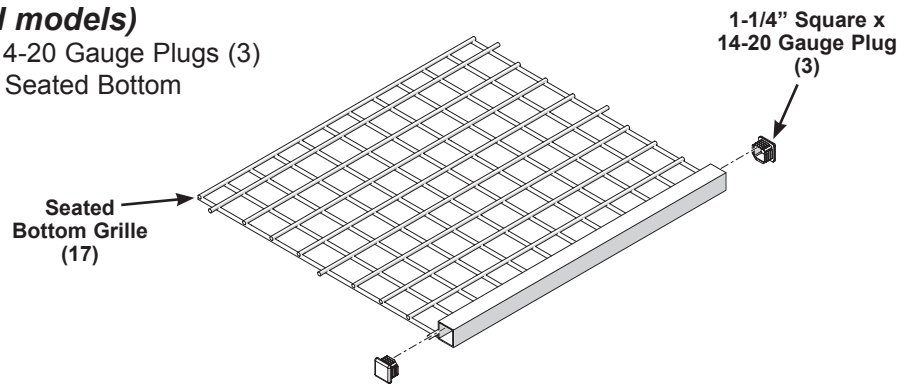

Bottom Grilles (non-seated models)

1. Pound 1-1/4" Square x 14-20 Gauge Plugs (3) into the open ends of all Non-Seated Bottom Grilles (39).
2. Secure a Bottom Shelf Shield (34) to the inside of the Bottom Grilles using seven 3/8" Panel Retainers (15).

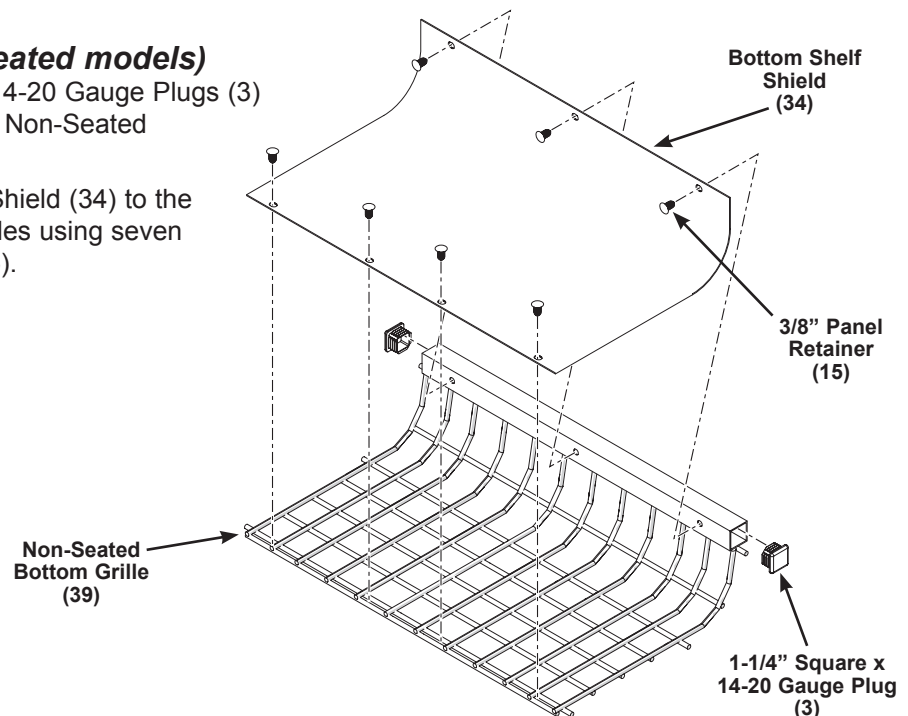

Pre-Installation Assembly (continued)

Starters and Extensions

1. Assemble all of the Starter Connectors (18), Extension Connectors (19), Island Base Starters (37) and Island Base Extensions (38).

Finger tighten a set of one 1/4-20 x 5-1/2" Capscrew (2), 1/4 Dia x 0.734" Flat Washer (6) and 1/4-20 Wedge Nut (1) into every Connect Tube of all Starter Connectors (19), Extension Connectors (19), Island Base Starters (37) and Island Base Extensions (38).

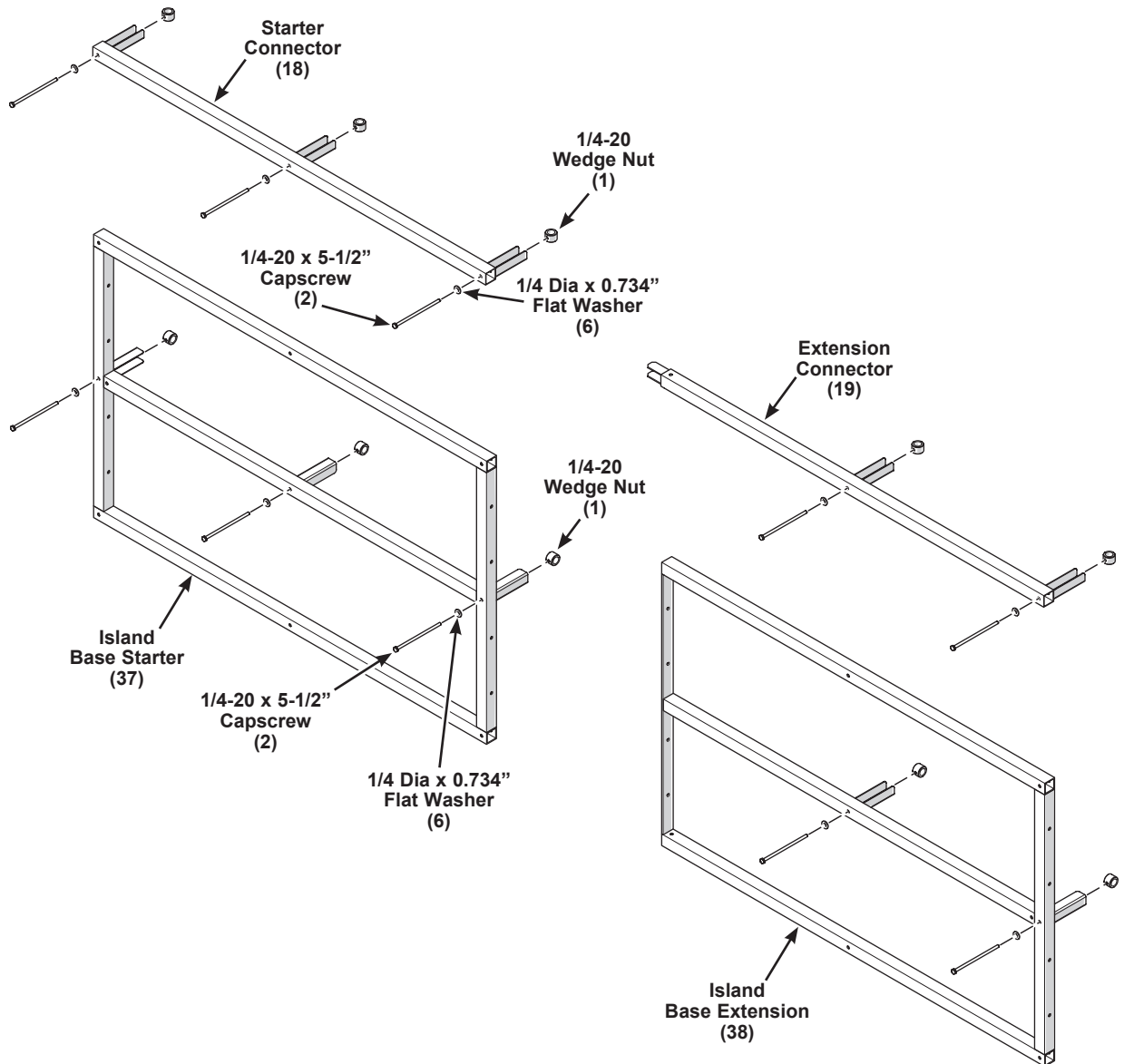

Wall Configuration Installation

The AirPro Lockers can be installed in either wall or island configurations. This is the procedure for installing the Wall Locker Configuration! For installing the Island Locker Configuration, go to page 21.

IMPORTANT: When the lockers are to be flush in a corner, the bank needs to start in that corner. The first bank of lockers (either two or three individual lockers) are mounted on starter tubes at the end of the row. The bank is completed with the remaining sets of lockers mounted on extension tubes. Starting the row with the wrong set of lockers will make it impossible to complete the installation. Refer to the installation drawings.

CAUTION

To avoid damage and injury, more than one person is needed for installation.

1. Lay all of the locker components out according to the installation drawings.
2. Build the first locker by positioning one Top Grille (16) and one Seated Bottom Grille (17) between two Wall Side Grilles (20). Align the extended wires of the Top and Bottom Grilles with the matching holes in the Side Grilles.
3. Use ratchet clamps to temporarily hold the Top, Bottom and Side Grilles together.

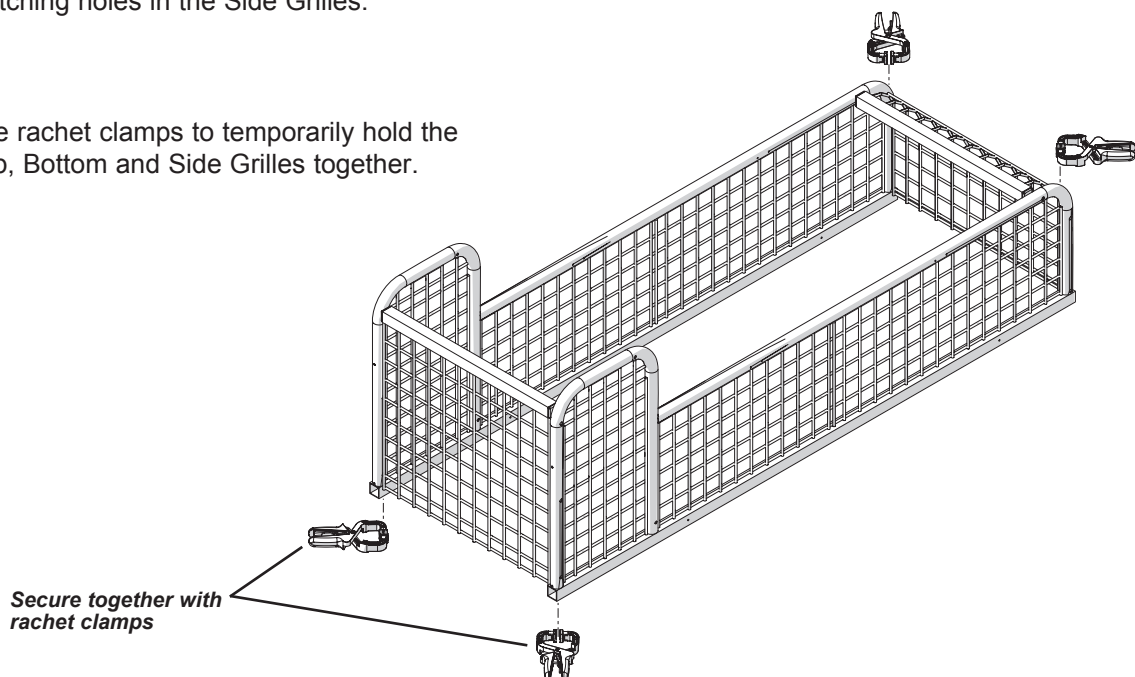
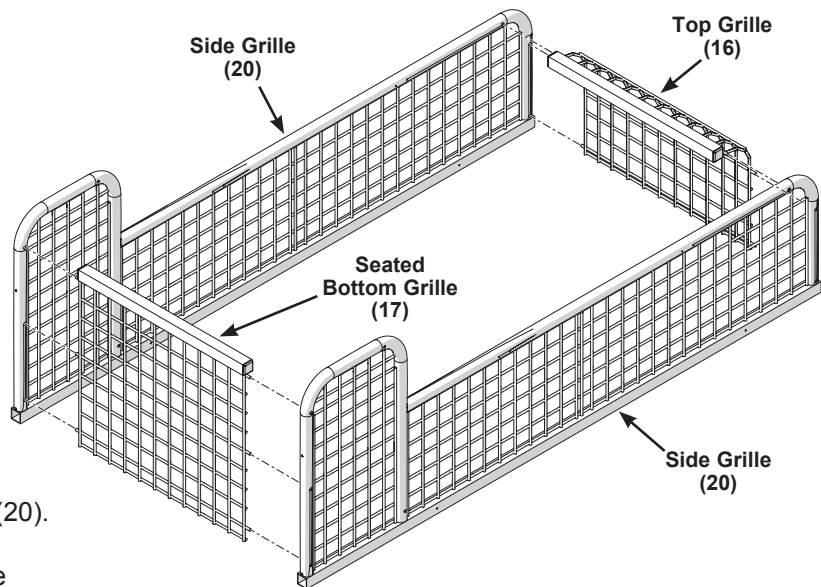

Wall Configuration Installation (continued)

4. Build the remaining lockers for this bank off of the just assembled locker depending on the configuration as indicated in the installation drawings.

Repeat steps 2-3 using an additional Top Grille, Bottom Grille and Side Grille to build the next locker off of the Side Grille from the already assembled locker.

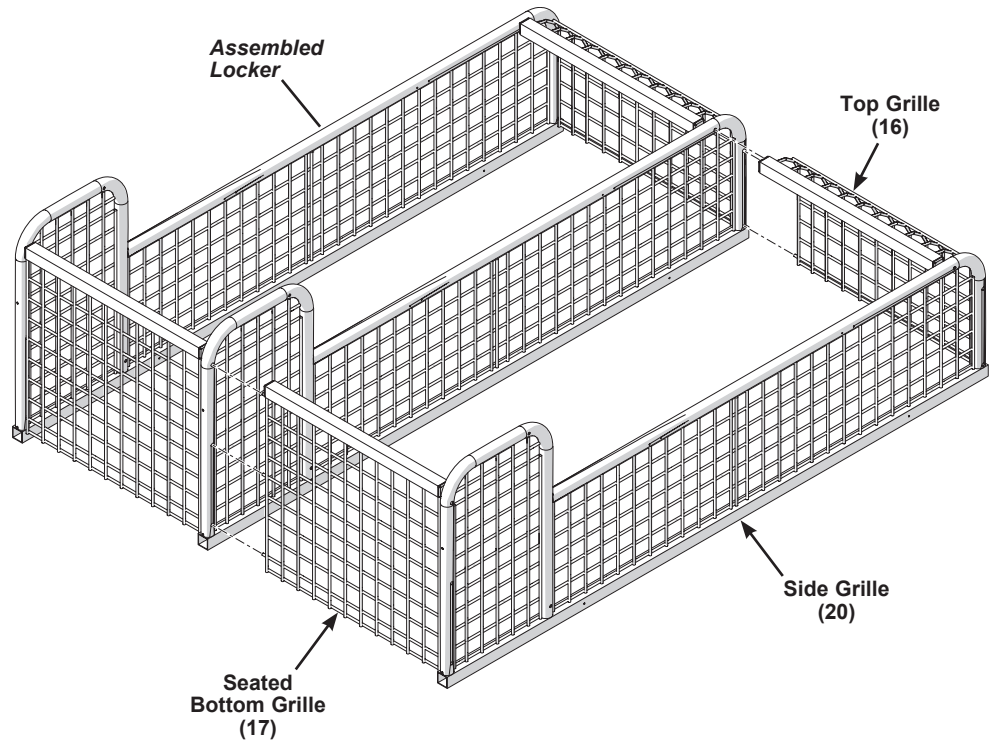

IMPORTANT: *Only assemble the lockers needed to fit on each individual Starter or Extension Connector. Do not assemble an entire bank of lockers, as it could become too heavy to move safely and without damage.*

Wall Configuration Installation (continued)

5. Insert the Starter Connector (18) or Extension Connector (19) Connect Tubes into the receptacle at the top and bottom of each Side Grille.
Tap the Connectors until the Connect Tubes are completely engaged with all of the Side Grilles.
6. Tighten all of the 1/4-20 x 5-1/2" Capscrews until they are snug.
Do not overtighten the Capscrews.

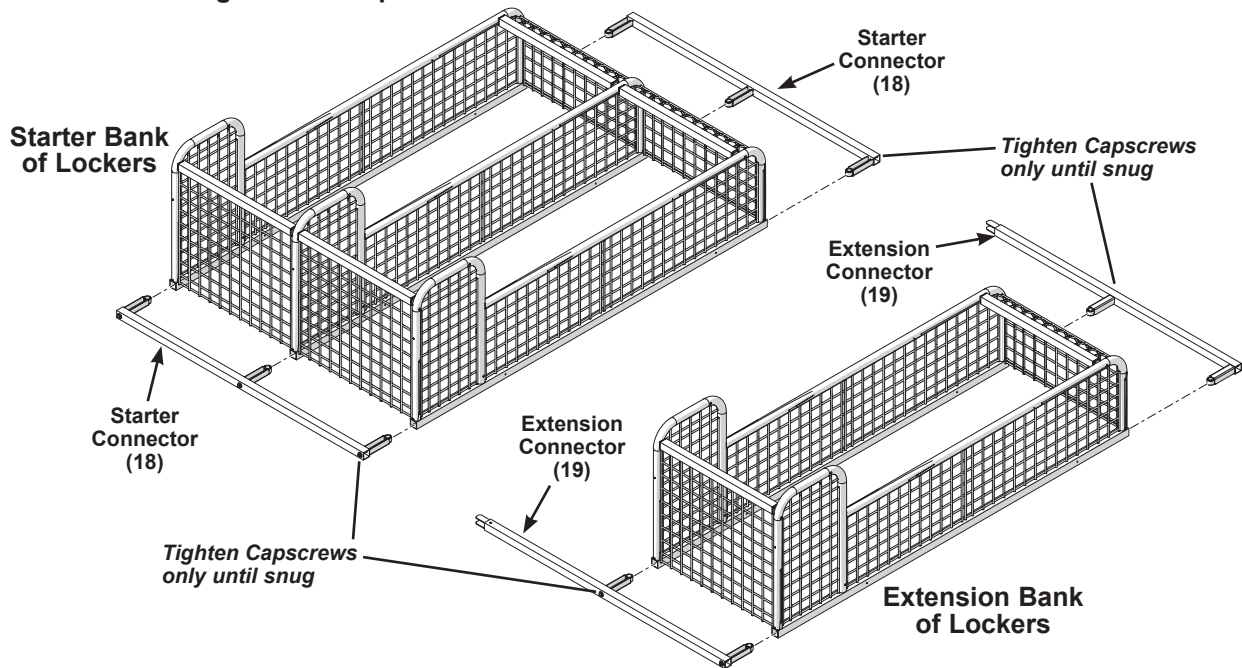

7. Attach the Wall Starter Tube (24) or Wall Front Extension Connector (25) to the bottom front of the lockers using #14 x 1-3/4" Self-Tapping Screws (7).
8. Secure the lockers together using a ratchet strap across the Bottom Grilles.
9. Assemble all of the remaining banks of extension lockers by repeating steps 2-8.

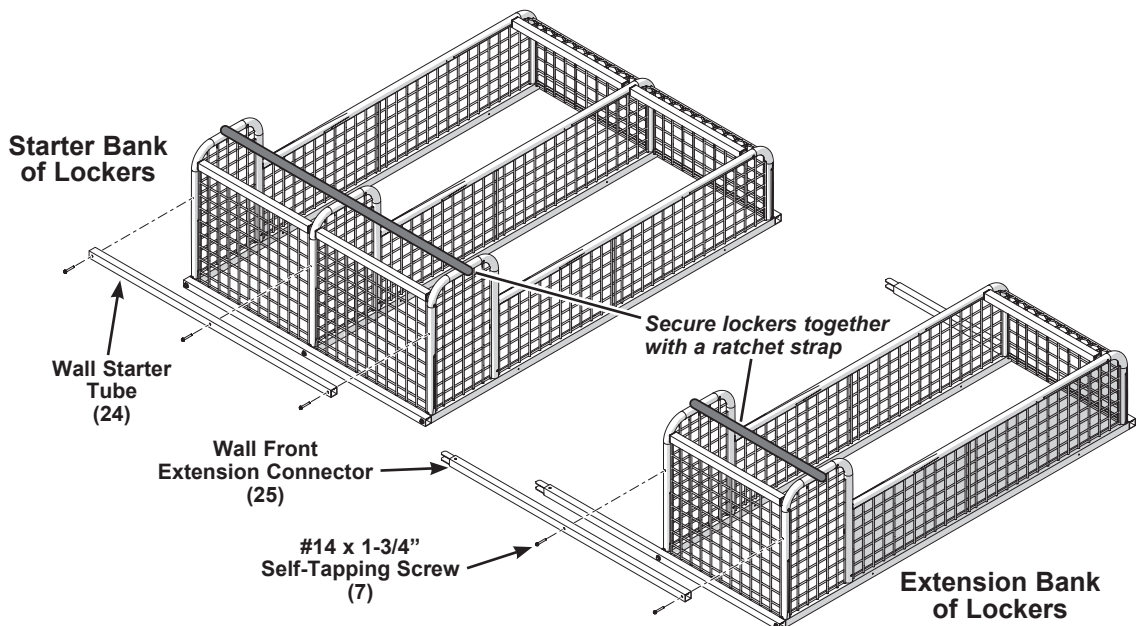

Wall Configuration Installation (continued)

10. Attach Wall Brackets (21) to the wall to support the bottom of the lockers.
 - a. See the installation drawings for Wall Bracket locations.
 - b. Measure up on the back wall 6" (152 mm) from the floor and snap a level line as a guide for the Wall Brackets.
 - c. Measure and mark the horizontal location of each Wall Bracket.
The Wall Brackets at the end of each bank must be placed 2" (51 mm) in from the outside edge of the Side Grilles to keep from interfering with the Starter and Extension Connectors.
 - d. Attach the Wall Brackets to the wall using the appropriate fasteners and method described in the "Fasteners - Not Supplied" section.

Note: The orientation of the Wall Brackets must match the detail view.

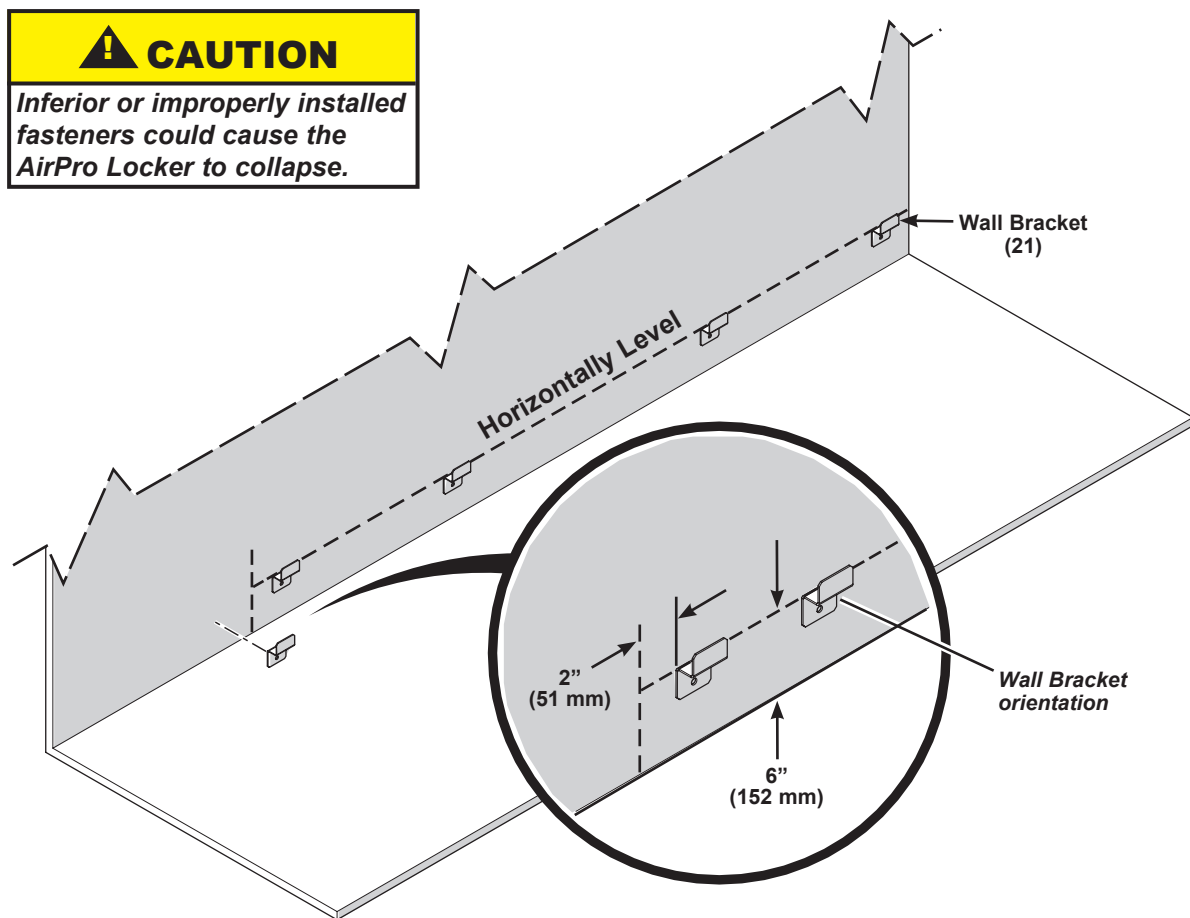

Wall Configuration Installation (continued)

- Using more than one person, tip the bank of lockers upright and lift them onto the Wall Brackets.
Lean the lockers slightly forward to tip into the brackets.



- Push the top of the lockers to be flush with the back wall and have people hold them in place.

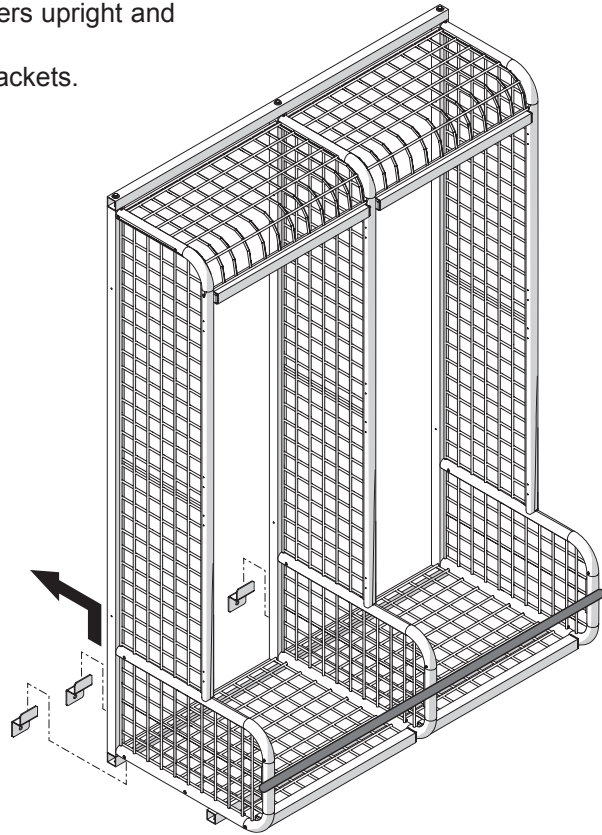

- Verify that the lockers are vertically level and attach Wall Brackets (21) to the wall to support the top of the lockers.

- Align the position of the top Wall Brackets with the position of the already attached bottom Wall Brackets.

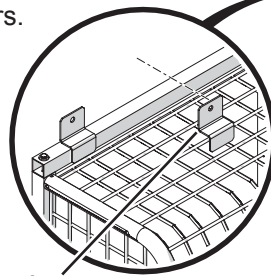

Wall Bracket
orientation

- Attach the Wall Brackets to the wall using the appropriate fasteners and method described in the "Fasteners - Not Supplied" section.

Note: The orientation of the Wall Brackets must match the detail view.

- The ratchet strap can now be removed from the bottom of the locker.

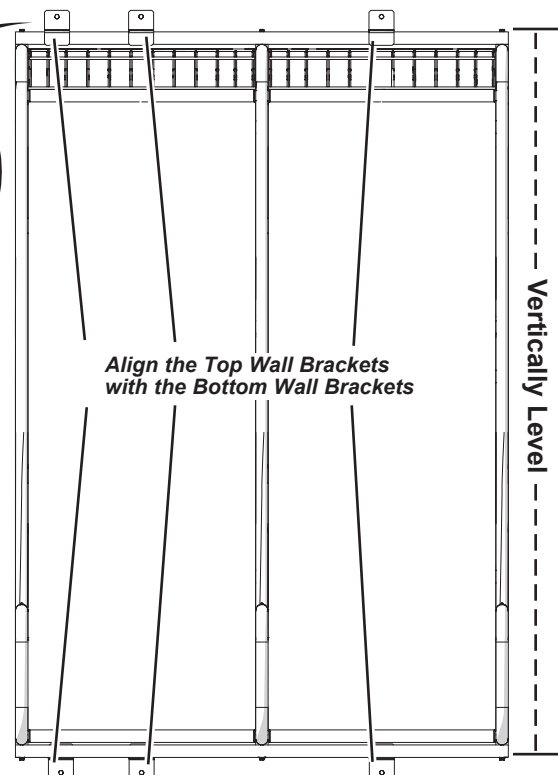

Wall Configuration Installation (continued)

15. Add any additional extension banks to the end of the starter lockers attached to the wall.

- Position one Top Grille (16) and one Seated Bottom Grille (17) on the end Wall Side Grilles (20) of the attached locker bank. Align the extended wires of the Top and Bottom Grilles with the matching holes in the Side Grille.
- Use Ratchet Clamps to temporarily hold the Top and Bottom Grilles in place.
- Using more than one person, tip the bank of lockers upright and lift them onto the Wall Brackets. Lean the lockers slightly forward to tip into the brackets.
- Push the top of the lockers to be flush with the back wall and slide the Extension Connectors to fit into the ends of the Starter Connectors and Tubes.
- Align the extended wires of the Top and Bottom Grilles with the matching holes in the Extension Side Grille.

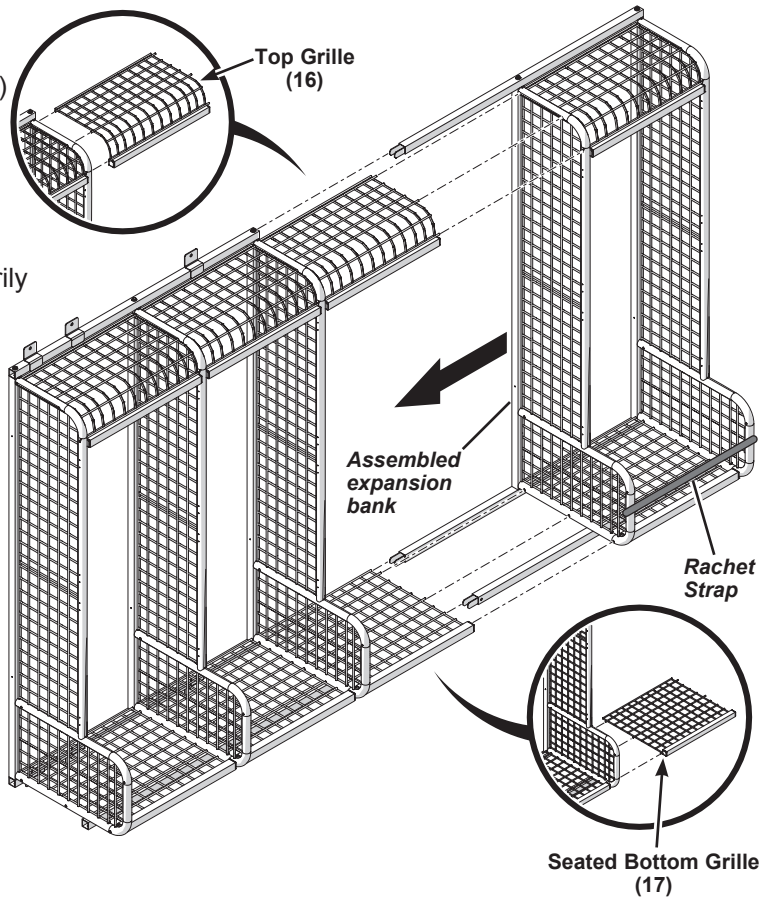

16. Attach the top Wall Brackets and remove the ratchet strap as described in steps 13-14.

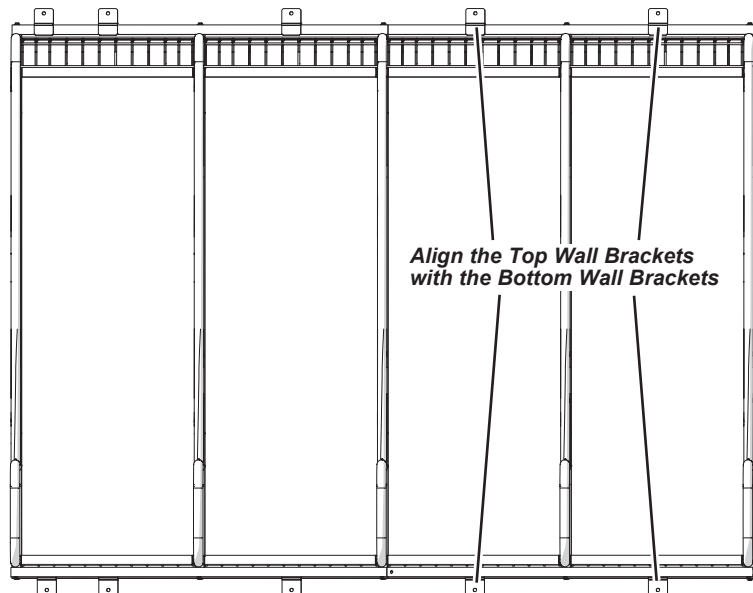

17. Screw an Adjustable Foot (22) into each of the Support Legs (23).

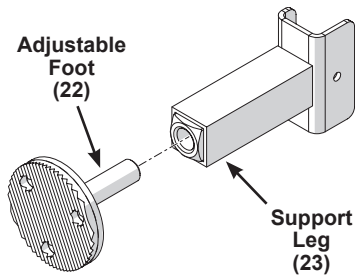

Wall Configuration Installation (continued)

18. Attach the Top Starter Connector to the Extension Connector and the Bottom Front Wall Starter Tube to the Wall Front Extension Connector using one 1/4-14 x 3/4" Self-Tapping Screw (5). Position the Screw 1" (25 mm) from the edge of the Starter Connector.
19. Attach the Support Legs to the lockers.
 - a. With the pilot hole tab facing out from the lockers, place one Support Leg at each end of the bank of lockers. Position the Support Legs to fit under the Wall Starter Tube and Front Extension Connector and to be 1" (25 mm) in from the end of the tubes.
 - b. Evenly space additional Support Legs under the bank according to the installation drawings. **Note:** The Support Legs should not be spaced more than 48" (1219 mm) apart.
 - c. Unscrew the Adjustable Feet to be tight against the floor. Mark the location of one hole on each of the feet. **Note:** Only one hole need to be marked, choose the most accessible hole.
 - d. Remove the Support Legs from the lockers and drill pilot holes into the marked floor locations.
 - e. Reposition the Support Legs back to their original position. Secure each Adjustable Foot into the floor pilot holes using the appropriate fasteners and method described in the "Fasteners - Not Supplied" section.
 - f. Attach the top of the Support Legs to the Wall Starter Tube and Front Extension Connectors using 1/4-14 x 3/4" Self-Tapping Screws (5).

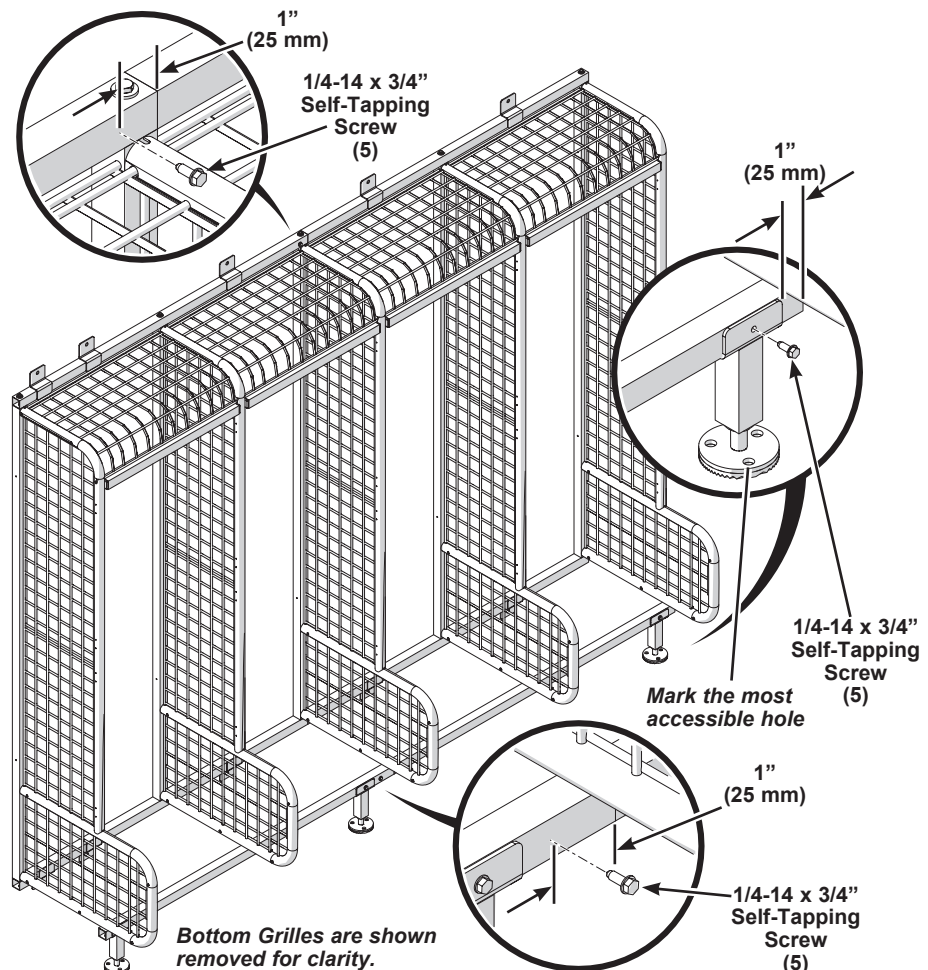

Wall Configuration Installation (continued)

20. Pound 1-1/4" Square x 14-20 Gauge Plugs (3) into the open ends of the Starter Connectors, Extension Connectors, Wall Starter Tubes and Extension Connectors.
21. Attach a GearBoss Decal (41) to the front of a Starter or Extension Connector at one end of the locker bank.

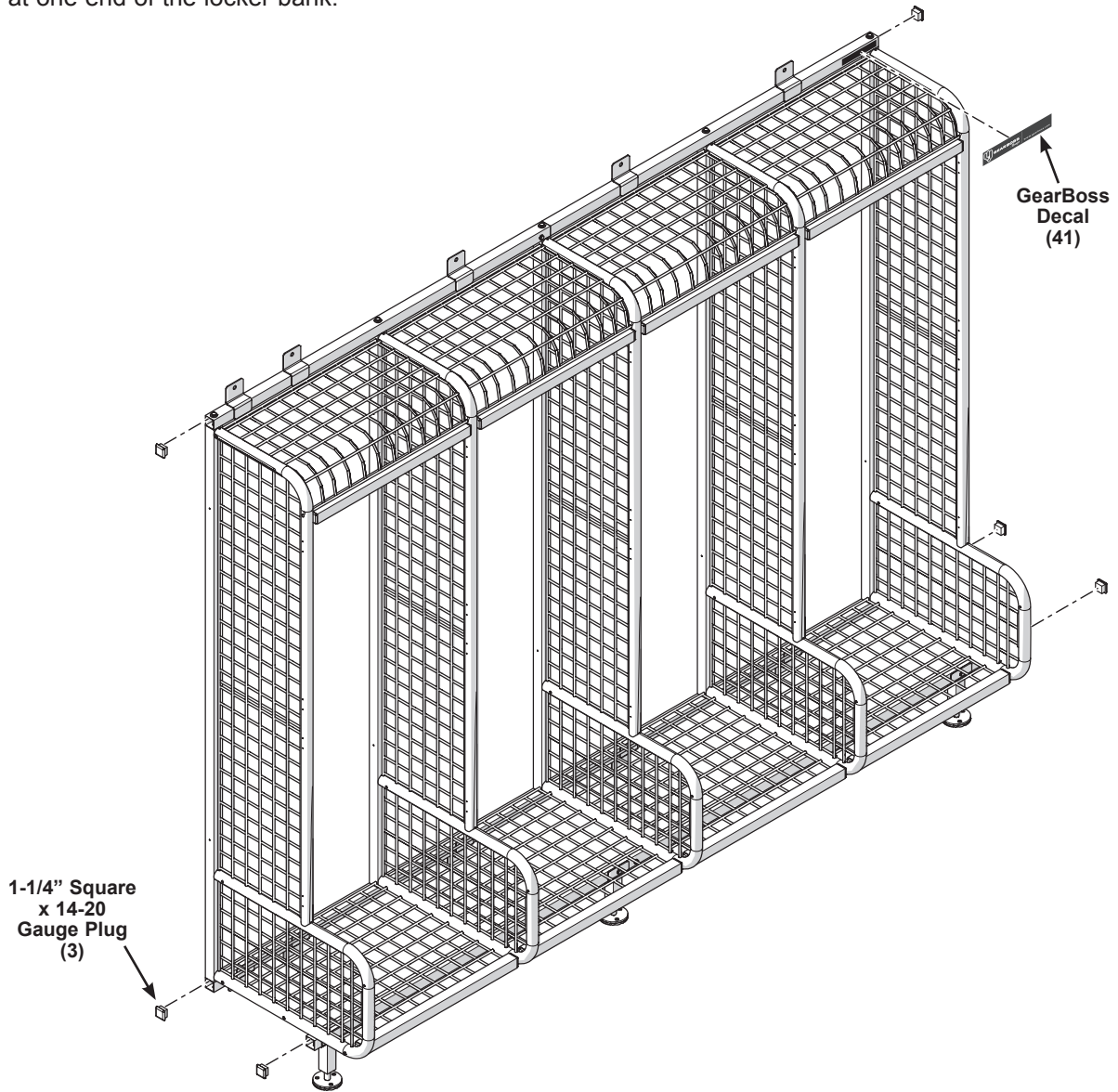

22. Install additional Island Configuration Lockers by following the steps on the following pages or skip ahead to "Final Assembly" on page 30.

Island Configuration Installation

The AirPro Lockers can be installed in either wall or island configurations. This is the procedure for installing the Island Locker Configuration! For installing the Wall Locker Configuration, go to page 13.

1. Lay all of the locker components out according to the installation drawings.
2. Lay one Island Side Grille (35) flat and fit one Back Panel (36) over the center weldment.
Align the extended wires of the Back Panel with the matching holes in the Side Grille.

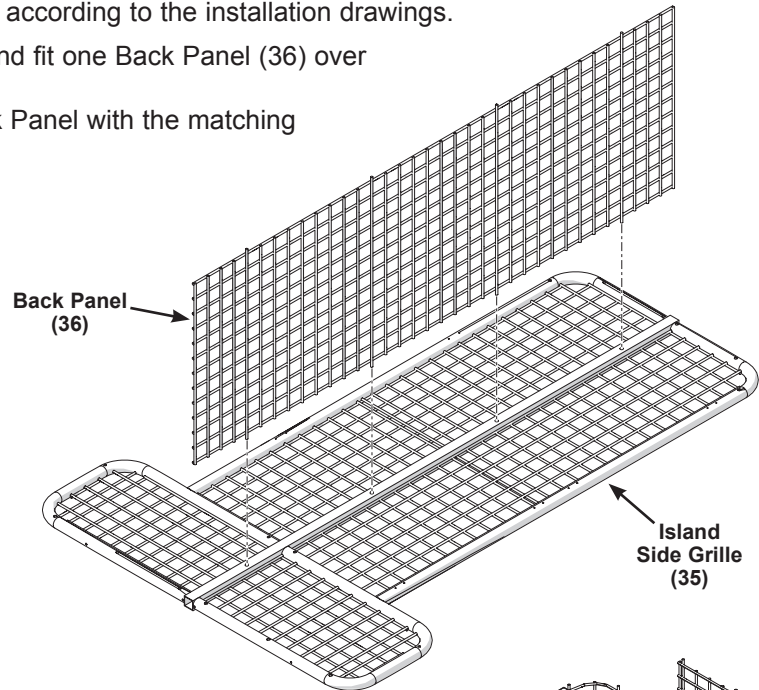

3. Build the first locker by positioning two Top Grilles (16) and two Bottom Grilles (17) on both sides of the Back Panel.

Align the extended wires of the Top and Bottom Grilles with the matching holes in the Side Grille.

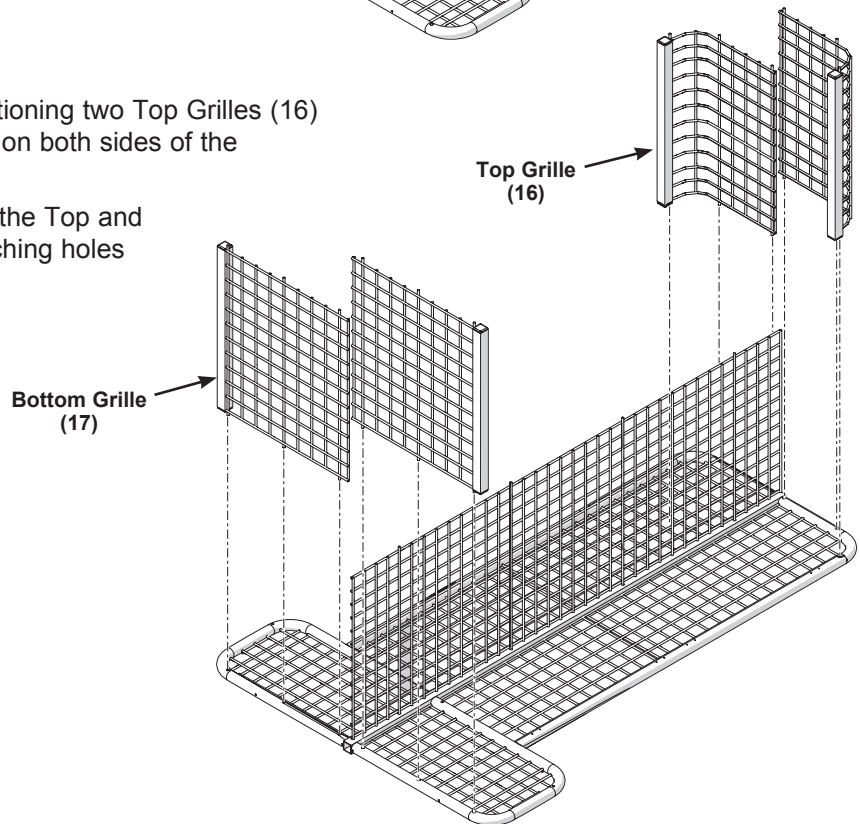

Island Configuration Installation (continued)

4. Use ratchet clamps to temporarily hold the Top, Bottom and Back Grilles together.
5. Place another Island Side Grille (35) onto the Top Grilles, Bottom Grilles and Back Panel.

Align the holes in the Side Grille with the extended wires of the Top, Bottom and Back Grilles.

Secure together with ratchet clamps

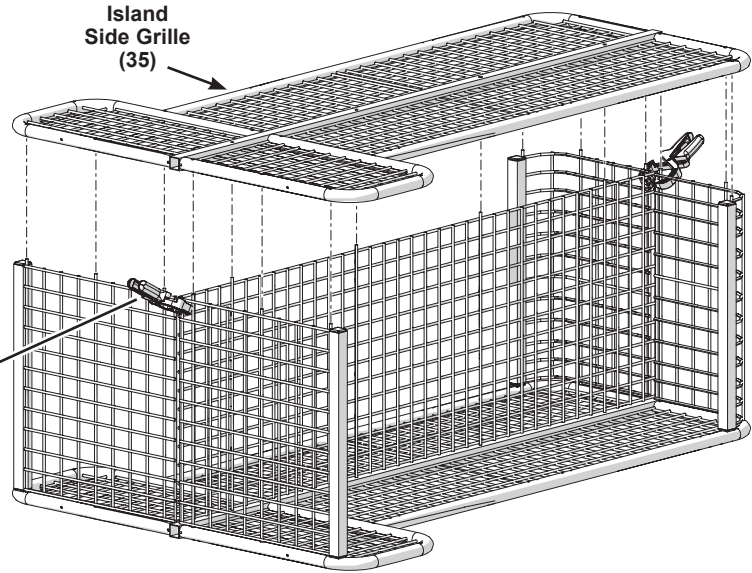

6. Build the remaining lockers for this bank off of the just assembled locker depending on the configuration as indicated in the installation drawings.

Repeat steps 2-5 using additional Top Grilles, Bottom Grilles and Back Panel to build the next locker off of the Side Grille from the already assembled locker.

IMPORTANT:

Only assemble the lockers needed to fit on each individual Starter or Extension Connector.

Do not assemble an entire bank of lockers, as it could become too heavy to move safely and without damage.

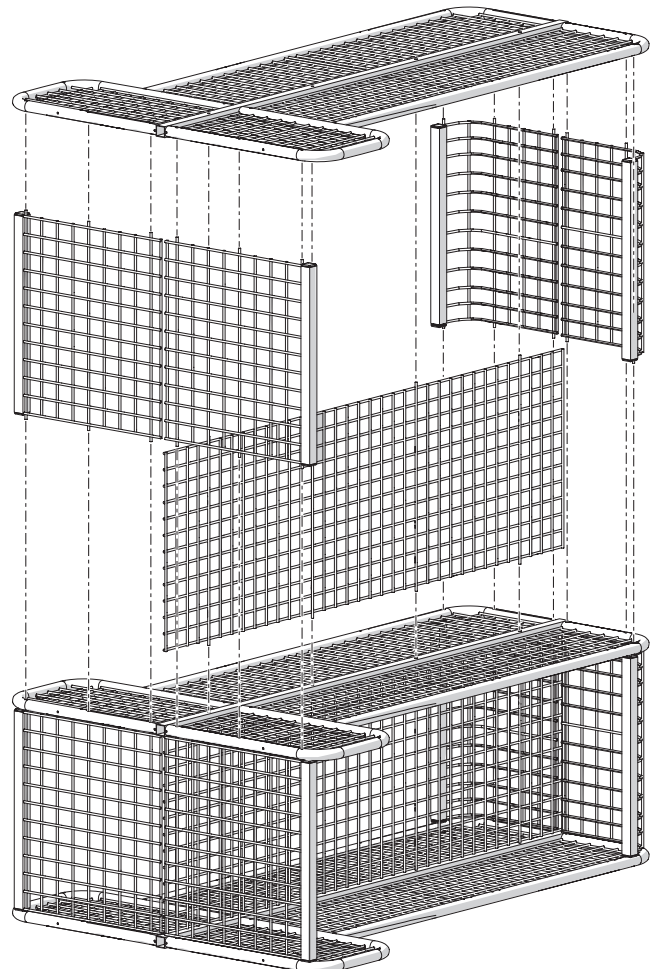

Island Configuration Installation (continued)

7. Insert the Starter Connector (18) or Extension Connector (19) Connect Tubes into the receptacle at the top of each Side Grille.
Tap the Connectors until the Connect Tubes are completely engaged with all of the Side Grilles.
8. Tighten all of the 1/4-20 x 5-1/2" Capscrews until they are snug.
Do not overtighten the Capscrews.

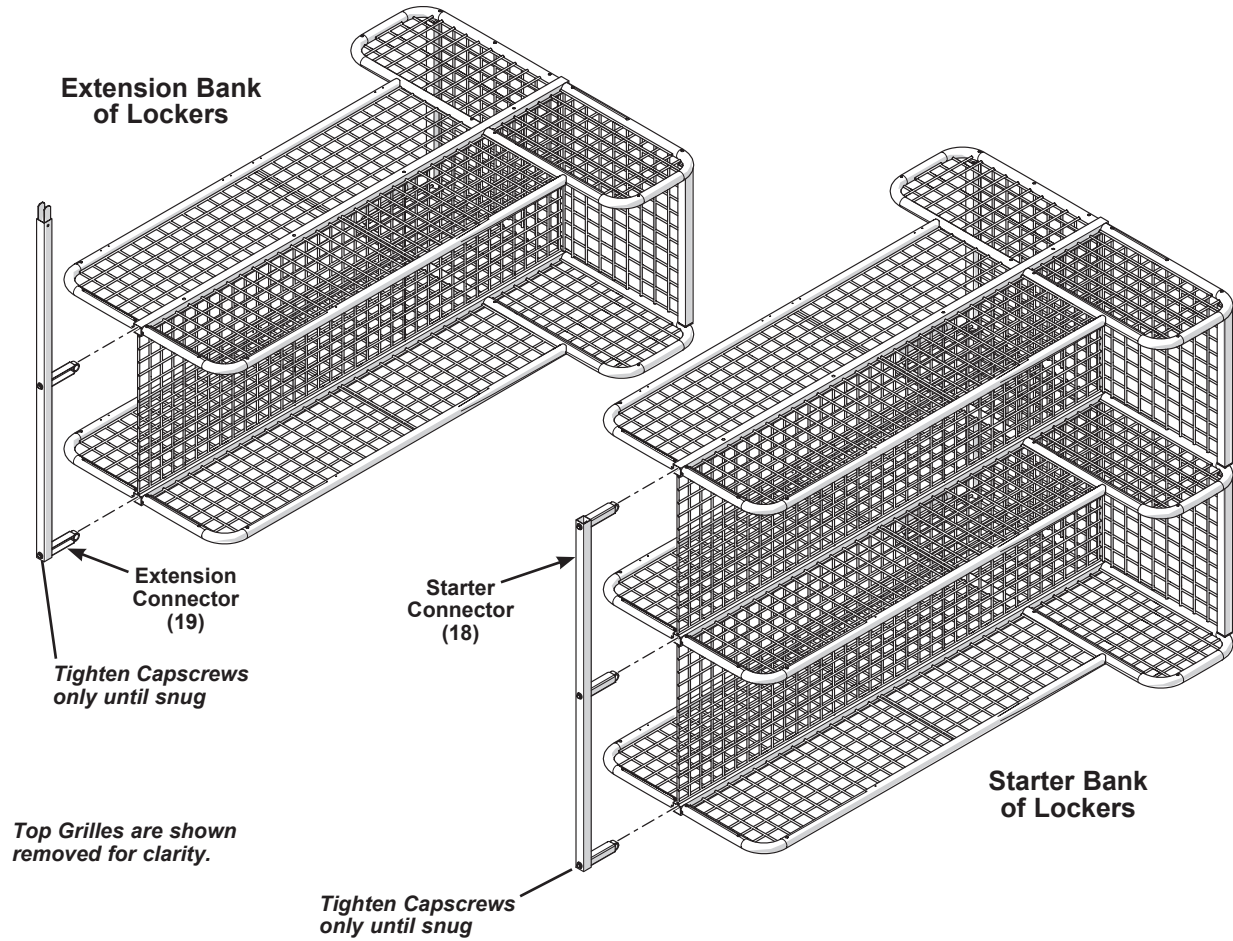

Island Configuration Installation (continued)

9. Insert the Base Starter (37) or Base Extension (38) Connect Tubes into the receptacle at the bottom of each Side Grille.
Tap the Connectors until the Connect Tubes are completely engaged with all of the Side Grilles.
10. Attach the Base to the Side Grilles using #14 x 1-3/4" Self-Tapping Screws (7) in the front and back.
11. Tighten all of the 1/4-20 x 5-1/2" Capscrews until they are snug.
Do not overtighten the Capscrews.

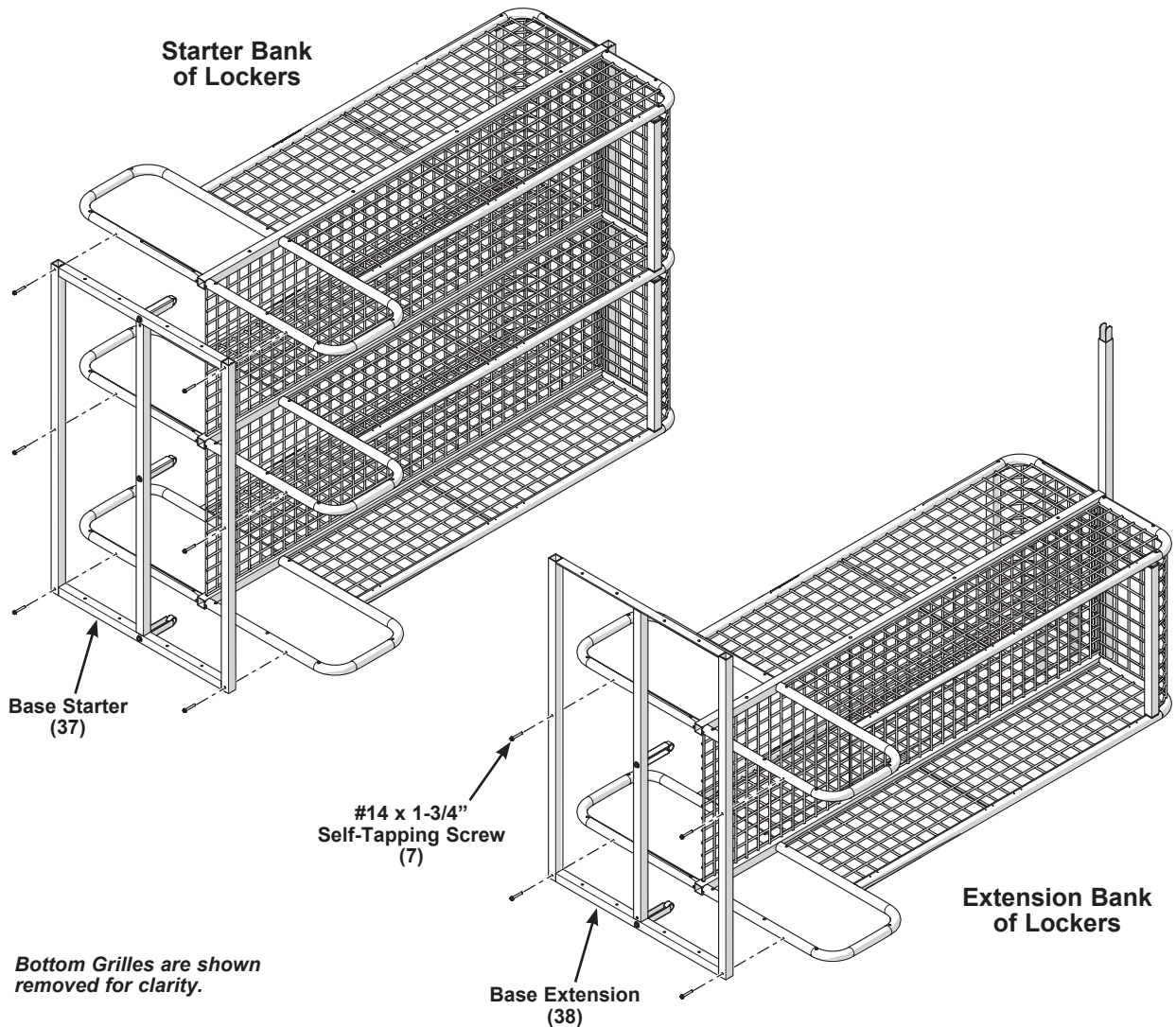

Island Configuration Installation (continued)

12. Screw an Adjustable Foot (22) into each of the Support Legs (23).

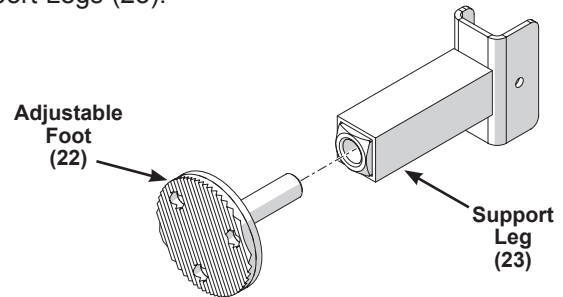

13. Attach the Support Legs to the lockers.

- a. With the pilot hole tab facing out from the lockers, position four Support Legs to be 1" (25 mm) in from the each end of the base.
- b. Attach the top of the Support Legs to the Base using 1/4-14 x 3/4" Self-Tapping Screws (5).
- b. Evenly space and attach additional Support Legs under the bank according to the installation drawings.

Note: The Support Legs should not be spaced more than 48" (1219 mm) apart.

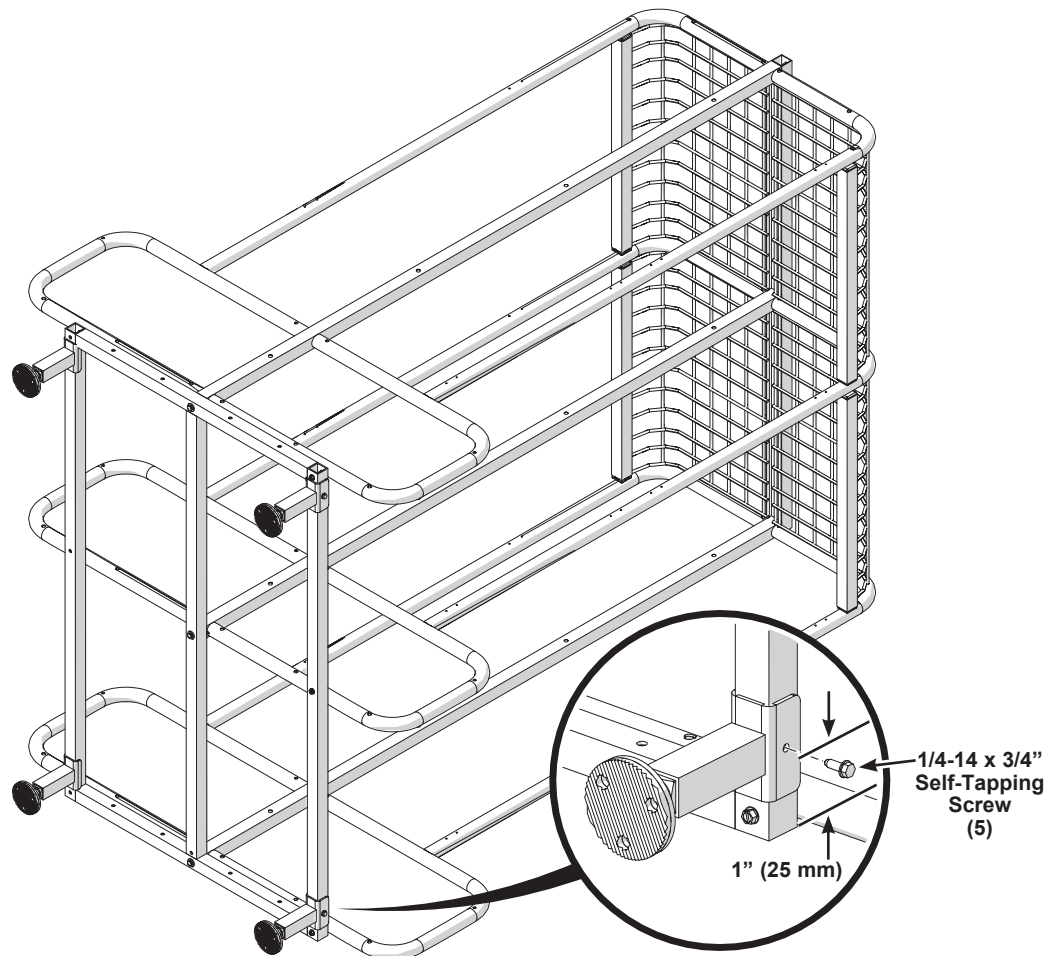

Wire Grids and Bottom Grilles are shown removed for clarity.

Island Configuration Installation (continued)

14. Using more than one person, lift the bank of lockers upright and onto the installation location.

Note: Be careful not to apply too much sideways force on the support legs.



15. Assemble all of the remaining banks of extension lockers by repeating steps 2-14.
16. Attach the Support Legs of the starter bank of lockers to the floor.
- With the locker in its installation location, unscrew the Adjustable Feet to level the lockers and set the height from the floor. Mark the location of one hole on each of the feet.
Note: Only one hole need to be marked, choose the most accessible hole.
 - Move the locker to allow access to the marked locations.
 - Drill pilot holes into the marked floor locations.
 - Move the locker back to its installation location.
 - Secure each Adjustable Foot into the floor pilot holes using the appropriate fasteners and method described in the "Fasteners - Not Supplied" section.

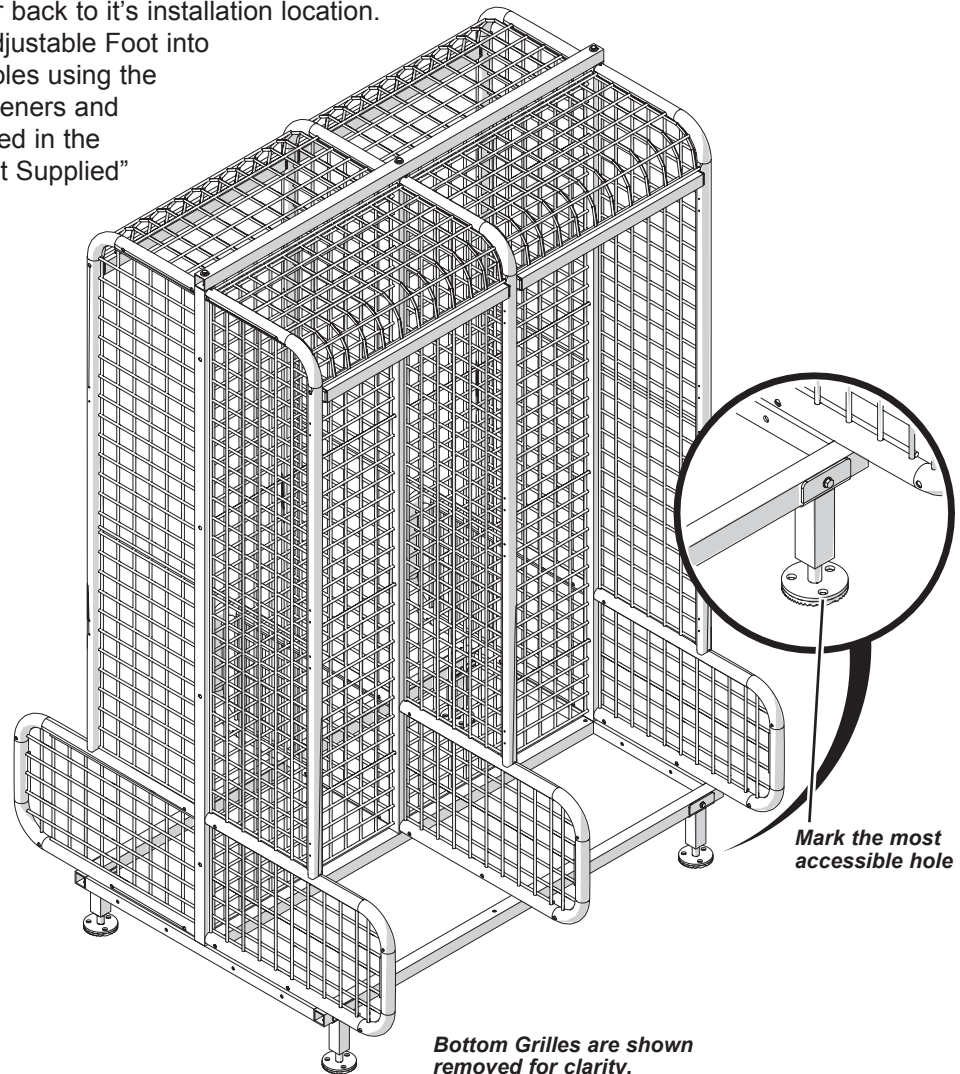

Island Configuration Installation (continued)

17. Add any additional extension banks to the end of the starter lockers attached to the wall.
 - a. Position two Top Grilles (16), two Bottom Grilles (17) and one Back Panel (36) on the end of the Island Side Grille (35) of the attached locker bank. Align the extended wires with the matching holes in the Side Panel.
 - b. Use Ratchet Clamps to temporarily hold them in place.

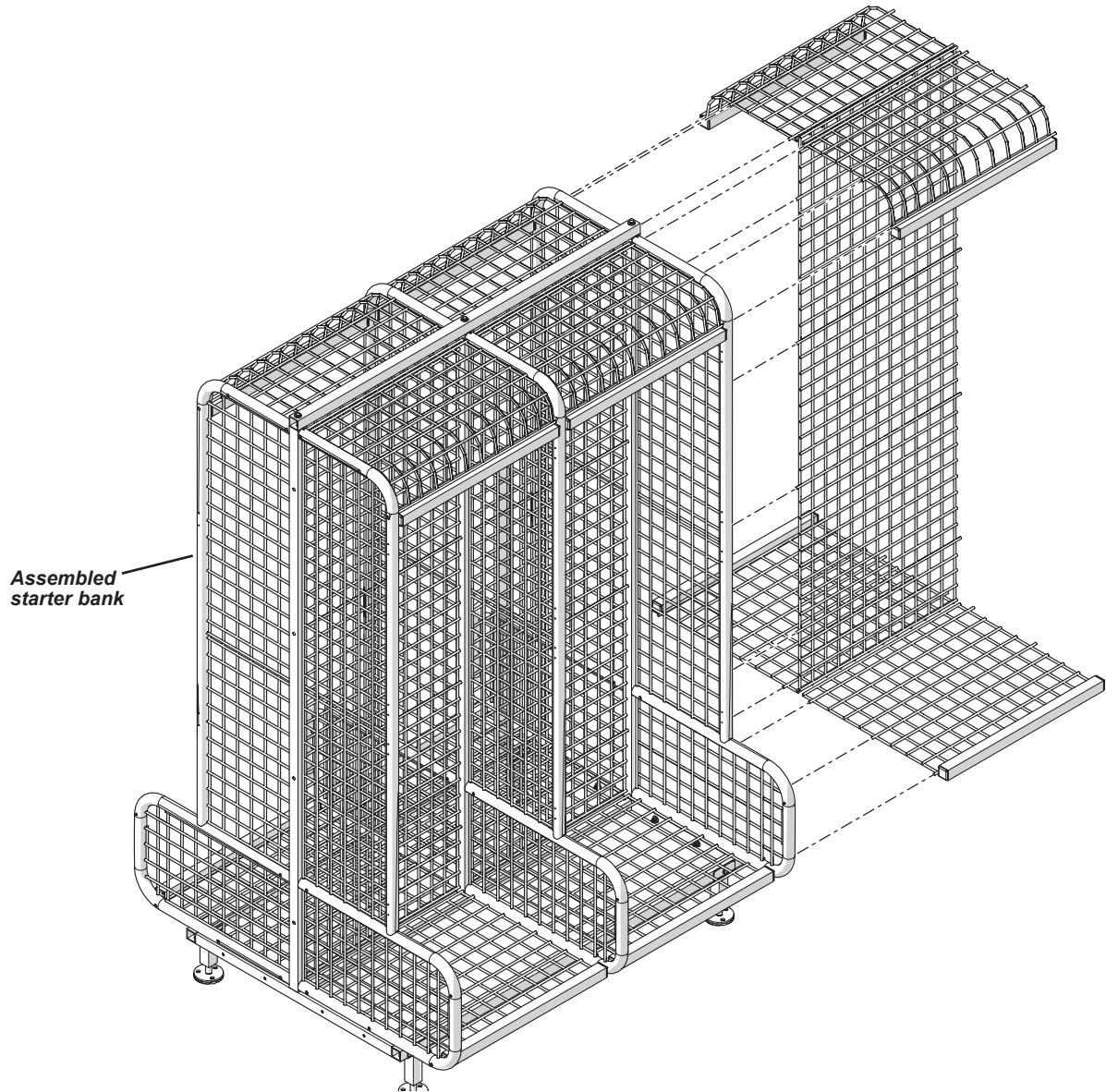

Island Configuration Installation (continued)

- c. Using more than one person, position the bank of extension lockers to align flush with the starter lockers.
- d. Align the extended wires of the Top Grilles, Bottom Grilles and Back Panel with the matching holes in the Extension Side Panel.
- e. Connect the Base Extension to the Base Starter using two 1/4-20 x 2" Capscrews (13), 1/4 Dia x 0.734" Flat Washers (6) and 1/4-20 Lock Nuts (12).

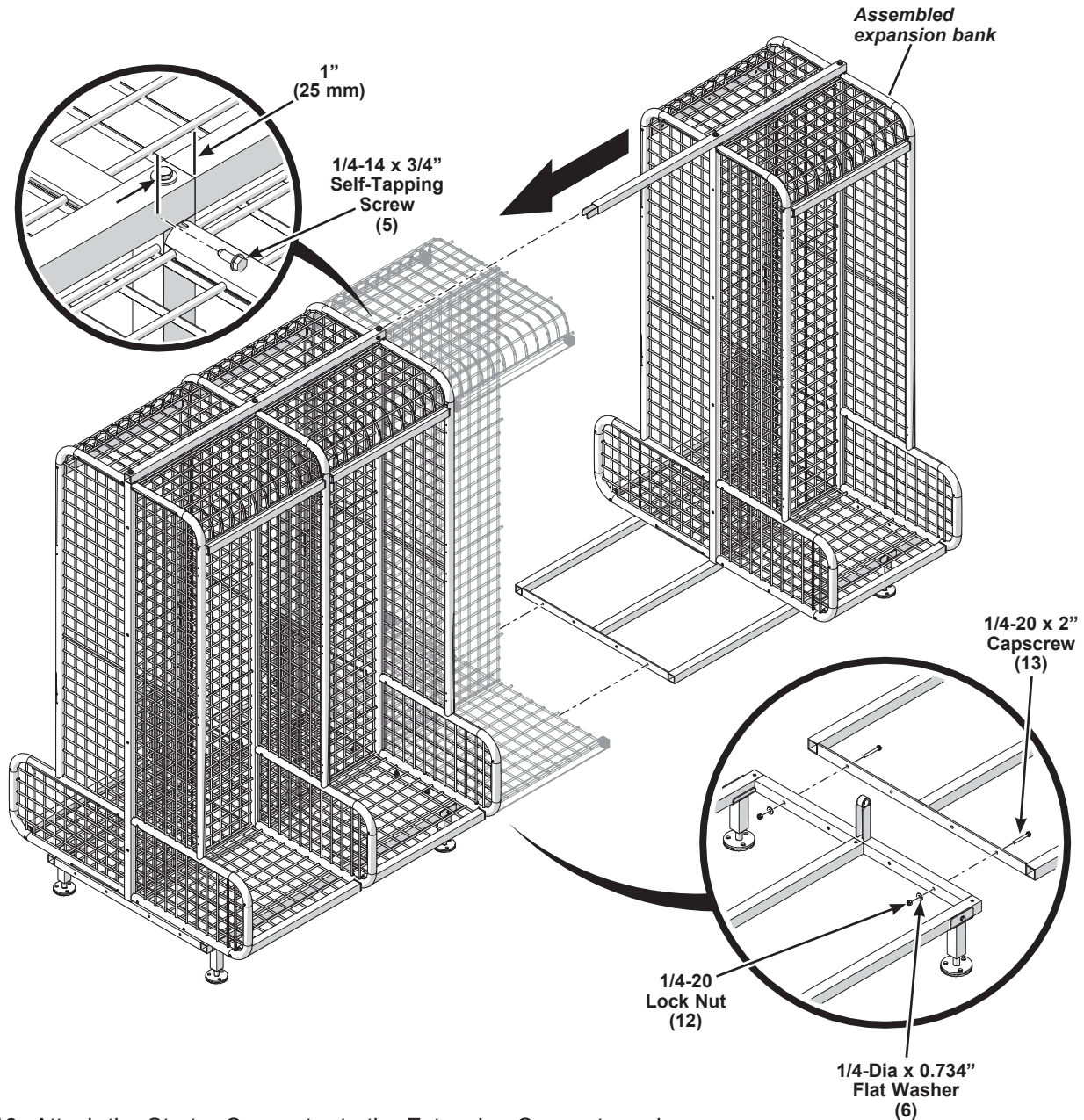

18. Attach the Starter Connector to the Extension Connector using one 1/4-14 x 3/4" Self-Tapping Screw (5). Position the Screw 1" (25 mm) from the edge of the Starter Connector.
19. Attach the Support Legs of the expansion bank of lockers to the floor. Use the same procedure as described for the starter bank in step 16.

Island Configuration Installation (continued)

20. Pound 1-1/4" Square x 14-20 Gauge Plugs (3) into the open ends of the Starter Connectors and Extension Connectors.
21. Pound 1-1/4" Square x 10-14 Gauge Plugs (4) into the open ends of the Base Starters and Base Extensions.
22. Attach a GearBoss Decal (41) to the front of a Starter or Extension Connector at one end of the locker bank.

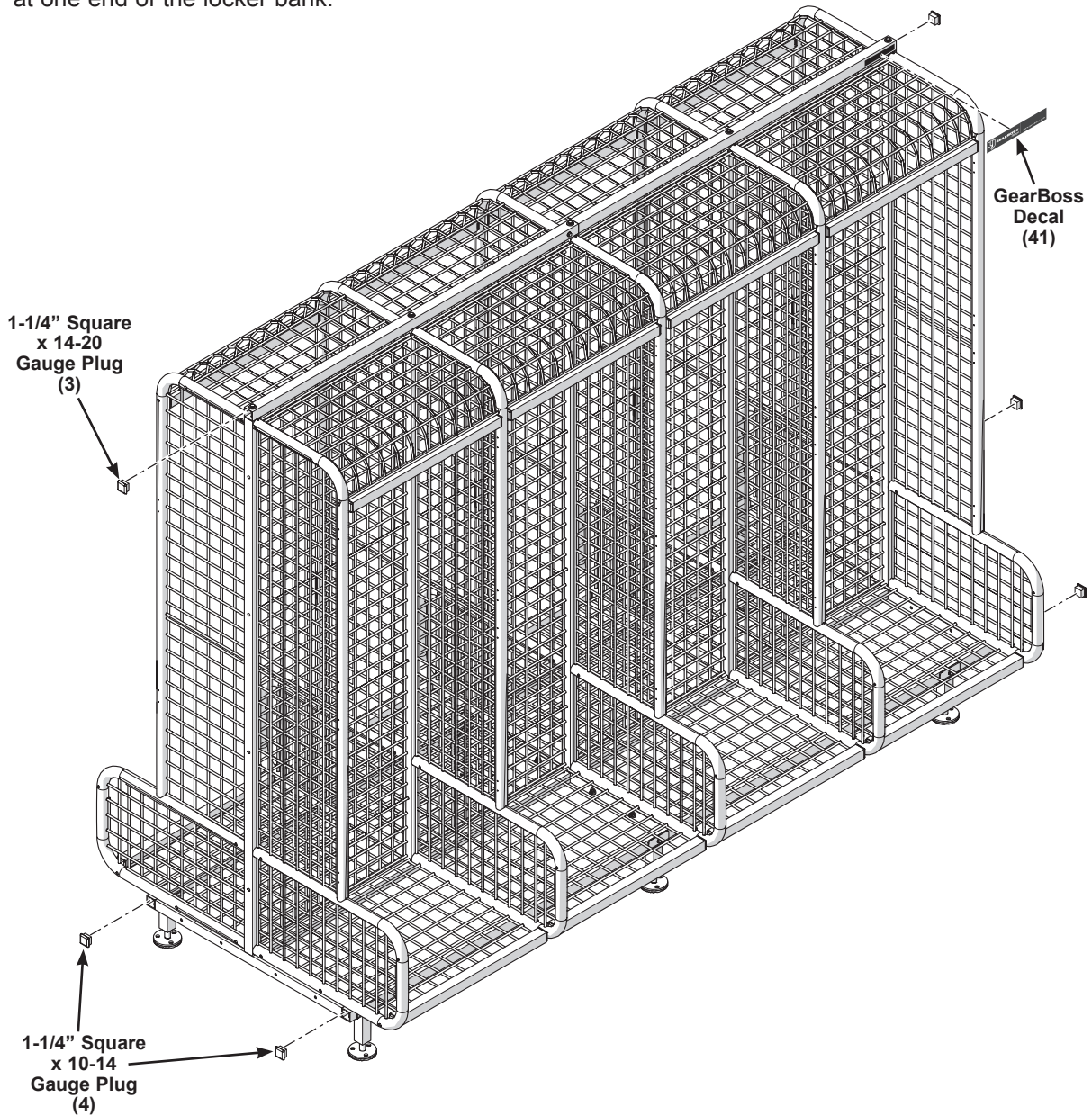

23. Install additional Island Configuration Lockers by following the steps on the following pages or skip ahead to "Final Assembly" on page 30.

Final Assembly

This procedure applies to both Wall and Island Locker Configurations.
A single wall locker is shown for clarity but the procedure is similar for all configurations.

Steps 1-6 apply to Seated Lockers only.

If installing Non-Seated Lockers, skip ahead to step 8.

1. Push or tap six 1/4-20 Insert Nuts (8) into the top side of all Seat Panels (29).

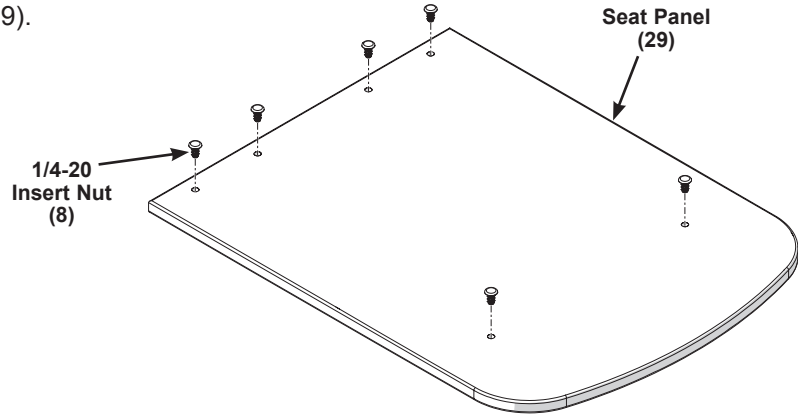

2. On the opposite side of the Seat Panels, loosely attach one Seat Hinge (30) to the bottom-right using two 1/4-20 x .708 Machine Screws (9) into the previously installed Insert Nuts.

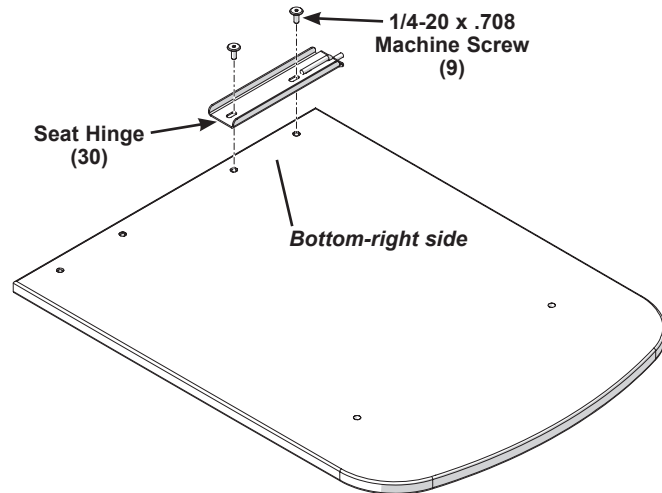

3. Push a 3/4 x 1-1/2" Rib Plug (14) into the opening at both ends of the Seat Support Weldment (31).

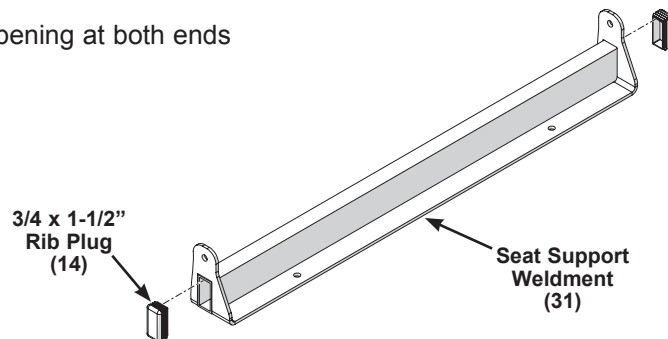

Final Assembly (continued)

4. Attach the Seat Support Weldment (31) to the front of the Seat Panel using two 1/4-20 x .708 Machine Screws (9).

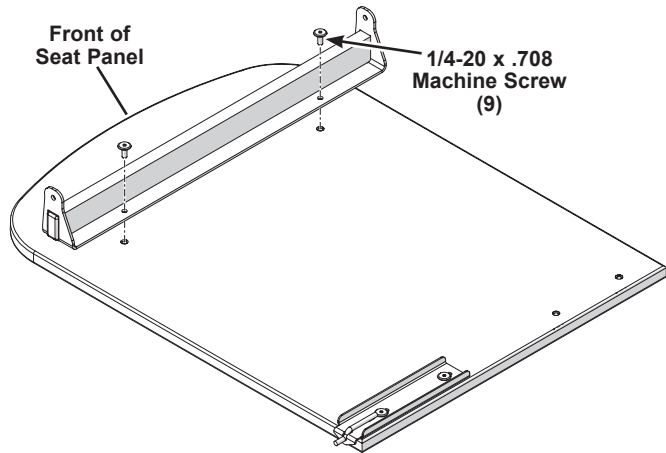

5. In each Locker, attach a Seat Panel.
 - a. Fit the post on the Seat Hinge (30) into the hole on the inner side of the Left Wall Side Grille.
 - b. On the opposite side, fit the post on a Seat Hinge into the hole on the inner side of the Right Wall Side Grille and loosely attach it to the Seat Panel using two 1/4-20 x .708 Machine Screws (9) into the previously installed Insert Nuts.

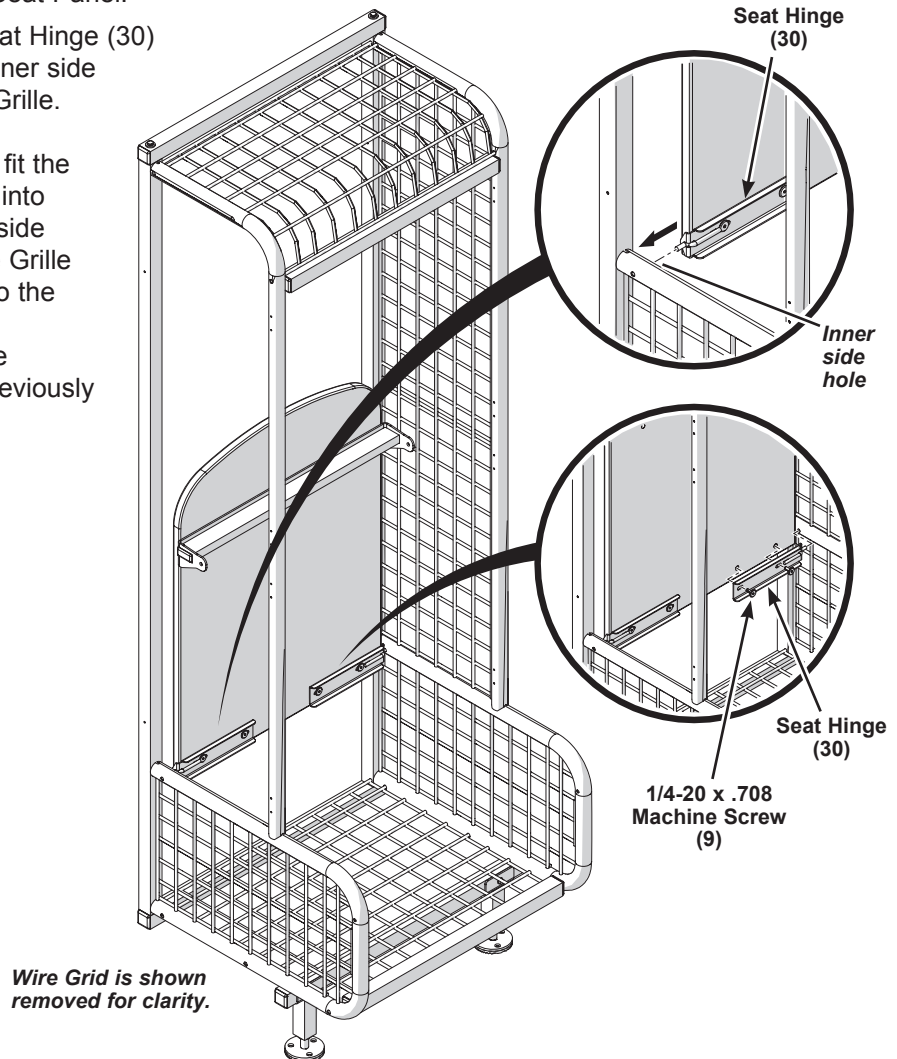

Final Assembly (continued)

6. Center and tighten the Seat Panel.
 - a. Tip the Seat Panel down to close it and center it to fit evenly between the Side Grilles.
 - b. Holding that position, raise the Seat Panel and secure it to the Seat Hinges by tightening the attached Machine Screws.

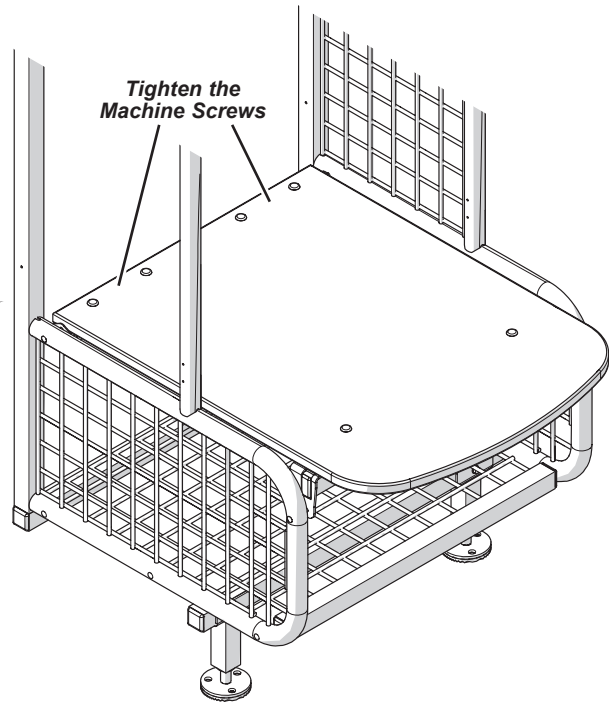
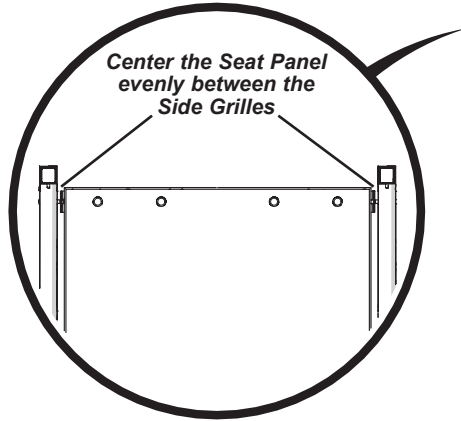

Wire Grid is shown removed for clarity.

7. Close the Seat Panel and attach the Seat Support Weldment to the Side Grilles using one 1/4-20 x .708 Machine Screw (9) on each side.

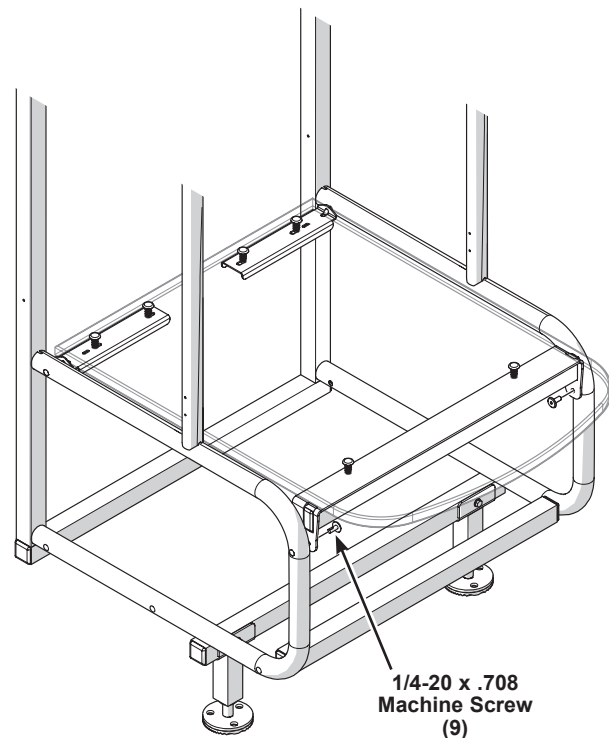

Final Assembly (continued)

If installing Optional Back Panels, stop here and skip ahead to “Optional Back Panel Installation” on page 47 before proceeding.

8. Attach Double Tier Side Hook Brackets (32) and Shelf Side Hook Brackets (26) to the lockers.

Note: Desired bracket placement may vary.

Verify that the Shelf Panel will fit the location if doors will be installed.

- a. At a common height near the top, attach Double Tier Side Hook Brackets (32) back-to-back on the inside of the lockers. On the ends of the locker bank, attach Hook Cover Plates (27).
- b. At the top of the double horizontal grille wire, attach Shelf Side Hook Brackets (26) back-to-back on the inside of the lockers. On the ends of the locker bank, attach Hook Cover Plates (27).
- c. Secure the Hook Brackets and Cover Plates using three 1/4-20 x .708 Machine Screws (9) and 1/4-20 Cap Nuts (10).

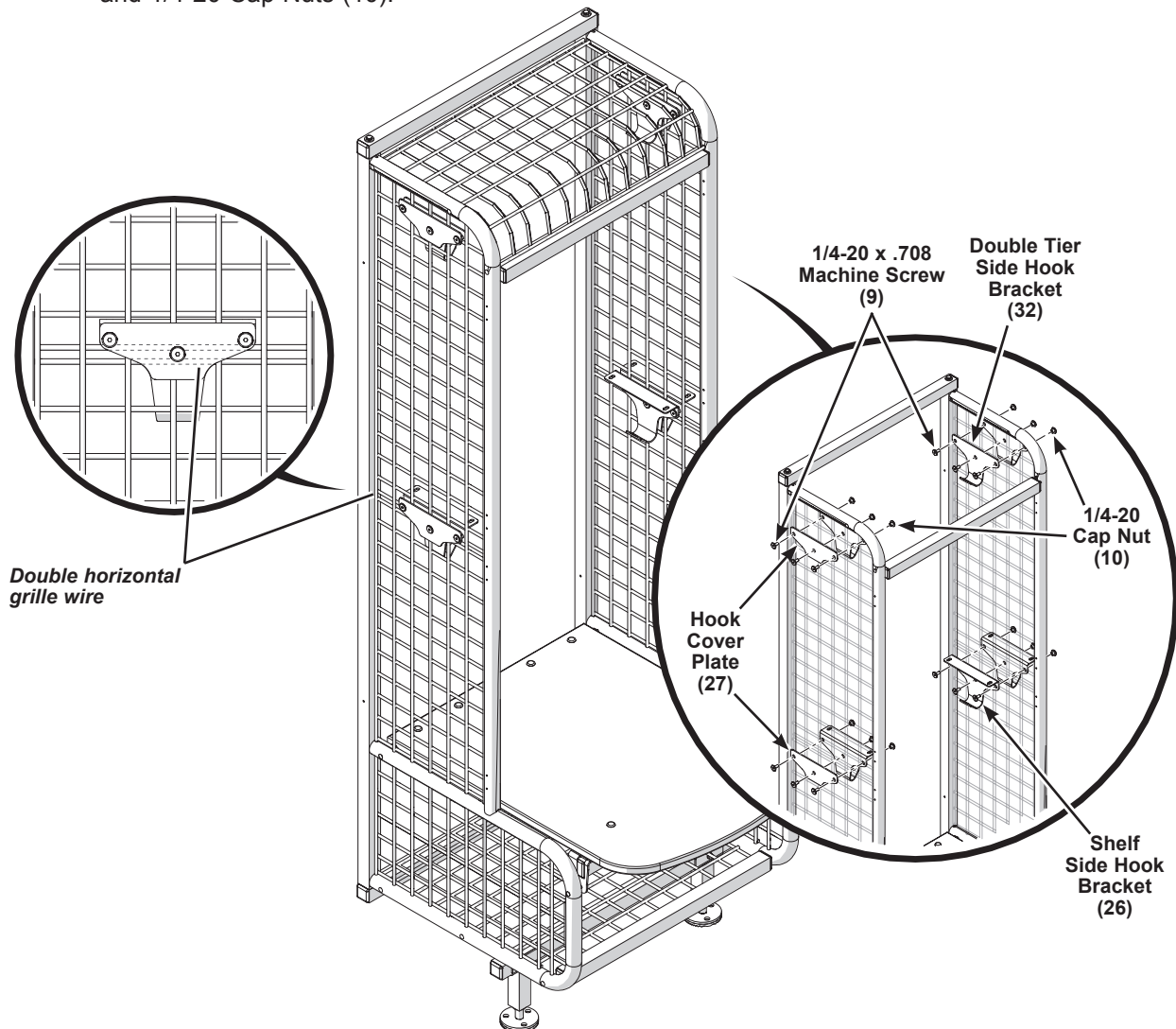

Final Assembly (continued)

9. Pound four 1/4-20 Insert Nuts (8) into either side of all Shelf Panels (28).

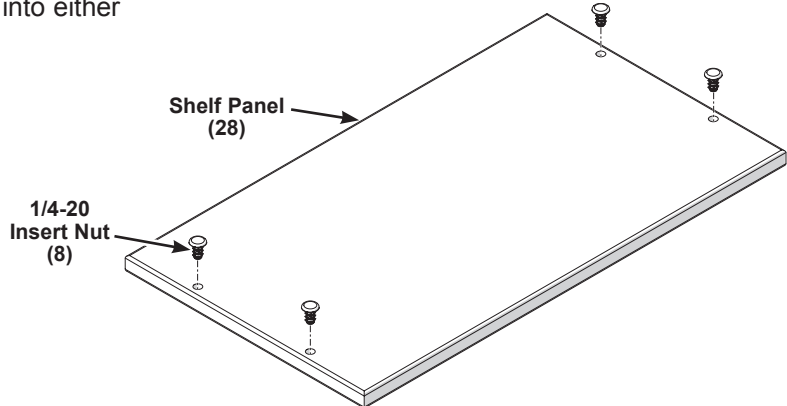

10. In each Locker, place a Shelf Panel (Insert Nut side up) onto the Shelf Side Hook Brackets.

Attach each side of the Shelf Panel using two 1/4-20 x .708 Machine Screws (11) into the previously installed Insert Nuts.

Note: Shelf Panels (28) used with Wall Configurations are deeper than Shelf Panels used with Island Configurations.

Shelf Panel depths
Wall Mount without Back Panel – 13.75" (349 mm)
Wall Mount with Back Panel – 12.75" (324 mm)
Island Mount without Back Panel – 12.75" (324 mm)
Island Mount with Back Panel – 12.00" (305 mm)

1/4-20 x .708
Machine Screw
(11)

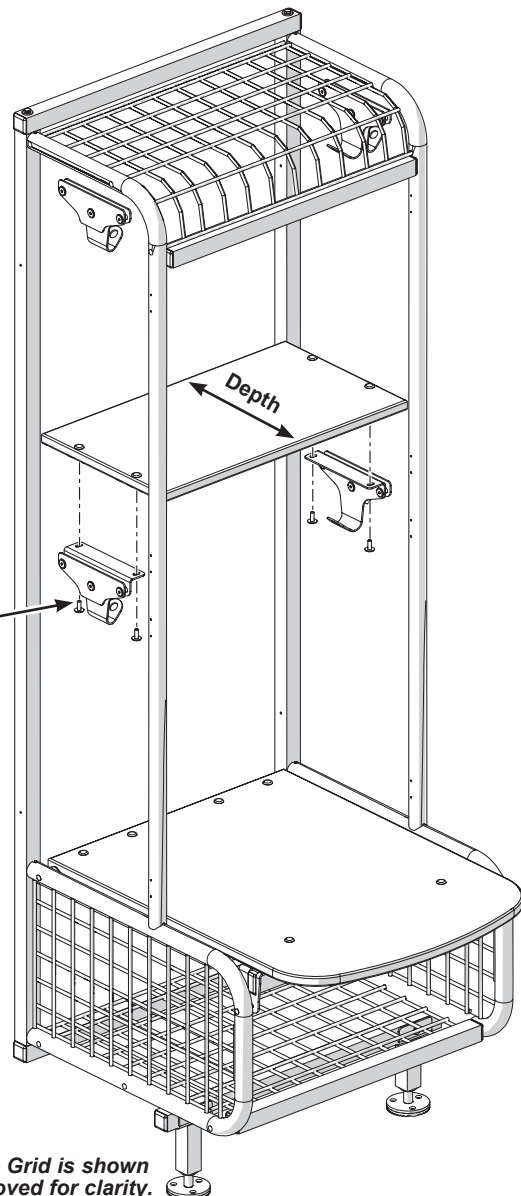

Final Assembly (continued)

11. Pound 0.312" Dia Dome Plugs (11) into all open outside-facing holes in the Side Grilles and Bases.

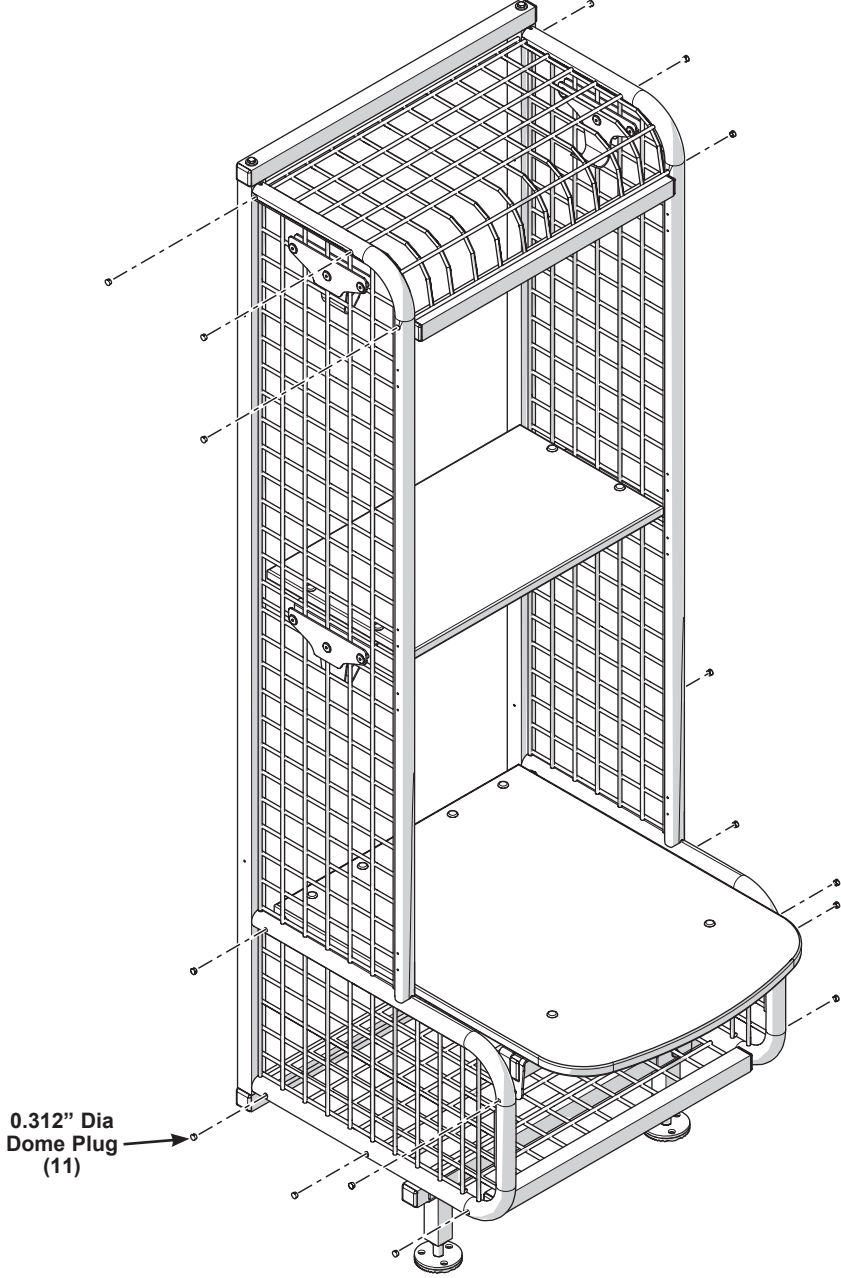

Optional Grille Door Components

Item	Description	Item	Description
12	1/4-20 Lock Nut*	45	5/16-18 Lock Nut
41	Grille Lock Bracket	46	#8-32 x 3/8" Socket Screw
42	Grille Lock Pivot Plate	47	Nameplate Weldment*
43	3/8" ID Flat Washer	48	Nameplate Plate*
44	5/16-18 x 1/4" Shoulder Bolt	49	Grill Door Assembly

*Nameplates are an additional option for doors

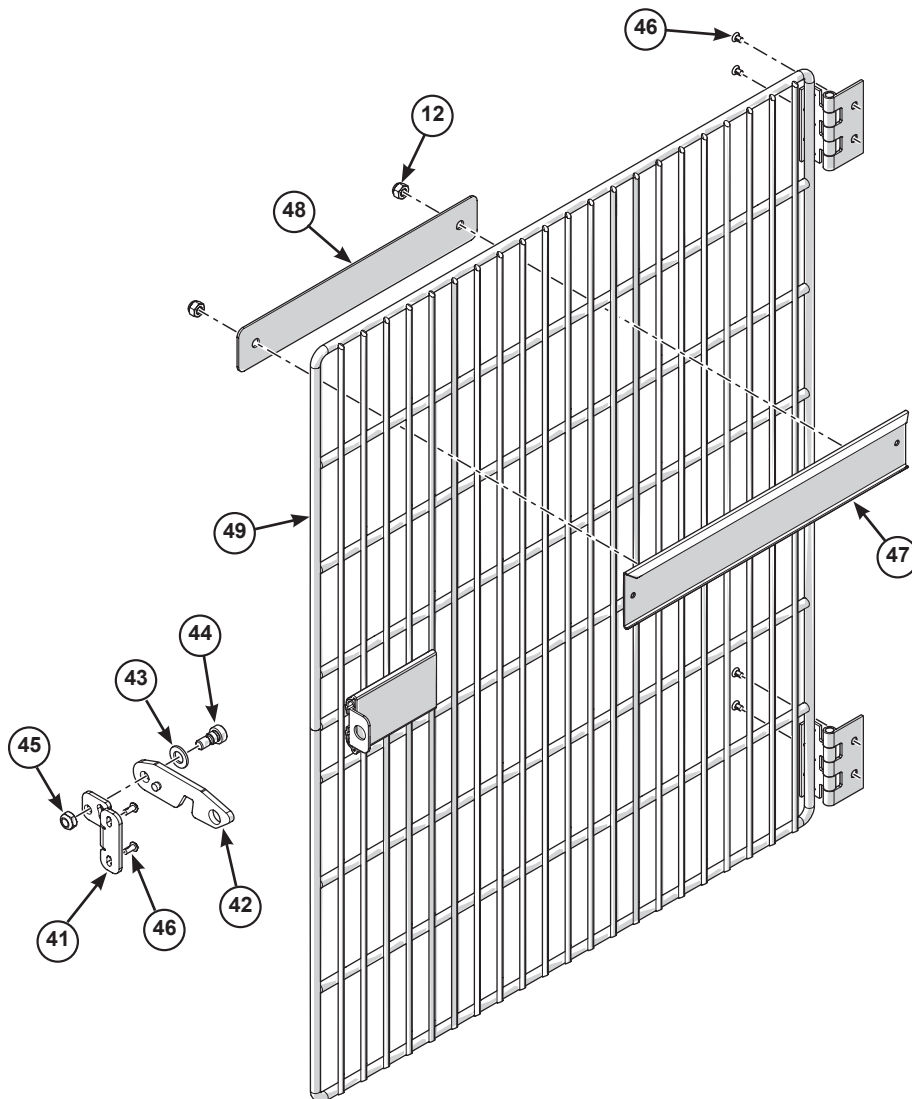

Optional Grille Door Installation

1. Assemble Door Locks for each Grille Door being installed.

- a. Attach a Grille Lock Bracket (41) to a Grille Lock Pivot Plate (42) using a 3/8" ID Flat Washer (43), 5/16-18" x 1/4" Shoulder Bolt (44) and 5/16-18 Lock Nut (45).
- b. Align the pin in the pivot plate with the slot in the bracket.

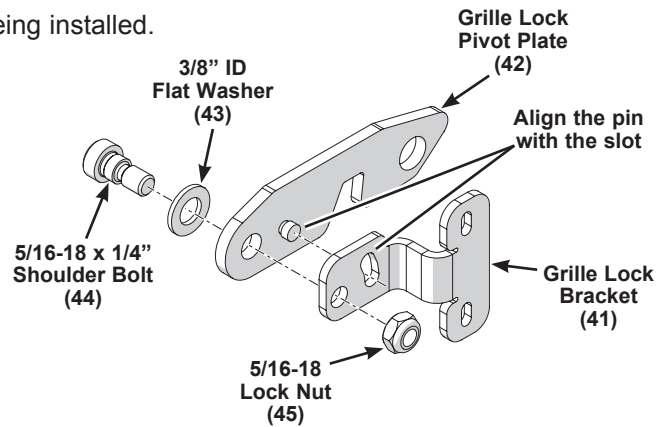

2. Attach each assembled Grille Lock to the inside of the Side Grilles using two #8-32 x 3/8" Socket Screws (46). The lock pilot holes are centered for the top and bottom compartments.

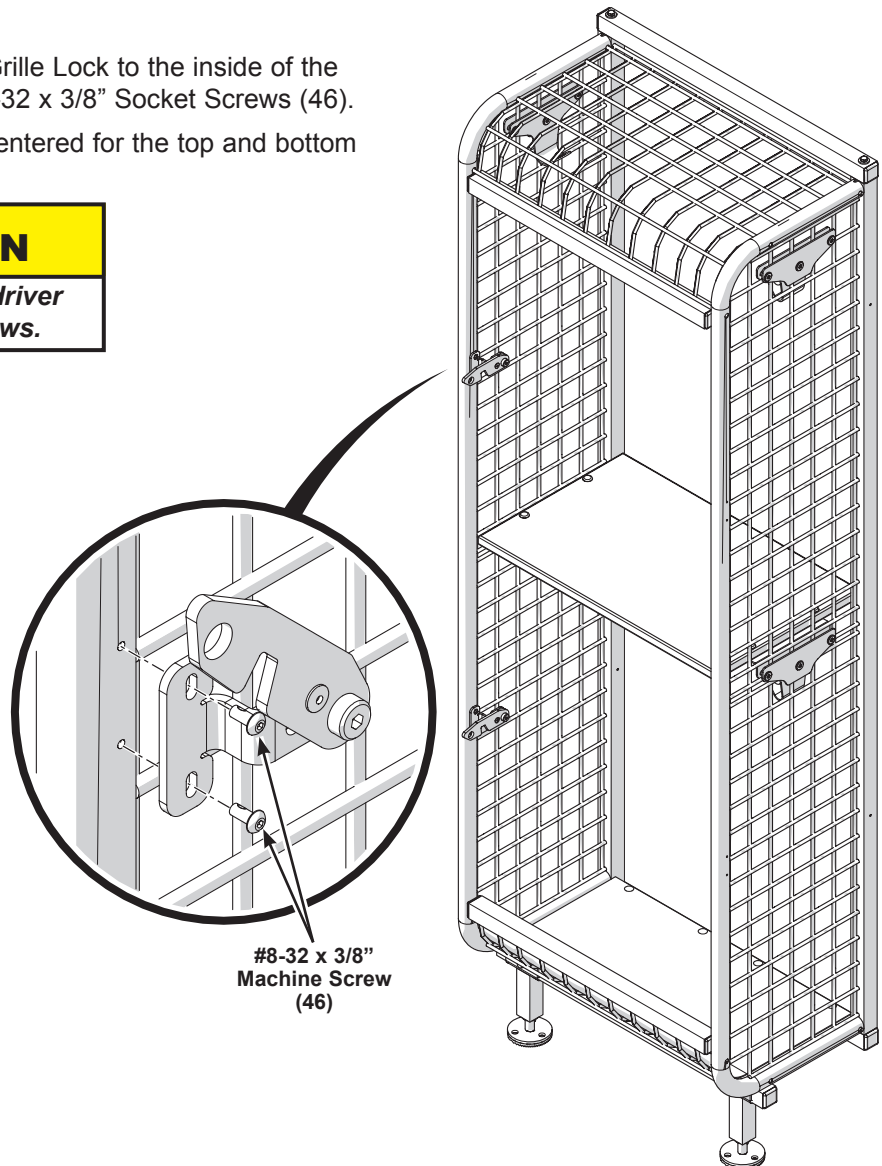

#8-32 x 3/8"
Machine Screw
(46)

Optional Grille Door Installation (continued)

3. If available, attach an optional Nameplate (47) to each Grille Door Assembly (49) using a Nameplate Plate (48) and two 1/4-20 Lock Nuts (12).

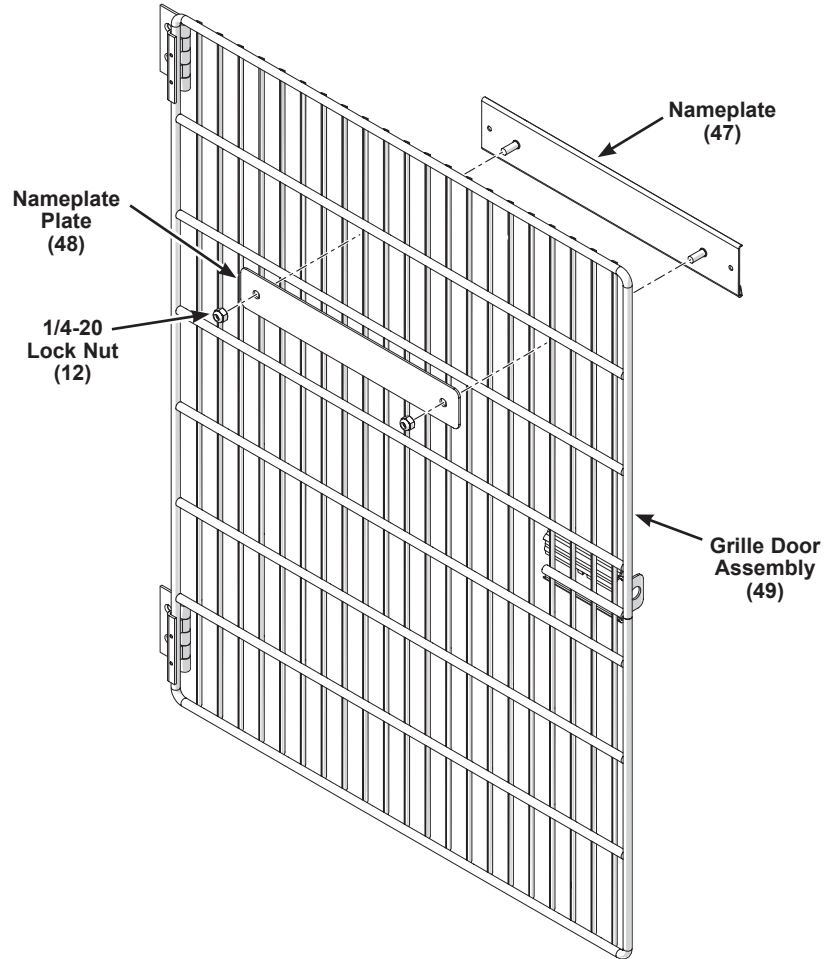

Optional Grille Door Installation (continued)

4. Attach each assembled Door to the pilot holes on the opposite Side Grille of the Door Lock using two #8-32 x 3/8" Socket Screws (46) in each hinge.

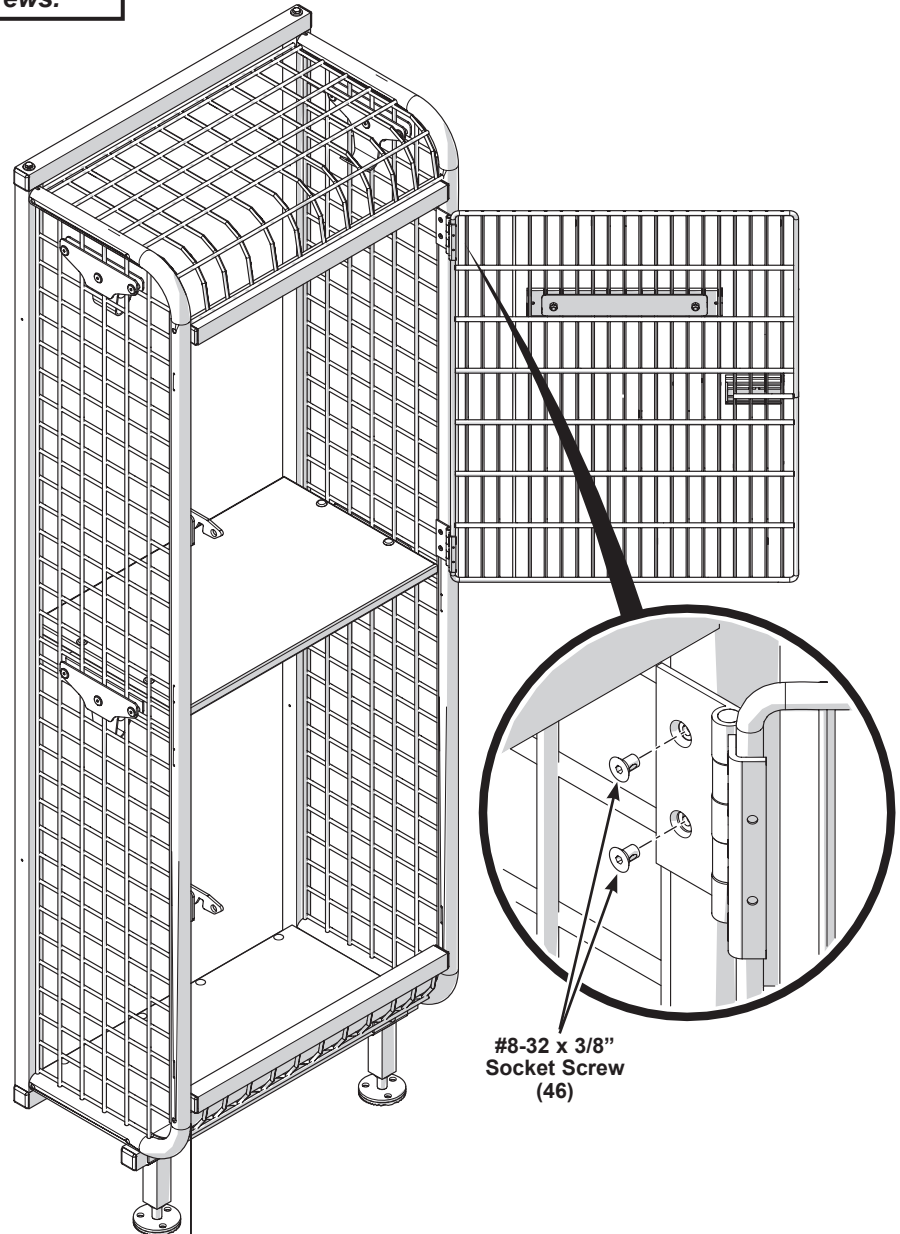

Optional Wood Door Components

Item	Description	Item	Description
10	1/4-20 Cap Nut*	53	Wood Door Hinge
43	3/8" ID Flat Washer	54	#8-32 x 5/8" Socket Screw
44	5/16-18 x 1/4" Shoulder Bolt	55	#8-32 Insert Nut
45	5/16-18 Lock Nut	56	#10-24 x 1/2" Cap Nut
46	#8-32 x 3/8" Socket Screw	57	#10-24 x 3/8" Machine Screw
47	Nameplate Weldment*	58	Stop Bracket
51	Wood Lock Bracket	59	Wood Door Panel
52	Wood Lock Pivot Plate		

*Nameplates are an additional option for doors

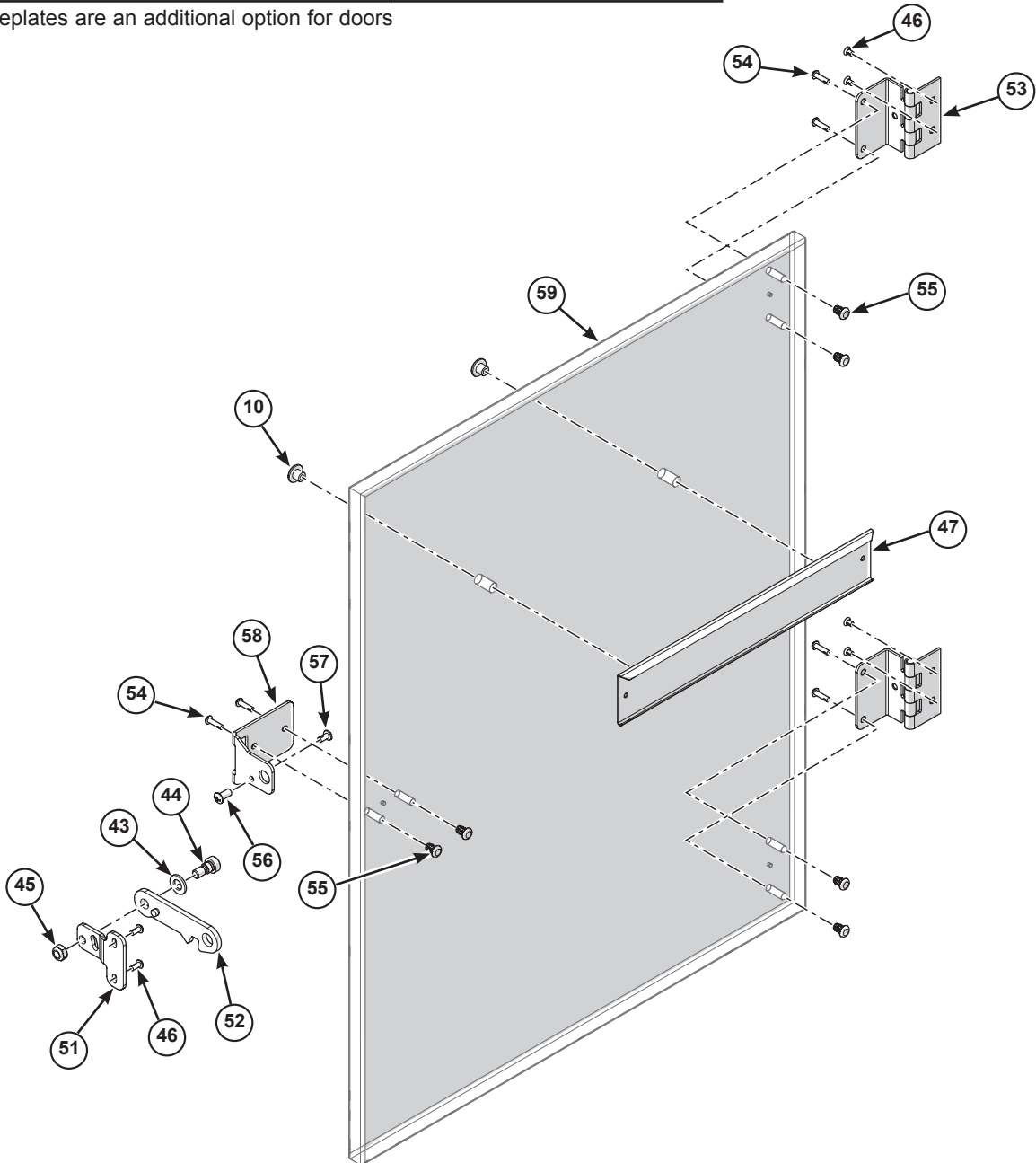

Optional Wood Door Installation

1. Assemble Door Locks for each Wood Door being installed.

- a. Attach a Wood Lock Bracket (51) to a Wood Lock Pivot Plate (52) using a 3/8" ID Flat Washer (43), 5/16-18" x 1/4" Shoulder Bolt (44) and 5/16-18 Lock Nut (45).
- b. Align the pin in the pivot plate with the slot in the bracket.

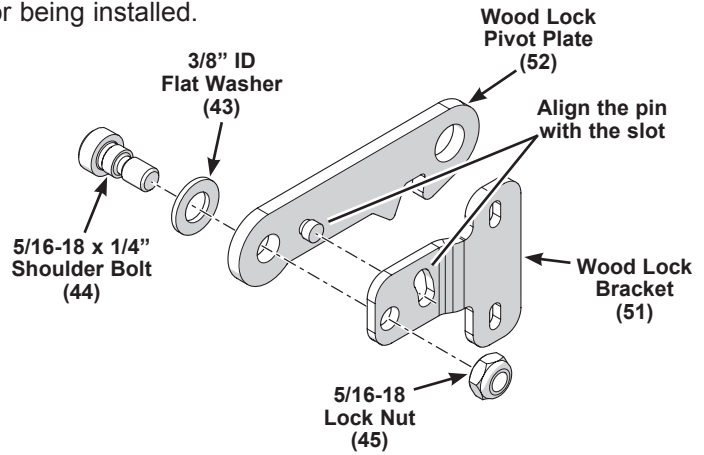

2. Attach each assembled Grille Lock to the inside of the Side Grilles using two #8-32 x 3/8" Socket Screws (46).

The lock pilot holes are centered for the top and bottom compartments.

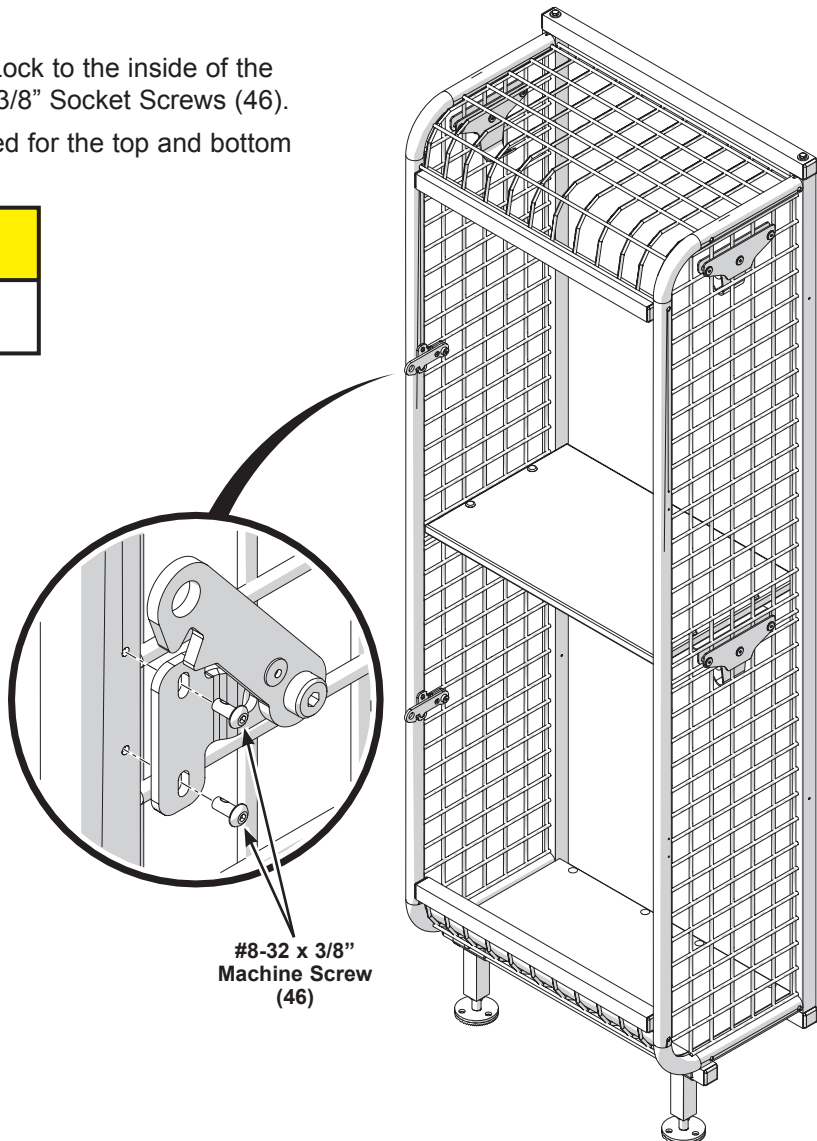

Optional Wood Door Installation (continued)

3. Attach Wood Door Hinges (53) to the inside of the Wood Door Panels (59) using two #8-32 x 5/8" Socket Screw (54) and #8-32 Insert Nuts (55).

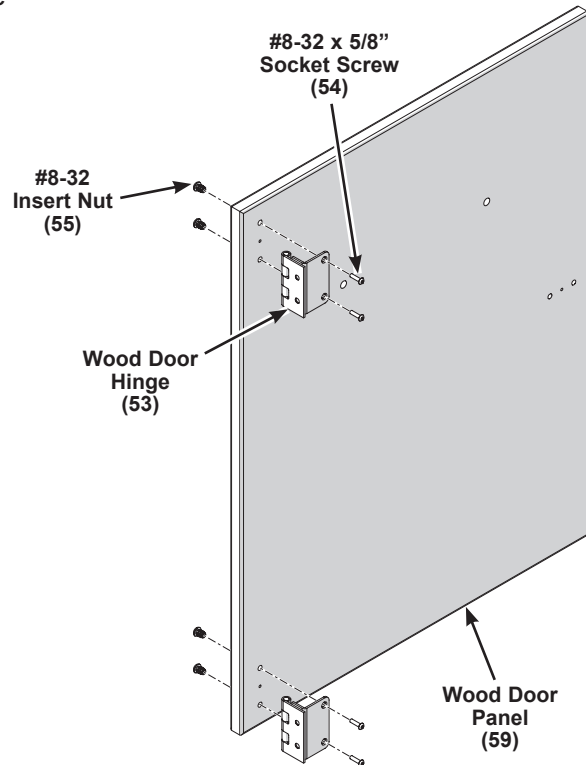

4. Attach a Stop Bracket (58) to the inside of each Door Panel using two #8-32 x 5/8" Socket Screws (54) and #8-32 Insert Nuts (55).
5. Attach one #10-24 x 1/2" Cap Nut (56) and #10-24 x 3x8" Machine Screw (57) to each Stop Bracket as shown.

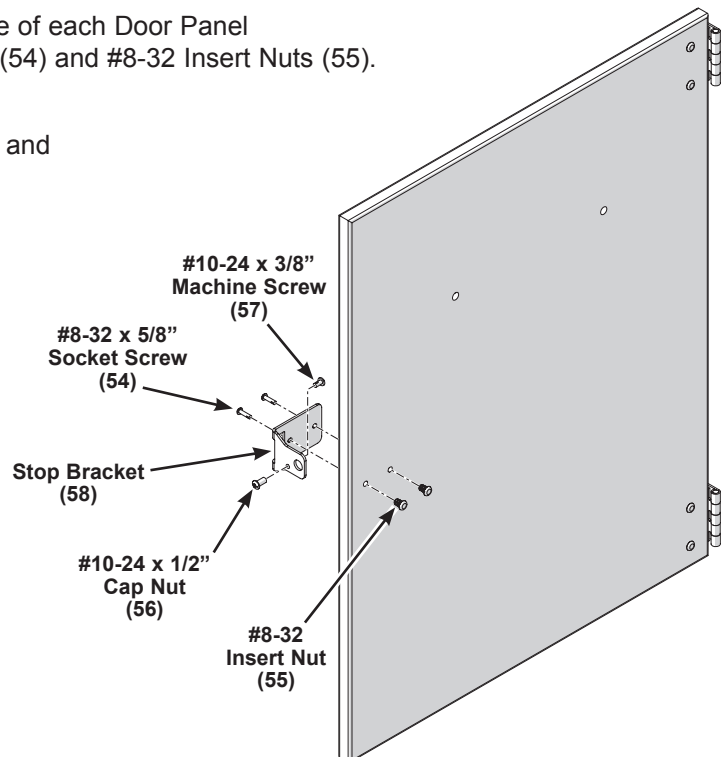

Optional Wood Door Installation (continued)

6. If available, attach an optional Nameplate (47) to the outside of each Wood Door Panel using two 1/4-20 Cap Nuts (10).

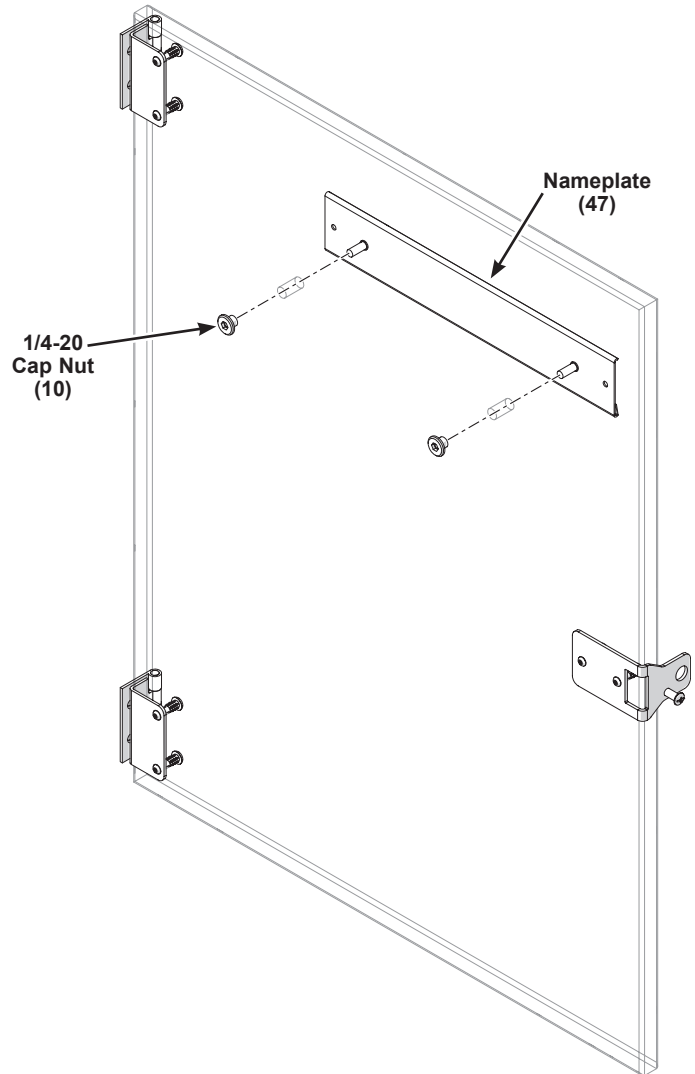

Optional Wood Door Installation (continued)

7. Attach each assembled Door to the pilot holes on the opposite Side Grille of the Door Lock using two #8-32 x 3/8" Socket Screws (46) in each hinge.

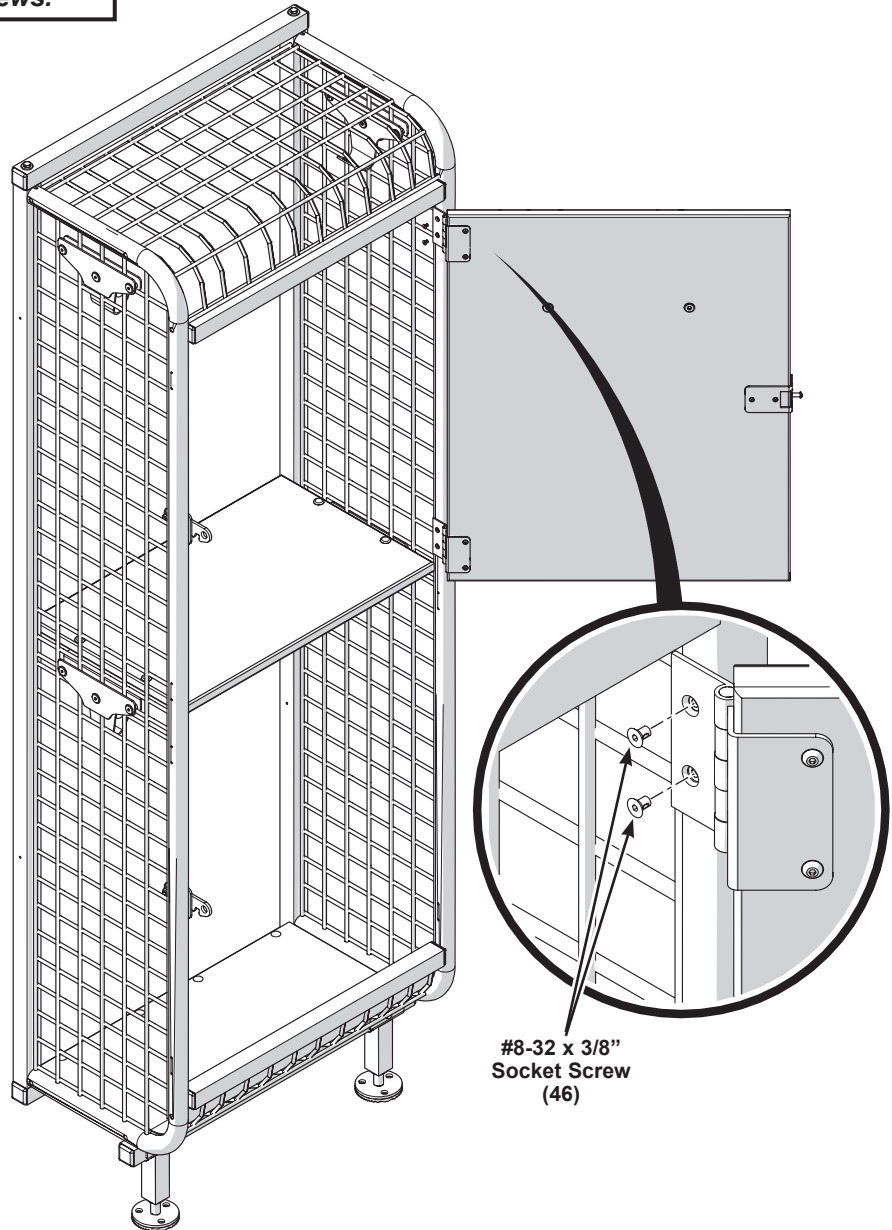

Optional Side Panel Installation

1. Pound 1/4-20 Insert Nuts (8) into the all of the holes on the outside of all Side Panels.

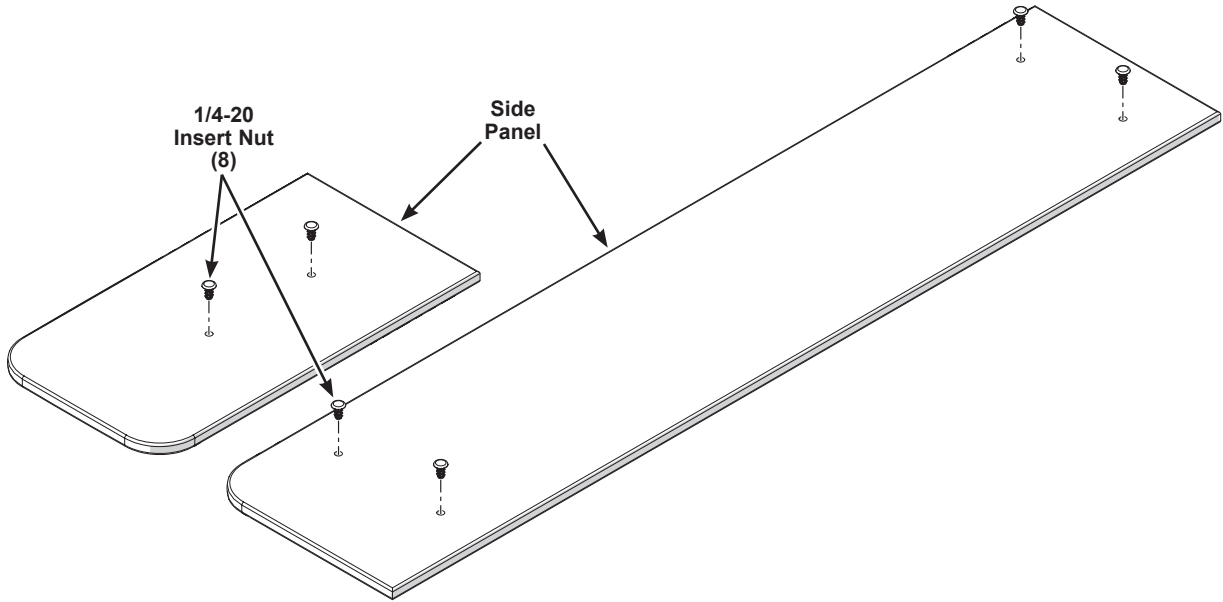

Optional Side Panel Installation (continued)

2. Attach the End Panels to the outside of the Side Grilles using End Panel Plates and 1/4-20 x .875 Machine Screws on the inside of the Side Grilles as shown.

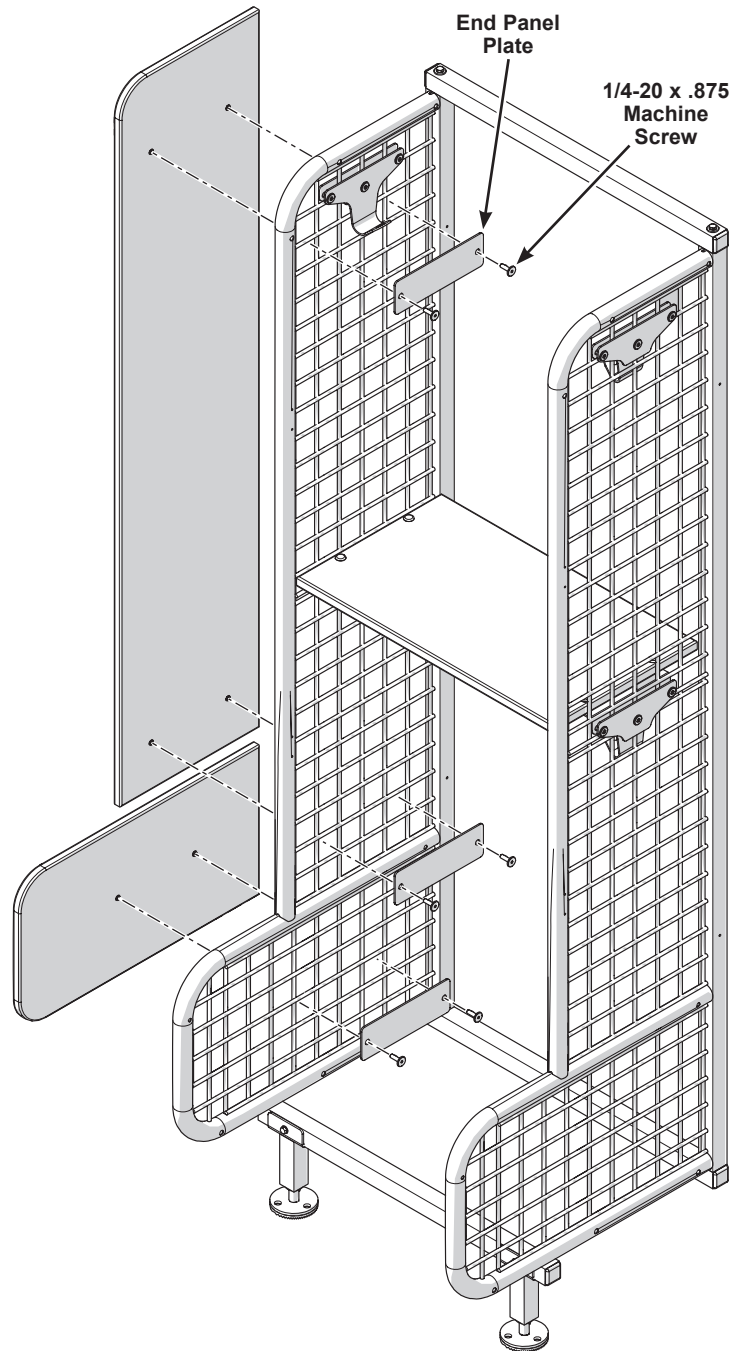

Optional Back Panel Installation

1. Attach four Back Panel Brackets to the top-rear and bottom-rear Uprights of the Side Grilles using #10 x 5/8" Pan Head Screws.

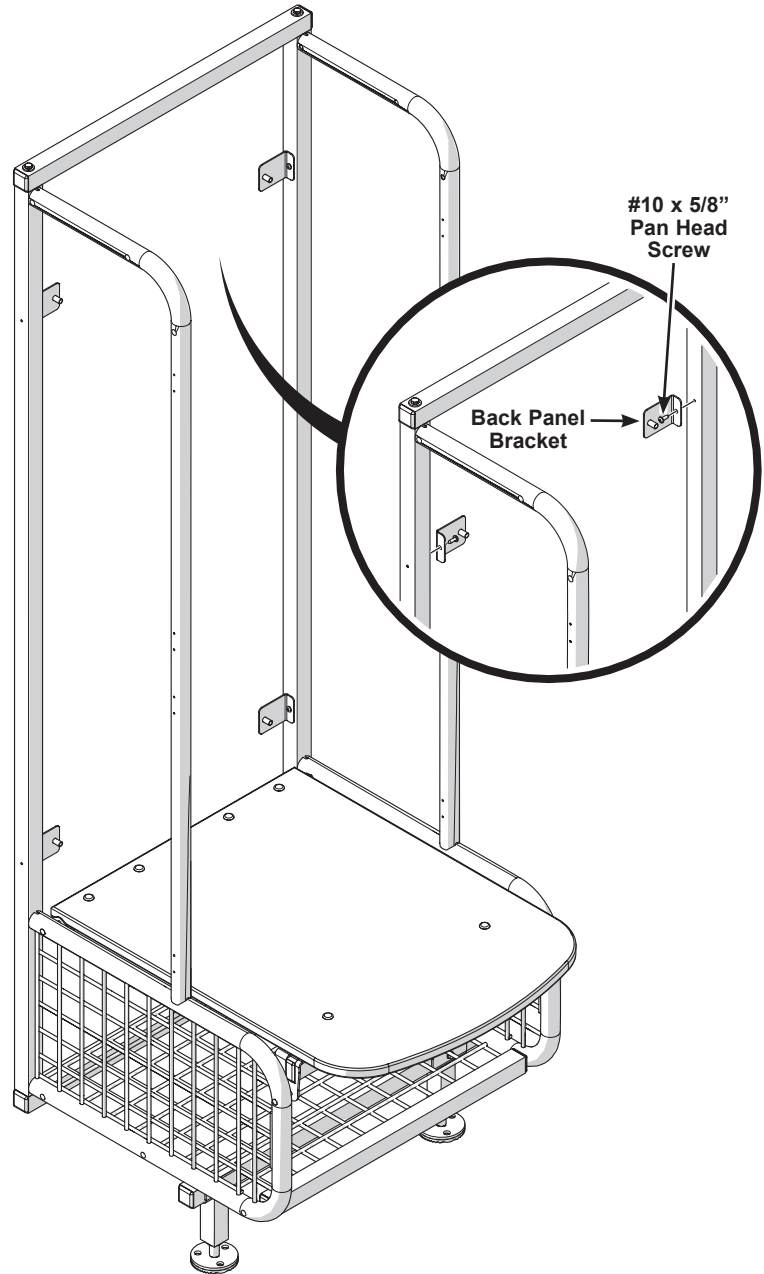

Optional Back Panel Installation (continued)

2. Fit the Back Panel onto the Back Panel Brackets and secure it in place using four 1/4-20 x .708 Machine Screws (9).
3. Return back to step 7 of "Final Assembly" to finish the installation.

