

# Owner's Manual & Safety Instructions

**Save This Manual** Keep this manual for the safety warnings and precautions, assembly, operating, inspection, maintenance and cleaning procedures. Write the product's serial number in the back of the manual near the assembly diagram (or month and year of purchase if product has no number). Keep this manual and the receipt in a safe and dry place for future reference.



## 1-1/4 Cubic Ft. CEMENT MIXER



### **NOTICE**

FOR CEMENT OR  
MORTAR ONLY.  
Do not use with Epoxy  
2-part resin mix.

REV 14i

Visit our website at: <http://www.harborfreight.com>  
Email our technical support at: [productsupport@harborfreight.com](mailto:productsupport@harborfreight.com) **ITEM 61931**

When unpacking, make sure that the product is intact and undamaged. If any parts are missing or broken, please call 1-888-866-5797 as soon as possible.

Copyright© 2014 by Harbor Freight Tools®. All rights reserved.

No portion of this manual or any artwork contained herein may be reproduced in any shape or form without the express written consent of Harbor Freight Tools. Diagrams within this manual may not be drawn proportionally. Due to continuing improvements, actual product may differ slightly from the product described herein. Tools required for assembly and service may not be included.

### **⚠WARNING**

**Read this material before using this product.  
Failure to do so can result in serious injury.  
SAVE THIS MANUAL.**

**NOTICE**

FOR CEMENT AND MORTAR ONLY.  
Do not use with Epoxy 2-part resin mix.

**Table of Contents**

Safety .....	2	Maintenance .....	12
Specifications .....	6	Parts List and Diagram .....	14
Setup .....	7	Warranty .....	16
Operation.....	10		





SAFETY

SETUP

OPERATION

MAINTENANCE

**WARNING SYMBOLS AND DEFINITIONS**

	This is the safety alert symbol. It is used to alert you to potential personal injury hazards. Obey all safety messages that follow this symbol to avoid possible injury or death.
	Indicates a hazardous situation which, if not avoided, will result in death or serious injury.
	Indicates a hazardous situation which, if not avoided, could result in death or serious injury.
	Indicates a hazardous situation which, if not avoided, could result in minor or moderate injury.
	Addresses practices not related to personal injury.

**IMPORTANT SAFETY INSTRUCTIONS**

**WARNING** - When using electric appliances, basic precautions should always be followed, including the following:

1. Read all the instructions before using the appliance.
2. To reduce the risk of injury, close supervision is necessary when an appliance is used near children.
3. Do not contact moving parts.
4. Only use attachments recommended or sold by the manufacturer.
5. To disconnect, turn all controls to the off ("O") position, then remove plug from outlet.
6. Do not unplug by pulling on cord. To unplug, grasp the plug, not the cord.
7. Unplug from outlet when not in use and before servicing or cleaning.
8. Do not operate any appliance with a damaged cord or plug, or after the appliance malfunctions or is dropped or damaged in any manner. Return appliance to the nearest authorized service facility for examination, repair, or electrical or mechanical adjustment.
9. Connect to a properly grounded outlet only. See Grounding Instructions.

**SAVE THESE INSTRUCTIONS**

## NOTICE

FOR CEMENT AND MORTAR ONLY.  
Do not use with Epoxy 2-part resin mix.

# GROUNDING INSTRUCTIONS

This appliance must be grounded. In the event of malfunction or breakdown, grounding provides a path of least resistance for electric current to reduce the risk of electric shock. This appliance is equipped with a cord having an equipment-grounding conductor and a grounding plug. The plug must be plugged into an appropriate outlet that is properly installed and grounded in accordance with all local codes and ordinances.

## ⚠ WARNING



**DANGER** – Improper connection of the equipment-grounding conductor can result in a risk of electric shock. Check with a qualified electrician or serviceman if the grounding instructions are not completely understood, or if in doubt as to whether the appliance is properly grounded. Do not modify the plug provided with the appliance – if it will not fit the outlet, have a proper outlet installed by a qualified electrician.

This appliance is for use on a nominal 120 V circuit, and has a grounding plug that looks like the plug illustrated in Figure A.

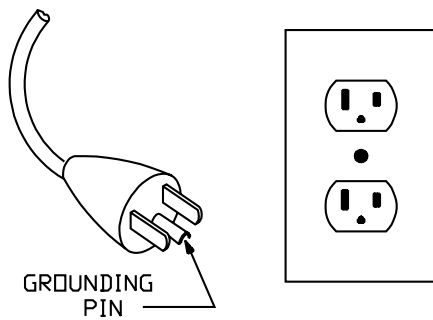

Figure A: 3-prong Plug

A temporary adaptor, which looks like the adaptor illustrated in Figures B and C, may be used to connect this plug to a 2-pole receptacle as shown in Figure B if a properly grounded outlet is not available.

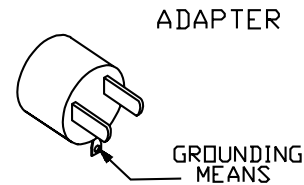

Figure B: Grounding Adaptor

The temporary adaptor should be used only until a properly grounded outlet can be installed by a qualified electrician. The green colored rigid ear, lug, and the like, extending from the adaptor must be connected to a permanent ground such as a properly grounded outlet box cover. Whenever the adaptor is used, it must be held in place by the metal screw, as shown in Figure C.

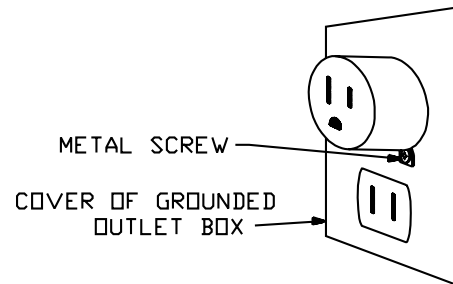

Figure C: Grounding Adaptor Connection

The adaptor should not be used if a three-slot grounded receptacle is available. A qualified electrician should be consulted if there is any doubt as to whether an outlet box is properly grounded.

## NOTICE

FOR CEMENT AND MORTAR ONLY.  
Do not use with Epoxy 2-part resin mix.

## Extension Cords

SAFETY

SETUP

OPERATION

MAINTENANCE

1. Extension cords (or a longer detachable power-supply cords) are available and may be used if care is exercised in their use.
2. If an extension cord (or a longer detachable power-supply cord) is used:
  - a. The marked electrical rating of the detachable power-supply cord or extension cord should be at least as great as the electrical rating of the appliance,
  - b. If the appliance is of the grounded type, the extension cord should be a grounding type 3-wire cord, and
  - c. The longer extension cord (or a longer detachable power-supply cord) should be arranged so that it will not drape over the countertop or tabletop where it can be tripped over, snagged, or pulled on unintentionally (especially by children).
3. An outdoor-use extension cord should be used with an outdoor-use appliance. An outdoor-use extension cord is marked with suffix letter "W" and with a tag stating "Suitable for Use with Outdoor Appliances."
4. The connection to an extension cord should be kept dry and off the ground.
5. Store appliance indoors when not in use. Keep out of reach of children.
6. Do not clean this appliance with a water spray or the like.
7. **Grounded** tools require a three wire extension cord. **Double Insulated** tools can use either a two or three wire extension cord.
8. As the distance from the supply outlet increases, you must use a heavier gauge extension cord. Using extension cords with inadequately sized wire causes a serious drop in voltage, resulting in loss of power and possible tool damage. (See Table A.)
9. The smaller the gauge number of the wire, the greater the capacity of the cord. For example, a 14 gauge cord can carry a higher current than a 16 gauge cord. (See Table A.)
10. When using more than one extension cord to make up the total length, make sure each cord contains at least the minimum wire size required. (See Table A.)
11. If you are using one extension cord for more than one tool, add the nameplate amperes and use the sum to determine the required minimum cord size. (See Table A.)
12. Make sure the extension cord is properly wired and in good electrical condition. Always replace a damaged extension cord or have it repaired by a qualified electrician before using it.
13. Protect the extension cords from sharp objects, excessive heat, and damp or wet areas.

NAMEPLATE AMPERES (at full load)	EXTENSION CORD LENGTH				
	25'	50'	75'	100'	150'
0 – 2.0	18	18	18	18	16
2.1 – 3.4	18	18	18	16	14
3.5 – 5.0	18	18	16	14	12
5.1 – 7.0	18	16	14	12	12
7.1 – 12.0	18	14	12	10	-
12.1 – 16.0	14	12	10	-	-
16.1 – 20.0	12	10	-	-	-

Based on limiting the line voltage drop to five volts at 150% of the rated amperes.

### Connecting Cords

To reduce the risk of the cords pulling apart during operation, do one of the following:

- a. Make a knot as shown below then connect the cords:

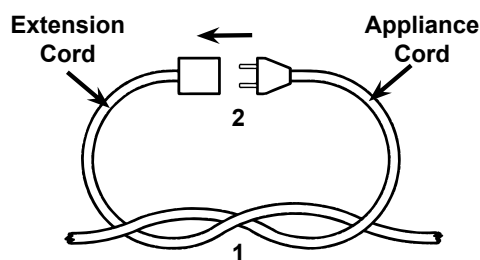

- b. Or, use a plug-receptacle retaining strap or connector designed to hold extension cords to appliance cords.

## NOTICE

FOR CEMENT AND MORTAR ONLY.  
Do not use with Epoxy 2-part resin mix.

# Mixer Safety Warnings

- FOR CEMENT AND MORTAR ONLY. DO NOT USE WITH EPOXY 2-PART RESIN MIX.**
- DO NOT INSERT SHOVEL OR HANDS INTO MIXER WHILE PLUGGED IN. RISK OF SERIOUS INJURY OR DEATH FROM ENTANGLEMENT.**
- Do not attempt to move the Cement Mixer when it is full and/or in operation. It is unsafe to move the mixer while in this condition, and severe injury to personnel could occur.**
- Assemble only according to these instructions. Improper assembly can create hazards.
- Wear ANSI-approved safety goggles and heavy-duty work gloves during assembly.
- Keep assembly area clean and well lit.
- Keep bystanders out of the area during assembly.
- Do not assemble when tired or when under the influence of alcohol, drugs or medication.
- This product is not a toy. Do not allow children to play with this item.
- Use as intended only.
- Inspect before every use; do not use if parts are loose or damaged.
- Do not overload mixer.
- Keep safe clearance around mixer. Keep all persons (except operator) at least six feet from mixer during operation.
- Don't use in dangerous environment. Don't use power tools in damp or wet locations, or expose them to rain. Keep work area well lighted.
- Make workshop kid proof with padlocks, master switches, or by removing starter keys.
- Wear proper apparel. Do not wear loose clothing, gloves, neckties, rings, bracelets, or other jewelry which may get caught in moving parts. Nonslip footwear is recommended. Wear protective hair covering to contain long hair.
- Never leave tool running unattended. Turn power off. Don't leave tool until it comes to a complete stop.
- Disconnect tools before servicing.
- When servicing use only identical replacement parts.
- Only use safety equipment that has been approved by an appropriate standards agency. Unapproved safety equipment may not provide adequate protection. Eye protection must be ANSI-approved and breathing protection must be NIOSH-approved for the specific hazards in the work area.
- Maintain labels and nameplates on the tool. These carry important safety information. If unreadable or missing, contact Harbor Freight Tools for a replacement.
- Avoid unintentional starting. Prepare to begin work before turning on the tool.
- People with pacemakers should consult their physician(s) before use. Electromagnetic fields in close proximity to heart pacemaker could cause pacemaker interference or pacemaker failure.
- WARNING:** Some dust created by power sanding, sawing, grinding, drilling, and other construction activities, contains chemicals known to the State of California to cause cancer and birth defects or other reproductive harm. Some examples of these chemicals are:
  - Lead from lead-based paints
  - Crystalline silica from bricks and cement or other masonry products
  - Arsenic and chromium from chemically treated lumberYour risk from these exposures varies, depending on how often you do this type of work. To reduce your exposure to these chemicals: work in a well ventilated area, and work with approved safety equipment, such as those dust masks that are specially designed to filter out microscopic particles. (California Health & Safety Code § 25249.5, *et seq.*)
- WARNING:** The cord of this product contains lead and/or di (2-ethylhexyl) phthalate (DEHP), chemicals known to the State of California to cause cancer, and birth defects or other reproductive harm. Wash hands after handling. (California Health & Safety Code § 25249.5, *et seq.*)
- The warnings, precautions, and instructions discussed in this instruction manual cannot cover all possible conditions and situations that may occur. It must be understood by the operator that common sense and caution are factors which cannot be built into this product, but must be supplied by the operator.

**NOTICE**

FOR CEMENT AND MORTAR ONLY.  
Do not use with Epoxy 2-part resin mix.

**Specifications**

Electrical Input	120 VAC / 60 Hz / 2.7 A
Motor No Load Speed	1192 RPM
Drum Speed	35 RPM
Drum Capacity	1-1/4 Cubic Feet
Drum Opening	10"



SAFETY

SETUP

OPERATION

MAINTENANCE



## NOTICE

FOR CEMENT AND MORTAR ONLY.  
Do not use with Epoxy 2-part resin mix.

## Setup - Before Use



Read the **ENTIRE** IMPORTANT SAFETY INFORMATION section at the beginning of this document including all text under subheadings therein before set up or use of this product.

## WARNING

**TO PREVENT SERIOUS INJURY FROM ACCIDENTAL OPERATION:**

**Turn the Power Switch of the tool off before performing any procedure in this section.**

**Note:** For additional information regarding the parts listed in the following pages, refer to the Assembly Diagram near the end of this manual.

## Assembly

1. Place the Stand (64) into the Wheel Bracket (4) so that bolt holes line up. See Figure D.

**Note:** Set Stand on its side for easier assembly.

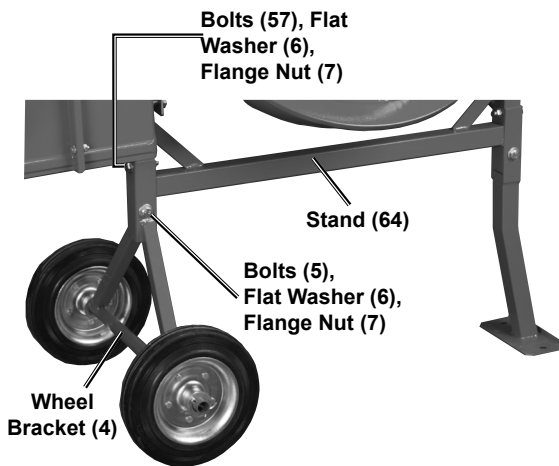

Figure D

2. Fasten together. Longer Bolt (M8x50, part 5) goes through the lower hole, while slightly shorter Bolt (M8x45, part 57) goes through the upper hole. Secure both Bolts with Flat Washers (6) and Flange Nuts (7). Tighten securely. See Figure D.
3. Insert Leg (65) into Stand so that bolt holes line up. See Figure E.

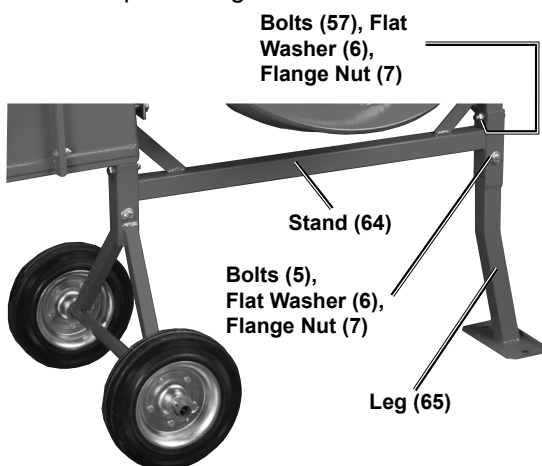

Figure E

4. Fasten together. Longer Bolt (M8x50, part 5) goes through the lower hole, while slightly shorter Bolt (M8x45, part 57) goes through the upper hole. Secure both Bolts with Flat Washers (6) and Flange Nuts (7). Tighten with a wrench (not included). See Figure E.
5. Place Stand upright.
6. To attach Wheels (3) to Wheel Bracket, slide a Flat Washer (2), Wheel and second Flat Washer onto each end of Wheel Bracket axle. See Figure F.

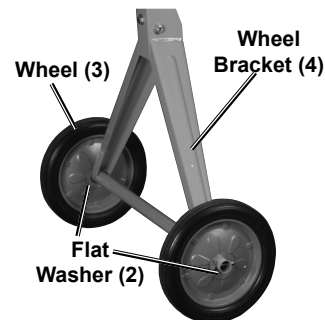

Figure F

7. Insert a Cotter Pin (1) through holes in each end of the Bracket axle and bend the Cotter Pins over to secure the Wheels in place. See Figure G.

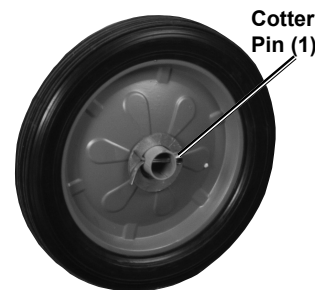

Figure G

## NOTICE

FOR CEMENT AND MORTAR ONLY.  
Do not use with Epoxy 2-part resin mix.

8. With assistance, set the Lower Drum (71) with attached Arm (59) and Support Bracket Seats (41) into Stand assembly and align the bolt holes. See Figure H.

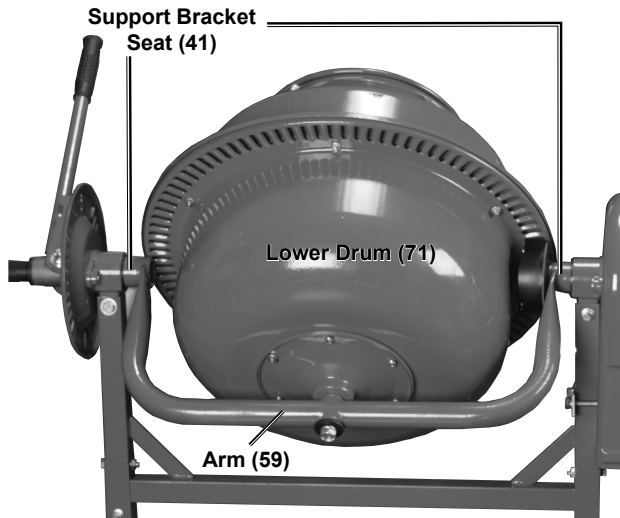

Figure H

9. Fasten together using Bolts (57), Flat Washers (6), and Flange Nuts (7). Tighten with wrench until secure.
10. Mount Handle Control Plate (48) to Support Bracket Seat (41) using Bolts (35), Spring Washers (36) and Flat Washers (37). See Figure I.

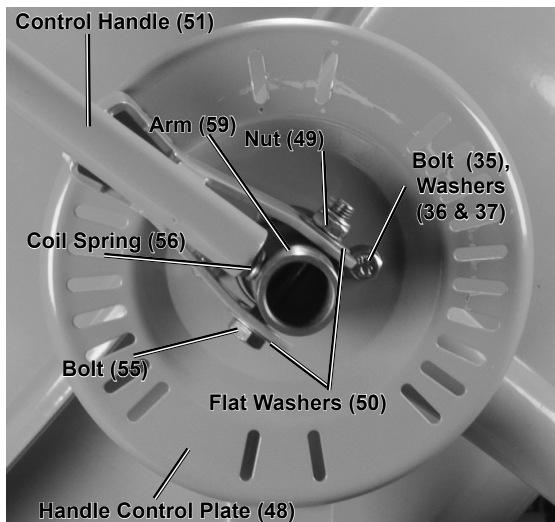

Figure I

11. Tighten to a point where the Arm (59) can still move.
12. Insert the Coil Spring (56) into the Control Handle (51).
13. Attach Control Handle to Arm shaft with a Bolt (55), two Flat Washers (50), and a Nut (49).
14. Use gasket sealer (not included) to stick the Rubber Gasket (72) to the Upper Drum (76), making sure the holes in both align. The Gasket must be flat on the Upper Drum to ensure a proper seal.

15. Place the Upper Drum onto the Lower Drum (71), making sure the mounting holes align in both.
16. Insert a Screw (73) into each of six mounting holes. Fasten Drums together using Flat Washers (77) and Nuts (39).
17. Position each Mixer Blade (78) inside the assembled Drum with the pointed end facing downward. The V-shaped bend in the Blades should point in the direction of the Drum rotation (clockwise).
18. Fasten tops of Mixer Blades to Upper Drum using Bolts (75), Washers (30), Seal Gaskets (74), and Nuts (39). Fasten pointed ends of Mixer Blades to Lower Drum using Bolts (73), Washers (30), Seal Gaskets (74), Rubber Gaskets (79) and Nuts (39).
19. Mount the Motor Hood (38) to the Support Bracket Seat (41) using Bolts (35), Spring Washers (36) and Flat Washers (37).
20. Use Bolts (5), Flat Washers (37), Spring Washers (36) and Clamp (63) to attach the Motor Bracket (8) to the Motor Hood. Tighten connections until secure. See Figure J.

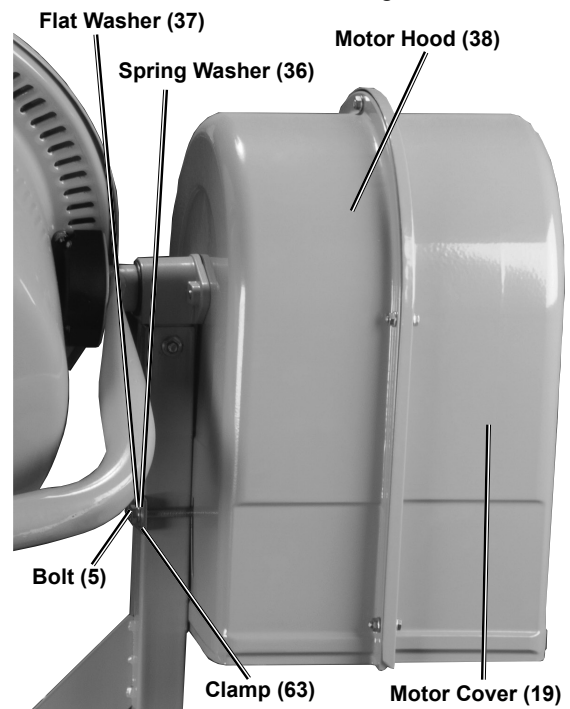

Figure J

21. Clean the Pinion Shaft (44) of all protective material and other debris. Clean debris out of the Motor Pulley (34) hub.
22. Spread a few drops of lubricating oil on the Pinion Shaft and squarely push the Drum Pulley (32) onto the Shaft so that the groove in the Pulley engages the Flat Key (31). The Pulley should be flush with the step on the Pinion Shaft.



## NOTICE

FOR CEMENT AND MORTAR ONLY.  
Do not use with Epoxy 2-part resin mix.

**Note:** Do not hammer the Drum Pulley onto the Pinion Shaft. Doing so can damage the unit and possibly lead to a loose fitting V-Belt (33).

23. Place the Motor (9) onto the Motor Bracket.
24. Use Bolts (10), Flat Washers (6) and Nuts (7) to secure the Motor to the Motor Bracket. Hand-tighten all four Nuts since the motor will be adjusted forward or backward later.
25. Once the Drum Pulley is pushed in all the way, use a key (not included) to tighten the Bolt on the end of the Pulley's hub.
26. Attach the V-Belt by placing it around the Motor Pulley and then over the Drum Pulley. Using a flat-edge screwdriver (not included), push the Motor inward until the Motor Pulley is directly under the Drum Pulley. Tighten the Bolts securing the Motor to the Motor Bracket.
27. Slightly loosen the Bolts (5) holding the Motor Bracket in place. Push the Motor downward until the V-Belt tension is tight. When proper V-Belt tension is achieved, tighten the Bolts (see Belt Inspection and Tensioning on page 12).
28. Check if Motor and V-Belt turn correctly. Hand turn the Drum Pulley and verify that Motor Pulley and Drum Pulley do not rub against any other part. Adjust Motor location as needed.
29. Mount the Motor Cover (19) to the Motor Hood (38) using five Bolts (26) and Nuts (39).
30. Check all connections to verify that all screws, nuts, and bolts are securely tightened.



**NOTICE**

FOR CEMENT AND MORTAR ONLY.  
Do not use with Epoxy 2-part resin mix.

**Operating Instructions**



Read the **ENTIRE IMPORTANT SAFETY INFORMATION** section at the beginning of this manual including all text under subheadings therein before set up or use of this product.

**Functions**

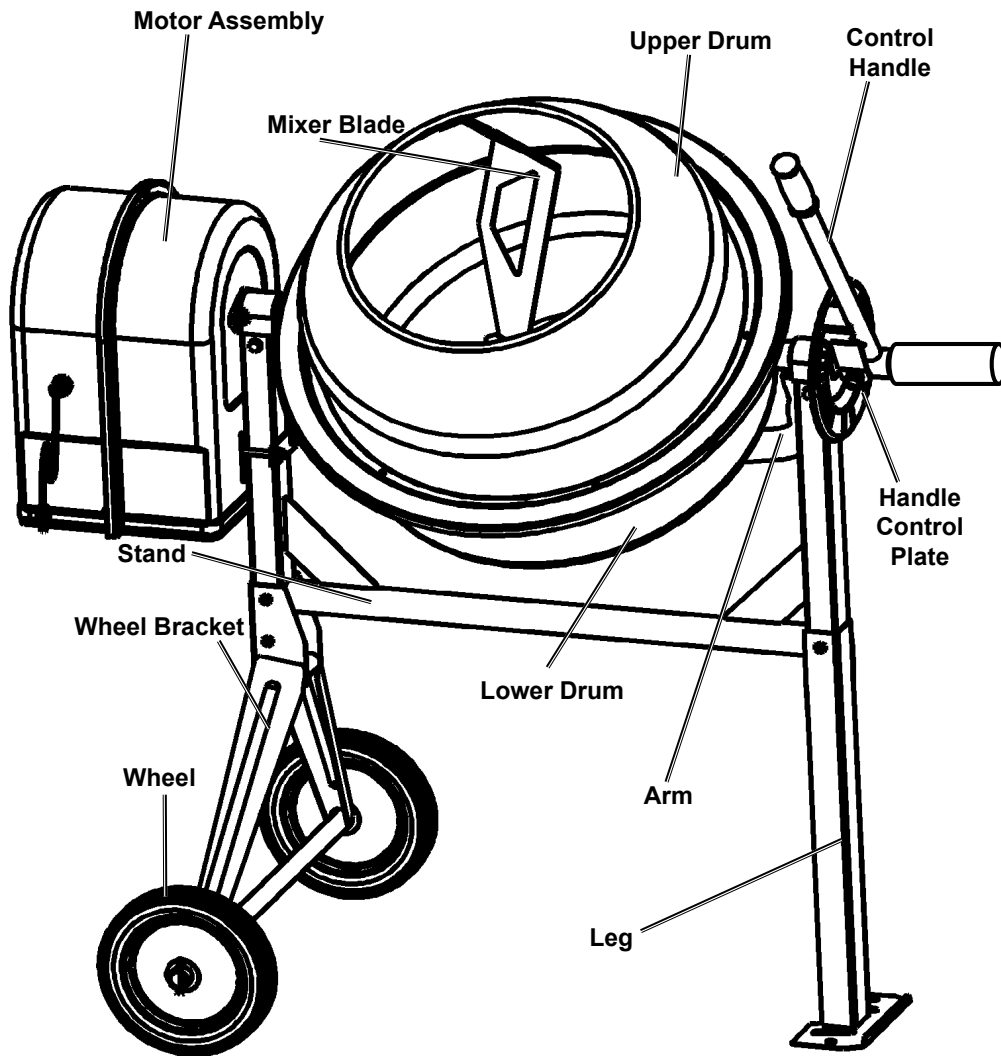

SAFETY

SETUP

OPERATION

MAINTENANCE

## NOTICE

FOR CEMENT AND MORTAR ONLY.  
Do not use with Epoxy 2-part resin mix.

# General Operating Instructions

1. Place the Cement Mixer on a solid, even surface.

**WARNING!** Do not attempt to move the Cement Mixer when it is full and/or in operation. Block the wheels with wheel chocks (not included).

2. Connect the Power Cord to an electric outlet (or properly rated grounded three prong extension cord).
3. Add material to the Drum. Typical maximum quantities include: 3/4 gallons water with 1 shovel of cement and 5 shovels aggregate rock (using a size 3 shovel, not included).
4. Adjust the Drum angle by pulling on the Control Handle. First, disengage the locking pins by pulling the Control Handle away from the drum and then pushing on the Handle until the desired angle is reached. Re-engage the locking pins.

5. Flip the switch to "ON" (I) position.

6. Once materials are mixed, tilt Drum and dump materials where needed. The materials are dumped while the Drum is rotating.

**CAUTION!** Never leave the Cement Mixer running while unattended. Do not turn Mixer off while full of cement.

7. When finished, flip the Switch to the "OFF" (O) position and disconnect the Power Cord.
8. Tilt the Drum angle as far down as possible to drain all fluids from Drum.
9. Clean, then store out of children's reach.

SAFETY

SETUP

OPERATION

MAINTENANCE



## NOTICE

FOR CEMENT AND MORTAR ONLY.  
Do not use with Epoxy 2-part resin mix.

## Maintenance



Procedures not specifically explained in this manual must be performed only by a qualified technician.

### **WARNING**

**TO PREVENT SERIOUS INJURY FROM ACCIDENTAL OPERATION:** Turn the Power Switch of the tool to its "OFF" position and unplug the tool from its electrical outlet before performing any inspection, maintenance, or cleaning procedures.

**TO PREVENT SERIOUS INJURY FROM TOOL FAILURE:**

Do not use damaged equipment. If abnormal noise or vibration occurs, have the problem corrected before further use.

## Cleaning, Maintenance, and Lubrication

- BEFORE EACH USE**, inspect the general condition of the tool. Check for:
  - Loose hardware
  - Misalignment or binding of moving parts
  - Cracked or broken parts
  - Damaged electrical wiring
  - Damaged or cracked belts
  - Any other condition that may affect its safe operation.
- AFTER USE**, immediately wash out all debris from the inside and outside of the Cement Mixer. Scrub the inside of the Drum with a stiff, long handled bristle brush for best results. Wipe external surfaces of the tool with clean cloth.
- DO NOT apply water in or around the Motor Cover.
- PERIODICALLY** recheck all fasteners and other connections for tightness.
- WARNING!** If the supply cord of this power tool is damaged, it must be replaced only by a qualified service technician.

## Belt Inspection and Tensioning

- Retighten V-Belt after the first 25 hours of use. To test the tension, follow the steps below.
- Remove Motor Cover.
- Examine Belt for cracks, tears in the backing, or other damage. Replace Belt if damaged according to steps below:
  - Loosen the Motor Bracket bolts and slide the Bracket up as far as possible.
  - Slide the old Belt off of the Drum Pulley first, then remove it from the Motor Pulley.
  - Put the new belt around the Motor Pulley first, then around the Drum Pulley.
  - Move the Motor Bracket down until the Belt is properly tensioned according to the directions below. Tighten the Motor Bracket bolts.
- Check and adjust belt tension according to the steps below:

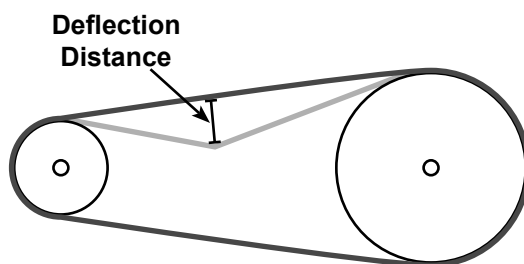

- Press on the center of the longest span on the belt with moderate finger pressure. Then measure the deflection distance, the distance that the belt moved. The belt should deflect anywhere from 1/2" to 3/4".
  - If the belt deflects too much**, tighten belt by loosening the Motor Bracket bolts and moving the Motor away from the Drum Pulley slightly. Tighten Motor Bracket bolts and retest tension. If the belt is too long to be properly tensioned, it must be replaced.
  - If the belt deflects too little**, loosen the Motor Bracket bolts and lift Bracket upward. Tighten Motor Bracket bolts and retest tension.
- Replace Motor Cover.

**NOTICE**

FOR CEMENT AND MORTAR ONLY.  
Do not use with Epoxy 2-part resin mix.

**Troubleshooting**

<b>Problem</b>	<b>Possible Causes</b>	<b>Likely Solutions</b>
Tool will not start.	<ol style="list-style-type: none"> <li>1. Cord not connected.</li> <li>2. No power at outlet.</li> <li>3. Internal damage or wear.</li> </ol>	<ol style="list-style-type: none"> <li>1. Check that cord is plugged in.</li> <li>2. Check power at outlet. If outlet is unpowered, turn off tool and check circuit breaker. If breaker is tripped, make sure circuit has the correct capacity for the tool and circuit has no other loads.</li> <li>3. Have technician service tool.</li> </ol>
Tool operates slowly.	Extension cord too long or wire size too small.	Eliminate use of extension cord. If an extension cord is needed, use shorter/heavier gauge cord. See <i>Extension Cords</i> in <i>GROUNDING</i> section.
Excessive noise or rattling.	<ol style="list-style-type: none"> <li>1. Belt too loose (slipping) or too tight (bearing damage).</li> <li>2. Internal damage or wear.</li> </ol>	<ol style="list-style-type: none"> <li>1. Properly tension belt.</li> <li>2. Have technician service tool.</li> </ol>
Overheating/ Overloading.	<ol style="list-style-type: none"> <li>1. Running with too much cement.</li> <li>2. Blocked motor housing vents.</li> <li>3. Motor being strained by long or small diameter extension cord.</li> </ol>	<ol style="list-style-type: none"> <li>1. Pour out some of the cement. Run only with lighter load.</li> <li>2. Wear ANSI-approved safety goggles and NIOSH-approved dust mask/respirator while blowing dust out of motor using compressed air.</li> <li>3. Eliminate use of extension cord. If an extension cord is needed, use one with the proper diameter for its length and load. See <i>Extension Cords</i> in <i>GROUNDING</i> section.</li> </ol>



**Follow all safety precautions whenever diagnosing or servicing the tool.  
Disconnect power supply before service.**

SAFETY

SETUP

OPERATION

MAINTENANCE

**NOTICE**

FOR CEMENT AND MORTAR ONLY.  
Do not use with Epoxy 2-part resin mix.

**Parts List and Diagram****Parts List**

Part	Description	Qty
1	Cotter Pin 5×40	2
2	Flat Washer 20	4
3	Wheel	2
4	Wheel Bracket	1
5	Bolt M8×50	4
6	Flat Washer 8	12
7	Flange Nut M8	10
8	Motor Bracket	1
9	Motor	1
10	Bolt M8×16	4
11	Screw M6×12	1
12	Flat Key 5×25	1
13	Bushing M12	3
14	Nut M4	4
15	Spring Washer 4	4
16	Ground Wire	2
17	Serrated Washer 4	2
18	Power Cord	1
19	Motor Cover	1
20	Overload Protection Device 3A	1
21	Switch	1
22	Screw ST3.5×9.5	4
23	Flat Washer 4	8
24	Cross-Head Screw M4×12	4
25	Switch Panel	1
26	Bolt M6×20	5
27	Terminal Box	1
28	Cross-Head Screw M6×10	2
29	Spring Washer 6	2
30	Flat Washer 6	10
31	Flat Key 5×30	1
32	Drum Pulley	1
33	V-Belt O-600	1
34	Motor Pulley	1
35	Bolt M8×20	4
36	Spring Washer 8	4
37	Flat Washer	6
38	Motor Hood	1
39	Nut M6	15
40	Ring Shield Ø38	4

Part	Description	Qty
41	Support Bracket Seat	2
42	Spacer	2
43	Bearing 6002	2
44	Pinion Shaft	1
45	Gear	1
46	Gear Cover	1
47	Cross-Head Screw M4×30	3
48	Handle Control Plate	1
49	Nut M10	1
50	Flat Washer 10	2
51	Control Handle	1
52	Rubber Handle	1
53	Handlebar	1
54	Handlebar Cover	1
55	Bolt M10×70	1
56	Coil Spring	1
57	Bolt M8×45	4
58	Flat Key 5×8	1
59	Arm	1
60	Flat Washer 12	1
61	Spring Washer 12	1
62	Bolt M12×25	1
63	Clamp	1
64	Stand	1
65	Leg	1
66	Nut M6	4
67	Bearing Cover, Lower	1
68	Bearing 6204	2
69	Shaft	1
70	Bearing Cover, Upper	1
71	Lower Drum	1
72	Rubber Gasket	1
73	Bolt M6×16	12
74	Seal Gasket	12
75	Bolt M6×12	2
76	Upper Drum	1
77	Flat Washer 6	6
78	Mixer Blade	2
79	Rubber Gasket	2

SAFETY

SETUP

OPERATION

MAINTENANCE

# NOTICE

FOR CEMENT AND MORTAR ONLY.  
Do not use with Epoxy 2-part resin mix.

## Assembly Diagram

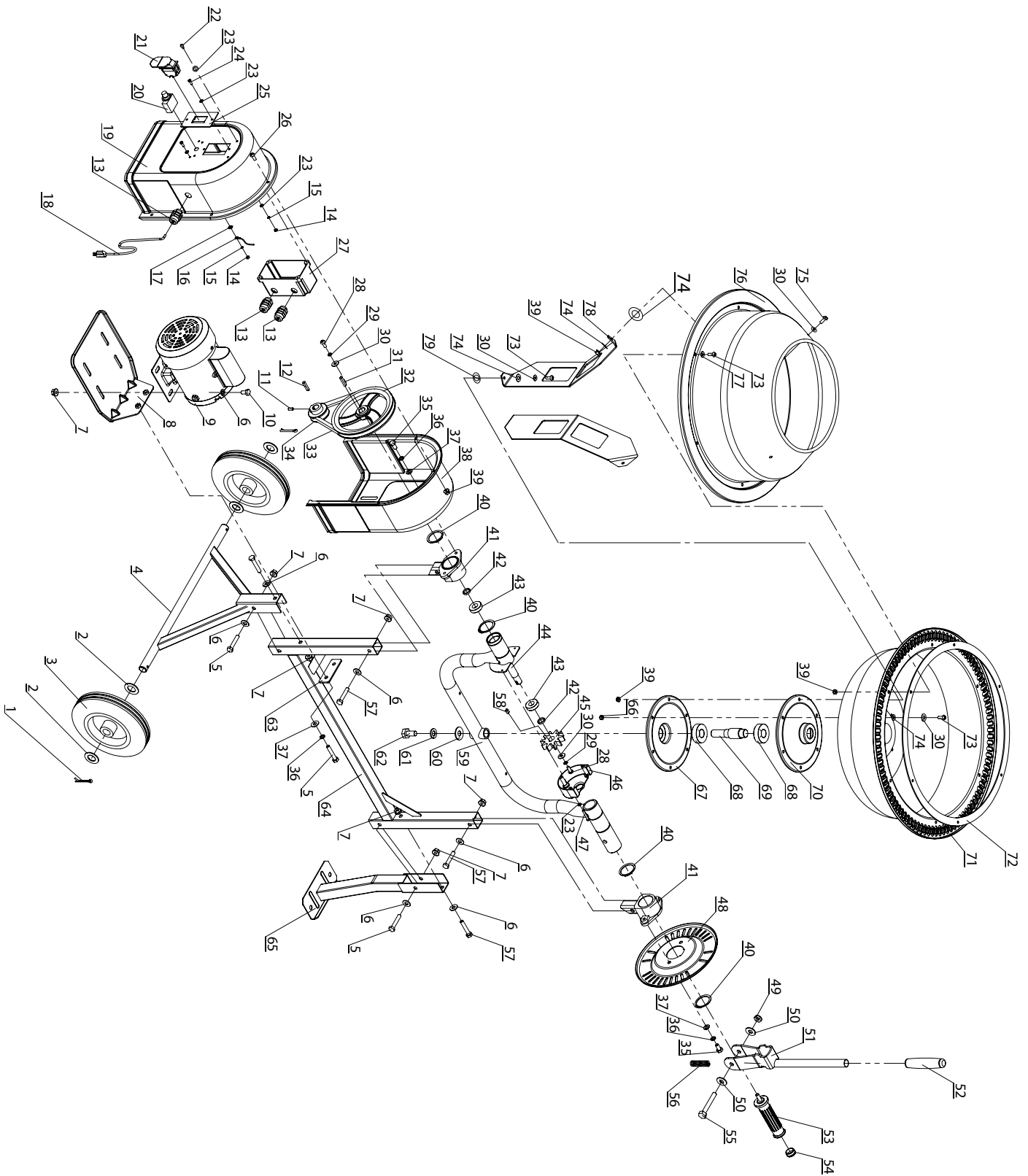

Record Serial Number Here:

**Note:** If product has no serial number, record month and year of purchase instead.

**Note:** Some parts are listed and shown for illustration purposes only, and are not available individually as replacement parts.

## PLEASE READ THE FOLLOWING CAREFULLY

---

THE MANUFACTURER AND/OR DISTRIBUTOR HAS PROVIDED THE PARTS LIST AND ASSEMBLY DIAGRAM IN THIS DOCUMENT AS A REFERENCE TOOL ONLY. NEITHER THE MANUFACTURER OR DISTRIBUTOR MAKES ANY REPRESENTATION OR WARRANTY OF ANY KIND TO THE BUYER THAT HE OR SHE IS QUALIFIED TO MAKE ANY REPAIRS TO THE PRODUCT, OR THAT HE OR SHE IS QUALIFIED TO REPLACE ANY PARTS OF THE PRODUCT. IN FACT, THE MANUFACTURER AND/OR DISTRIBUTOR EXPRESSLY STATES THAT ALL REPAIRS AND PARTS REPLACEMENTS SHOULD BE UNDERTAKEN BY CERTIFIED AND LICENSED TECHNICIANS, AND NOT BY THE BUYER. THE BUYER ASSUMES ALL RISK AND LIABILITY ARISING OUT OF HIS OR HER REPAIRS TO THE ORIGINAL PRODUCT OR REPLACEMENT PARTS THERETO, OR ARISING OUT OF HIS OR HER INSTALLATION OF REPLACEMENT PARTS THERETO.

### Limited 90 Day Warranty

Harbor Freight Tools Co. makes every effort to assure that its products meet high quality and durability standards, and warrants to the original purchaser that this product is free from defects in materials and workmanship for the period of 90 days from the date of purchase. This warranty does not apply to damage due directly or indirectly, to misuse, abuse, negligence or accidents, repairs or alterations outside our facilities, criminal activity, improper installation, normal wear and tear, or to lack of maintenance. We shall in no event be liable for death, injuries to persons or property, or for incidental, contingent, special or consequential damages arising from the use of our product. Some states do not allow the exclusion or limitation of incidental or consequential damages, so the above limitation of exclusion may not apply to you. THIS WARRANTY IS EXPRESSLY IN LIEU OF ALL OTHER WARRANTIES, EXPRESS OR IMPLIED, INCLUDING THE WARRANTIES OF MERCHANTABILITY AND FITNESS.

To take advantage of this warranty, the product or part must be returned to us with transportation charges prepaid. Proof of purchase date and an explanation of the complaint must accompany the merchandise. If our inspection verifies the defect, we will either repair or replace the product at our election or we may elect to refund the purchase price if we cannot readily and quickly provide you with a replacement. We will return repaired products at our expense, but if we determine there is no defect, or that the defect resulted from causes not within the scope of our warranty, then you must bear the cost of returning the product.

This warranty gives you specific legal rights and you may also have other rights which vary from state to state.

