

INSTRUCTION MANUAL



your creative assistant

CELEBRITY 550



FREE ARM SEWING MACHINE

Safety instructions

Like any other electrical device, a sewing machine can cause serious, even life-threatening injuries. To avoid this, and in order to work safely:

- Before initial use of your sewing machine, read these operating instructions thoroughly.
- Keep the operating instructions in a suitable place near the machine. When passing the appliance on to others, always enclose the operating instructions.
- Always disconnect the power supply when leaving the machine unattended. This will prevent the risk of accidents if the machine is switched on accidentally.
- First pull the power plug before changing the bulb or performing maintenance work on the machine. This will prevent possibly life-threatening electric shocks.
- Do not remove the plug from the socket by pulling on the cable. Always grip the plug and not the cable when pulling out the power plug.
- Only use the sewing machine in dry rooms.
- In case of any visible damage on the machine, the foot switch or the power cable: Have the damage repaired by Customer Service before using the sewing machine again.
- Never let children or elderly persons handle the machine unsupervised because they may not properly appreciate the possible dangers. Keep electrical appliances outside the reach of children.
- Never use the machine when the ventilation apertures are blocked. Keep the ventilation apertures of the machine and the foot switch free from fluff, dust and waste material.
- Don't let children play with sewing machine.
- Never use the machines if the air vents are blocked. Keep the air vents free from dust, fluff and leftovers.
- Never place anything on the foot controller.
- This machine is not intended for use by persons (including children) with reduced physical, sensory or mental capabilities, or lack of experience and knowledge, unless they have been given supervision or instruction concerning use of the appliance by a person responsible for their safety.
- Children should be supervised to ensure that they do not play with the machine.

Warning against injuries and material damages:

According to legislation, you as the user of an electrical appliance are responsible for preventing possible accidents through safety-conscious behaviour:

- Keep your work space tidy. An untidy workplace can lead to accidents.
- Provide adequate lighting when working!
- Do not wear loose clothing or jewellery, as these can be caught in the moving parts. You should also wear a hair net if you have long hair.
- Avoid abnormal posture. Remain steady and in a well-balanced position at all times.
- Be alert! Pay attention to what you are doing. Always take a rational approach to your work. Never work with the sewing machine if you are unable to concentrate or if you are feeling unwell!

If accidents occur as a result of handling the machine with insufficient care, or failure to follow the safety instructions in this manual, then the manufacturer cannot accept liability.

If the supply cord that fixed with foot controller is damaged, it must be replaced by the manufacturer or its service agent or a similar qualified person in order to avoid a hazard.

Please use for your sewing machine the ZHEJIANG FOUNDER presser foot, type KD-2902.

Power rating: 220 - 230V ~, 50Hz

Current rating: 1.0A

Protection Class : II

CONTENTS

Parts Diagram	3-4
Accessories	5
Before sewing (Power supply and sewing lamp)	6
Removing extension table.....	7
Free-arm sewing	7
Winding the bobbin	8
Removing bobbin case and bobbin.....	9
Inserting bobbin into bobbin case	9
Inserting bobbin case into shuttle race	10
Threading upper thread & Twin needle threading	11
Drawing up the bobbin thread	12
Changing sewing directions	12
Adjusting thread tension.....	13
Regulating the presser foot pressure	14
Drop feed.....	14
Changing needle	15
Fabric-Thread-Needle-table	16
Sewing (pattern selector) and operation table	17
To start sewing	18
Stitch width	18
How to finish stitches	19
Straight stitch.....	20
Zigzag sewing	20
Automatic embroidery	20
Overcasting	21
Straight and zigzag stretch stitches	21
Blind stitch	22-23
Button sewing.....	24
Binding	24
Zipper sewing	25
Buttonhole sewing.....	26
Hemming	27
Twin needle	28
Embroidery	28
Quilter.....	29
Seam guide	29
Maintenance (Cleaning and oiling)	30
Checking performance problems-Troubleshooting	31

PARTS DIAGRAM (FRONT VIEW)

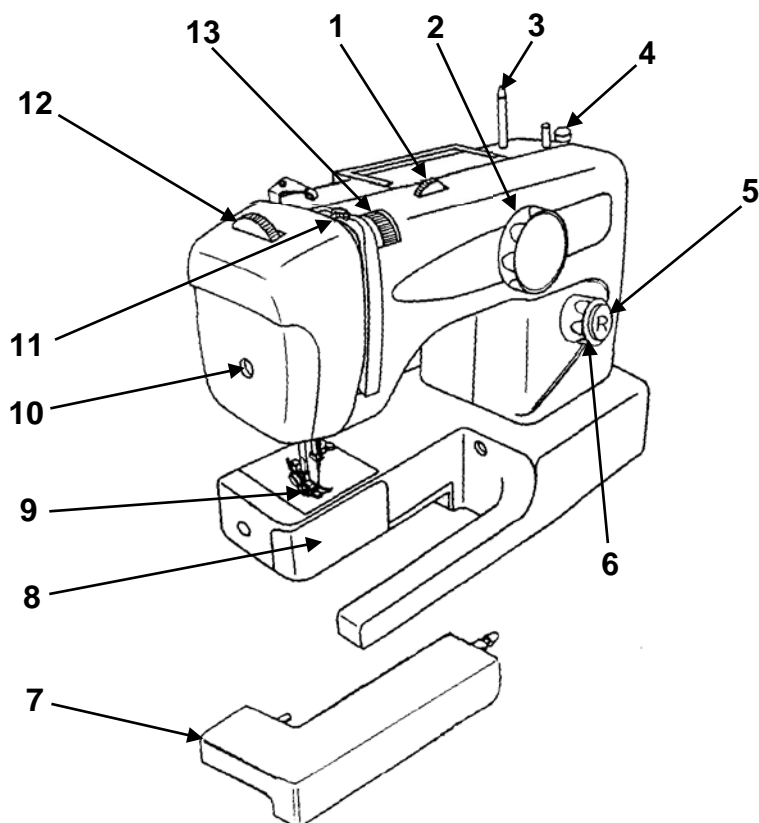

1. Stitch width dial
2. Pattern selector dial
3. Spool pin
4. Bobbin winder stopper
5. Reverse button
6. Stitch length dial
7. Extension table
8. Shuttle cover
9. Presser foot
10. Screw for opening the lampflap
11. Take up lever
12. Presser foot pressure dial
13. Thread tension dial

REAR VIEW

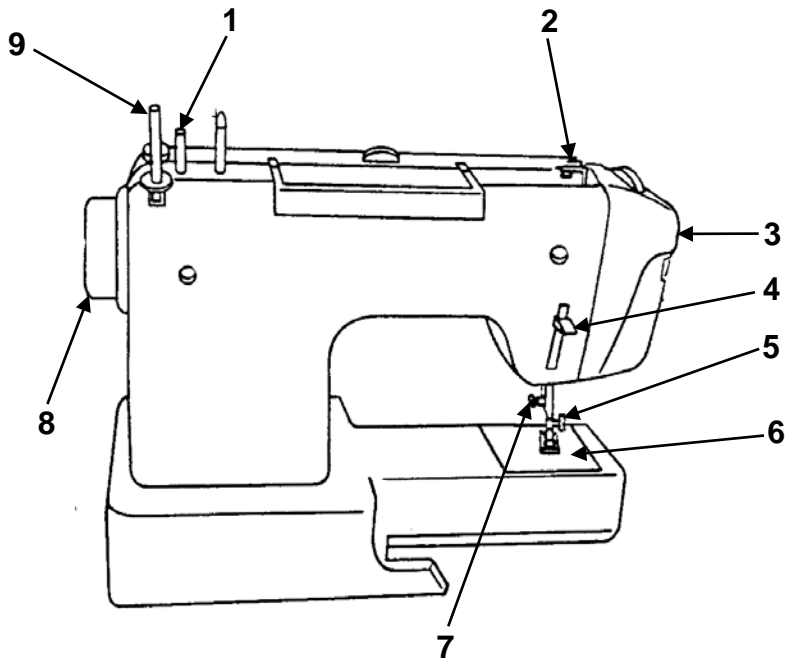

1. Bobbin winder spindle
2. Upper thread guide
3. Face cover
4. Presser foot lever
5. Thumb screw
6. Needle plate
7. Thread guide and needle clamp
8. Hand wheel
9. Extra spool pin

ACCESSORIES



Bobbin



Felt



Zigzag foot
(on machine)

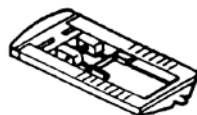

Buttonhole foot

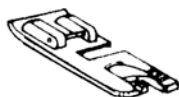

Hemmer foot

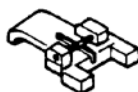

Button sewing foot



Zipper foot



Cloth guide and screw

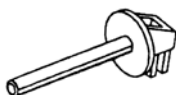

Extra spool pin

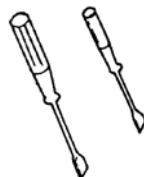

Screw driver
(Large & small)

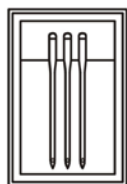

Needles
#11 #14

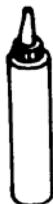

Machine oil

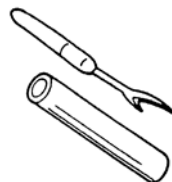

Buttonhole cutter

BEFORE SEWING

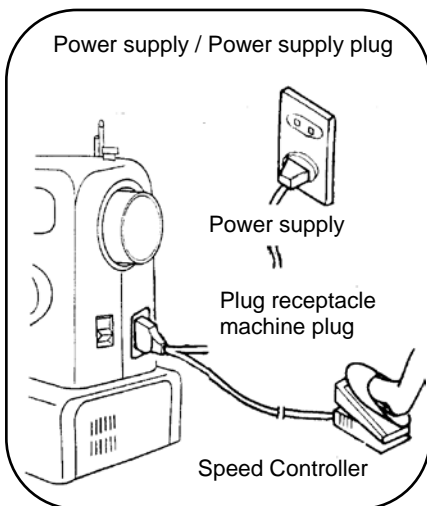

1. Fit plug into the machine.
2. Insert plug into the main socket.
3. Sewing speed can be varied by the foot control.

Warning: Please always unplug the power plug before you change the bulb or perform maintenance work to the machine so that you prevent deadly peril and electric shock.

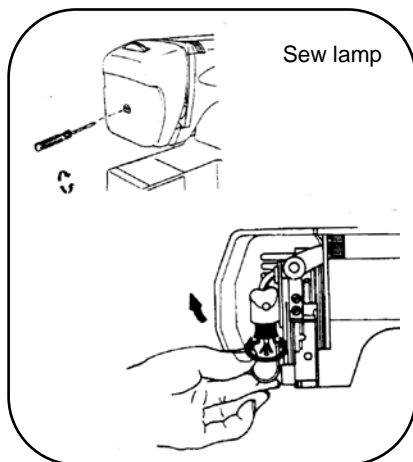

Bulb replacement:

1. Open face cover in direction of arrow.
2. Remove bulb by unscrewing it counter-clockwise.
3. Install a new bulb by screwing it in clockwise.
4. Use a 15 watt bulb. (max)
5. Make sure the bulb is cold before removing it.

REMOVING EXTENSION TABLE

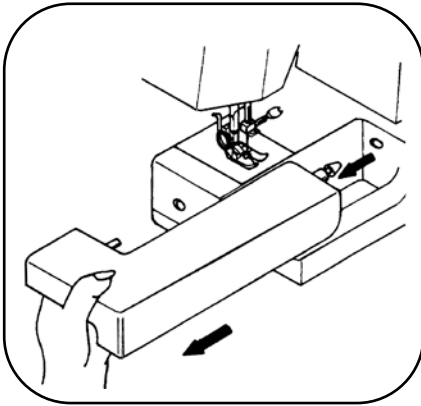

Hold the left end of the table and pull it out in direction of the arrow.

FREE-ARM SEWING

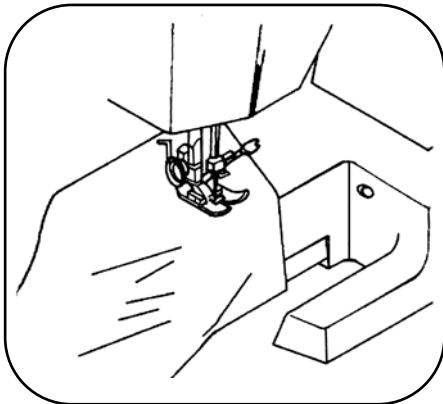

1. This sewing machine can be used as a flat bed machine but easily converts to a free arm machine by removing the extension table.
2. Especially useful for sewing sleeves, pant legs, tubular fabrics etc. more easily.
3. To sew tubular items just slip the sleeve or leg of pants on the free arm as shown on the illustration.

WINDING THE BOBBIN

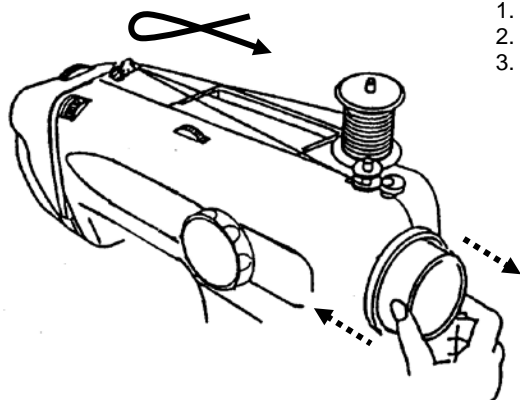

1. Release coupling knob.
2. Thread as shown.
3. When bobbin is filled, re-engage coupling knob.

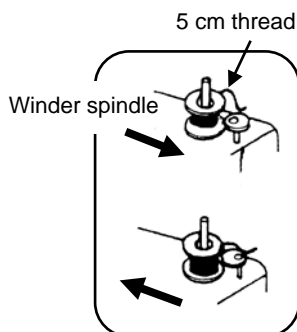

Push bobbin winder spindle in direction of the arrow. When bobbin winding is completed, return spindle to its original position.

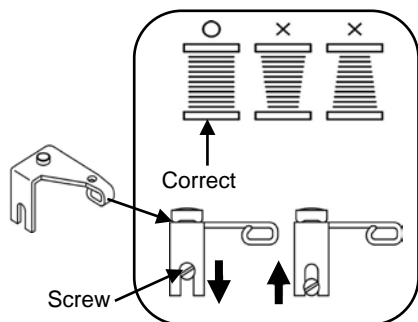

When bobbin winding is incorrect, release the screw of the upper thread guide and adjust up or down until bobbin the winding is balanced.

REMOVING BOBBIN CASE AND BOBBIN

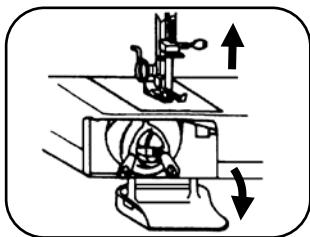

1. Raise the needle to its highest position and open shuttle race cover.



2. Open the hinged latch of the bobbin case and pull the bobbin case out of the machine.



3. Release the latch and the bobbin will fall out easily.

INSERTING BOBBIN INTO BOBBIN CASE

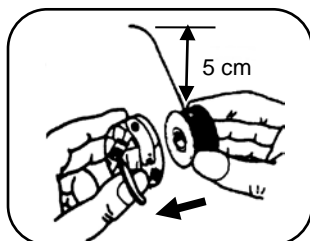

1. Pull 5 cm of thread from bobbin and insert it into bobbin case as shown.

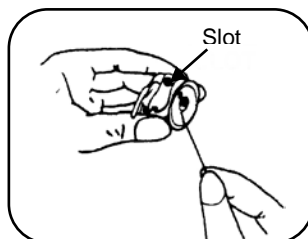

2. Guide the end of thread into the slot.

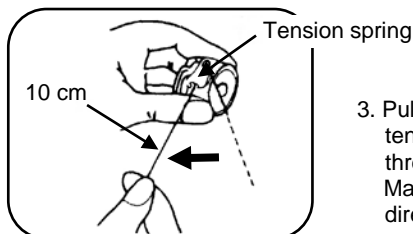

3. Pull the thread through the slot and under the tension spring and draw out about 10 cm of thread. Making sure the bobbin turns in a clockwise direction.

INSERTING BOBBIN CASE INTO SHUTTLE RACE

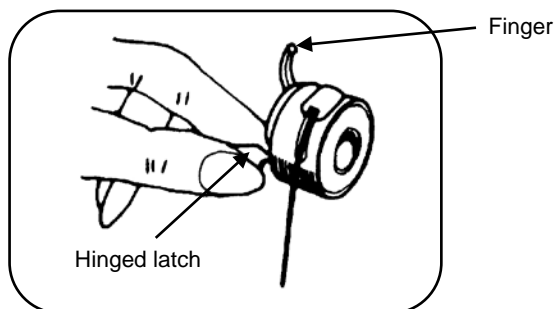

1. Raise the needle to its highest position. Pull the thread to the front, open the latch of the bobbin case and hold it.

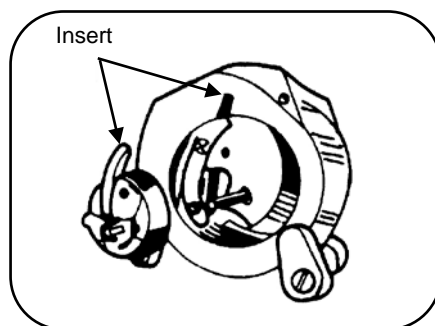

2. Holding the latch open, place bobbin case onto the center pin in the shuttle and release latch.

THREADING UPPER THREAD

Warning: Before contriving please adjust main control switch to (O).

Pass the thread from A to E as shown.

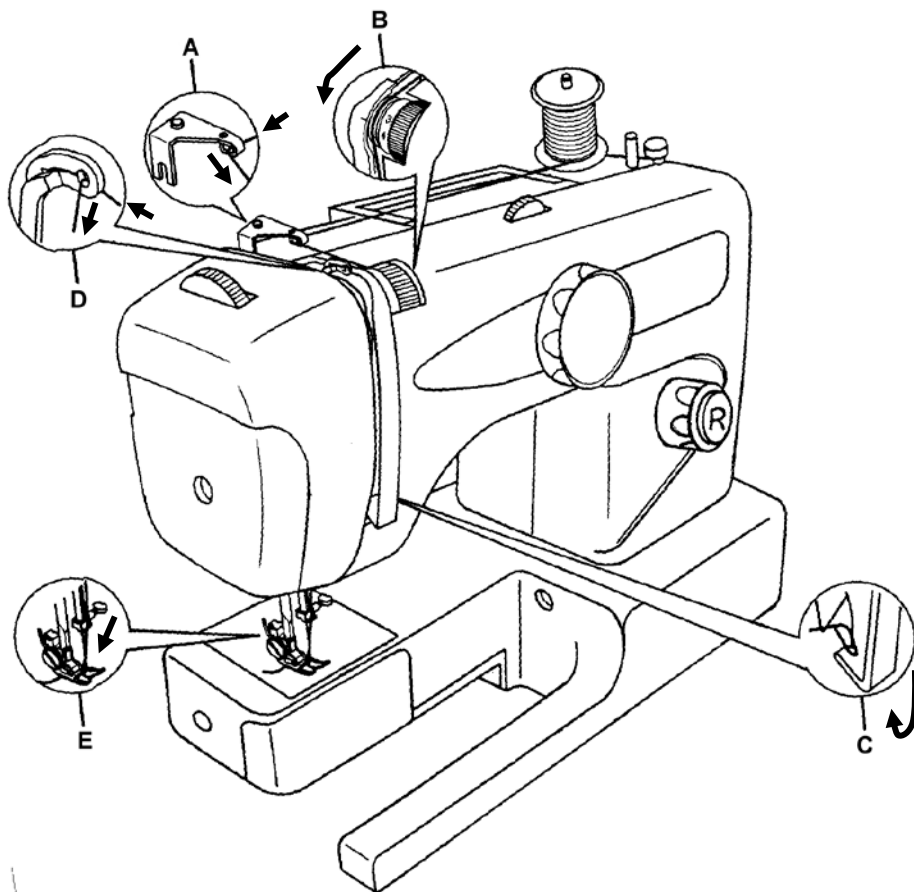

Twin needle threading.

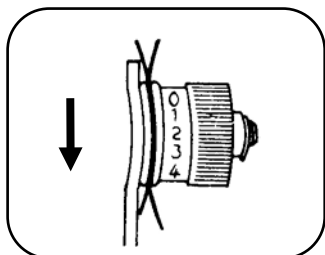

B

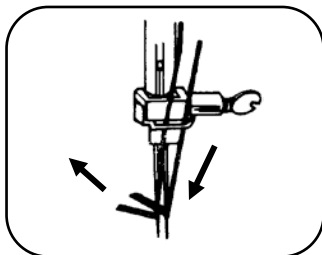

E

DRAWING UP THE BOBBIN THREAD

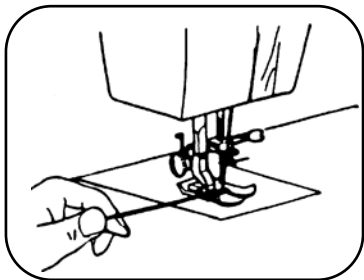

1. Hold the upper thread with left hand, turn the hand wheel slowly towards you until the needle goes down and comes up. Then stop the hand wheel when the take up lever is at its highest position.

Lightly draw up the upper thread, by which the lower thread will be brought up in a loop.

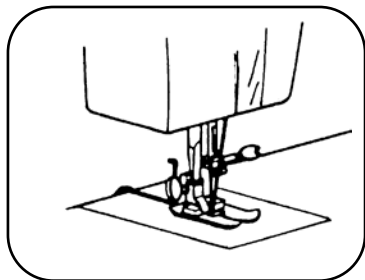

2. Pull out both threads and place them together under presser foot to the rear of the machine.
3. Place fabric under presser foot from the front, lower presser foot.
4. Start to sew.

CHANGING SEWING DIRECTIONS

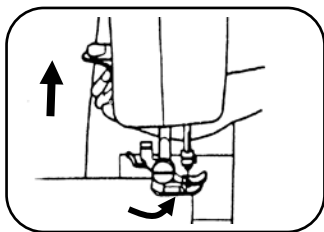

1. Lower needle down into fabric and raise presser foot, pivot the fabric around the needle to change direction as desired.

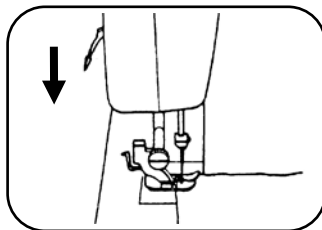

2. Lower the presser foot and start to sew.

ADJUSTING THREAD TENSION

Normal upper thread tension: 4 – 6

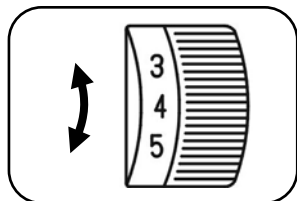

Upper thread tension may be adjusted by turning the thread tension dial.

Correct

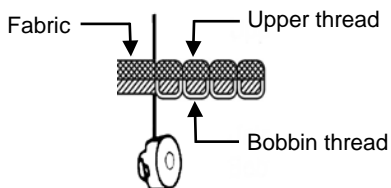

Incorrect

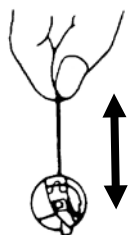
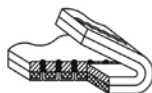
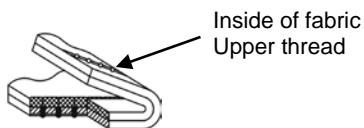

Lower thread tension can be increased by turning the screw of the bobbin case slightly to the right (clockwise). Turning it to the left (counter-clockwise) decreases tension.

REGULATING THE PRESSER FOOT PRESSURE

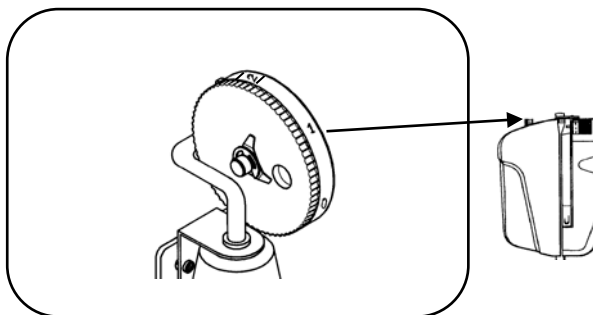

1. Push down the lever for the desired pressure; for light fabrics set lever at 3, set at 2 for medium fabrics and at 1 for heavy fabrics.
2. Insufficient pressure may cause poor feeding, skipped stitches or difficulty in guiding the fabric. To adjust the presser foot pressure, use the lever behind the cover of the lamp. Loosen the stop screw of the lamp cover to open it.
3. When darning or sewing freehand embroidery, release the pressure by setting the lever to O.
After adjusting the presser foot pressure and closing the lamp cover, tighten up the stop screw. The lever is usually adjusted at 2.

DROP FEED

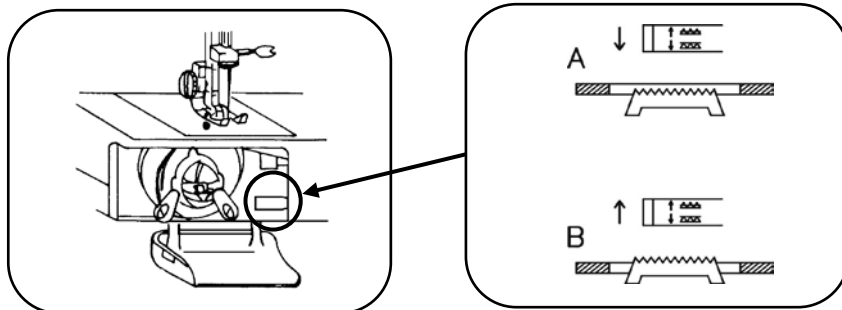

- A. Push feed lever down to drop feed below needle plate for darning, embroidery, and button sewing.
- B. Push feed lever up to raise feed above needle plate for normal sewing.

CHANGING NEEDLE



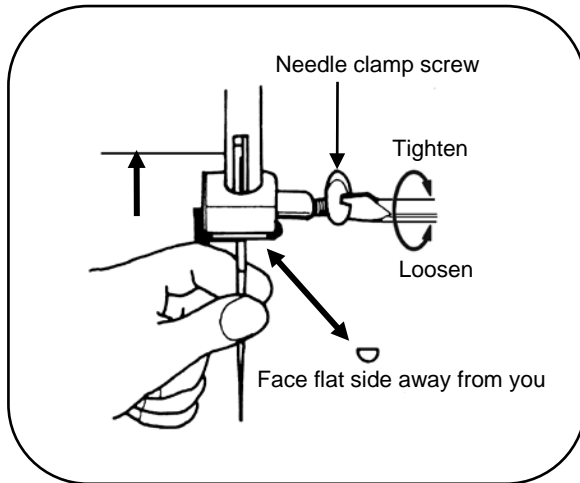







Warning: Before changing the pin please adjust main control switch to (O).



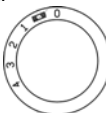



























1. Raise the needle bar to its highest position.
2. Loosen needle clamp screw and remove the old needle.
3. With the flat side of the needle facing away from you, insert the needle as far up as it will go.
4. Tighten the needle clamp screw securely.

FABRIC-THREAD-NEEDLE-TABLE

Please pay attention to the following list as a guide for sewing different types of fabric.

	Fabric	Thread	Needle	Pressure of Presser Foot	Length of Stitches		Indication of Upper Tension
				See page 14 Pressure regulation 	Straight stitch	ZZ	
					Stitch Length Dial 		
Light 	Nylon	80 Cotton	70 (10)	3	1 - 3	1 - 4	
	Tricot	60 S Fiber silk					
	Silk	50 Silk					
	Wool silk	50 S Fiber silk	80 (12)				
Medium 	Gingham	60-80 Cotton	80-90 (12-14)	2	0.5 - 3	0.5 - 4	
	Thin Jersey	60 S Fiber	80 (12)				
	Gabardine	50 Silk					
Heavy 	Denim	50 Cotton	90-100 (14-16)	1	0.5 - 3	0.5 - 4	
	Jersey	50 S Fiber	80-90 (12-14)				
	Tweed	50 Silk	80-90 (12-14)				

SEWING (PATTERN SELECTOR) AND OPERATION TABLE

	Stitch patterns		Stitch length	Presser foot	Drop feed	
A	Straight stitch					
B-E	Zigzag					
F	Blind stitch					
G	Blind helm					
H	Three step zigzag stitch					
I	Slant over edge					
J	Single overlock stitch					
K	Honeycomb stitch					
L	Zigzag stitch					
M	Straight stretch stitch					
N	Automatic Embroidery					
O						
P						
Q						
R-T	Buttonhole					
	Twin Needle	Stitch Nos. A,B,C,M only				
	Free-hand embroidery			Without		

TO START SEWING

Important hints:

1. Raise the take-up lever to its highest position before starting and after stopping sewing.
2. Hold both threads about 10 cms to the rear of the machine for the first two or three stitches.
3. Sufficient fabric should be placed under needle before lowering the presser foot.
4. Depress foot/speed control and start to sew.
5. Test the machine stitches on a scrap of fabric you plan to use, adjusting the machine for the length of the stitch and tension suitable to your fabric.
6. Separate the machine from the power system if you leave it unsupervised.

Attention:

1. When turning the hand wheel manually, always turn it toward you.
2. Guide the cloth gently with your hand.
3. To prevent breaking needles, always raise the needle out of the fabric when you stop sewing.

STITCH WIDTH

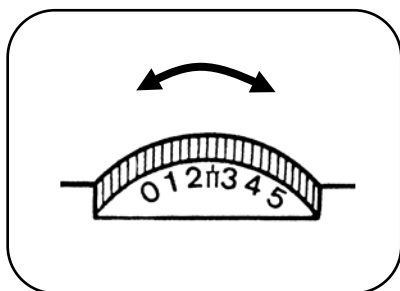

Using this dial, you can adjust the stitch width in an infinitely variable way between 0 and 5.

ATTENTION: When using the twin needle, adjust the stitch width to maximally 3. Adjusting the stitch width to a higher number causes the needle to break.

HOW TO FINISH STITCHES

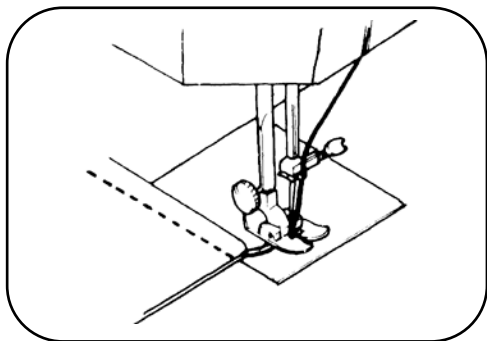

1. Sew to the edge of seam.
2. Push the reverse button and sew in reverse for about 3-4 cms.
3. Raise needle to its highest position.
4. Lift the presser foot and pull the fabric out of the back of the machine.

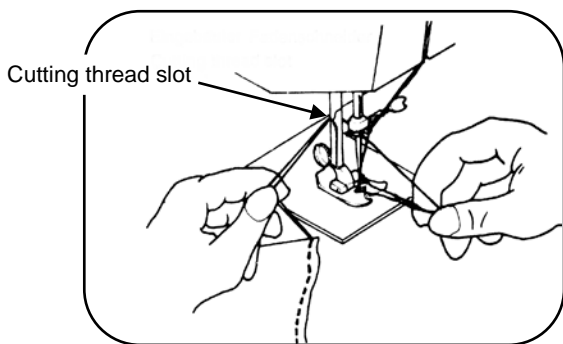

5. Cut threads as shown on the thread cutter.

STRAIGHT STITCH

1. This type of stitching is used most frequently.
2. The zigzag presser foot can be used for both straight and zigzag sewing.
3. For sewing light fabric, use a smaller stitch size. (Refer to page 16 for dial setting).

ZIGZAG SEWING



Pattern selector position

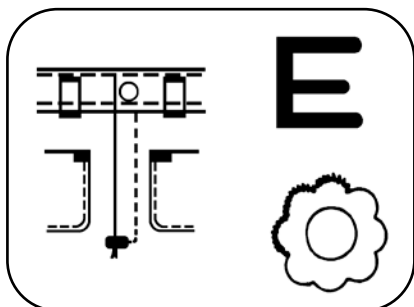

Satin stitching can be used for sewing initials, patterns, appliqué, etc.

AUTOMATIC EMBROIDERY

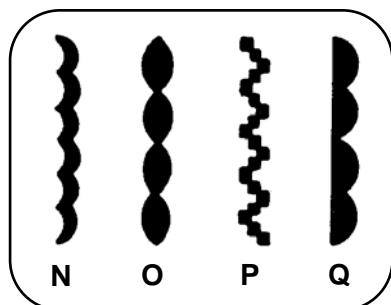

These stitches have a wide range of decorative and utility applications and are particularly suitable for woven fabrics. The Scallop stitch (N) is ideal for edging collars, cuffs, tablecloths, serviettes etc. For all the stitches, the stitch length can be reduced to achieve a close “satin stitch” if required.

With satin stitch a paper backing, will improve the result.

OVERCASTING

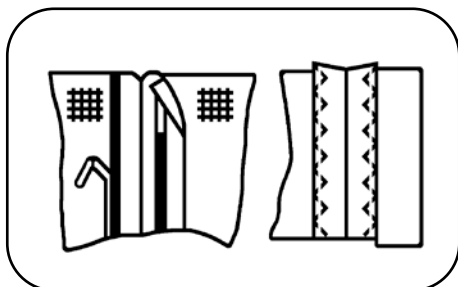

Use these stitches for oversewing rough edges.

STRAIGHT AND ZIGZAG STRETCH STITCHES

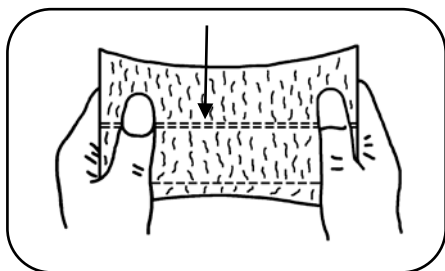

Use this stitch with knitted, tricot or other stretchy fabrics.
The stitch enables your seam to stretch without breaking the thread.

BLIND STITCH (Optional)



1. Fold fabric as shown.

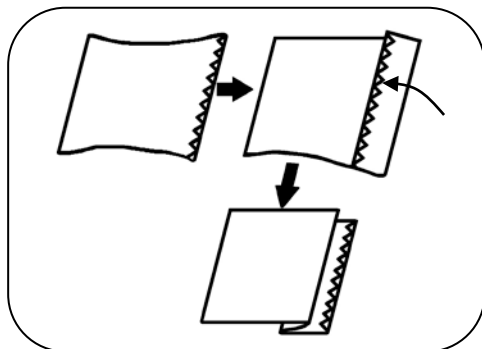

2. Finish the seam as shown.

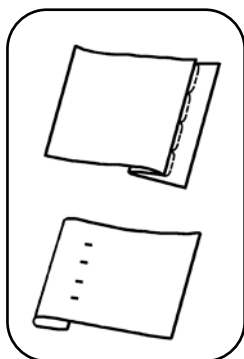



Adjust the width to obtain the correct seam.

Wrong: Needle is not piercing edge to fold at all.

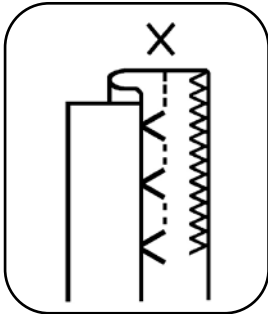

Needle pierces the edge of fold too much.

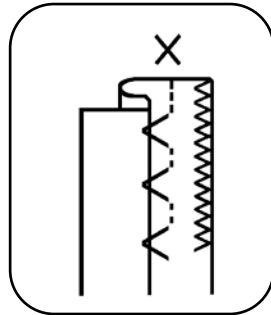

Correct seam.

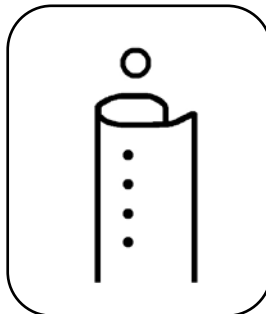

BUTTON SEWING

Utilize the button presser foot.

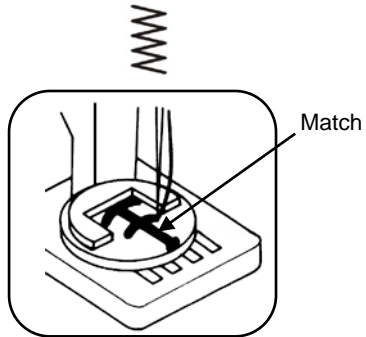
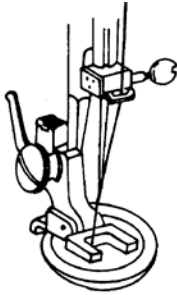

(Use drop feed see page 14)

1. Lower drop feed.
2. Place button presser foot in position and attach it firmly.
3. Place the button between presser foot and fabric and lower the presser foot.
4. Manually turn hand wheel towards you, ensuring that the needle enters into both holes of button without obstruction. (Increase or decrease width setting).
5. Sew about 7 stitches.
6. Pull both threads to the underside and tie them together.

BINDING

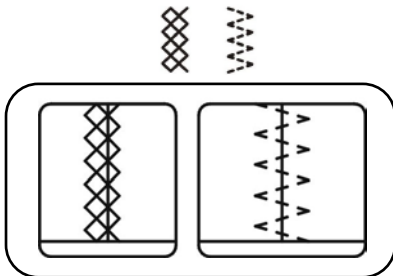

To sew fabrics edge select the multi-zigzag stitch.

ZIPPER SEWING

Utilize the zipper foot.

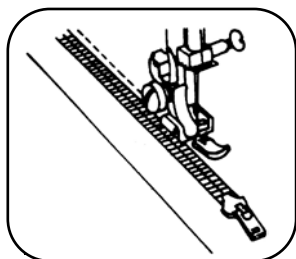

Select straight stitch.

1. Zipper foot is designed to sew close to a raised edge, thus preventing sewing on zipper.
2. Place zipper foot in position and attach firmly.
3. Fold the fabric about 2 cm and place the fabric under foot.

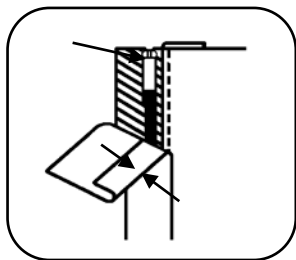



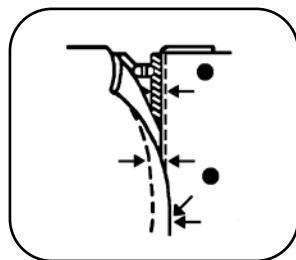



1. To sew the left side of the zipper, set the zipper on the right side of the needle.
2. To sew the right side of the zipper, set it on the left side of the needle.

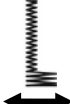

Sew as illustrated.

BUTTONHOLE SEWING

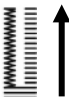
Utilise the foot of the buttonholes.
Set the stitch length dial.

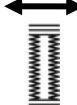
Pattern selector dial	Steps	Setting
		<ol style="list-style-type: none"> 1. Set dial to "1" position 2. Sew left side 3. Raise the needle
		<ol style="list-style-type: none"> 4. Set dial to "2" position 5. Sew 5-6 stitches 6. Raise the needle
		<ol style="list-style-type: none"> 7. Set dial to "3" position 8. Sew right side 9. Raise the needle
		<ol style="list-style-type: none"> 10. Set dial to "4" position 11. Sew 5-6 stitches 12. Raise the needle

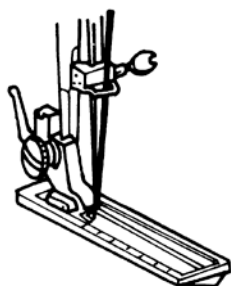

Before sewing, fit buttonhole foot as shown.

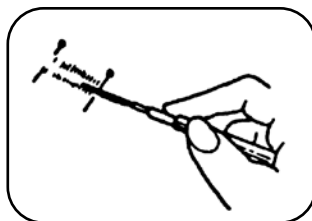

Cut buttonhole along centre with cutter as shown.

HEMMING

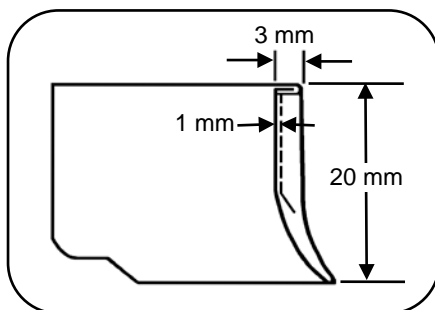

1. Raise the foot and the needle to its highest position. Replace the foot with the picot foot.
2. Fold over the fabric edge by about 3 mm and place it under the foot. Secure the folded edge with a few stitches. Slide the hem of your project into the picot foot by pulling the threads.

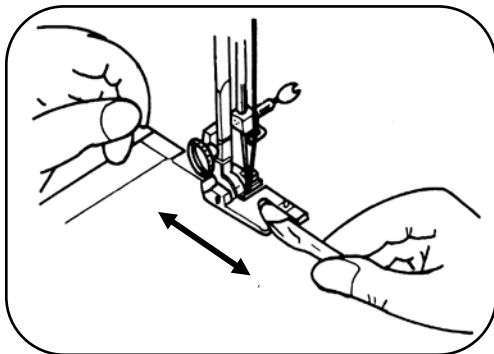

3. Lower the foot and sew the hem.
 4. While sewing fold the fabric to the left a little and guide it into the hemmer foot.
 5. Make sure that the fabric does not move under the right half of the foot. The fabric must be fed into the scroll of the hemmer sufficiently so that the project edge runs freely through the groove under the foot.
- Only suitable materials can be used and some practice may be necessary to achieve the best results.

TWIN NEEDLE (Optional)

Please place second extra spool pin into the position for twin needle sewing as page 4, no. 9 pic.

Put in the twin needle with the flat side backwards.

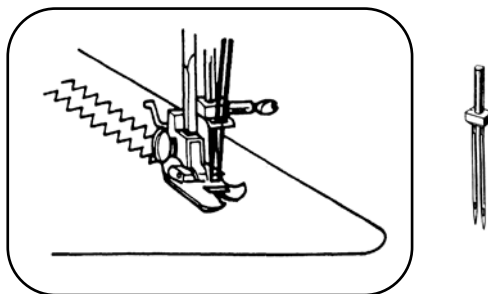

Thread the machine for normal sewing, leading both threads to needle and passing their ends separately through its eye.

Sewing width should not exceed the third widest stitch width, as this will break the needles.

ATTENTION: When using the twin needle, adjust the stitch width to maximally 3. Adjusting the stitch width to a higher number causes the needle to break.

EMBROIDERY

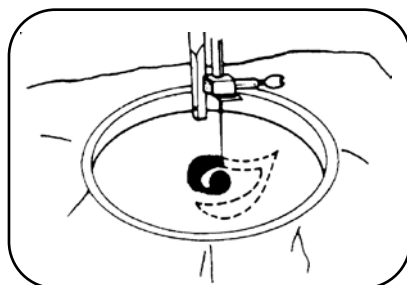

(Use drop feed see page 14)

Remove the presser foot and lower feed dog.

Lower feed dog and move the hooped fabric slowly in the desired direction until the fabric has been embroidered.

QUILTER (Optional)

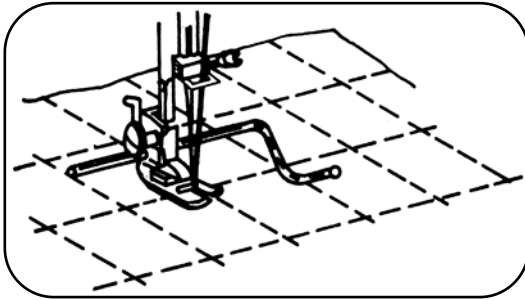

1. Slide the arm through the hole on top of the presser foot holder.
2. Move the quilter to the required stitch distance.

SEAM GUIDE

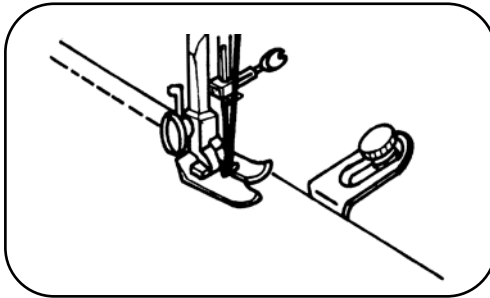

1. Use the seam guide to sew long seams of an equal distance from the edge of the fabric.
2. Screw the guide on the right side of the needle plate and adjust the desired distance.
3. While sewing, the edge of the fabric must touch the guide.

MAINTENANCE (CLEANING AND OILING)

Warning: Please always unplug the power plug before you change the bulb or perform maintenance work to the machine so that you prevent deadly peril and electric shock.

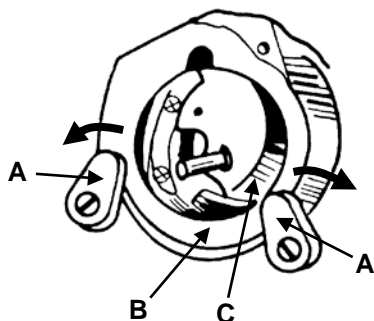

Cleaning shuttle race
 (A) Latch knob
 (B) Shuttle race cover
 (C) Shuttle hook

1. Raise needle to its highest position.
2. Take out the bobbin case.
3. Turn the latch knob A as illustrated.
4. Take off shuttle race cover.
5. Take out shuttle hook.
6. Clean and oil shuttle race and hook, thereafter replace all parts in reverse order.

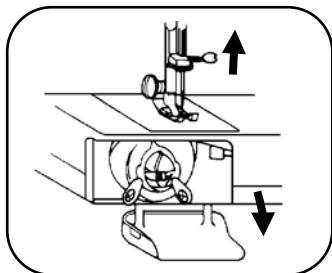

Open top cover and oil the parts indicated.

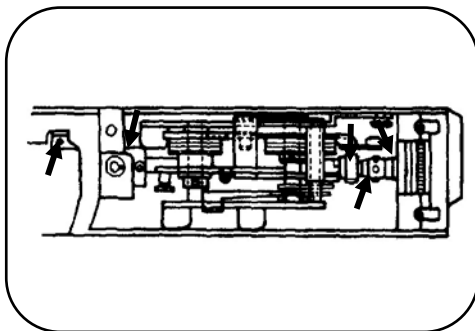

Open top cover and oil points indicated.

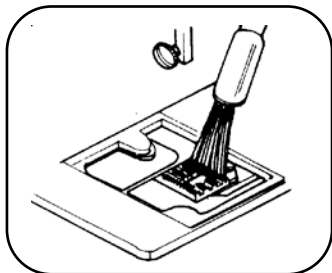

Cleaning feed dog.

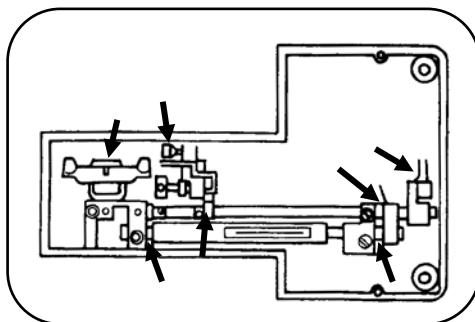

Oil points indicated on underside of bed base.

CHECKING PERFORMANCE PROBLEMS – TROUBLESHOOTING

Problem	Probable cause	What to do
Fabric does not move	<ul style="list-style-type: none"> - Feed teeth down - Stitch length dial "0" position - Light presser foot pressure 	<ul style="list-style-type: none"> - Raise feed teeth - Set dial between 1 and 4 - Increase pressure
Breaking needle	<ul style="list-style-type: none"> - Incorrect insertion of needle - Bent needle - Fabric is being pulled - Needle, thread and fabric do not match 	<ul style="list-style-type: none"> - Re-insert needle - Replace needle - Do not pull fabric - Use correct needle and thread
Breaking upper thread	<ul style="list-style-type: none"> - Faulty adjustment of zigzag width - Improper threading - Tight upper thread tension - Bent needle - Scratches or nicks on bobbin case 	<ul style="list-style-type: none"> - Re-adjust zigzag width - Re-thread machine - Reduce upper thread tension - Replace needle - Polish or replace bobbin case
Breaking bobbin thread	<ul style="list-style-type: none"> - Tight bobbin thread tension - Incorrect insertion of needle - Improper threading - Lint or thread in bobbin case 	<ul style="list-style-type: none"> - Reduce bobbin thread tension - Re-insert needle - Rethread machine - Clean bobbin case
Machine jamming	<ul style="list-style-type: none"> - Excessive tension - Presser foot pressure too strong - Needle, thread and fabric do not match - No oil 	<ul style="list-style-type: none"> - Re-adjust tension - Change pressure accordingly - Reduce proper needle and thread according to type of fabric - Oil moving parts
Puckering	<ul style="list-style-type: none"> - Tension too tight - Sewing foot pressure too strong - Incorrect fabric, needle, and thread 	<ul style="list-style-type: none"> - Reset - Reduce sewing foot pressure - Use correct fabric, needle and thread

STORING THE MACHINE

- Store the machine in its box or in a clean, dry place.
- Never wrap the power cord around the machine.

SERVICING THE MACHINE

If the unit is not operating correctly, please check the following:

- You have followed the instructions correctly.
- The wall socket is switched on.
- That the mains power supply is ON.
- That the plug is firmly in the mains socket.

If the machine still does not work after checking the above:

- Consult the retailer for possible repair or replacement. If the retailer fails to resolve the problem and you need to return the machine, make sure that:
 - The unit is packed carefully back into its original packaging.
 - Proof of purchase is attached.
 - A reason is provided for why it is being returned.

If the supply cord is damaged, it must be replaced by the manufacturer or an authorised service agent, in order to avoid any hazard. If service becomes necessary within the warranty period, the machine should be returned to an approved Home of Living Brands (Pty) Limited service centre. Servicing outside the warranty period is still available, but will, however, be chargeable.

**PLEASE AFFIX YOUR PROOF OF PURCHASE/RECEIPT HERE
IN THE EVENT OF A CLAIM UNDER WARRANTY THIS RECEIPT MUST BE PRODUCED.**

W A R R A N T Y

1. Home of Living Brands (Pty) Ltd ("Home of Living Brands") warrants to the original purchaser of this product ("the customer") that this product will be free of defects in quality and workmanship which under normal personal, family or household use and purpose may manifest within a period of 1 (one) year from the date of purchase ("warranty period").
2. Where the customer has purchased a product and it breaks, is defective or does not work properly for the intended purpose, the customer must notify the supplier from whom the customer bought the product ("the supplier") thereof within the warranty period. Any claim in terms of this warranty must be supported by a proof of purchase. If proof of purchase is not available, then repair, and/or service charges may be payable by the customer to the supplier.
3. The faulty product must be taken to the supplier's service centre to exercise the warranty.
4. The supplier will refund, repair or exchange the product in terms of this warranty subject to legislative requirements. This warranty shall be valid only where the customer has not broken the product himself, or used the product for something that it is not supposed to be used for. The warranty does not include and will not be construed to cover products damaged as a result of disaster, misuse, tamper, abuse or any unauthorised modification or repair of the product.
5. This warranty will extend only to the product provided at the date of the purchase and not to any expendables attached or installed by the customer.
6. If the customer requests that the supplier repairs the product and the product breaks or fails to work properly within 3 (three) months of the repair and not as a result of misuse, tampering or modification by or on behalf of the customer, then the supplier may replace the product or pay a refund to the customer.
7. The customer may be responsible for certain costs where products returned are not in the original packaging, or if the packaging is damaged. This will be deducted from any refund paid to the customer.

HOME OF LIVING BRANDS (PTY) LTD (JOHANNESBURG)

JOHANNESBURG

TEL NO. (011) 490-9600

CAPE TOWN

TEL NO. (021) 552-5161

DURBAN

TEL NO. (031) 792-6000

www.homeoflivingbrands.co.za

